

① BASE MAP

GENERAL NOTES

1. GASTINEAU SCHOOL WAS CONSTRUCTED IN THREE GENERAL PHASES: AREAS A AND C IN 1956; AREA D IN 1965; AND AREA B IN 1989. NO HAZARDOUS MATERIALS HAVE BEEN IDENTIFIED IN AREA B. SEE BASE MAP FOR AREA LOCATIONS.
2. ORIGINAL VINYL ASBESTOS FLOOR TILE (VAT) AND ASSOCIATED BLACK MASTIC ARE ASBESTOS–CONTAINING MATERIALS. ORIGINAL VAT AND MASTIC REMAIN UNDER VARIOUS FINISHES THROUGHOUT THE BUILDING. VAT HAS BEEN ABATED IN SOME AREAS, WITH NEW FLOORINGS INSTALLED OVER ACM BLACK MASTIC RESIDUE. ALL AREAS REQUIRING ABATEMENT OF FLOOR FINISHES SHALL BE ABATED TO A CLEAN CONCRETE FINAL SURFACE SUITABLE FOR GRINDING BY NON–CERTIFIED WORKERS.
3. ORIGINAL PIPE FITTING THERMAL SYSTEM INSULATION (TSI) THROUGHOUT THE BUILDING IS ACM. AN ABATEMENT PROJECT IN 1989 REMOVED ALL FITTING TSI IN THE BOILER ROOM, FAN ROOM 9, AND FAN ROOM 30. ORIGINAL FITTING TSI IS NOT SEEN IN THE ABOVE–CEILING SPACE BUT MAY EXIST IN LOCATIONS THAT ARE OBSCURED FROM VIEW. ORIGINAL FITTING TSI REMAINS TO AN UNKNOWN EXTENT INSIDE WALLS SERVING HEATERS AND PLUMBING FIXTURES.
4. ACM CEMENT ASBESTOS BOARD (CAB) WAS USED AS A FINAL FINISH ON EXTERIOR SOFFITS AND ABOVE WINDOWS AND DOORS. CAB IS ALSO COATED WITH LEAD–BASED PAINT AND SHOULD BE HANDLED AND DISPOSED OF IN ACCORDANCE WITH REGULATIONS FOR BOTH MATERIALS.
5. CERAMIC TILE FOUND IN TOILET ROOMS AND SHOWERS CONTAINS LEAD. TCLP ANALYSIS HAS BEEN PERFORMED AND SHOWS THAT THE TILE MEETS THE REGULATION REQUIREMENTS FOR DISPOSAL IN A MUNICIPAL LANDFILL. ALL TILE REMOVAL WORK SHALL BE PERFORMED BY WORKERS CERTIFIED FOR LEAD REMOVAL AND BY A CREW HOLDING EPA LEAD RRP CERTIFICATION. CERAMIC TILE MAY BE DISPOSED OF ALONG WITH GENERAL CONSTRUCTION DEBRIS.
6. SOME SINKS AND TOILETS IN THE BUILDING CONTAIN LEAD GLAZES. THESE FIXTURES SHALL BE REMOVED BY CERTIFIED LEAD WORKERS AND SHALL BE STOCKPILED UNTILTCLP ANALYSIS INDICATES THE APPROPRIATE METHOD FOR DISPOSAL.
7. ROOFING MATERIALS ON THE BUILDING HAVE BEEN ABATED AS PART OF A PAST PROJECT, BUT ACM ROOFING STILL REMAINS ON THE ENTRANCE CANOPY.
8. BALLASTS AND BULBS FROM ALL FLUORESCNT FIXTURES SHALL BE REMOVED AND DISPOSED OF AS A PART OF THIS PROJECT.
9. SOME WHITEBOARDS AND BULLETIN BOARDS CONTAIN LEAD AND SHALL BE REMOVED BY LEAD WORKERS. THESE MATERIALS MAY BE DISPOSED OF ALONG WITH GENERAL CONSTRUCTION DEBRIS.
10. I–BEAMS IN THE 1956 AND 1965 WINGS (AREAS A, C, AND D) ARE COATED WITH LEAD–BASED PRIMER. SOME AREAS OF THE BEAMS REQUIRE CUTTING OR WELDING FOR STRUCTURAL UPGRADES. GENERAL CONTRACTOR MAY REQUIRE ABATEMENT FOR CUTTING IN MORE AREAS THAN SHOWN ON THE DRAWINGS FOR EASE OF DEMOLITION. ABATEMENT SUBCONTRACTOR SHALL COORDINATE WITH GENERAL CONTRACTOR REGARDING THE NUMBER OF LOCATIONS TO BE ABATED. OWNER SHALL NOT PAY EXTRA COSTS FOR ADDITIONAL AREAS ADDED TO THE WORK FOR EASE OF DEMOLITION.

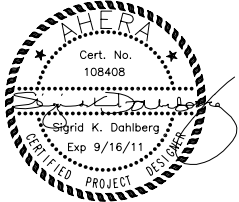

**CD Carson Dorn Inc.**  
712 WEST 12TH STREET  
JUNEAU, ALASKA 99801  
(907) 586-4447



1" = 1'-0"  
IF THE ABOVE DIMENSION DOES NOT  
EQUAL EXACTLY 1", THIS DRAWING  
HAS BEEN ENLARGED OR REDUCED,  
AFFECTING ALL LABELLED SCALES

GASTINEAU ELEMENTARY SCHOOL  
RENOVATION  
CBJ Contract No. E11-137  
JUNEAU, ALASKA

SHEET TITLE:  
HAZARDOUS  
MATERIALS

DATE: NOV. 15, 2010  
REVISION: ....  
CHECKED BY: SKD  
DRAWN: RAS

SHEET #

HAZO.O

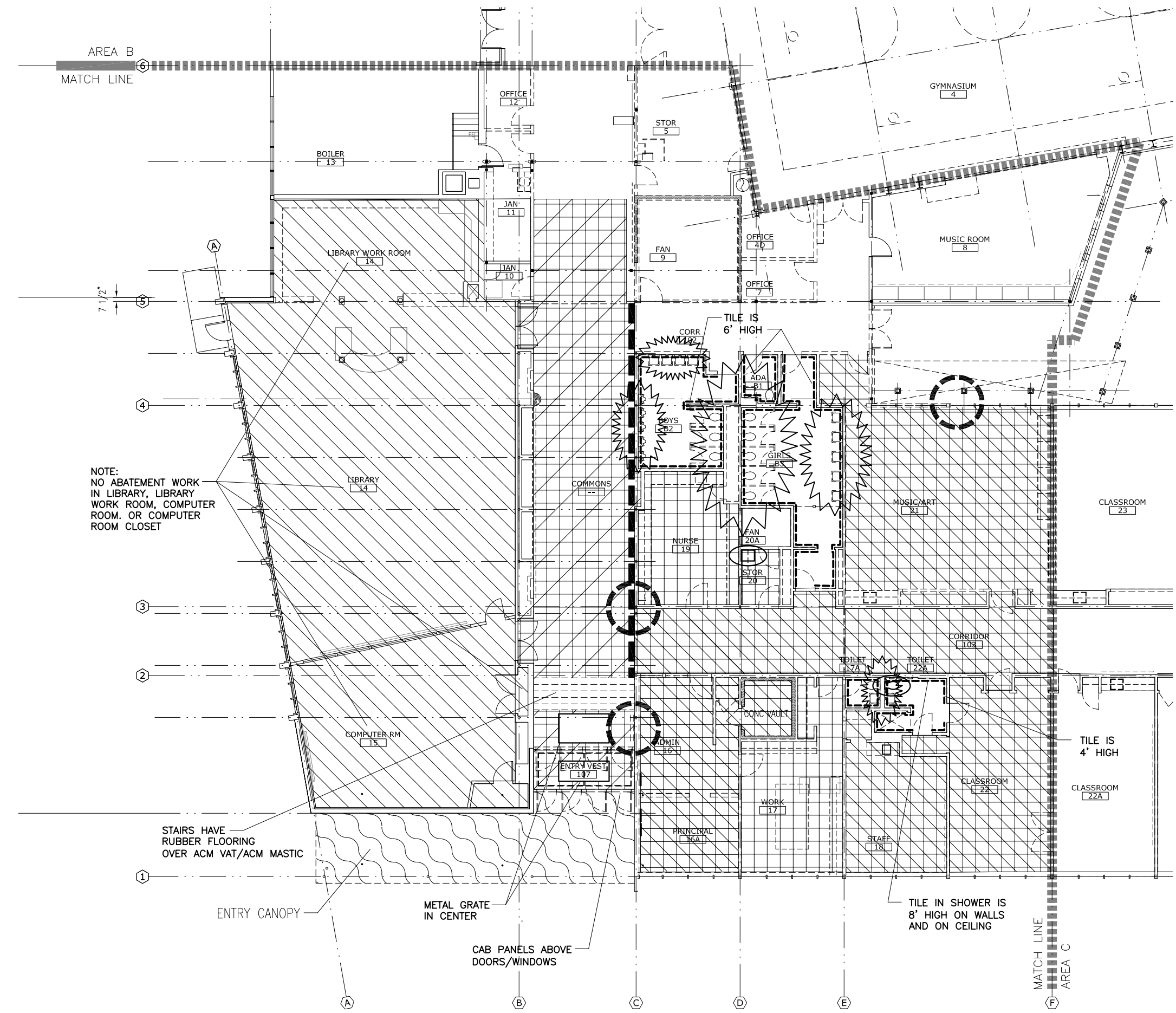

WORK THIS SHEET

1. REMOVE & DISPOSE OF CARPET OVER ACM VAT/ACM MASTIC DOWN TO CLEAN CONCRETE IN ADMIN 16, PRINCIPAL 16A, STAFF 18, CLASSROOMS 21 AND 22 AND CORRIDOR 103 INCLUDING ALL STORAGE CLOSET AND COAT CLOSET AREAS.
2. REMOVE & DISPOSE OF RUBBER FLOORING OVER ACM VAT/MASTIC DOWN TO CLEAN CONCRETE IN ENTRY VEST 107, STAIR LOBBY, AND COMMONS.
3. REMOVE & DISPOSE OF CERAMIC WALL TILE WITH LEAD GLAZE IN BOY'S TOILET B2, GIRL'S TOILET B3, STAFF TOILET 17A, AND TOILET 22A.
4. REMOVE AND DISPOSE OF PIPE INSULATION OF WHATEVER NATURE AS INDICATED. SEE MECHANICAL SHEETS M1.11 AND M1.21 FOR PIPING DETAILS.
5. ABATE LEAD-BASED PAINT ON 36" SECTION OF I-BEAM IN PREPARATION FOR CUTTING AND WELDING IN EACH AREA INDICATED. COORDINATE WORK WITH GENERAL CONTRACTOR.
6. REMOVE & DISPOSE OF ALL FLUORESCENT BULBS AND BALLASTS THROUGHOUT THE BUILDING.
7. REMOVE & DISPOSE OF ACM CAB EXTERIOR SIDING AND SOFFIT ALONG WEST WALL OF GYM FROM GRIDLINE 2 TO GRIDLINE 5 AS SHOWN.
8. REMOVE & DISPOSE OF ACM CAB SOFFIT WITH LEAD-BASED PAINT ON UNDERSIDE OF CANOPY, ALONG WEST SIDE OF COMMONS AT ROOF LEVEL. SEE SHEETS A4.0, A4.2, A4.3, AND A5.0 FOR ELEVATION VIEW.
9. REMOVE & DISPOSE OF ACM ASPHALTIC ROOFING ON ENTRY CANOPY AND ACM CAB SOFFIT ON UNDERSIDE OF ENTRY CANOPY.

LEGEND

- CARPET OVER ACM VAT/ACM MASTIC
- CARPET OVER ACM MASTIC
- RUBBER FLOORING OVER ACM VAT/ACM MASTIC
- NON-ACM VT/ACM MASTIC OVER ACM VAT/ACM MASTIC
- ACM ROOFING / ACM CAB SOFFIT BELOW
- CERAMIC TILE ON WALL (LEAD DISPOSAL CONCERN)
- ACM CAB ON WALL
- TOILET OR SINK w/ LEAD DISPOSAL CONCERNS
- PIPE FITTING TSI IN WALLS OR CEILINGS.
- I-BEAM REQUIRING LBP ABATEMENT

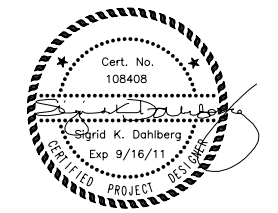
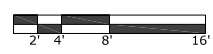
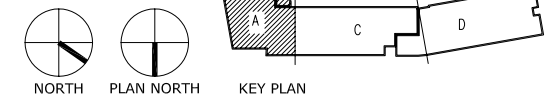

**Carson Dorn Inc.**  
712 WEST 12TH STREET  
JUNEAU, ALASKA 99801  
(907) 586-4447

**NorthWind Architects LLC**

IF THE ABOVE DIMENSION DOES NOT EQUAL EXACTLY 1", THIS DRAWING HAS BEEN ENLARGED OR REDUCED, AFFECTING ALL LABELLED SCALES

GASTINEAU ELEMENTARY SCHOOL  
RENOVATION  
CBJ Contract No. E11-137  
JUNEAU, ALASKA

SHEET TITLE:  
**HAZARDOUS MATERIALS**

DATE: NOV. 15, 2010

REVISION: ....

CHECKED BY: SKD

DRAWN: RAS

SHEET #

HAZ1.0

LEGEND

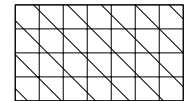

CARPET OVER ACM VAT/ACM MASTIC



CARPET OVER ACM MASTIC

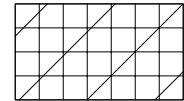

RUBBER FLOORING OVER ACM VAT/ACM MASTIC

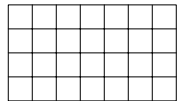

ACM VAT/ACM MASTIC

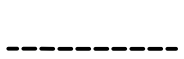

CERAMIC TILE ON WALL (LEAD DISPOSAL CONCERN)



TOILET OR SINK w/ LEAD DISPOSAL CONCERNS



WHITEBOARD AND/OR PINBOARD WITH LEAD CONCERNS

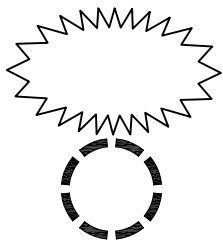

PIPE FITTING TSI IN WALLS OR CEILINGS.



I-BEAM REQUIRING LBP ABATEMENT

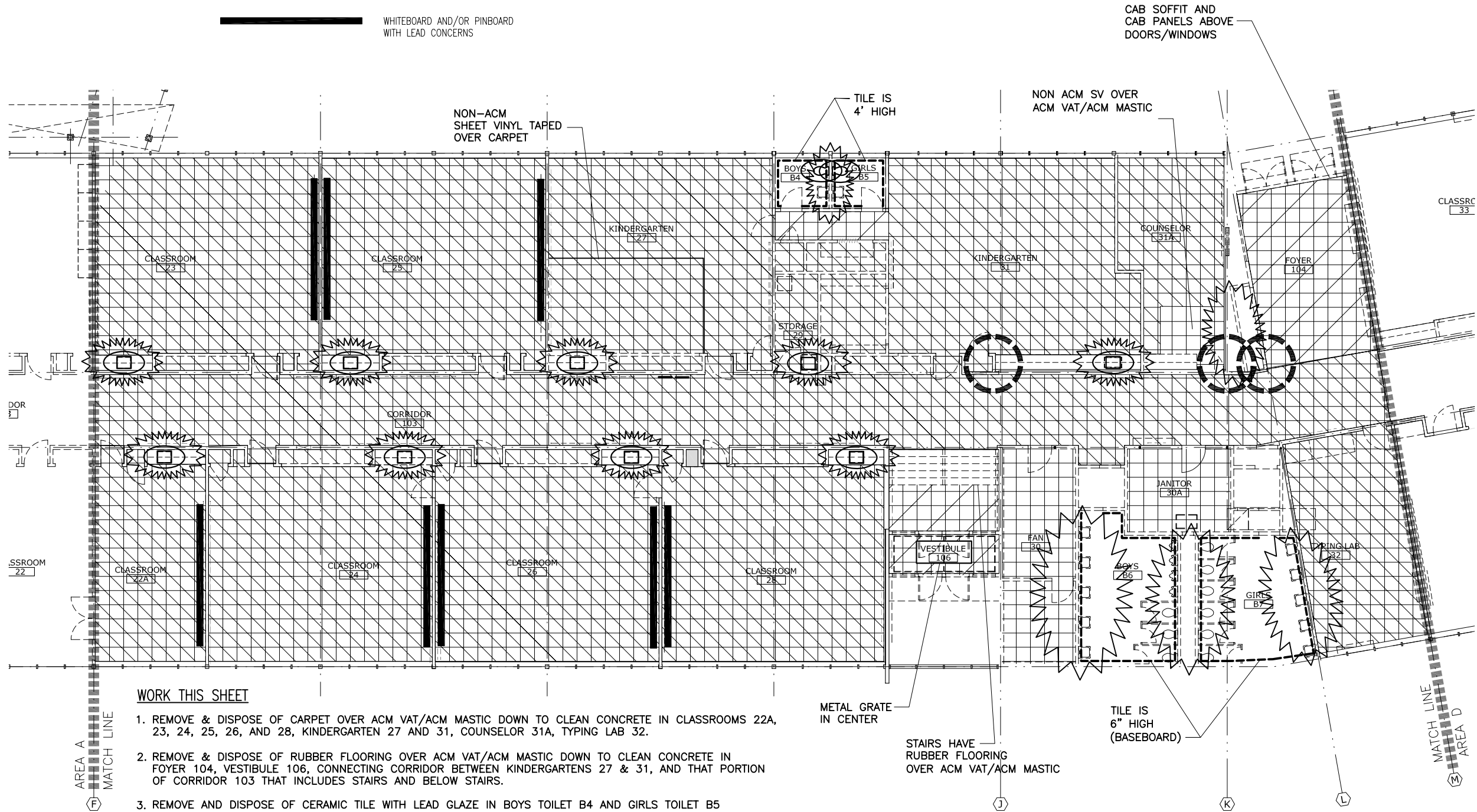

WORK THIS SHEET

1. REMOVE & DISPOSE OF CARPET OVER ACM VAT/ACM MASTIC DOWN TO CLEAN CONCRETE IN CLASSROOMS 22A, 23, 24, 25, 26, AND 28, KINDERGARTEN 27 AND 31, COUNSELOR 31A, TYPING LAB 32.
2. REMOVE & DISPOSE OF RUBBER FLOORING OVER ACM VAT/ACM MASTIC DOWN TO CLEAN CONCRETE IN FOYER 104, VESTIBULE 106, CONNECTING CORRIDOR BETWEEN KINDERGARTENS 27 & 31, AND THAT PORTION OF CORRIDOR 103 THAT INCLUDES STAIRS AND BELOW STAIRS.
3. REMOVE AND DISPOSE OF CERAMIC TILE WITH LEAD GLAZE IN BOYS TOILET B4 AND GIRLS TOILET B5 (4' HIGH) AND BOYS TOILET B6 AND GIRLS TOILET B7 (BASEBOARD ONLY).
4. REMOVE AND DISPOSE OF PIPE INSULATION OF WHATEVER NATURE AS INDICATED. SEE MECHANICAL SHEETS M1.13 AND M1.23 FOR PIPING DETAILS.
5. REMOVE & DISPOSE OF WHITEBOARDS AND/OR PINBOARDS IN ALL CLASSROOMS WHEREVER THEY OCCUR.
6. ABATE LEAD-BASED PAINT ON A 36" SECTION OF I-BEAM IN PREPARATION FOR CUTTING AND WELDING IN EACH AREA INDICATED. COORDINATE WORK WITH GENERAL CONTRACTOR.
7. REMOVE & DISPOSE OF ALL FLUORESCENT BULBS AND BALLASTS THROUGHOUT THE BUILDING.

1 AREA C | HAZARDOUS MATERIALS

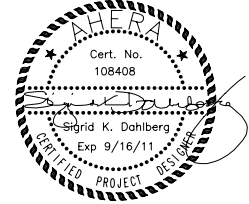
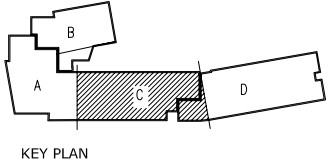
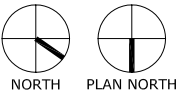
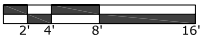

**Carson Dorn Inc.**  
712 WEST 12TH STREET  
JUNEAU, ALASKA 99801  
(907) 586-4447



1" = 1'  
IF THE ABOVE DIMENSION DOES NOT EQUAL EXACTLY 1", THIS DRAWING HAS BEEN ENLARGED OR REDUCED, AFFECTING ALL LABELLED SCALES

GASTINEAU ELEMENTARY SCHOOL  
RENOVATION  
CBJ Contract No. E11-137  
JUNEAU, ALASKA

SHEET TITLE:  
HAZARDOUS MATERIALS

DATE: NOV. 15, 2010  
REVISION: ....  
CHECKED BY: SKD  
DRAWN: RAS

SHEET #

HAZ1.2

WORK THIS SHEET

- 1. REMOVE & DISPOSE OF CARPET OVER ACM VAT/ACM MASTIC DOWN TO CLEAN CONCRETE IN CLASSROOMS 33 THROUGH 41 (10 ROOMS) AND CORRIDOR 105, INCLUDING ALL STORAGE CLOSET AND COAT CLOSET AREAS.
- 2. REMOVE & DISPOSE OF SINKS WITH LEAD CONCERNS IN CLASSROOMS 33–41 AS SHOWN. TEST FOR DISPOSAL.
- 3. REMOVE AND DISPOSE OF PIPE INSULATION OF WHATEVER NATURE AS INDICATED. SEE MECHANICAL SHEETS M1.14 AND M1.24 FOR PIPING DETAILS.
- 4. REMOVE & DISPOSE OF WHITEBOARDS AND/OR PINBOARDS IN ALL CLASSROOMS WHEREVER THEY OCCUR.
- 5. ABATE LEAD–BASED PAINT ON A 36” SECTION OF I–BEAM IN PREPARATION FOR CUTTING AND WELDING IN EACH AREA INDICATED. COORDINATE WORK WITH GENERAL CONTRACTOR.
- 6. REMOVE & DISPOSE OF ALL FLUORESCENT BULBS AND BALLASTS IN THROUGHOUT THE BUILDING.
- 7. REMOVE & DISPOSE OF METAL GRATE WITH LEAD–BASED PAINT AT WEST ENTRANCE TO BUILDING.
- 8. REMOVE AND DISPOSE OF EXTERIOR ACM CAB ABOVE DOORS AT WEST ENTRANCE.

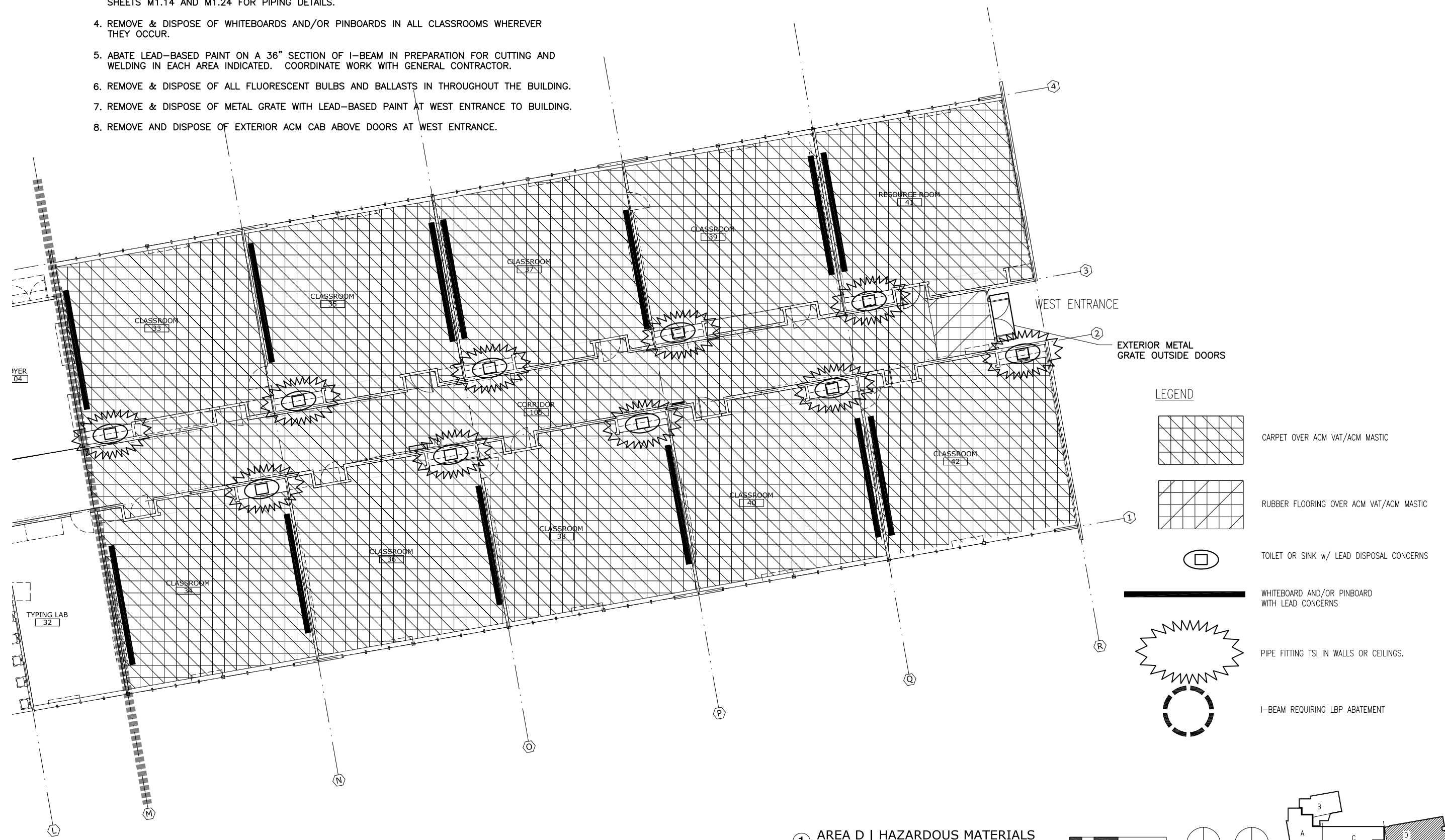

**Carson Dorn Inc.**  
712 WEST 12TH STREET  
JUNEAU, ALASKA 99801  
(907) 586-4447



IF THE ABOVE DIMENSION DOES NOT EQUAL EXACTLY 1", THIS DRAWING HAS BEEN ENLARGED OR REDUCED, AFFECTING ALL LABELLED SCALES

GASTINEAU ELEMENTARY SCHOOL  
RENOVATION  
CBJ Contract No. E11-137  
JUNEAU, ALASKA

SHEET TITLE:  
**HAZARDOUS MATERIALS**

DATE: NOV. 15, 2010

REVISION: ....

CHECKED BY: SKD

DRAWN: RAS

SHEET #

1 AREA D | HAZARDOUS MATERIALS

