

Riverside Rotary Park Playground

City and Borough of Juneau, Department of Engineering and Public Works,
Project number: BE18-087

Bid Documents
December, 2017

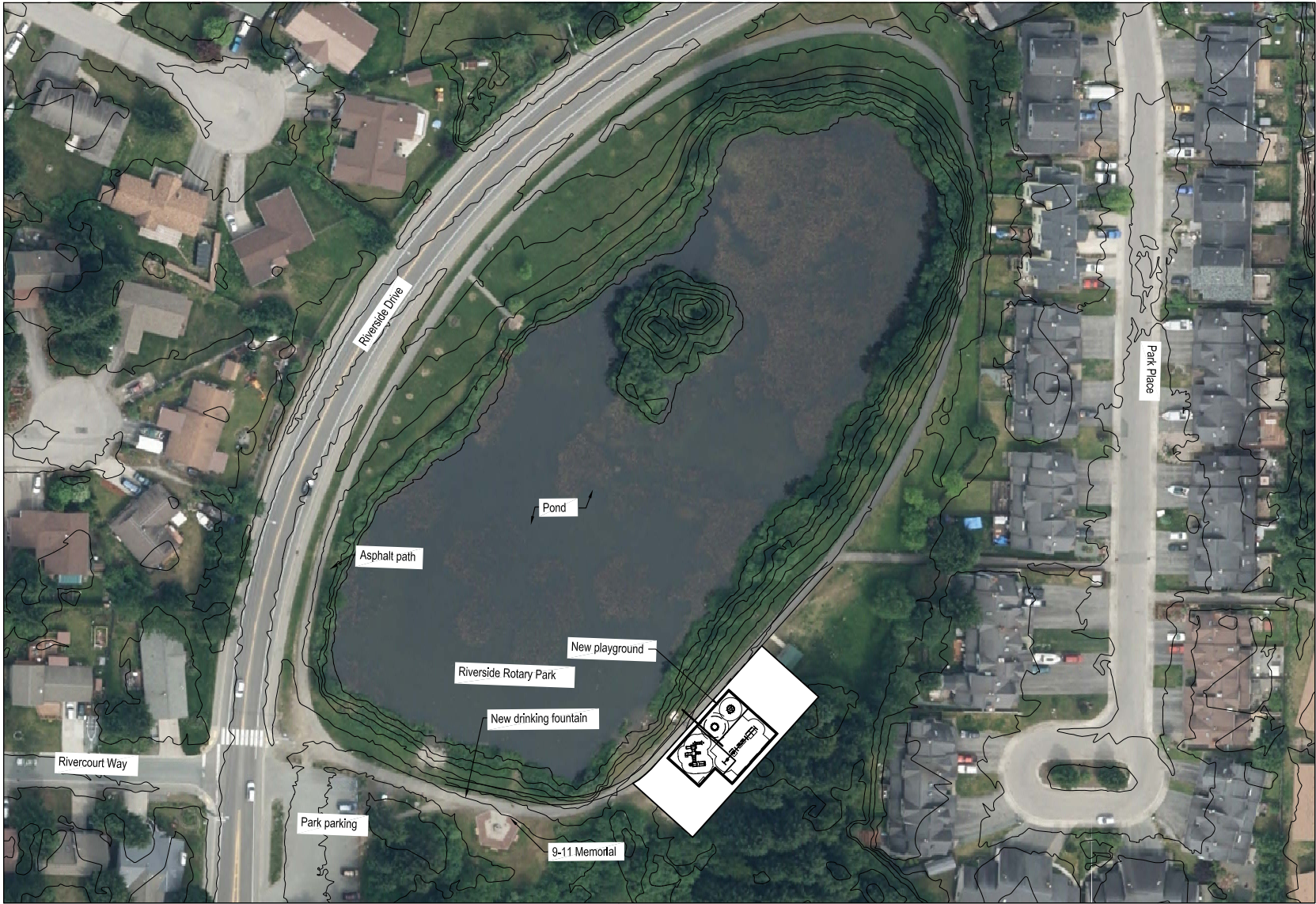

Vicinity Map - NTS

PROJECT TEAM

OWNER

City and Borough of Juneau
Lisa EaganLagerquist
Engineering and Public Works
155 South Seward St
Juneau, Alaska
p: (907) 586-0893
Lisa.EaganLagerquist@juneau.org

LANDSCAPE ARCHITECT

Corvus Design, Inc.
Chris Merti
119 Seward St., Unit 15
Juneau, AK, 99801
p: (907) 988-9000
cmerti@corvus-design.com



Landscape Architecture
www.corvus-design.com
Anchorage - 907.222.2859
2506-B Fairbanks St, 99503
Juneau - 907.988.9000
119 Seward St, 99801
AECC #1195



SEAL:



City and Borough of Juneau
Riverside Rotary Park Playground
Bid Documents, BE18-087
Juneau, Alaska

DATE: 2017-12-14
JOB NUMBER: CBJ-17-01
DRAWN BY: LM/PB
CHECKED BY: CM/PB

Cover Sheet, Vicinity
Map, & Sheet Index
SHEET #:

G100

© CORVUS DESIGN. ALL RIGHTS RESERVED

SHEET INDEX

GENERAL

G100 COVER SHEET, VICINITY MAP, AND SHEET INDEX
D100 EXISTING CONDITIONS AND DEMOLITION PLAN

SITE

L100 LAYOUT & SUBDRAIN PLAN
L500 DETAILS

ABBREVIATIONS AND SYMBOLS

Ø	Diameter or Round	N	Non-Frost Susceptible
A	Adjacent	NIC	Not In Contract
ADJ	Approximate	NTS	Not To Scale
B	Balled And Burlap	O	On Center
B&B		OC	
C	Container Grown	R	Roof Drain
CG	Clear	RD	Right Of Way
CLR	Concrete	ROW	
CONC	Continuous	S	Specification
CONT		SPEC	Slope/Grade to Drain
D	Demolish, Demolition	SLOPE	
DEMO	Diameter	T	To Be Determined
DIA		TBD	Top of Curb
E	Each	TOC	Top of Wall
EA	Elevation	TOW	Typical
ELEV	Equal	TYP	
EQ	Existing	V	Vertical
EX.		VERT	Verify in Field
F	Finished Grade	VIF	
FG		W	With
G	Grade Break	W/	
GB			
H	Horizontal		
HORZ	Height		
HT			
L	Limit of Work		
LOW	Low Point		
LP			
M	Maximum		
MAX	Minimum		
MIN	Miscellaneous		
MISC			

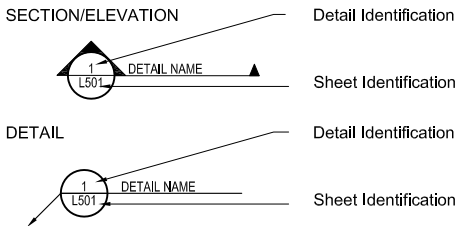

- Notes:
- This set includes items to be installed by the contractor as well as items to be installed by others. Items to be installed by others will be notated as either NIC (Not in Contract) or 'By Others'. See specifications for more information, clarifications, and phasing of work.
 - Existing items shown have not been located by survey. It is the contractor's responsibility to verify conditions, locations, and amounts of materials to be removed or replaced.

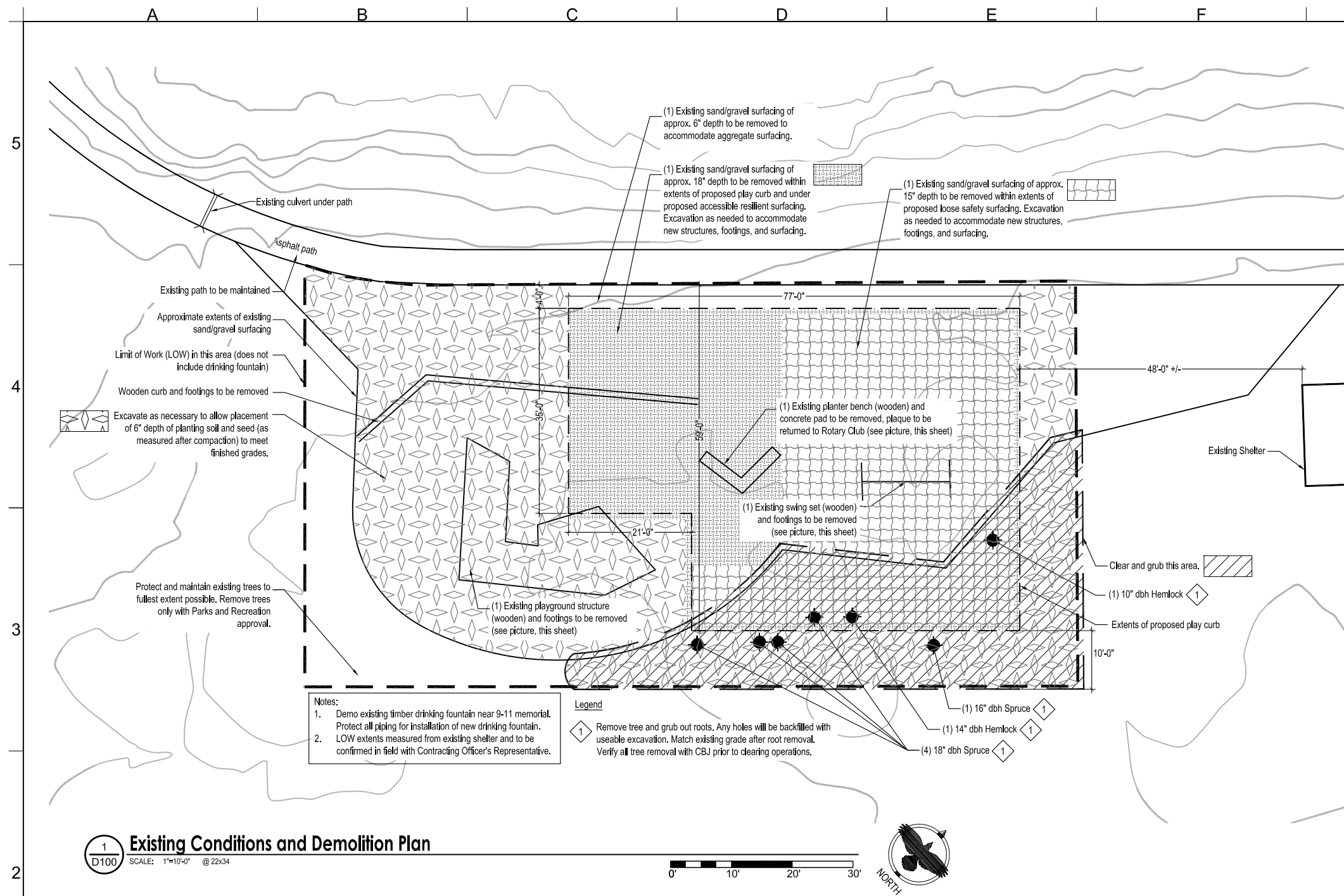

Existing play structure (wooden)



Existing planter bench and swings (wooden)



Existing swings and character of existing trees to be removed for new swing set (approximate)



Corvus Design
Landscape Architecture
www.corvus-design.com
Anchorage - 907.222.2859
2506-B Fairbanks St., 99503
Juneau - 907.988.9000
119 Seward St., 99801
AEC# #1195



SEAL:



City and Borough of Juneau
Riverside Rotary Park Playground
Bid Documents, BE18-087
Juneau, Alaska

1" = ACTUAL

DATE: 2017-12-14
JOB NUMBER: CBJ-17-01
DRAWN BY: LM/PB
CHECKED BY: CM/PB

Existing Conditions
and Demolition Plan
SHEET #:

D100

A B C D E F G H

5

4

3

2

1

Surfacing Legend

- Loose safety surfacing
- Accessible resilient surfacing

Notes:

- Notes:
- Verify layout with play equipment manufacturer on minimum dimensions for fall zones for all equipment and verify in field prior to installation.
 - Install new drinking fountain with concrete base as recommended by manufacturer. Install at location of demolished drinking fountain. Orient bowl toward path. Contractor to excavate all footings (for all play equipment and bench) to required depth and width as directed by manufacturer. Contractor to install forms for all footings. Installation of play equipment, bench, and concrete footings by Others.

1 Site and Layout Plan

SCALE: 1"=10'-0" @ 22x34



2 Subdrainage Plan

SCALE: 1"=10'-0" @ 22x34



3 Planting Soil and Seed Plan

SCALE: 1"=20'-0" @ 22x34



Corvus Design
Landscape Architecture
www.corvus-design.com
Anchorage - 907.222.2859
2506-B Fairbanks St., 99503
Juneau - 907.988.9000
119 Seward St., 99801
AECC #1195



City and Borough of Juneau
Riverside Rotary Park Playground
Bid Documents, BE18-087
Juneau, Alaska

1" = ACTUAL

DATE: 2017-12-14
JOB NUMBER: CBJ-17-01
DRAWN BY: LM/PB
CHECKED BY: CM/PB

Layout Plan

SHEET #:

L100

© CORVUS DESIGN. ALL RIGHTS RESERVED

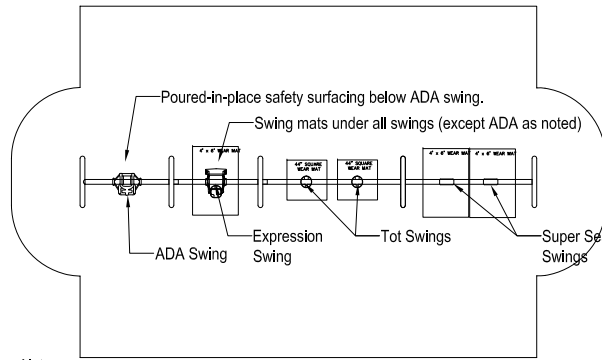

Notes:
1) Swings to be provided by Contractor, installed by others.
2) Swing Mats and surfacing below swings to be installed by Contractor.

7 Swings
SCALE: NTS
dt-play-swing.dwg

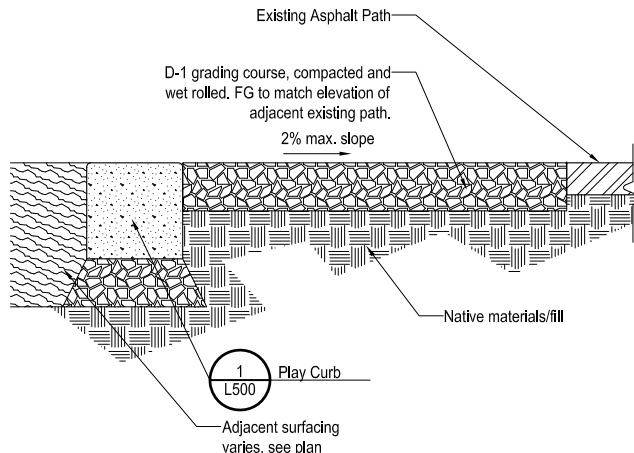

4 Aggregate Surfacing
SCALE: 1"=1'-0"
dt-pvmt-aggr.dwg

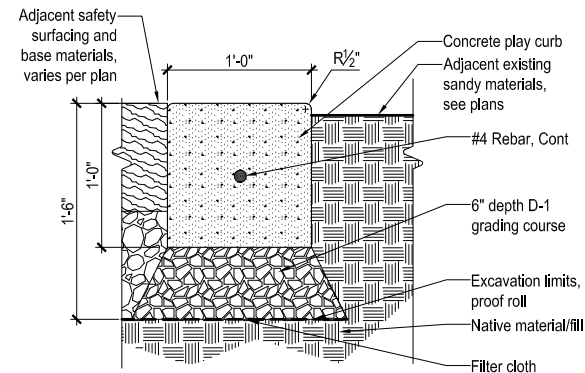

Note:
Expansion joints shall be symmetrically/equidistantly located a maximum of 16' apart. Control joints shall be placed equidistantly between expansion joints a maximum of 4' apart, and diagonally across curb at corners.

1 Play Curb
SCALE: 1 1/2"=1'-0"
dt-play-curb.dwg

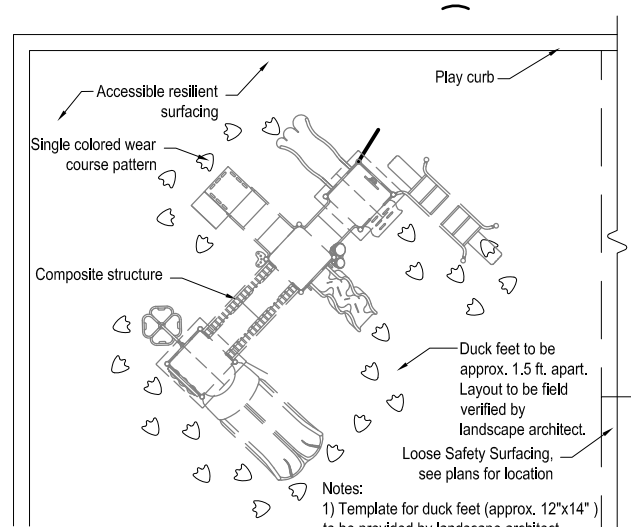

8 Play Surfacing Pattern
SCALE: 3/16"=1'-0"
dt-play-surf-pln.dwg

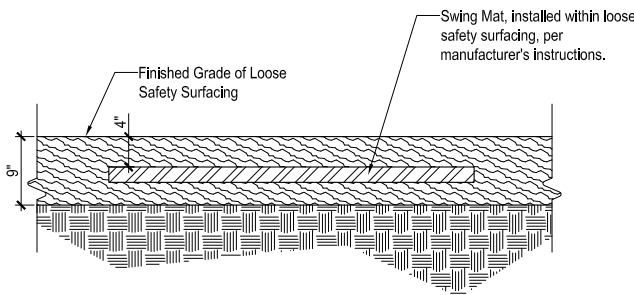

5 Swing Mat
SCALE: NTS - detail is diagrammatic only
dt-play-surf-mat.dwg

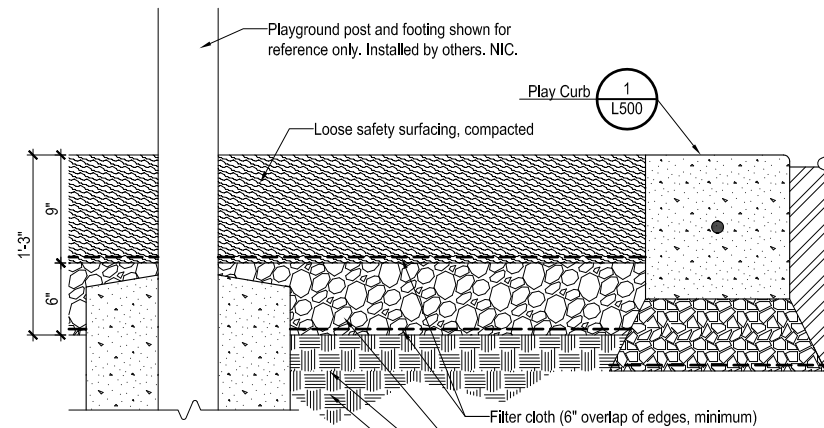

Note: Thickness of safety surfacing shown is for specified product and materials listed. It is the contractor's responsibility to verify all thickness of materials with manufacturer to ensure all safety standards are met for all play equipment and surfacing.

2 Loose Play Surfacing
SCALE: 1 1/2"=1'-0"
dt-play-surf-loos.dwg

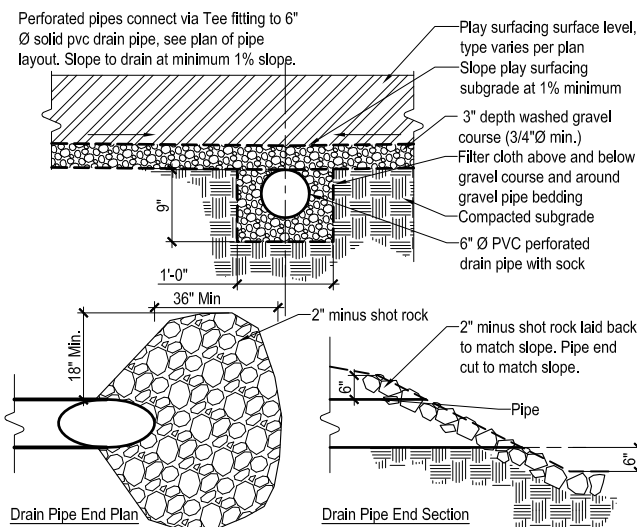

9 Playground Subdrain
SCALE: NTS
dt-play-drain.dwg

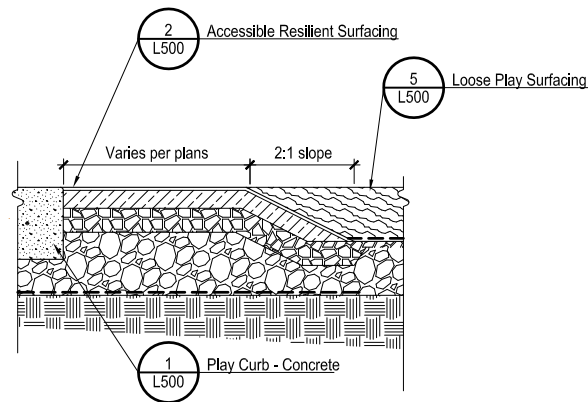

6 Play Surfacing - Transition
SCALE: 3/4"=1'-0"
dt-play-tran.dwg

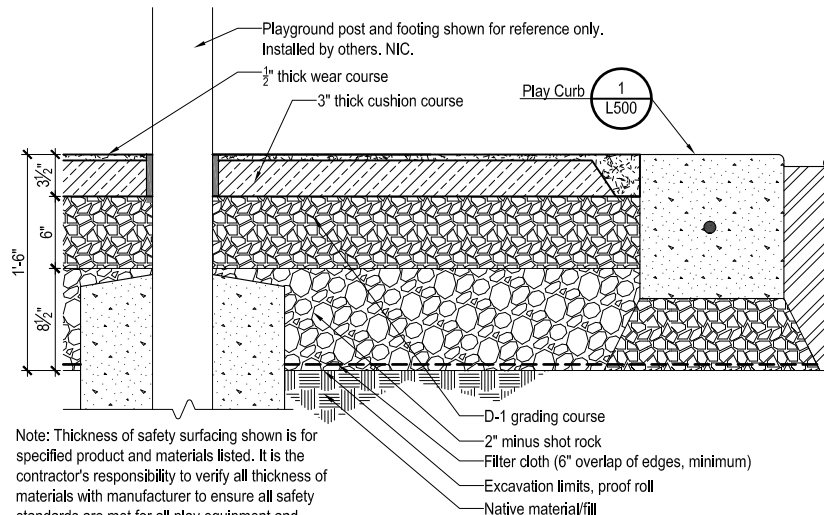

Note: Thickness of safety surfacing shown is for specified product and materials listed. It is the contractor's responsibility to verify all thickness of materials with manufacturer to ensure all safety standards are met for all play equipment and surfacing.

3 Accessible Resilient Surfacing
SCALE: 1 1/2"=1'-0"
dt-play-surf.dwg



Landscape Architecture
www.corvus-design.com
Anchorage - 907.222.2859
2506-B Fairbanks St, 99503
Juneau - 907.988.9000
119 Seward St, 99801
AECC #1195

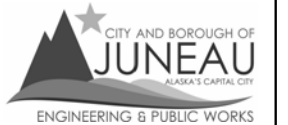

SEAL:

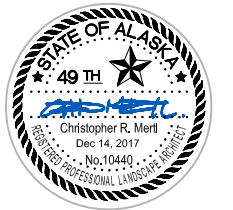

City and Borough of Juneau
Riverside Rotary Park Playground
Bid Documents, BE18-087
Juneau, Alaska

If the above dimension does not measure one inch (1") exactly, this drawing will have been enlarged or reduced, affecting all labeled scales.

DATE: 2017-12-14
JOB NUMBER: CBJ-17-01
DRAWN BY: LM/PB
CHECKED BY: CM/PB

Details

SHEET #:

L500

© CORVUS DESIGN. ALL RIGHTS RESERVED