



## ADDENDUM TO THE CONTRACT

for the

### CBJ-MIS & Server Room A/C Installation

Contract No. BE17-144

**ADDENDUM NO.:** TWO

**CURRENT DEADLINE FOR BIDS:**  
February 1, 2017

**PREVIOUS ADDENDA:** ONE

**ISSUED BY:** City and Borough of Juneau  
ENGINEERING DEPARTMENT  
155 South Seward Street  
Juneau, Alaska 99801

**DATE ADDENDUM ISSUED:** January 23, 2017

The following items of the contract are modified as herein indicated. All other items remain the same. This is a faxed addendum. A confirming copy will not be mailed to you. This addendum has been issued and is posted online. Please refer to the CBJ Engineering Contracts Division webpage at:  
<http://www.juneau.org/engineering ftp/contracts/Contracts.php>

#### **Contractor Questions and Answers: (Electrical)**

1. On site it was brought to our attention that the proper clearance in front of the new F2 panel in the Penthouse will not be to code. The AHU is approximately 34 inches from the wall. With the additional depth of the panel we will have 30" of clearance in front of the panel.

*Response:* Panel F2 has been eliminated. See the revised electrical drawings issued 1-18-17.

2. On drawing E200, Penthouse plan-are the disconnects for CCU 2 and CCU3 fused or are non-fused disconnects permitted?

*Response:* Non-fused disconnects are permitted.

3. For Panel F2 will a load center panel be permitted or is a panelboard required?

*Response:* Panel F2 has been eliminated. See the revised electrical drawings issued 1-18-17.

#### **DRAWINGS:**

- Item No. 1 M001 SYMBOLS & SCHEDULES, **Add** the following to Air Conditioner Schedule, Description/Features of CCU-2 & 3: "WIND BAFFLE ACCESSORY."
- Item No. 2 M001 SYMBOLS & SCHEDULES, **Add** the following to Air Conditioner Schedule, Description/Features of AC-3: "CONDENSATE PUMP ACCESSORY."

- Item No. 3 M200 MECHANICAL SITE PLAN, **Add** Construction Note #3 to all refrigerant piping stating: "REFRIGERANT PIPE SIZING ACCORDING TO MANUFACTURER'S RECOMMENDATIONS IS ACCEPTABLE"
- Item No. 4 M200 MECHANICAL SITE PLAN, **Rotate** AC-3 counter-clockwise 45° to align with ceiling grid. **Add** note on plan directed at MIS Server Room: "COORDINATE POTENTIAL SMOKE DETECTOR CONFLICTS WITH ELECTRICAL."
- Item No. 5 M200 MECHANICAL SITE PLAN, **Add** note to Sheet: "LOCATE AC-3 THERMOSTAT NEXT TO EXISTING AC-1 THERMOSTAT"
- Item No. 6 M200 MECHANICAL SITE PLAN, **Enlarge** graphics of AC-2A and B Units to 3'x3' (Currently displayed as 2'x2')
- Item No. 7 M200 MECHANICAL SITE PLAN, **Add** to Construction Note #2 the following: "MODIFY CEILING GRID TO CLEANLY INTEGRATE AC UNITS, LOCATE AC UNITS AS TO NOT INTERFERE WITH EXISTING LIGHTING"
- Item No. 8 M200 MECHANICAL SITE PLAN, **Change** plan scale lengths from 0-4'-8'-16' to the following: 0-2'-4'-8'
- Item No. 9 M200 MECHANICAL SITE PLAN, **Add** Construction Note #4 to each wall penetration of a pipe assembly. Construction Note #4 to state: "SEAL PIPE PENETRATION."
- Item No. 10 M200 MECHANICAL SITE PLAN, **Add** sheet note: "1. TEMPORARY PLASTIC PARTITION TO BE ERECTED AROUND CONSTRUCTION AREA IN SERVER ROOM FOR DUST PROTECTION. REMOVE IMMEDIATELY AFTER NO LONGER NEEDED. COORDINATE WITH MIS STAFF."
- Item No. 11 M201 PENTHOUSE MECHANICAL PLAN, **Add** Sheet note "1. ALL EXISTING CABLING IS NOT SHOWN, COORDINATE ONSITE."
- Item No. 12 M201 PENTHOUSE MECHANICAL PLAN, **Add** Sheet note "2. COORDINATE PROJECT WORK WITH NON RELATED CABLING AND TRANSMITTERS. COORDINATE WITH CBJ PERSONNEL IF RELOCATION OF EXISTING CABLING IS REQUIRED."
- Item No. 13 E100 MIS DEMOLITION PLAN, LEGEND, NOTES, **Remove** Sheet E100 DEMOLITION PLAN, LEGEND, NOTES and **Replace** with attached E100-R1 DEMOLITION PLAN, LEGEND, NOTES, REVISION DATE 1/18/17.
- Item No. 14 E200 LEGEND, NOTES, SINGLE LINE, SITE PLAN, **Remove** Sheet E200 LEGEND, NOTES, SINGLE LINE, SITE PLAN and **Replace** with attached E200-R1 LEGEND, NOTES, SINGLE LINE, SITE PLAN, REVISION DATE 1/18/17.

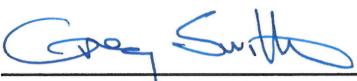
By:   
Greg Smith,  
Contract Administrator

Total number of pages contained within this Addendum: 4



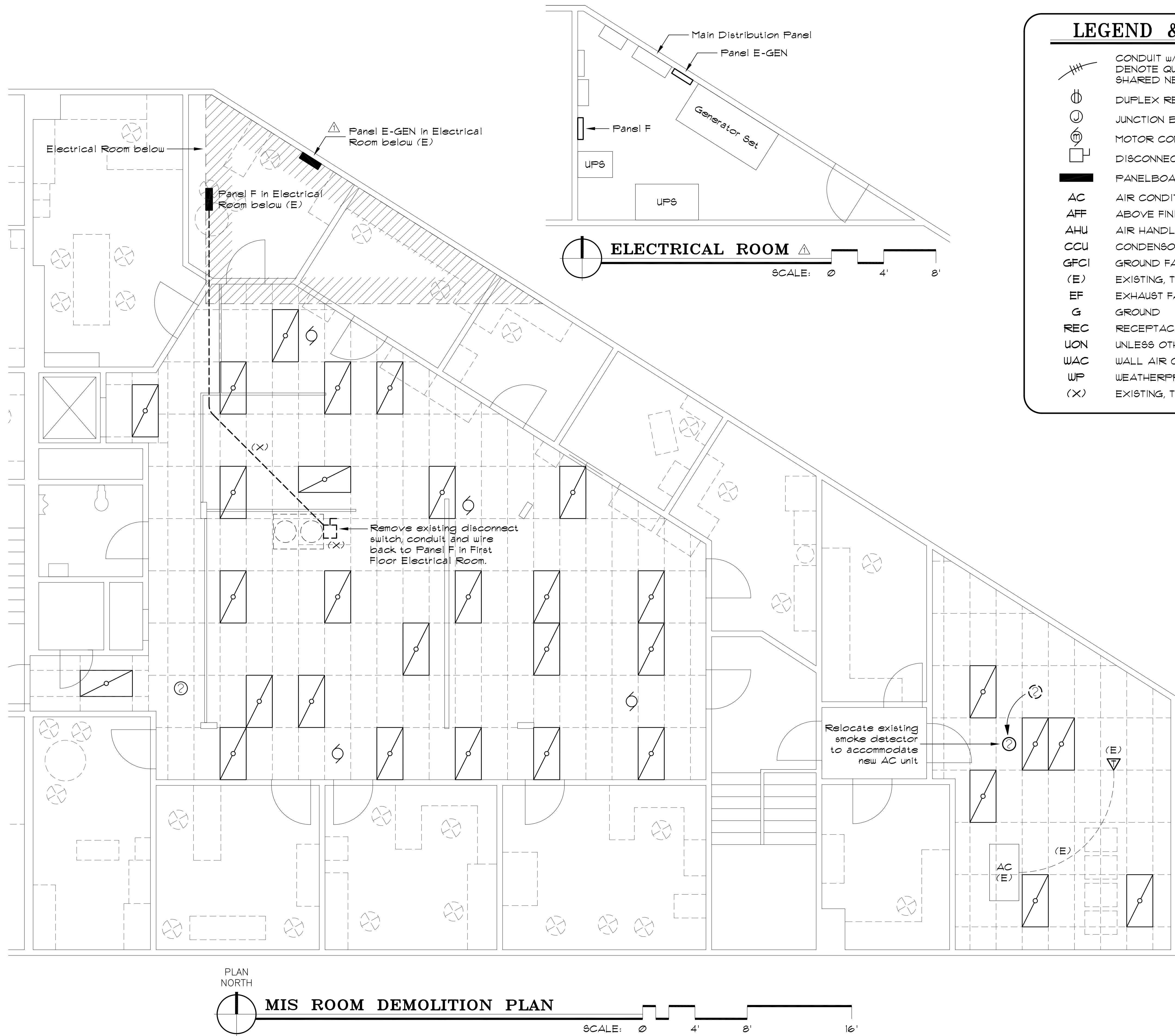

## LEGEND & ABBREVIATIONS

	CONDUIT w/ #12 AWG CONDUCTORS, UON. SLASHES DENOTE QUANTITY OF CONDUCTORS IF NOT TWO. SHARED NEUTRALS SHALL BE #10 AWG.
	DUPLEX RECEPTACLE: 18" AFF, UON
	JUNCTION BOX
	MOTOR CONNECTION: "m" = MANUAL STARTER
	DISCONNECT SWITCH
	PANELBOARD
AC	AIR CONDITIONER
AFF	ABOVE FINISHED FLOOR
AHU	AIR HANDLING UNIT
CCU	CONDENSOR COMPRESSOR UNIT
GFCI	GROUND FAULT CIRCUIT INTERRUPTER
(E)	EXISTING, TO REMAIN
EF	EXHAUST FAN
G	GROUND
REC	RECEPTACLE
UON	UNLESS OTHERWISE NOTED
WAC	WALL AIR CONDITIONER
WP	WEATHERPROOF
(X)	EXISTING, TO BE REMOVED

**GORMAN ENGINEERS**

12761 HORIZON DRIVE  
JUNEAU, ALASKA 99801-7626  
PHONE: 463-6721 CELL: 723-8884  
e-mail: pgorman@gcl.net



September 28, 2016

**MURRAY & ASSOCIATES, P. C.**

CONSULTING ENGINEERS  
MURRAYPC.COM



TEL: 907 780-6151  
FAX: 907 780-6182

P O BOX 21081  
JUNEAU, ALASKA 99802

## NOTES & SPECIFICATIONS

- Provide all work as shown on the drawings and described in the specifications and notes for a complete and functional installation. Unless otherwise noted, all material shall be of new manufacture and of the manufacturer's standard construction. All material shall be approved by Underwriters Laboratories (UL) and so noted.
- All work shall comply with the latest approved editions of the:
  - National Electrical Code (NEC)
  - National Fire Protection Association Codes
  - International Building Code (IBC)
  - Uniform Federal Accessibility Standards
  - All applicable Federal, State & Local regs
- Provide two sets of as-built drawings at project completion. Minimize and seal penetrations of the vapor barrier caused by the electrical installation. Label all new circuit breakers, junction boxes, controls, etc. Provide a new accurate, typed circuit directory for each revised panelboard.
- Raceway systems shall be EMT for feeder and branch circuits and rigid steel for exterior.
- All conductors shall be copper. Conductors in raceways shall have type THHN/THWN insulation for inside work and type XHHW-2 for exterior work. Type MC cable is acceptable for interior work where concealed and approved by the local authority, the Owner and the NEC.
- Boxes shall be steel. All wiring devices shall be specification grade, screw connected, with matching nylon plates. Provide a manual starter/disconnect for motor loads as necessary.
- Total Additional Connected Load for the facility is 3.0 kVA (8.3 Amperes). Actual Additional Demand Load for the facility is 3.0 kVA (8.3 Amperes).

**CBJ MIS and Server Room  
Air Conditioning Installation**

JUNEAU, ALASKA  
CBJ CONTRACT NO. BE17-144

SHEET TITLE:  
**MIS DEMOLITION  
PLAN, LEGEND,  
NOTES**

REVISION 1 1/18/17

SCALE: AS SHOWN  
DATE: 09/28/2016  
DRAWN: PG/SB/KB  
DESIGNED: PG  
CHECKED: PG

SHEET NO.

**E100-R1**

JOB NO. 15-120



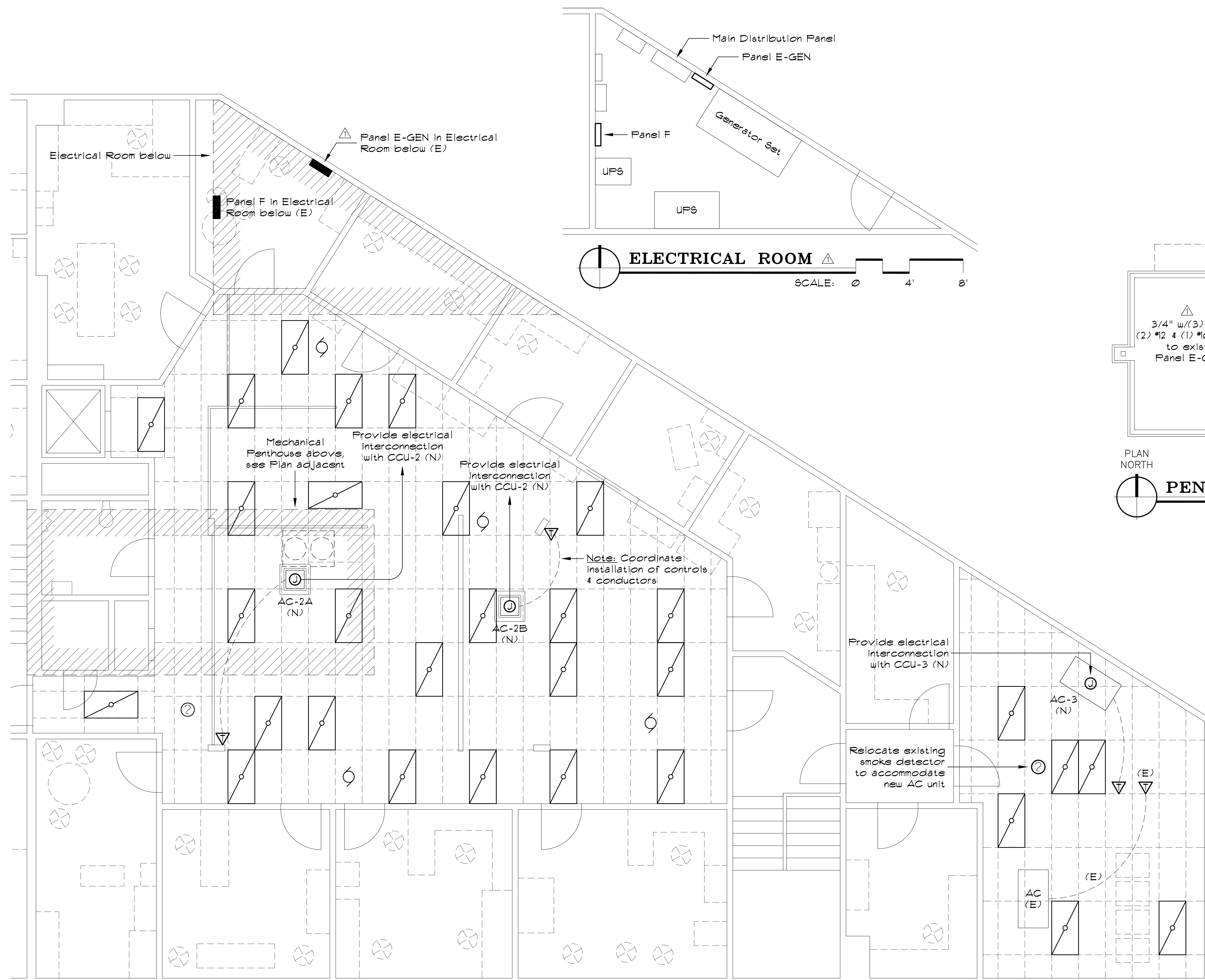

PLAN NORTH  
**MIS ROOM NEW WORK PLAN**  
SCALE: 0 4' 8' 16'

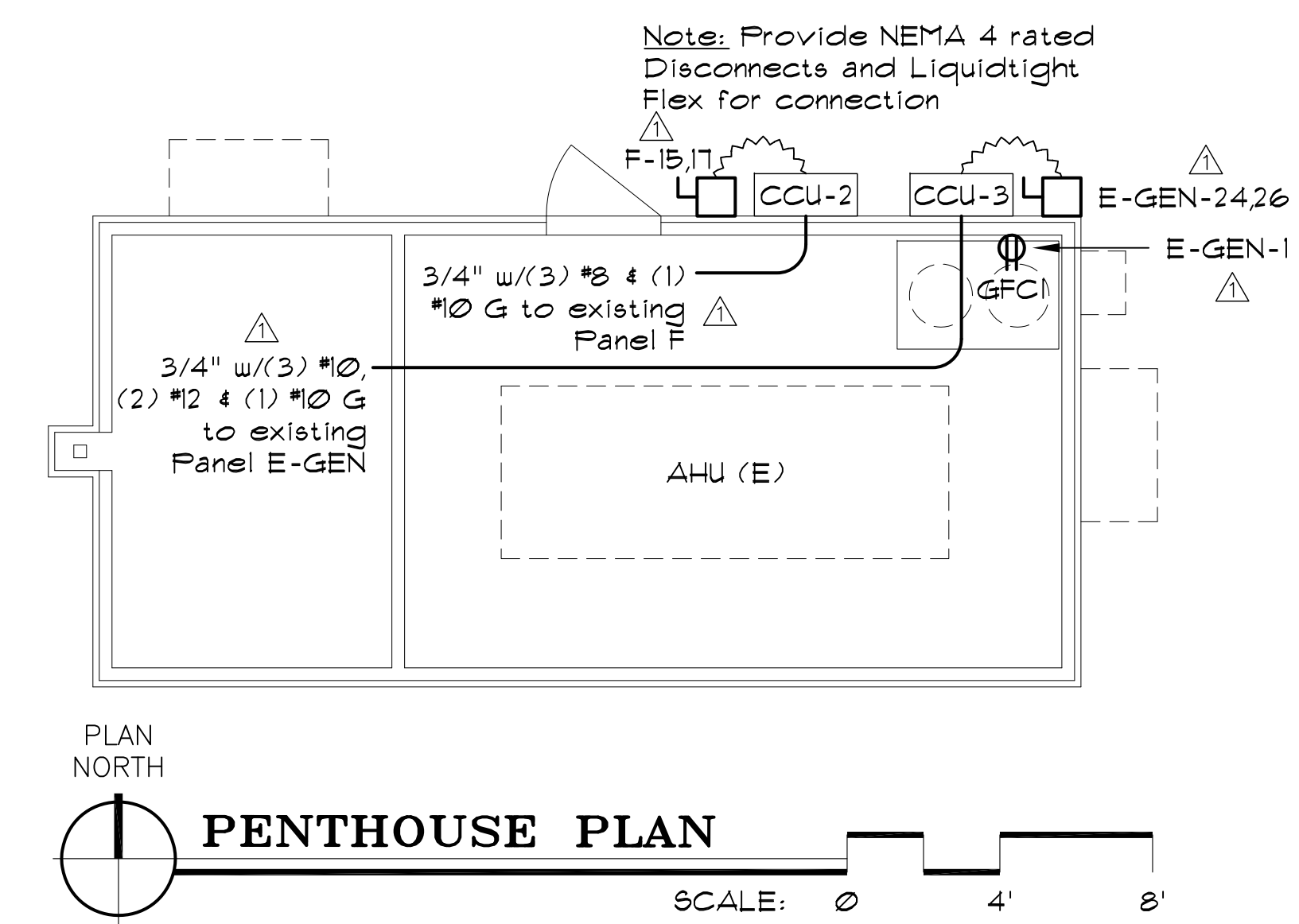
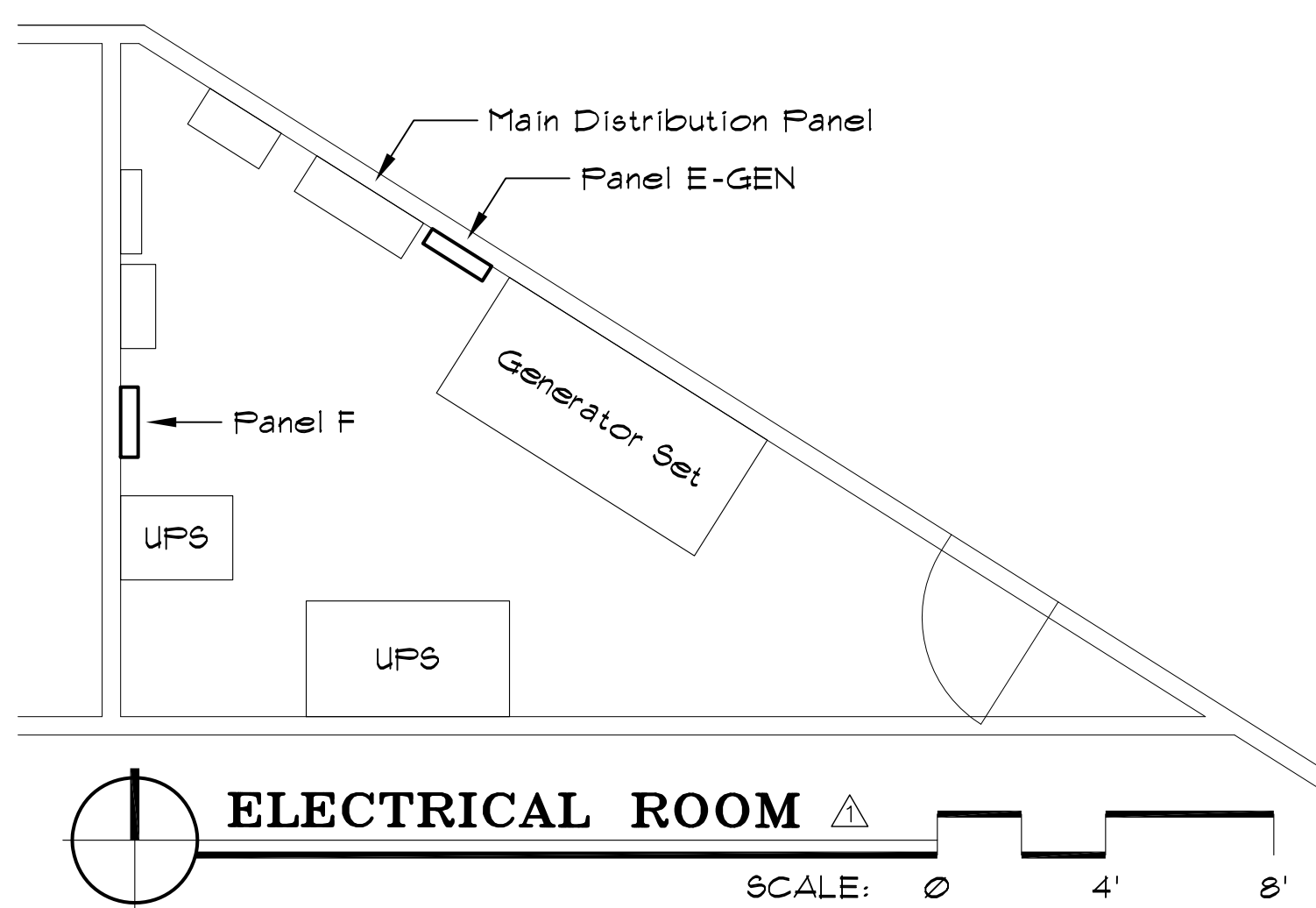

PLAN NORTH  
**PENTHOUSE PLAN**  
SCALE: 0 4' 8'

### SHEET NOTES

1. For CCU-2: Remove the existing 50/3 circuit breaker in Panel F (15,17,19) and replace with a 35/2 breaker (F-15,17). Install a filler plate in the remaining opening (F-19). Feed the new disconnect and Condensor Compressor Unit CCU-2 on the Penthouse with (3) #8 & (1) #10 G in 3/4" conduit as shown.
2. For CCU-3: Utilize the existing 30 ampere, two-pole (30/2) spare circuit breaker in Panel E-GEN-24,26. Feed the new disconnect and Condensor Compressor Unit CCU-3 on the Penthouse with (3) #10 & (1) #10 G in 3/4" conduit as shown.
3. For the new Condensate Pump: Utilize the existing 20 ampere, single-pole (20/1) spare circuit breaker in Panel E-GEN-1. Feed the new GFCI receptacle in the Penthouse with (2) #12 & (1) #12 G in the 3/4" conduit in paragraph 2 above.

**GORMAN ENGINEERS**  
10761 HORIZON DRIVE  
JUNEAU, ALASKA 99801-7626  
PHONE: 463-6721 CELL: 723-8884  
e-mail: pgorman@gcl.net

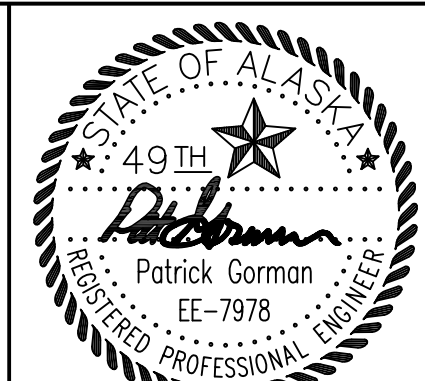

September 28, 2016

**MURRAY & ASSOCIATES, P. C.**  
CONSULTING ENGINEERS  
MURRAYPC.COM



TEL: 907 780-6151  
FAX: 907 780-6182  
P O BOX 21081  
JUNEAU, ALASKA 99802

**CBJ MIS and Server Room  
Air Conditioning Installation**

JUNEAU, ALASKA  
CBJ CONTRACT NO. BE17-144

SHEET TITLE:  
**LEGEND, NOTES,  
SINGLE LINE,  
SITE PLAN**

REVISION 1 1/18/17

SCALE: AS SHOWN  
DATE: 09/28/2016  
DRAWN: PG/SB/KB  
DESIGNED: PG  
CHECKED: PG

SHEET NO.  
**E200-R1**

JOB NO. 15-120