

CONSTRUCTION PLANS FOR
 CITY & BOROUGH OF JUNEAU
 ENGINEERING DEPARTMENT

JUNEAU INTERNATIONAL AIRPORT
 CARGO HARDSTAND
 CBJ CONTRACT No. BE17-035
 PFC 04-07-C-04-JNU

File: U:\204700309\Draws\C\Draws\01 COVER SHEET AND VICINITY MAP.dwg
 Script Date: Jul 05, 2016 4:50pm
 Plot Date: Jul 05, 2016 4:50pm
 RPK
 Designed By: JGL&BEH
 Checked By: MRM
 Drawn By:

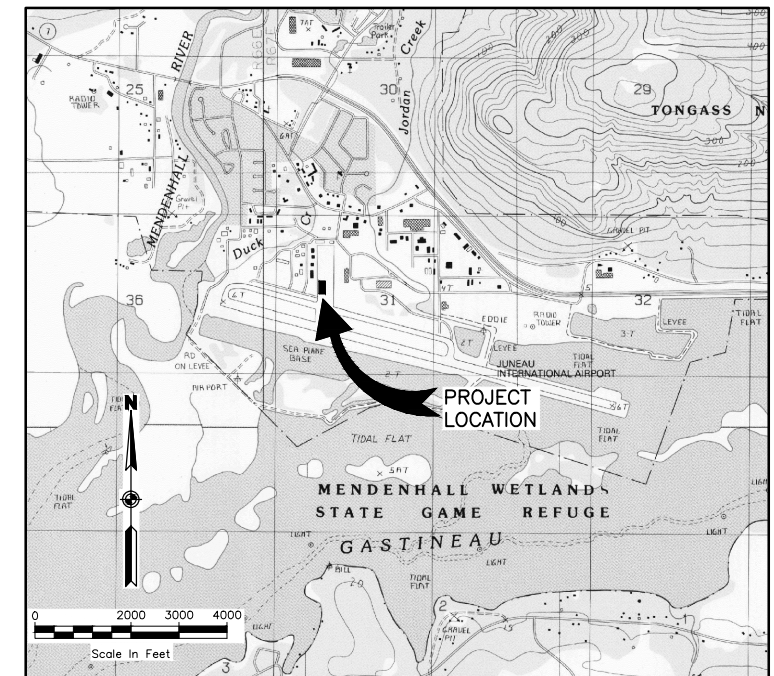
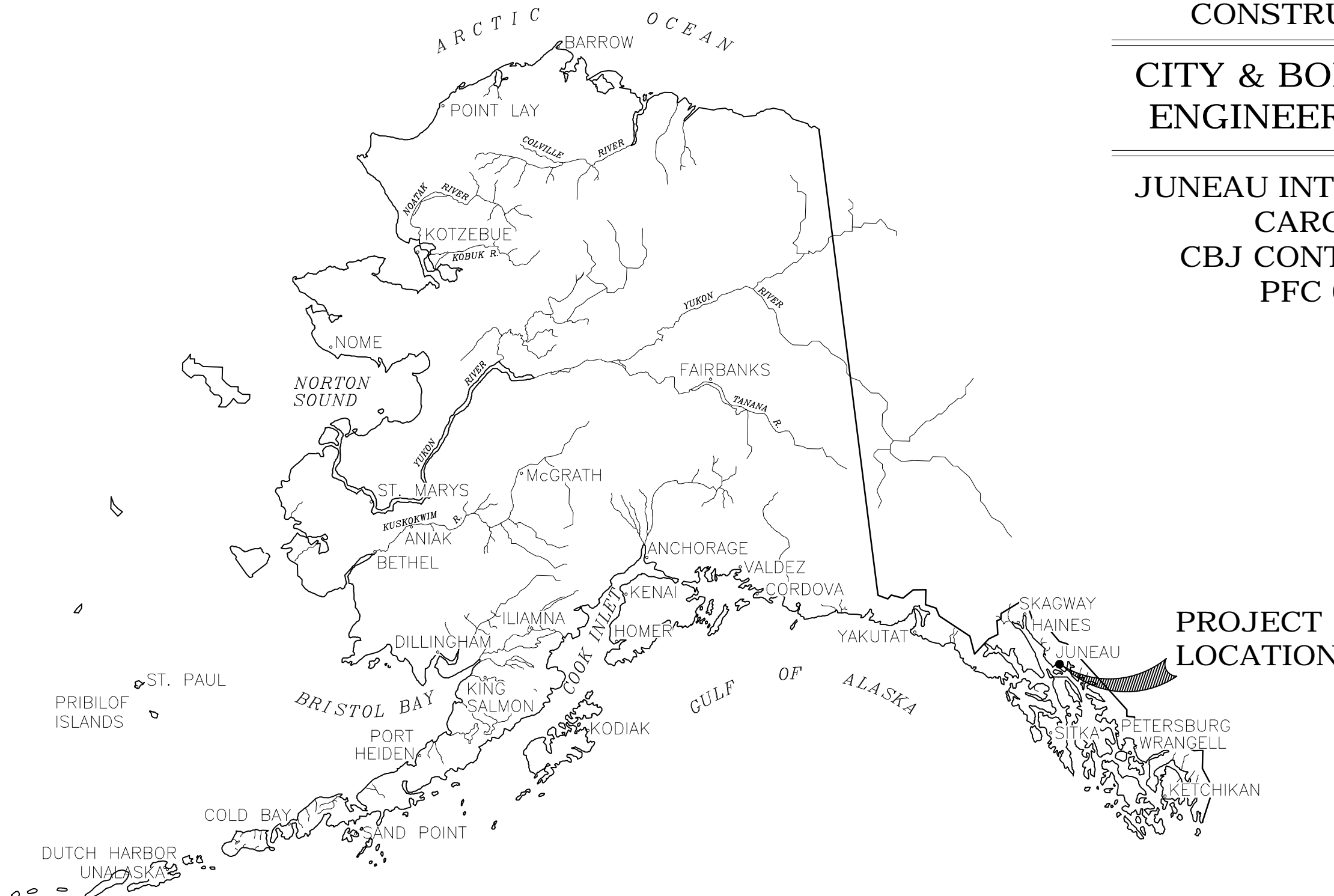

VICINITY MAP
 T 40S, R 67E, SEC 31, 32
 T 40S, R 66E, SEC 36
 COPPER RIVER MERIDIAN
 USGS JUNEAU (B-2) 1986 SW, ALASKA



STANTEC CONSULTING SERVICES, INC.
 725 EAST FIREWEED LANE, SUITE 200
 ANCHORAGE, AK 99503-2245
 907-276-4245

CERTIFICATE OF AUTHORIZATION # 126386



APPROVED FOR CONSTRUCTION:

AIRPORT ENGINEER
 KEN NICHOLS, P.E.

DATE

AIRPORT MANAGER
 PATRICIA K. WAHTO

DATE

FOR BID

U:\204700309\Drawings\C\Sheets\02 SHEET INDEX AND LEGEND.dwg
 File: Script File: Plot Date: JUL 05, 2016 -- 3:40pm
 Designed By: JGL/JH/BEH
 Checked By: ZWS
 Drawn By: MRM

ABBREVIATIONS

AIP	AIRPORT IMPROVEMENT PROJECT
AC	ADVISORY CIRCULAR
AOA	AIRCRAFT OPERATIONS AREA
APPROX	APPROXIMATE/APPROXIMATELY
ARFF	AIRPORT RESCUE AND FIRE FIGHTING
AWOS	AUTOMATED WEATHER OBSERVING SYSTEM
BMP	BEST MANAGEMENT PRACTICE
BRL	BUILDING RESTRICTION LINE
¢	CENTERLINE
CABC	CRUSHED AGGREGATE BASE COURSE
CBMH	CATCH BASIN MANHOLE
CMP	CORRUGATED METAL PIPE
CPEP	CORRUGATED POLYETHYLENE PIPE
CS	CONTINGENT SUM
CSPP	CONSTRUCTION SAFETY AND PHASING PLAN
CY	CUBIC YARD
DIA	DIAMETER
E	EAST/EASTING
EA	EACH
ELEC	ELECTRICAL
ELEV	ELEVATION
ESCP	EROSION AND SEDIMENT CONTROL PLAN
FAA	FEDERAL AVIATION ADMINISTRATION
FOD	FOREIGN OBJECT DEBRIS
FT	FOOT/FEET
HMA	HOT MIX ASPHALT
INV	INVERT ELEVATION
JNU	JUNEAU INTERNATIONAL AIRPORT IDENTIFIER
LF	LINEAR FOOT
LS	LUMP SUM
LT	LEFT
MALS	MEDIUM INTENSITY APPROACH LIGHTING SYSTEM
MAX	MAXIMUM
MIN	MINIMUM
MTE	MATCH TO EXISTING
N	NORTH/NORTHING
NAD	NORTH AMERICAN DATUM
NAVD	NORTH AMERICAN VERTICAL DATUM
NIC	NOT IN CONTRACT
NOTAM	NOTICE TO AIRMEN
NTP	NOTICE TO PROCEED
NTS	NOT TO SCALE
TOFA	TAXIWAY OBJECT FREE AREA
OFF	OFFSET
OFZ	OBJECT FREE ZONE
PS&E	PLANS, SPECIFICATIONS, AND ESTIMATE
R	RADIUS
RP	RADIUS POINT
RT	RIGHT
RW	RUNWAY
SD	STORM DRAIN
SDMH	STORM DRAIN MANHOLE
SPCD	SAFETY PLAN COMPLIANCE DOCUMENT
SREB	SNOW REMOVAL EQUIPMENT BUILDING
SY	SQUARE YARD
TOFA	TAXIWAY OBJECT FREE AREA
TSA	TAXIWAY SAFETY AREA
TW	TAXIWAY
TYP	TYPICAL

LEGEND

EXISTING	PROPOSED	DESCRIPTION
		AIRPORT BOUNDARY
		BUILDING
		COMMUNICATION LINE
		CONCRETE
		CONTOUR LINE
		DRAINAGE FLOW ARROW
		EDGE OF PAVEMENT
		EDGE OF SUBSURFACE TRANSITION SLAB
		FENCE POST/STEEL BOLLARD
		FENCE, CHAIN LINK
		HAUL ROUTE
		STORM DRAIN INLET/CATCH BASIN
		STORM DRAIN MANHOLE
		STORM DRAIN PIPE
		WATER BODY
		BURIED ELECTRICAL LINE
		ELECTRIC JBOX
		TAXIWAY OBJECT FREE AREA

LEGEND NOTES

- SOME SHEETS CONTAIN SHEET SPECIFIC LEGENDS.
- SEE ATTACHED TONER NORDLING SHEET FOR SURVEY CONTROL.

SHEET INDEX

SHEET No.	SHEET TITLE
01	COVER SHEET AND VICINITY MAP
02	SHEET INDEX AND LEGEND
03	ESTIMATED QUANTITIES
04	PROJECT LAYOUT AND GENERAL SAFETY PLAN
05	SAFETY PLAN DETAILS
06	EROSION AND SEDIMENT CONTROL PLAN
07	HARDSTAND GRADING PLAN
08	HARDSTAND FOUNDATION SLAB PLAN
09	HARDSTAND STRUCTURAL DETAILS
10	TEMPORARY MARKING PLAN
11	PERMANENT HARDSTAND MARKING PLAN
12	HARDSTAND MARKING DETAILS
13	TUG ROAD MARKING PLAN

ATTACHMENT:

TONER NORDLING SURVEY CONTROL SHEET (FOLLOWS SHEET 13).

FOR BID

CALL BEFORE YOU DIG
 The Contractor shall notify all area utility companies prior to commencement of excavation.
Alaska Digline, Inc.
 Statewide Toll Free 1-800-478-3121
 Local Digline
 (907) 586-1333

BY	DATE	REVISIONS

SCALE	
HORZ.	
VERT.	
W.O. NO.	204700309
FOR BIDS	

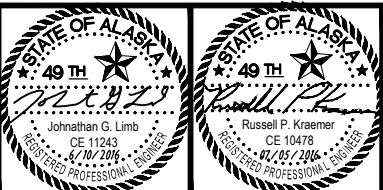

Stantec
 STANTEC CONSULTING SERVICES, INC.
 725 EAST FIREWEED LANE, SUITE 200
 ANCHORAGE, AK 99503-2245
 907-276-4245
 CERTIFICATE OF AUTHORIZATION # 126386



JUNEAU INTERNATIONAL AIRPORT
 JUNEAU, ALASKA
 CARGO HARDSTAND
 CBJ CONTRACT No. BE17-035
 PFC 04-07-C-04-JNU
SHEET INDEX AND LEGEND

File: U:\204700309\Draws\C\Sheets\03 ESTIMATED QUANTITIES.dwg
 Script File: JUL 05, 2016 - 3:40pm
 Plot Date: JUL 05, 2016 - 3:40pm
 Designed By: JGL/JH/BEH
 Checked By: ZWS
 Drawn By: MRM

ESTIMATED QUANTITIES - BASIC BID			
No.	PAY ITEM	PAY UNIT	QUANTITY
G-100a	MOBILIZATION AND DEMOBILIZATION	LUMP SUM	ALL REQUIRED
G-135a	CONSTRUCTION SURVEYING BY THE CONTRACTOR	LUMP SUM	ALL REQUIRED
G-200a	CONTRACTOR QUALITY CONTROL PROGRAM	LUMP SUM	ALL REQUIRED
G-700a	AIRPORT FLAGGER	CONTINGENT SUM	ALL REQUIRED
P-152a	UNCLASSIFIED EXCAVATION	CUBIC YARD	660
P-157a	EROSION, SEDIMENT AND POLLUTION CONTROL ADMINISTRATION	LUMP SUM	ALL REQUIRED
P-157c	TEMPORARY EROSION, SEDIMENT AND POLLUTION CONTROL	LUMP SUM	ALL REQUIRED
P-157f	WITHHOLDING	CONTINGENT SUM	ALL REQUIRED
P-160a	EXCAVATION OF PAVEMENT (AC)	SQUARE YARD	1 080
P-209b	CRUSHED AGGREGATE BASE COURSE	TON	740
P-401h	HOT MIX ASPHALT TYPE II, CLASS E	TON	180
P-501a	PORTLAND CEMENT CONCRETE PAVEMENT	CUBIC YARD	220
P-620c	RUNWAY AND TAXIWAY PAINTING	LUMP SUM	ALL REQUIRED
P-670b	FLASHER UNIT FOR PLASTIC BARRIER	EACH	80
P-670c	FLAG	EACH	80

ESTIMATING FACTORS			
No.	ITEM	FACTOR/QTY	
P-209	CRUSHED AGG BASE COURSE	1.96	TON/CY
P-401a	HOT MIX ASPHALT TYPE II, CLASS E	160	LBS/CF
P-401c	ASPHALT CEMENT PG 64-28	5.50%	of P-401a

FOR BID

BY	DATE	REVISIONS

SCALE
HORZ.
VERT.
W.O. NO. 204700309
FOR BIDS



Stantec

STANTEC CONSULTING SERVICES, INC.
 725 EAST FIREWEED LANE, SUITE 200
 ANCHORAGE, AK 99503-2245
 907-276-4245
 CERTIFICATE OF AUTHORIZATION # 126386



JUNEAU INTERNATIONAL AIRPORT
 JUNEAU, ALASKA
 CARGO HARDSTAND
 CBJ CONTRACT No. BE17-035
 PFC 04-07-C-04-JNU
ESTIMATED QUANTITIES

SHEET
 03
 OF
 13

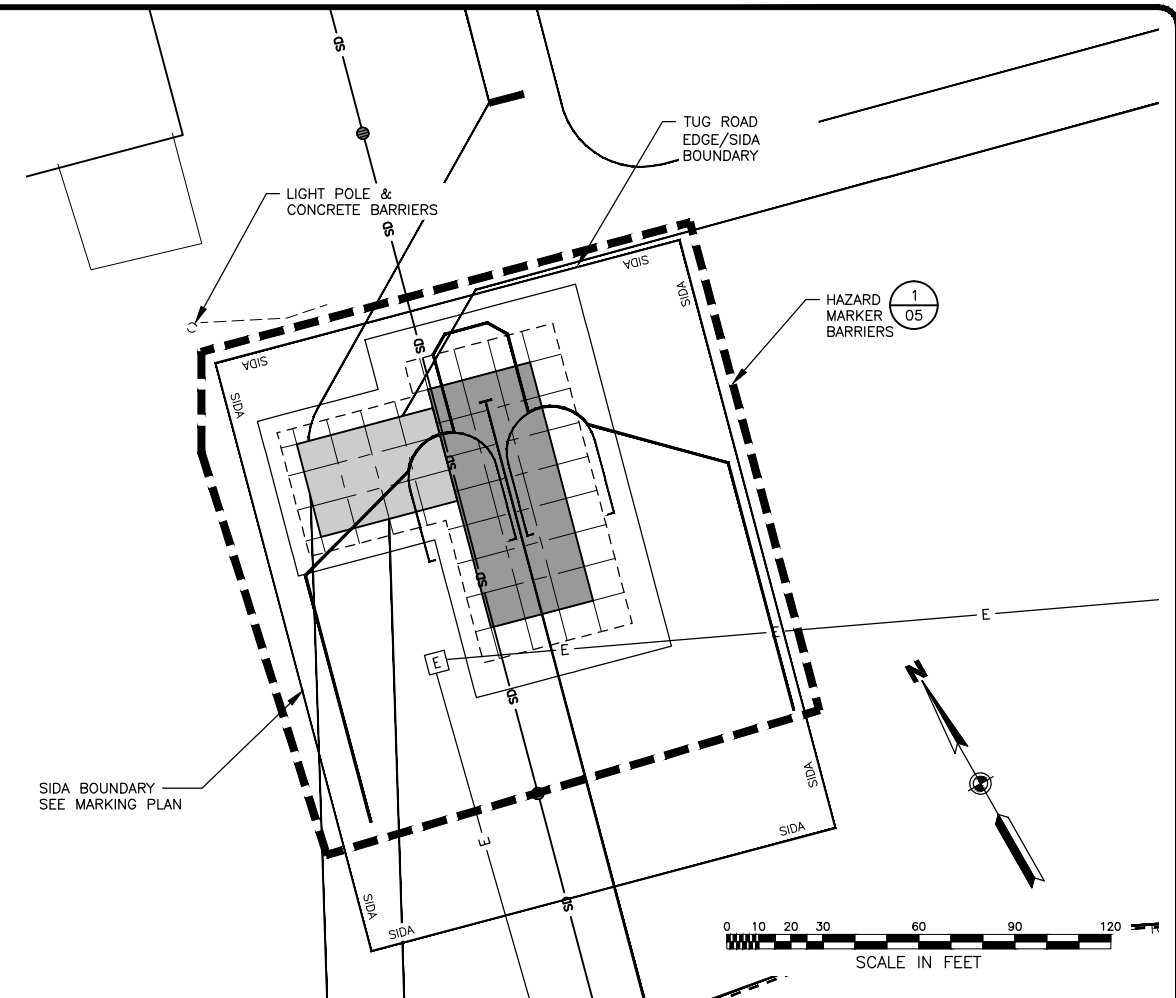
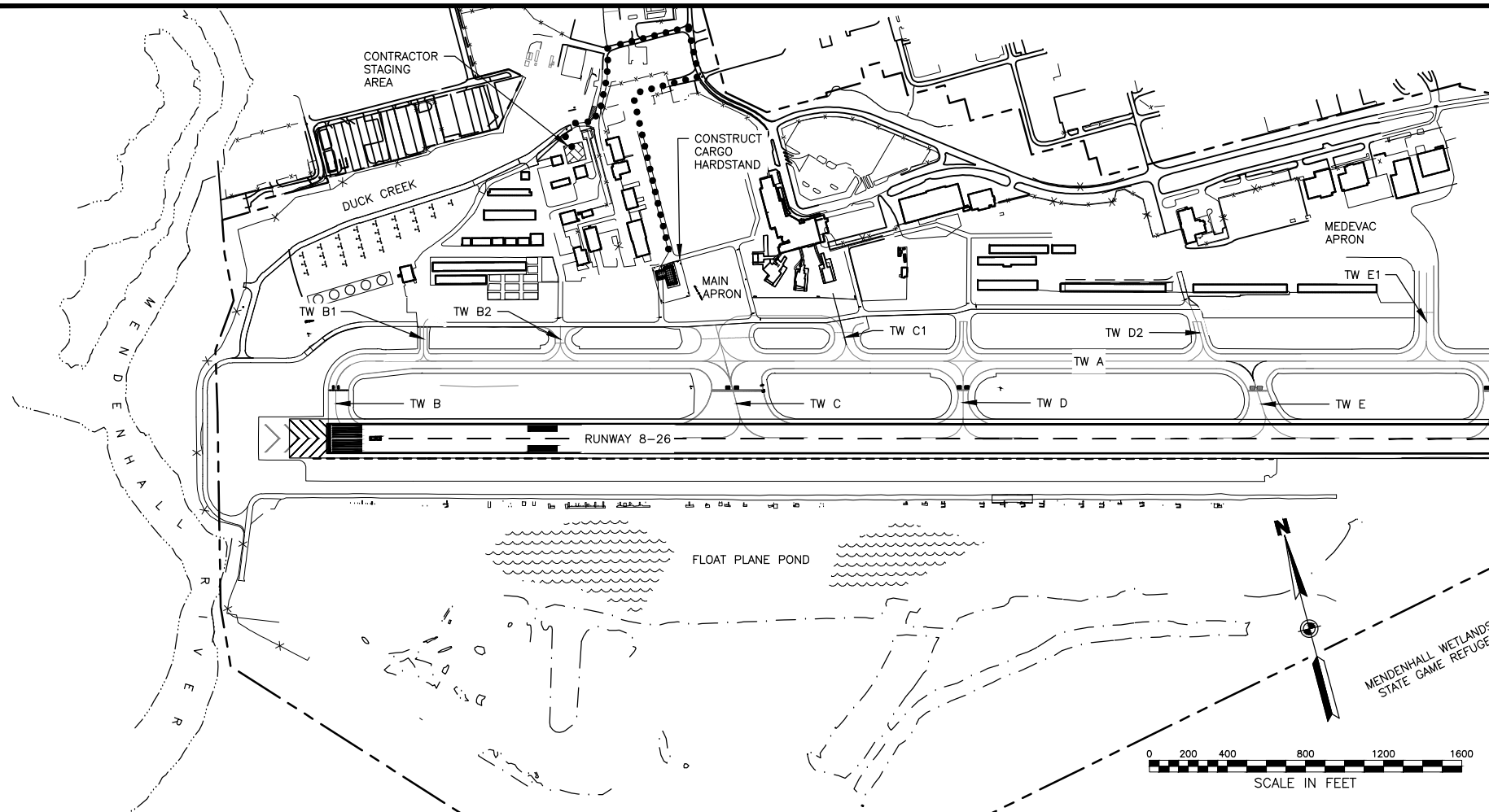

U:\204700309\Drawgs\C\Sheets\04 PROJECT LAYOUT AND GENERAL SAFETY PLAN.dwg
 JUL 05, 2016 3:41 pm
 File: Script File: Plot Date:
 Designed By: JGL/JH/BEH
 Checked By: ZWS
 Drawn By: MRM



SAFETY PLAN NOTES

- SUBMIT A SAFETY PLAN COMPLIANCE DOCUMENT (SPCD) PER FAA ADVISORY CIRCULAR (AC) 150/5370-2F, OPERATIONAL SAFETY ON AIRPORTS DURING CONSTRUCTION (SAFETY AC), TO THE ENGINEER FOR REVIEW. DO NOT BEGIN CONSTRUCTION ACTIVITIES UNTIL THE ENGINEER APPROVES THE SPCD IN WRITING. ALLOW 10 DAYS FOR INITIAL REVIEW. INCLUDE CONSTRUCTION SEQUENCING. IF PLAN DIFFERS FROM WHAT IS SHOWN, OR IF SUBSEQUENT CHANGES ARE MADE, SUBMIT A REVISION TO THE ENGINEER FOR REVIEW AND APPROVAL. ALLOW 5 DAYS FOR REVIEW OF REVISED SPCD. SEE APPENDIX D OF THE SPECIFICATIONS FOR THE CONSTRUCTION SAFETY AND PHASING PLAN (CSPP) DOCUMENT, AND MORE INFORMATION ON THE REQUIREMENTS OF THE SAFETY AC AND SPCD. SEE SECTION 104c ON PAGE 4 OF THE SAFETY AC FOR A SUMMARIZED GENERAL LIST OF CONTRACTOR RESPONSIBILITIES REGARDING SAFETY DURING CONSTRUCTION.
- COORDINATE WORK EFFORTS WITH ANY OTHER WORK THAT MAY BE OCCURRING ON THE AIRPORT.
- NO CONSTRUCTION ACTIVITY IS ALLOWED WITHIN THE TAXIWAY OBJECT FREE AREA (TOFA) WHILE THE TAXIWAY IS OPEN FOR AIRCRAFT OPERATIONS. SEE SECTION 221 OF THE SAFETY AC FOR REQUIREMENTS REGARDING THE NARROWING OF THE TOFA FOR CONSTRUCTION. COORDINATE ANY RESTRICTIONS TO AIRCRAFT OPERATIONS WITH AIRPORT USERS, AND AIRPORT. TOFA WIDTH FOR THE MAIN APRON TAXILANE IS 162'.
- WHenever the plans or specifications call for coordination, notification, contact, or other interaction with FAA, Airport, Maintenance and Operations, ARFF Personnel, Airport Tenants, Airport Users, any Local, State, or Federal Agency, Group, or Association, or the General Public, such activity shall be done through, in the presence of, or with the written approval of the Engineer and Airport Management. Allow sufficient time for coordination and approvals within proposed work schedules.
- ARFF MUST HAVE ACCESS TO ENTIRE AIRPORT AT ALL TIMES TO RESPOND TO EMERGENCIES. MAINTAIN SUITABLE CORRIDORS AND COORDINATE ACCESS WITH ARFF PERSONNEL THROUGH THE ENGINEER AS REQUIRED.
- THE AIRPORT MAY PROVIDE A SAFETY OFFICER TO MONITOR TOWER AND GROUND CONTROL FREQUENCIES AND ADVISE CONSTRUCTION EQUIPMENT OPERATORS DURING CONSTRUCTION AS THE ENGINEER REQUIRES.
- ALL PERSONS AND EQUIPMENT WORKING WITHIN THE AIRPORT PROPERTY SHALL REMAIN IN CONSTANT RADIO CONTACT WITH THE SAFETY OFFICER (WHEN PRESENT) USING A RADIO FREQUENCY APPROVED FOR USE BY THE FEDERAL COMMUNICATIONS COMMISSION.
- STORAGE OF EQUIPMENT OR MATERIALS ON APRONS, TAXIWAYS AND SAFETY AREAS OR RUNWAY SAFETY AREA WILL NOT BE ALLOWED. NO STOCKPILING OF MATERIALS, PARKING OR STAGING OF EQUIPMENT IS ALLOWED WITHIN 400 FEET OF THE ACTIVE RUNWAY CENTERLINE, NOR WITHIN 1000 FEET BEYOND EACH OF THE THRESHOLDS ALONG THE EXTENDED CENTERLINE.
- MAINTAIN TEMPORARY MARKINGS AND LIGHTING SYSTEMS THROUGHOUT THE PHASES OF CONSTRUCTION. REPAIR DAMAGED OR NON-FUNCTIONING MARKINGS AND LIGHTING IMMEDIATELY UPON DISCOVERY OR NOTIFICATION. USE OF LIGHT COLORED SAND BAGS, OR OTHER MATERIALS THAT INTERFERE WITH THE AIRPORT MARKING SYSTEM WILL NOT BE ALLOWED.
- PROVIDE CONTINUOUS COORDINATION THROUGH THE ENGINEER USING WEEKLY BRIEFINGS WITH AIRPORT, AIRPORT MAINTENANCE, ARFF PERSONNEL, ATC, AND AIRPORT USERS TO KEEP EVERYONE AWARE OF THE STATUS AND CHANGES OF AIRPORT SURFACES IN RELATION TO AIRCRAFT AND GROUND TRAFFIC. PROVIDE DETAILED DRAWINGS INDICATING TRAFFIC ROUTES FOR AIRCRAFT, AND GROUND TRAFFIC. INDICATE AREAS CLOSED TO AIRCRAFT MOVEMENT AND PARKING. PROVIDE UPDATED DRAWINGS AT WEEKLY CONSTRUCTION MEETINGS AS CONSTRUCTION PROCEEDS.
- THE CONTRACTOR MUST REPORT ANY SAFETY ISSUES TO THE ENGINEER AND AIRPORT UPON DISCOVERY. THE CONTRACTOR MUST TAKE IMMEDIATE ACTION TO RESOLVE SAFETY ISSUES AS DIRECTED.
- PROVIDE WATER FOR DUST CONTROL AS REQUIRED, AND AS DIRECTED. DUST, SMOKE, STEAM, OR OTHER AIRBORNE PARTICULATES CAUSED BY CONTRACTOR ACTIVITIES MAYBE CONSIDERED A SAFETY VIOLATION AS DETERMINED BY THE ENGINEER.
- REMOVE ALL FOREIGN OBJECTS AND DEBRIS (FOD) FROM ACTIVE SURFACES IMMEDIATELY UPON DISCOVERY OR NOTIFICATION. FAILURE TO REMOVE FOD MAY BE CONSIDERED A SAFETY VIOLATION AS DETERMINED BY THE ENGINEER. PROVIDE A VACUUM SWEEPER TRUCK, (STREET SWEEPER). INCLUDE MAKE AND MODEL IN THE SPCD FOR APPROVAL.
- CONDUCT A JOINT INSPECTION OF AIRPORT SURFACES WITH AIRPORT MANAGEMENT, AND THE ENGINEER PRIOR TO OPENING THEM FOR AIRCRAFT MOVEMENT OR OPERATIONS. REMOVE ALL FOREIGN OBJECTS, CLEAN AND SWEEP SURFACES AS REQUIRED OR AS DIRECTED.
- PREPARE ALL SURFACES SO NO AIRCRAFT WILL BE REQUIRED TO OPERATE ON UNPAVED SURFACES.
- FIELD VERIFY SUITABILITY OF HAUL ROUTES AND STAGING AREAS SHOWN. DEVELOP AND MAINTAIN HAUL ROUTES AS REQUIRED. PROVIDE TRAFFIC CONTROL PLANS FOR EACH PHASE OF WORK.
- REFER TO FAA AC 150/5370-2F FOR ADDITIONAL GUIDANCE ON PREPARING SAFETY PLANS. REFER TO AC 150/5300-13A CHAPTER 3 FOR CLEARANCE STANDARDS RELATED TO THE TAXIWAY OFA. NOTICE THAT THE MOST RESTRICTIVE CRITERIA GOVERNS. JNU IS AN APPROACH CATEGORY C, AND DESIGN GROUP III AIRPORT. SEE THE CSPP ATTACHED TO THE SPECIFICATIONS AS AN APPENDIX FOR ADDITIONAL INFORMATION.
- ALL WASTE IS TO BE DISPOSED OF OFF-SITE AT THE CONTRACTORS EXPENSE.
- NORTHSTAR AND TRANSIENT HELICOPTER OPERATIONS ARE PERFORMED DIRECTLY WEST OF PROJECT AREA. ROTOR WASH WILL DISTURB ANY FOD ON PROJECT SITE DAMAGING PROPERTY AND PERSONNEL. CONTINUALLY INSPECT SITE FOR FOD AND DISPOSE OF WASTE PROPERLY AND IMMEDIATELY.

LEGEND

-  CONTRACTOR STAGING AREA
-  CONTRACTOR ACCESS / HAUL ROUTE
-  HAZARD MARKER BARRIERS

SUGGESTED WORK SEQUENCE:

- THE FOLLOWING GENERAL WORK TASKS ARE A SUGGESTED SEQUENCE ONLY, AND MAY BE ADJUSTED BY THE CONTRACTOR AND SUBMITTED TO THE ENGINEER FOR APPROVAL. THE WORK DESCRIBED MAY NEED TO BE COMPLETED CONCURRENTLY, AND IS NOT INTENDED TO BE A COMPREHENSIVE LIST OF ALL WORK. SOME WORK MAY NEED TO BE COMPLETED DURING NIGHT TIME HOURS, OR DURING PERIODS WITH NO SCHEDULED FLIGHTS. SUBMIT A COMPLETE WORK SCHEDULE FOR APPROVAL AS SPECIFIED.
- INSTALL EROSION SEDIMENT CONTROL MEASURES.
 - PAINT TEMPORARY MARKINGS, CLOSE CONSTRUCTION AREA BY PLACING HAZARDOUS AREA BARRIERS.
 - SAWCUT & REMOVE PAVEMENT. CONSTRUCT NEW HARDSTAND.
 - PAINT NEW PERMANENT PARKING POSITION MARKINGS, INCLUDING SIDA. OPEN NEW HARDSTAND FOR AIRCRAFT PARKING.
 - REMOVE EXISTING TUG ROAD & TEMPORARY MARKINGS.
 - PAINT NEW TUG ROAD MARKINGS.

FOR BID

BY	DATE	REVISIONS

SCALE	
HORZ.	
VERT.	
W.O. NO.	204700309
FOR BIDS	

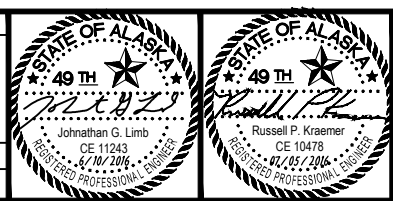

Stantec

STANTEC CONSULTING SERVICES, INC.
 725 EAST FIREWEED LANE, SUITE 200
 ANCHORAGE, AK 99503-2245
 907-276-4245
 CERTIFICATE OF AUTHORIZATION # 126386



JUNEAU INTERNATIONAL AIRPORT
 JUNEAU, ALASKA
 CARGO HARDSTAND
 CBJ CONTRACT No. BE17-035
 PFC 04-07-C-04-JNU
**PROJECT LAYOUT AND
 GENERAL SAFETY PLAN**

SHEET	04
OF	13

U:\204700309\Drawings\C\Sheets\5 SAFETY PLAN DETAIL.dwg
 File: U:\204700309\Drawings\C\Sheets\5 SAFETY PLAN DETAIL.dwg
 Script File: U:\204700309\Drawings\C\Sheets\5 SAFETY PLAN DETAIL.dwg
 Plot Date: JUL 05, 2016 -- 3:41 pm

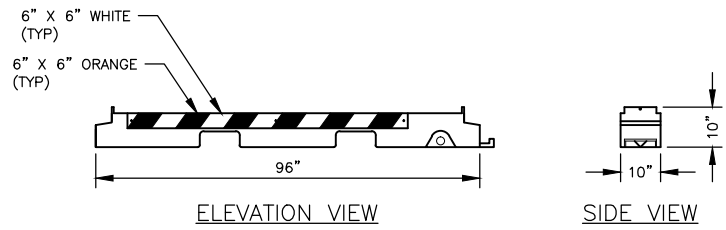

HAZARD MARKER BARRIER NOTES

1. PLACE BARRIERS TO LIMIT ACCESS TO THE CLOSED CARGO HARDSTAND. USE OWNER FURNISHED LOW STYLE BARRIERS (LESS THAN 12 INCHES HIGH). PROVIDE ONE SET OF: ONE NEW FLAG AND ONE NEW LIGHT PER BARRICADE.
2. CONSIDER JET BLAST AND ROTORWASH WHEN PLACING BARRIERS. BARRICADES ARE REQUIRED TO CONNECT.

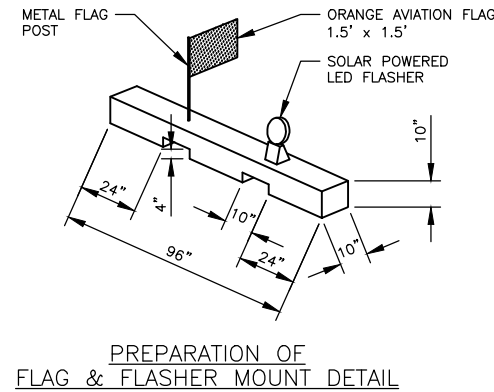

1 HAZARD MARKER BARRIER
 05 SCALE: NOT TO SCALE

CONCEPTUAL DETAIL, BARRICADES WILL BE OWNER FURNISHED USED EQUIPMENT. FLAGS AND LIGHTS WILL BE CONTRACTOR FURNISHED NEW EQUIPMENT.

FOR BID

BY	DATE	REVISIONS

SCALE	
HORZ.	
VERT.	
W.O. NO.	204700309
FOR BIDS	

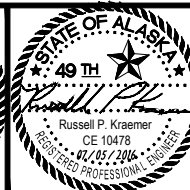
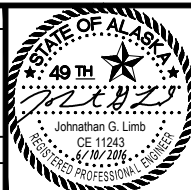

Stantec
 STANTEC CONSULTING SERVICES, INC.
 725 EAST FIREWEED LANE, SUITE 200
 ANCHORAGE, AK 99503-2245
 907-276-4245
 CERTIFICATE OF AUTHORIZATION # 126386



JUNEAU INTERNATIONAL AIRPORT
 JUNEAU, ALASKA
 CARGO HARDSTAND
 CBJ CONTRACT No. BE17-035
 PFC 04-07-C-04-JNU
SAFETY PLAN DETAILS

File: U:\204700309\Drawings\C\Sheets\06 EROSION AND SEDIMENT CONTROL PLAN.dwg
 Script File: U:\204700309\Drawings\C\Sheets\06 EROSION AND SEDIMENT CONTROL PLAN.dwg
 Plot Date: JUL 05, 2016 -- 3:42pm
 Designed By: JGL/JH/BEH
 Checked By: ZMS
 Drawn By: MRM

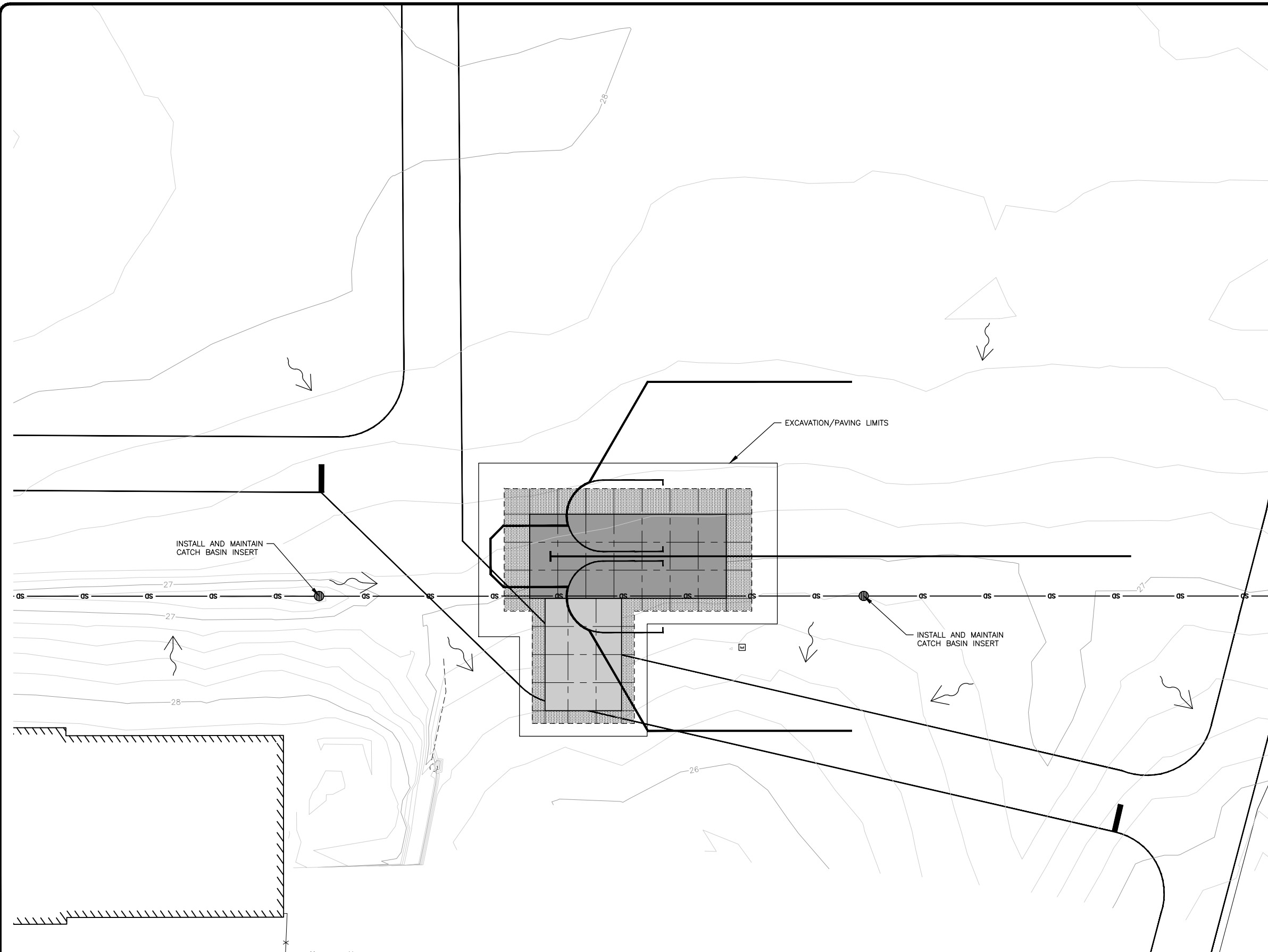

EROSION AND SEDIMENT CONTROL PLAN NOTES

1. INSTALL SEDIMENT CONTROL DEVICES BEFORE ERODIBLE SOILS ARE EXPOSED. DEVICES MAY HAVE TO BE REMOVED AND REINSTALLED DAILY TO ALLOW CONSTRUCTION ACTIVITIES TO PROCEED. MAINTAIN ALL DEVICES ON A DAILY BASIS, INCLUDING, BUT NOT LIMITED TO, REMOVAL AND DISPOSAL OF ACCUMULATED SOILS, CLEANING, AND REPAIR OF DAMAGED DEVICES OR REPLACEMENT WITH NEW.
2. INSPECT AND REPAIR DEVICES AFTER EACH RAINFALL. IF INSPECTION REVEALS EROSION CONTROL MEASURES ARE INSUFFICIENT, IMMEDIATELY IMPLEMENT CORRECTIVE ACTION. THIS MAY INCLUDE: CHANGING CONSTRUCTION METHODS, INSTALLING ADDITIONAL EROSION CONTROL BMPs, PHASING WORK, AND OTHER CORRECTIVE MEASURES.
3. MINIMIZE THE AREA AND TIME PERIOD ERODIBLE SOILS ARE EXPOSED TO STORM WATER. DISTURBED AREAS SHALL BE STABILIZED AS SOON AS PRACTICABLE AFTER DISTURBANCE AND IN ACCORDANCE WITH ALASKA CONSTRUCTION GENERAL PERMIT (ACGP) GUIDELINES. REMOVE AND DISPOSE OF SEDIMENT CONTROL DEVICES AFTER STABILIZATION.
4. USE WATER OR NON-TOXIC DUST PALLIATIVES TO CONTROL DUST.
5. PROVIDE INLET PROTECTION ON ALL INLETS WITHIN 25 FEET OF DISTURBED GROUND.
6. MATERIAL TRACKED BY CONSTRUCTION EQUIPMENT SHALL BE SWEEPED BACK INTO THE PROJECT AREA OR PICKED UP BY A VACUUM TRUCK. INSTALL A CONSTRUCTION EXIT IF SWEEPING MEASURES ARE INADEQUATE TO CONTROL TRACK-OUT.
7. CONSTRUCT A CONCRETE WASHOUT IN THE CONTRACTOR'S STAGING AREA AS LOCATED ON SHEET 04.

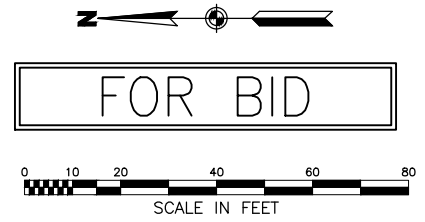

FOR BID

BY	DATE	REVISIONS

SCALE
HORZ.
VERT.
W.O. NO. 204700309
FOR BIDS

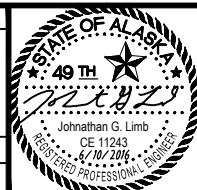



 STANTEC CONSULTING SERVICES, INC.
 725 EAST FIREWEED LANE, SUITE 200
 ANCHORAGE, AK 99503-2245
 907-276-4245
 CERTIFICATE OF AUTHORIZATION # 126386



JUNEAU INTERNATIONAL AIRPORT
 JUNEAU, ALASKA
 CARGO HARDSTAND
 CBJ CONTRACT No. BE17-035
 PFC 04-07-C-04-JNU
EROSION AND SEDIMENT CONTROL PLAN

SHEET
06
 OF
13

U:\204700309\Drawings\C\Sheets\07 HARDSTAND GRADING PLAN.dwg
 File: U:\204700309\Drawings\C\Sheets\07 HARDSTAND GRADING PLAN.dwg
 Script File: U:\204700309\Drawings\C\Sheets\07 HARDSTAND GRADING PLAN.dwg
 Plot Date: JUL 05 2016 5:01 pm

Designed By: JGL/JH/BEH
 Checked By: ZWS
 Drawn By: MRM

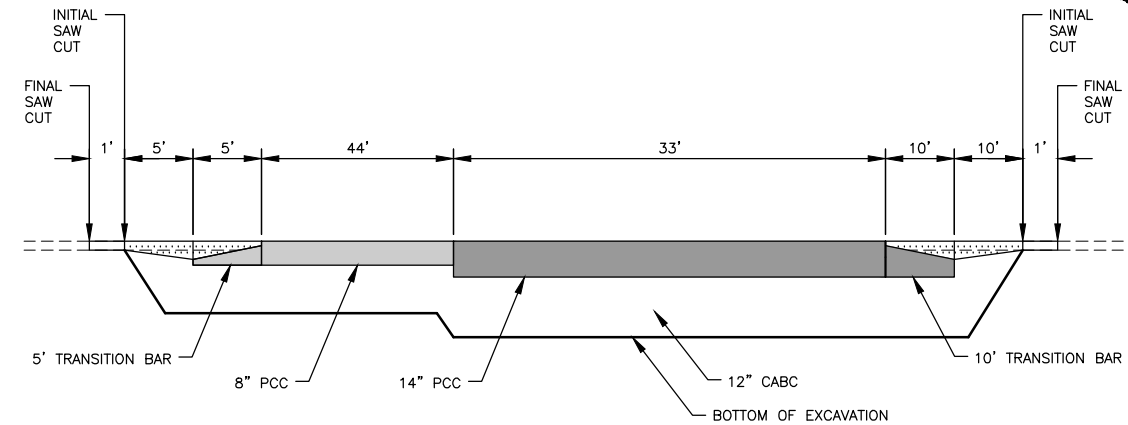
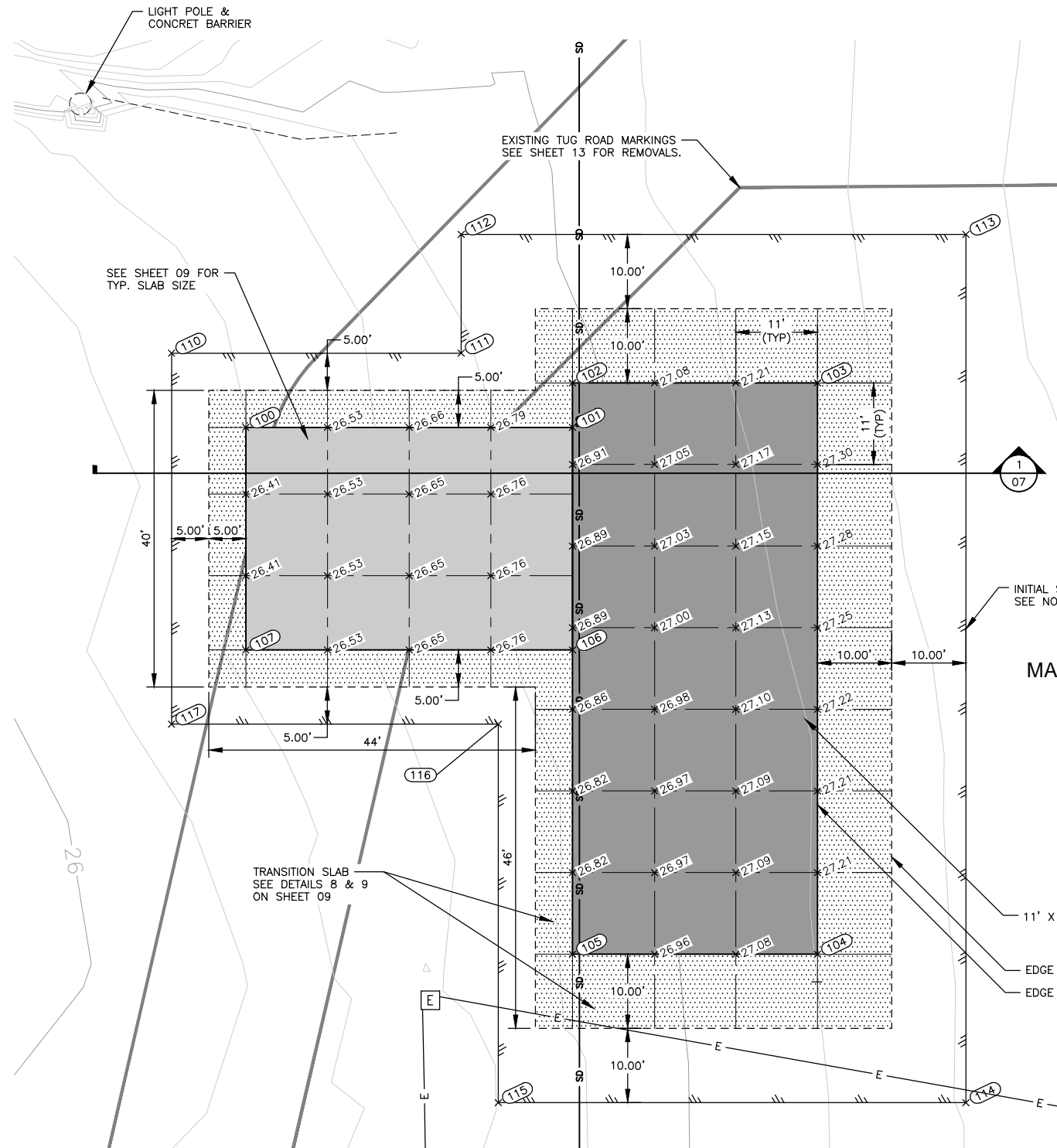

1 SECTION
 07 SCALE: NOT TO SCALE

COORDINATE TABLE				
POINT	ELEVATION	NORTHING	EASTING	DESCRIPTION
100	26.40	50970.25	46516.35	EDGE_HMA
101	26.93	50970.25	46560.35	EDGE_HMA
102	26.95	50976.25	46560.35	EDGE_HMA
103	27.33	50976.25	46593.35	EDGE_HMA
104	27.20	50899.25	46593.35	EDGE_HMA
105	26.82	50899.25	46560.35	EDGE_HMA
106	26.88	50940.25	46560.35	EDGE_HMA
107	26.43	50940.25	46516.35	EDGE_HMA

COORDINATE TABLE				
POINT	ELEVATION	NORTHING	EASTING	DESCRIPTION
110	MTE	50980.25	46506.35	SAW_CUT
111	MTE	50980.25	46545.35	SAW_CUT
112	MTE	50996.25	46545.35	SAW_CUT
113	MTE	50996.25	46613.35	SAW_CUT
114	MTE	50879.25	46613.35	SAW_CUT
115	MTE	50879.25	46550.35	SAW_CUT
116	MTE	50930.25	46550.35	SAW_CUT
117	MTE	50930.25	46506.35	SAW_CUT

MTE = MATCH TO EXISTING

NOTES

- ALL ELEVATIONS REFER TO TOP OF FINISHED GRADE.
- FIELD VERIFY ALL MATCH POINTS. REVIEW WITH ENGINEER PRIOR TO BEGINNING ANY DEMOLITION WORK. ADJUST SAW CUT LOCATION AS DIRECTED.
- SEE SHEET 09 FOR JOINT DIMENSIONS AND REINFORCEMENT.
- MAKE INITIAL SAW AT THE LIMITS SHOWN. A SECOND AND FINAL SAW CUT WILL BE REQUIRED 24 HOURS PRIOR TO HMA PAVING TO ENSURE A CLEAN VERTICAL FACE AT THE MATCH LINE.
- ADJUST ALL EXISTING UTILITIES WITHIN THE LIMITS OF PAVEMENT REMOVAL TO FINAL GRADE. ADJUSTMENT OF UTILITIES IS SUBSIDIARY TO THE CONTRACT.

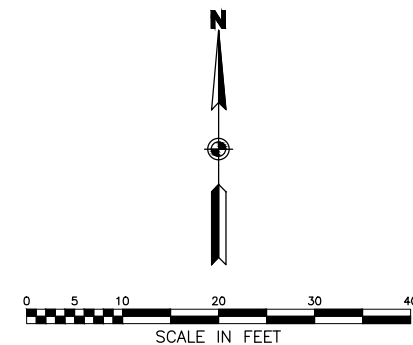

FOR BID

BY	DATE	REVISIONS

SCALE	
HORZ.	
VERT.	
W.O. NO.	204700309
FOR BIDS	

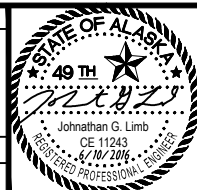

Stantec
 STANTEC CONSULTING SERVICES, INC.
 725 EAST FIREWEED LANE, SUITE 200
 ANCHORAGE, AK 99503-2245
 907-276-4245
 CERTIFICATE OF AUTHORIZATION # 126386



JUNEAU INTERNATIONAL AIRPORT
 JUNEAU, ALASKA
 CARGO HARDSTAND
 CBJ CONTRACT No. BE17-035
 PFC 04-07-C-04-JNU
HARDSTAND GRADING PLAN

U:\204700309\Drawings\C\Sheets\08 HARDSTAND FOUNDATION SLAB PLAN.dwg
 File: U:\204700309\Drawings\C\Sheets\08 HARDSTAND FOUNDATION SLAB PLAN.dwg
 Script File: U:\204700309\Drawings\C\Sheets\08 HARDSTAND FOUNDATION SLAB PLAN.dwg
 Plot Date: JUL 05, 2016 3:44pm

Designed By: JGL/JH/BEH
 Checked By: ZWS
 Drawn By: MRM

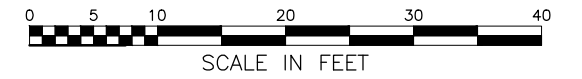
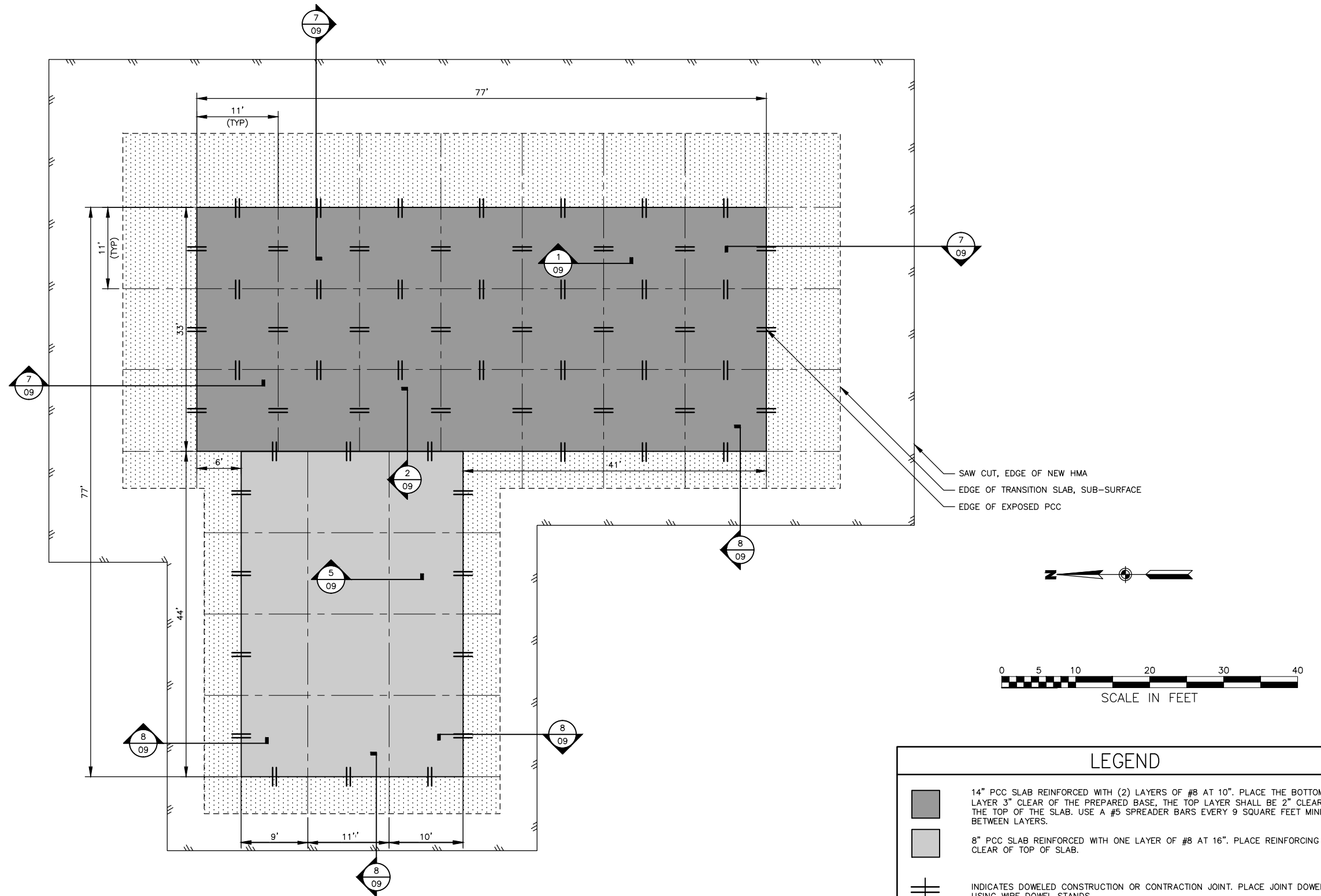

LEGEND

- 14" PCC SLAB REINFORCED WITH (2) LAYERS OF #8 AT 10". PLACE THE BOTTOM LAYER 3" CLEAR OF THE PREPARED BASE, THE TOP LAYER SHALL BE 2" CLEAR OF THE TOP OF THE SLAB. USE A #5 SPREADER BARS EVERY 9 SQUARE FEET MINIMUM BETWEEN LAYERS.
- 8" PCC SLAB REINFORCED WITH ONE LAYER OF #8 AT 16". PLACE REINFORCING 2" CLEAR OF TOP OF SLAB.
- INDICATES DOWELED CONSTRUCTION OR CONTRACTION JOINT. PLACE JOINT DOWELS USING WIRE DOWEL STANDS.
- INDICATES CONTRACTION JOINT. CONTRACTOR'S OPTION TO SUBSTITUTE A CONSTRUCTION JOINT AT ANY CONTRACTION JOINT LOCATION.

FOR BID

BY	DATE	REVISIONS

SCALE
HORZ.
VERT.
W.O. NO. 204700309
FOR BIDS

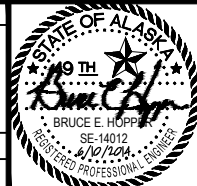

Stantec

STANTEC CONSULTING SERVICES, INC.
 725 EAST FIREWEED LANE, SUITE 200
 ANCHORAGE, AK 99503-2245
 907-276-4245
 CERTIFICATE OF AUTHORIZATION # 126386



JUNEAU INTERNATIONAL AIRPORT
 JUNEAU, ALASKA
 CARGO HARDSTAND
 CBJ CONTRACT No. BE17-035
 PFC 04-07-C-04-JNU

HARDSTAND FOUNDATION SLAB PLAN

SHEET
08
 OF
13

U:\204700309\Drawings\C\Sheets\09 HARDSTAND STRUCTURAL DETAILS.dwg
 File: U:\204700309\Drawings\C\Sheets\09 HARDSTAND STRUCTURAL DETAILS.dwg
 Script File: U:\204700309\Drawings\C\Sheets\09 HARDSTAND STRUCTURAL DETAILS.dwg
 Plot Date: JUL 05, 2016 3:45pm
 Designed By: JGL/JH/BEH
 Checked By: ZWS
 Drawn By: MRM

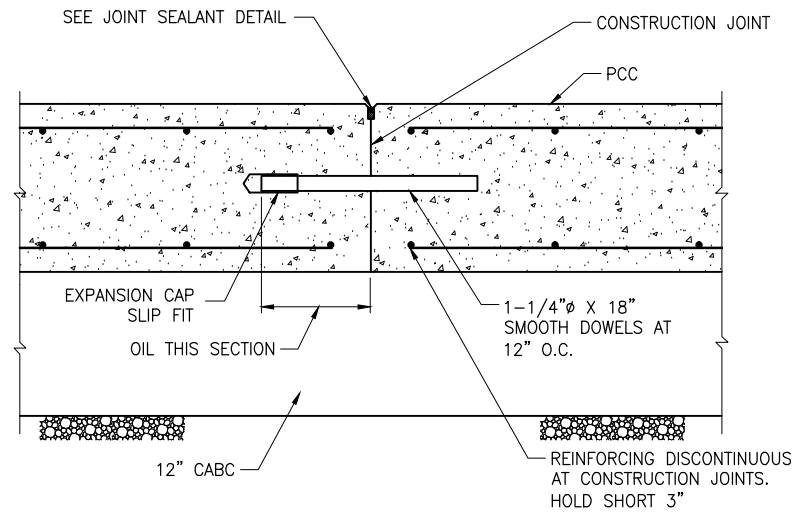

1 CONSTRUCTION JOINT IN 14" PCC
 SCALE: 1 1/2"=1'-0"

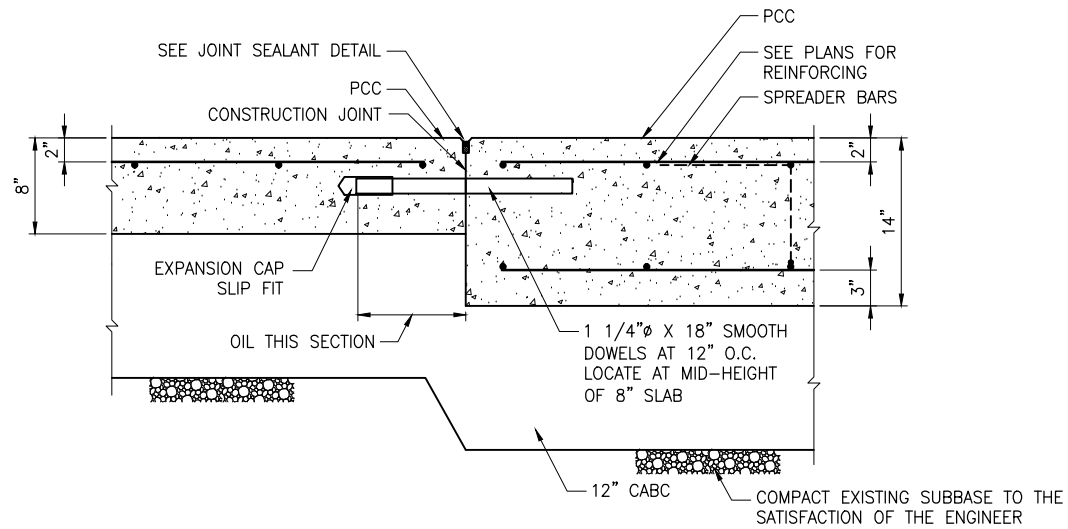

2 TRANSITION 14" PCC TO 8" PCC
 SCALE: 1 1/2"=1'-0"

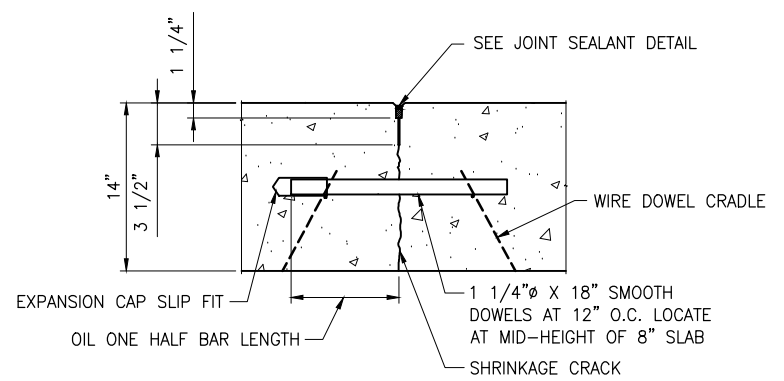

3 CONTRACTION JOINT IN 14" PCC
 SCALE: 1 1/2"=1'-0"

NOTE:
 1. REINFORCING NOT SHOWN FOR CLARITY.
 2. CONSTRUCTION JOINTS CAN BE USED IN LIEU OF CONTRACTION JOINTS.

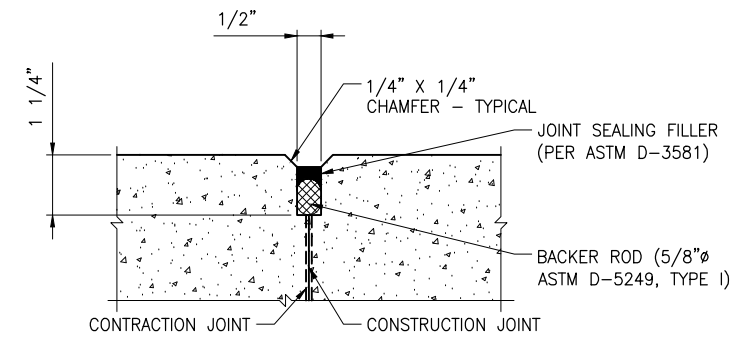

4 JOINT SEALANT DETAIL
 SCALE: 6"=1'-0"

NOTE: REINFORCING NOT SHOWN FOR CLARITY

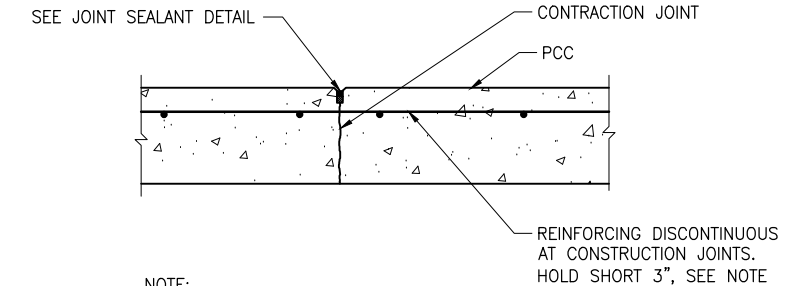

5 TYPICAL CONTRACTION JOINT IN 8" PCC
 SCALE: 1 1/2"=1'-0"

NOTE:
 CONSTRUCTION JOINTS CAN BE USED IN LIEU OF CONTRACTION JOINTS.

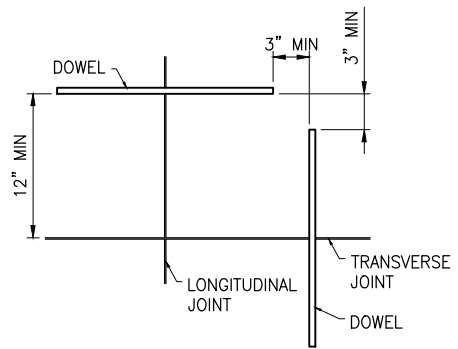

6 DOWEL POSITION DETAIL
 SCALE: 1 1/2"=1'-0"

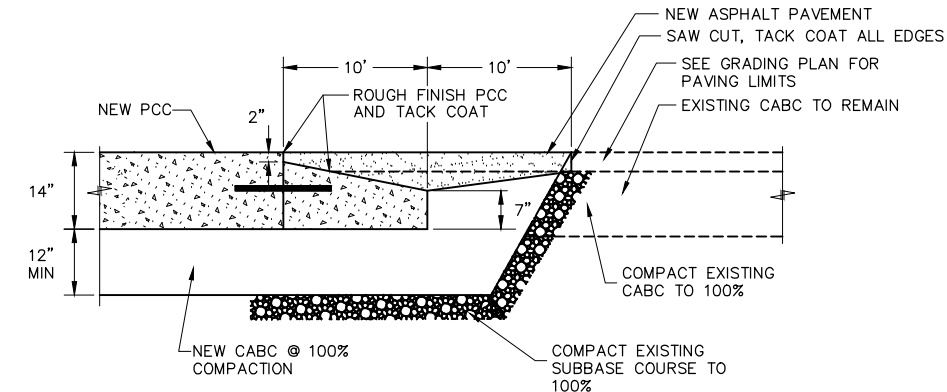

7 10' TRANSITION PCC TO HMA
 SCALE: NOT TO SCALE

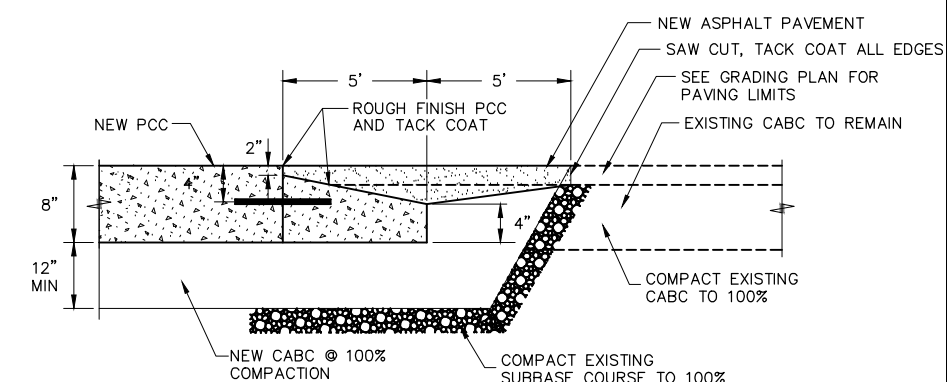

8 5' TRANSITION PCC TO HMA
 SCALE: NOT TO SCALE

FOR BID

BY	DATE	REVISIONS

SCALE	
HORZ.	
VERT.	
W.O. NO.	204700309
FOR BIDS	

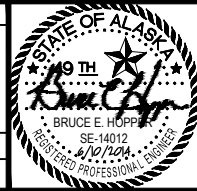

Stantec
 STANTEC CONSULTING SERVICES, INC.
 725 EAST FIREWEED LANE, SUITE 200
 ANCHORAGE, AK 99503-2245
 907-276-4245
 CERTIFICATE OF AUTHORIZATION # 126386



JUNEAU INTERNATIONAL AIRPORT
 JUNEAU, ALASKA
 CARGO HARDSTAND
 CBJ CONTRACT No. BE17-035
 PFC 04-07-C-04-JNU
HARDSTAND STRUCTURAL DETAILS

SHEET
09
 OF
13

File: U:\204700309\Drawings\C\Sheets\TO TEMPORARY MARKING PLAN.dwg
 Script File: JUL 05, 2016 -- 3:46pm
 Plot Date:
 Designed By: JGL/JH/BEH
 Checked By: ZWS
 Drawn By: MRM

REMOVE EXISTING TUG ROAD MARKINGS
SEE SHEET 13.

AIRCRAFT SAFETY
BOUNDARY, SEE
DETAILS SHEET 12

CONSTRUCT HARDSTAND
SEE SHEET 07.

SIDA MARKING
RED LEGEND ON WHITE BACKGROUND.
COORDINATE WITH ENGINEER FOR USE
OF AIRPORT OWNED STENCIL.

TEMPORARY SIDA BOUNDARY
12 INCH RED.

COORDINATE TABLE

POINT	NORTHING	EASTING	DESCRIPTION
230	50722.23	46513.02	TEMP_MRKG
231	50802.23	46513.02	TEMP_MRKG
232	50825.18	46552.42	TEMP_MRKG
233	50819.73	46565.68	RP
234	50833.58	46569.36	TEMP_MRKG
235	50858.72	46569.36	TEMP_MRKG
236	50863.88	46574.52	TEMP_MRKG
237	50863.88	46588.52	TEMP_MRKG
238	50858.72	46593.69	TEMP_MRKG
239	50833.58	46593.69	TEMP_MRKG
240	50819.73	46597.37	RP
241	50825.18	46610.63	TEMP_MRKG
242	50802.23	46650.02	TEMP_MRKG
243	50722.23	46650.02	TEMP_MRKG
244	50796.23	46611.37	TEMP_MRKG
245	50796.23	46583.37	TEMP_MRKG
246	50796.23	46579.68	TEMP_MRKG
247	50796.23	46551.68	TEMP_MRKG
248	50840.23	46581.52	TERMINATION_BAR
249	50873.19	46506.52	TEMP_SIDA
250	50873.34	46656.52	TEMP_SIDA
251	50711.49	46656.52	TEMP_SIDA
252	50711.49	46506.52	TEMP_SIDA
253	50691.22	46581.52	LEAD-IN

NOTES

- ALL POINTS REFER TO CENTER OF RED OR CENTER OF YELLOW STRIPES. ENGINEER MUST APPROVE LAYOUT OF MARKINGS PRIOR TO PAINTING. ADJUST LAYOUT OF MARKINGS AS DIRECTED.
- CONTRACTOR WILL REPLACE ANY OF THE AIRPORT MARKINGS DAMAGED OR REMOVED DUE TO CONSTRUCTION ACTIVITY AT NO ADDITIONAL COST.
- REMOVE TEMPORARY MARKINGS AFTER COMPLETING HARDSTAND CONSTRUCTION AND PERMANENT MARKINGS.

FOR BID

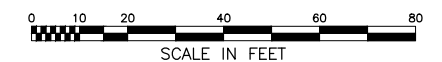

BY	DATE	REVISIONS

SCALE	
HORZ.	
VERT.	
W.O. NO.	204700309
FOR BIDS	

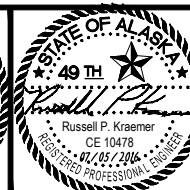
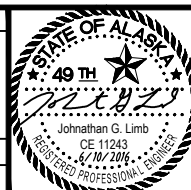

STANTEC CONSULTING SERVICES, INC.
 725 EAST FIREWEED LANE, SUITE 200
 ANCHORAGE, AK 99503-2245
 907-276-4245
 CERTIFICATE OF AUTHORIZATION # 126386



JUNEAU INTERNATIONAL AIRPORT
 JUNEAU, ALASKA
 CARGO HARDSTAND
 CBJ CONTRACT No. BE17-035
 PFC 04-07-C-04-JNU
**TEMPORARY MARKING
 PLAN**

SHEET
 10
 OF
 13

U:\204700309\Drawings\C\Sheets\11 PERMANENT HARDSTAND MARKING PLAN.dwg
 File: U:\204700309\Drawings\C\Sheets\11 PERMANENT HARDSTAND MARKING PLAN.dwg
 Script File: U:\204700309\Drawings\C\Sheets\11 PERMANENT HARDSTAND MARKING PLAN.dwg
 Plot Date: JUL 05, 2016 3:46pm
 Designed By: JGL/JH/BEH
 Checked By: ZWS
 Drawn By: MRM

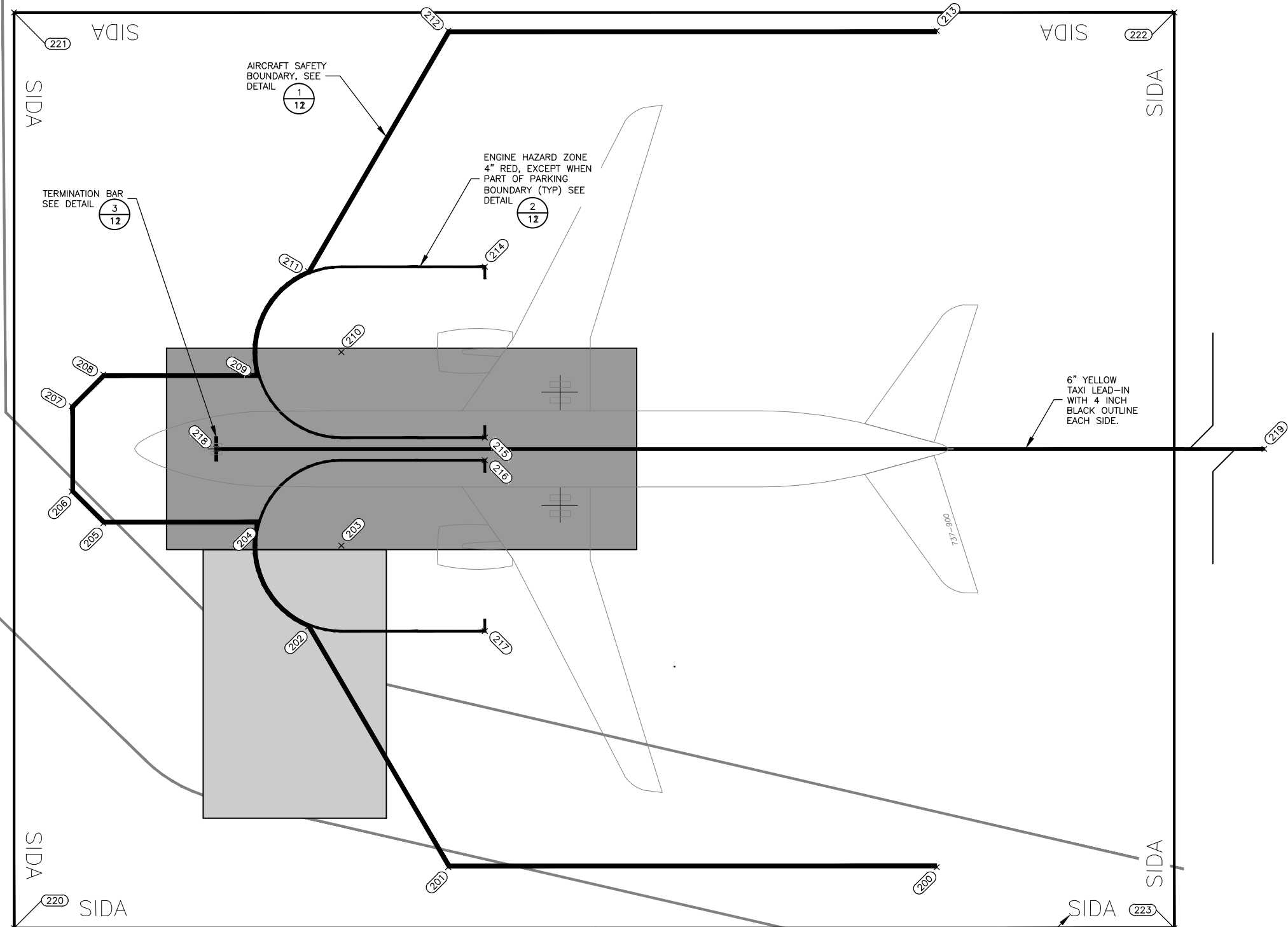

COORDINATE TABLE			
POINT	NORTHING	EASTING	DESCRIPTION
200	50850.11	46508.35	APRON MARK
201	50930.11	46508.35	APRON MARK
202	50953.05	46547.74	APRON MARK
203	50947.61	46561.00	RP
204	50961.46	46564.68	APRON MARK
205	50986.59	46564.68	APRON MARK
206	50991.76	46569.85	APRON MARK
207	50991.76	46583.85	APRON MARK
208	50986.59	46589.02	APRON MARK
209	50961.46	46589.02	APRON MARK
210	50947.61	46592.69	RP
211	50953.05	46605.95	APRON MARK
212	50930.11	46645.35	APRON MARK
213	50850.11	46645.35	APRON MARK
214	50924.11	46606.69	APRON MARK
215	50924.11	46578.69	APRON MARK
216	50924.11	46575.00	APRON MARK
217	50924.11	46547.00	APRON MARK
218	50968.10	46576.85	TERMINATION BAR
219	50740.79	46576.85	LEAD-IN START
220	51001.21	46498.35	SIDA
221	51001.21	46648.35	SIDA
222	50811.21	46648.35	SIDA
223	50811.21	46498.35	SIDA

NOTES

1. ALL POINTS REFER TO CENTER OF RED OR CENTER OF YELLOW STRIPES. ENGINEER MUST APPROVE LAYOUT OF MARKINGS PRIOR TO PAINTING. ADJUST LAYOUT OF MARKINGS AS DIRECTED.
2. REMOVE ALL EXISTING STRIPES BEFORE PAINTING NEW STRIPING.
3. CONTRACTOR WILL REPLACE ANY OF THE AIRPORT MARKINGS DAMAGED OR REMOVED DUE TO CONSTRUCTION ACTIVITY AT NO ADDITIONAL COST.
4. REMOVE TEMPORARY MARKINGS AFTER COMPLETING HARDSTAND CONSTRUCTION AND PERMANENT MARKINGS.

SIDA BOUNDARY
12 INCH RED.

REMOVE EXISTING TUG ROAD MARKINGS
SEE SHEET 13.

SIDA MARKING
RED LEGEND ON WHITE BACKGROUND.
COORDINATE WITH ENGINEER FOR USE
OF AIRPORT OWNED STENCIL.



FOR BID



BY	DATE	REVISIONS

SCALE	
HORZ.	
VERT.	
W.O. NO.	204700309
FOR BIDS	

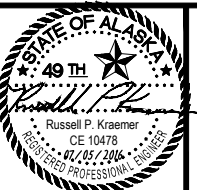

Stantec
 STANTEC CONSULTING SERVICES, INC.
 725 EAST FIREWEED LANE, SUITE 200
 ANCHORAGE, AK 99503-2245
 907-276-4245
 CERTIFICATE OF AUTHORIZATION # 126386



JUNEAU INTERNATIONAL AIRPORT
 JUNEAU, ALASKA
 CARGO HARDSTAND
 CBJ CONTRACT No. BE17-035
 PFC 04-07-C-04-JNU
**PERMANENT HARDSTAND
 MARKING PLAN**

U:\204700309\Drawgs\C\Sheets\12 HARDSTAND MARKING DETAIL.S.dwg
 File: U:\204700309\Drawgs\C\Sheets\12 HARDSTAND MARKING DETAIL.S.dwg
 Script File: U:\204700309\Drawgs\C\Sheets\12 HARDSTAND MARKING DETAIL.S.dwg
 Plot Date: JUL 05, 2016 3:47 pm

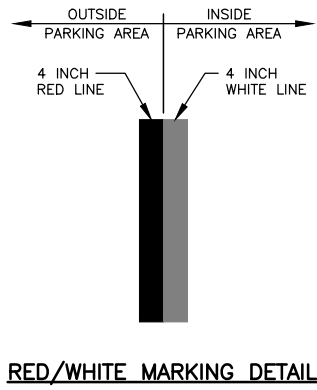
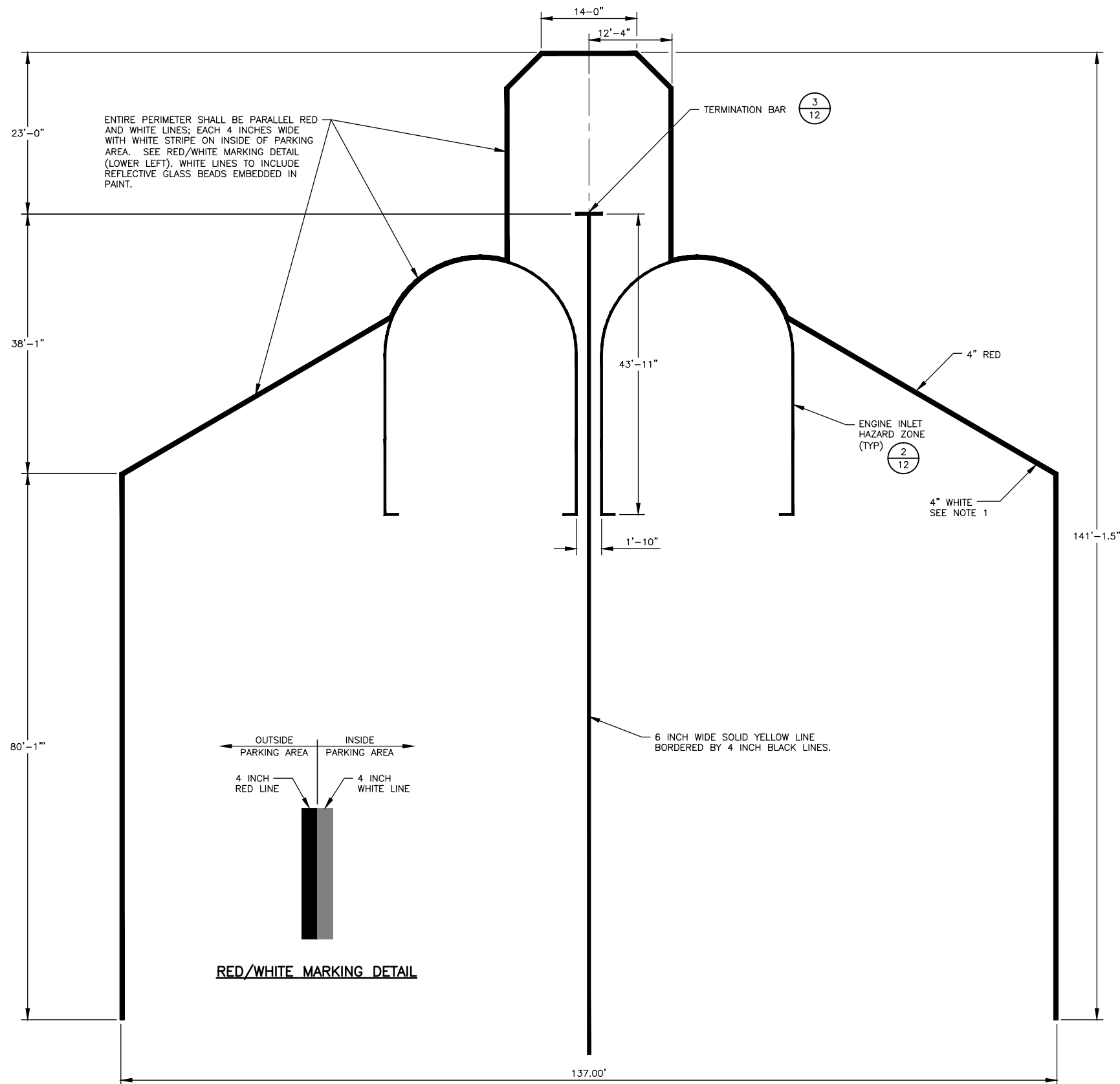

1
12
AIRCRAFT SAFETY MARKINGS
SCALE: NOT TO SCALE

NOTES

- PERIMETER OF AIRCRAFT SAFETY MARKING CONSIST OF TWO 4-INCH WIDE STRIPES, ONE RED, ONE WHITE. THE RED STRIPE IS THE OUTER MARKING ALONG THE PERIMETER.
- ALL DIMENSIONS REFER TO CENTER OF RED OR CENTER OF YELLOW STRIPES.
- THE ENGINE HAZARD RADIUS OF 14' CHANGES FROM RED, TO WHITE, AND BACK TO RED, AS IT BECOMES THE OUTER PERIMETER OF THE AIRCRAFT SAFETY MARKING.
- ALL RED, WHITE AND YELLOW MARKINGS TO INCLUDE REFLECTIVE GLASS BEADS EMBEDDED IN PAINT.

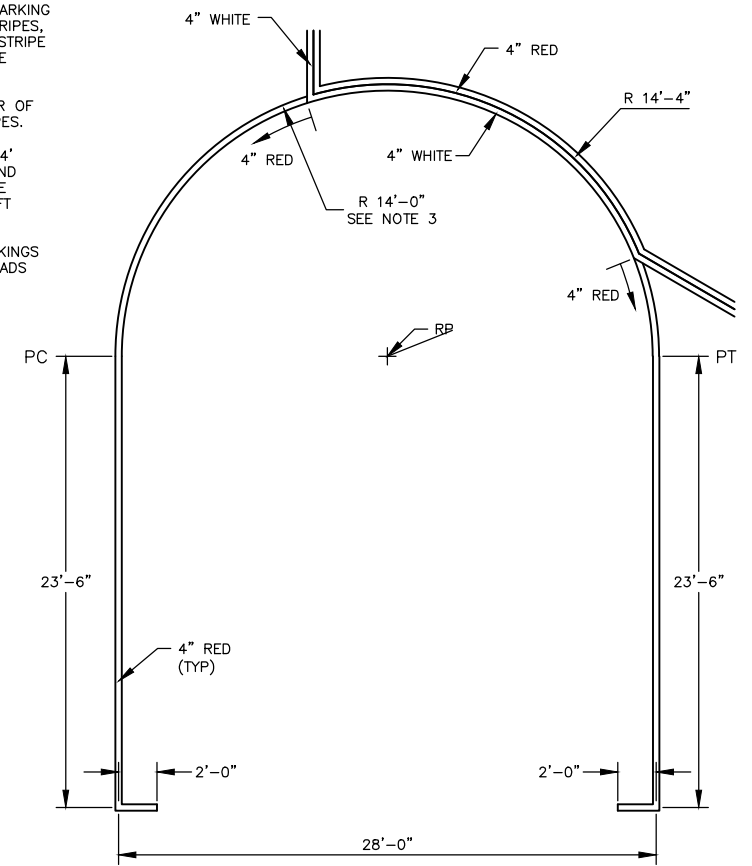

2
12
(RIGHT SIDE) ENGINE INLET HAZARD ZONE MARKINGS
SCALE: NOT TO SCALE

- ALL STRIPES ARE 4-INCH WIDE, RED, EXCEPT AS SHOWN, AND AS SPECIFIED IN NOTE 3 BELOW.
- LEFT ENGINE HAZARD MARKING IS MIRROR IMAGE.

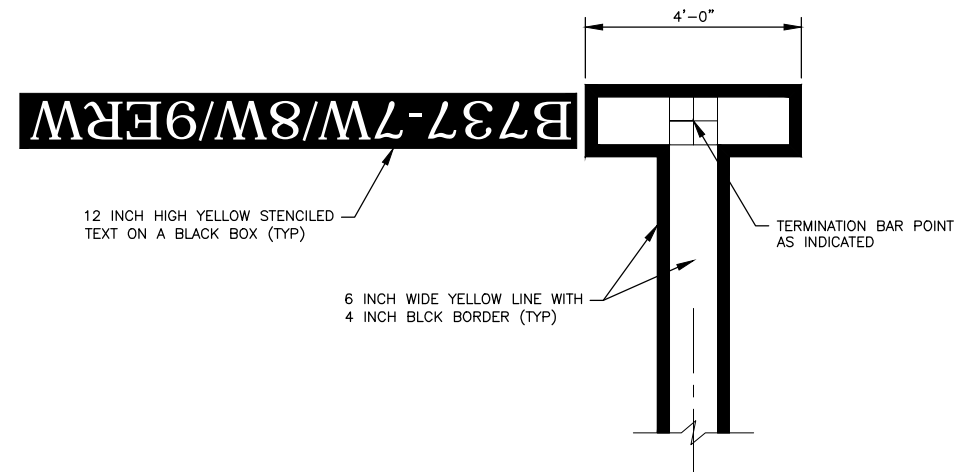

3
12
TERMINATION BAR (NOSE WHEEL MARK)
SCALE: NOT TO SCALE

FOR BID

BY	DATE	REVISIONS

SCALE	
HORZ.	
VERT.	
W.O. NO.	204700309
FOR BIDS	

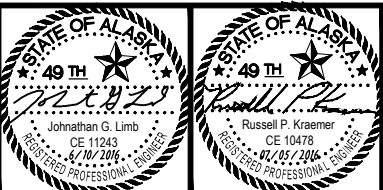

Stantec
 STANTEC CONSULTING SERVICES, INC.
 725 EAST FIREWEED LANE, SUITE 200
 ANCHORAGE, AK 99503-2245
 907-276-4245
 CERTIFICATE OF AUTHORIZATION # 126386



JUNEAU INTERNATIONAL AIRPORT
 JUNEAU, ALASKA
 CARGO HARDSTAND
 CBJ CONTRACT No. BE17-035
 PFC 04-07-C-04-JNU
HARDSTAND MARKING DETAILS

U:\204700309\Drawings\C\Sheets\13 TUG ROAD MARKING PLAN.dwg
 File: U:\204700309\Drawings\C\Sheets\13 TUG ROAD MARKING PLAN.dwg
 Script File: ZWS
 Plot Date: JUL 05, 2016 -- 4:55pm
 Designed By: JGL/JH/BEH
 Checked By: ZWS
 Drawn By: MRM

COORDINATE TABLE			
POINT	NORTHING	EASTING	DESCRIPTION
260	51057.85	46601.85	TUG_RD
261	51002.71	46601.49	TUG_RD
262	51003.02	46641.33	TUG_RD
263	50978.02	46666.52	TUG_RD
264	50978.59	46690.52	TUG_RD
265	51003.59	46715.33	TUG_RD
266	50727.98	46666.52	TUG_RD_PI
267	50725.49	46690.52	TUG_RD_PI
268	50699.52	46660.55	TUG_RD
269	50694.58	46684.04	TUG_RD
270	50680.18	46630.94	TUG_RD
271	50664.98	46703.37	TUG_RD
272	50709.25	46510.85	TUG_RD
273	50728.92	46437.35	TUG_RD
274	50978.02	46641.52	RP
275	50978.59	46715.52	RP
276	50704.65	46636.08	RP
277	50689.45	46708.50	RP

NOTES

1. ALL POINTS AND DIMENSIONS REFER TO CENTER OF WHITE MARKINGS.
2. REMOVE ALL EXISTING STRIPES BEFORE PAINTING NEW STRIPING.
3. CONTRACTOR WILL REPLACE ANY OF THE AIRPORT MARKINGS DAMAGED OR REMOVED DUE TO CONSTRUCTION ACTIVITY AT NO ADDITIONAL COST. SEE SECTION 70-11(G).
4. ALL TUG ROAD MARKINGS ARE WHITE.

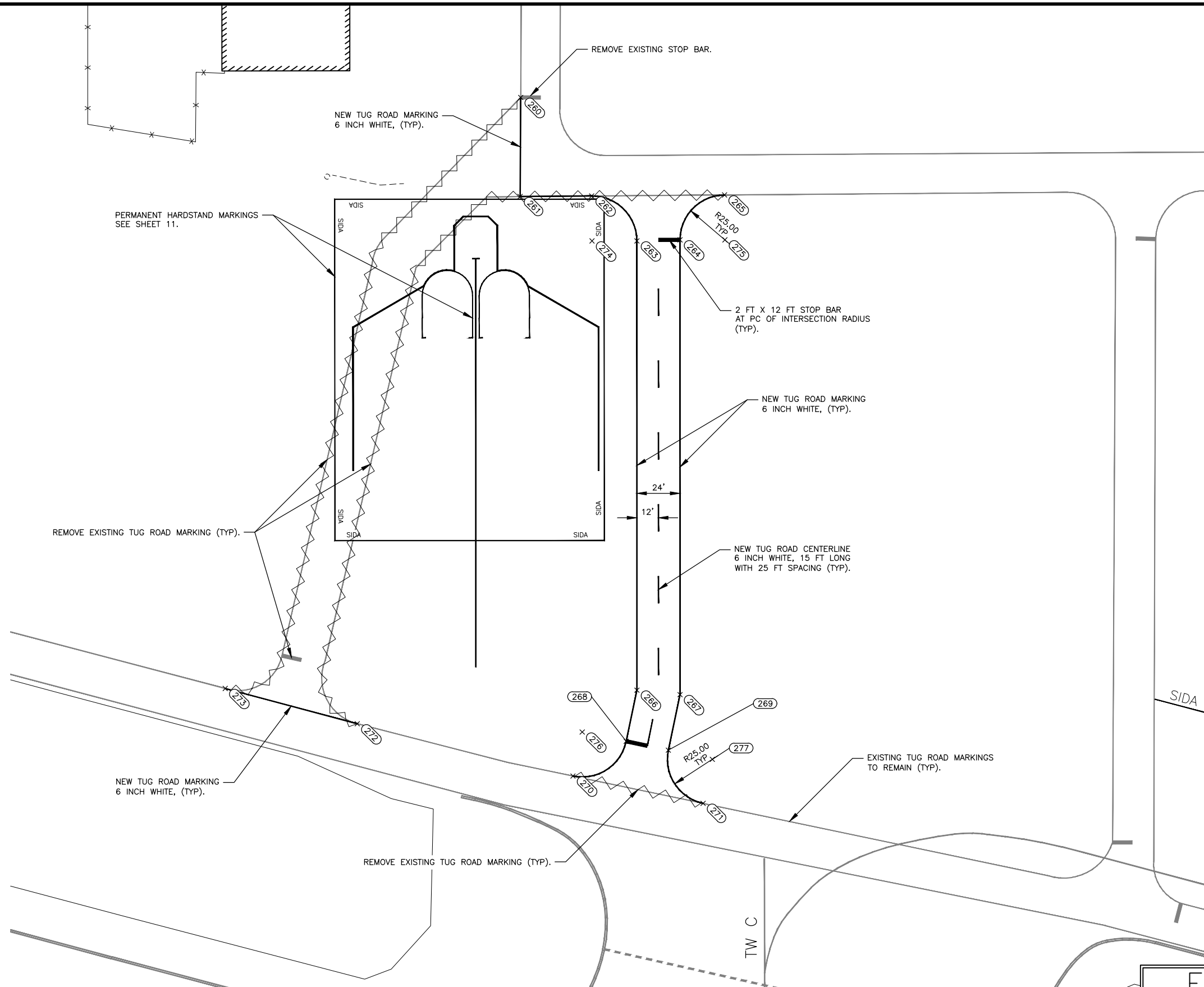

FOR BID

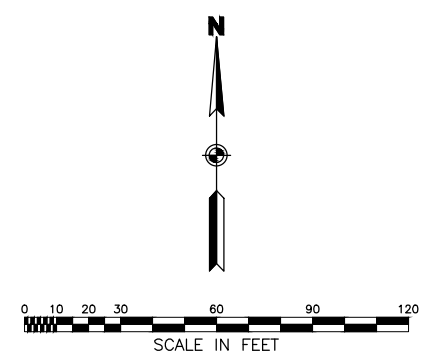

BY	DATE	REVISIONS

SCALE	
HORZ.	
VERT.	
W.O. NO.	204700309
FOR BIDS	



Stantec
 STANTEC CONSULTING SERVICES, INC.
 725 EAST FIREWEED LANE, SUITE 200
 ANCHORAGE, AK 99503-2245
 907-276-4245
 CERTIFICATE OF AUTHORIZATION # 126386



JUNEAU INTERNATIONAL AIRPORT
 JUNEAU, ALASKA
 CARGO HARDSTAND
 CBJ CONTRACT No. BE17-035
 PFC 04-07-C-04-JNU
TUG ROAD MARKING PLAN