

# **MEADOW LANE DRAINAGE IMPROVEMENTS**

## **VOLUME II of II**

**Contract No. E16-073**

File No. 1816

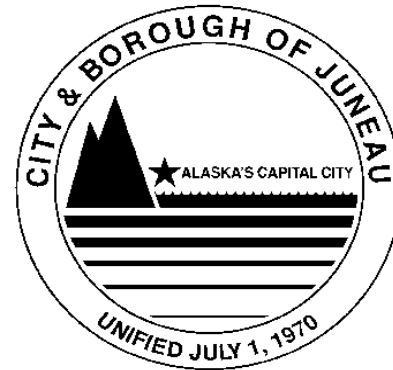

ENGINEERING DEPARTMENT

INDEX

DESCRIPTION	SHEET NO.
COVER SHEET	1 OF 14
LEGEND, ABBREVIATIONS, AND GENERAL NOTES	2 OF 14
TRAFFIC CONTROL NOTES, TABLES AND PAVING SEQUENCE REQUIREMENTS	3 OF 14
TYPICAL SECTION	4 OF 14
TYPICAL SECTIONS	5 OF 14
DETAILS	6 OF 14
HORIZONTAL AND VERTICAL CONTROL CURB AND GUTTER LAYOUT AND GRADES STIKINE STREET TO STA "M" 12+50	7 OF 14
HORIZONTAL AND VERTICAL CONTROL CURB AND GUTTER LAYOUT AND GRADES STA "M" 12+50 TO STA "M" 15+25	8 OF 14
HORIZONTAL AND VERTICAL CONTROL CURB AND GUTTER LAYOUT AND GRADES STA "M" 15+25 TO EOP	9 OF 14
PLAN – MEADOW LANE STIKINE STREET TO STA "M" 12+50	10 OF 14
PLAN – MEADOW LANE STA "M" 12+50 TO STA "M" 15+25	11 OF 14
PLAN – MEADOW LANE STA "M" 15+25 TO EOP	12 OF 14
PROFILE – MEADOW LANE STIKINE STREET TO STA "M" 16+00	13 OF 14
PROFILE – MEADOW LANE STA "M" 16+00 TO EOP	14 OF 14

MEADOW LANE DRAINAGE  
IMPROVEMENTS  
CONTRACT NO. E16-073

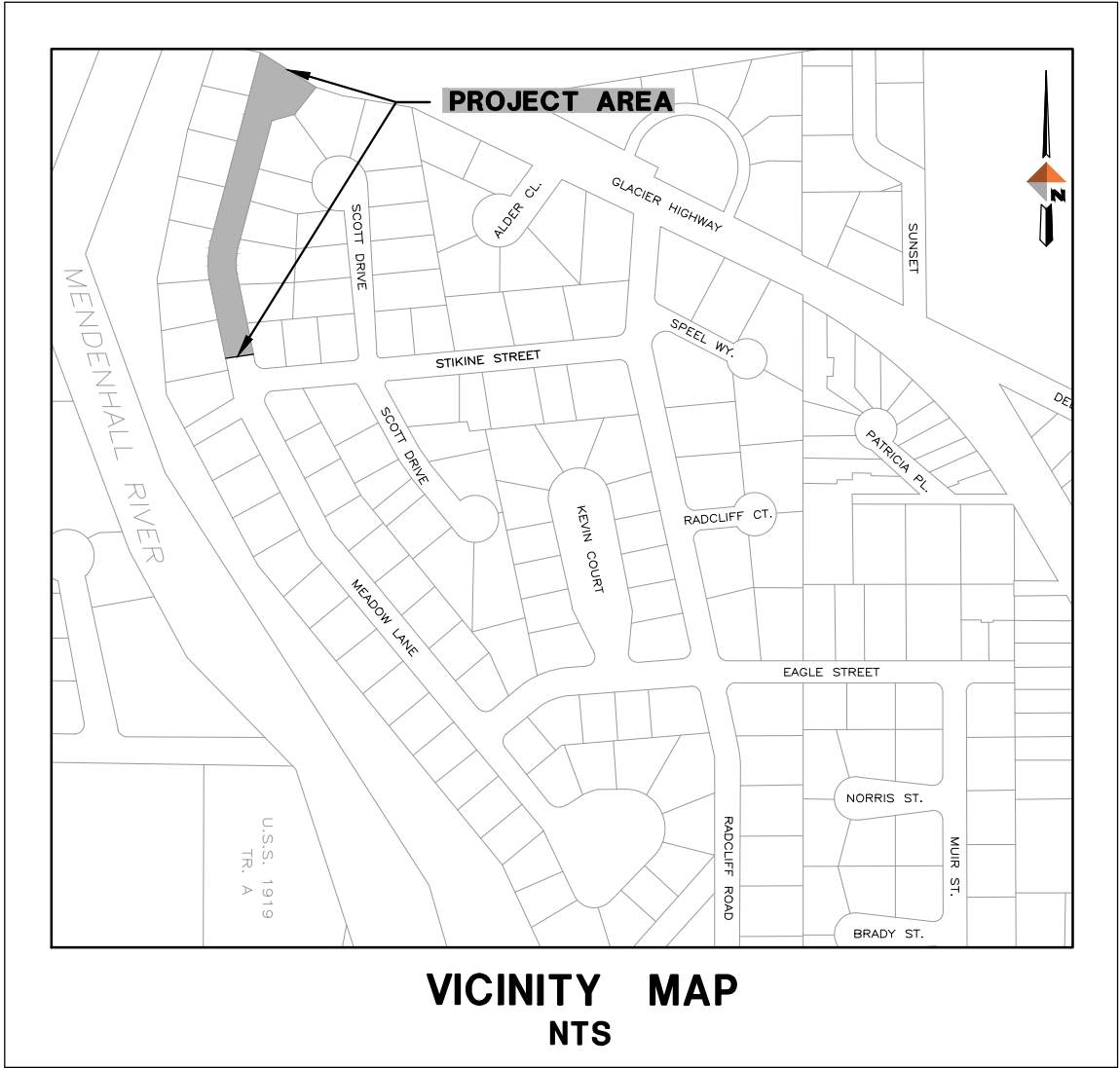

VICINITY MAP  
NTS



Consulting Engineers • Land Surveyors • Construction Administration

5368 Commercial Blvd.  
Juneau, Alaska 99801  
(907) 780-3533 Office  
(907) 780-3535 Fax

C:\Civil 3D Projects\22\70633-03\Civil\SC14-CT-LD-70633.03.dwg 2015-10-6 12:46:17

LEGEND

DESCRIPTION	EXISTING	REMOVE	PROPOSED
BURIED ELECTRICAL UTILITIES			
CATCH BASIN			
CONCRETE PAVEMENT			
CONTROL POINT			
CURB & GUTTER			
DRIVEWAY CUT			
FILL LIMITS			
FIRE HYDRANT			
HOUSE NO			
MAILBOX			
PROJECT CONTROL LINE			
PROPERTY LINE			
LIGHT POLE			
SANITARY SEWER PIPE			
SANITARY SEWER MANHOLE			
STORM DRAIN PIPE			
SAW CUT LIMITS			
SHRUB			
SUBCUT LIMITS			
SURVEY MONUMENT-REBAR W/ PLASTIC CAP			
TREE CONIFER			
TREE DECIDUOUS			
VALLEY GUTTER			
WATER LINE PIPE			
WATER VALVE BOX			

ABBREVIATIONS

AC	ASPHALT CEMENT
CB	CATCH BASIN
CMP	CORRUGATED METAL PIPE
CPP	CORRUGATED POLYETHYLENE PIPE
CONC	CONCRETE
CTE	CONNECT TO EXISTING
DI	DUCTILE IRON
DIA	DIAMETER
EOP	END OF PROJECT
FG	FINISHED GRADE
GV	GATE VALVE
INV	INVERT
LG	LIP OF GUTTER
LT	LEFT
MH	MANHOLE
MN	MAGNETIC NAIL
MTE	MATCH TO EXISTING
NFPA	NATIONAL FIRE PROTECTION ASSOCIATION
NO	NUMBER
NTS	NOT TO SCALE
PC	POINT OF CURVATURE
PT	POINT OF TANGENCY
PVI	POINT OF VERTICAL INTERSECTION
POC	POINT ON CURVE
PCC	POINT OF COMPOUND CURVE
PRC	POINT OF REVERSE CURVATURE
PVC	POLYVINYL CHLORIDE PIPE
RT	RIGHT
STA	STATION
STD	STANDARD
TBC	TOP BACK OF CURB
TBG	TOP BACK OF GUTTER
TP	TOP OF PAVEMENT
VG	VALLEY GUTTER

ABBREVIATIONS TO BE USED WITHOUT PERIODS

GENERAL NOTES

- BEGIN SUBCUT 24 INCHES FROM PAVEMENT SAWCUT LINE AT STREET CONNECTIONS, UNLESS OTHERWISE SHOWN ON THE DRAWINGS, OR DIRECTED BY THE ENGINEER. REMOVE AND REPLACE BASE COURSE WITH 9-1/2 INCHES OF 2" MINUS SHOT ROCK W/ BASE COURSE TO 12 INCHES FROM PAVEMENT SAWCUT LINE. SAWCUT AS NECESSARY ALONG ALL STREET AND DRIVEWAY APPROACHES TO PROVIDE A NEAT MATCH LINE.
- LARGE BOULDERS, STUMPS, LOGS, ORGANICS AND GROUND WATER MAY BE ENCOUNTERED AT VARIOUS DEPTHS DURING EXCAVATION OPERATIONS.
- CONTRACTOR SHALL ENSURE UNINTERRUPTED GARBAGE PICKUP AND DAILY MAIL SERVICE TO ALL RESIDENCES AFFECTED BY THIS PROJECT.
- THE 4TH EDITION OF THE CBJ STANDARD DETAILS, DATED AUGUST 14 2011, IS MADE PART OF THIS CONTRACT, WITH CURRENT REVISIONS AS APPLICABLE.
- ALL EXISTING STORM DRAIN PIPES (6 INCH DIAMETER AND LARGER), AND APPURTENANCES TO BE TAKEN OUT OF SERVICE, THAT ARE WITHIN THE STREET AND SIDEWALK LIMITS, SHALL BE REMOVED AND DISPOSED OF, UNLESS OTHERWISE NOTED.
- EXISTING PIPE LOCATIONS ARE DERIVED FROM CBJ AS-BUILTS OR FIELD LOCATED BY UTILITY LOCATES. ACTUAL LOCATIONS MAY VARY FROM THOSE SHOWN. DEPTH OF THE EXISTING PIPES SHOWN ON THE ELEVATIONS ARE ASSUMED. CONTRACTOR SHALL FIELD VERIFY THE LOCATION OF EACH EXISTING SERVICE PIPE PRIOR TO INSTALLING THE STORM DRAIN PIPES. DIAL BEFORE YOU DIG 586-1333.
- GRADING AND ALIGNMENT ARE SUBJECT TO MINOR REVISIONS BY THE ENGINEER.
- LOCATION OF STORM CATCH BASINS, PIPING AND PIPE LENGTHS ARE SUBJECT TO MINOR REVISIONS BY THE ENGINEER.
- THE CONTRACTOR SHALL NOTIFY CBJ WATER UTILITIES AT 780-6808 OF PROPOSED WATER MAIN INTERRUPTION AND SUBMIT THE "WATER SYSTEM SPECIAL USE PERMIT" (COSIGNED BY THE ENGINEER) AT LEAST ONE WEEK PRIOR TO SHUTDOWN OF MAINLINE WATER PIPE.
- PROPERTY LINE LOCATIONS USED IN THESE PLANS ARE DERIVED FROM RECORD PLATS AND DO NOT REPRESENT A BOUNDARY SURVEY. EXISTING RECORD PLATS DO NOT CLOSE WITH EACH OTHER IN SOME CASES. THE PROPERTY LINES SHOWN ON THESE PLANS ARE A BEST FIT APPROXIMATION OF CLOSURE.
- CONTRACTOR SHALL VERIFY LOCATION AND DEPTH OF EXISTING WATER AND SEWER PIPES, INCLUDING ALL SERVICES ALONG THE STORM DRAIN ALIGNMENT, TO DETERMINE PIPE INSULATION LOCATIONS, AND TO ENSURE DAMAGE DOES NOT OCCUR TO THE SERVICE PIPES.
- ALL ITEMS DESIGNATED TO BE REMOVED SHALL BE DISPOSED OF AT AN APPROVED DISPOSAL SITE, EXCEPT AS NOTED IN THE CONTRACT DOCUMENTS.
- CONTRACTOR SHALL REFERENCE ALL EXISTING PROPERTY CORNER MONUMENTS (E.G. REBARS, CONCRETE NAILS, BRASS CAP MONUMENT) PRIOR TO CONSTRUCTION AND REMONUMENT AFTER SURFACING IS REPLACED. ALL WORK SHALL BE DONE BY, OR UNDER THE DIRECTION OF, AN ALASKA REGISTERED LAND SURVEYOR.
- ALL ASPHALT PAVEMENT TO BE REMOVED AND DISPOSED OF SHALL BE DELIVERED TO A STOCKPILE AREA AT THE LEMON CREEK CITY PIT TO BE DESIGNATED BY THE ENGINEER. CONTACT THE ENGINEER FOR THE EXACT LOCATION OF THE STOCKPILE.
- AE&P, ACS, AND GCI MAY CONDUCT WORK WITHIN THE PROJECT LIMITS TO RELOCATE UTILITIES AND UPGRADE THEIR RESPECTIVE SYSTEMS. THE CONTRACTOR SHALL COORDINATE ITS ACTIVITIES WITH EACH UTILITY COMPANY AND PROVIDE ACCESS AS NECESSARY FOR UTILITY COMPANIES TO CONDUCT THEIR WORK.
- ONLY HORIZONTAL ELBOW FITTINGS (BENDS) ARE SHOWN ON PLANS. ADDITIONAL FITTINGS WILL BE REQUIRED FOR VERTICAL DEFLECTIONS NEAR CONNECTIONS TO EXISTING PIPES AND AT OTHER LOCATIONS REQUIRING GRADE CHANGES TO AVOID CONFLICTS.
- THE CONTRACTOR SHALL RESTRICT ITS COMPACTION AND OTHER VIBRATION INDUCING OPERATIONS AS NECESSARY TO ENSURE NO DAMAGE OCCURS TO ADJACENT BUILDINGS OR STRUCTURES. REFER TO SECTION 01530, ARTICLE 1.7 FOR FURTHER REQUIREMENTS.
- THE PLAN SHEETS DO NOT SHOW ALL OF THE TREES AND OTHER VEGETATION THAT WILL BE ENCOUNTERED DURING CONSTRUCTION ACTIVITIES. NO TREES OR OTHER VEGETATION ARE TO BE REMOVED OR DAMAGED, UNLESS SHOWN ON THE DRAWINGS OR DIRECTED BY THE ENGINEER.
- THE CONTRACTOR SHALL NOT STORE MATERIALS OR EQUIPMENT, OR OPERATE EQUIPMENT WITH ITS TRACKS OR WHEELS PLACED ON PRIVATE PROPERTY, WITHOUT PRIOR WRITTEN APPROVAL OF THE PROPERTY OWNER.
- THE USE OF GROUT AND QUICKSET CEMENT PRODUCTS WITH ADJUSTING RINGS, BRICKS, WOOD, STONES AND OTHER SIMILAR GRADE ADJUSTMENT DEVICES TO SUPPORT CATCH BASIN FRAMES OVER CATCH BASINS AND MANHOLES WILL NOT BE PERMITTED. CATCH BASIN FRAME AND GRATES SHALL BE SET AT 6-3/4" BELOW TOP BACK OF CURB ELEVATION WITH 3 FOOT LONG CONCRETE TRANSITIONS TO BOTH SIDES OF GRATE.
- THE CONTRACTOR SHALL NOTIFY EACH RESIDENT OF EACH DRIVEWAY CLOSURE THE DAY PRECEDING THE DAY THE DRIVEWAY IS TO BE CLOSED TO VEHICULAR ACCESS. THE RESIDENT SHALL BE INFORMED OF THE PERIOD OF TIME THE CLOSURE WILL BE IN EFFECT. NO DRIVEWAY CLOSURES WILL BE PERMITTED UNTIL THIS REQUIREMENT HAS BEEN MET TO THE SATISFACTION OF THE ENGINEER.
- ALL FORMS FOR CONCRETE SEGMENTS BETWEEN PC'S AND PT'S WITH A RADIUS LESS THAN 200' SHALL BE ARCED TO MATCH THE REQUIRED CURVATURE. NO STRAIGHT FORMS SHALL BE USED WITHIN ANY CURVED SEGMENT WITH A RADIUS OF LESS THAN 200'. STRAIGHT FORMS USED FOR ANY ARCED SEGMENT WITH A RADIUS OF MORE THAN 200' SHALL NOT EXCEED 10' IN LENGTH.
- APPLY "CONCRETE INTERNATIONAL CORPORATION" ASHFORD FORMULA CURING COMPOUND, OR APPROVED EQUAL, TO ALL NEWLY PLACED CONCRETE SURFACES IN ACCORDANCE WITH THE MANUFACTURER'S RECOMMENDATIONS.
- "JUMPING JACK" OR SIMILAR TYPE COMPACTORS SHALL BE USED TO THOROUGHLY COMPACT ALL LAYERS OF MATERIAL AROUND WATER VALVE BOXES, CATCH BASINS, MANHOLES AND OTHER STRUCTURES.

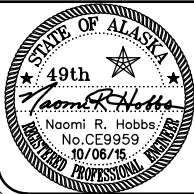

Consulting Engineers • Land Surveyors • Construction Administration

JOB No. J70633.03 DRAWN BY: STAFF DESIGNED BY: R. STEPHENS CHECKED BY: STAFF DATE: OCT 2015

5368 Commercial Blvd.  
Juneau, Alaska 99801  
(907) 780-3533 Office  
(907) 780-3535 Fax



DEPARTMENT OF ENGINEERING

MEADOW LANE DRAINAGE  
IMPROVEMENTS  
CONTRACT NO. E16-073

LEGEND, ABBREVIATIONS,  
AND GENERAL NOTES

SHEET NO.

2  
of  
14

C:\Civil 3D Projects\22\70633-03\Civil\SC14-CT-TS-70633.03.dwg 2015-10-6 12:48:57

CATCH BASIN FRAME AND GRATE TABLE

CATCH BASIN No.	EAST JORDAN IRON WORKS, OLYMPIC FOUNDRY CO., CBJ STANDARD No., OR APPROVED EQUAL
CB-1	EJIW 7701 T2 HOOD W/7700 M3 GRATE
CB-2	OF SM18
CB-3	OF SM18
CB-4	OF SM18
CB-5	OF SM18
CB-6	OF SM18
CB-7	OF SM18
CB-8	OF SM18

CATCH BASIN TOP SLAB OPENINGS SHALL BE DIMENSIONED TO FIT THE FRAME DIMENSIONS. ALL COVERS SHALL BE HEAVY DUTY CONSTRUCTION AND BICYCLE SAFE. ALL FRAMES AND GRATES SHALL BE DUCTILE IRON.

LOCAL FLOW LINE DEPRESSION AT CATCH BASIN SHALL BE 3/4 INCH, WITH 36" TRANSITIONS TO EACH SIDE OF FRAME, UNLESS OTHERWISE DIRECTED BY THE ENGINEER.

RECONSTRUCT MAILBOX TABLE

HOUSE NUMBER	LOCATION	COMMENTS
2563	STA "M" 10+98.8, 11.0 LT	SINGLE
2564	STA "M" 11+59.9, 11.0 RT	SINGLE
2565	STA "M" 11+91.3, 11.0 LT	SINGLE
2567 / 2569	STA "M" 12+46.9, 11.0 LT	GANG
2566 / 2568	STA "M" 13+14.2, 11.0 RT	GANG
2570	STA "M" 13+53.0, 11.0 RT	SINGLE
2573 APT 5 / 2573 APT 6	STA "M" 13+73.3, 11.0 RT	GANG
2573 APT 7 / 2573 APT 8	STA "M" 13+75.3, 11.0 RT	GANG
2571 APT 9 / 2571 APT 10	STA "M" 13+77.3, 11.0 RT	GANG
2571 APT 11 / 2571 APT 12	STA "M" 13+79.3, 11.0 RT	GANG

MAILBOXES SHALL BE CONSTRUCTED IN ACCORDANCE WITH CBJ STANDARD DETAILS 116 & 117.

MAILBOX LOCATIONS ARE GIVEN TO THE FRONT CENTER FACE OF EACH MAILBOX ASSEMBLY.

CONTRACTOR SHALL STAKE MAILBOX POST LOCATION FOR APPROVAL BY THE ENGINEER PRIOR TO INSTALLATION.

REINSTALL EXISTING MAILBOX AND NEWSPAPER RECEPTACLES TO NEW POST ASSEMBLIES. IF THE RECEPTACLES ARE DAMAGED BY THE CONTRACTOR, NEW RECEPTACLES OF SAME SIZE AND COLOR AND NEW HOUSE NUMBERS SHALL BE PROVIDED BY THE CONTRACTOR.

GANG MAILBOX ASSEMBLIES SHALL BE MEASURED FOR PAYMENT UNDER PAY ITEM 2719.1. RECONSTRUCT MAILBOX, AS ONE PAY UNIT.

MAIL DELIVERY SERVICE SHALL NOT BE INTERRUPTED AND ACCESS TO EACH MAILBOX RECEPTACLE SHALL BE AVAILABLE TO THE UNITED STATES POSTAL SERVICE AND THE RESIDENTS AT ALL TIMES.

EXISTING MAILBOXES THAT ARE MOVED BY THE CONTRACTOR SHALL HAVE TEMPORARY SUPPORTS PROVIDED AS REQUIRED FOR CONTINUOUS USAGE.

THE LOCATIONS PROVIDED ARE NEW LOCATIONS FOR THE MAILBOXES. EXISTING STATION AND OFFSET LOCATIONS FOR THE MAILBOXES ARE NOT PROVIDED.

PAVING SEQUENCE REQUIREMENTS:

- LAYDOWN OPERATIONS SHALL BE CONDUCTED IN A MANNER THAT ENSURES THE MINIMUM TEMPERATURE ALONG THE CENTERLINE EDGE OF THE FIRST PAVED LANE DOES NOT FALL BELOW 200° F BEFORE THE SECOND PAVED LANE IS PLACED AGAINST THIS EDGE.

NOTES FOR TRAFFIC CONTROL:

- ALL TRAFFIC TO BE CONTROLLED PER THE REQUIREMENTS OF THE ALASKA TRAFFIC MANUAL (U.S. DEPARTMENT OF TRANSPORTATION "MANUAL ON UNIFORM TRAFFIC CONTROL DEVICES" AND THE ALASKA SUPPLEMENT).
- ROAD CLOSURES WILL BE PERMITTED ONLY AS APPROVED BY THE ENGINEER.
- THE CONTRACTOR WILL NOT BE PERMITTED TO OBSTRUCT VEHICULAR TRAFFIC BETWEEN THE HOURS OF 4:30pm AND 8:00am SEVEN DAYS A WEEK. DURING THIS PERIOD, TWO LANES, WITH A MINIMUM TOTAL WIDTH OF 18 FEET, SHALL BE OPEN TO VEHICULAR TRAFFIC.
- PROVIDE ACCESS FOR EMERGENCY VEHICLES AT ALL TIMES.
- PEDESTRIAN TRAFFIC SHALL BE AVAILABLE ALONG AT LEAST ONE SIDE OF THE STREET AT ALL TIMES. THE PEDESTRIAN PATHWAY SHALL BE CLEARLY MARKED AND SHALL SATISFY THE REQUIREMENTS DESCRIBED IN THE SPECIAL PROVISIONS.

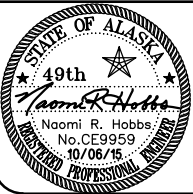

Consulting Engineers • Land Surveyors • Construction Administration

5368 Commercial Blvd.  
Juneau, Alaska 99801  
(907) 780-3533 Office  
(907) 780-3535 Fax

JOB No. J70633.03 | DRAWN BY: STAFF | DESIGNED BY: R. STEPHENS | CHECKED BY: STAFF | DATE: OCT 2015



DEPARTMENT OF ENGINEERING

MEADOW LANE DRAINAGE  
IMPROVEMENTS  
CONTRACT NO. E16-073

TRAFFIC CONTROL NOTES,  
TABLES AND PAVING  
SEQUENCE REQUIREMENTS

SHEET NO.

3  
of  
14

C:\Civil 3D Projects\22\70633-03\Civil\SC14-CT-TS-70633.03.dwg 2015-10-6 12:48:59

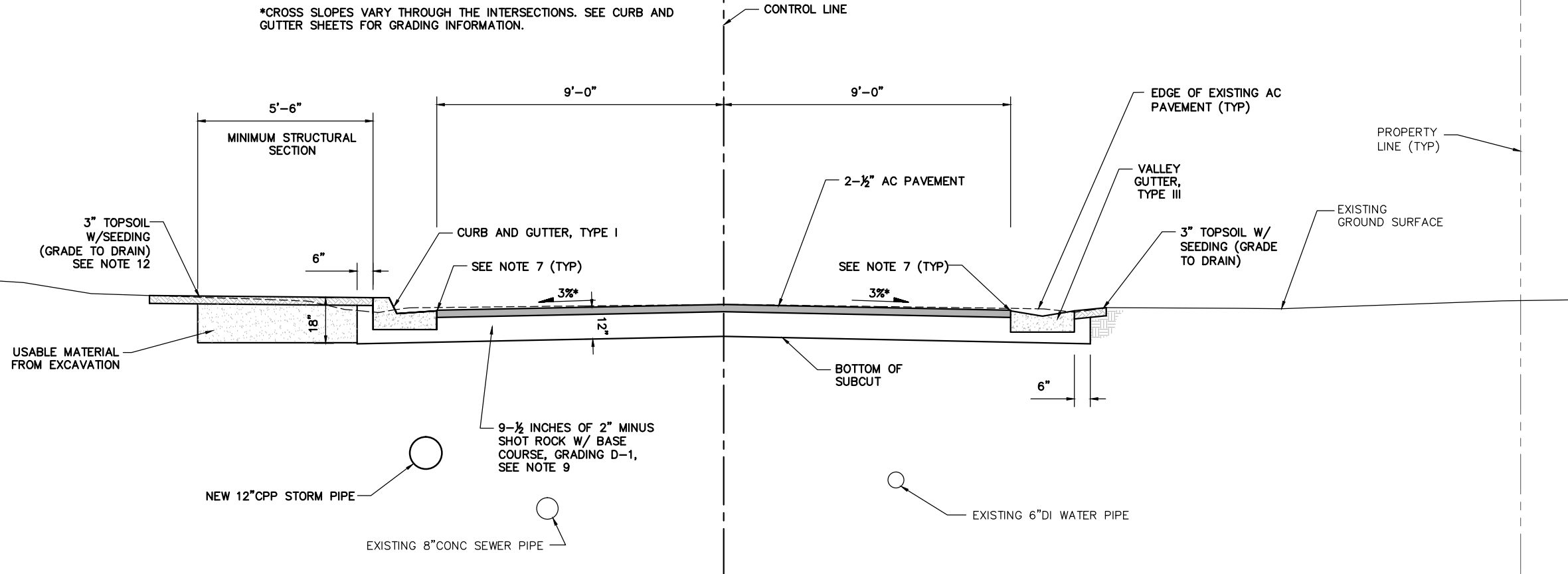

**TYPICAL SECTION**  
**MEADOW LANE STA "M" 10+33 TO STA "M" 13+20**

NTS

**NOTES FOR TYPICAL SECTIONS AND DRIVEWAYS**

1. ADDITIONAL EXCAVATION BELOW THE NEATLINE SUBCUT LEVEL MAY BE REQUIRED IF ORGANIC OR OTHER UNSUITABLE MATERIALS ARE FOUND AT OR NEAR THE PLANNED SUBCUT LEVEL, AS DIRECTED BY THE ENGINEER. USABLE MATERIAL FROM EXCAVATION SHALL BE USED TO BACKFILL THE ADDITIONAL AREAS OF EXCAVATION. THE ADDITIONAL EXCAVATION WILL BE MEASURED FOR PAYMENT, HOWEVER THE BACKFILLING WITH USABLE MATERIAL FROM EXCAVATION WILL BE CONSIDERED INCIDENTAL TO OTHER WORK.
2. SEE HORIZONTAL AND VERTICAL CONTROL, CURB AND GUTTER LAYOUT AND GRADE DRAWINGS FOR GRADING DETAILS.
3. UNDERGROUND CABLE, TELEPHONE, AND ELECTRICAL UTILITIES ARE NOT SHOWN. SEE PLAN SHEETS FOR LOCATIONS.
4. SANITARY SEWER, WATER AND STORM DRAIN SERVICES ARE NOT SHOWN ON THE TYPICAL SECTION. SEE PLAN VIEW DRAWINGS FOR LOCATIONS.
5. ALL FILL AREAS BEYOND SUBCUT LIMITS SHALL BE BACKFILLED WITH SUITABLE MATERIAL FROM EXCAVATION AND GRADED TO DRAIN AS SHOWN ON THE PLAN VIEW DRAWINGS.
6. DRIVEWAYS DISTURBED DURING CONSTRUCTION SHALL BE RECONSTRUCTED TO EQUAL, OR BETTER CONDITION WITH SUBGRADE REPLACED IN LAYERS TO MATCH THOSE REMOVED EXCEPT:
  - A) PAVED DRIVEWAYS SHALL BE SUBCUT TO 12 INCHES BELOW FINISH GRADE AND REPLACED WITH 9-1/2 INCHES OF 2-INCH MINUS SHOT ROCK W/ BASE COURSE, AND 2-1/2 INCHES OF AC PAVEMENT.
  - B) ORGANICS, ROOTS, WOOD OR OTHER DELETERIOUS MATERIALS ENCOUNTERED IN THE DRIVEWAYS DURING EXCAVATION OPERATIONS SHALL NOT BE REPLACED, BUT SHALL BE DISPOSED OF AT AN APPROVED DISPOSAL SITE. BACKFILL VOIDS BELOW THE REQUIRED SUBBASE LAYER WITH USABLE MATERIAL FROM EXCAVATION.
7. TOP OF AC PAVEMENT GRADES GIVEN ON THE PLANS ARE ACTUAL FINISHED PAVEMENT SURFACE ELEVATIONS. TOP OF AC PAVEMENT ALONG NEW CONCRETE GUTTERS SHALL BE FINISHED 1/4 INCHES ABOVE THE LIP OF GUTTER.
8. GRADE TOP OF CURB AT 2% TOWARD THE GUTTER.
9. THE BASE COURSE LAYER SHALL BE 7-1/2" TO 8-1/2" OF 2-INCH MINUS SHOT ROCK WITH 1" TO 2" TOP LAYER OF BASE COURSE, GRADING D-1 FOR A TOTAL THICKNESS OF 9-1/2". THE 2" MINUS SHOT ROCK SHALL BE WELL COMPACTED PRIOR TO PLACING THE BASE COURSE, GRADING D-1.
10. BASE COURSE, GRADING D-1, MAY BE USED FOR THE FULL DEPTH OF THE BASE COURSE UNDER THE DRIVEWAYS AS A NO COST SUBSTITUTION.
11. DRIVEWAY DEPRESSIONS ALONG THE CURB AND GUTTER WITH EXTENSIONS FOR POSTAL SERVICE MAIL DELIVERIES ARE MARKED ON THE PLAN DRAWINGS. MINIMUM LENGTHS FROM THE MAILBOX TO THE END OF THE DEPRESSED CURB MUST BE MET TO ENSURE DELIVERY OF MAIL BY THE POSTAL SERVICE. THE CONTRACTOR SHALL NOTIFY THE ENGINEER WHEN THE LOCATION OF THE CURB DEPRESSIONS ARE READY FOR APPROVAL PRIOR TO PLACEMENT OF CONCRETE.
12. THE LIMITS OF USABLE MATERIAL AND TOPSOIL OUTSIDE THE STRUCTURAL SECTION WILL VARY IN DISTANCE FROM RIGHT-OF-WAY LINES. PLACE AND GRADE THESE MATERIALS TO PROVIDE A SMOOTH, WELL DRAINED TRANSITION TO EXISTING GRADES, AS DIRECTED BY THE ENGINEER.

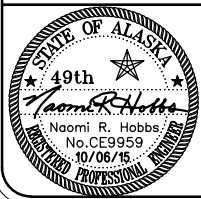

Consulting Engineers • Land Surveyors • Construction Administration

5368 Commercial Blvd.  
Juneau, Alaska 99801  
(907) 780-3533 Office  
(907) 780-3535 Fax

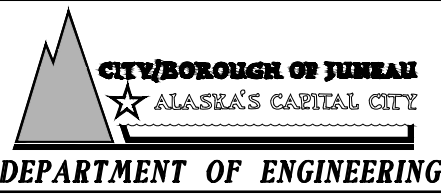

**MEADOW LANE DRAINAGE  
IMPROVEMENTS  
CONTRACT NO. E16-073**

**TYPICAL SECTION**

SHEET NO.

**4**  
of  
**14**



C:\Civil\_3D\Projects\22\70633-03\Civil\SC14-CT-TS-70633.03.dwg 2015-10-6 12:49:03

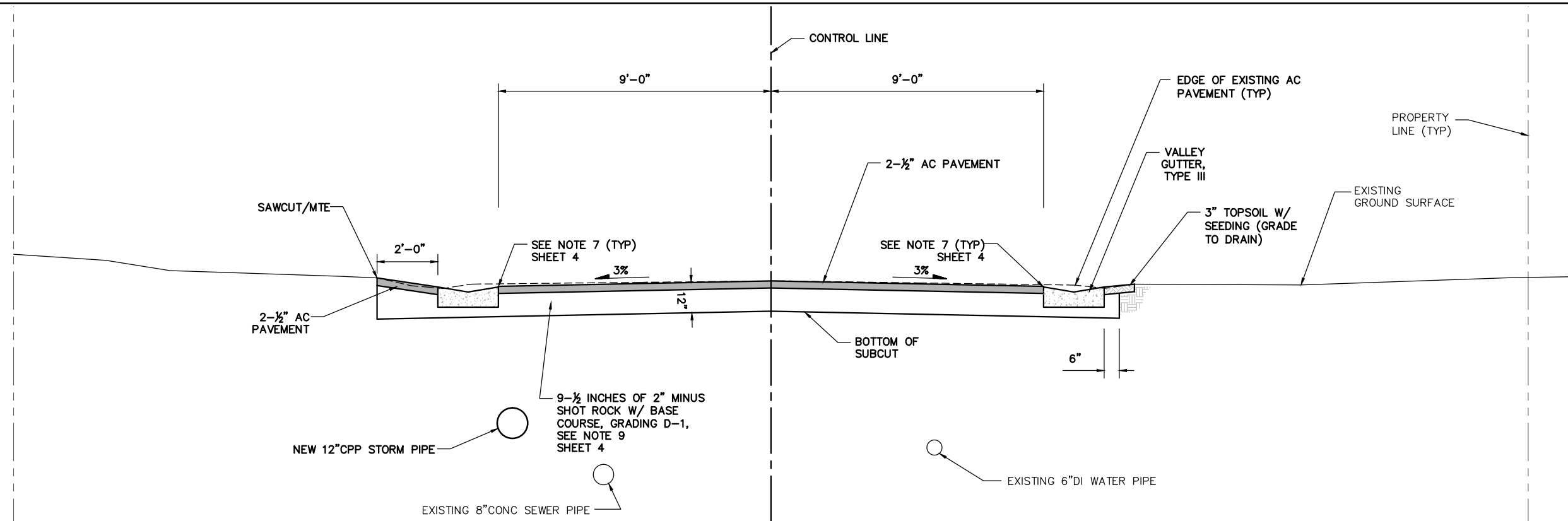

**TYPICAL SECTION  
MEADOW LANE STA "M" 13+20 TO STA "M" 16+05**

NTS

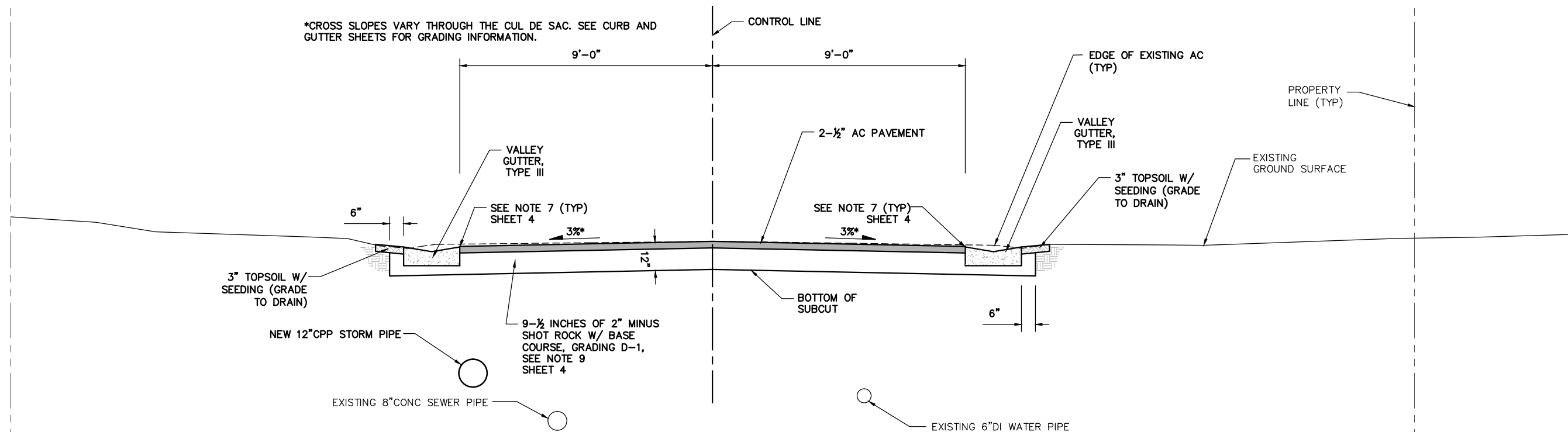

**TYPICAL SECTION  
MEADOW LANE STA "M" 16+05 TO EOP**

NTS

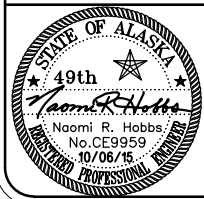

**DOWL**  
Consulting Engineers • Land Surveyors • Construction Administration

5368 Commercial Blvd.  
Juneau, Alaska 99801  
(907) 780-3533 Office  
(907) 780-3535 Fax

Naomi R. Hobbs  
No. CE9959  
10/06/15

JOB No. J70633.03 DRAWN BY: STAFF DESIGNED BY: R. STEPHENS CHECKED BY: STAFF DATE: OCT 2015

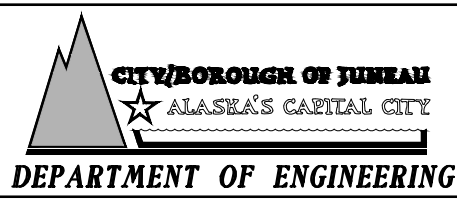

**MEADOW LANE DRAINAGE  
IMPROVEMENTS  
CONTRACT NO. E16-073**

**TYPICAL SECTIONS**

SHEET NO.  
**5**  
of  
**14**

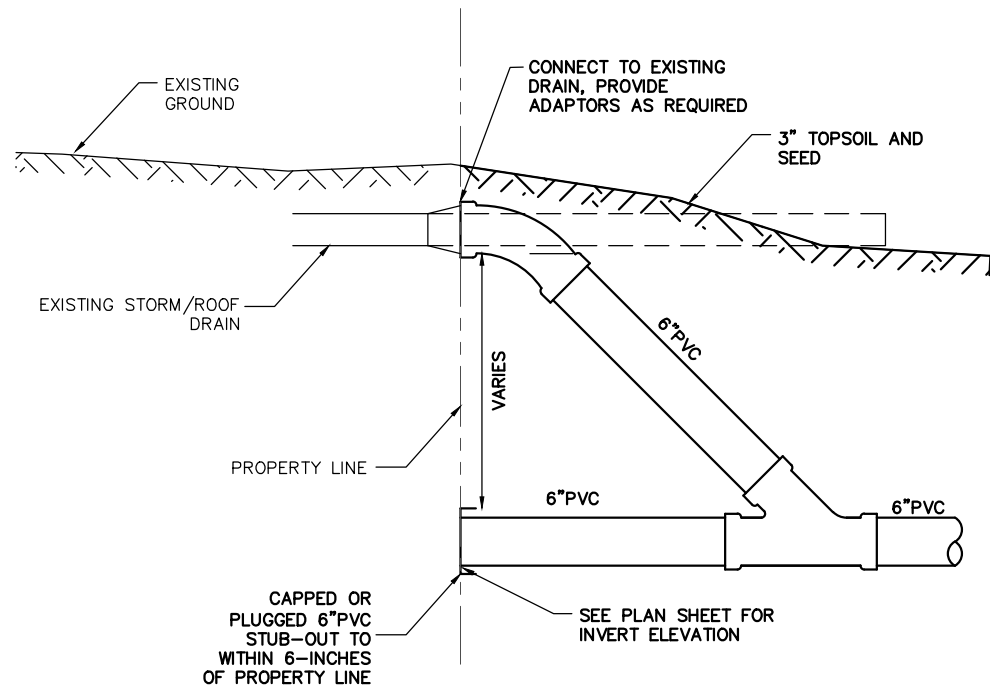

**1**  
**6**  
**CONNECTION TO EXISTING PROPERTY DRAINS**  
NTS

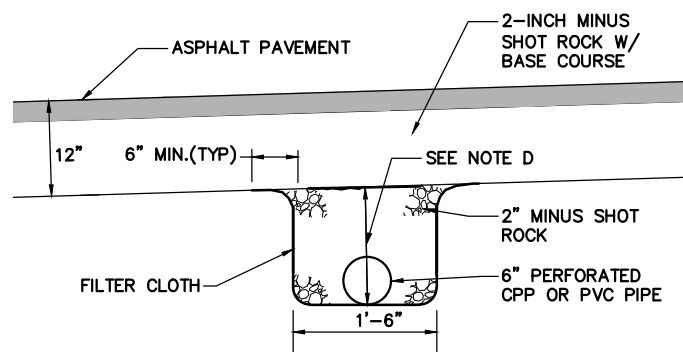

**5**  
**6**  
**6\"/>**

- A. 6-INCH UNDERDRAIN IS A CONTINGENCY ITEM. THE ACTUAL LENGTHS AND LOCATIONS, IF USED SHALL BE AS DETERMINED BY THE ENGINEER.
- B. OUTFALL CONNECTIONS WILL BE EITHER INTO CATCH BASINS, OR CPP SADDLE TEES.
- C. UPPER END OF PIPES SHALL BE CAPPED AND THE FILTER CLOTH FOLDED AND OVERLAPPED TO SEAL END OF DRAINAGE ROCK SECTION. VARIES AS DIRECTED BY THE ENGINEER.
- D. EXACT DEPTH AS DETERMINED BY THE ENGINEER UP TO A MAXIMUM OF 5 FEET.
- E. MINIMUM PIPE GRADIENT SHALL BE 1%.

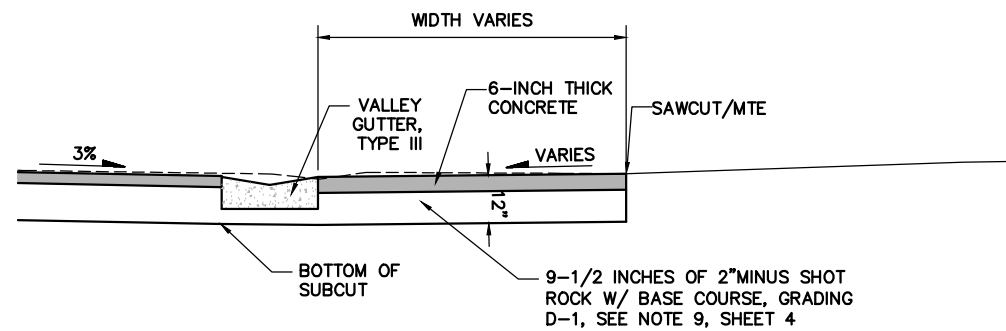

**2**  
**6**  
**DRIVEWAY TIE-IN 6-INCH THICK CONCRETE**  
NTS

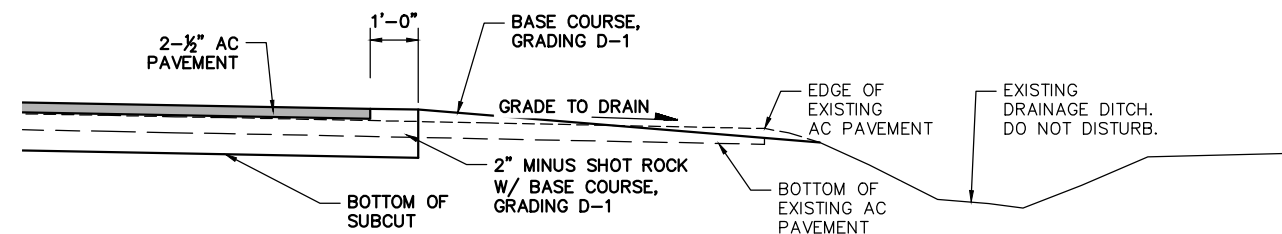

- NOTES:**
1. BASE COURSE, GRADING D-1 SHALL BE BE PAID FOR UNDER PAY ITEM NUMBER 2204.1 - 2-INCH MINUS SHOT ROCK W/ BASE COURSE.

**3**  
**6**  
**DRIVEWAY TIE-IN 2-1/2\"/>**

**4**  
**6**  
**GRAVEL SHOULDER IN CUL DE SAC**  
NTS

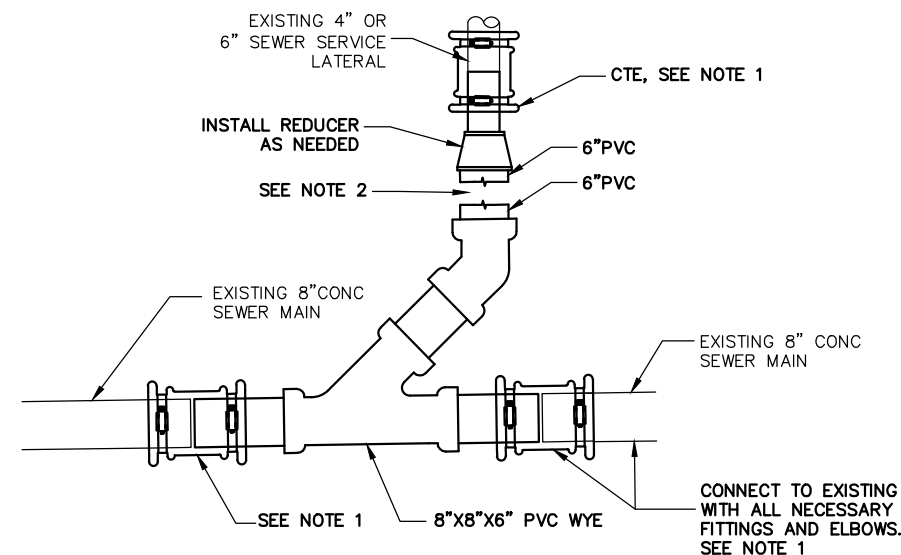

**6**  
**6**  
**REPAIR DETAIL FOR SANITARY SEWER LATERAL CONNECTION TO MAIN**  
NTS

- NOTES:**
1. ALL PIPE CONNECTIONS THAT CANNOT BE MADE WITH 8\"/>

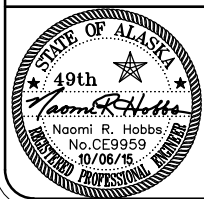

Consulting Engineers • Land Surveyors • Construction Administration

5368 Commercial Blvd.  
Juneau, Alaska 99801  
(907) 780-3533 Office  
(907) 780-3535 Fax

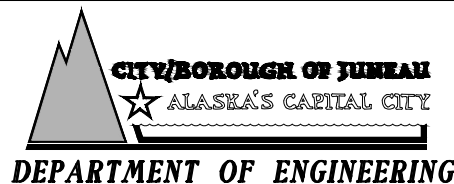

**MEADOW LANE DRAINAGE IMPROVEMENTS**  
**CONTRACT NO. E16-073**

**DETAILS**

SHEET NO.  
**6**  
of  
**14**

1. STATIONS, OFFSETS, ELEVATIONS AND CURVE INFORMATION ALONG CURBING ARE TO TOP BACK OF CURB (TBC), UNLESS OTHERWISE NOTED. TOP OF PAVEMENT ARE TP. TOP OF SIDEWALK ARE TSW. TOP BACK OF VALLEY GUTTER ARE TBG.
2. SEE TYPICAL SECTIONS FOR OTHER GRADING INFORMATION.
3. ESTABLISH VERTICAL CURVES AS NECESSARY FOR A SMOOTH ALIGNMENT (NO ANGLE POINTS) BY VISUALLY ALIGNING TOP OF CURB THROUGH VERTICAL CONTROL POINTS.
4. ALL FORMS FOR SEGMENTS BETWEEN PC'S AND PT'S WITH A RADIUS OF LESS THAN 200 FEET SHALL BE ARCHED TO MATCH REQUIRED CURVATURE. NO STRAIGHT FORMS SHALL BE USED WITHIN THE CURVED SEGMENTS WITH A RADIUS OF LESS THAN 200 FEET.
5. THE CONTRACTOR SHALL PERFORM A CLOSED LEVEL LOOP THROUGH TBM's AS LISTED TO VERIFY ELEVATIONS BEFORE BEGINNING ANY GRADING WORK.
6. SLOPES SHOWN DEPICT GENERAL FLOW DIRECTION ONLY AND SHOULD NOT BE USED TO ESTABLISH INTERMEDIATE LAYOUT POINTS. LAYOUT INFORMATION PROVIDED FOR CENTERLINE AND CURB AND GUTTER SHALL GOVERN.
7. ADJUST CURBING ALIGNMENT AT CONNECTIONS TO EXISTING CURBING AS REQUIRED FOR A TANGENT ALIGNMENT MATCH.

## VERTICAL CONTROL



CURVE No.	LENGTH	RADIUS	DELTA	CHORD BEARING	CHORD LENGTH
C1	22.41	48.00	26°44'55"	N23° 47' 28"W	22.21
C2	112.03	259.00	24°47'00"	N1° 58' 30"E	111.16



5368 Commercial Blvd.  
Juneau, Alaska 99801  
(907) 780-3533 Office  
(907) 780-3535 Fax



## HORIZONTAL AND VERTICAL CONTROL CURB AND GUTTER LAYOUT AND GRADES STIKINE STREET TO STA "M" 12+50

7  
of  
14



C:\Civil\_3D\Projects\22\70633-03\Civil\MCI4-CT-GR-70633.03.dwg 2015-10-6 12:50:12

MATCHLINE STA "M" 12+50

STA "M" 12+88.13  
11.00' LT  
EL=27.24 TBC

CONTROL POINT "DOWL-3"  
N: 5250.58 E: 4496.93

PT STA "M" 13+27.03  
11.00' LT  
EL=27.01 BEGIN TBG

STA "M" 12+88.13  
0.00'  
EL=27.09 TP

STA "M" 12+88.13  
11.00' RT  
EL=26.82 TBC

PT STA "M" 13+27.03  
N: 5254.98 E: 4512.35  
EL=27.28 TP

PT STA "M" 13+27.03  
11.00' RT  
EL=27.01 TBG

STA "M" 14+50.00  
11.00' LT  
EL=27.65 TBG

STA "M" 14+50.00  
0.00'  
EL=27.92 TP

STA "M" 14+50.00  
11.00' RT  
EL=27.65 TBG

MEADOW LANE

MATCHLINE STA "M" 15+25

#### NOTES

1. STATIONS, OFFSETS, ELEVATIONS AND CURVE INFORMATION ALONG CURBING ARE TO TOP BACK OF CURB (TBC), UNLESS OTHERWISE NOTED. TOP OF PAVEMENT ARE TP. TOP OF SIDEWALK ARE TSW. TOP BACK OF VALLEY GUTTER ARE TBG.
2. SEE TYPICAL SECTIONS FOR OTHER GRADING INFORMATION.
3. ESTABLISH VERTICAL CURVES AS NECESSARY FOR A SMOOTH ALIGNMENT (NO ANGLE POINTS) BY VISUALLY ALIGNING TOP OF CURB THROUGH VERTICAL CONTROL POINTS.
4. ALL FORMS FOR SEGMENTS BETWEEN PC'S AND PT'S WITH A RADIUS OF LESS THAN 200 FEET SHALL BE ARCHED TO MATCH REQUIRED CURVATURE. NO STRAIGHT FORMS SHALL BE USED WITHIN THE CURVED SEGMENTS WITH A RADIUS OF LESS THAN 200 FEET.
5. THE CONTRACTOR SHALL PERFORM A CLOSED LEVEL LOOP THROUGH TBMs AS LISTED TO VERIFY ELEVATIONS BEFORE BEGINNING ANY GRADING WORK.
6. SLOPES SHOWN DEPICT GENERAL FLOW DIRECTION ONLY AND SHOULD NOT BE USED TO ESTABLISH INTERMEDIATE LAYOUT POINTS. LAYOUT INFORMATION PROVIDED FOR CENTERLINE AND CURB AND GUTTER SHALL GOVERN.
7. ADJUST CURBING ALIGNMENT AT CONNECTIONS TO EXISTING CURBING AS REQUIRED FOR A TANGENT ALIGNMENT MATCH.

#### VERTICAL CONTROL

TBM No.	ELEVATION	DESCRIPTION
A	26.28	MAG NAIL IN CENTER OF 6-INCH CONCRETE BORDER STRIP OF 2563 10- FEET FROM EDGE OF ROAD ALONG NORTH EDGE OF DRIVEWAY.
B	29.91	WEST BOLT OF TOP FLANGE OF EXISTING FIRE HYDRANT BETWEEN 2568 AND 2570.
C	31.22	SOUTHWEST BOLT OF TOP FLANGE ON EXISTING FIRE HYDRANT PRIOR TO THE CUL DE SAC.

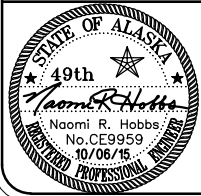
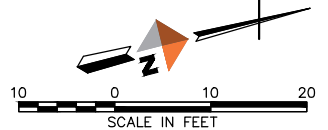

Consulting Engineers • Land Surveyors • Construction Administration

5368 Commercial Blvd.  
Juneau, Alaska 99801  
(907) 780-3533 Office  
(907) 780-3535 Fax

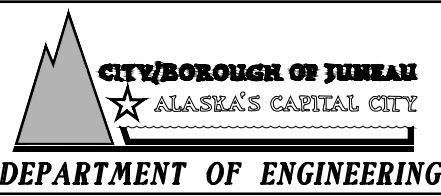

MEADOW LANE DRAINAGE  
IMPROVEMENTS  
CONTRACT NO. E16-073

HORIZONTAL AND VERTICAL CONTROL  
CURB AND GUTTER LAYOUT AND GRADES  
STA "M" 12+50 TO STA "M" 15+25

SHEET NO.

8  
of  
14

C:\Civil\_3D\Projects\22\70633-03\Civil\MC14-CT-GR-70633.03.dwg 2015-10-6 12:50:16

MATCHLINE STA "M" 15+25

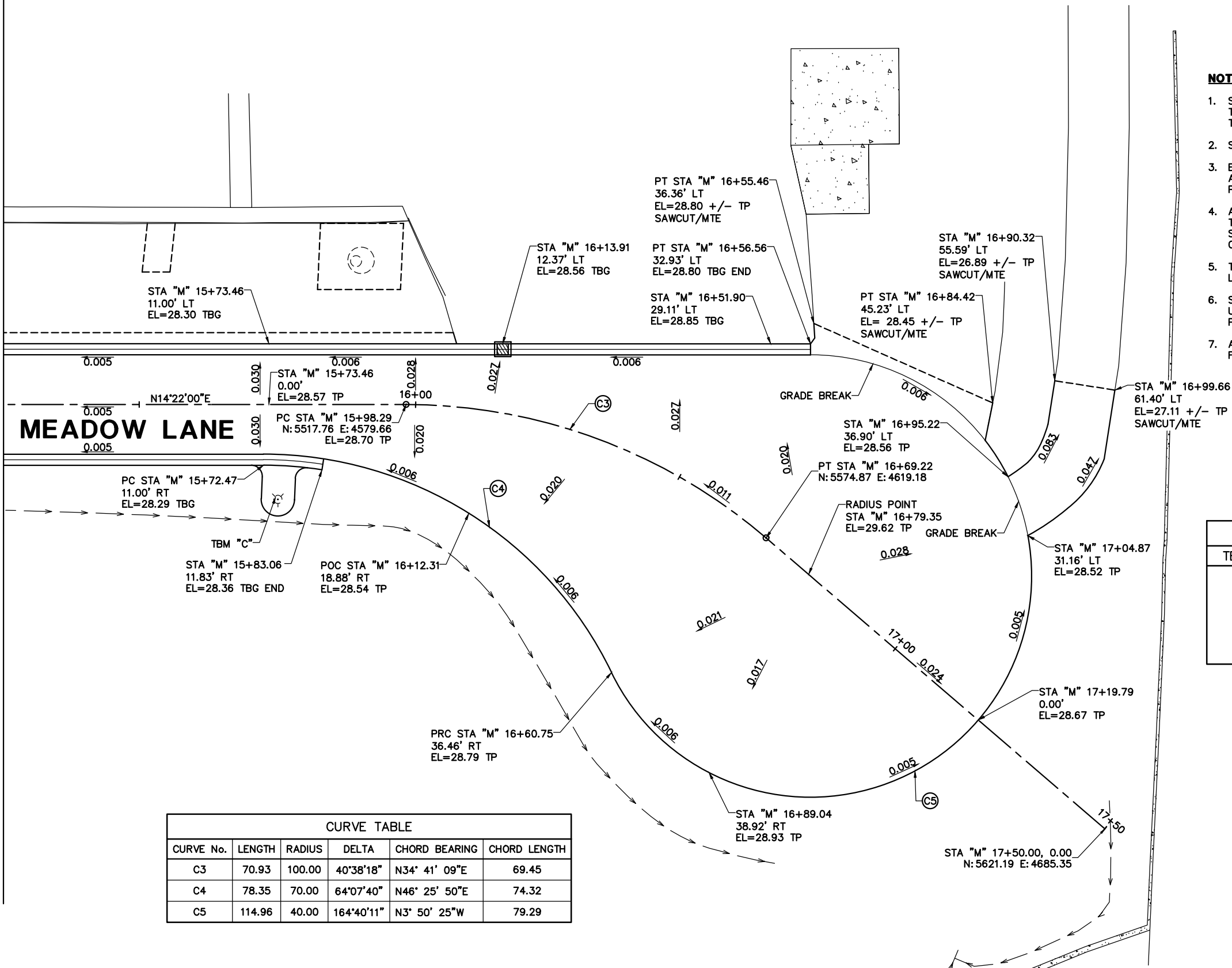

#### NOTES

1. STATIONS, OFFSETS, ELEVATIONS AND CURVE INFORMATION ALONG CURBING ARE TO TOP BACK OF CURB (TBC), UNLESS OTHERWISE NOTED. TOP OF PAVEMENT ARE TP. TOP OF SIDEWALK ARE TSW. TOP BACK OF VALLEY GUTTER ARE TBG.
2. SEE TYPICAL SECTIONS FOR OTHER GRADING INFORMATION.
3. ESTABLISH VERTICAL CURVES AS NECESSARY FOR A SMOOTH ALIGNMENT (NO ANGLE POINTS) BY VISUALLY ALIGNING TOP OF CURB THROUGH VERTICAL CONTROL POINTS.
4. ALL FORMS FOR SEGMENTS BETWEEN PC'S AND PT'S WITH A RADIUS OF LESS THAN 200 FEET SHALL BE ARCHED TO MATCH REQUIRED CURVATURE. NO STRAIGHT FORMS SHALL BE USED WITHIN THE CURVED SEGMENTS WITH A RADIUS OF LESS THAN 200 FEET.
5. THE CONTRACTOR SHALL PERFORM A CLOSED LEVEL LOOP THROUGH TBMs AS LISTED TO VERIFY ELEVATIONS BEFORE BEGINNING ANY GRADING WORK.
6. SLOPES SHOWN DEPICT GENERAL FLOW DIRECTION ONLY AND SHOULD NOT BE USED TO ESTABLISH INTERMEDIATE LAYOUT POINTS. LAYOUT INFORMATION PROVIDED FOR CENTERLINE AND CURB AND GUTTER SHALL GOVERN.
7. ADJUST CURBING ALIGNMENT AT CONNECTIONS TO EXISTING CURBING AS REQUIRED FOR A TANGENT ALIGNMENT MATCH.

#### VERTICAL CONTROL

TBM No.	ELEVATION	DESCRIPTION
A	26.28	MAG NAIL IN CENTER OF 6-INCH CONCRETE BORDER STRIP OF 2563 10- FEET FROM EDGE OF ROAD ALONG NORTH EDGE OF DRIVEWAY.
B	29.91	WEST BOLT OF TOP FLANGE OF EXISTING FIRE HYDRANT BETWEEN 2568 AND 2570.
C	31.22	SOUTHWEST BOLT OF TOP FLANGE ON EXISTING FIRE HYDRANT PRIOR TO THE CUL DE SAC.

#### CURVE TABLE

CURVE No.	LENGTH	RADIUS	DELTA	CHORD BEARING	CHORD LENGTH
C3	70.93	100.00	40°38'18"	N34° 41' 09"E	69.45
C4	78.35	70.00	64°07'40"	N46° 25' 50"E	74.32
C5	114.96	40.00	164°40'11"	N3° 50' 25"W	79.29

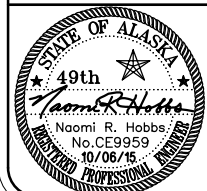
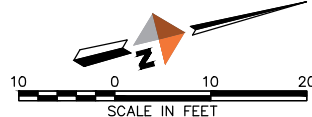

**DOWL**  
Consulting Engineers • Land Surveyors • Construction Administration  
5368 Commercial Blvd.  
Juneau, Alaska 99801  
(907) 780-3533 Office  
(907) 780-3535 Fax  
JOB No. J70633.03 DRAWN BY: STAFF DESIGNED BY: R. STEPHENS CHECKED BY: STAFF DATE: OCT 2015

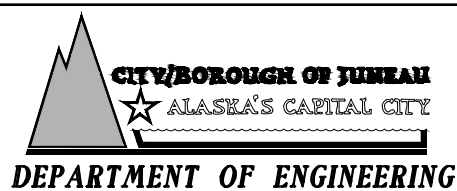

### MEADOW LANE DRAINAGE IMPROVEMENTS CONTRACT NO. E16-073

### HORIZONTAL AND VERTICAL CONTROL CURB AND GUTTER LAYOUT AND GRADES STA "M" 15+25 TO EOP

NOTES

1. PROVIDE ALL ADAPTERS, ELBOWS AND OTHER FITTINGS NECESSARY TO CONNECT TO DISSIMILAR PIPE SIZES, MATERIALS AND DEPTHS. CONNECT TO EXISTING.
2. PIPE LENGTHS ARE MEASURED ALONG THE SLOPE, FROM CENTER TO CENTER OF STRUCTURES. SLOPES ARE CALCULATED TO ENDS OF PIPE.
3. REPLACE EXISTING SANITARY SEWER SERVICE LATERAL FROM SEWER MAIN TO PROPERTY LINE WITH NEW 6" PVC SERVICE WITH CLEANOUT PER CBJ STD 213.
4. REPLACE EXISTING STOP AND WASTE VALVE AND VALVE BOX WITH A NEW CURB STOP AND VALVE BOX PER CBJ STD 406A. CONNECT TO EXISTING SERVICE LINE ON EITHER SIDE OF THE NEW CURB STOP. THE CONTRACTOR SHALL CONTACT CBJ WASTEWATER UTILITIES 24 HOURS PRIOR TO REPLACEMENT TO COORDINATE FREEZING OF THE WATER SERVICE.
5. LOCATIONS OF SEWER SERVICE LATERALS ARE APPROXIMATE. SOME LOCATIONS ARE TAKEN FROM CBJ WASTEWATER UTILITY CAMERA NOTES. COORDINATE WITH CBJ WASTEWATER UTILITIES TO LOCATE THE SERVICES.
6. REMOVE AND DISPOSE OF EXISTING STREET LIGHT ASSEMBLY AND BASE. INSTALL A NEW STREET LIGHT ASSEMBLY AND BASE PER CBJ STD DETAIL 118 AND PROJECT SPECIFICATIONS.

CB-1 TYPE I	
STA "M" 10+70.3, MATCH CURB	
FG	EL=25.57
INV S-1	EL=16.93
INV S-2	EL=21.24
INV S-3	EL=17.01
INV 6" PVC	EL=22.10
SUMP 16" MIN	

2563  
DAVID G & KRISTEEN A GRESS  
MEADOW LN  
LOT 2 FR LOT 3

PIPE SUMMARY - STORM DRAINAGE				
PIPE	DIA	LENGTH	TYPE	SLOPE
S-1	12"	32.4	CPP	0.004
S-2	12"	20.0	CPP	0.032
S-3	12"	170.2	CPP	0.028
S-4	12"	19.75	CPP	0.053
S-5	12"	50.3	CPP	0.010
SEE NOTE 2				

MH-1, EXISTING TYPE I	
STA "M" 10+23.0, 7.5 LT	
EXISTING COVER	EL=25.36
INV EXISTING 8" CONC (IN)	EL=18.13
INV EXISTING 8" CONC (IN)	EL=18.16
INV EXISTING 8" CONC (OUT)	EL=17.92

2565  
TIMOTHY D BIRT &  
JOANN S CAMERON  
MEADOW LN  
FR LOT 3  
723-0545

CB-3 TYPE IV	
STA "M" 12+39.6, MATCH CURB	
FG	EL=26.46
INV S-3	EL=21.65
INV S-4	EL=21.73
INV S-5	EL=21.73
INV 6" PVC	EL=21.73
SUMP 16" MIN	

2567  
MARY LEE ELLIS  
MEADOW LN  
LOT 4  
789-9260

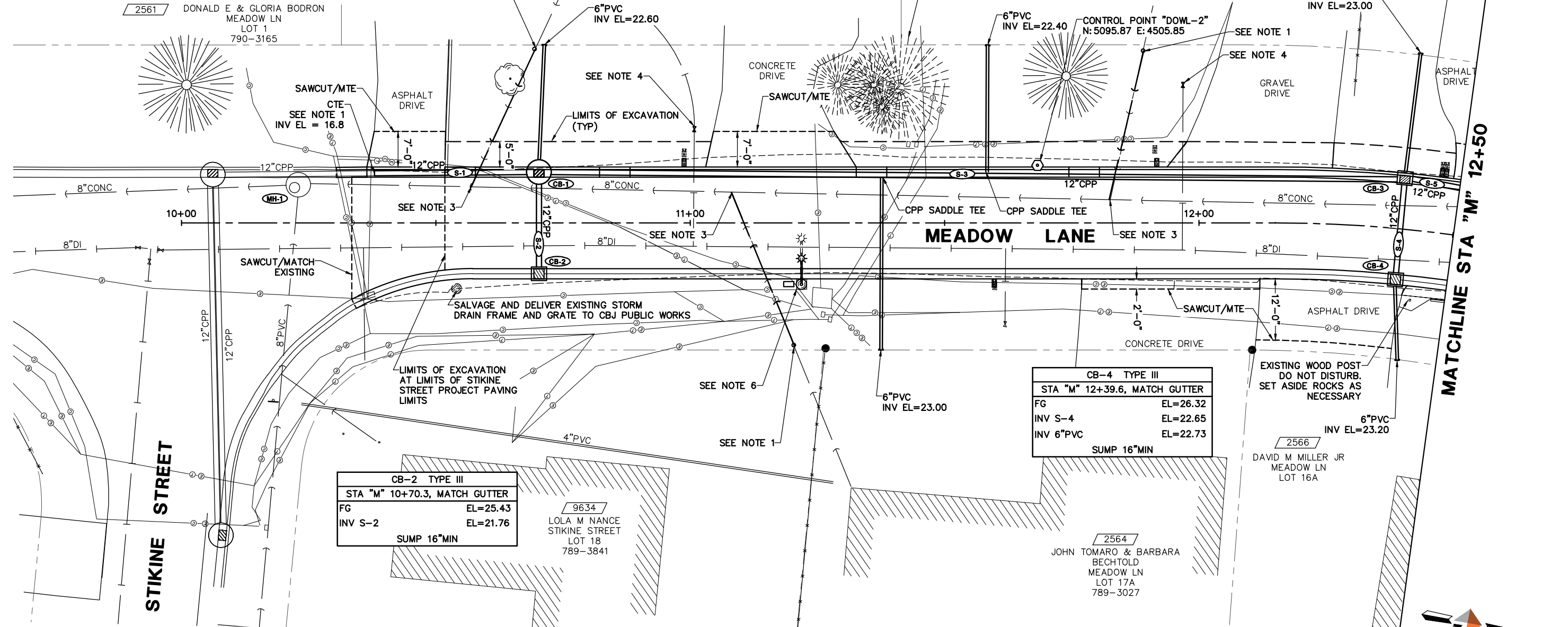

CB-2 TYPE III	
STA "M" 10+70.3, MATCH GUTTER	
FG	EL=25.43
INV S-2	EL=21.76
SUMP 16" MIN	

9634  
LOLA M NANCE  
STIKINE STREET  
LOT 18  
789-3841

CB-4 TYPE III	
STA "M" 12+39.6, MATCH GUTTER	
FG	EL=26.32
INV S-4	EL=22.65
INV 6" PVC	EL=22.73
SUMP 16" MIN	

2566  
DAVID M MILLER JR  
MEADOW LN  
LOT 16A

2564  
JOHN TOMARO & BARBARA  
BECHTOLD  
MEADOW LN  
LOT 17A  
789-3027

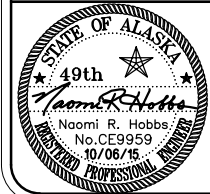

Consulting Engineers • Land Surveyors • Construction Administration

JOB No. J70633.03 DRAWN BY: STAFF DESIGNED BY: R. STEPHENS CHECKED BY: STAFF DATE: OCT 2015

5368 Commercial Blvd.  
Juneau, Alaska 99801  
(907) 780-3533 Office  
(907) 780-3535 Fax



DEPARTMENT OF ENGINEERING

MEADOW LANE DRAINAGE  
IMPROVEMENTS  
CONTRACT NO. E16-073

PLAN - MEADOW LANE  
STIKINE STREET TO STA "M" 12+50

SHEET NO.

10  
of  
14



C:\Civil\_3D\Projects\22\70633-03\Civil\MC14-CT-BA-70633.03.dwg 2015-10-6 12:51:21

PIPE SUMMARY - STORM DRAINAGE				
PIPE	DIA	LENGTH	TYPE	SLOPE
S-5	SEE SHEET 10			
S-6	12"	163.3	CPP	0.005
S-7	12"	20.1	CPP	0.034
S-8	12"	165.8	CPP	0.005
SEE NOTE 2				

MH-2, EXISTING TYPE I	
STA "M" 13+21.4, 25.2 LT	
EXISTING COVER	EL=27.12
INV EXISTING 8"CONC (IN)	EL=20.52
INV EXISTING 8"CONC (OUT)	EL=20.45

CB-5 TYPE IV	
STA "M" 12+88.1, MATCH GUTTER	
FG	EL=26.70
INV S-5	EL=22.20
INV S-6	EL=22.28
SUMP 16"MIN	

CB-6 TYPE IV	
STA "M" 14+50.0, MATCH GUTTER	
FG	EL=27.42
INV S-6	EL=23.08
INV S-7	EL=23.16
INV S-8	EL=23.16
INV 6"PVC	EL=23.16
SUMP 16"MIN	

CB-7 TYPE III	
STA "M" 14+50.0, MATCH GUTTER	
FG	EL=27.42
INV S-7	EL=23.75
INV 6"PVC	EL=23.83
SUMP 16"MIN	

#### NOTES

1. PROVIDE ALL ADAPTERS, ELBOWS AND OTHER FITTINGS NECESSARY TO CONNECT TO DISSIMILAR PIPE SIZES, MATERIALS AND DEPTHS. CONNECT TO EXISTING.
2. PIPE LENGTHS ARE MEASURED ALONG THE SLOPE, FROM CENTER TO CENTER OF STRUCTURES. SLOPES ARE CALCULATED TO ENDS OF PIPE.
3. REPLACE EXISTING SANITARY SEWER SERVICE LATERAL FROM SEWER MAIN TO PROPERTY LINE WITH NEW 6"PVC SERVICE WITH CLEANOUT PER CBJ STD 213.
4. CLEAN AND REPAINT EXISTING FIRE HYDRANT. INSTALL STORZ FITTING. ADJUST VALVE BOX TO GRADE.
5. REPLACE EXISTING STOP AND WASTE VALVE AND VALVE BOX WITH A NEW CURB STOP AND VALVE BOX PER CBJ STD 406A. CONNECT TO EXISTING SERVICE LINE ON EITHER SIDE OF THE NEW CURB STOP. THE CONTRACTOR SHALL CONTACT CBJ WATER UTILITIES 24 HOURS PRIOR TO REPLACEMENT TO COORDINATE FREEZING THE WATER SERVICE.
6. LOCATIONS OF SEWER SERVICE LATERALS ARE APPROXIMATE. SOME LOCATIONS ARE TAKEN FROM CBJ WASTEWATER UTILITY CAMERA NOTES. COORDINATE WITH CBJ WASTEWATER UTILITIES TO LOCATE THE SERVICES.
7. REPAIR HOLE IN EXISTING SANITARY SEWER MAIN USING LSS-1 NON-SHEAR COUPLERS. LOCATION OF REPAIR IS APPROXIMATELY 28.8 FT DOWN STREAM FROM MH-2.
8. REMOVE PLANTER. SET ASIDE BRICKS FOR HOMEOWNER. DISPOSE OF PLANTINGS WITHIN PLANTER. GRADE AREA TO MATCH THE REST OF THE YARD.
9. PROVIDE ACCESS FOR SCHOOL BUSES TO THIS RESIDENCE AT ALL TIMES UNTIL THE END OF THE SCHOOL YEAR.
10. STRAIGHTEN THE EXISTING VALVE BOX. VERIFY WHETHER OR NOT THE EXISTING SERVICE VALVE IS A STOP AND WASTE VALVE. IF THE VALVE IS A STOP AND WASTE VALVE REPLACE IT PER NOTE 5.
11. REMOVE AND DISPOSE OF EXISTING STREET LIGHT ASSEMBLY AND BASE. INSTALL A NEW STREET LIGHT ASSEMBLY AND BASE PER CBJ STD DETAIL 118 AND PROJECT SPECIFICATIONS.

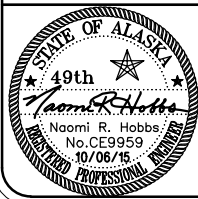

Consulting Engineers • Land Surveyors • Construction Administration

JOB No. J70633.03 DRAWN BY: STAFF DESIGNED BY: R. STEPHENS CHECKED BY: STAFF DATE: OCT 2015

5368 Commercial Blvd.  
Juneau, Alaska 99801  
(907) 780-3533 Office  
(907) 780-3535 Fax

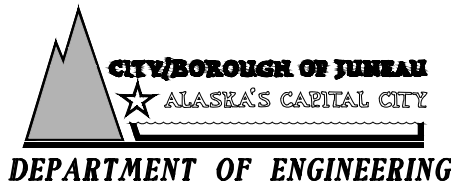

## MEADOW LANE DRAINAGE IMPROVEMENTS CONTRACT NO. E16-073

## PLAN - MEADOW LANE STA "M" 12+50 TO STA "M" 15+25

SHEET NO.

11  
of  
14

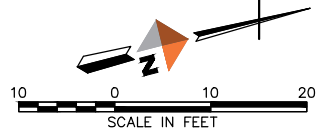

C:\Civil\_3D\Projects\22\70633-03\Civil\MC14-CT-BA-70633.03.dwg 2015-10-6 12:51:27

MATCHLINE STA "M" 15+25

2575  
GARY PAUL & ROBIN HERDMAN  
MEADOW LN  
LOT 7  
586-3632

CB-8 TYPE IV	
STA "M" 16+13.9, 12.4 LT MATCH GUTTER	
FG	EL=28.33
INV S-8	EL=23.97
INV 6"PVC	EL=24.05
INV 6"PVC	EL=24.05
SUMP 16"MIN	

MH-3, TYPE I	
STA "M" 15+90.1, 26.1 LT	
FG	EL=28.25
EXISTING COVER	EL=28.50
INV EXISTING 8"CONC (OUT)	EL=23.07

2577  
JANIE M CESAR  
MEADOW LN  
LOT 8  
789-7620  
(NANCI MAKI)

#### NOTES

1. PROVIDE ALL ADAPTERS, ELBOWS AND OTHER FITTINGS NECESSARY TO CONNECT TO DISSIMILAR PIPE SIZES, MATERIALS AND DEPTHS. CONNECT TO EXISTING.
2. PIPE LENGTHS ARE MEASURED ALONG THE SLOPE, FROM CENTER TO CENTER OF STRUCTURES. SLOPES ARE CALCULATED TO ENDS OF PIPE.
3. REPLACE EXISTING SANITARY SEWER SERVICE LATERAL FROM SEWER MAIN TO PROPERTY LINE WITH NEW 6"PVC SERVICE WITH CLEANOUT PER CBJ STD 213.
4. REPLACE EXISTING STOP AND WASTE VALVE AND VALVE BOX WITH A NEW CURB STOP AND VALVE BOX PER CBJ STD 406A. CONNECT TO EXISTING SERVICE LINE ON EITHER SIDE OF THE NEW CURB STOP. THE CONTRACTOR SHALL CONTACT CBJ WATER UTILITIES 24 HOURS PRIOR TO REPLACEMENT TO COORDINATE FREEZING OF THE WATER SERVICE.
5. REMOVE AND REPLACE EXISTING HYDRANT AND HYDRANT LEG TO MAIN WITH A NEW FIRE HYDRANT ASSEMBLY PER CBJ STD 403. SALVAGE THE EXISTING HYDRANT AND 6-INCH GATE VALVE AND RETURN TO CBJ WATER UTILITIES. INSTALL NEW HYDRANT GUARD POSTS AND HYDRANT PAD. REUSE EXISTING 8"x8"x6" TEE.
6. LOCATIONS OF SEWER SERVICE LATERALS ARE APPROXIMATE. SOME LOCATIONS ARE TAKEN FROM CBJ WASTEWATER UTILITY CAMERA NOTES. COORDINATE WITH CBJ WASTEWATER UTILITIES TO LOCATE THE SERVICES.

MEADOW LANE

GLACIER HIGHWAY

PIPE SUMMARY - STORM DRAINAGE				
PIPE	DIA	LENGTH	TYPE	SLOPE
S-8		SEE SHEET 11		
S-9	12"	35.8	CPP	0.105
SEE NOTE 2				

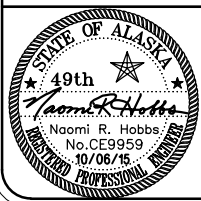
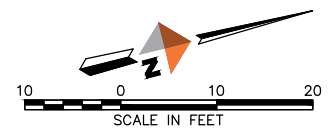

Consulting Engineers • Land Surveyors • Construction Administration

5368 Commercial Blvd.  
Juneau, Alaska 99801  
(907) 780-3533 Office  
(907) 780-3535 Fax

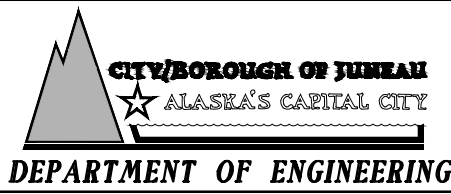

MEADOW LANE DRAINAGE  
IMPROVEMENTS  
CONTRACT NO. E16-073

PLAN - MEADOW LANE  
STA "M" 15+25 TO EOP

SHEET NO.

12  
of  
14

JOB No. J70633.03 DRAWN BY: STAFF DESIGNED BY: R. STEPHENS CHECKED BY: STAFF DATE: OCT 2015



C:\Civil 3D Projects\22\70633-03\Civil\SC14-CT-PR-70633.03.dwg 2015-10-6 12:52:27

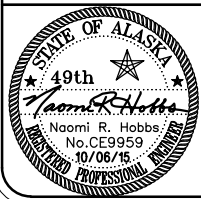
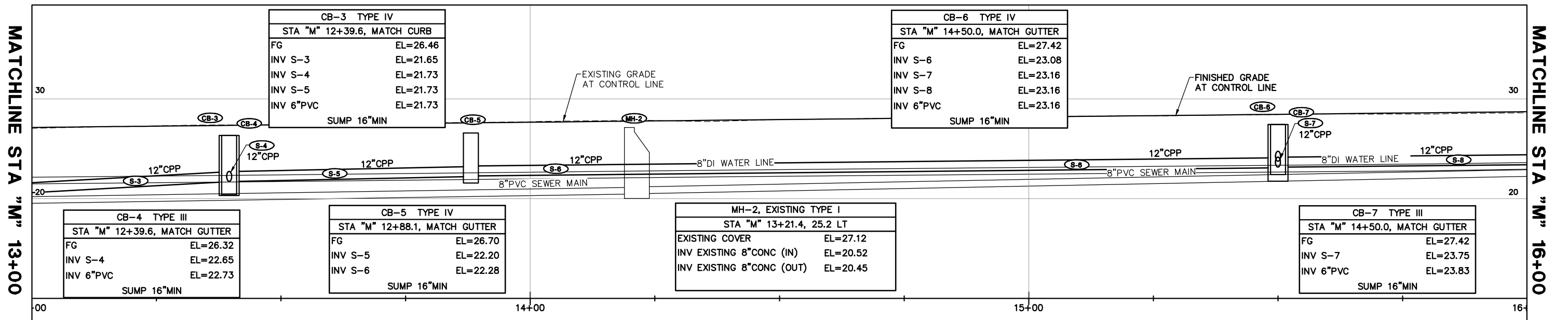
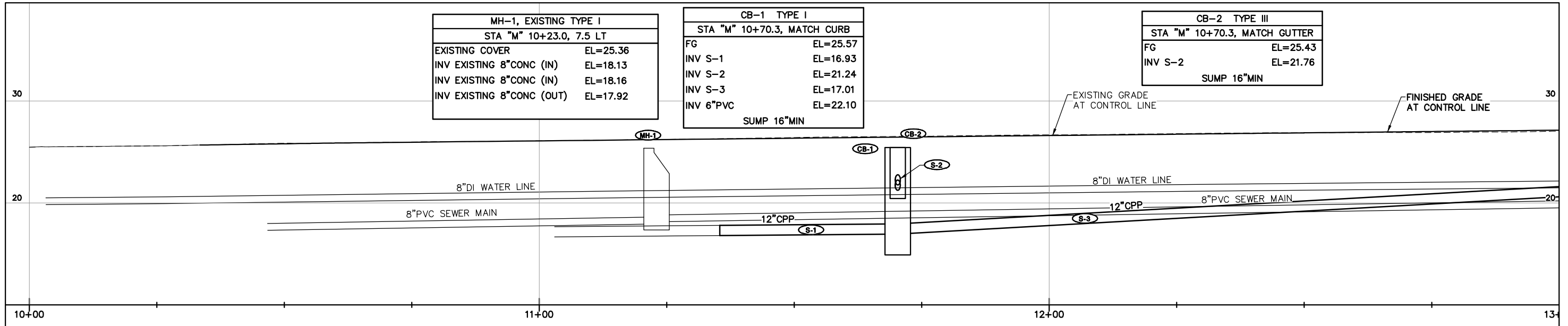

Consulting Engineers • Land Surveyors • Construction Administration

5368 Commercial Blvd.  
Juneau, Alaska 99801  
(907) 780-3533 Office  
(907) 780-3535 Fax

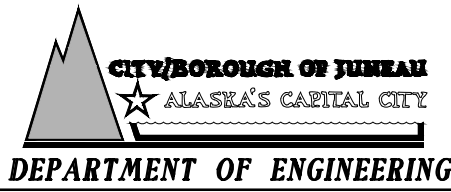

**MEADOW LANE DRAINAGE  
IMPROVEMENTS  
CONTRACT NO. E16-073**

**PROFILE - MEADOW LANE  
STIKINE STREET TO STA "M" 16+00**

SHEET NO.

**13  
of  
14**

C:\Civil\_3D\Projects\22\70633-03\Civil\SC14-CT-PR-70633.03.dwg 2015-10-6 12:52:31

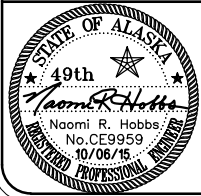
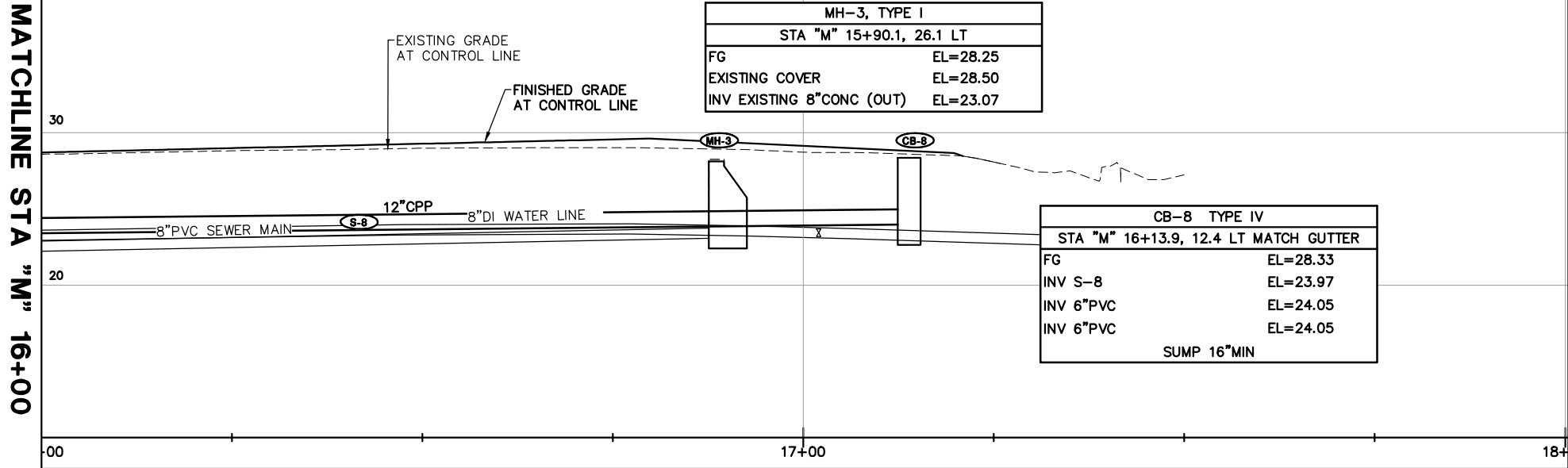

Consulting Engineers • Land Surveyors • Construction Administration

JOB No. J70633.03 | DRAWN BY: STAFF | DESIGNED BY: R. STEPHENS | CHECKED BY: STAFF | DATE: OCT 2015

5368 Commercial Blvd.  
Juneau, Alaska 99801  
(907) 780-3533 Office  
(907) 780-3535 Fax

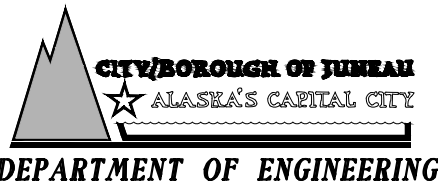

**MEADOW LANE DRAINAGE  
IMPROVEMENTS  
CONTRACT NO. E16-073**

**PROFILE - MEADOW LANE  
STA "M" 16+00 TO EOP**

SHEET NO.

**14  
of  
14**