

CITY AND BOROUGH OF JUNEAU DOWNTOWN SEAWALK BRIDGE TO GOLD CREEK

217 SECOND STREET, SUITE 207
JUNEAU, AK 99801
MAIN: (907) 586-6400 FAX: (907) 463-3677



www.tetrattech.com

PROJECT LOCATION:

EGAN DRIVE
JUNEAU, ALASKA

CLIENT INFORMATION:

CITY AND BOROUGH OF JUNEAU
ENGINEERING DEPARTMENT
JUNEAU, AK 99801

Tt PROJECT No.:

135-12554-15003

CLIENT PROJECT No.:

E16-011

PROJECT DESCRIPTION / NOTES:

THE PROJECT CONSISTS OF BRIDGE PARK LOCATED ALONG GASTINEAU CHANNEL BETWEEN 8TH AND 9TH STREETS, AND AN EXTENSION OF THE DOWNTOWN JUNEAU SEAWALK FROM THE PARK TO GOLD CREEK. THE PARK INCLUDES A SMALL ACTIVE RECREATION ZONE, A WATER VIEWING PLAZA, WHALE SCULPTURE AND WATER FEATURE, AND A BUS DROP OFF AND VEHICLE PARKING AREA. THE SEAWALK INCLUDES APPROXIMATELY 1000 LF OF PILE-SUPPORTED WALKWAY WITH A 16-FT NOMINAL WIDTH VARYING IN DECK ELEVATION FROM +25 TO +29 ABOVE MLLW. THE SEAWALK ALSO INCLUDES APPROXIMATELY 350 LF OF AT-GRADE BOARDWALK ACROSS AN AREA OF INTERTIDAL FILL CONSTRUCTED TO INCREASE HABITAT DIVERSITY.

ISSUED:

05-22-15: 65% SUBMITTAL
07-03-15: 95% SUBMITTAL
08-12-15: BID DOCUMENTS

VICINITY MAP:

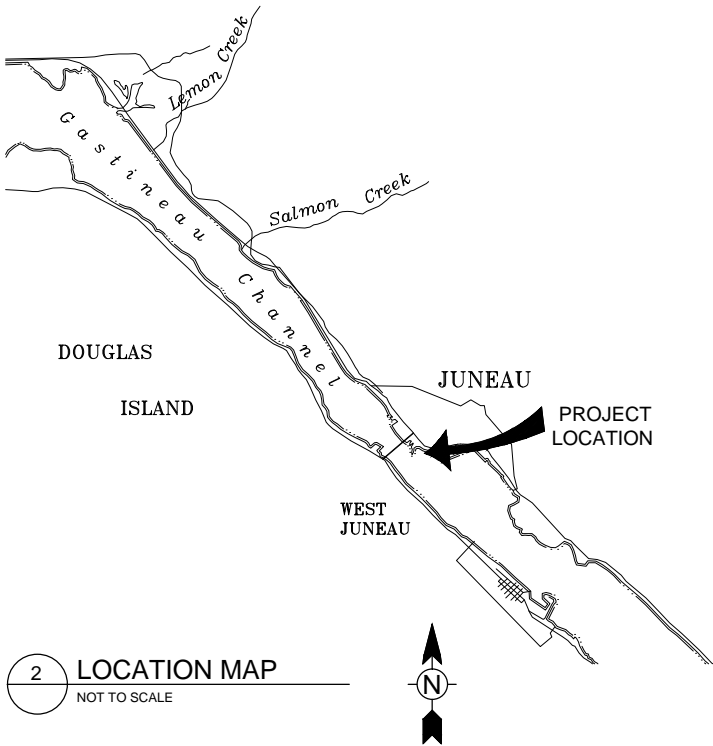

SHEET INDEX

GENERAL

G-000 VICINITY MAP, LOCATION MAP, DRAWING INDEX
G-001 ABBREVIATIONS, REFERENCE, AND GENERAL NOTES
G-002 EXISTING SITE CONDITION SURVEY - BRIDGE TO GOLD CREEK
G-003 ILLUSTRATIVE SITE PLAN - BRIDGE TO GOLD CREEK
G-004 EROSION AND SEDIMENT AND TRAFFIC CONTROL PLAN
G-005 CLEAR AND GRUB

TYPICAL DETAILS AND NOTES

L-000 LANDSCAPE OVERVIEW PLAN
L-001 TYPICAL LANDSCAPE PLANTING DETAILS
L-002 TYPICAL LANDSCAPE PLANTING DETAILS
L-003 LANDSCAPE PLANTING SCHEDULE
L-004 SEED MIXES
S-001 TYPICAL STRUCTURAL NOTES
S-002 TYPICAL STRUCTURAL DETAILS
S-003 TYPICAL STRUCTURAL DETAILS
A-000 OVERVIEW SITE PLAN
A-001 RAILING DETAILS
A-002 RAILING DETAILS
A-003 RAILING DETAILS
A-004 RAILING DETAILS
A-005 RAILING DETAILS
A-006 RAILING DETAILS
A-007 BOAT RAILING DETAILS
E-001 ELECTRICAL LEGEND
E-002 POWER SUPPLY AND DISTRIBUTIONS PLAN - SEAWALK

BRIDGE PARK

CIVIL

C-101 OVERALL SITE DEMOLITION PLAN - BRIDGE PARK
C-102 SITE GRADING AND DRAINAGE - BRIDGE PARK
C-103 OVERALL SITE LAYOUT POINTS - BRIDGE PARK
C-104 OVERALL CIVIL SITE PLAN - BRIDGE PARK
C-105 PAINTING AND STRIPING - BRIDGE PARK
C-131 SITE CIVIL SECTIONS AND DETAILS - BRIDGE PARK
C-132 SITE CIVIL SECTIONS AND DETAILS - BRIDGE PARK
C-151 SITE CIVIL DETAILS - BRIDGE PARK
C-152 SITE CIVIL DETAILS - BRIDGE PARK

LANDSCAPING

L-101 LANDSCAPE MATERIALS PLAN - BRIDGE PARK
L-102 LANDSCAPE PLANTING PLAN - BRIDGE PARK
L-103 LANDSCAPE DETAIL PLAN - UNDERSEA GARDEN
L-104 LANDSCAPE DETAIL PLAN - PARK PLAZA AREA
L-131 LANDSCAPE SECTIONS - BRIDGE PARK
L-132 LANDSCAPE SECTIONS - BRIDGE PARK
L-133 LANDSCAPE SECTIONS - BRIDGE PARK
L-151 LANDSCAPE MATERIALS DETAILS
L-152 LANDSCAPE MATERIALS DETAILS - UNDERSEA GARDEN
L-153 LANDSCAPE MATERIALS DETAILS
L-154 LANDSCAPE MATERIALS DETAILS - PLAZA - WOOD DECKING
L-155 LANDSCAPE MATERIALS DETAILS
L-156 LANDSCAPE MATERIALS DETAILS

STRUCTURAL

S-101 FOUNDATION PLAN - BRIDGE PARK SCULPTURE AND POOL
S-102 TOP PLAN - BRIDGE PARK SCULPTURE AND POOL
S-104 PICNIC SHELTER FLOOR AND ROOF PLANS
S-105 BUS SHELTER FLOOR AND ROOF PLANS
S-131 SCULPTURE AND POOL SECTIONS - BRIDGE PARK
S-132 PICNIC SHELTER SECTIONS
S-133 BUS SHELTER SECTIONS
S-151 BRIDGE PARK STRUCTURAL DETAILS
S-152 PICNIC SHELTER DETAILS
S-153 BUS SHELTER DETAILS AND SECTIONS

ARCHITECTURAL

A-101 ENLARGED SITE PLAN - BRIDGE PARK
A-102 PICNIC SHELTER FLOOR AND ROOF PLANS
A-103 BUS SHELTER FLOOR AND ROOF PLANS AND ELEVATIONS
A-104 BRIDGE ABUTMENT GUARDRAIL PLAN
A-131 PICNIC SHELTER ELEVATIONS AND SECTIONS
A-151 PICNIC / BUS SHELTER DETAILS
A-152 PICNIC / BUS SHELTER DETAILS

PIPING

P-101 LOWER LEVEL PIPING PLAN - BRIDGE PARK SCULPTURE AND POOL
P-102 UPPER LEVEL PIPING PLAN - BRIDGE PARK SCULPTURE AND POOL
P-151 PIPING DETAILS - BRIDGE PARK SCULPTURE AND POOL

ELECTRICAL

E-101 SITE POWER AND LIGHTING - BRIDGE PARK
E-102 ENLARGED PLANS - BUS SHELTER AND PICNIC SHELTER LIGHTING
E-151 LIGHTING SCHEDULES AND DETAILS - BRIDGE PARK
E-152 DETAILS - BRIDGE PARK

SEAWALK

CIVIL

C-201 SITE LAYOUT - HABITAT ISLAND CORE
C-202 SITE LAYOUT - HABITAT ISLAND FINAL SURFACE
C-203 SITE LAYOUT & GRADING - SEAWALK EAST / EGAN DRIVE CONNECTION
C-204 SITE PLAN - COVE BEACH ACCESS
C-205 SITE PLAN - WEST EIGHT STREET ACCESS
C-231 SITE CIVIL SECTIONS - SEAWALK
C-232 SITE CIVIL SECTIONS - SEAWALK
C-251 SITE CIVIL SECTION DETAILS - SEAWALK

LANDSCAPING

L-201 LANDSCAPE MATERIALS PLAN - SEAWALK WEST
L-202 LANDSCAPE MATERIALS PLAN - HABITAT ISLAND
L-203 LANDSCAPE MATERIALS PLAN - COVE BEACH
L-204 LANDSCAPE MATERIALS PLAN - SEAWALK EAST
L-205 LANDSCAPE SEEDING PLAN - SEAWALK WEST
L-206 LANDSCAPE SEEDING PLAN - HABITAT ISLAND
L-207 LANDSCAPE SEEDING PLAN - COVE BEACH
L-208 LANDSCAPE PLANTING PLAN - SEAWALK WEST
L-209 LANDSCAPE PLANTING PLAN - HABITAT ISLAND
L-210 LANDSCAPE PLANTING PLAN - COVE BEACH
L-211 LANDSCAPE PLANTING PLAN - SEAWALK EAST
L-231 LANDSCAPE SECTIONS SEAWALK - ISLAND
L-251 LANDSCAPE MATERIALS DETAILS
L-252 LANDSCAPE MATERIALS DETAILS

STRUCTURAL

S-201 STRUCTURAL PLAN - SEAWALK
S-202 STRUCTURAL PARTIAL PLAN - SEAWALK WEST
S-203 STRUCTURAL PARTIAL PLAN - SEAWALK WEST
S-204 STRUCTURAL PARTIAL PLAN - SEAWALK WEST
S-205 STRUCTURAL PARTIAL PLAN - SEAWALK EAST
S-206 STRUCTURAL PARTIAL PLAN - SEAWALK EAST
S-207 STRUCTURAL PARTIAL PLAN - SEAWALK EAST
S-208 STAIR PLAN - SEAWALK WEST
S-231 STRUCTURAL SECTIONS - SEAWALK
S-232 STAIRS SECTIONS - SEAWALK WEST
S-233 STRUCTURAL SECTIONS - SEAWALK
S-251 STRUCTURAL DETAILS - SEAWALK
S-252 FIBERGLASS STAIRS DETAILS AND SECTIONS
S-253 STRUCTURAL DETAILS - SEAWALK
S-258 PILING SCHEDULES AND DETAILS - SEAWALK

ARCHITECTURAL

A-201 ENLARGED SITE PLAN - SEAWALK WEST
A-202 ENLARGED SITE PLAN - SEAWALK WEST
A-203 ENLARGED SITE PLAN - HABITAT ISLAND
A-204 ENLARGED SITE PLAN - SEAWALK EAST
A-205 ENLARGED SITE PLAN - SEAWALK EAST
A-206 ENLARGED SITE PLAN - SEAWALK WEST AND EAST
A-207 ENLARGED SITE PLAN - SEAWALK EAST
A-231 STAIR SECTION - SEAWALK WEST
A-232 BOAT PLAN AND SECTION - SEAWALK WEST
A-251 BOAT DETAILS - SEAWALK WEST
A-252 BOAT DETAILS - SEAWALK WEST

ELECTRICAL

E-201 SITE POWER AND LIGHTING PLAN - SEAWALK
E-202 SITE POWER AND LIGHTING PLAN - SEAWALK
E-203 SITE POWER AND LIGHTING PLAN - SEAWALK
E-204 SITE POWER AND LIGHTING PLAN - SEAWALK
E-205 SITE POWER AND LIGHTING PLAN - SEAWALK
E-206 SITE POWER AND LIGHTING PLAN - SEAWALK
E-251 LUMINAIRE SCHEDULES AND DETAILS - SEAWALK

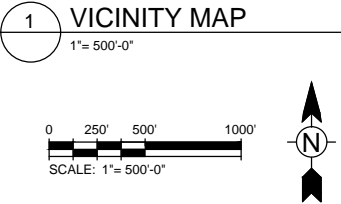
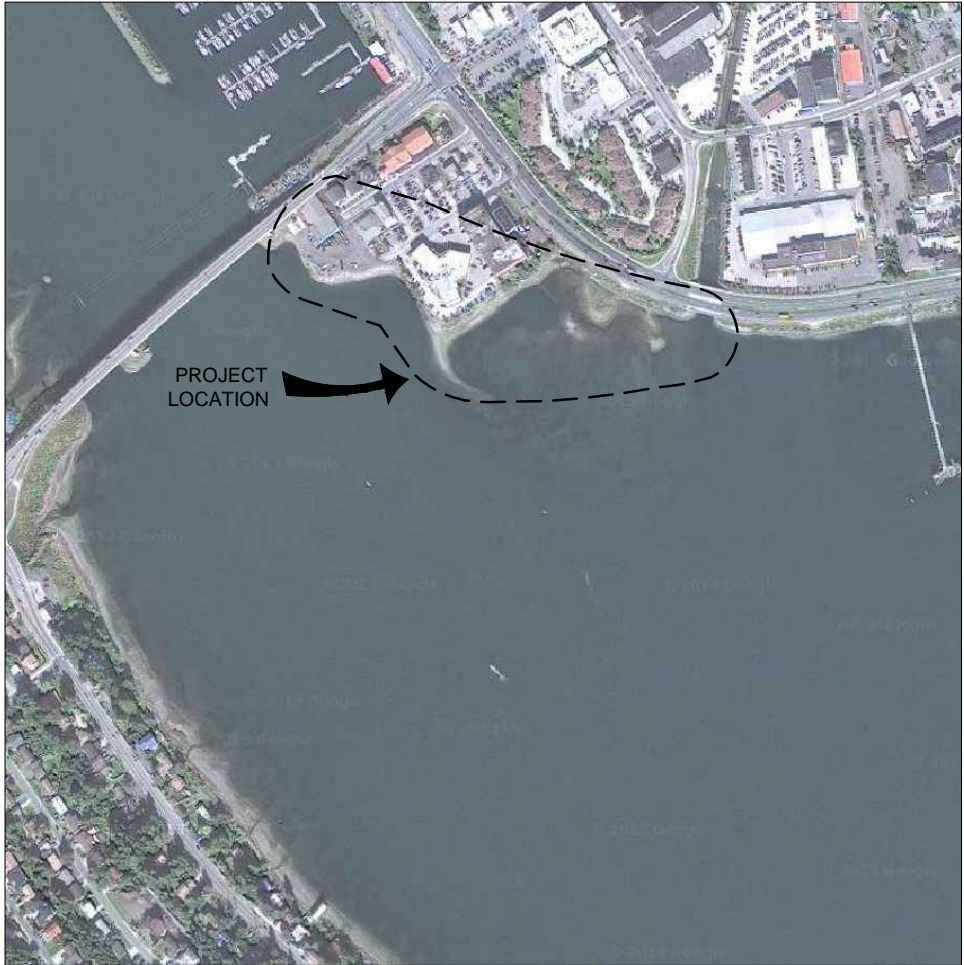

8/12/2015 2:49:18 PM - P:\12554\135-12554-15003\CAD\SHEETFILES\G-001 ABBREVSLEGNOTES.DWG - ONEILL, SEAN

ABBREVIATIONS

AB	ANCHOR BOLT
AC	ASPHALT CEMENT
ADJ	ADJACENT
ALUM	ALUMINUM
APPROX	APPROXIMATELY
BOT	BOTTOM
COL	COLUMN
CONC	CONCRETE
CONT	CONTINUOUS
CPP	CORRUGATED POLYETHYLENE PIPE
DIA	DIAMETER
DIM	DIMENSION
(E)	EXISTING
EL	ELEVATION
ELEC	ELECTRICAL
EQ	EQUAL
EXPAN	EXPANSION
EXST	EXISTING
FEMA	FEDERAL EMERGENCY MANAGEMENT AGENCY
FIXT	FIXTURE
GA	GAUGE
GALV	GALVANIZED
GLAZ	GLAZING
HEX	HEXAGONAL
INV	INVERT
JT	JOINT
LB	POUND
LED	LIGHT-EMITTING DIODE
MAX	MAXIMUM
MIL	ONE THOUSANDTH OF AN INCH
MIN	MINIMUM
MTE	MATCH TO EXISTING
NA	NOT APPLICABLE
NTS	NOT TO SCALE
OC	ON CENTER
OD	OUTSIDE DIAMETER
OFCI	OWNER FURNISHED CONTRACTOR INSTALLED
OFOI	OWNER FURNISHED OWNER INSTALLED
OPP	OPPOSITE
RAD	RADIUS
REF	REFER TO
RH	ROUND HEAD
RSW	REFRIGERATED SEA WATER SYSTEM
SIM	SIMILAR
SQ	SQUARE
SST	STAINLESS STEEL
STL	STEEL
STOR	STORAGE
STRUCT	STRUCTURAL
TBC	TOP BACK OF CURB
TBD	TO BE DETERMINED
THRU	THROUGH
TOW	TOP OF WALL
TRTD	TREATED
TSW	TOP OF SIDEWALK
TYP	TYPICAL
UHMW	ULTRA HIGH MOLECULAR WEIGHT
UNO	UNLESS NOTED OTHERWISE
VG	VERTICAL GRAIN
VIF	VERIFY IN FIELD
W/	WITH
W/O	WITHOUT
WP	WATERPROOF

REFERENCE

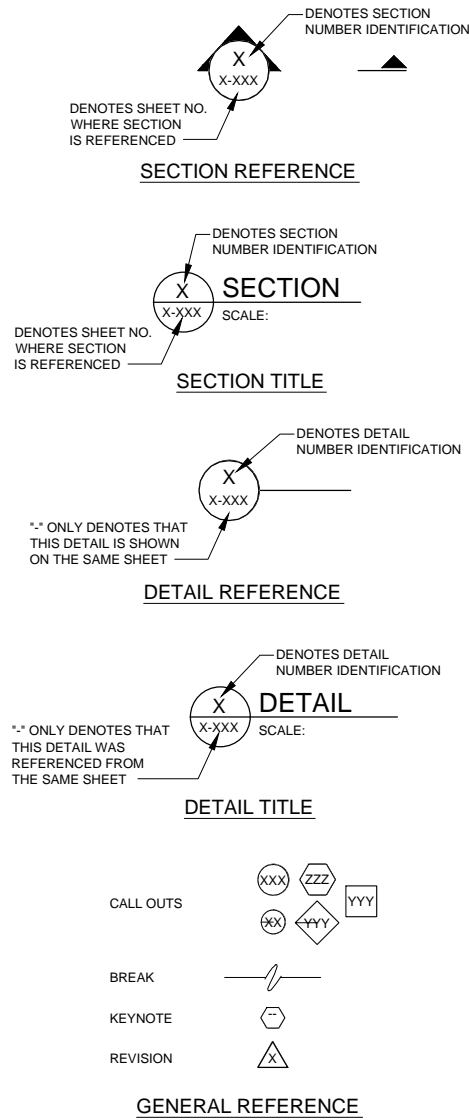

SHEET NUMBERING

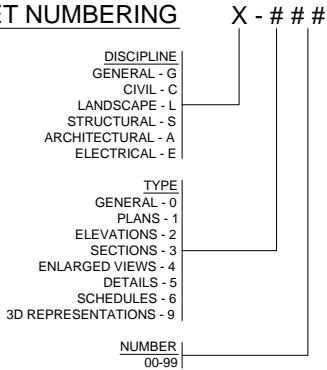

GENERAL NOTES

- ALL WORK SHALL BE IN CONFORMANCE WITH THE CITY AND BOROUGH OF JUNEAU ENGINEERING STANDARD DETAILS, 4TH EDITION, DATED AUGUST 2015 AND ALL WORK MUST CONFORM TO THE LATEST ADOPTED EDITION OF ALL APPLICABLE CODES AS OF AUGUST 2015.
- IT SHALL BE THE CONTRACTOR'S RESPONSIBILITY TO DETERMINE THE TRUE ELEVATIONS AND LOCATIONS OF UTILITIES SO AS TO AVOID DAMAGE OR DISTURBANCE DURING CONSTRUCTION. PRIOR TO STARTING CONSTRUCTION, THE CONTRACTOR SHALL CALL JUNEAU UTILITY COUNCIL AT 556-1333 AND THE CBJ FOR UTILITY LOCATIONS (WATER, SANITARY SEWER, STORM SEWER, POWER, TELEPHONE, AND TELEVISION). ALL UTILITY RELOCATION SHALL BE DONE IN ACCORDANCE WITH THE SPECIFICATIONS.
- THE CONTRACTOR SHALL MEET ALL TRENCH SAFETY REQUIREMENTS OF CBJ, STATE AND FEDERAL LAW AND SHALL BE RESPONSIBLE FOR MAINTAINING TRENCH SAFETY MEASURES THROUGHOUT THE PROJECT.
- A COPY OF THESE APPROVED DRAWINGS MUST BE ON THE JOB SITE WHENEVER CONSTRUCTION IS IN PROGRESS.
- WORK ON CBJ OR STATE OF ALASKA DOT & PF RIGHT-OF-WAY SHALL BE PERFORMED DURING HOURS AND DAYS LISTED IN SECTIONS 00700 & 01550 OF THE SPECIFICATIONS, AND IN APPLICABLE PERMITS.
- ANY REVISIONS TO THESE DRAWINGS MUST BE REVIEWED AND APPROVED BY THE ENGINEER PRIOR TO ANY IMPLEMENTATION IN THE FIELD. TRUCK HAUL ROUTES AND EQUIPMENT ACCESS ARE TO BE APPROVED BY ENGINEER AND CITY BEFORE CONSTRUCTION IS ALLOWED TO COMMENCE.
- NOTIFY THE CBJ AS REQUIRED BY THE SPECIFICATIONS BEFORE CONSTRUCTION IS STARTED AND BEFORE ANY EXPOSURE OR POSSIBLE DISTURBANCE OF UTILITIES.
- IF ANY WORK REQUIRES LANE CLOSURES WITHIN STATE OF ALASKA AND CBJ RIGHT-OF-WAYS, CONTRACTOR SHALL OBTAIN LANE CLOSURE PERMIT FROM ALASKA DOTPF (UNDER 17 AAC 20.017) AND APPROVAL OF TRAFFIC CONTROL PLAN FROM CBJ PRIOR TO CONSTRUCTION.
- DURING CONSTRUCTION, CONTRACTOR SHALL BE REQUIRED TO CONTROL ON-SITE STORM WATER RUNOFF BY USING TEMPORARY EROSION/SILTATION CONTROL PROCEDURES WHERE NECESSARY. NO SEDIMENT LADEN STORM WATER SHALL BE ALLOWED TO DISCHARGE TO SURFACE WATERS, THE STORM DRAINAGE SYSTEM OR ONTO ADJACENT PROPERTIES. NO STORM DRAINAGE OR GROUND WATER WILL BE ALLOWED INTO THE SANITARY SEWER SYSTEM. CONTROL OF WATER AND EROSION CONTROL MEASURES SHALL BE IN ACCORDANCE WITH SECTIONS 01530 PROTECTION AND RESTORATION OF EXISTING FACILITIES AND 01570 EROSION CONTROL, OF THE SPECIFICATIONS. SILT FENCING AND STORM DRAIN INLET PROTECTION AS REQUIRED, SHALL BE IN PLACE A MINIMUM ONE WEEK PRIOR TO STARTING CONSTRUCTION.
- DURING CONSTRUCTION, ALL STREETS ADJACENT TO THIS PROJECT, INCLUDING HAUL ROUTES SHALL BE KEPT CLEAN OF ALL MATERIAL DEPOSITS RESULTING FROM THE CONTRACTOR'S OPERATIONS, AS DIRECTED BY THE ENGINEER. THE CONTRACTOR SHALL ALSO CONTROL DUST ON THE SITE AND HAUL ROUTES.
- CONTRACTOR SHALL NOTIFY ENGINEER IN THE EVENT OF DISCOVERY OF POOR SOILS, STANDING GROUNDWATER OR DISCREPANCIES FROM DRAWINGS IN EXISTING CONDITIONS.
- THE CONTRACTOR SHALL INSTALL, REPLACE, OR RELOCATE SIGNS AFFECTED BY CONSTRUCTION, PER CBJ REQUIREMENTS. ALL STREET SIGNS SHALL CONFORM TO CBJ STANDARDS. THE CONTRACTOR SHALL MAINTAIN TRAFFIC CONTROL ON DETOUR ROUTES, HAUL ROUTES, AND STREETS UNDER CONSTRUCTION PER SECTION 01550 SITE ACCESS AND STORAGE OF THE SPECIFICATIONS.
- ALL ITEMS DESIGNATED TO BE REMOVED SHALL BE DISPOSED OF AT AN APPROVED DISPOSAL SITE, EXCEPT AS NOTED IN THE CONTRACT DOCUMENTS.
- ALL ASPHALT PAVEMENT TO BE REMOVED AND DISPOSED OF SHALL BE DELIVERED TO A STOCKPILE AREA AT THE STATE/CITY PIT. CONTACT ALLAN STEFFERT AT 586-0481 FOR THE EXACT LOCATION OF THE STOCKPILE WITHIN THE PIT AREA.
- EXISTING CONDITIONS SHOWN ON THESE DRAWINGS BASED ON SITE SURVEYS BY DOWL-HKM DATED AUGUST 2010 AND SUPPLEMENTED IN BY SUBSEQUENT FIELD OBSERVATIONS.
- ALL ELEVATIONS SHOWN ARE BASED ON A DATUM OF MLLW = 0.0. TIDAL RANGES ARE AS FOLLOWS:
 - EHW = 23.2 (USACE)
 - HIGHEST 1% EXCEEDANCE (NOAA) = 22.3
 - HTL = 20.8 (USACE)
 - HIGHEST PREDICTED IN 2015 = 20.4
 - MHHW = 16.30
 - MHW = 15.4 (USACE)
 - MSL = 8.6
 - MLLW = 0.0
 - LOWEST PREDICTED IN 2015 = -4.3
 - LOWEST 1% EXCEEDANCE (NOAA) = -6.1
- CONTRACTOR TO INSTALL TEMPORARY FENCING THROUGHOUT PERIOD OF CONSTRUCTION TO PREVENT UNAUTHORIZED PUBLIC ACCESS TO CONSTRUCTION AREAS.
- SUBMIT FOR REVIEW AND APPROVAL BY CBJ A SITE ACCESS, MATERIAL STORAGE, TRUCK HAUL ROUTE AND SITE SECURITY PLAN.

TETRA TECH



BY									
DESCRIPTION									
DATE									
MARK									

CITY AND BOROUGH OF JUNEAU
E16-011, DOWNTOWN SEAWALK - BRIDGE TO GOLD CREEK

ABBREVIATIONS, REFERENCE
AND GENERAL NOTES

Project No.:	135-12554-15003
Designed By:	SRO
Drawn By:	SRO
Checked By:	DRB

G-001

Bar Measures 1 inch

Copyright: tetra tech

8/12/2015 5:10:53 PM - P:\JUNEAU DOWNTOWN SEAWALK\2015\CAD\SHEETS\JUNEAU G-005 CLEAR&GRUB.DWG - CAROL OHLES

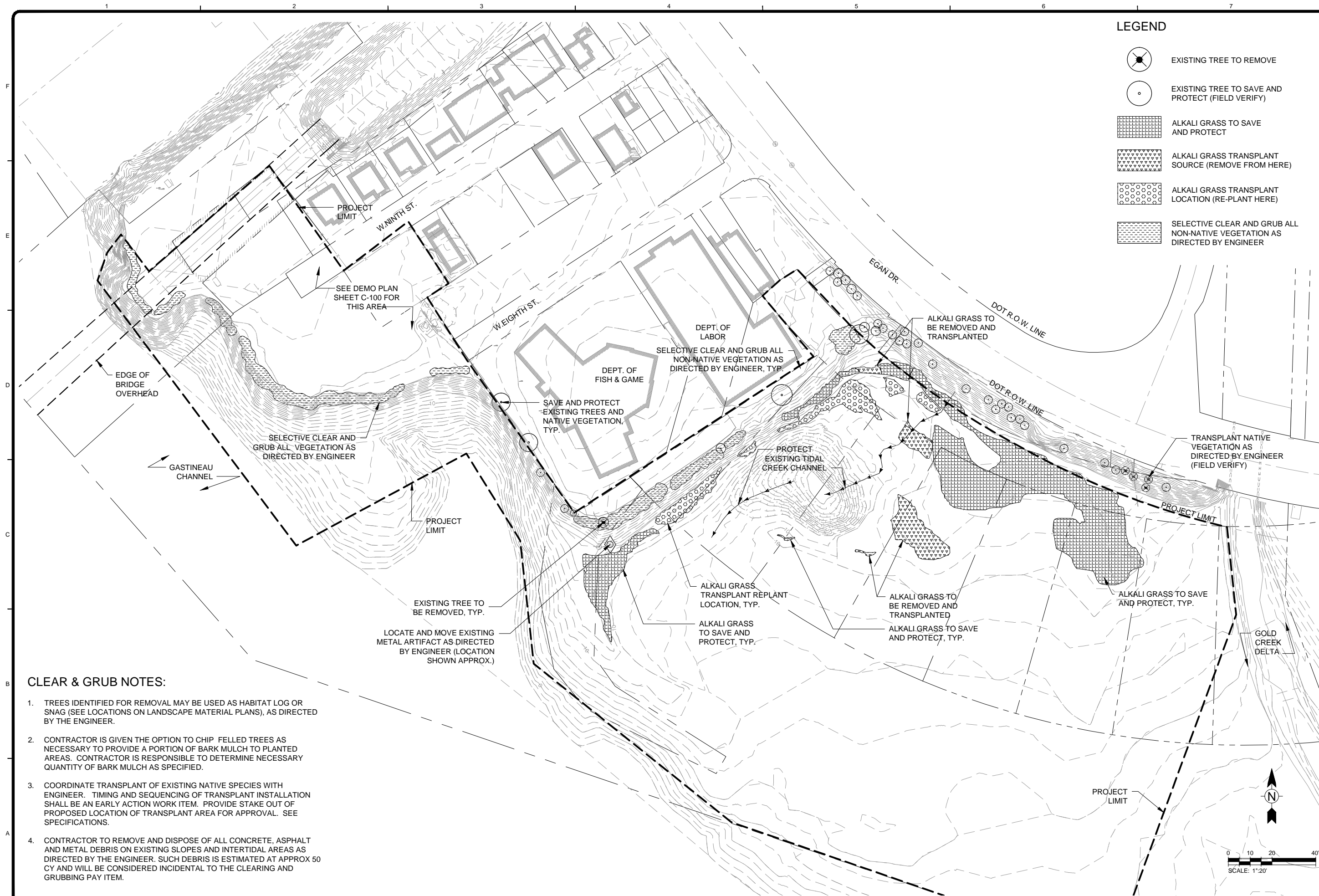

TETRA TECH
www.tetratech.com
217 SECOND STREET, SUITE 207
JUNEAU, AK 99801
MAIN: (907) 586-6400 FAX: (907) 463-3677

8/12/2015

j.a. brennan
associates LLC
Landscape Architects & Planners
100 South King Street, Suite 200
Seattle, WA 98104
T: 206.583.0620 F: 206.583.0623

MARK	DATE	DESCRIPTION	BY

CITY AND BOROUGH OF JUNEAU
E:16-011, DOWNTOWN SEAWALK - BRIDGE TO GOLD CREEK

**LANDSCAPE
CLEAR & GRUB PLAN**

Project No.: 135-12554-15002
Designed By: DC
Drawn By: MH
Checked By: JB

G-005

Copyright: Tetra Tech
Bar Measures 1 inch