

GLACIER AVENUE WATER EXTENSION

CONTRACT NO. E15-207

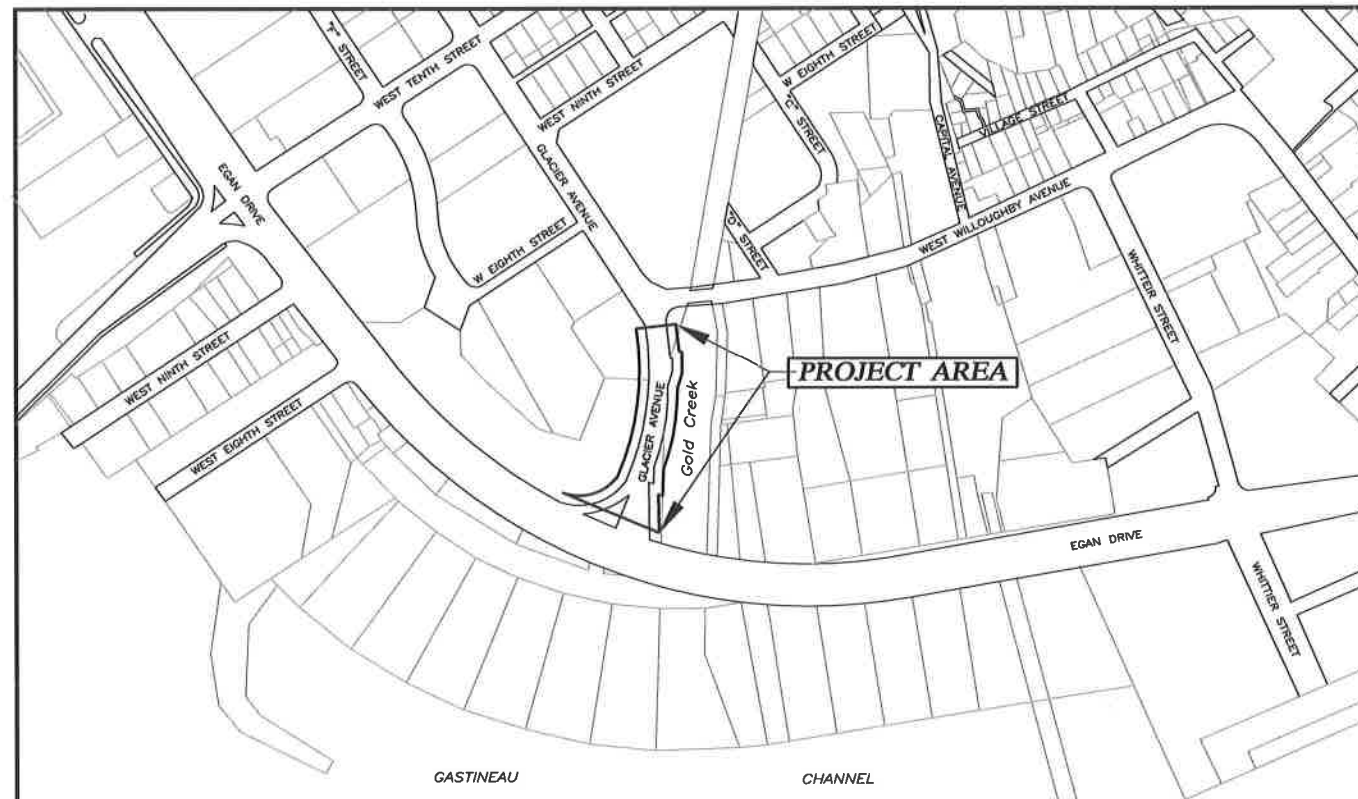

INDEX

DESCRIPTION	SHEET NO.
COVER SHEET	1 OF 3
TYPICAL SECTION, DETAILS AND GENERAL NOTES	2 OF 3
PLAN - GLACIER AVENUE	3 OF 3



CITY AND BOROUGH OF JUNEAU
★ ALASKA'S CAPITAL CITY
ENGINEERING DEPARTMENT

SHEET NO.

1 of 3

GENERAL NOTES:

1. ALL ASPHALT PAVEMENT TO BE REMOVED AND DISPOSED OF SHALL BE PROPERLY DELIVERED TO A STOCKPILE AREA AT THE LEMON CREEK CITY PIT TO BE DESIGNATED BY THE ENGINEER. CONTACT THE ENGINEER FOR THE EXACT LOCATION OF THE STOCKPILE.
2. UNDERGROUND UTILITIES ARE NOT SHOWN ON THE PLANS. THE CONTRACTOR SHALL BE RESPONSIBLE FOR OBTAINING LOCATES PRIOR TO BEGINNING CONSTRUCTION. DIAL BEFORE YOU DIG 586-1333.

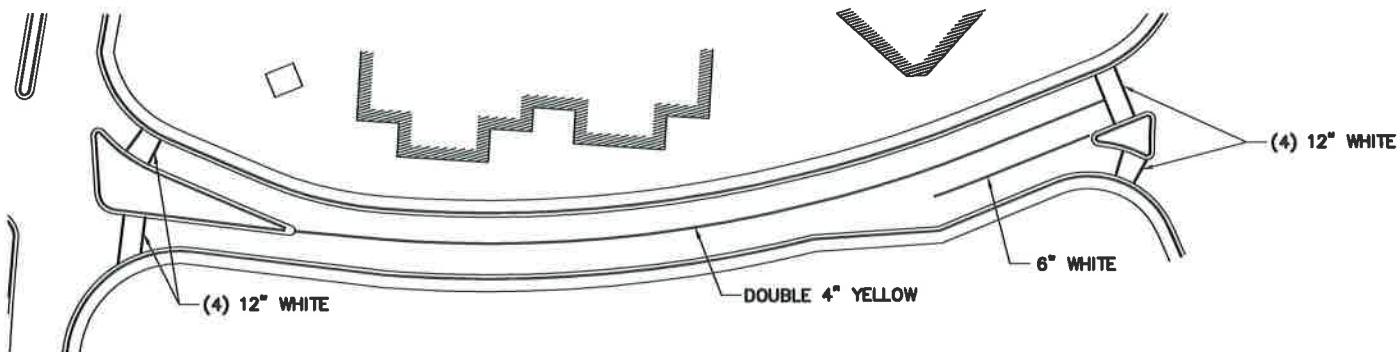

NOTE: EXISTING PAINTED TRAFFIC MARKINGS SHALL BE LOCATED BY THE CONTRACTOR PRIOR TO CONSTRUCTION AND REPLACED AFTER FINAL PAVING.

PAINTED TRAFFIC MARKINGS

NTS

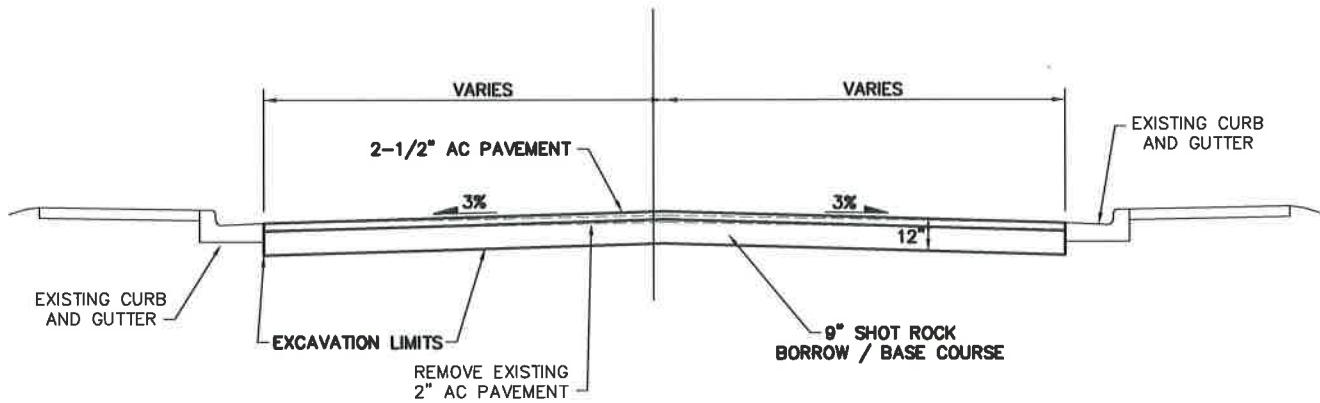

TYPICAL SECTION

NTS

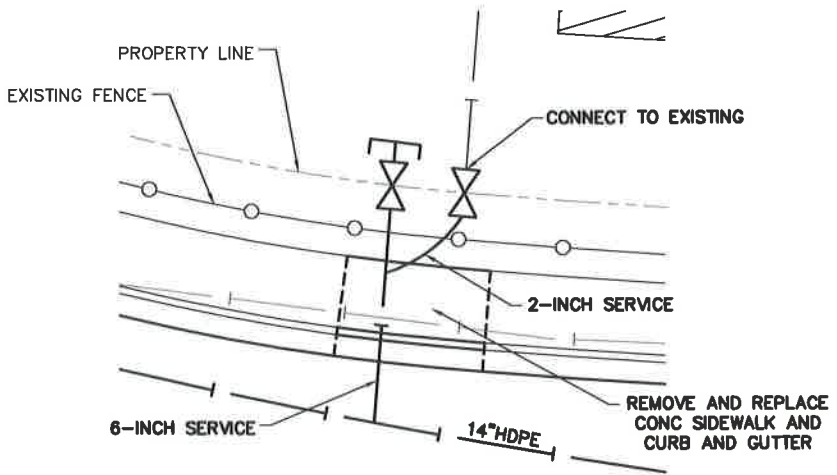

6-INCH WATER SERVICE WITH 2-INCH SERVICE STUB

NTS

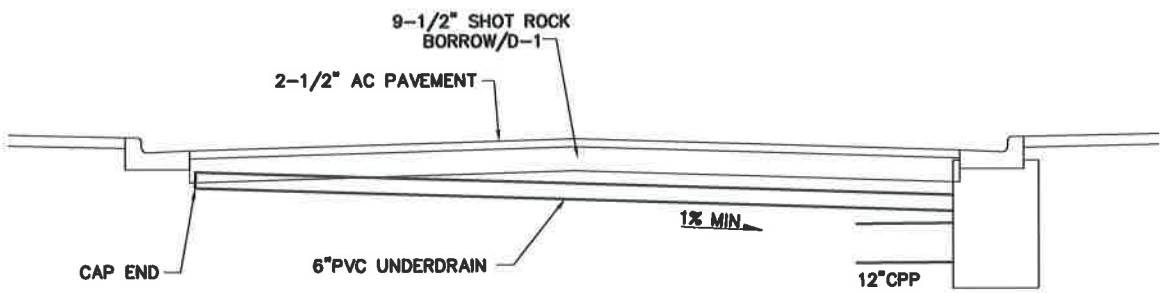

*ADJUST DEPTH AS REQUIRED TO MAINTAIN 1% MINIMUM GRADIENT

6 INCH CPP UNDERDRAIN

NTS

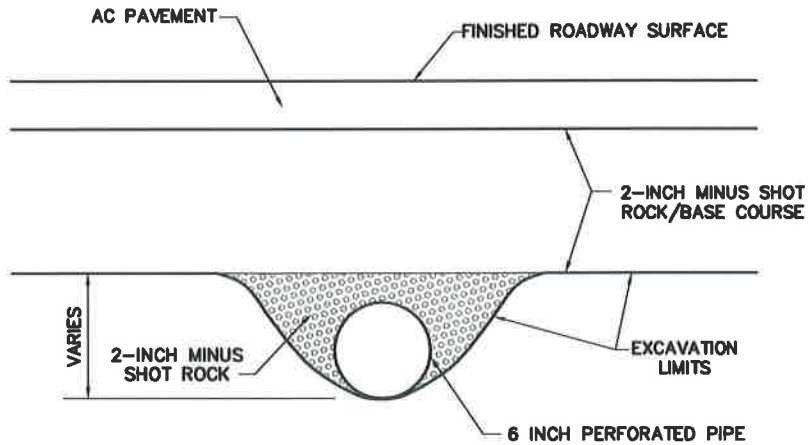

Revisions		
Date	Description	Intls.



Prepared by:
CITY AND BOROUGH OF JUNEAU
★ ALASKA'S CAPITAL CITY
ENGINEERING DEPARTMENT

**GLACIER AVENUE
WATER EXTENSION
CONTRACT NO. E15-207**

**TYPICAL SECTION, DETAILS
AND GENERAL NOTES**

DATE: 3/2/15 DRAWN BY: STAFF SCALE: AS SHOWN

SHEET:
2 of 3

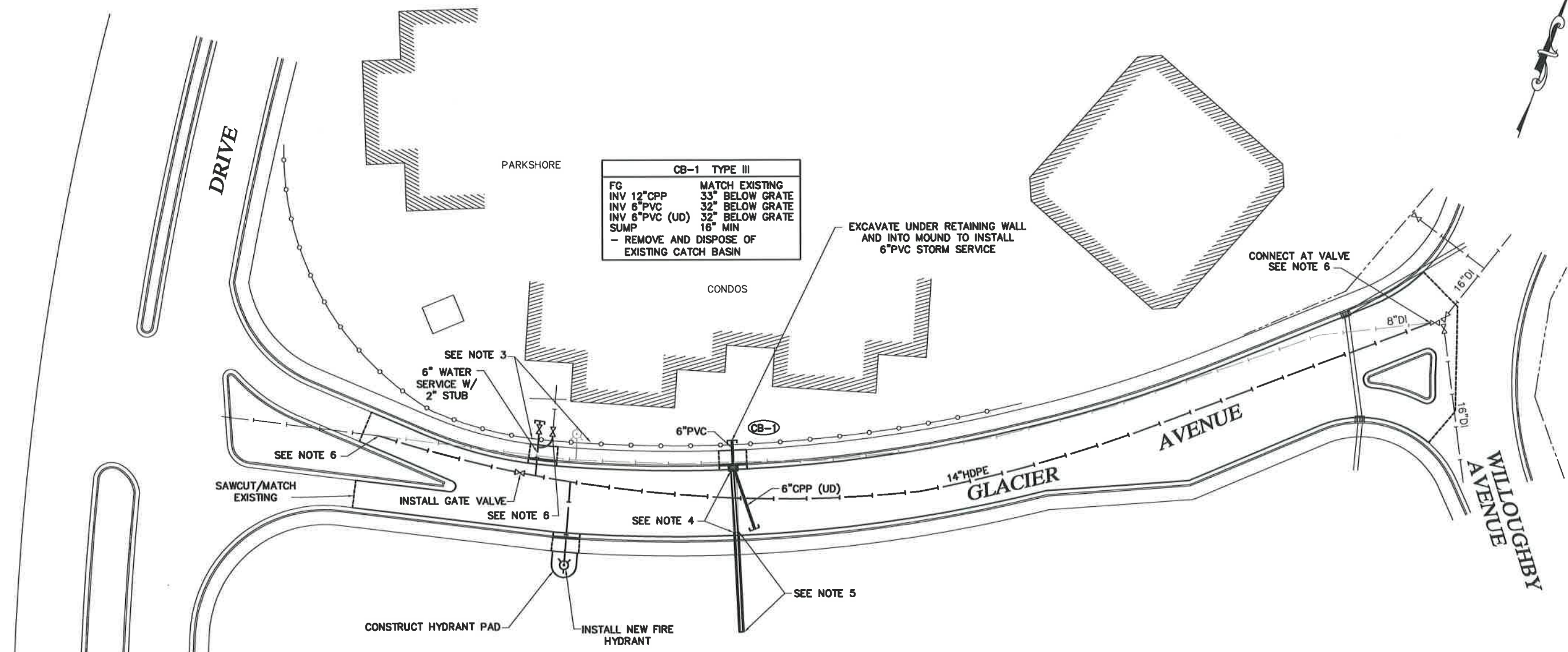

NOTES:

1. PAVEMENT LIMITS SHOWN ARE APPROXIMATE ONLY. CONTRACTOR SHALL VERIFY LIMITS WITH THE ENGINEER PRIOR TO CONSTRUCTION.
2. UNDERGROUND UTILITIES ARE NOT SHOWN ON THE PLANS. THE CONTRACTOR SHALL BE RESPONSIBLE FOR OBTAINING LOCATES PRIOR TO BEGINNING CONSTRUCTION. DIAL BEFORE YOU DIG 588-1333.
3. REMOVE AND REPLACE FENCE AS NECESSARY FOR 2" WATER SERVICE INSTALLATION AND REMOVE OF HYDRANT ASSEMBLY.
4. REMOVE EXISTING 18" CMP AND REPLACE WITH 12" CPP ALONG SAME GRADE.
5. SLIPLINE 12" CPP INSIDE EXISTING 18" CMP. FILL UPSTREAM END CAVITY WITH GROUT AT LEAST 12" THICK INTO PIPE.
6. PROVIDE ALL ADAPTERS, ELBOWS AND OTHER FITTINGS NECESSARY TO CONNECT TO DISSIMILAR PIPE SIZES, MATERIALS AND DEPTHS. CONNECT TO EXISTING.
7. CONTRACTOR SHALL OBTAIN A ADOT/PF LANE CLOSURE PERMIT PRIOR TO BEGINNING CONSTRUCTION.

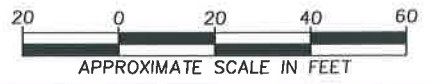

Revisions		
Date	Description	Intls.

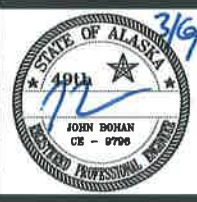

Prepared by:
 CITY AND BOROUGH OF JUNEAU
 ★ ALASKA'S CAPITAL CITY
 ENGINEERING DEPARTMENT

**GLACIER AVENUE
 WATER EXTENSION
 CONTRACT NO. E15-207**

PLAN - GLACIER AVENUE

DATE: 3/2/15 DRAWN BY: STAFF SCALE: AS SHOWN

SHEET:
 3 of 3