



ADDENDUM TO THE CONTRACT

for the

**Downtown Fire Station Paving
Contract No. E15-092**

ADDENDUM NO.: ONE

CURRENT DEADLINE FOR BIDS:
September 17, 2014

PREVIOUS ADDENDA: NONE

ISSUED BY: City and Borough of Juneau
ENGINEERING DEPARTMENT
155 South Seward Street
Juneau, Alaska 99801

DATE ADDENDUM ISSUED: September 5, 2014

The following items of the contract are modified as herein indicated. All other items remain the same. This addendum has been issued and is posted online. Please refer to the CBJ Engineering Contracts Division webpage at: <http://www.juneau.org/engineering ftp/contracts/Contracts.php>

PROJECT MANUAL:

Item No. 1 SECTION 00310 – BID SCHEDULE, *Delete and replace*, with the attached SECTION 00310 – BID SCHEDULE, labeled Addendum No. 1

SPECIAL PROVISIONS:

Item No. 2 SECTION 02714 FILTER CLOTH, PART 2 – PRODUCTS, *Delete in its entirety*.

Item No. 3 SECTION 01025 MEASUREMENT AND PAYMENT, Article 2.7 STABILAZATION FABRIC (Pay Item No. 2714.1) PRICE BASED ON QUANTITY, SQUARE YARD, in title and paragraphs A and B, *Add* the word "INSTALL" in front of all "STABILAZATION FABRIC" to read "Install Stabilization Fabric".

DRAWINGS:

Item No. 4 *Delete and replace*, Sheet 2A PLAN & TYPICAL SECTION, with the attached Sheet 2A PLAN & TYPICAL SECTION, labeled Addendum No. 1

By: 
Greg Smith
Contract Administrator

Total number of pages contained within this Addendum: 3

SECTION 00310 - BID SCHEDULE

PAY ITEM NO.	PAY ITEM DESCRIPTION	PAY UNIT	APPROX. QUANTITY	UNIT PRICE		AMOUNT	
				DOLLARS	CENTS	DOLLARS	CENTS
1505.1	Mobilization	Lump Sum	All Req'd	Lump	Sum		
1570.1	Erosion and Sediment Control	Lump Sum	All Req'd	Lump	Sum		
2202.1	Excavation	CY	1,880				
2202.2	10-Inch Minus Shot Rock Borrow	CY	1,460				
2204.1	2-Inch Minus Shot Rock / Base Course	CY	325				
2402.1	Adjust Sanitary Sewer Cleanout	Each	4				
2702.1	Construction Surveying	Lump Sum	All Req'd	Lump	Sum		
2720.1	Painted Traffic Markings	Lump Sum	All Req'd	Lump	Sum		
2714.1	Install Stabilization Fabric	SY	1,944				
2801.1	3" A.C. Pavement, Type II, Class B	Ton	388				
2806.1	Remove Existing AC Pavement	SY	1,944				

TOTAL BID _____

COMPANY NAME: _____

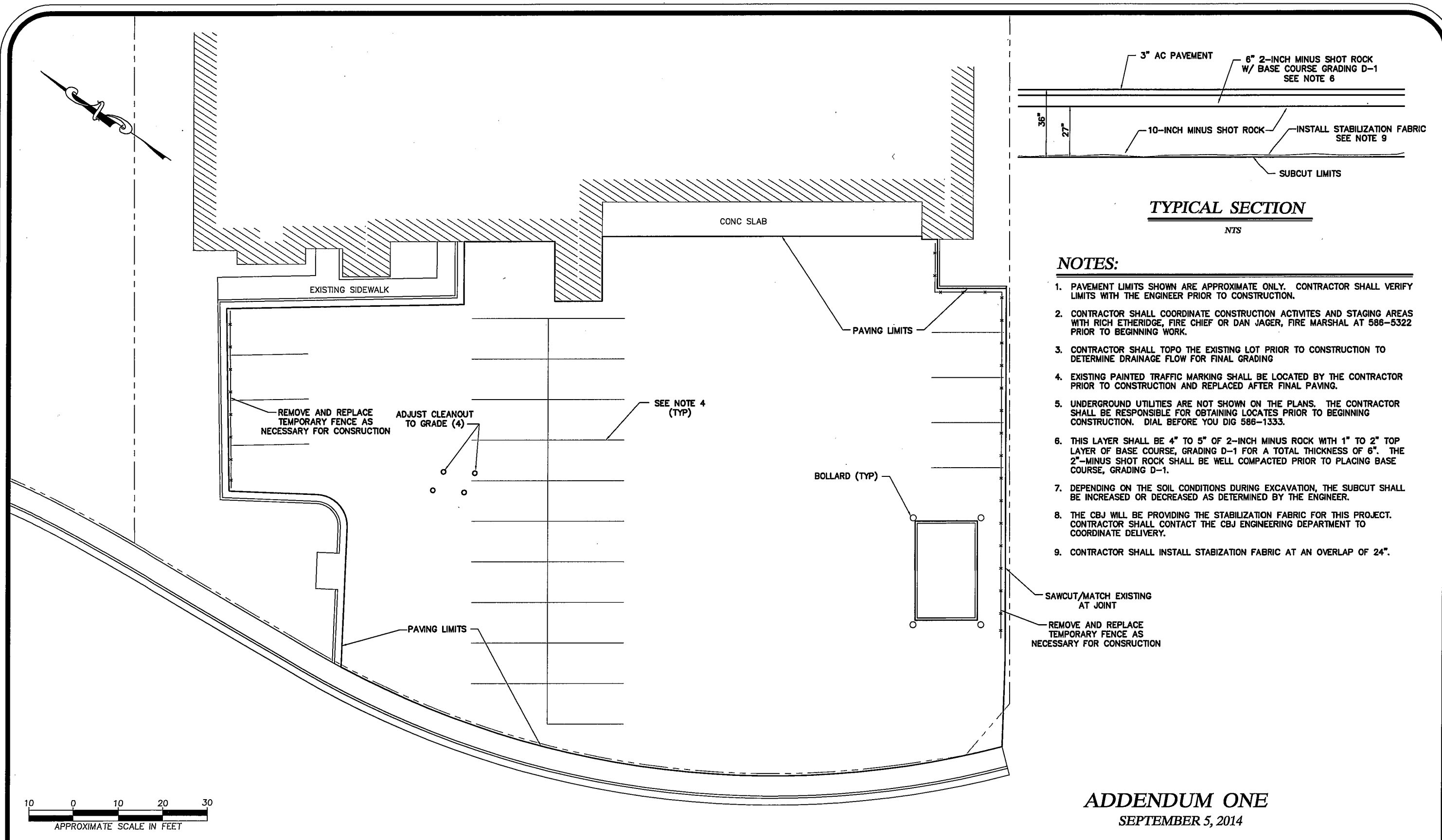

NOTES:

1. PAVEMENT LIMITS SHOWN ARE APPROXIMATE ONLY. CONTRACTOR SHALL VERIFY LIMITS WITH THE ENGINEER PRIOR TO CONSTRUCTION.
2. CONTRACTOR SHALL COORDINATE CONSTRUCTION ACTIVITIES AND STAGING AREAS WITH RICH ETHERIDGE, FIRE CHIEF OR DAN JAGER, FIRE MARSHAL AT 586-5322 PRIOR TO BEGINNING WORK.
3. CONTRACTOR SHALL TOPO THE EXISTING LOT PRIOR TO CONSTRUCTION TO DETERMINE DRAINAGE FLOW FOR FINAL GRADING
4. EXISTING PAINTED TRAFFIC MARKING SHALL BE LOCATED BY THE CONTRACTOR PRIOR TO CONSTRUCTION AND REPLACED AFTER FINAL PAVING.
5. UNDERGROUND UTILITIES ARE NOT SHOWN ON THE PLANS. THE CONTRACTOR SHALL BE RESPONSIBLE FOR OBTAINING LOCATES PRIOR TO BEGINNING CONSTRUCTION. DIAL BEFORE YOU DIG 586-1333.
6. THIS LAYER SHALL BE 4" TO 5" OF 2-INCH MINUS ROCK WITH 1" TO 2" TOP LAYER OF BASE COURSE, GRADING D-1 FOR A TOTAL THICKNESS OF 6". THE 2"-MINUS SHOT ROCK SHALL BE WELL COMPACTED PRIOR TO PLACING BASE COURSE, GRADING D-1.
7. DEPENDING ON THE SOIL CONDITIONS DURING EXCAVATION, THE SUBCUT SHALL BE INCREASED OR DECREASED AS DETERMINED BY THE ENGINEER.
8. THE CBJ WILL BE PROVIDING THE STABILIZATION FABRIC FOR THIS PROJECT. CONTRACTOR SHALL CONTACT THE CBJ ENGINEERING DEPARTMENT TO COORDINATE DELIVERY.
9. CONTRACTOR SHALL INSTALL STABILIZATION FABRIC AT AN OVERLAP OF 24".

ADDENDUM ONE
SEPTEMBER 5, 2014

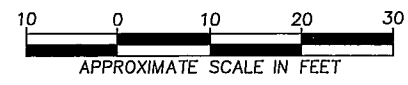

<p>Revisions</p> <table border="1" style="width: 100%; border-collapse: collapse;"> <thead> <tr> <th style="width: 15%;">Date</th> <th style="width: 60%;">Description</th> <th style="width: 25%;">Intls.</th> </tr> </thead> <tbody> <tr><td> </td><td> </td><td> </td></tr> <tr><td> </td><td> </td><td> </td></tr> <tr><td> </td><td> </td><td> </td></tr> <tr><td> </td><td> </td><td> </td></tr> </tbody> </table>			Date	Description	Intls.														<p>Prepared by:</p> <p>CITY AND BOROUGH OF JUNEAU</p> <p>★ ALASKA'S CAPITAL CITY</p> <p>ENGINEERING DEPARTMENT</p>	<p>DOWNTOWN FIRE STATION</p> <p>PAVING</p> <p>CONTRACT NO. E15-092</p>	<p>PLAN & TYPICAL SECTION</p>		<p>SHEET:</p> <p>2A of 2</p>
Date	Description	Intls.																					
<p>DATE: 8/22/14</p>			<p>DRAWN BY: STAFF</p>		<p>SCALE: AS SHOWN</p>																		