

# DOWNTOWN FIRE STATION PAVING

CONTRACT NO. E15-092

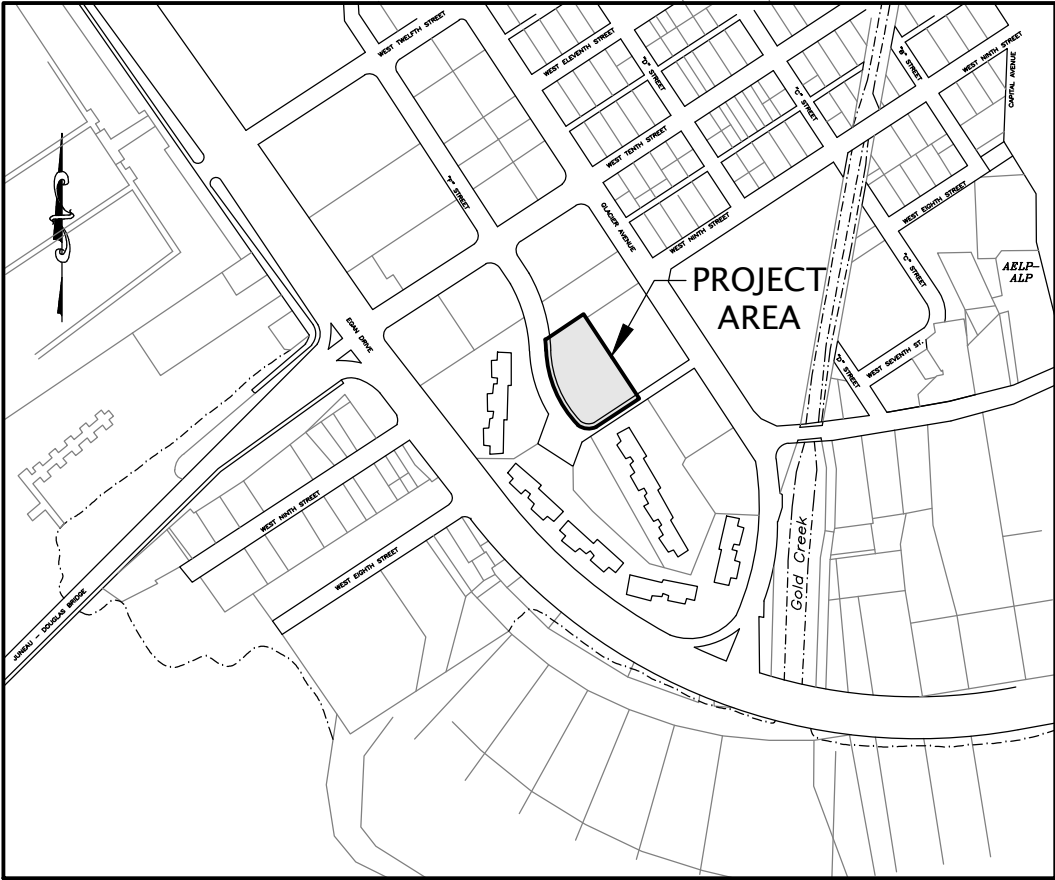

## INDEX

DESCRIPTION	SHEET NO.
COVER SHEET	1 OF 2
PLAN AND TYPICAL SECTIONS	2 OF 2

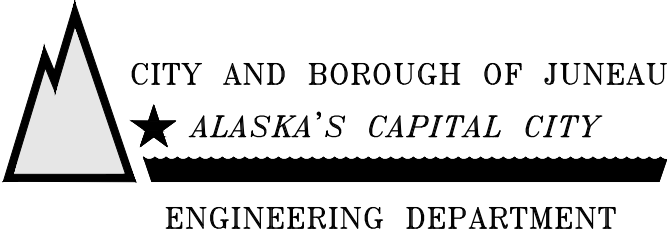

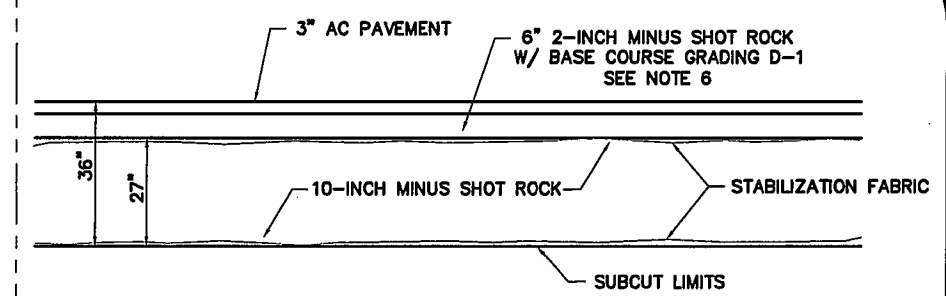
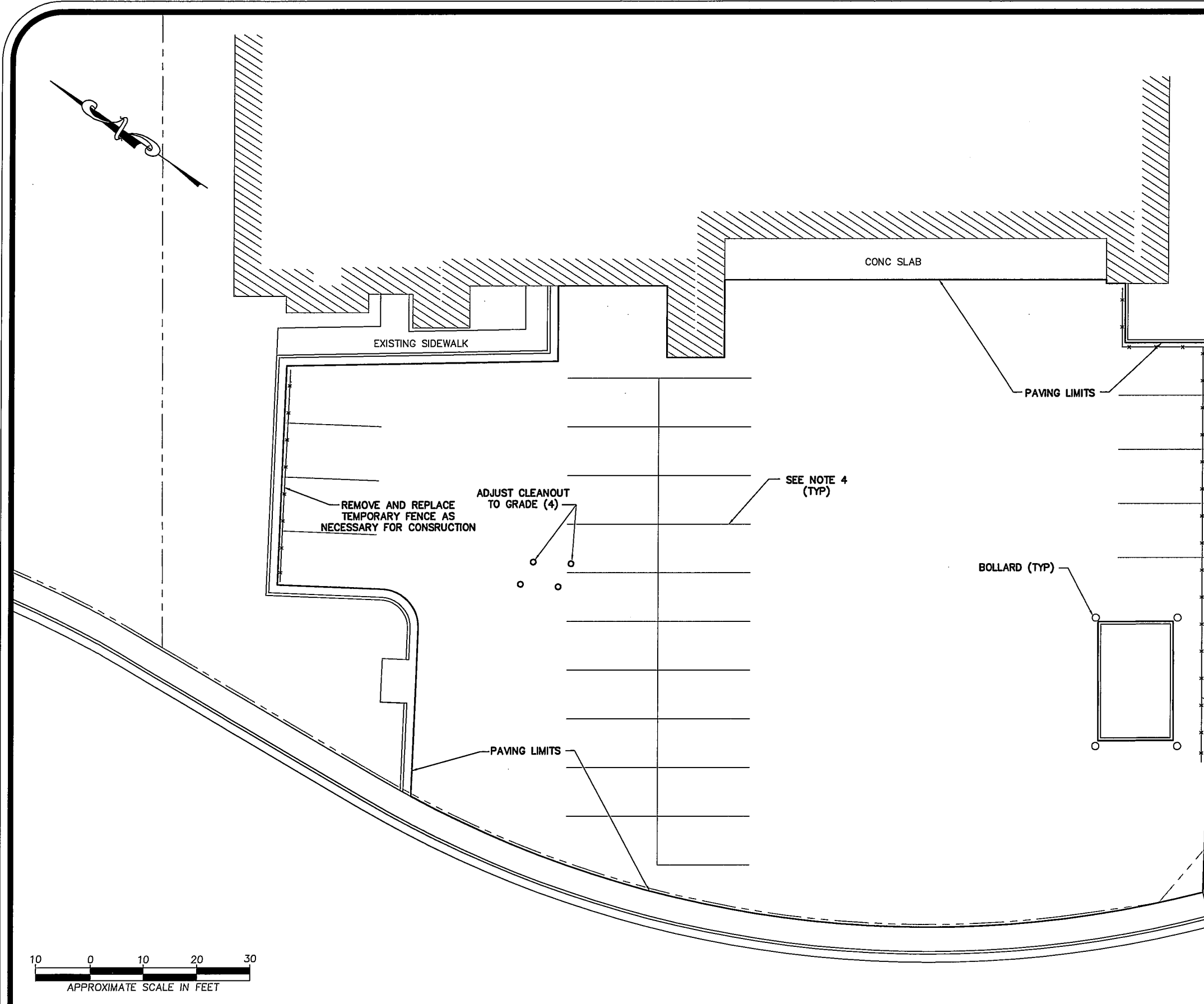

**TYPICAL SECTION**  
NTS

**NOTES:**

1. PAVEMENT LIMITS SHOWN ARE APPROXIMATE ONLY. CONTRACTOR SHALL VERIFY LIMITS WITH THE ENGINEER PRIOR TO CONSTRUCTION.
2. CONTRACTOR SHALL COORDINATE CONSTRUCTION ACTIVITIES AND STAGING AREAS WITH RICH ETHERIDGE, FIRE CHIEF OR DAN JAGER, FIRE MARSHAL AT 586-5322 PRIOR TO BEGINNING WORK.
3. CONTRACTOR SHALL TOPO THE EXISTING LOT PRIOR TO CONSTRUCTION TO DETERMINE DRAINAGE FLOW FOR FINAL GRADING
4. EXISTING PAINTED TRAFFIC MARKING SHALL BE LOCATED BY THE CONTRACTOR PRIOR TO CONSTRUCTION AND REPLACED AFTER FINAL PAVING.
5. UNDERGROUND UTILITIES ARE NOT SHOWN ON THE PLANS. THE CONTRACTOR SHALL BE RESPONSIBLE FOR OBTAINING LOCATES PRIOR TO BEGINNING CONSTRUCTION. DIAL BEFORE YOU DIG 586-1333.
6. THIS LAYER SHALL BE 4" TO 5" OF 2-INCH MINUS ROCK WITH 1" TO 2" TOP LAYER OF BASE COURSE, GRADING D-1 FOR A TOTAL THICKNESS OF 6". THE 2"-MINUS SHOT ROCK SHALL BE WELL COMPACTED PRIOR TO PLACING BASE COURSE, GRADING D-1.
7. DEPENDING ON THE SOIL CONDITIONS DURING EXCAVATION, THE SUBCUT SHALL BE INCREASED OR DECREASED AS DETERMINED BY THE ENGINEER.

SAWCUT/MATCH EXISTING AT JOINT

REMOVE AND REPLACE TEMPORARY FENCE AS NECESSARY FOR CONSTRUCTION

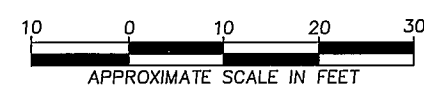

Revisions		
Date	Description	Intls.

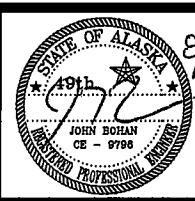

8/25/14  
Prepared by:  
CITY AND BOROUGH OF JUNEAU  
★ ALASKA'S CAPITAL CITY  
ENGINEERING DEPARTMENT

**DOWNTOWN FIRE STATION  
PAVING  
CONTRACT NO. E15-092**

**PLAN & TYPICAL SECTION**

DATE: 8/22/14      DRAWN BY: STAFF      SCALE: AS SHOWN

SHEET:  
**2** of **2**