

SAVIKKO BALL FIELDS RESURFACING PROJECT

CONTRACT NO. E14-203

INDEX

DESCRIPTION	SHEET NO.
COVER SHEET	1 of 10
SURVEY CONTROL AND LAYOUT	2 of 10
DETAILS	3 of 10
EXISTING GRADES FIELD 1	4 of 10
SITE AND GRADING PLAN FIELD 1	5 of 10
CROSS SECTIONS FIELD 1	6 of 10
EXISTING GRADES FIELDS 3 AND 4	7 of 10
SITE AND GRADING PLAN FIELDS 3 AND 4	8 of 10
CROSS SECTIONS FIELDS 3 AND 4	9 of 10
CROSS SECTIONS FIELDS 3 AND 4	10 of 10

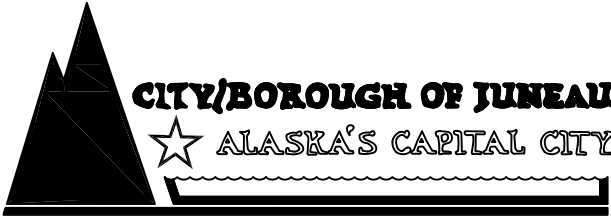
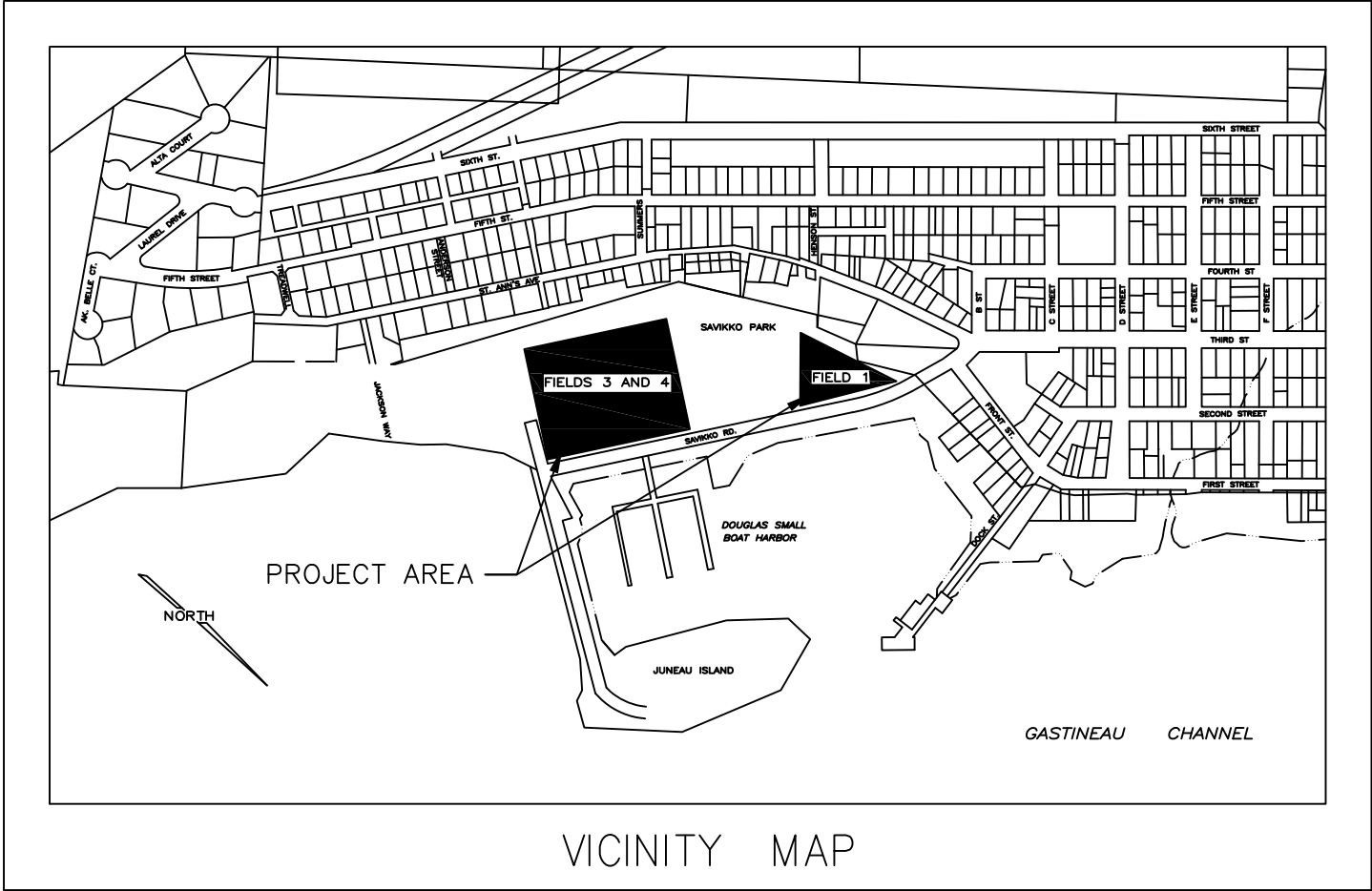

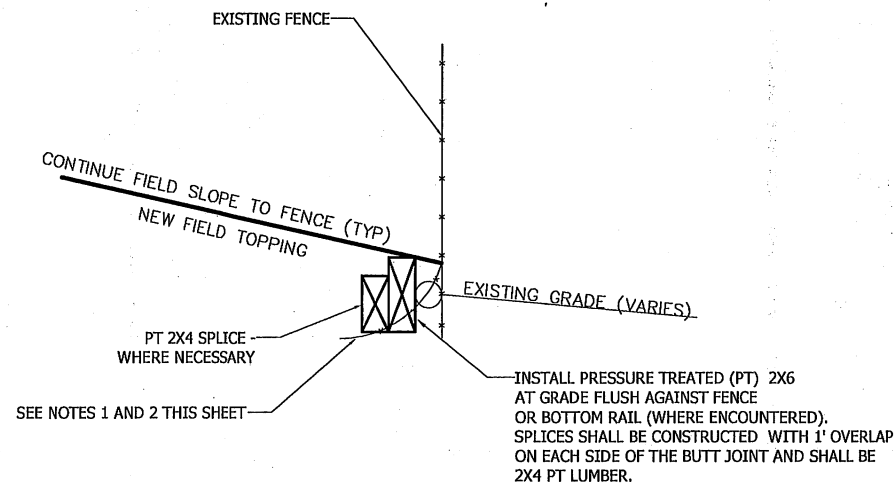

FIELD SURFACING/ FENCE DETAIL
NTS

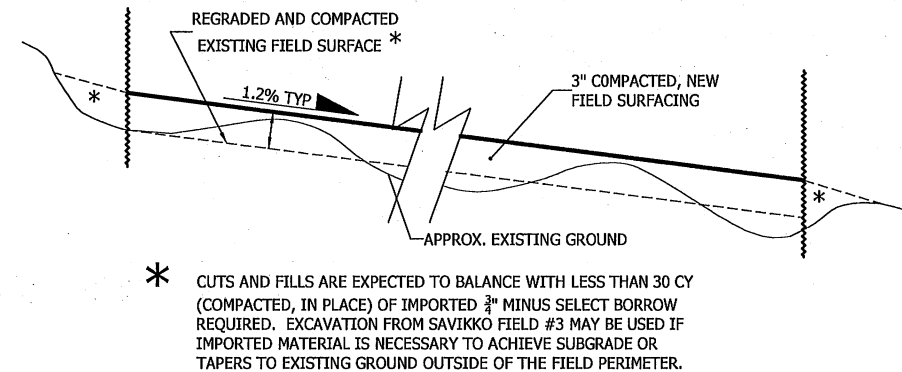

SAVIKKO FIELD #1 TYPICAL SECTION
NTS

NOTES:

1. CONTRACTOR IS ENCOURAGED TO PERFORM EXCAVATION AND GRADING WORK ADJACENT TO FENCE LINES BY HAND TO PREVENT FENCE DAMAGE. ANY FENCE DAMAGE CAUSED BY CONTRACTOR SHALL BE PROFESSIONALLY REPAIRED TO FULL HEIGHT BY REMOVING DAMAGED FABRIC TO FULL HEIGHT AND INSTALLING NEW FULL HEIGHT FENCE FABRIC.
2. THE BOTTOM OF THE EXISTING FENCE MAY BE CURLED TOWARDS THE EXCAVATION IN SOME AREAS. CONTRACTOR SHALL CAREFULLY LOCATE FENCE TO ENSURE DAMAGE IS NOT DONE TO FENCE. ANY DAMAGE TO FENCE WILL BE REPAIRED PER NOTE 1. CONTRACTOR SHALL USE 2X6 TO PUSH FENCE BACK TOWARD POSTS AND FENCE LINE.
3. CONTRACTOR SHALL EXCAVATE, GRADE AND COMPACT EXISTING FIELD SURFACE TO FINAL SUB GRADE ELEVATIONS PRIOR TO PLACING FIELD TOPPING MATERIAL.
4. HOME PLATE, BATTER'S BOX, PITCHERS RUBBER AND INFIELD BASES AND ANCHORS TO BE REMOVED BY OTHERS.
5. LOCATIONS OF EXISTING SCOREBOARD CONDUIT/CONDUCTOR ARE APPROXIMATE ONLY AND DEPTH UNKNOWN.

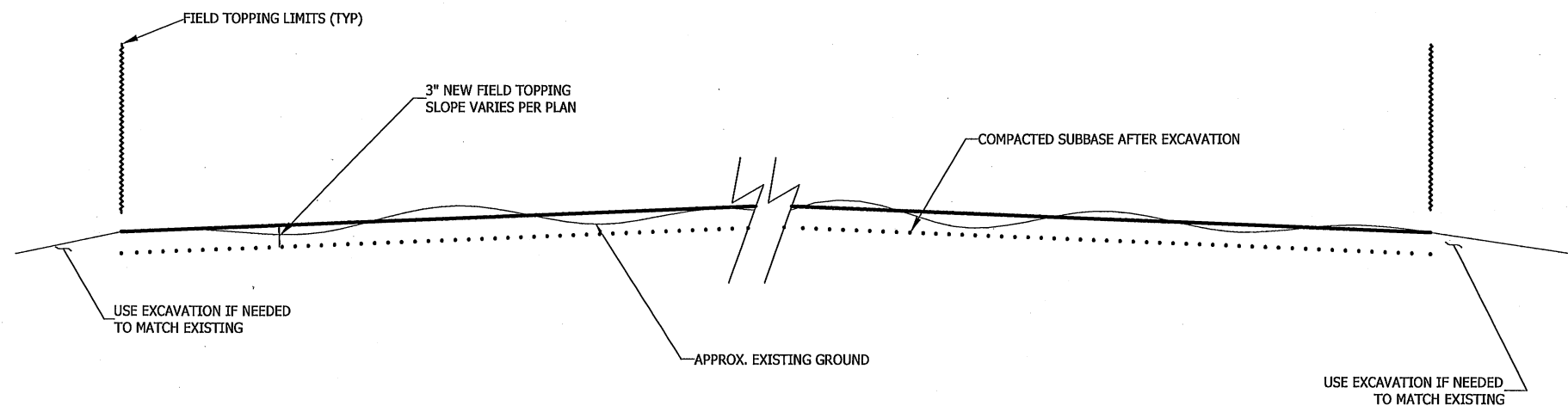

SAVIKKO FIELD NO 3 & 4 TYPICAL SECTION
NTS

Revisions

Date	Description	Intls.

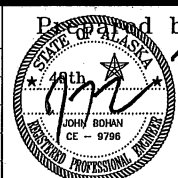

City and Borough of Juneau
★ ALASKA'S CAPITAL CITY
ENGINEERING DEPARTMENT

SAVIKKO BALL FIELDS
RESURFACING PROJECT

Contract No. E14-203

DETAILS

DESIGNED BY: --	CHECKED BY: --	FILE: --
DATE: FEB 2014	DRAWN BY: --	SCALE: As Shown

PAGE:

3 of 10

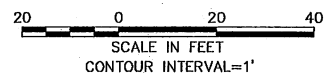
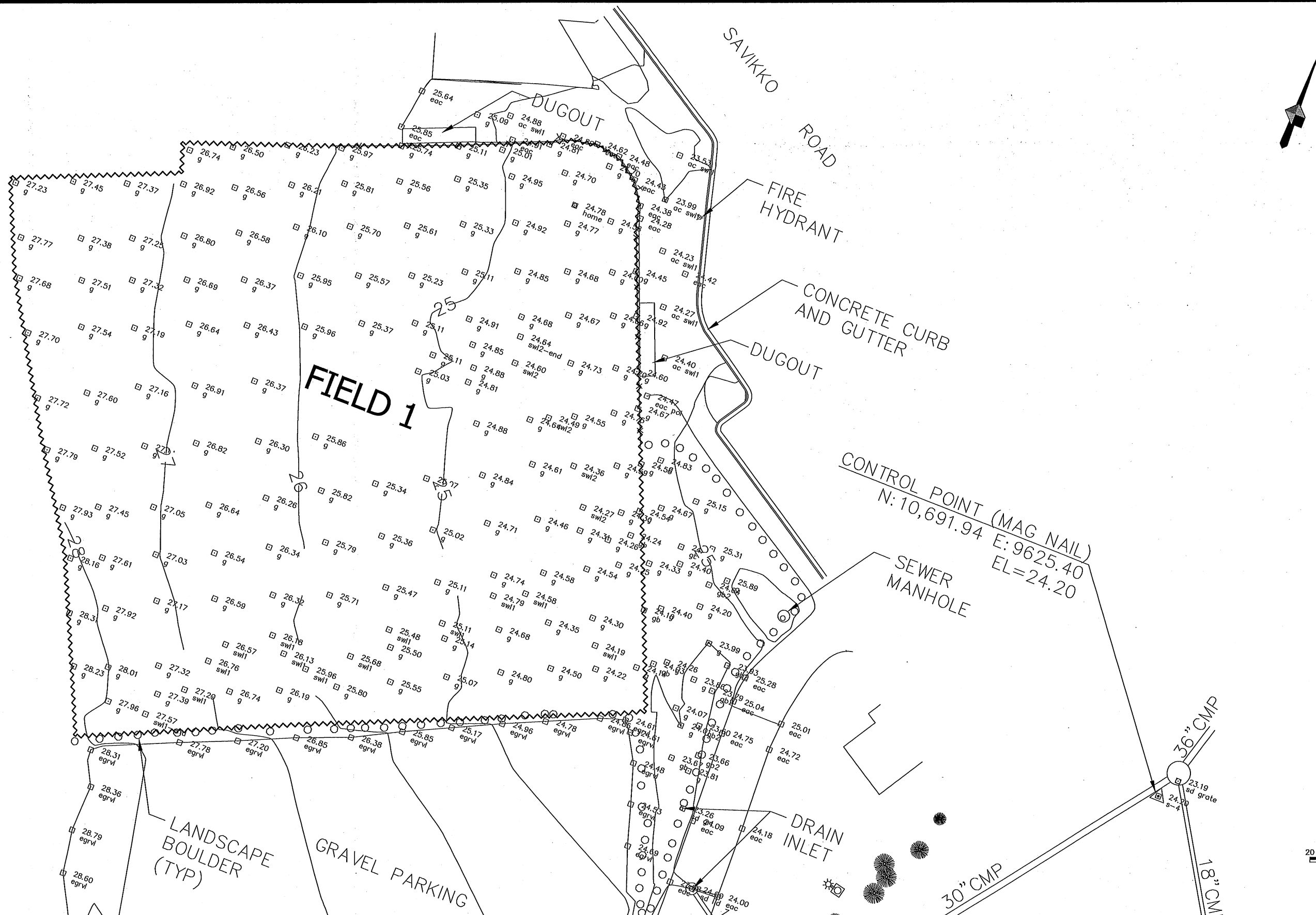

Revisions		
Date	Description	Intls.

Prepared by: **JOHN BOHAN**
CITY AND BOROUGH OF JUNEAU
★ ALASKA'S CAPITAL CITY
ENGINEERING DEPARTMENT

**SAVIKKO BALL FIELDS
RESURFACING PROJECT**
Contract No. E14-203

EXISTING GRADES FIELD 1		
DESIGNED BY: --	CHECKED BY: --	FILE: --
DATE: Feb 2014	DRAWN BY: --	SCALE: As Shown

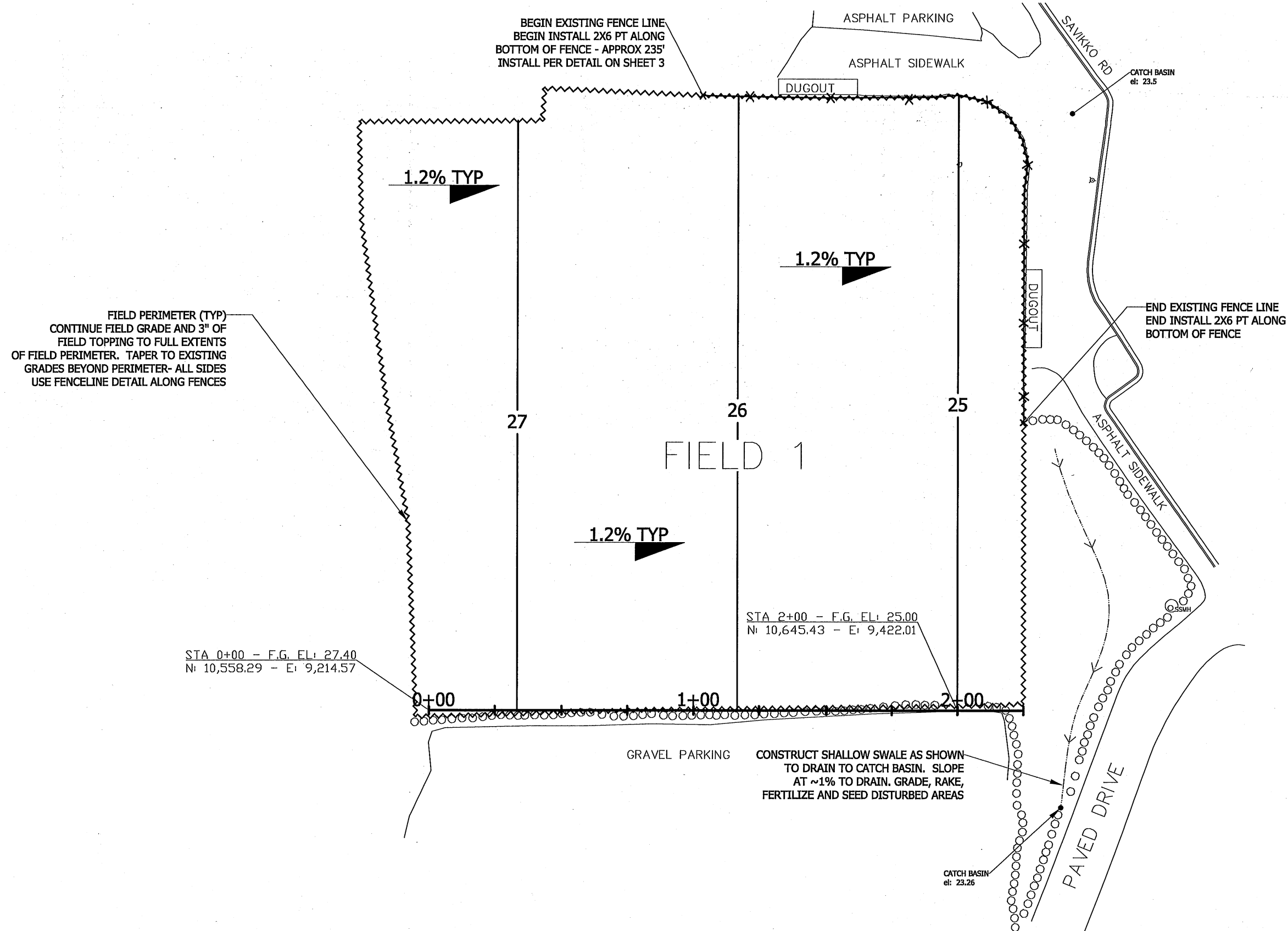

Revisions		
Date	Description	Intls.

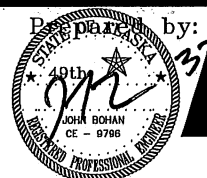

by: **3511-14**

CITY AND BOROUGH OF JUNEAU
★ ALASKA'S CAPITAL CITY
ENGINEERING DEPARTMENT

SAVIKKO BALL FIELDS RESURFACING PROJECT

Contract No. E14-203

SITE AND GRADING PLAN FIELD 1

DESIGNED BY: --	CHECKED BY: --	FILE: --
DATE: february 2014	DRAWN BY: --	SCALE: As Shown

PAGE:
5 of **10**

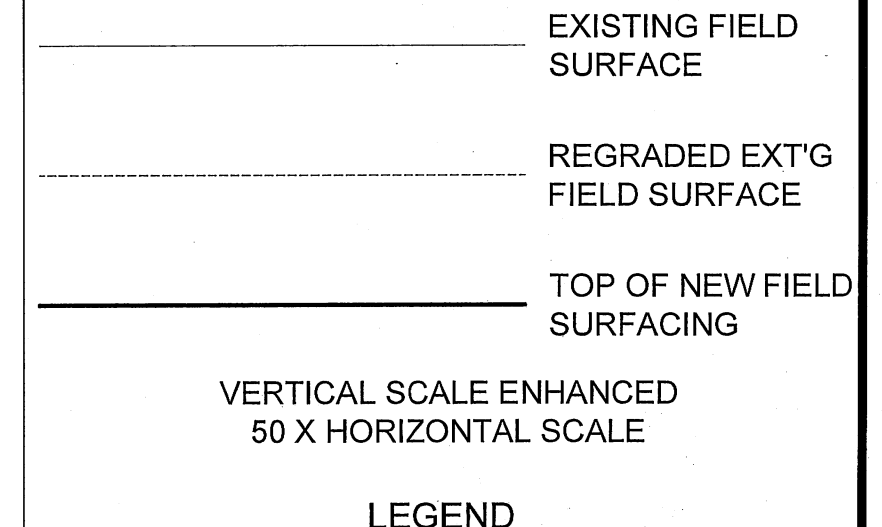
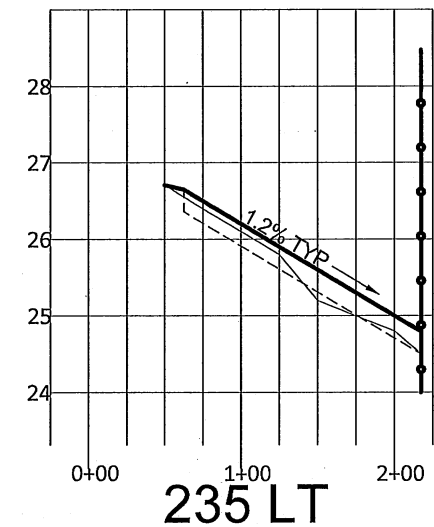
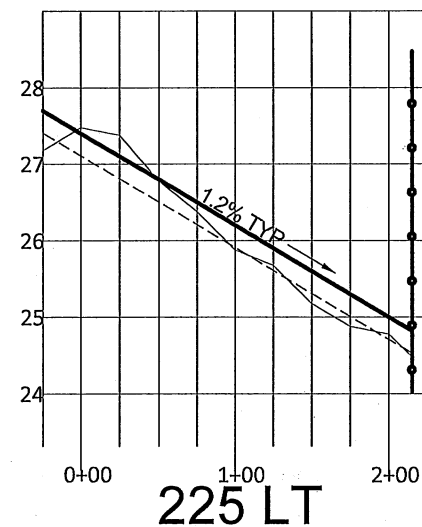
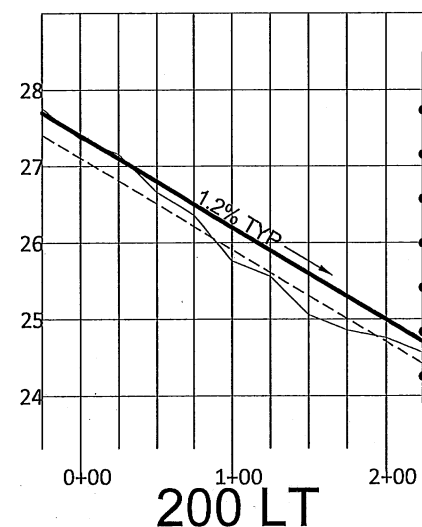
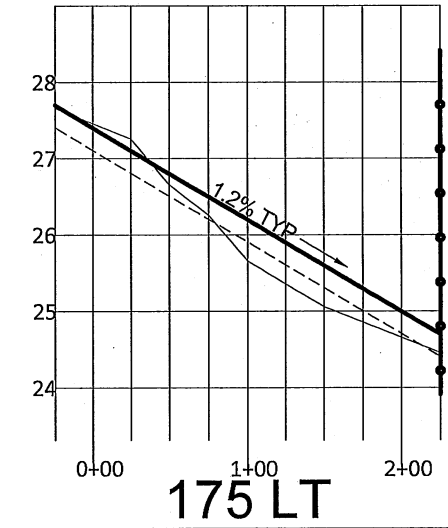
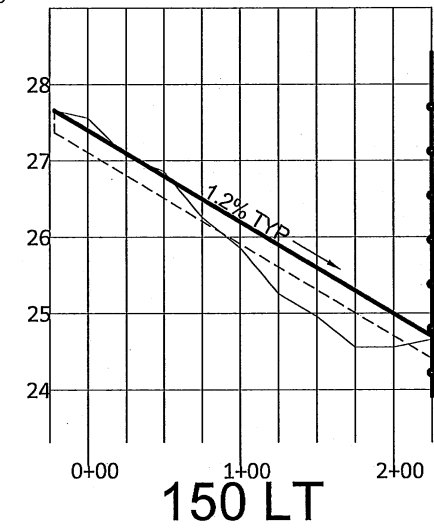
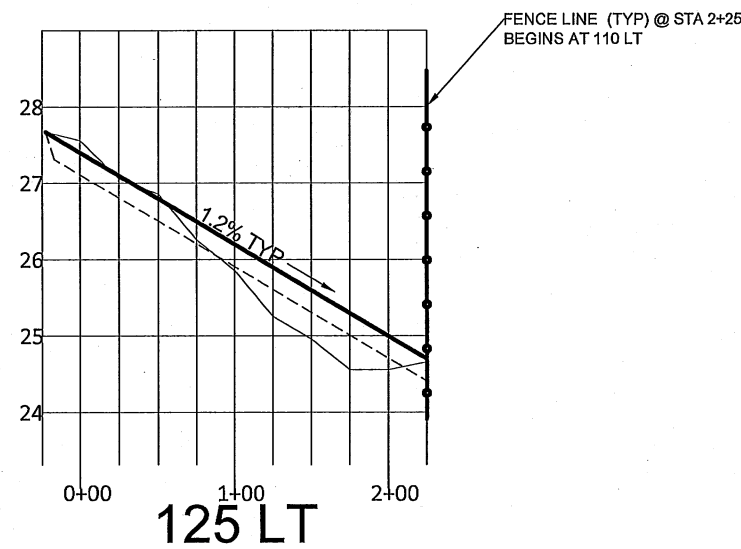
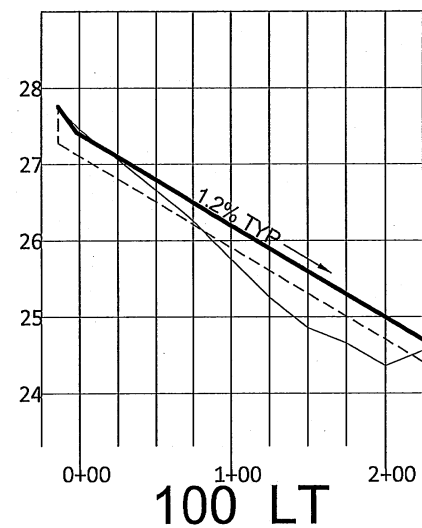
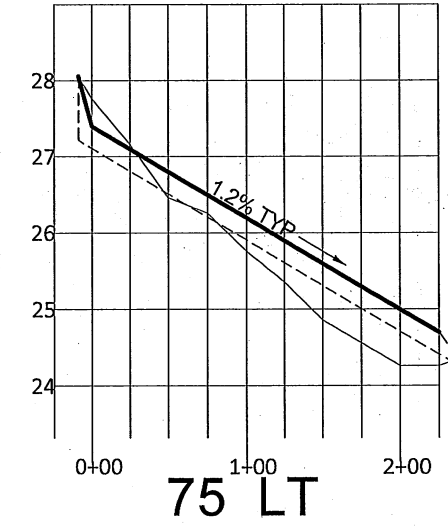
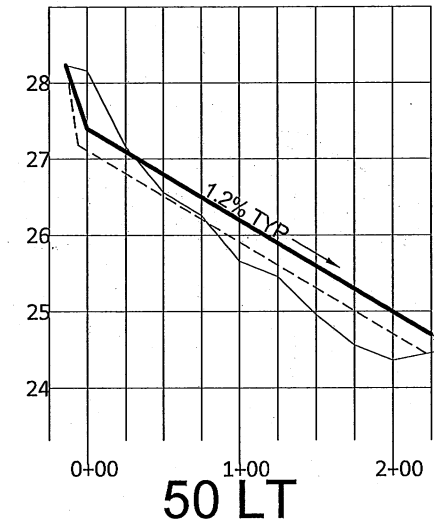
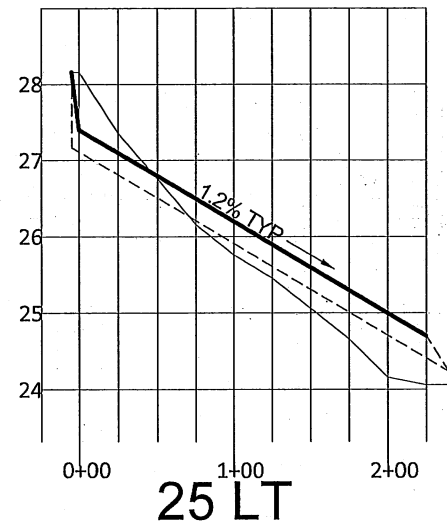
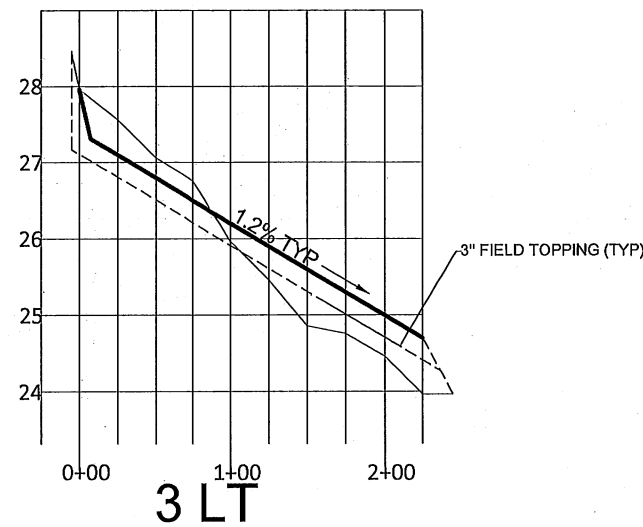

Revisions		
Date	Description	Intls.

Prepared by: **3-11-14**

CITY AND BOROUGH OF JUNEAU
★ ALASKA'S CAPITAL CITY
ENGINEERING DEPARTMENT

**SAVIKKO BALL FIELDS
RESURFACING PROJECT**
 Contract No. E14-203

**CROSS SECTIONS
FIELD 1**

DESIGNED BY: --	CHECKED BY: --	FILE: --
DATE: february 2014	DRAWN BY: --	SCALE: As Shown

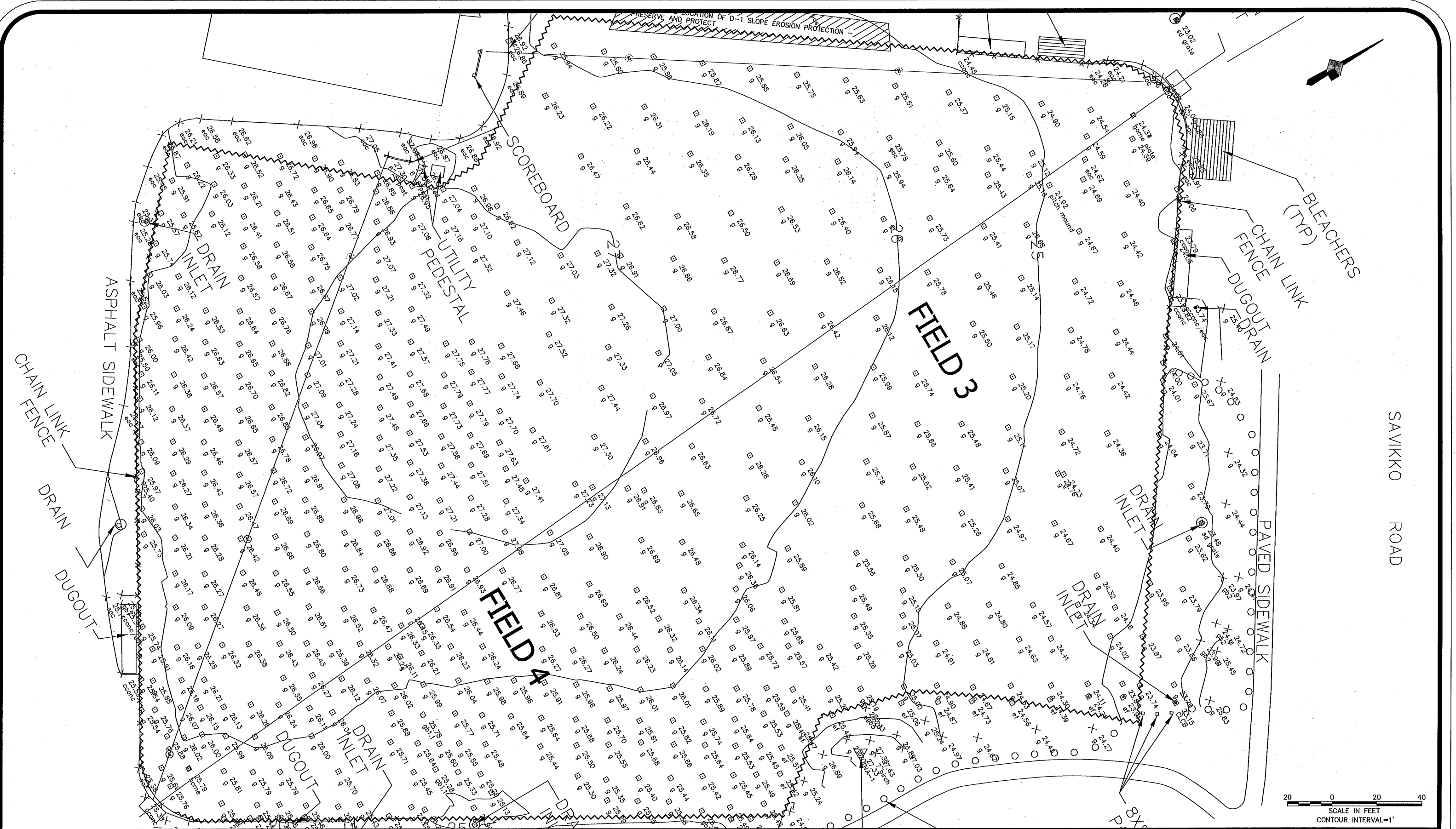

SAVIKKO ROAD

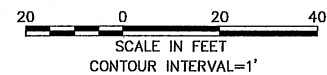

Revisions		
Date	Description	Intls.

Prepared by: **3/17/14**

 **JOHN BOHAN**
CE - 9786

CITY AND BOROUGH OF JUNEAU
★ **ALASKA'S CAPITAL CITY**
ENGINEERING DEPARTMENT

SAVIKKO BALL FIELDS
RESURFACING PROJECT
Contract No. E14-203

EXISTING GRADES		
FIELDS 3 AND 4		
DESIGNED BY: --	CHECKED BY: --	FILE: --
DATE: Feb 2014	DRAWN BY: --	SCALE: As Shown

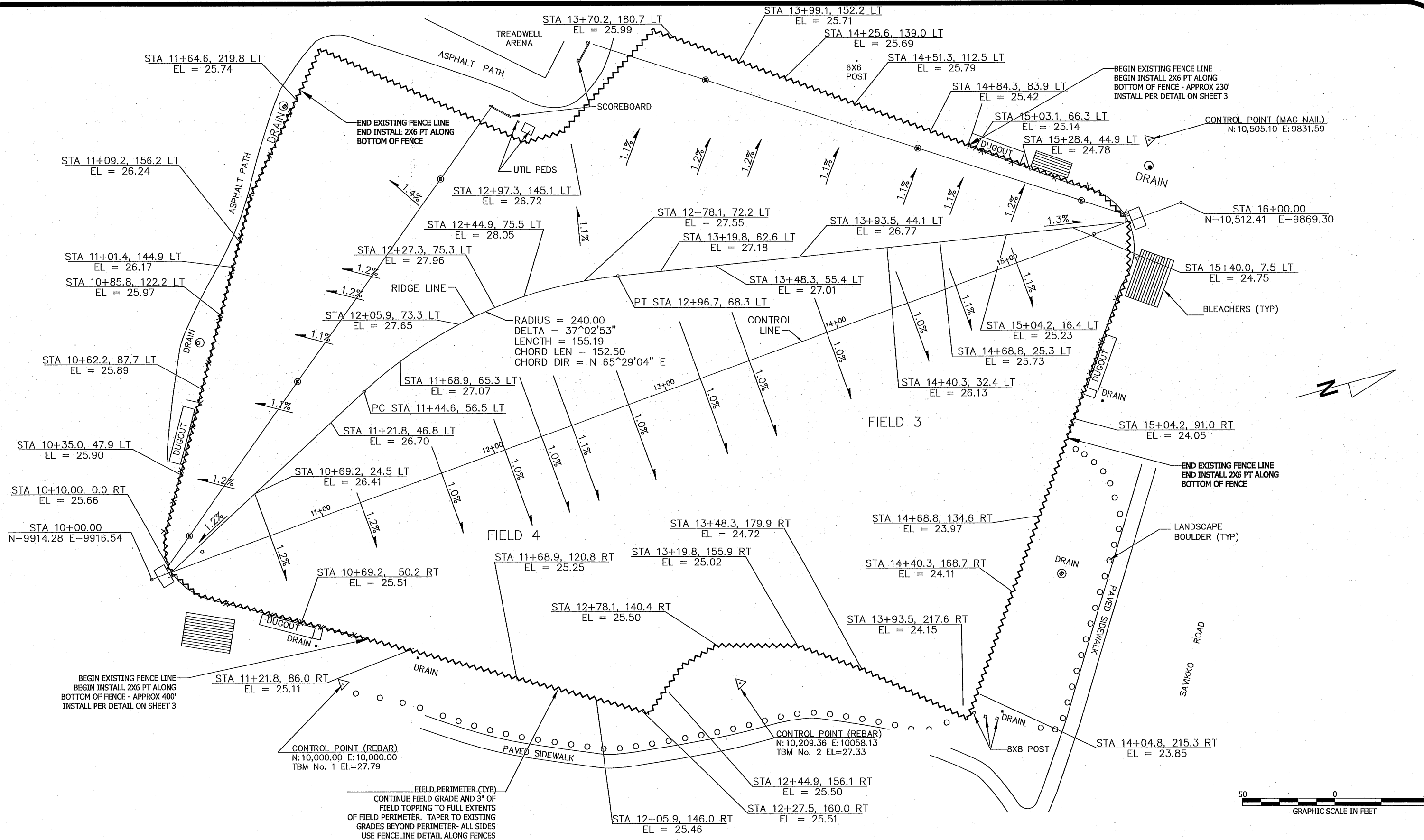

Revisions		
Date	Description	Intls.

Prepared by: **John Bohan**
 CITY AND BOROUGH OF JUNEAU
 ★ ALASKA'S CAPITAL CITY
 ENGINEERING DEPARTMENT

**SAVIKKO BALL FIELDS
 RESURFACING PROJECT**
 Contract No. E14-203

SITE AND GRADING PLAN FIELDS 3 AND 4		
DESIGNED BY: --	CHECKED BY: --	FILE: --
DATE: feb 2014	DRAWN BY: --	SCALE: As Shown

----- EXISTING FIELD SURFACE
 REGRADED EXISTING FIELD SURFACE
 _____ TOP OF NEW FIELD SURFACING

VERTICAL SCALE ENHANCED 10X HORIZONTAL SCALE

LEGEND

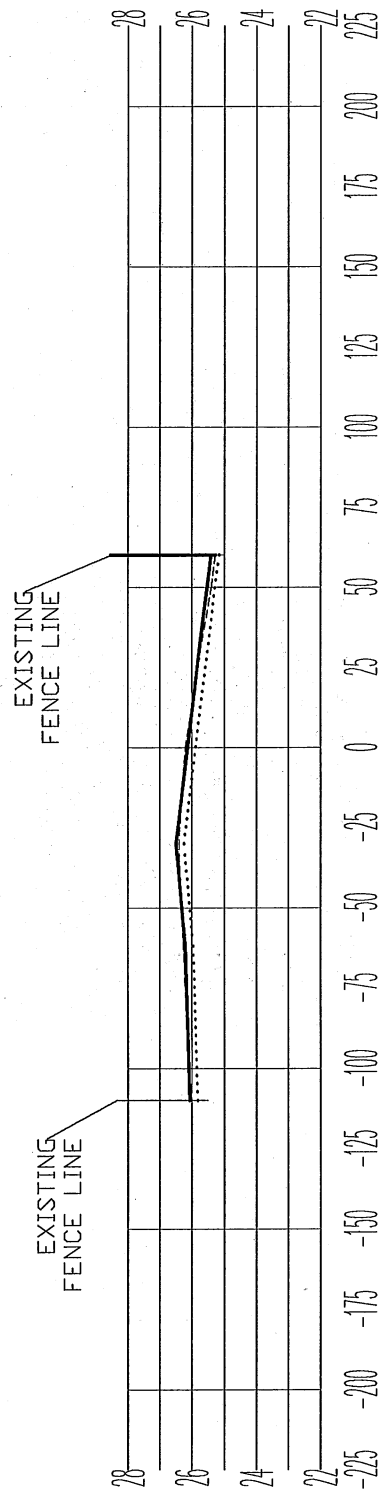

10+80

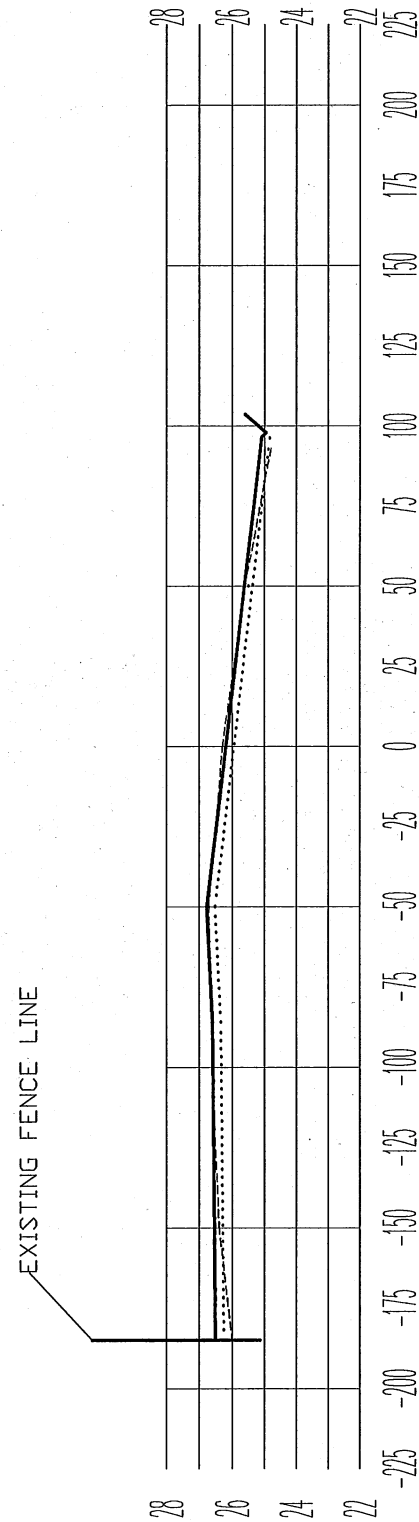

11+30

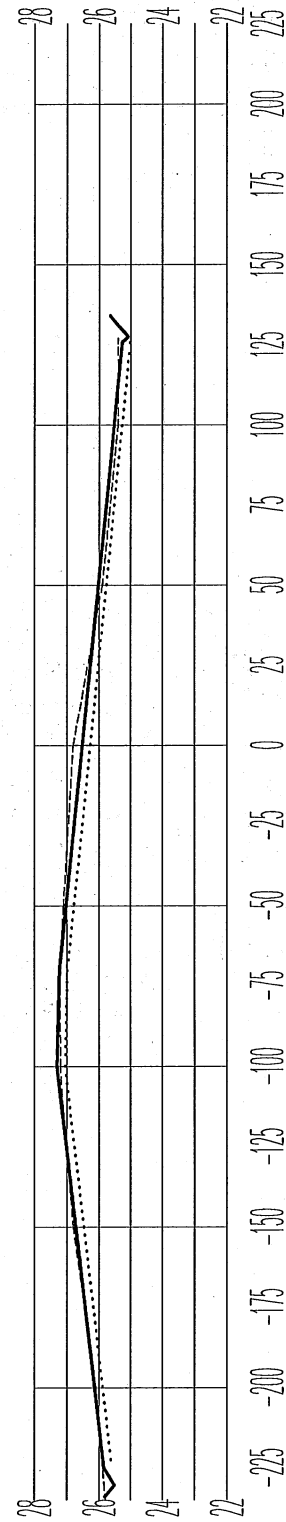

11+80

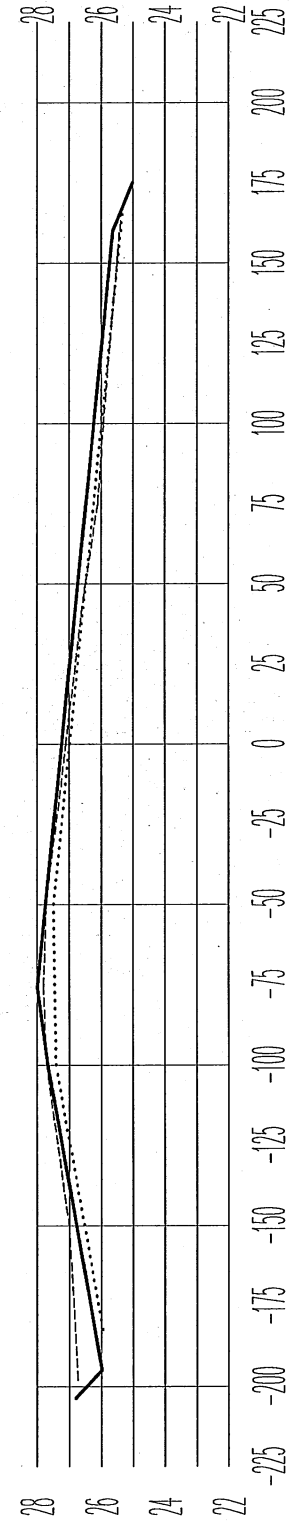

12+30

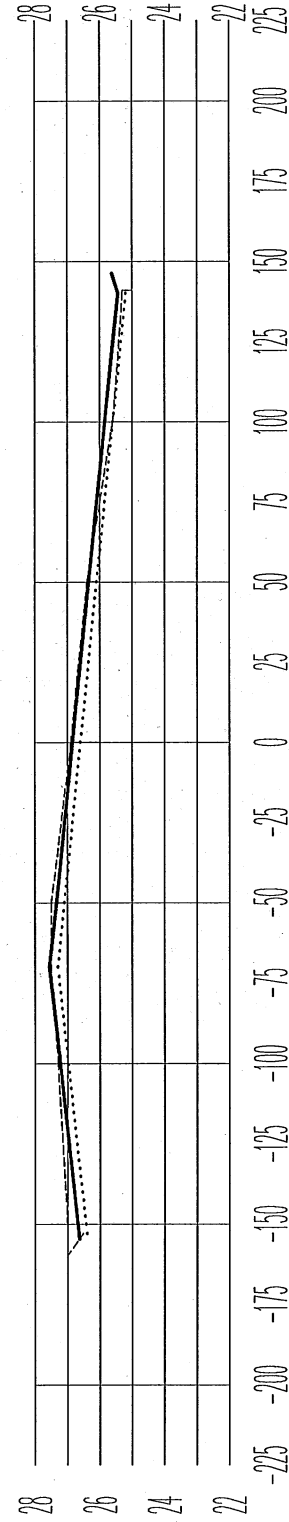

12+80

Revisions

Date	Description	Intls.



Prepared by: **3-11-14**
 CITY AND BOROUGH OF JUNEAU
 ★ ALASKA'S CAPITAL CITY
 ENGINEERING DEPARTMENT

**SAVIKKO BALL FIELDS
 RESURFACING PROJECT**

Contract No. E14-203

**CROSS SECTIONS
 FIELDS 3 AND 4**

DESIGNED BY: --	CHECKED BY: --	FILE: --
DATE: feb 2014	DRAWN BY: --	SCALE: As Shown

PAGE:

9 of 10

EXISTING FIELD SURFACE

.....

REGRADED EXISTING FIELD SURFACE

TOP OF NEW FIELD SURFACING

VERTICAL SCALE ENHANCED 10X HORIZONTAL SCALE

LEGEND

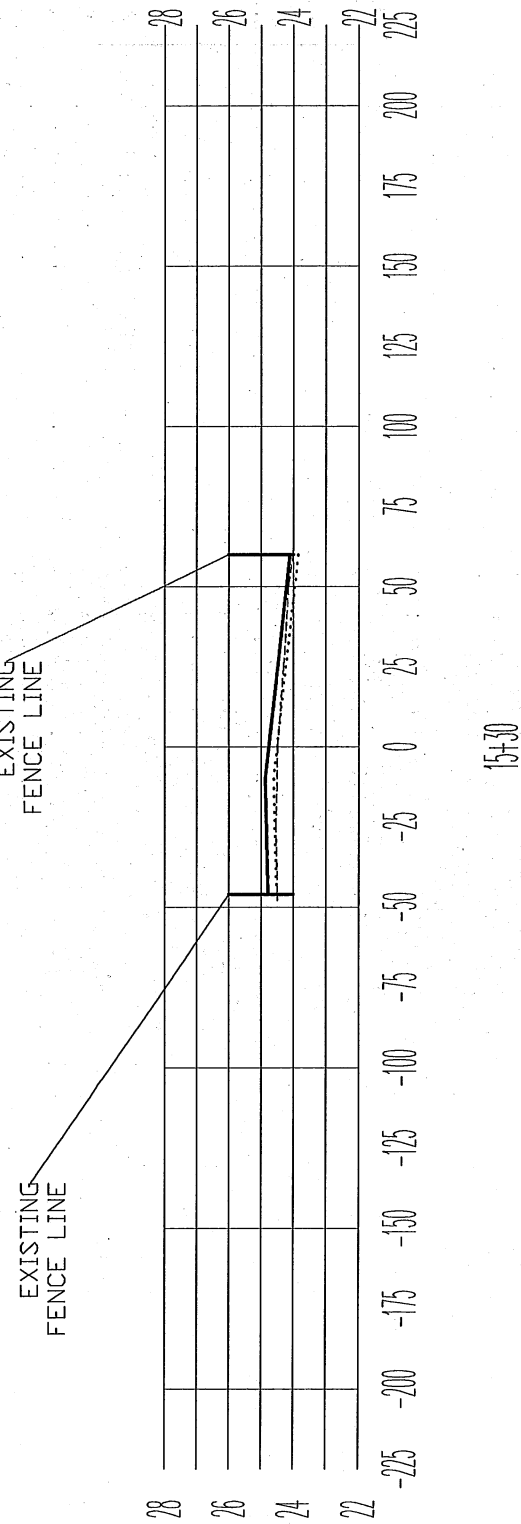
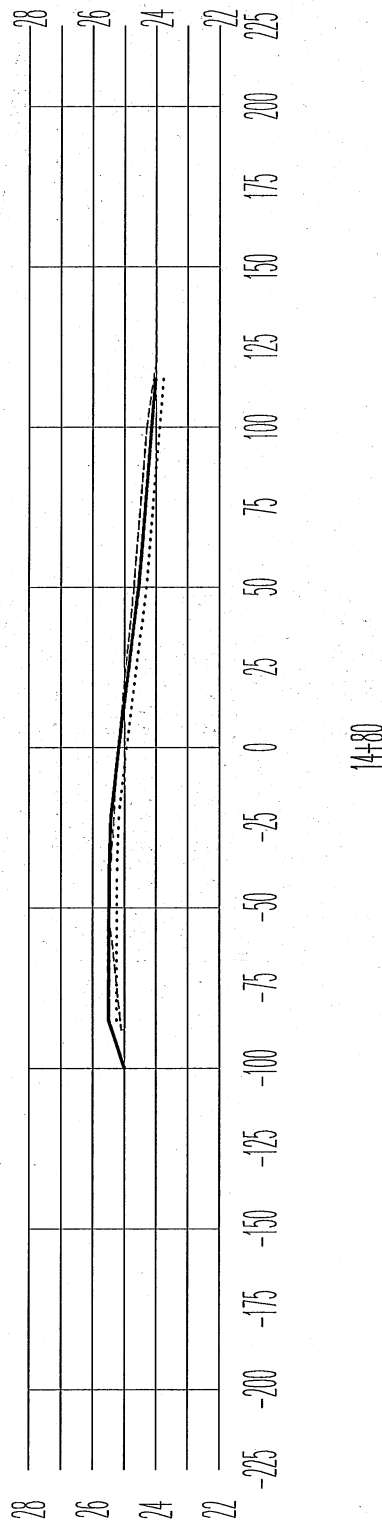
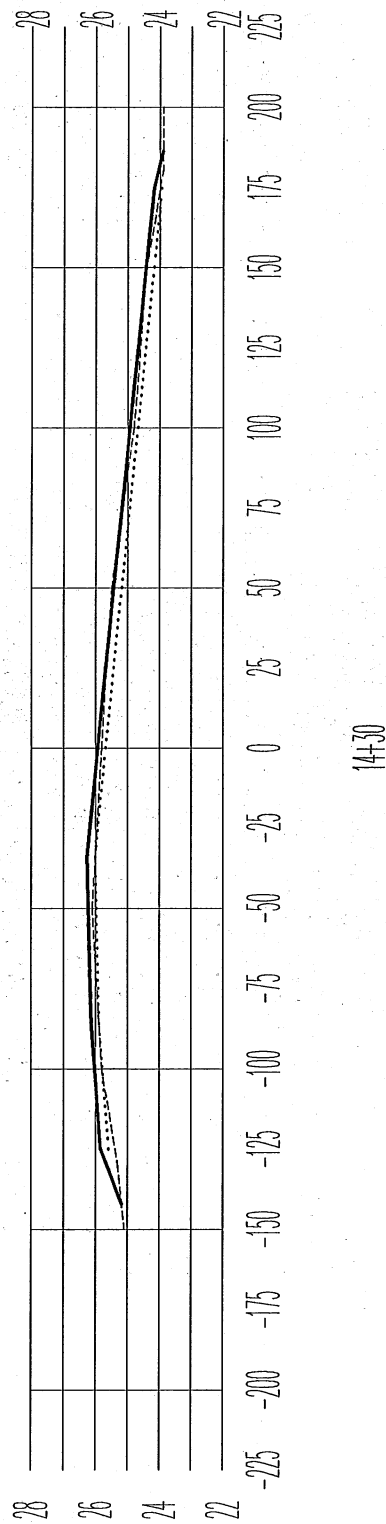
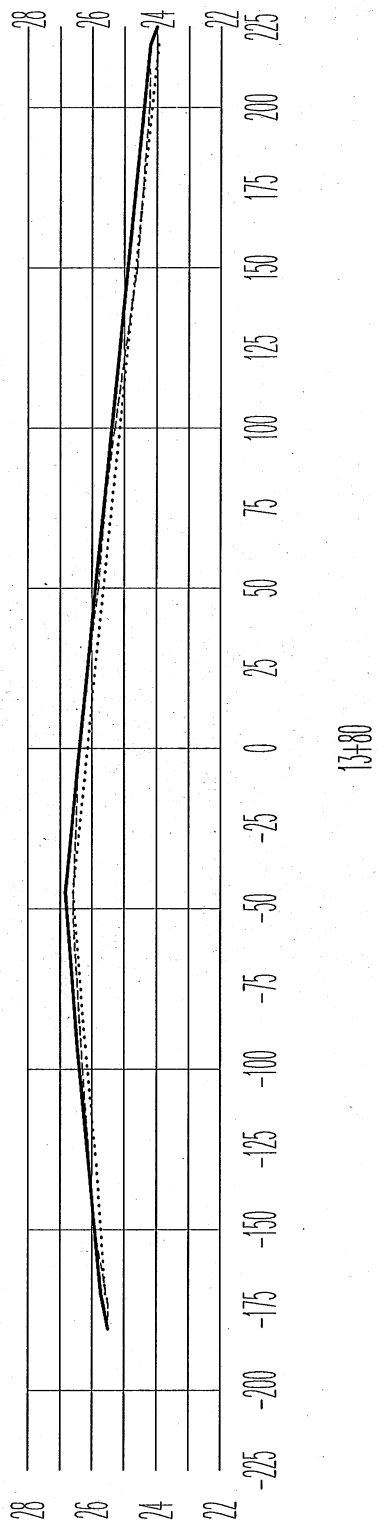
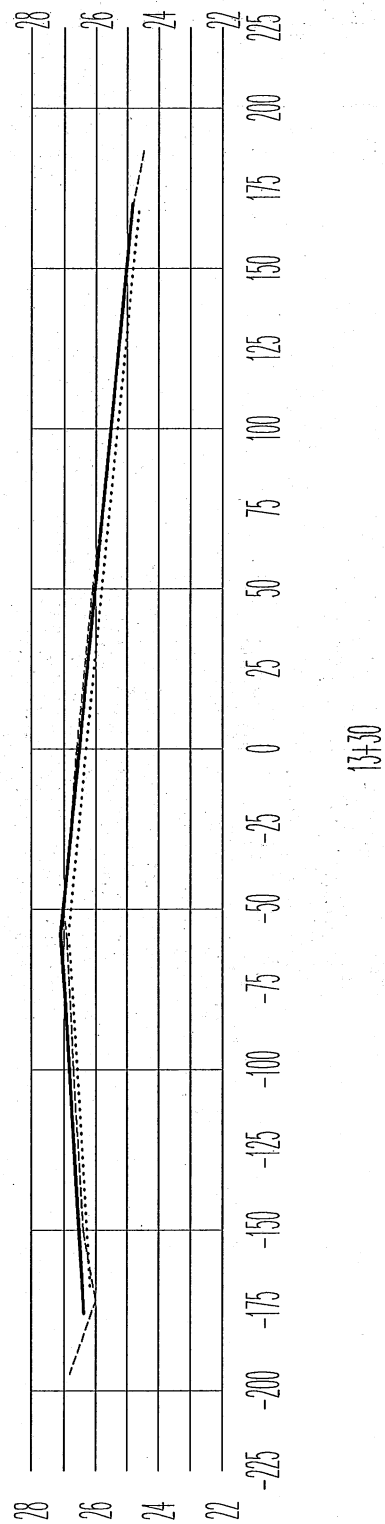

Revisions		
Date	Description	Intls.

Prepared by:

3-11-14

CITY AND BOROUGH OF JUNEAU

★ ALASKA'S CAPITAL CITY

ENGINEERING DEPARTMENT

SAVIKKO BALL FIELDS

RESURFACING PROJECT

Contract No. E14-203

CROSS SECTIONS FIELDS 3 AND 4		
DESIGNED BY: --	CHECKED BY:	FILE: --
DATE: feb 2014	DRAWN BY: --	SCALE: As Shown