

BONNIE BRAE AND RIVERWOOD DRIVE INTERSECTION PAVING IMPROVEMENTS

CONTRACT NO. E13-292

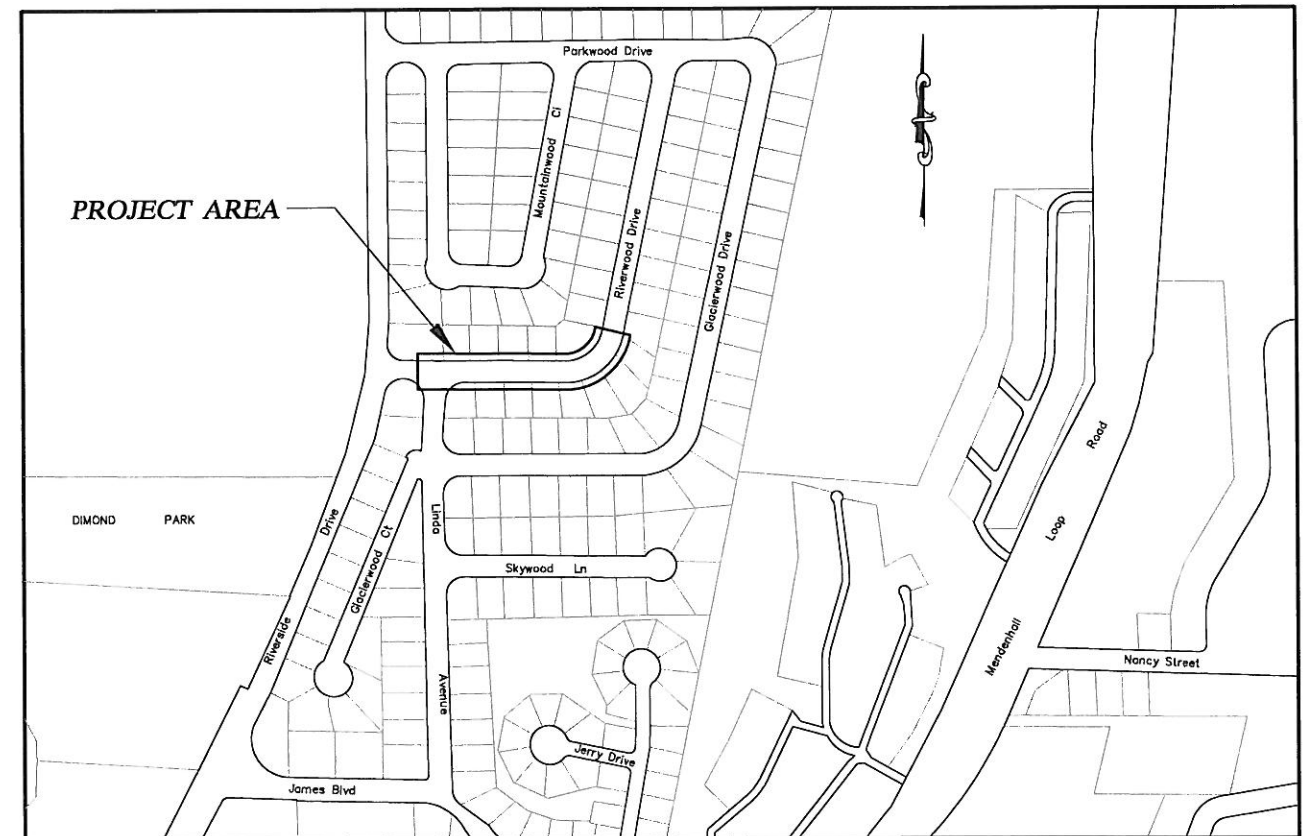
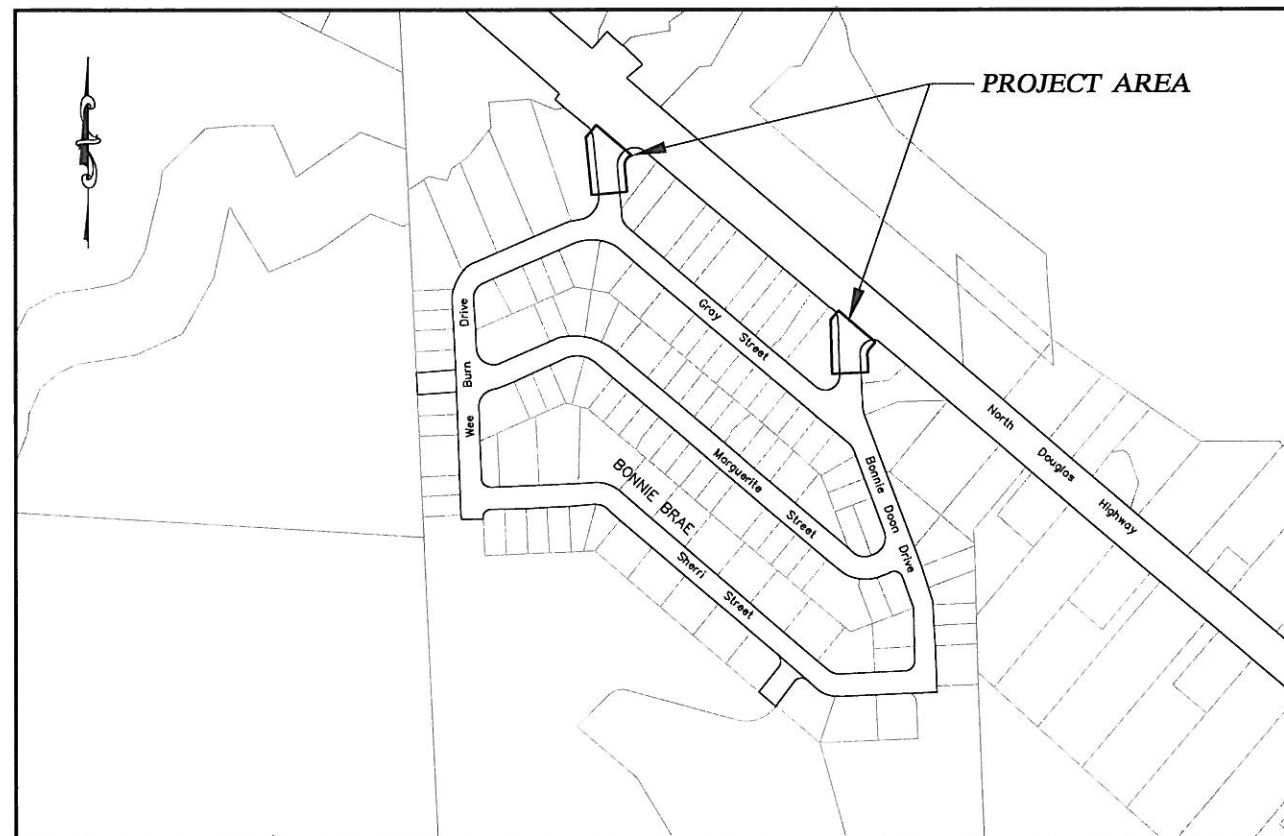

INDEX

DESCRIPTION	SHEET NO.
COVER SHEET	1 OF 6
TYPICAL SECTIONS	2 OF 6
DETAILS AND GENERAL NOTES	3 OF 6
PLAN BONNIE DOON DRIVE	4 OF 6
PLAN WEE BURN DRIVE	5 OF 6
PLAN RIVERWOOD DRIVE	6 OF 6



CITY AND BOROUGH OF JUNEAU

★ ALASKA'S CAPITAL CITY

ENGINEERING DEPARTMENT

SHEET NO.

1 of 6

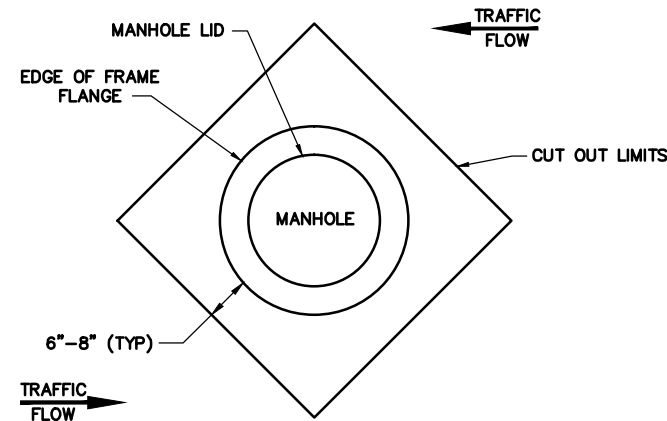

NTS

9-1/2" SHOT ROCK BORROW/D-1

2-1/2" AC PAVEMENT

APPROXIMATELY 26 LF 6" PVC UNDERDRAIN

CAP END

1% MIN

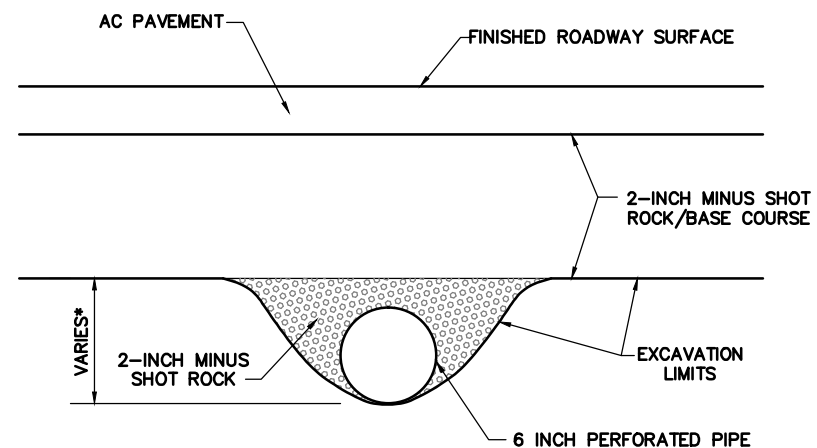

NTS

1. ALL ASPHALT PAVEMENT TO BE REMOVED AND DISPOSED OF SHALL BE PROPERLY DELIVERED TO A STOCKPILE AREA AT THE LEMON CREEK CITY PIT TO BE DESIGNATED BY THE ENGINEER. CONTACT THE ENGINEER FOR THE EXACT LOCATION OF THE STOCKPILE.
2. THE CONTRACTOR SHALL NOT STORE MATERIALS OR EQUIPMENT OR OPERATE EQUIPMENT WITH ITS TRACKS OR WHEELS PLACED ON PRIVATE PROPERTY, WITHOUT WRITTEN APPROVAL OF THE PROPERTY OWNER.
3. CONTRACTOR SHALL ASSURE GARBAGE PICKUP AND DAILY MAIL SERVICE WILL BE UNINTERRUPTED TO ALL RESIDENTS AFFECTED BY THIS PROJECT.
4. UNDERGROUND UTILITIES ARE NOT SHOWN ON THE PLANS. THE CONTRACTOR SHALL BE RESPONSIBLE FOR OBTAINING LOCATES PRIOR TO BEGINNING CONSTRUCTION. CALL BEFORE YOU DIG 586-1333.
5. CONTRACTOR SHALL USE INFRA RISER (RECYCLED RUBBER) GRADE RINGS FOR ADJUSTING/INSTALLING NEW FRAME AND LID ON MANHOLES.
6. CONTRACTOR SHALL SUBMIT TO THE ENGINEER AN EROSION AND SEDIMENT CONTROL PLAN, A COPY OF THE NOI AND DOCUMENTATION OF THEIR SUBMITTAL OF THE STORM WATER POLLUTION PREVENTION PLAN (SWPPP) TO ADEC PRIOR TO BEGINNING ANY WORK.
7. THE 4TH EDITION OF THE CBJ STANDARD DETAILS, DATED AUGUST 14, 2011, IS MADE PART OF THIS CONTRACT, WITH CURRENT REVISIONS AS APPLICABLE.
8. PROPERTY LINE LOCATIONS USED IN THESE PLANS ARE DERIVED FROM RECORD PLATS AND DO NOT REPRESENT BOUNDARY SURVEY.
9. PRIOR TO PLACEMENT OF 2" SHOT ROCK BORROW, THE EXCAVATED SURFACE SHALL BE ADEQUATELY PROOF ROLLED AS DIRECTED BY THE ENGINEER.

Revisions		
Date	Description	Intls.

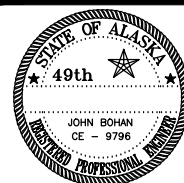

Prepared by:
CITY AND BOROUGH OF JUNEAU
★ ALASKA'S CAPITAL CITY
ENGINEERING DEPARTMENT

CONTRACT NO. E13-292

DETAILS AND GENERAL NOTES

DATE: 5/6/13

DRAWN BY: STAFF

SCALE: AS SHOWN

SHEET:
2 of 6

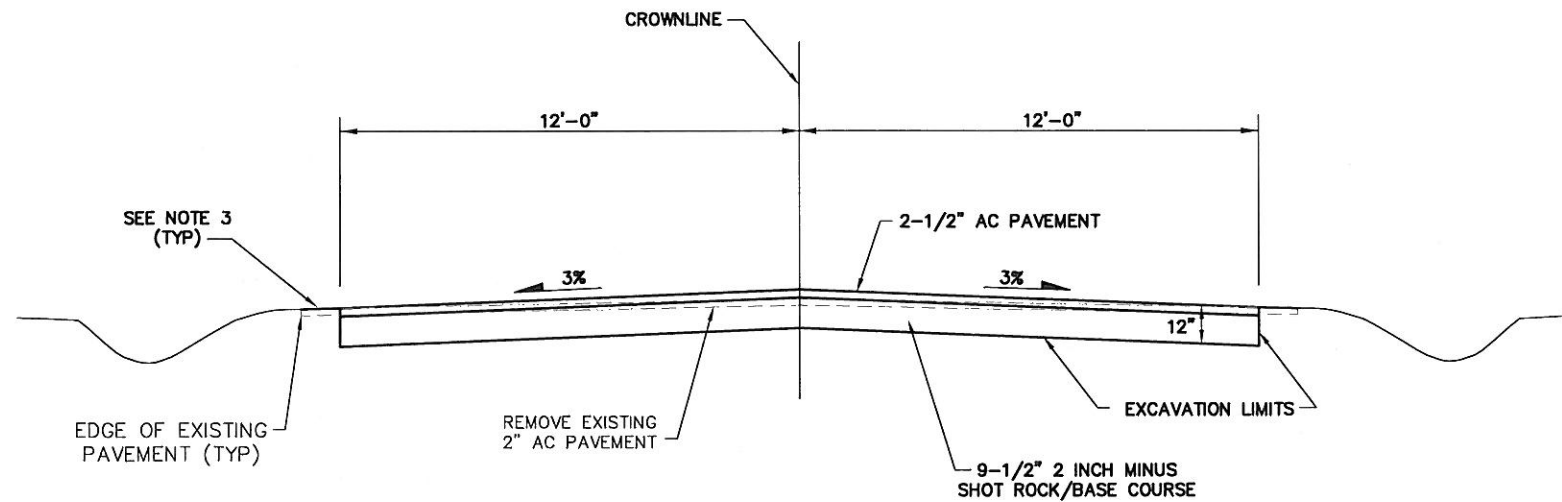

RIVERWOOD DRIVE

NTS

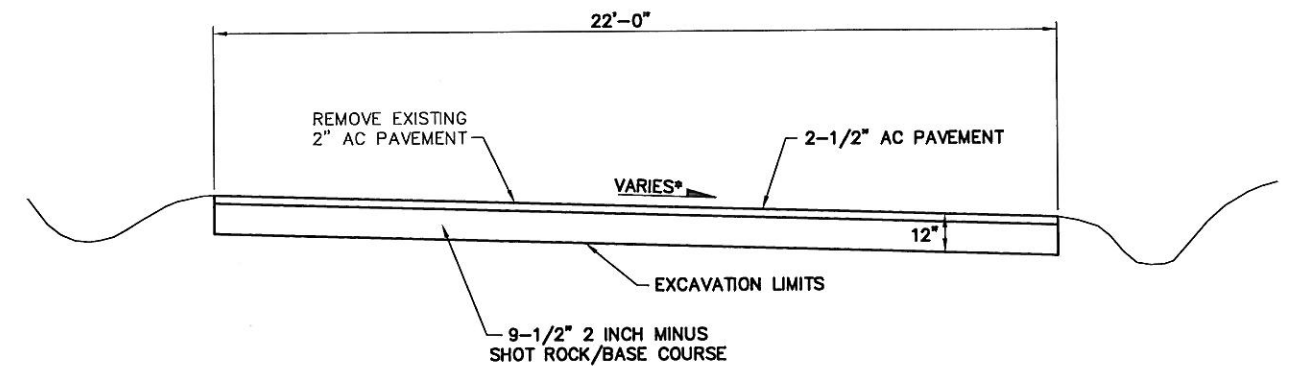

* MATCH EXISTING SLOPES TO 3% MIN.

WEE BURN DRIVE

NTS

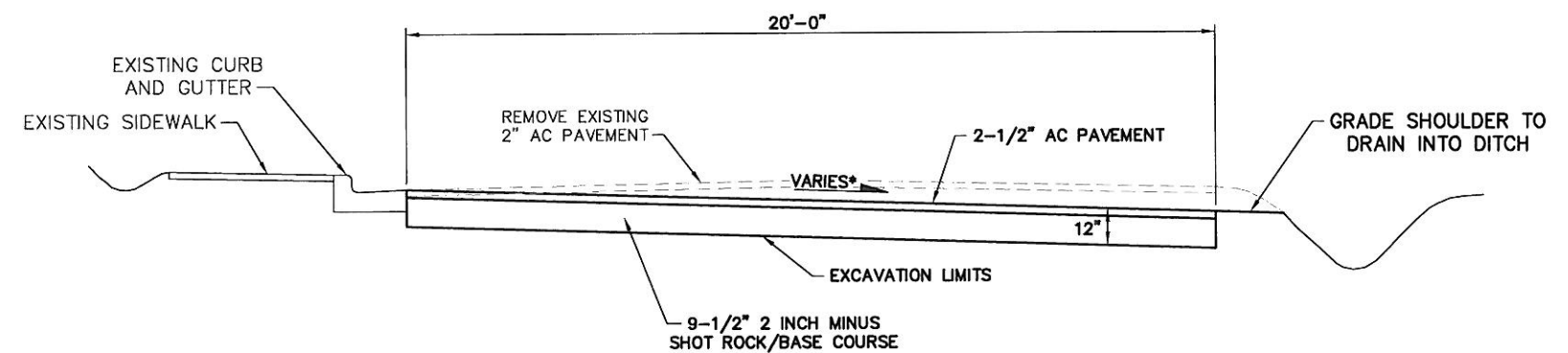

* SLOPES VARY, SEE PLAN SHEET FOR SLOPE INFORMATION

BONNIE DOON

NTS

TYPICAL SECTION NOTES

1. THE CONTRACTOR SHALL USE EXISTING EDGE OF PAVEMENT OR DRIVEWAY ELEVATIONS TO CONSTRUCT THE TYPICAL SECTIONS FOR EACH ROADWAY. THE CONTRACTOR SHALL DOCUMENT AND MAINTAIN THE EXISTING ROADWAY ALIGNMENTS WITH THE NEW ROADWAY CONSTRUCTION UNLESS NOTED OTHERWISE ON THE PLANS.
2. CONTRACTOR SHALL TAKE SPECIAL CARE NOT TO DISTURB THE AREAS OUTSIDE OF THE EXCAVATION LIMITS. IF THIS DOES OCCUR, THE AREAS MUST BE RETURNED TO ORIGINAL OR BETTER CONDITION AT THE CONTRACTORS EXPENSE.

Revisions

Date	Description	Intls.

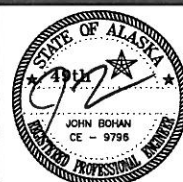

5-16-13

Prepared by:

CITY AND BOROUGH OF JUNEAU

★ ALASKA'S CAPITAL CITY

ENGINEERING DEPARTMENT

BONNIE BRAE AND RIVERWOOD DRIVE INTERSECTION PAVING IMPROVEMENTS

CONTRACT NO. E13-292

TYPICAL SECTIONS

DATE: 5/6/13

DRAWN BY: STAFF

SCALE: AS SHOWN

SHEET:

3 of 6

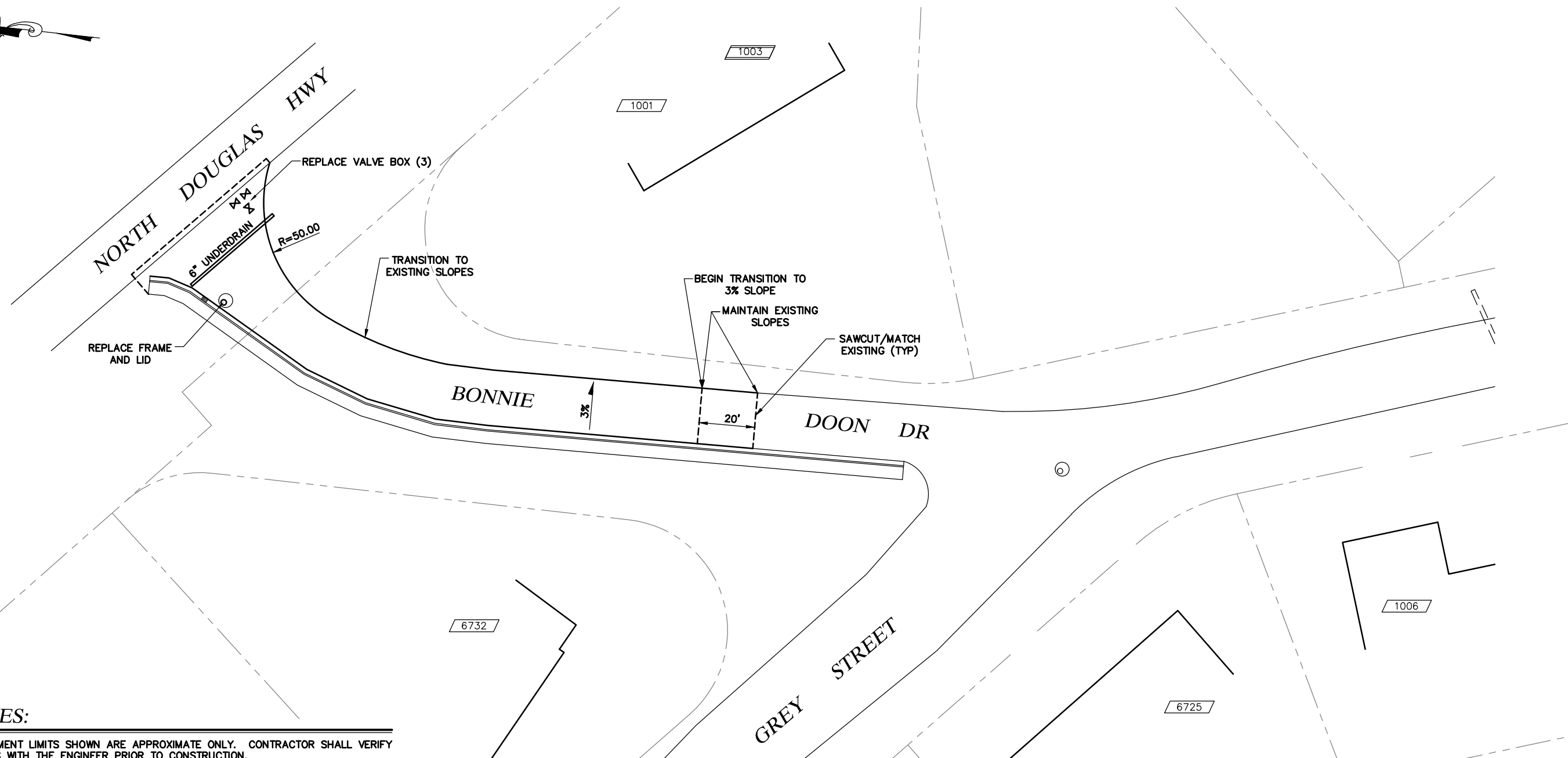

NOTES:

1. PAVEMENT LIMITS SHOWN ARE APPROXIMATE ONLY. CONTRACTOR SHALL VERIFY LIMITS WITH THE ENGINEER PRIOR TO CONSTRUCTION.
2. UNDERGROUND UTILITIES ARE NOT SHOWN ON THE PLANS. THE CONTRACTOR SHALL BE RESPONSIBLE FOR OBTAINING LOCATES PRIOR TO BEGINNING CONSTRUCTION. DIAL BEFORE YOU DIG 586-1333.



Revisions		
Date	Description	Intls.

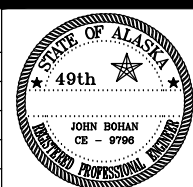

Prepared by:
CITY AND BOROUGH OF JUNEAU
★ ALASKA'S CAPITAL CITY
ENGINEERING DEPARTMENT

BONNIE BRAE AND RIVERWOOD DRIVE
INTERSECTION PAVING IMPROVEMENTS
CONTRACT NO. E13-292

PLAN
BONNIE DOON DRIVE

DATE: 5/6/13 DRAWN BY: STAFF SCALE: AS SHOWN

SHEET:
4 of 6

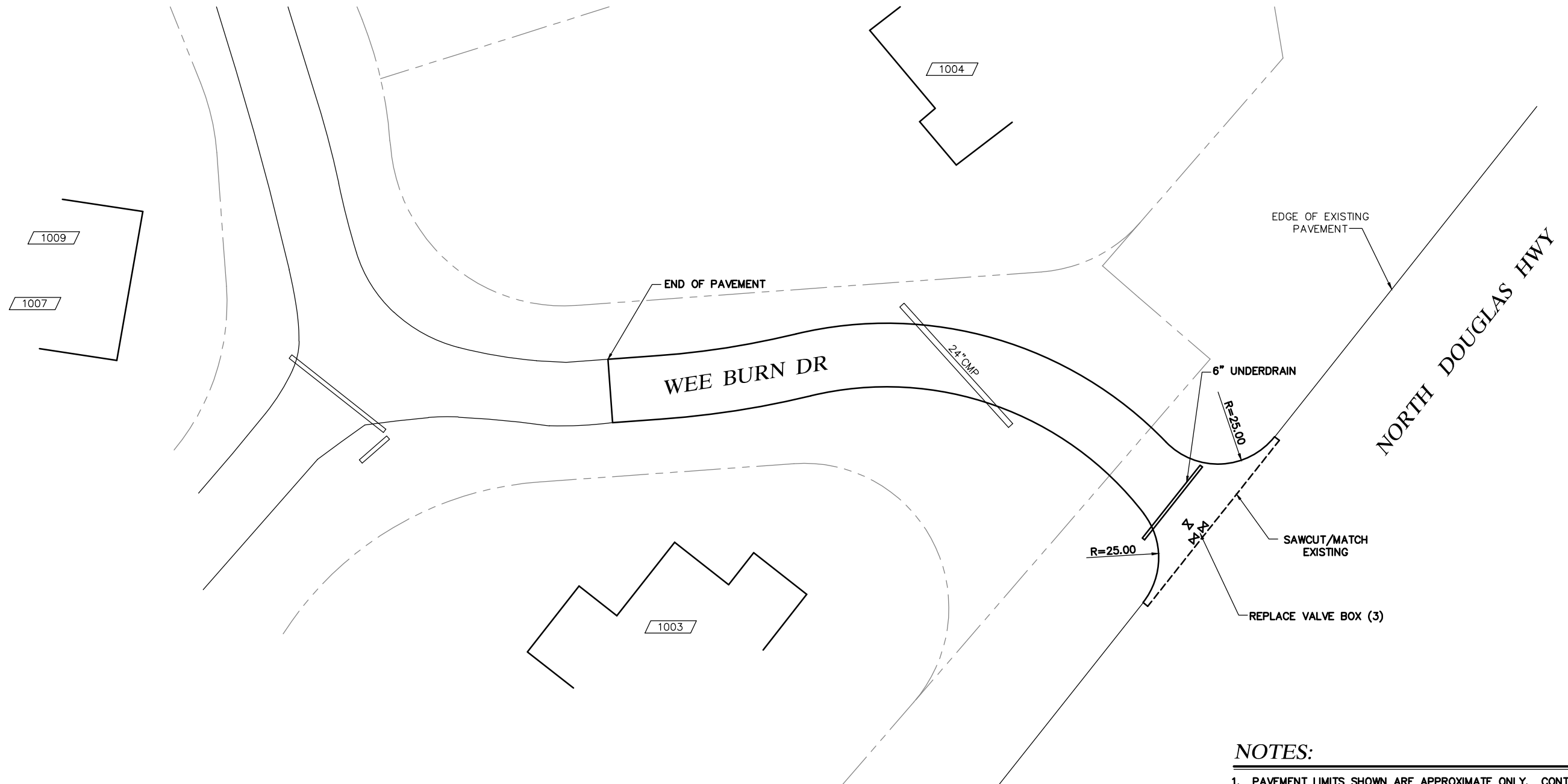

NOTES:

1. PAVEMENT LIMITS SHOWN ARE APPROXIMATE ONLY. CONTRACTOR SHALL VERIFY LIMITS WITH THE ENGINEER PRIOR TO CONSTRUCTION.
2. UNDERGROUND UTILITIES ARE NOT SHOWN ON THE PLANS. THE CONTRACTOR SHALL BE RESPONSIBLE FOR OBTAINING LOCATES PRIOR TO BEGINNING CONSTRUCTION. DIAL BEFORE YOU DIG 586-1333.

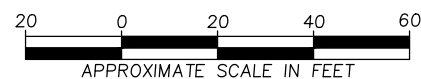

Revisions		
Date	Description	Intls.

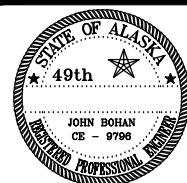

Prepared by:
CITY AND BOROUGH OF JUNEAU
★ ALASKA'S CAPITAL CITY
ENGINEERING DEPARTMENT

BONNIE BRAE AND RIVERWOOD DRIVE
INTERSECTION PAVING IMPROVEMENTS
CONTRACT NO. E13-292

PLAN
WEE BURN DRIVE

DATE: 5/6/13

DRAWN BY: STAFF

SCALE: AS SHOWN

SHEET:
5 of 6

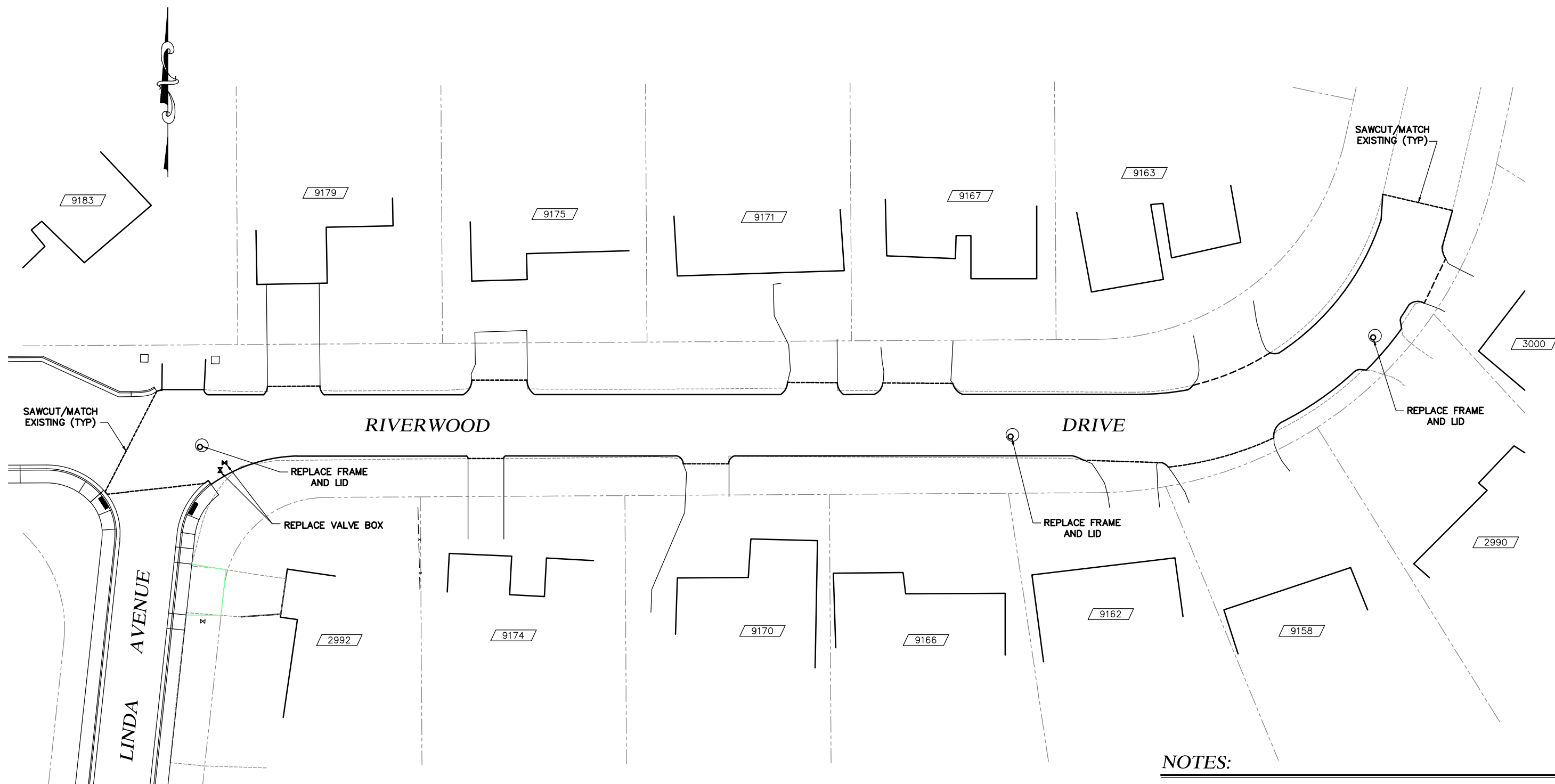

NOTES:

1. PAVEMENT LIMITS SHOWN ARE APPROXIMATE ONLY. CONTRACTOR SHALL VERIFY LIMITS WITH THE ENGINEER PRIOR TO CONSTRUCTION.
2. UNDERGROUND UTILITIES ARE NOT SHOWN ON THE PLANS. THE CONTRACTOR SHALL BE RESPONSIBLE FOR OBTAINING LOCATES PRIOR TO BEGINNING CONSTRUCTION. DIAL BEFORE YOU DIG 586-1333.
3. 6" UNDERDRAINS, NOT SHOWN, SHALL BE INSTALLED APPROXIMATELY EVERY 150 FEET. FINAL LOCATION TO BE DETERMINED BY THE ENGINEER.



Revisions		
Date	Description	Intls.

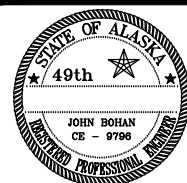

Prepared by:
CITY AND BOROUGH OF JUNEAU
★ ALASKA'S CAPITAL CITY
ENGINEERING DEPARTMENT

BONNIE BRAE AND RIVERWOOD DRIVE
INTERSECTION PAVING IMPROVEMENTS
CONTRACT NO. E13-292

PLAN
RIVERWOOD DRIVE

DATE: 5/6/13 DRAWN BY: STAFF SCALE: AS SHOWN

SHEET:
6 of 6