

# AREA WIDE STREET SURFACING IMPROVEMENTS

CONTRACT NO. E13-255

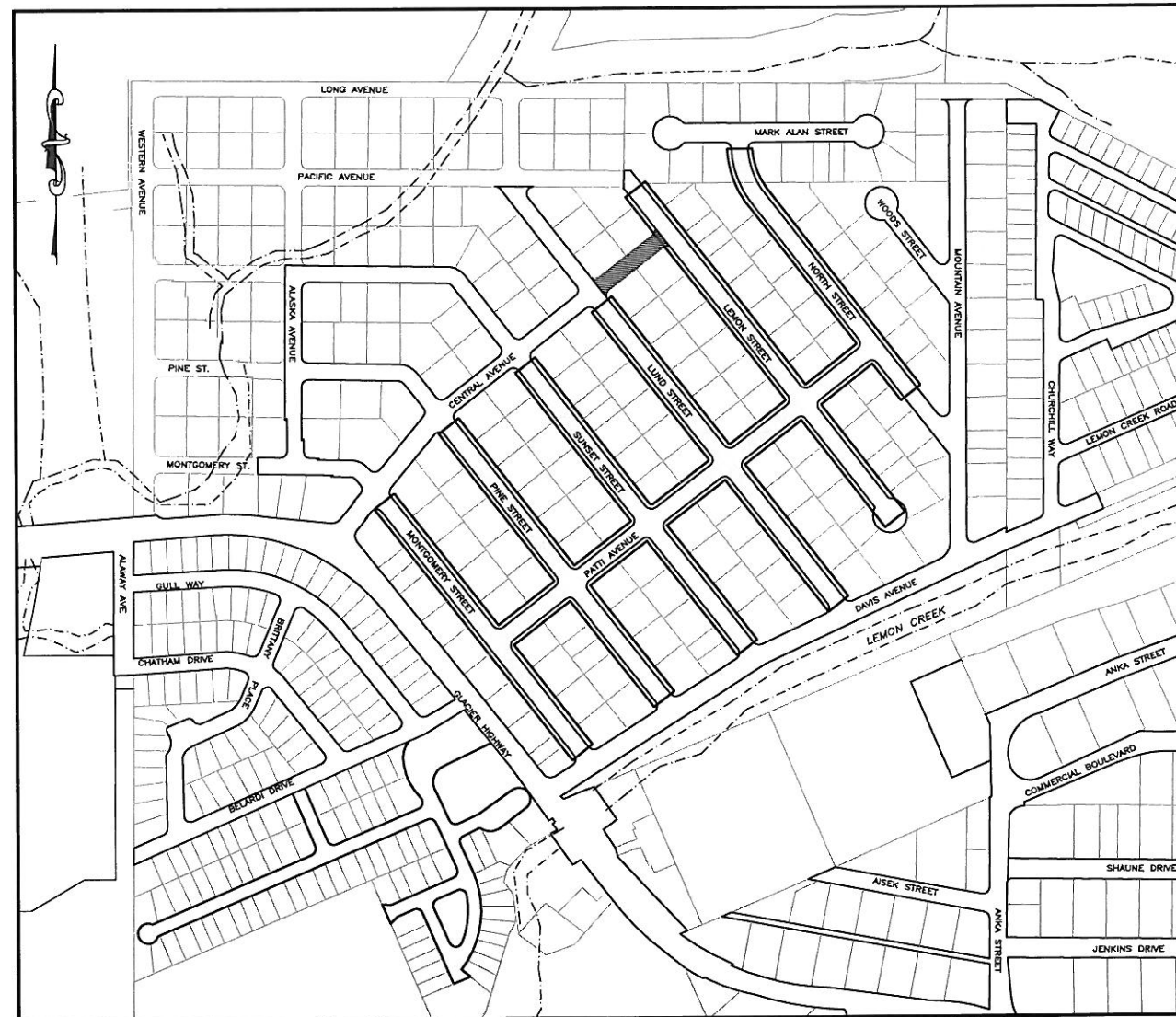

PROJECT AREA

## INDEX

DESCRIPTION	SHEET NO.
COVER SHEET	1 OF 5
TYPICAL SECTION, DETAILS AND GENERAL NOTES	2 OF 5
PLAN SHEET ONE	3 OF 5
PLAN SHEET TWO	4 OF 5
PLAN SHEET THREE	5 OF 5



CITY AND BOROUGH OF JUNEAU  
★ ALASKA'S CAPITAL CITY

ENGINEERING DEPARTMENT

SHEET NO.

1 of 5

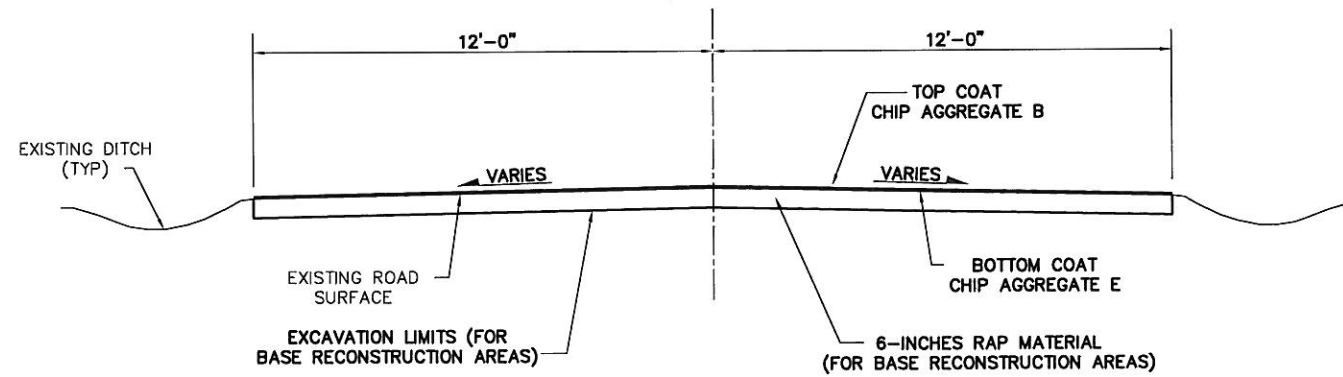

**TYPICAL SECTION**

NTS

**GENERAL NOTES:**

1. THE CONTRACTOR SHALL NOT STORE MATERIALS OR EQUIPMENT OR OPERATE EQUIPMENT WITH ITS TRACKS OR WHEELS PLACED ON PRIVATE PROPERTY, WITHOUT WRITTEN APPROVAL OF THE PROPERTY OWNER.
2. CONTRACTOR SHALL ASSURE GARBAGE PICKUP AND DAILY MAIL SERVICE WILL BE UNINTERRUPTED TO ALL RESIDENTS AFFECTED BY THIS PROJECT.
3. UNDERGROUND UTILITIES ARE NOT SHOWN ON THE PLANS. THE CONTRACTOR SHALL BE RESPONSIBLE FOR OBTAINING LOCATES PRIOR TO BEGINNING CONSTRUCTION. DIAL BEFORE YOU DIG 586-1333.
4. CONTRACTOR SHALL USE INFRA RISER (RECYCLED RUBBER) GRADE RINGS FOR ADJUSTING FRAME AND LID ON MANHOLES.
5. RAP MATERIAL FOR THE RECONSTRUCTED BASE AREAS WILL BE SUPPLIED BY THE CBJ AT NO COST TO THE CONTRACTOR. THE CONTRACTOR IS REQUIRED TO FILL OUT A WEIGHT TICKET ON ALL TRUCKS.
6. ALL CHIP MATERIALS COLLECTED DURING FINAL SWEEPING SHALL BE REMOVED FROM THE CONSTRUCTION AREAS.

Revisions		
Date	Description	Intls.

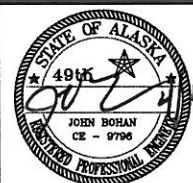

Prepared by:  
 CITY AND BOROUGH OF JUNEAU  
 ★ ALASKA'S CAPITAL CITY  
 ENGINEERING DEPARTMENT

**AREA WIDE STREET  
 SURFACING IMPROVEMENTS**  
 CONTRACT NO. E13-255

**TYPICAL SECTION, DETAILS  
 AND GENERAL NOTES**

DATE: 4/8/13

DRAWN BY: STAFF

SCALE: AS SHOWN

SHEET:  
 2 of 5



MATCHLINE  
SEE SHEET FOUR

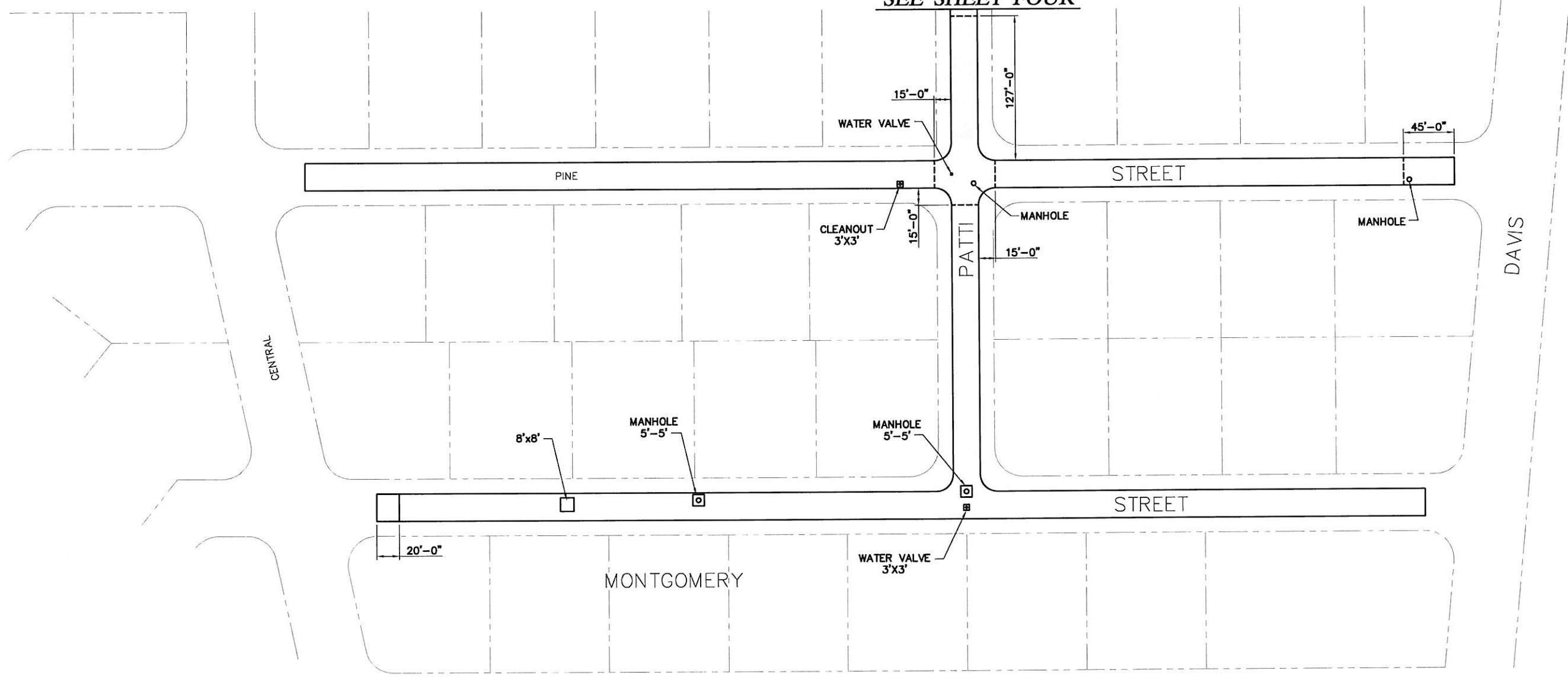

**NOTES**

1. AREAS THAT ARE SHADED REQUIRE REMOVAL OF TOP 6 INCHES OF SURFACE AND BASE AND REPLACED WITH RAP PRIOR TO CHIP SEAL OPERATIONS. SEE TYPICAL SECTION ON SHEET TWO.
2. CONTRACTOR SHALL VERIFY BASE RECONSTRUCTION AREAS WITH THE ENGINEER PRIOR TO CONSTRUCTION.

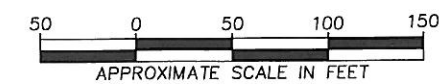

Revisions		
Date	Description	Intls.

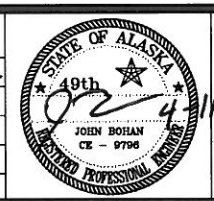

Prepared by:  
CITY AND BOROUGH OF JUNEAU  
★ ALASKA'S CAPITAL CITY  
ENGINEERING DEPARTMENT

**AREA WIDE STREET  
SURFACING IMPROVEMENTS  
CONTRACT NO. E13-255**

**PLAN SHEET ONE**

DATE: 4/8/13      DRAWN BY: STAFF      SCALE: AS SHOWN

SHEET:  
**3** of **5**

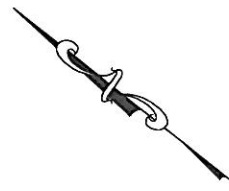

MATCHLINE  
SEE SHEET FIVE

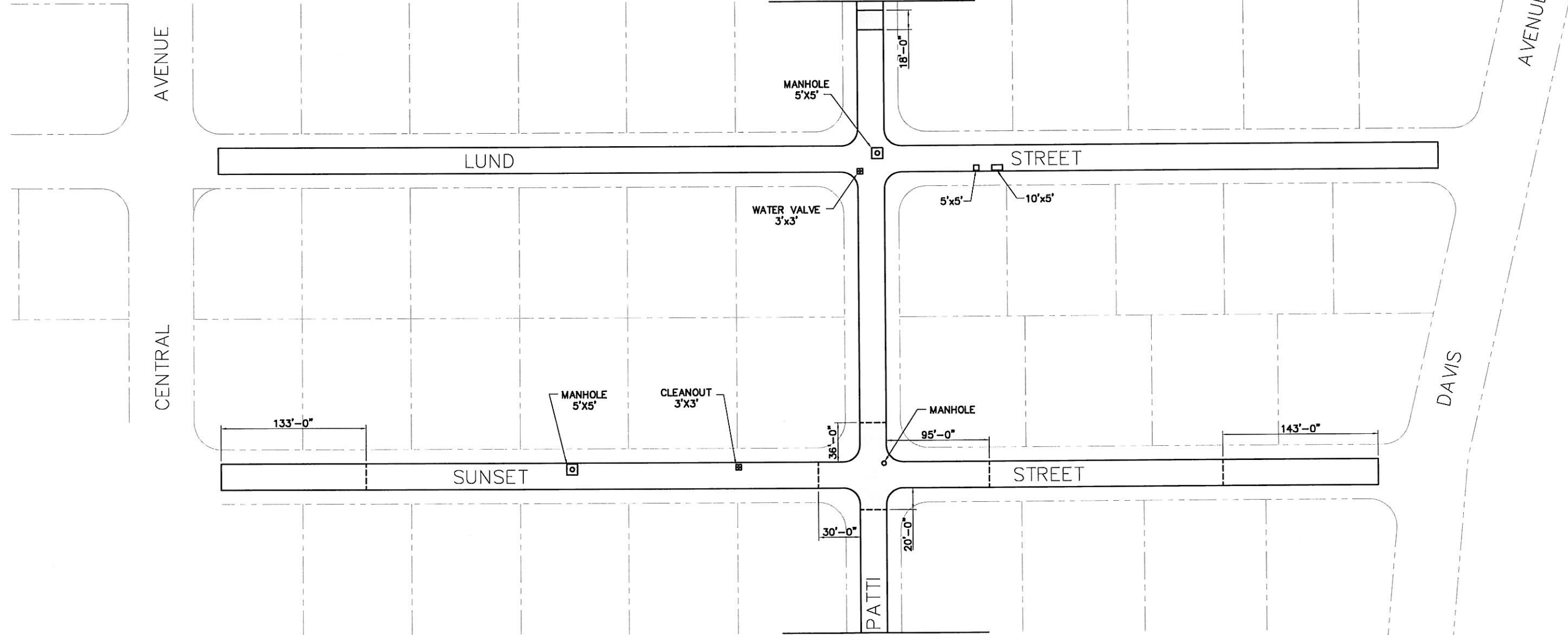

MATCHLINE  
SEE SHEET THREE

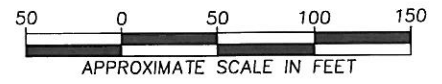

**NOTES**

1. AREAS THAT ARE SHADED REQUIRE REMOVAL OF TOP 6 INCHES OF SURFACE AND BASE AND REPLACED WITH RAP PRIOR TO CHIP SEAL OPERATIONS. SEE TYPICAL SECTION ON SHEET TWO.
2. CONTRACTOR SHALL VERIFY BASE RECONSTRUCTION AREAS WITH THE ENGINEER PRIOR TO CONSTRUCTION.

Revisions		
Date	Description	Intls.

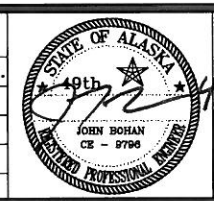

Prepared by:  
CITY AND BOROUGH OF JUNEAU  
★ ALASKA'S CAPITAL CITY  
ENGINEERING DEPARTMENT

**AREA WIDE STREET  
SURFACING IMPROVEMENTS  
CONTRACT NO. E13-255**

**PLAN SHEET TWO**

DATE: 4/8/13      DRAWN BY: STAFF      SCALE: AS SHOWN

SHEET:  
**4** of **5**

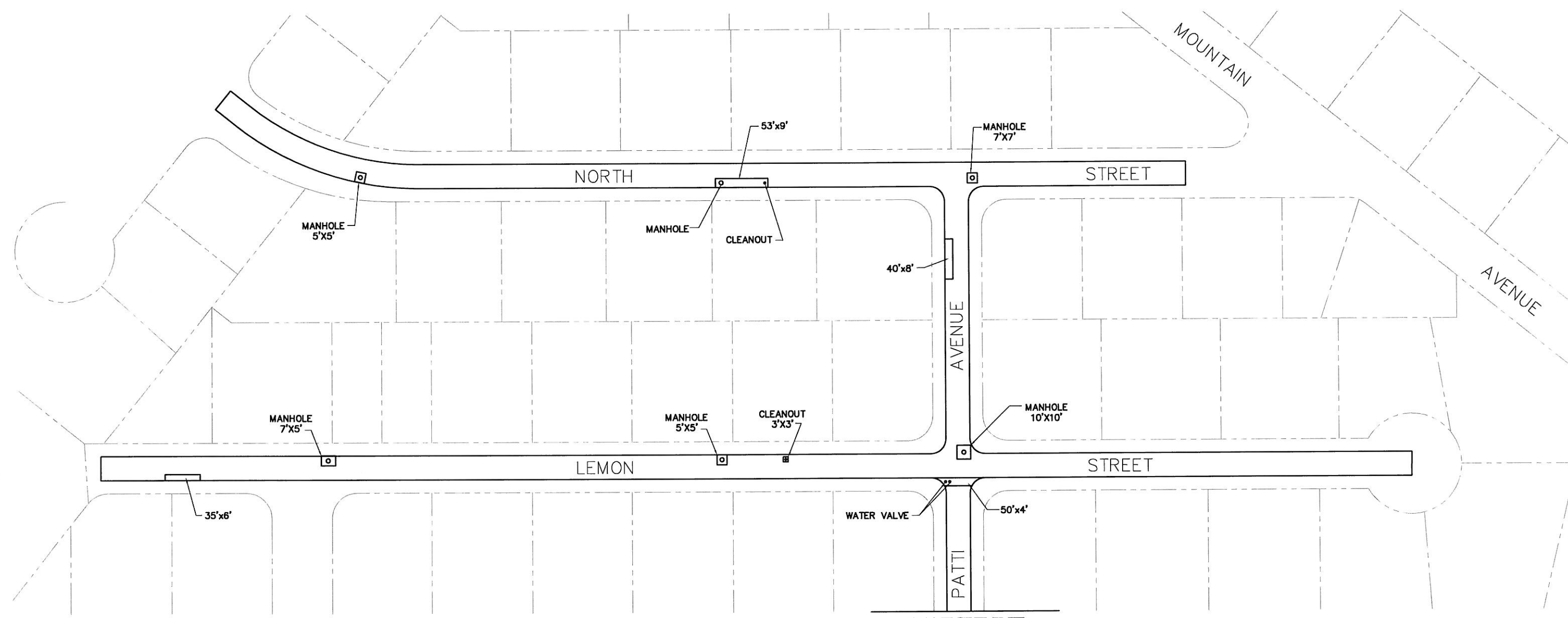
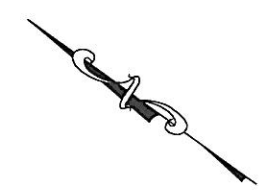

MATCHLINE  
SEE SHEET FOUR

**NOTES**

1. AREAS THAT ARE SHADED REQUIRE REMOVAL OF TOP 6 INCHES OF SURFACE AND BASE AND REPLACED WITH RAP PRIOR TO CHIP SEAL OPERATIONS. SEE TYPICAL SECTION ON SHEET TWO.
2. CONTRACTOR SHALL VERIFY BASE RECONSTRUCTION AREAS WITH THE ENGINEER PRIOR TO CONSTRUCTION.

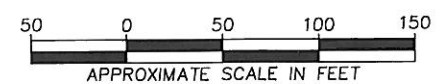

Revisions		
Date	Description	Intls.

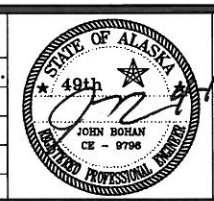

Prepared by:  
CITY AND BOROUGH OF JUNEAU  
★ ALASKA'S CAPITAL CITY  
ENGINEERING DEPARTMENT

**AREA WIDE STREET  
SURFACING IMPROVEMENTS**  
CONTRACT NO. E13-255

**PLAN SHEET THREE**

DATE: 4/8/13      DRAWN BY: STAFF      SCALE: AS SHOWN

SHEET:  
**5** of **5**