



ENGINEERING DEPARTMENT

**ADDENDUM TO THE CONTRACT
for the
Auke Bay Elementary
School Renovation Re-Bid
Contract No. E12-216**

ADDENDUM NO.: TWO

**CURRENT DEADLINE FOR BIDS:
March 8, 2012**

PREVIOUS ADDENDA: ONE

ISSUED BY: City and Borough of Juneau
ENGINEERING DEPARTMENT
155 South Seward Street
Juneau, Alaska 99801

DATE ADDENDUM ISSUED: February 28, 2012

The following items of the contract are modified as herein indicated. All other items remain the same. This addendum has been issued and is posted online. Please refer to the CBJ Engineering Contracts Division webpage at: <http://www.juneau.org/engineering ftp/contracts/Contracts.php>

INFORMATION ITEM: All addenda previously issued with cancelled bid E12-042 are incorporated by reference and should **not** be acknowledged with the re-bidding of this project. Please only acknowledge addenda issued under Re-Bid No. E12-216 on the Bid form, Section 00300.

PROJECT MANUAL RE-BID PACKET:

1. Section 011000 Summary 1.5 4. Phase 1 Site Work: **Add** the following at the end of the first paragraph: "At the contractor's option, All site work other than Power Sewer and Water can occur in either the summer of phase one or the summer of phase 3 when school is not in session".
2. Section 011000 Summary 1.5 4. Phase 1 Building: **Add** the following at the end of the first paragraph: "Phase 1 early substantial completion required for 1st floor toilet rooms 112 and 113 and vestibule 156 including connecting corridor leading to existing entry. These areas are required to be complete and ready for occupancy on August 14, 2012.
3. Section 012300 Alternates: **Add** section 012300 Alternates labeled Addendum 2.
4. Section 015000 Temporary Facilities and Controls 3.4 K 4.: **Delete** paragraph K.4.
5. Section 061600 Sheathing: **Replace** 2.6 Underlayment (Acoustical) with the following: 2.6 Underlayment
 - A. Plywood Underlayment for Resilient Flooring: DOC PS 1, Exterior A-C Exposure 1 Underlayment with fully sanded face.
 - B. Plywood Underlayment for Ceramic Tile: DOC PS 1, Exterior, C-C Plugged, not less than 5/8-inch (15.9-mm) nominal thickness, for ceramic tile set in EGP (exterior glue plywood) latex-portland cement mortar.
 - C. Plywood Underlayment for Carpet: DOC PS 1, Exterior, C-C Plugged Exposure 1, Underlayment.
6. Section 074660 Fiber Cement Board Siding: **Add** section 074660 Fiber Cement Board Siding labeled Addendum 2.
7. Section 085313 Vinyl Windows: **Add** section 085313 Vinyl Windows labeled Addendum 2.
8. Section 092900 Gypsum Board 3.7 D: **Replace** paragraphs 4& 5 with the following paragraphs 4&5

4. Level 4: At panel surfaces that will be semi exposed to view such as walls behind open joint wood plank unless otherwise indicated.
5. Level 5: At panel surfaces that will be exposed to view unless otherwise indicated.

DRAWINGS:

9. Sheet A101: **Replace** sheet A101 in its entirety with the attached A101 CBJ project number E12-216. *Note: additional information on installation of 6 portables will be included in a subsequent addendum.*
10. Sheet A900 Key Note 901: **Add** the following after Paint: "Where surface is exposed".
11. Sheet A900 Key note 9130 **change** 3/8" underlayment to 1/2" plywood underlayment.
12. Sheet A909 Detail 1: **Delete** key note 9128 and in lieu of 2 layers of underlayment (note 9130 top and bottom), provide one layer of underlayment (note 9130).

CONTRACT E12-042 ADDENDUM:

13. Contract E12-042 Addendum Three Item 21 sheet C100 & Item 22 sheet C101; **Delete** these items in their entirety. The existing sewer pipe has been found to be PVC pipe, not AC pipe. Removal of sewer pipe required according to original documents.

Enc.:

1. Section 012300 Alternates
2. Section 074660 Fiber Cement Board Siding
3. Section 085313 Vinyl Windows
4. Sheet A101



By: _____
Jennifer Mannix,
Contract Administrator

Date: February 28, 2012

Total number of pages contained within this Addendum: 18

SECTION 012300 - ALTERNATES

PART 1 - GENERAL

1.1 RELATED DOCUMENTS

- A. Drawings and general provisions of the Contract, including General and Supplementary Conditions and other Division 01 Specification Sections, apply to this Section.

1.2 SUMMARY

- A. Section includes administrative and procedural requirements for alternates.

1.3 DEFINITIONS

- A. Alternate: An amount proposed by bidders and stated on the Bid Form for certain work defined in the bidding requirements that may be added to deducted from the base bid amount if Owner decides to accept a corresponding change either in the amount of construction to be completed or in the products, materials, equipment, systems, or installation methods described in the Contract Documents.
 - 1. Alternates described in this Section are part of the Work only if enumerated in the Agreement.
 - 2. The cost or credit for each alternate is the net addition to or deduction from the Contract Sum to incorporate alternate into the Work. No other adjustments are made to the Contract Sum.

1.4 PROCEDURES

- A. Alternates will be either Additive Alternates or Deductive Alternates as indicated.
- B. Coordination: Revise or adjust affected adjacent work as necessary to completely integrate work of the alternate into Project.
 - 1. Include as part of each alternate, miscellaneous devices, accessory objects, and similar items incidental to or required for a complete installation whether or not indicated as part of alternate.
- C. Notification: Immediately following award of the Contract, notify each party involved, in writing, of the status of each alternate. Indicate if alternates have been accepted, rejected, or deferred for later consideration. Include a complete description of negotiated revisions to alternates.
- D. Execute accepted alternates under the same conditions as other work of the Contract.
- E. Schedule: A schedule of alternates is included at the end of this Section. Specification Sections referenced in schedule contain requirements for materials necessary to achieve the work described under each alternate.

SECTION 012300 - ALTERNATES

PART 2 - PRODUCTS (Not Used)

PART 3 - EXECUTION

3.1 SCHEDULE OF DEDUCTIVE ALTERNATES

- A. Deductive Alternate No. 1: Fiber Cement Siding & Soffit.
1. Base Bid: Siding -Plastic decking siding (section 066120) identified by note 826 on sheet A800 with rain screen furring channels and fasteners at 24” oc identified by note 807 on sheet A800. Soffit – Plywood identified by note 841 Sheet A800.
 2. Alternate: Siding - In lieu of plastic decking siding with channels spaced at 24” oc; Provide Fiber Cement Board siding (section 074660) with hat channels spaced at 16” oc. (note 807). Soffit - In lieu of plywood soffit provide Fiber Cement Board soffit (section 074660).
- B. Deductive Alternate No. 2: Vinyl Windows.
1. Base Bid: Fiberglass Windows (section 085413)
 2. Alternate: Vinyl Windows (section 085313) In lieu of fiberglass windows Provide Vinyl windows.

3.2 SCHEDULE OF ADDITIVE ALTERNATES

- A. Alternate No. 3 (formerly alternate 1&7 now combined) : Landscaping: soils, mulch, plants, shrubs, trees and Landscaping/Civil features and accessories.
1. Base Bid: Provide excavation and 4” depth of planting soil and plant with Type A seed mix (turf), in all areas indicated on sheet L101 – L105 to receive soil, plants, shrubs or trees. Provide planting soil and type B and C seed mix where indicated on L104. Provide flag pole. Provide square edge of concrete slab 4/C306, 8” thick as shown without 6” curb and without 1’-6” wave wall shown in 3/C306,1/L502 and 2/L502. Omit boulders shown on L102 and 7/L501. Omit sound tubes shown on L101, 3/L502, 4/L502, 5/L502 & 6/L502. Omit Utility Screens shown on L101 and 5/L503 Omit benches and trash cans.
 2. Alternate: Provide Rock Mulch, Landscape edging, soils, plants, shrubs, trees, native grasses and native grass and wildflower mix as indicated on L101 - L105. : Provide curb shown on 4/C306 and wave wall shown in 3/C306,1/L502 and 2/L502. Provide boulders shown on L102 and 7/L501 Provide sound tubes shown on L101, 3/L502, 4/L502, 5/L502 and 6/L502. Provide Utility Screens shown on L101 and 5/L503. Provide benches and trash cans.
- B. Alternate No. 4 (formerly alternate 2) : Landscape/Civil Paving patterns.

SECTION 012300 - ALTERNATES

1. Base Bid: Sheets L101 Provide 7.5'x7.5' square grid of control joints and expansion joints, without wave lines and without board walk pattern shown from end of finger to entry on L101. All concrete in base bid will be non colored concrete.
 2. Alternate: In lieu of base bid paving patterns and non colored concrete, provide paving patterns, concrete type and finishes indicated on L101
- C. Alternate No. 5 (formerly alternate 3 and 4 now combined) : Site lighting & Main Entry Canopy.
1. Base Bid: Provide three exterior pole mounted AD lights along the bus drop off/ pick up as indicated on Sheet E101. Provide a portion of the main entry canopy including structure, roofing and lighting indicated on sheet A205 and S700 including 4 bays 5 columns and an overhang at the south end of 5'-0" from center line of column.
 2. Alternate: Provide exterior pole mounted AB lights shown on E100. Provide remaining portion of canopy shown on A205 and S700 consisting of 3 column bays and 3 columns and overhang.
- D. Alternate No. 6: (formerly alternate 5 and 6 now combined) Wall cabinets above 7' and Telescoping Stands.
1. Base Bid: Provide all base cabinets, counter tops and wall cabinets below 7'-0" measured from the finish floor. Omit Telescoping Stands.
 2. Alternate: Provide all wall cabinets shown above 7'-0" measured from finish floor. Provide wall attached telescoping stands as indicated on A403 and specified in section 126600

END OF SECTION

SECTION 074660 – FIBER CEMENT SIDING

PART 1 - GENERAL

1.1 RELATED DOCUMENTS

- A. Drawings and general provisions of the Contract, including General and Supplementary Conditions and Division 01 Specification Sections, apply to this Section.

1.2 SUMMARY

A. Section Includes:

1. Fiber-cement siding.
2. Fiber-cement soffit.

B. Related Sections:

1. Section 061000 – Rough Carpentry
2. Section 064013 – Exterior Architectural Woodwork
3. Section 072500 – Weather Barriers

1.3 DEFINITIONS

- A. Siding: Fiber Cement Trim boards installed in a rain screen system as primary exterior finish.

1.4 SUBMITTALS

- A. Submit under provisions of Section 013300

B. Product Data: For each type of product indicated, provide:

1. Material descriptions, dimensions and profiles.
2. Preparation instructions and recommendations.
3. Manufacturer's requirements for water resistive barrier, paint, etc. to be installed by others.
4. Storage and handling requirements and recommendations.
5. Installations methods, including nailing patterns.

- C. Samples for Initial Selection: For siding and soffit including related accessories from manufacturer's full line of colors.

D. Samples for Verification: For each type, color, texture, and pattern required.

1. 12 inch long by actual width Sample of siding.
2. 24 inch wide by 36 inch high Sample of soffit panel.

SECTION 074660 – FIBER CEMENT SIDING

1.5 CLOSEOUT SUBMITTALS

- A. Maintenance Data: For each type of siding and soffit and related accessories to include in maintenance manuals.

1.6 MAINTENANCE MATERIAL SUBMITTALS

- A. Furnish extra materials that match products installed and that are packaged with protective covering for storage and identified with labels describing contents.
 - 1. Furnish full lengths of siding and soffit including related accessories, in a quantity equal to 2 percent of amount installed.

1.7 QUALITY ASSURANCE

- A. Labeling: Provide fiber-cement siding that is tested and labeled according to ASTM C 1186 by a qualified testing agency acceptable to authorities having jurisdiction.
- B. Source Limitations: Obtain each type, color, texture, and pattern of siding and soffit, including related accessories, from single source from single manufacturer.
- C. Installer Qualifications: Provide installer with not less than three years of experience with products similar to those specified.
- D. Pre-installation Conference: Conduct conference at Project site.

1.8 DELIVERY, STORAGE, AND HANDLING

- A. Store products off the ground, on a flat surface, and under a roof or separate waterproof covering.

1.9 COORDINATION

- A. Coordinate installation with flashings and other adjoining construction to ensure proper sequencing.

1.10 WARRANTY

- A. Special Warranty: Standard form in which manufacturer agrees to repair or replace siding and soffit that fail(s) in materials or workmanship within specified warranty period.
 - 1. Failures include, but are not limited to, the following:
 - a. Structural failures including cracking, deforming.
 - b. Deterioration of metals, metal finishes, and other materials beyond normal weathering.

SECTION 074660 – FIBER CEMENT SIDING

2. Warranty Period:
 - a. Siding: 25 years from date of Substantial Completion.
 - b. Soffits: 50 years from date of Substantial Completion.
 - c. Coating: 15 years from date of Substantial Completion.

PART 2 - PRODUCTS

2.1 MANUFACTURER

- A. Basis-of-Design Product: Subject to compliance with requirements, provide products by CertainTeed Corporation.
- B. Substitutions: Allowed in accordance with provisions of Section 012500.

2.2 FIBER-CEMENT PRODUCTS

- A. General: ASTM C 1186, Type A, Grade II, fiber-cement board, noncombustible when tested according to ASTM E 136; with a flame-spread index of 25 or less when tested according to ASTM E 84.

2.3 SIDING (TRIM BOARD)

- A. CertainTeed WeatherBoards Trim, or equal.
 1. Thickness: 3/4 inch
 2. Width: 5-1/2 inches.
 3. Texture: Wood grain or reversible wood grain / smooth installed with wood grain visible.
 4. Factory Finish: Factory applied CertainTeed ColorMax Finishing System 100% acrylic solid color, selected from manufacturer's full line of colors.

2.4 SOFFIT BOARD

- A. CertainTeed Soffit / Porch Panel or equal.
 1. Thickness: 1/4 inch.
 2. Width: 48 inches.
 3. Length: 8 feet, plus or minus 1/8 inch.
 4. Texture: Wood grain.
 5. Factory Finish: Factory applied CertainTeed ColorMax Finishing System 100% acrylic solid color, selected from manufacturer's full line of colors.
- B. Ventilation: Provide an unperforated soffit.

SECTION 074660 – FIBER CEMENT SIDING

2.5 ACCESSORIES

- A. Flashing: Provide flashing complying with Section 076200 "Sheet Metal Flashing and Trim" at window and door heads and where indicated.
- B. Fasteners: Provide siding nails of sufficient length to penetrate hat channels or a minimum of 1-1/4 inches into solid furring or sheathing; hot-dipped galvanized or stainless steel.
- C. Water resistive barrier: Provide barrier complying with Section 072500 "Weather Barriers" where indicated.
- D. Touch Up Kit: Provide CertainTeed ColorMax touch-up kit, or equal, for each color provided.

PART 3 - EXECUTION

3.1 EXAMINATION

- A. Examine substrates for compliance with requirements for installation tolerances and other conditions affecting performance of siding and soffit and related accessories.
- B. Proceed with installation only after unsatisfactory conditions have been corrected.

3.2 PREPARATION

- A. Clean substrates of projections and substances detrimental to application.

3.3 INSTALLATION

- A. General: Comply with siding and soffit manufacturer's written installation instructions applicable to products and applications indicated unless more stringent requirements apply.
 - 1. Do not install damaged components.
- B. Prior to installation of siding and trim, install water resistive barrier and flashings as required to provide a weather resistant substrate. Install furring where indicated.
- C. Install fiber-cement siding and soffit and related accessories.
 - 1. Read warranty and comply with all terms necessary to maintain warranty coverage.
 - 2. Touch up all field cut edges before installing with touch-up kit from manufacturer.
 - 3. Install fasteners no more than 16 inches o.c.; use (2) aligned fasteners, top and bottom, at each furring strip.
 - 4. Pre-drill nail holes if necessary to prevent breakage.
- D. Avoid butt joints in horizontal siding where possible; where joints are inevitable, stagger joints between successive courses. Follow manufacturer's installation instructions for treatment of butt joints.

SECTION 074660 – FIBER CEMENT SIDING

- E. Do not install siding less than 6 inches from the surface of ground nor closer than 1 inch to roofs, paving and other surfaces where water may collect.
- F. Allow space between ends of soffit panels that butt against trim or dissimilar materials for thermal movement; seal joint with exterior grade sealant.
- G. After installation, seal joints in accordance with manufacturer's installation instructions. Seal around all penetrations within soffit. Paint all exposed cut edges with touch-up kit from manufacturer.

3.4 ADJUSTING AND CLEANING

- A. Touch-up, repair or replace damaged products before Substantial Completion.
- B. Clean finished surfaces according to manufacturer's written instructions and maintain in a clean condition during construction.

END OF SECTION

SECTION 085313 - VINYL WINDOWS

PART 1 - GENERAL

1.1 RELATED DOCUMENTS

- A. Drawings and general provisions of the Contract, including General and Supplementary Conditions and Division 01 Specification Sections, apply to this Section.

1.2 SUMMARY

- A. Section includes fixed and operable vinyl-framed windows.

1.3 PREINSTALLATION MEETINGS

- A. Preinstallation Conference: Conduct conference at Project site.
 - 1. Review and finalize construction schedule and verify availability of materials, Installer's personnel, equipment, and facilities needed to make progress and avoid delays.
 - 2. Review, discuss, and coordinate the interrelationship of vinyl windows with other exterior wall components. Include provisions for anchoring, flashing, weeping, sealants, and protecting finishes.
 - 3. Review and discuss the sequence of work required to construct a watertight and weathertight exterior building envelope.
 - 4. Inspect and discuss the condition of substrate and other preparatory work performed by other trades.
 - 5. Review phasing and installation requirements for each phase.

1.4 ACTION SUBMITTALS

- A. Product Data: For each type of product.
 - 1. Include construction details, material descriptions, glazing and fabrication methods, dimensions of individual components and profiles, hardware, and finishes for vinyl windows.
- B. Shop Drawings: Include plans, elevations, sections, hardware, accessories, insect screens, operational clearances, and details of installation, including anchor, flashing, and sealant installation.
- C. Samples: For each exposed product and for each color specified, **2 by 4 inches (50 by 100 mm)** in size. Submit a sample of each extrusion to be used in the window including weather strip and glazing gaskets.

SECTION 085313 - VINYL WINDOWS

- D. Samples for Initial Selection: For units with factory-applied color finishes.
 - 1. Include similar Samples of hardware and accessories involving color selection.
- E. Product Schedule: For vinyl windows. Use same designations indicated on Drawings.

1.5 INFORMATIONAL SUBMITTALS

- A. Qualification Data: For manufacturer and Installer.
- B. Product Test Reports: For each type of vinyl window, for tests performed by a qualified testing agency demonstrating conformance to performance criteria indicated.
- C. Sample Warranties: For manufacturer's warranties.

1.6 QUALITY ASSURANCE

- A. All windows shall be marked with AAMA/NWWDA & NFRC certification labels in accordance with requirements of the applicable reference standards.
- B. Manufacturer Qualifications: A manufacturer capable of fabricating vinyl windows that meet or exceed performance requirements indicated and of documenting this performance by test reports and calculations. Manufacturer with a history producing the model and series of window indicated for a period of one year or more.
- C. Installer Qualifications: An installer acceptable to vinyl window manufacturer for installation of units required for this Project.

1.7 WARRANTY

- A. Manufacturer's Warranty: Manufacturer agrees to repair or replace vinyl windows that fail in materials or workmanship within specified warranty period. Warranty shall cover all materials labor and installation cost.
 - 1. Failures include, but are not limited to, the following:
 - a. Failure to meet performance requirements.
 - b. Structural failures including excessive deflection, water leakage, and air infiltration.
 - c. Faulty operation of movable sash and hardware.
 - d. Deterioration of materials and finishes beyond normal weathering.
 - e. Failure of insulating glass.
 - 2. Warranty Period:
 - a. Window and hardware: 20 years from date of Substantial Completion.

SECTION 085313 - VINYL WINDOWS

- b. Glazing Units: 10 years from date of Substantial Completion.

PART 2 - PRODUCTS

2.1 MANUFACTURERS

- A. **Basis-of-Design Product:** Subject to compliance with requirements, provide Capitol Glass Northern Window Series 3255, (2300 E 63rd Ave Anchorage AK) Vinyl window or comparable product by another manufacturer:
- B. Substitutions: Allowed in accordance with Section 012500.
- C. Source Limitations: Obtain vinyl windows from single source from single manufacturer.

2.2 WINDOW PERFORMANCE REQUIREMENTS

- A. Product Standard: Comply with AAMA/WDMA/CSA 101/I.S.2/A440 for definitions and minimum standards of performance, materials, components, accessories, and fabrication unless more stringent requirements are indicated.
- B. Performance Class and Grade: AAMA/WDMA/CSA 101/I.S.2/A440 as follows:
1. Minimum Performance Class operable windows: C.
 2. Minimum Performance Grade operable windows: 60.
 3. Minimum Performance Class fixed windows: C.
 4. Minimum Performance Grade fixed windows: 80.
- C. Thermal Transmittance U: Glass shall be triple glazed sealed insulating units. Two layers low e coat filled with argon gas. NFRC 100 maximum whole-window U-factor for awning or casement windows of **0.2 Btu/sq. ft. x h x deg F or less**. NFRC 100 maximum whole-window U-factor for fixed windows of **0.15 Btu/sq. ft. x h x deg F or less**
- D. Condensation Resistance CR: An awning or casement window of 15 sf shall have an overall CR of 64 or greater when tested in accordance with NFRC 500-2010.
- E. Solar Heat-Gain Coefficient (SHGC): NFRC 200 maximum whole-window SHGC of 0.31.
- F. Visible Light Transmittance VT: An awning or casement window of 15 sf shall have an overall VT of .39 or greater when tested in accordance with NFRC 200-2010.
- G. Air infiltration: Air infiltration shall not exceed .02 cfm/ sf of sash with the sash in the closed and locked position under a static pressure drop of 1.57 psf (equivalent to 25mph wind velocity) when tested in accordance with ASTM-E283
- H. Water Penetration Resistance: There shall be no leakage when tested according to ASTM E 547 under pressure drop of 9 psf.

SECTION 085313 - VINYL WINDOWS

- I. Structural Performance: Provide windows capable of withstanding the effects of the following loads, based on testing units representative of those indicated for the project that pass AAMA/WDMA 101/I.S.2/A440-05, uniform structural load test:
 - 1. Design Wind Loads: Determine wind loads according to ASCE7 Section 6.5 "Method 2-Analytical Procedure."
 - a. Basic Wind Speed: 110mph (3 second gust).
 - b. Importance factor 1
 - c. Exposure Category D
 - d. Height above grade 33 ft.

2.3 VINYL WINDOWS

- A. Operating Types: Provide the following operating types in locations indicated on Drawings:
 - 1. Casement: Project out.
 - 2. Awning: Project out.
 - 3. Fixed.
- B. Frames and Sashes: Extruded, Impact-resistant, UV-stabilized PVC complying with AAMA/WDMA/CSA 101/I.S.2/A440. Miter cut and fusion weld all corners. Welds are to match frame finish.
 - 1. PVC Returns to receive wood trim: Provide at interior face of frame.
 - 2. Finish: Factory finish of homogeneous color throughout in accordance with AAMA 613-02. Custom color as selected by architect.
- C. Glass: Clear annealed glass, ASTM C 1036, Type 1, Class 1, q3.
 - 1. Kind: Fully tempered where windows are within 24" of doors.
- D. Insulating-Glass Units: ASTM E 2190.
 - 1. Glass: ASTM C 1036, Type 1, Class 1, q3.
 - a. Tint: Clear.
 - b. Kind: Fully tempered where windows are within 24" of doors.
 - 2. Lites: 3 panes, thickness 3mm minimum as required to meet structural wind load requirements.
 - 3. Filling: Fill spaces between glass lites with argon. 1/2" space
 - 4. Low-E Coating: Pyrolytic or Sputtered on second and fifth surface.
- E. Glazing System: Manufacturer's double weather strip with extruded EPDM bulb factory glazing system that produces weathertight seal.
- F. Hardware, General: Provide heavy duty stainless steel by Truth Hardware or approved equal complying with AAMA 907, designed to smoothly operate, tightly close, and securely lock windows, and sized to accommodate sash weight and dimensions.
 - 1. Exposed Hardware Color and Finish: As selected by Architect from manufacturer's full range.

SECTION 085313 - VINYL WINDOWS

2. Rotary crank type operators and 4 bar stainless steel hinge assembly.
 3. Multi point locking system operated by a single handle.
 4. Limit Devices: Concealed support arms with adjustable, limited, hold-open limit devices designed to restrict sash opening.
 - a. Limit clear opening to **12 inches** for ventilation; with custodial key release.
- G. Weather Stripping: Provide full-perimeter weather stripping for each operable sash unless otherwise indicated.
- H. Fasteners: Noncorrosive and compatible with window members, trim, hardware, anchors, and other components.
1. Exposed Fasteners: Do not use exposed fasteners to the greatest extent possible. For application of hardware, use fasteners that match finish hardware being fastened.

2.4 INSECT SCREENS

- A. General: Fabricate insect screens to fully integrate with window frame. Provide screen for each operable exterior sash. Screen wickets are not permitted.
1. Type and Location: Full, inside for project-out sashes.
- B. Aluminum Frames: Manufacturer's standard aluminum alloy complying with SMA 1004 or SMA 1201. Fabricate frames with mitered or coped joints or corner extrusions, concealed fasteners, and removable PVC spline/anchor concealing edge of frame.
1. Tubular Framing Sections and Cross Braces: Roll formed from aluminum sheet.
 2. Finish for Interior Screens: Baked-on organic coating in color selected by Architect from manufacturer's full range.
 3. Finish for Exterior Screens: Baked-on organic coating in color selected by Architect from manufacturer's full range.
- C. Glass-Fiber Mesh Fabric: **20-by-20 (0.85-by-0.85-mm)** or **20-by-30 (0.85-by-0.42-mm)** mesh of PVC-coated, glass-fiber threads; woven and fused to form a fabric mesh resistant to corrosion, shrinkage, stretch, impact damage, and weather deterioration. Comply with ASTM D 3656.
1. Mesh Color: Manufacturer's standard.

2.5 FABRICATION

- A. Fabricate vinyl windows in sizes indicated. Include a complete system for assembling components and anchoring windows. Provide mulled window sets as indicated.
- B. Glaze vinyl windows in the factory.
- C. Weather strip each operable sash to provide weathertight installation.

SECTION 085313 - VINYL WINDOWS

- D. Mullions: Provide mullions and cover plates, compatible with window units, complete with anchors for support to structure and installation of window units. Allow for erection tolerances and provide for movement of window units due to thermal expansion and building deflections. Provide mullions and cover plates capable of withstanding design wind loads of window units. Provide manufacturer's standard finish to match window units.
- E. Hardware: Mount hardware through double walls of vinyl extrusions or provide corrosion-resistant reinforcement.
- F. Complete fabrication, assembly, finishing, hardware application, and other work in the factory to greatest extent possible. Disassemble components only as necessary for shipment and installation. Allow for scribing, trimming, and fitting at Project site.

PART 3 - EXECUTION

3.1 EXAMINATION

- A. Examine openings, substrates, structural support, anchorage, and conditions, with Installer present, for compliance with requirements for installation tolerances and other conditions affecting performance of the Work.
- B. Verify rough opening dimensions, levelness of sill plate, and operational clearances. Provide maximum ½" gap on all sides.
- C. Examine wall flashings, vapor retarders, water and weather barriers, and other built-in components to ensure weathertight window installation.
- D. Proceed with installation only after unsatisfactory conditions have been corrected.

3.2 INSTALLATION

- A. Comply with manufacturer's written instructions for installing windows, hardware, accessories, and other components. For installation procedures and requirements not addressed in manufacturer's written instructions, comply with installation requirements in ASTM E 2112.
- B. Install windows level, plumb, square, true to line, without distortion, anchored securely in place to structural support, and in proper relation to wall flashing and other adjacent construction to produce weathertight construction.

3.3 ADJUSTING, CLEANING, AND PROTECTION

- A. Adjust operating sashes and hardware for a tight fit at contact points and weather stripping for smooth operation and weathertight closure.
- B. Clean exposed surfaces immediately after installing windows. Remove excess sealants, glazing materials, dirt, and other substances.

SECTION 085313 - VINYL WINDOWS

1. Keep protective films and coverings in place until final cleaning.
- C. Remove and replace sashes if glass has been broken, chipped, cracked, abraded, or damaged during construction period.
- D. Protect window surfaces from contact with contaminating substances resulting from construction operations. If contaminating substances do contact window surfaces, remove contaminants immediately according to manufacturer's written instructions.

END OF SECTION 085313

SHEET NOTES SITE PHASING

1 PHASE 1 - OWNER WILL OCCUPY AREAS OUTSIDE CONTRACTOR STAGING DURING 2012-2013 SCHOOL YEAR

AREA OF WORK

1d WEST PARKING LOT:

1e EXCAVATE & FILL FOR WEST PARKING LOT

1f INSTALL SOUND SOURCE HEAT PILLS & PIPING

1g INSTALL SUBSURFACE DRAINAGE FIRING

1h PREPARE GRAVEL SURFACE WITH 95% COMPACTION FOR PARKING DURING 2012-2013 SCHOOL YEAR

1i TRENCHING DEMOLITION & INSTALLATION OF UTILITIES AS REQ. DURING PHASE 2. TYP WHERE SHOWN

1j EXCAVATION, GRADING, FILLING SUB BASE PREP FOR PHASE 3 SITE WORK

1k CONSTRUCTION OF RETAINING WALL

1l CONSTRUCTION OF ROAD (EXCEPT PAVING)

1m SUBSURFACE DRAINAGE

1n INSTALL PORTABLES (6)

2 PHASE 2

GENERAL NOTES: NO SITE WORK UNTIL END OF 2012-2013 SCHOOL YEAR. ALL WORK OUTSIDE BUILDING AREAS MUST BE COMPLETED BY OWNER UNTIL END OF 2012-2013 SCHOOL YEAR

2a EXISTING ENTRY DRIVE & PAVED PARKING TO REMAIN UNTIL START OF PHASE 3

2b OWNER TO OCCUPY EXISTING PARKING LOT & BUS DROP OFF DURING 2012-2013 SCHOOL YEAR

2c BUS DROP OFF DURING 2012-2013 SCHOOL YEAR

2d ENTRY TO SCHOOL DURING 2012-2013 SCHOOL YEAR

2e LOCATION OF BUILDING DUMPSTER DURING 2012-2013 SCHOOL YEAR

2f PROVIDE OWNER ACCESS TO ROAD & PLAYGROUND DURING 2012-2013 SCHOOL YEAR

2g COMPLETE ALL SITE WORK & BUILDING WORK

2h NEW SITE WORK HALF-TONE FOR CLARITY

2i COMPLETE ALL REMAINING SITE WORK IN PHASE 3

3 PHASE 3

3a COMPLETE ALL SITE WORK & BUILDING WORK

3b NEW SITE WORK HALF-TONE FOR CLARITY

3c COMPLETE ALL REMAINING SITE WORK IN PHASE 3

4 GENERAL NOTES

4a CONTRACTOR STAGING AREA - ALL PHASES

4b LIMITS OF CONSTRUCTION

4c EXISTING FENCE (SEE CIVIL)

4d KEEP AREA OPEN & FENCED EACH SIDE FOR ACCESS TO PORTABLES & PLAYGROUND DURING SCHOOL YEAR

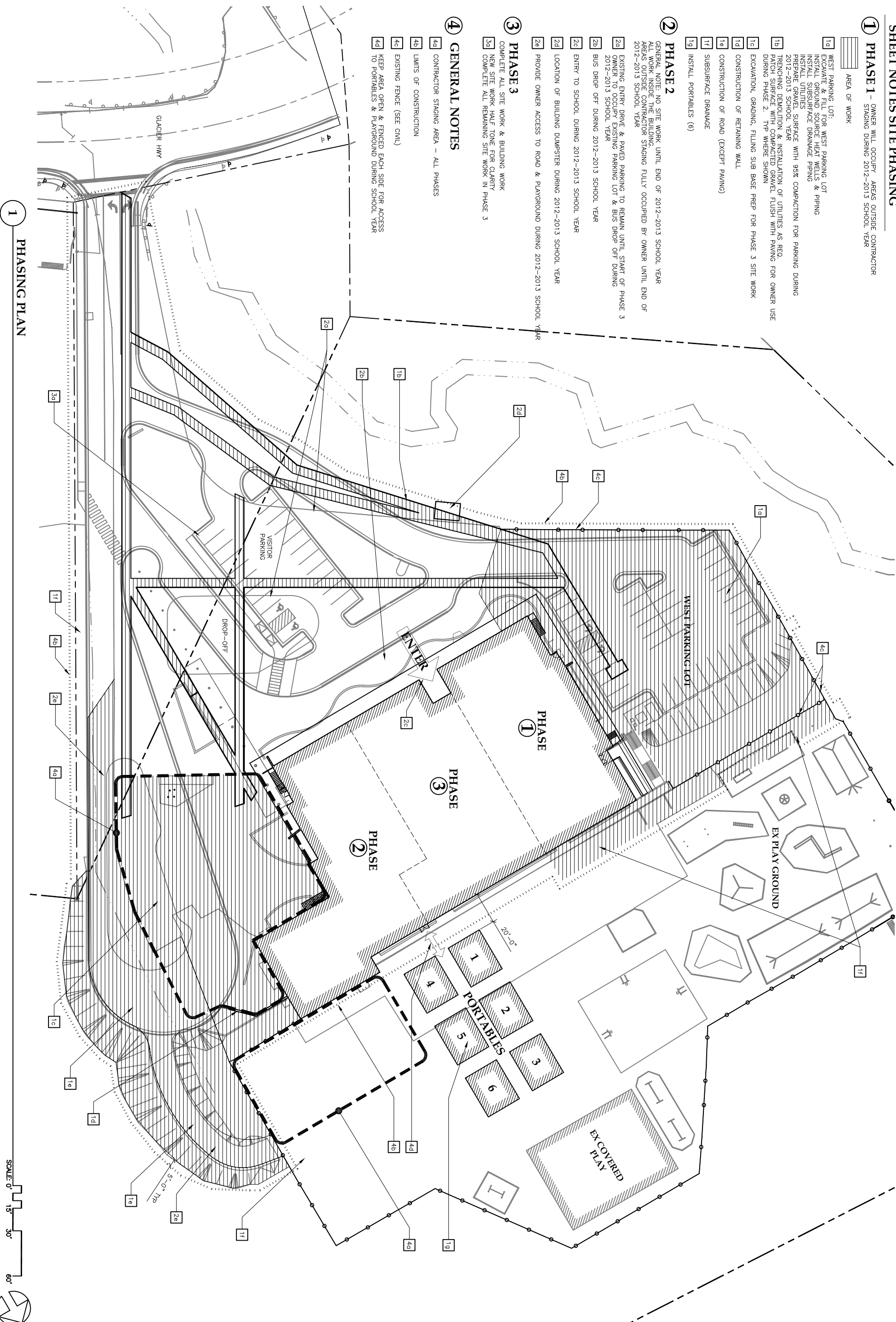

Jensen Yorba Loft Inc.
 522 West 10th Street
 Juneau, Alaska 99801
 phone 907-586-1070
 fax 907-586-3959
 jensenyorbaloft.com



City and Borough of Juneau - Juneau School District
Auke Bay Elementary School Renovation
 CBJ Project No. E12-216
 Juneau, Alaska

ADDENDUM 2
 REVISIONS
 FEB 27, 2012

SHEET TITLE
SITE PHASING & CONSTRUCTION STAGING
 DATE: DECEMBER 21, 2011
 FILE: 10036

A101