

G:_Projects\0657\Cad\CDMAIN ENTRY\Arch\Conformed\D201_cf.dwg, Layout1, 9/20/2011 10:25:44 AM, amacdonald, Adobe PDF 11X17.pc3, Tabloid, 1:2

KEY NOTES

- 201 EX PAVING W/ HEAT LOOPS TO REMAIN - FROM CURB TO EDGE OF EX WALL
- 202 REMOVE COLUMNS TO T.O. CONC BASE - WHERE OCCURS - OR TO ±0" ABOVE EX HEATED CONC SIDEWALK. GRIND CUTS SMOOTH. TOTAL OF (4)
- 203 REMOVE WALL COMPLETE
- 204 SALVAGE RELITE FRAME, WOOD PANELING, & TRIM FOR REUSE
- 205 REMOVE CANOPY / DECK
- 206 REMOVE PARAPET CAP
- 207 PROTECT EX SCUPPER
- 208 REMOVE TILE FLOORING & GROUT, GRIND EX SLAB SMOOTH
- 209 REMOVE WINDOW
- 210 EX CANOPY TO REMAIN
- 211 PROTECT EX GWB FIREPROOFING, REPAIR OR REPLACE GWB AS REQ
- 212 REMOVE WALK-OFF GRATE & PIT @ VESTIBULE
- 213 CAREFULLY REMOVE EX FLOORING IN WORK AREA AND UNDER TEMP WALL AND STORE FOR REUSE
- 214 REMOVE SECURITY GATE
- 215 CONTRACTOR TO CAREFULLY REMOVE CASEWORK, LIGHTS, & FIXED EQUIPMENT & TURN OVER TO TENANTS FOR REUSE IN THIS AREA
- 216 PLANTS TO BE REMOVED AND STORED BY OWNER
- 217 TEMPORARY PARTITION TO REMAIN IN PLACE UNTIL SUBSTANTIAL COMPLETION, EXCEPT AS REQUIRED IN INSTALL 1ST FLOOR CEILING. VERIFY ONSITE CONDITIONS, COORDINATE WITH OWNER
- 218 TEMPORARY FENCING: 6' HIGH CHAIN LINK FENCING W/ 2" DIA STL POSTS @ 8' O.C. W/ PORTABLE CONC FOOTINGS. SEE 1/A003 FOR EXTENTS
- 219 EX PARAPET TO REMAIN
- 220 EX ROOF DRAIN AND SUMP TO REMAIN

- GENERAL NOTES
- DO NOT DISTURB EX SIDEWALK W/ ICE MELT TO REMAIN
 - CONTRACTOR TO ISOLATE CONSTRUCTION ACTIVITIES FROM TERMINAL OPERATIONS AT ALL TIMES, INCLUDING PROTECTING EQUIPMENT & BUILDING SYSTEMS FROM DUST, ETC.

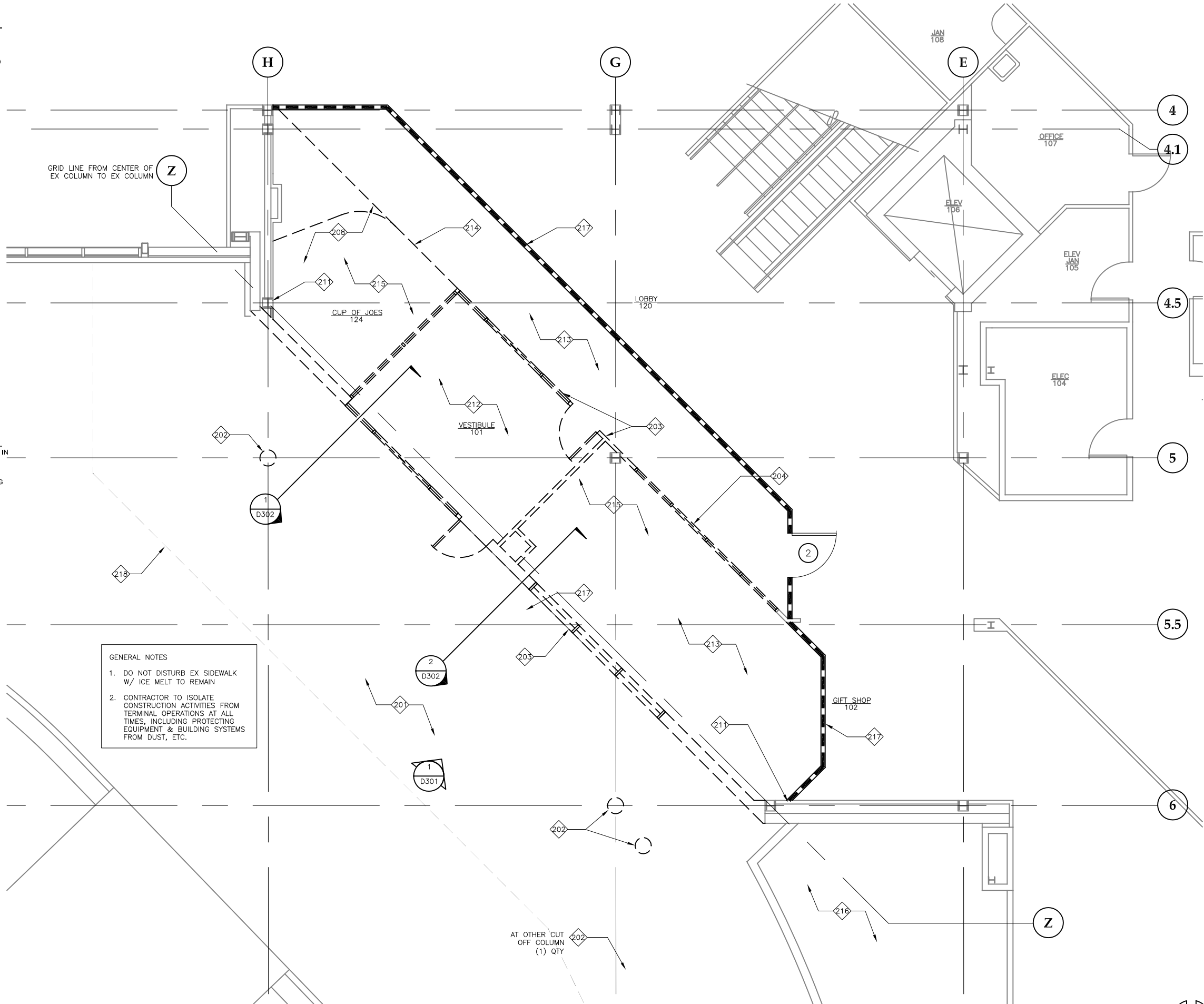

1 ENLARGED 1st FLOOR DEMOLITION PLAN

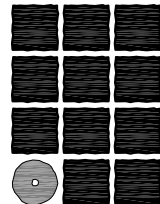

**Jensen
Yorba
Lott
Inc.**

522 West 10th Street
Juneau, Alaska 99801
phone 907-586-1070
fax 907-586-3959
jensenyorbalott.com



**City & Borough of Juneau
Juneau International Airport
Terminal Main Entry
Renovation
CBJ Contract No. E12-036
Juneau, Alaska**

REVISIONS

- CONFORMED 9/20/11

SHEET TITLE
**ENLARGED
1st FLOOR
DEMOLITION PLAN**



DATE: August 16, 2011
FILE: 0657

D201

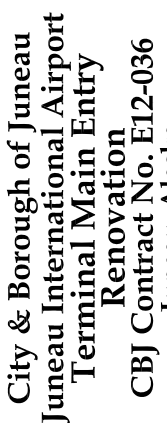

JNU AIRPORT
CITY/BOROUGH OF JUNEAU
ALASKA'S CAPITAL CITY



 CONFORMED 9/20/01
 .
 .

A201

GENERAL NOTES

1. DO NOT DISTURB EX SIDEWALK
W/ ICE MELT TO REMAIN
2. CONTRACTOR TO ISOLATE
CONSTRUCTION ACTIVITIES FROM
TERMINAL OPERATIONS AT ALL
TIMES, INCLUDING PROTECTING
EQUIPMENT & BUILDING SYSTEMS
FROM DUST, ETC.



SCALE: 0 2' 4' 8'



G:_Projects\0657\Cad\CD\MAIN ENTRY\Arch\Conformed\A601_cf.dwg, Layout1, 9/20/2011 10:26:04 AM, amacdonald, Adobe PDF 11X17.pc3, Tabloid, 1:2

KEY NOTES

- 601 RETRACTABLE SECURITY GATE IN SAME LOCATION AS REMOVED GATE
- 602 GYPSUM BOARD SOFFIT, MATCH ADJACENT EX SOFFIT, HIDE SEAM
- 603 PATCH EX CEILING AS NECESSARY
- 604 2'X2' CEILING GRID
- 605 LIGHT FIXTURES, SEE ELECTRICAL FOR ADDITIONAL INFO
- 606 GLASS & METAL CANOPY, PANELS TO MATCH EX CANOPY
- 607 SUSPENDED MTL LINEAR CEILING, FINISH TO MATCH EX, PATCH FULL LENGTH PANELS W/SALVAGED WHERE POSSIBLE
- 608 EX. CEILING AND FIXTURES
- 609 HVAC, SEE MECHANICAL
- 610 SUSPENDED GYPSUM BOARD CEILING, MATCH EX FINISH
- 611 REUSE EX LIGHT FIXTURES

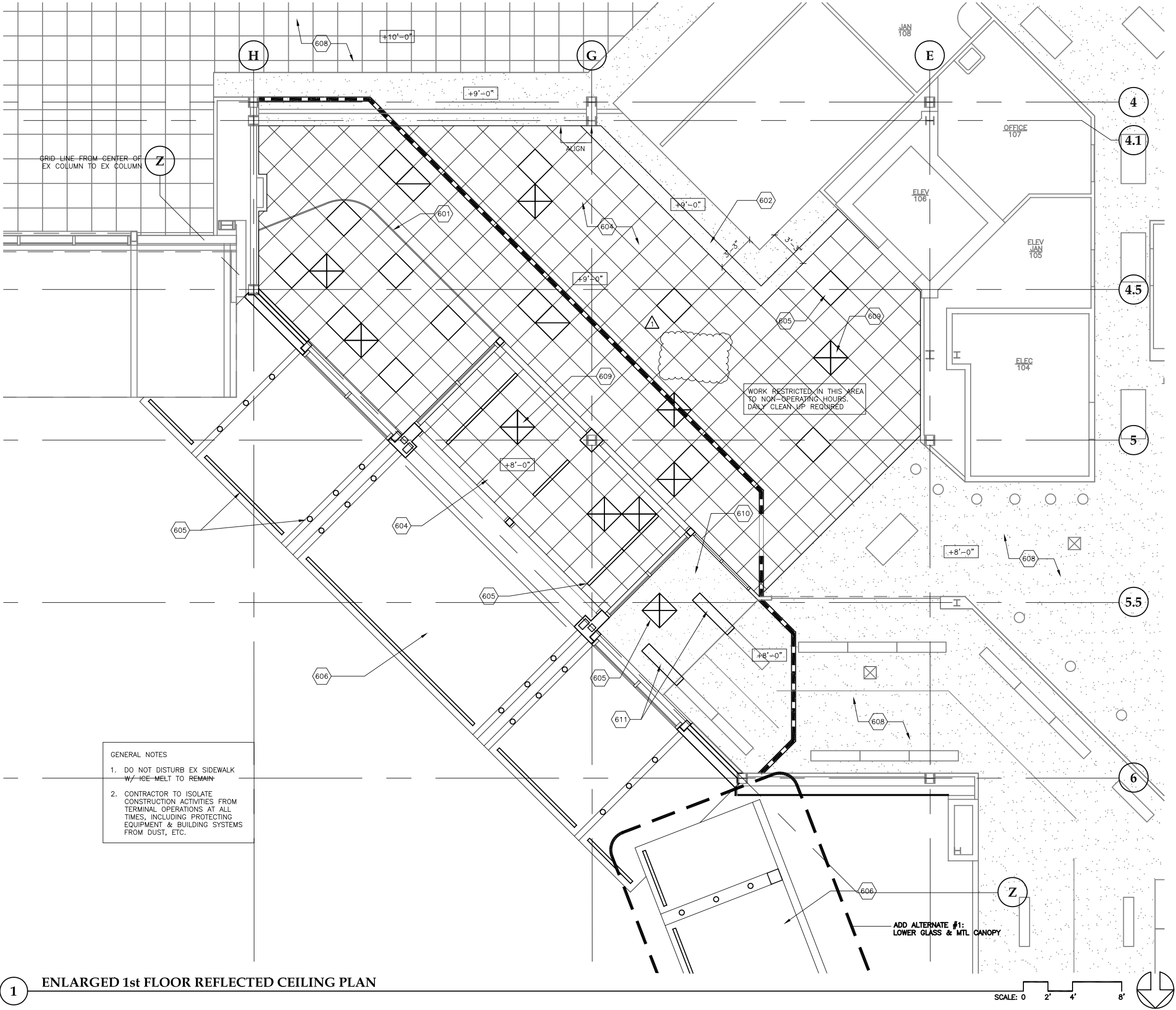

- GENERAL NOTES
- DO NOT DISTURB EX SIDEWALK W/ ICE-MELT TO REMAIN
 - CONTRACTOR TO ISOLATE CONSTRUCTION ACTIVITIES FROM TERMINAL OPERATIONS AT ALL TIMES, INCLUDING PROTECTING EQUIPMENT & BUILDING SYSTEMS FROM DUST, ETC.

Jensen Yorba Lott Inc.

522 West 10th Street
Juneau, Alaska 99801
phone 907-586-1070
fax 907-586-3959
jensenyorbalott.com



City & Borough of Juneau
Juneau International Airport
Terminal Main Entry
Renovation
CBJ Contract No. E12-036
Juneau, Alaska

REVISIONS

△ CONFORMED 9/20/11

SHEET TITLE

ENLARGED
1st FLOOR
REFLECTED
CEILING PLAN

DATE: August 16, 2011
FILE: 0657

A601