



A PLAYCORE Company

1-800-235-2440

ISSUED/REVISED: 8/23/11

26057 2 WAY X-POD STEP

- ⬡ = INSTALLATION
DETAIL
- = PARTS LIST
REFERENCE

INSTRUCTIONS

1. Before assembling this equipment, read the enclosed *INSTALLER INSTRUCTIONS* in the installation booklet; follow all the instructions during installation.
2. Assemble parts as shown in the *ASSEMBLY DRAWING*. Refer to the assembly details for the specific hardware required in each connection.
3. Loctite (supplied by others) should be used on all threaded hardware.

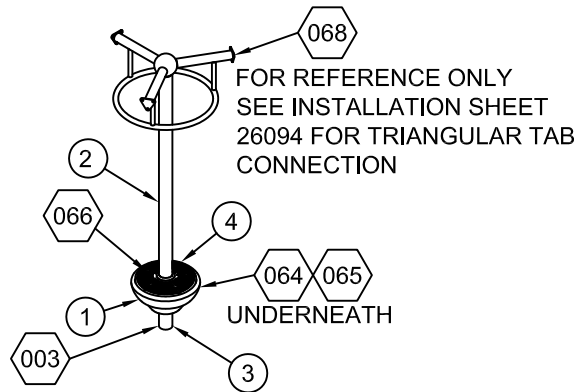

26058

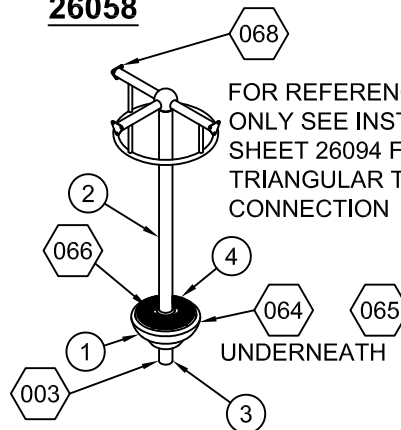

26121

3 WAY 26058
4 WAY 26059
90° 3 WAY 26121
90° 2 WAY 26143

FOR REFERENCE ONLY
SEE INSTALLATION SHEET
26094 FOR TRIANGULAR TAB
CONNECTION

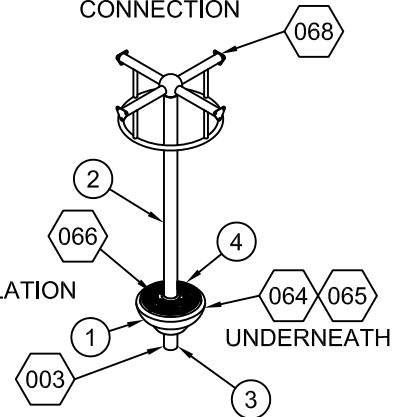

26059

FOR REFERENCE ONLY
SEE INSTALLATION SHEET
26094 FOR TRIANGULAR TAB
CONNECTION

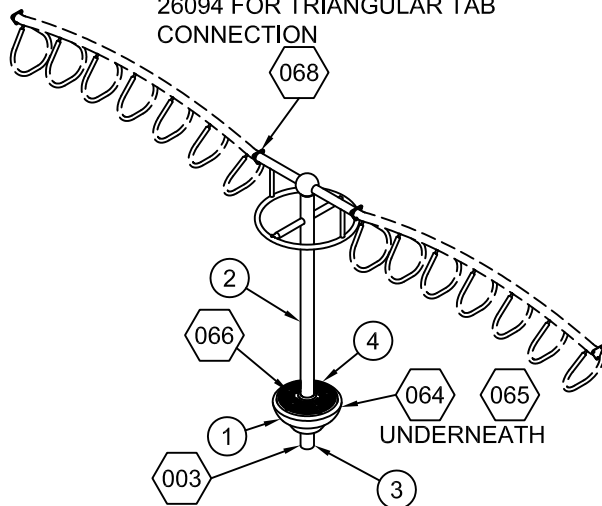

26057

FOR REFERENCE ONLY
SEE INSTALLATION SHEET
26094 FOR TRIANGULAR TAB
CONNECTION

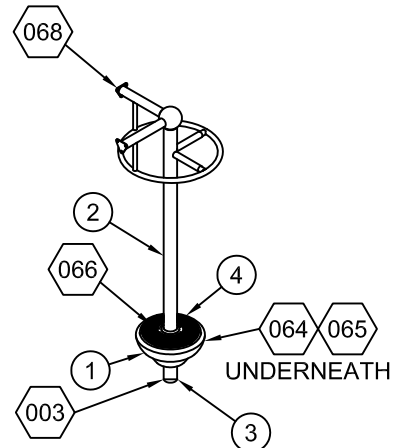

26143

ASSEMBLY DRAWINGS

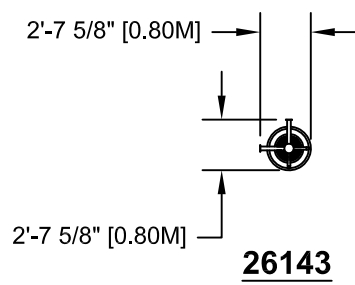
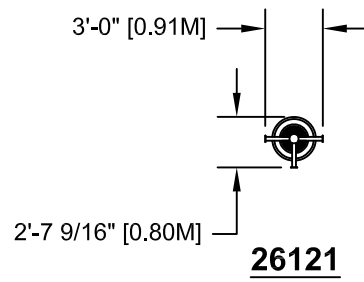
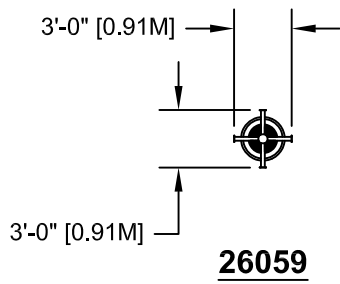
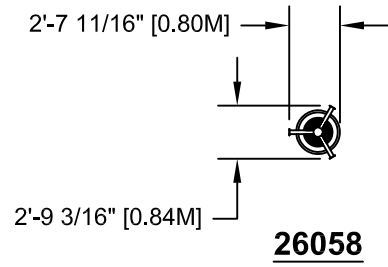
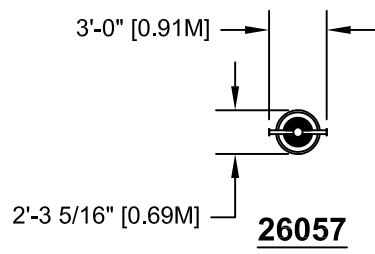

TOP VIEWS

DIA.1'-6" [45.72cm] x
2'-6" [76.20cm] DEEP

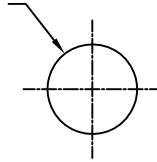

CONCRETE REQUIRED:
.10 CUBIC YARDS
(.08 CUBIC METERS)

GROUND PLAN

PARTS LIST

| REF NO. | DESCRIPTION | NUMBER REQUIRED | | | | | PART NUMBER |
|------------|---------------------------------|-----------------|-------|-------|-------|-------|----------------|
| | | 26057 | 26058 | 26059 | 26121 | 26143 | |
| 1 | X-Pod Step | 1 | 1 | 1 | 1 | 1 | 178658 |
| 2 | 2 Way X-Pod Step Weld Ass'y | 1 | 0 | 0 | 0 | 0 | 178643 |
| 2 | 3 Way X-Pod Step Weld Ass'y | 0 | 1 | 0 | 0 | 0 | 178654 |
| 2 | 90° 3 Way X-Pod Step Weld Ass'y | 0 | 0 | 0 | 1 | 0 | 200210 |
| 2 | 4 Way X-Pod Step Weld Ass'y | 0 | 0 | 1 | 0 | 0 | 178656 |
| 2 | 90° 2 Way X-Pod Step Weld Ass'y | 0 | 0 | 0 | 0 | 1 | 202221 |
| 3 | Ground Socket Weld Ass'y | 1 | 1 | 1 | 1 | 1 | 178650 |
| 4 | X-Pod Step Surface | 1 | 1 | 1 | 1 | 1 | 201055 |
| | Hardware Complete | 1 | 1 | 1 | 1 | 1 | 178677 |
| | 3/8" x 1" P.B.H.C.S. | 2 | 2 | 2 | 2 | 2 | 812050* |
| | 3/8" x 2" P.B.H.C.S. | 5 | 5 | 5 | 5 | 5 | 812055* |
| | 3/8" x 3 3/4" Hex Head Bolt | 2 | 2 | 2 | 2 | 2 | 801014* |
| | 3/8" Lockwasher | 9 | 9 | 9 | 9 | 9 | 817334* |
| | 3/8" Flatwasher | 7 | 7 | 7 | 7 | 7 | 817410* |
| | 3/8" Hex Nut | 2 | 2 | 2 | 2 | 2 | 804053* |

Unless Otherwise Specified, All Units of Measure are Each

** Included in Hardware*

**Warning: During Installation, Hardware And Small Parts Are Choking Hazards
For Young Children. Store Unused Parts Appropriately Until Assembly Is Completed.
Once Assembly Is Completed, Remove Any Unused Parts From The Play Environment
And Dispose/Save Them In A Secure Location.**

DETAILS -for- 26057, 26058, 26059 AND 26143

IMPORTANT

To REDUCE THE RISK OF CLOTHING ENTANGLEMENT IN COMPLIANCE WITH ASTM F1487, ANY BOLT END PROTRUDING MORE THAN TWO FULL THREADS BEYOND THE FACE OF THE NUT SHALL BE CUT-OFF FLUSH, FILED SMOOTH AND TREATED TO PREVENT CORROSION.

NOTE: AFTER ASSEMBLY IS COMPLETE, PEEN TEE-NUTS AND FLATWASHERS TO MATCH RADIUS OF PIPE.

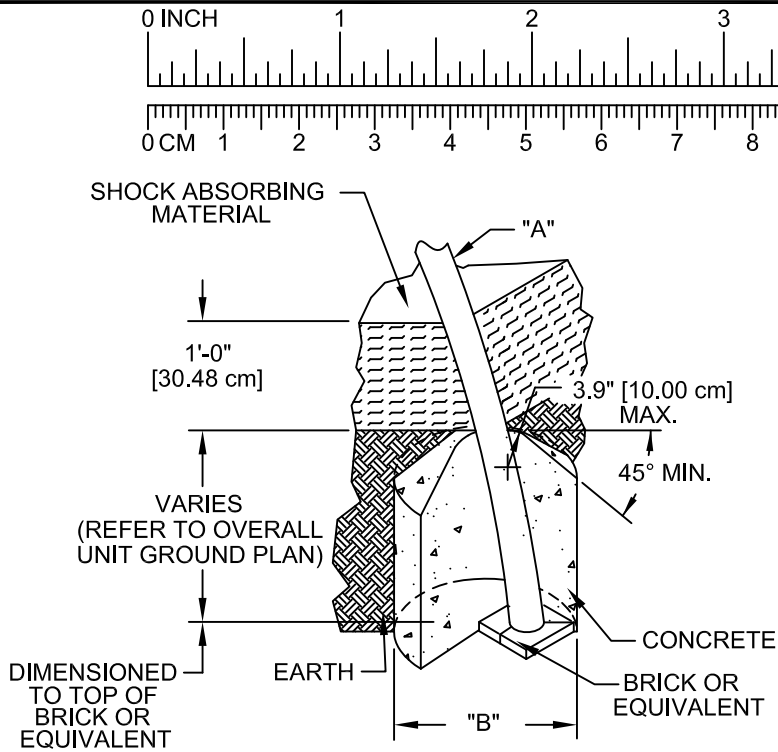

| DIA. "A" (PIPE SIZE) | DIA. "B" (FOOTING SIZE) |
|-------------------------|----------------------------|
| 1 7/8" [4.83 cm] | 1'-2" [35.56 cm] |
| 3 1/2" [8.89 cm] | 1'-6" [45.72 cm] |
| SWINGS | |
| 3 1/2" [8.89 cm] | 2'-0" [60.96 cm] |

NOTES:

- SLOPED FOOTING IS A REQUIREMENT OF EUROPEAN STANDARD EN1176-1
- SUGGESTED MINIMUM CONCRETE RATING: 3000 PSI

003

SHOCK ABSORBING PROPERTIES OF SURFACING MATERIALS VARY. IF YOU DETERMINE THAT LESS THAN 1'-0" [30.48cm] OF SURFACING IS REQUIRED, MAKE UP THE DIFFERENCE IN ELEVATION WITH EARTH, BEFORE APPLYING SURFACING.

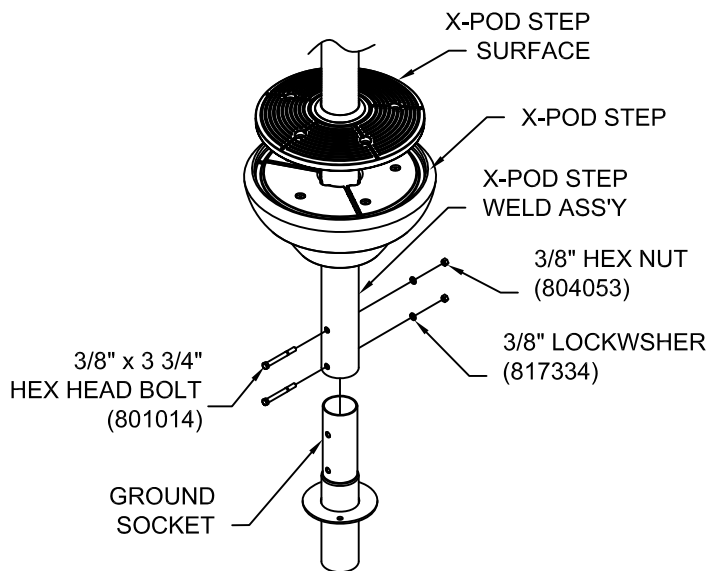

064

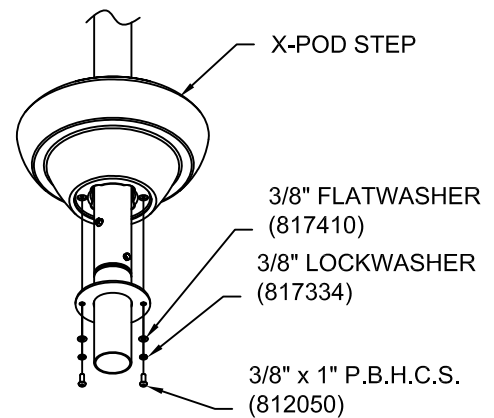

065

DETAILS -for- 26057, 26058, 26059 AND 26143

IMPORTANT

To REDUCE THE RISK OF CLOTHING ENTANGLEMENT IN COMPLIANCE WITH ASTM F1487, ANY BOLT END PROTRUDING MORE THAN TWO FULL THREADS BEYOND THE FACE OF THE NUT SHALL BE CUT-OFF FLUSH, FILED SMOOTH AND TREATED TO PREVENT CORROSION.

NOTE: AFTER ASSEMBLY IS COMPLETE, PEEN TEE-NUTS AND FLATWASHERS TO MATCH RADIUS OF PIPE.

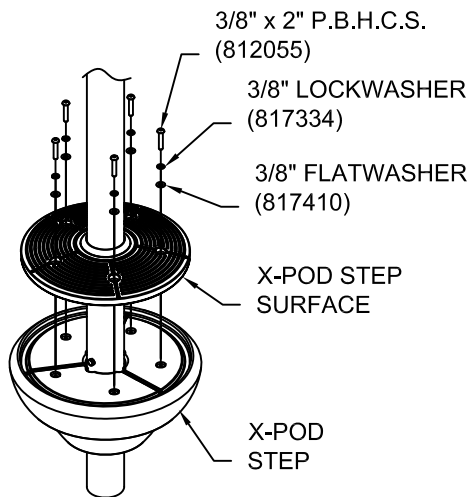
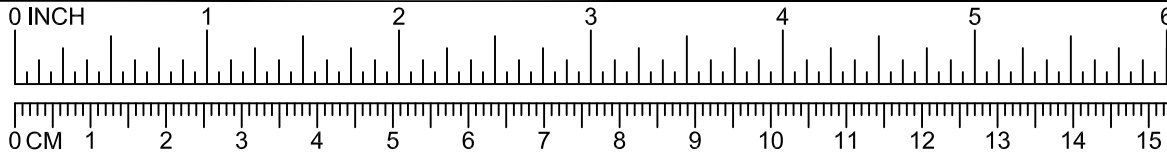

066

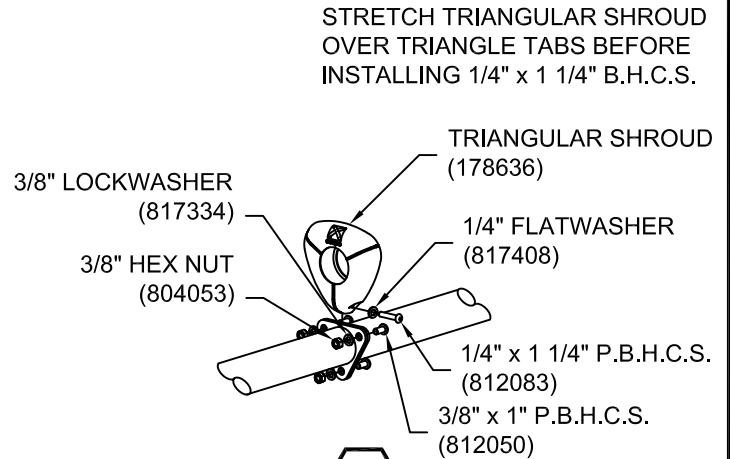

068

NOTE: SEE INSTALLATION SHEET 26094 FOR RUBBER SHROUD CONNECTION DETAIL. HARDWARE FOR THIS CONNECTION IS LOCATED IN HARDWARE COMPLETE #178755



Enriching Childhood Through Play™

1-800-235-2440

ISSUED/REVISED: 5/25/11

26061

TRAPEZE DUAL CIRCUIT

| | |
|----------------------|-------|
| TRAPEZE DUAL CIRCUIT | 26061 |
| TRAPEZE QUAD CIRCUIT | 26062 |

⬡ = INSTALLATION
DETAIL

○ = PARTS LIST
REFERENCE

FOR REFERENCE ONLY
SEE INSTALLATION SHEET
26094 FOR TRIANGLE TAB
CONNECTION

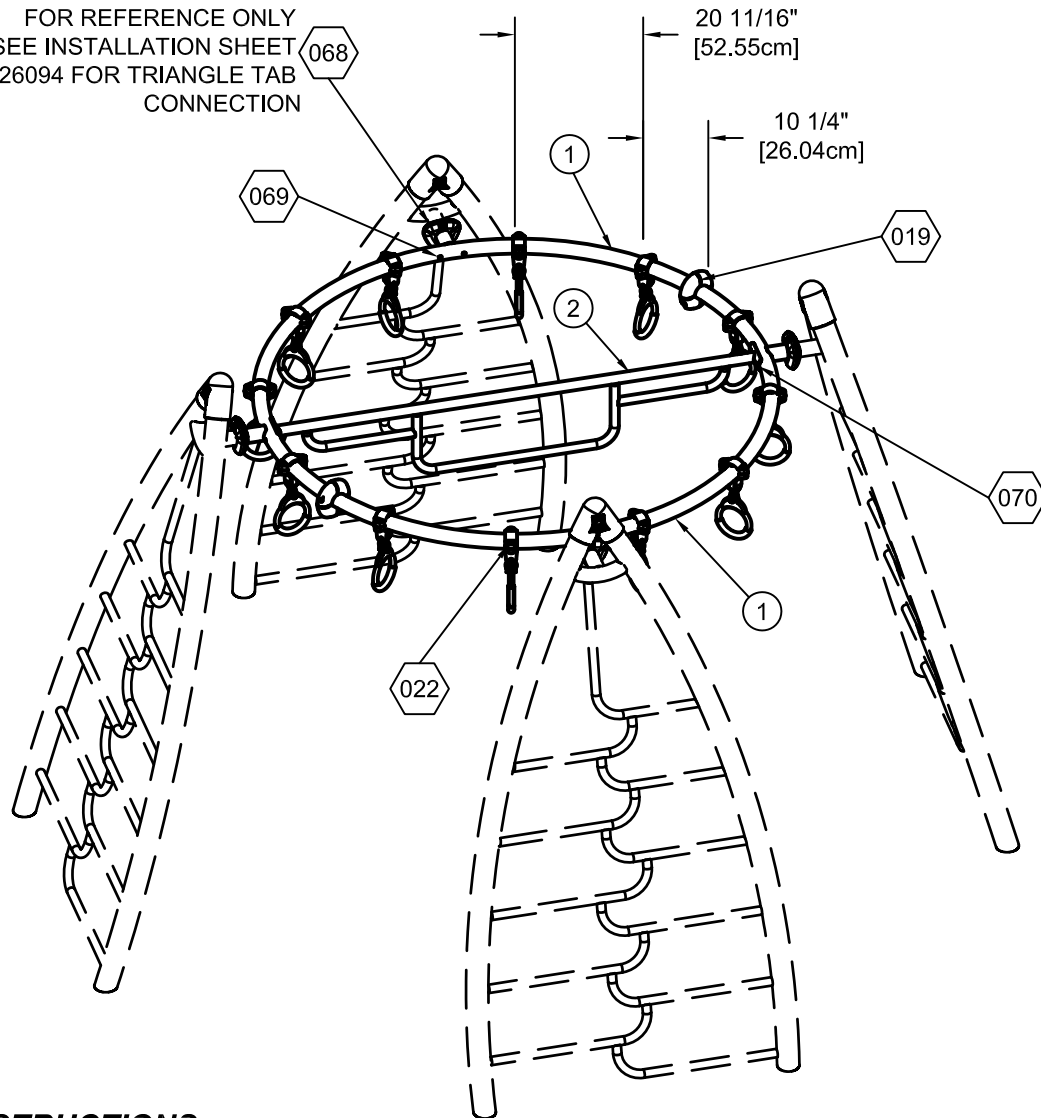

INSTRUCTIONS

1. Before assembling this equipment, read the enclosed *INSTALLER INSTRUCTIONS* in the installation booklet; follow all the instructions during installation.
2. Assemble parts as shown in the *ASSEMBLY DRAWING*. Refer to the assembly details for the specific hardware required in each connection.
3. Loctite (supplied by others) should be used on all threaded hardware.

26061 ASSEMBLY DRAWING

FOR REFERENCE ONLY
SEE INSTALLATION SHEET
26094 FOR TRIANGLE TAB
CONNECTION

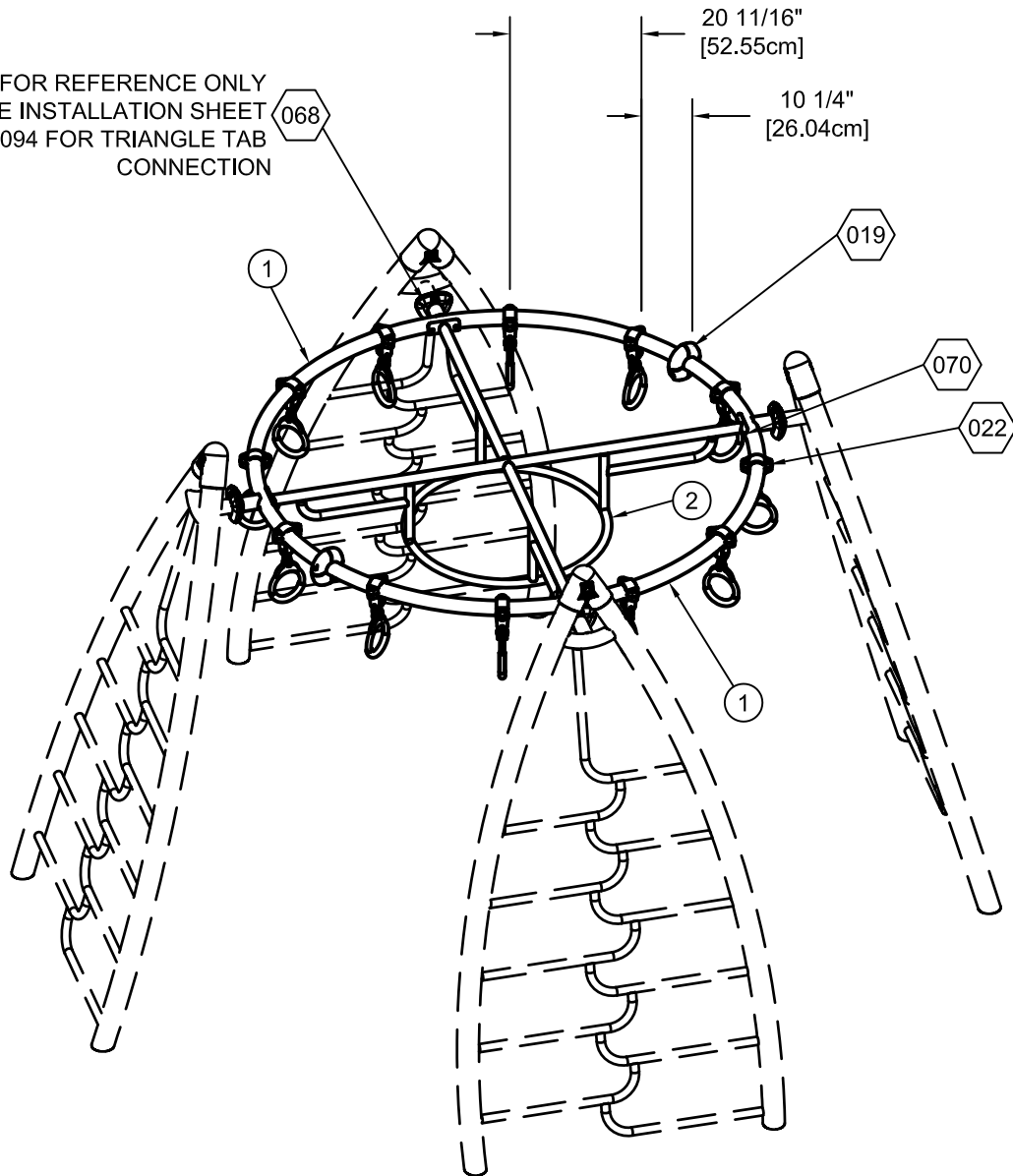

26062
ASSEMBLY DRAWING

PARTS LIST

| REF NO. | DESCRIPTION | 26061 | 26062 | PART NUMBER |
|------------|---------------------------------|-------|-------|----------------|
| 1 | Overhead Loop Rail | 2 | 2 | 178743 |
| 2 | Overhead Dual Rail | 1 | 0 | 176859 |
| 2 | Overhead Quad Rail | 0 | 1 | 176867 |
| | Hardware Complete | 1 | 0 | 178710 |
| | Hardware Complete | 0 | 1 | 178711 |
| | 3/8" x 1" P.B.H.C.S. w/Patch | 8 | 8 | 812050* |
| | 3/8" x 2 1/4" P.B.H.C.S w/Patch | 4 | 8 | 812056* |
| | 3/8" x 1 3/4" P.B.H.C.S w/Patch | 4 | 0 | 812054* |
| | 3/8" x 1 1/4" Shoulder Bolt | 12 | 12 | 811227* |
| | 3/8" x 2" Carriage Bolt | 24 | 24 | 800256* |
| | 3/8" T-Nut | 8 | 8 | 804556* |
| | 3/8" Lockwasher | 12 | 14 | 817334* |
| | 3/8" Flatwasher | 16 | 16 | 817410* |
| | 3/8" Locknut | 32 | 32 | 804353* |
| | Top Clevis | 12 | 12 | 158223* |
| | Bottom Clevis | 12 | 12 | 158227* |
| | Pendulum | 12 | 12 | 177721* |
| | Trapeze Rings | 12 | 12 | 109* |
| | 5/16" Jam Nut | 12 | 12 | 804100* |
| | 1/2" Hex Nut | 12 | 12 | 804055* |
| | 1/2" Lock Washer | 12 | 12 | 817342* |
| | 1/2" x 2 1/2" Hex Bolt | 12 | 12 | 801200* |
| | Round Rubber Shroud | 4 | 4 | 202065* |
| | 1/4" x 1 1/4" P.B.H.C.S. | 4 | 4 | 812083* |
| | 1/4" Flatwasher | 4 | 4 | 817408* |

Unless Otherwise Specified, All Units of Measure are Each

** Included in Hardware*

Warning: During Installation, Hardware And Small Parts Are Choking Hazards For Young Children. Store Unused Parts Appropriately Until Assembly Is Completed. Once Assembly Is Completed, Remove Any Unused Parts From The Play Environment And Dispose/Save Them In A Secure Location.

DETAILS -for- 26061 & 26062

IMPORTANT

To REDUCE THE RISK OF CLOTHING ENTANGLEMENT IN COMPLIANCE WITH ASTM F1487, ANY BOLT END PROTRUDING MORE THAN TWO FULL THREADS BEYOND THE FACE OF THE NUT SHALL BE CUT-OFF FLUSH, FILED SMOOTH AND TREATED TO PREVENT CORROSION.

NOTE: AFTER ASSEMBLY IS COMPLETE, PEEN TEE-NUTS AND FLATWASHERS TO MATCH RADIUS OF PIPE.

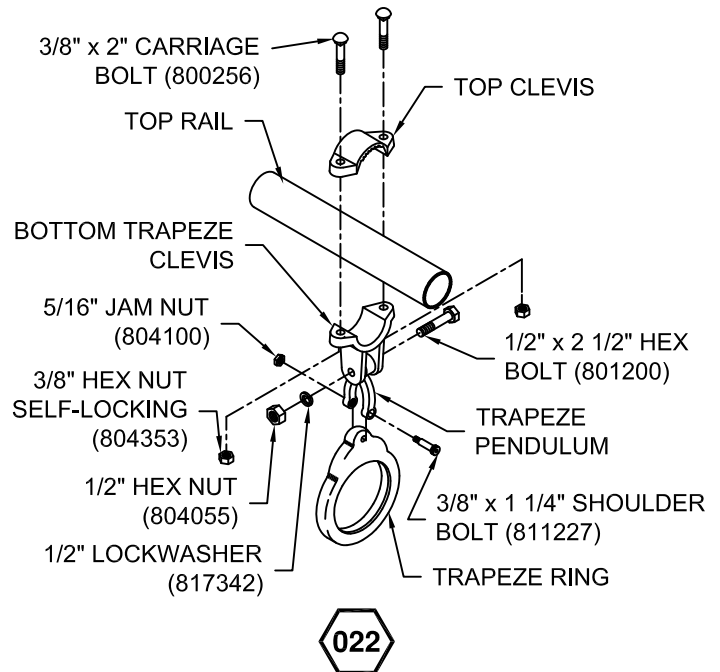
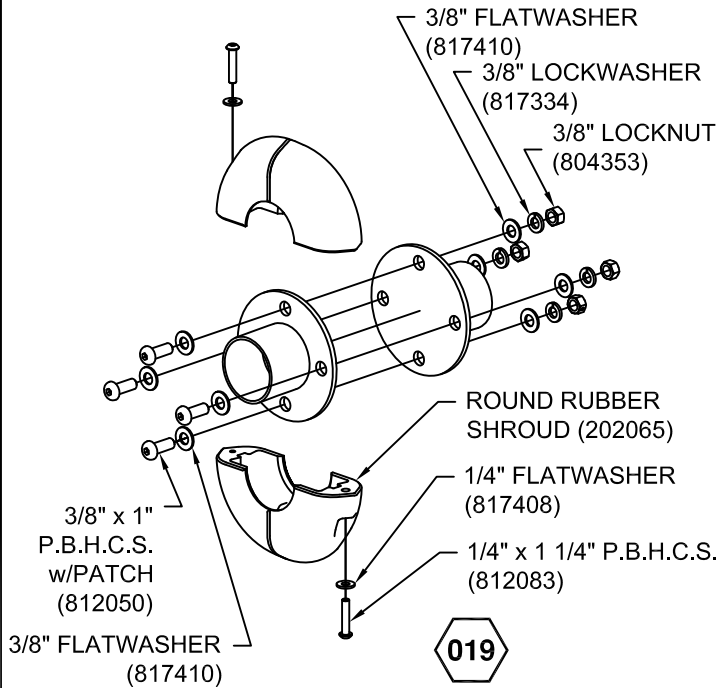
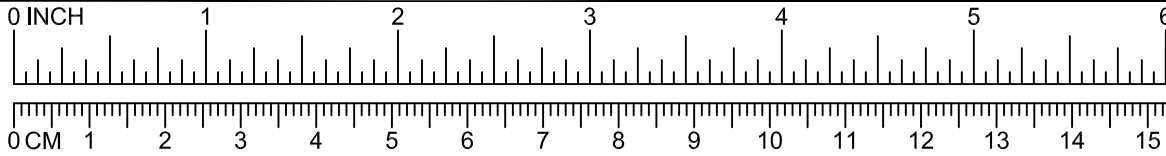

STRETCH TRIANGULAR SHROUD OVER TRIANGLE TABS BEFORE INSTALLING 1/4" x 1 1/4" B.H.C.S.

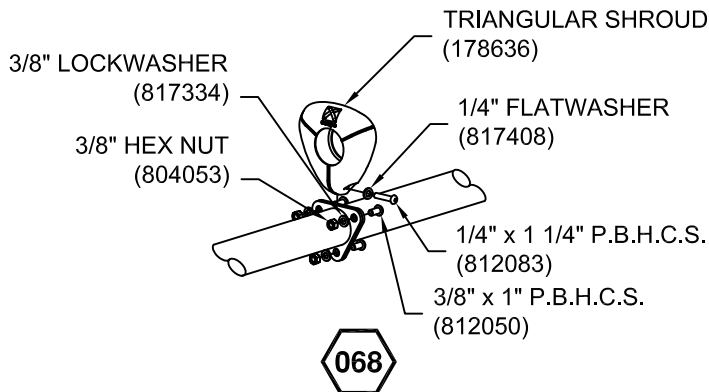

NOTE: SEE INSTALLATION SHEET 26094 FOR RUBBER SHROUD CONNECTION DETAIL. HARDWARE FOR THIS CONNECTION IS LOCATED IN HARDWARE COMPLETE #178755

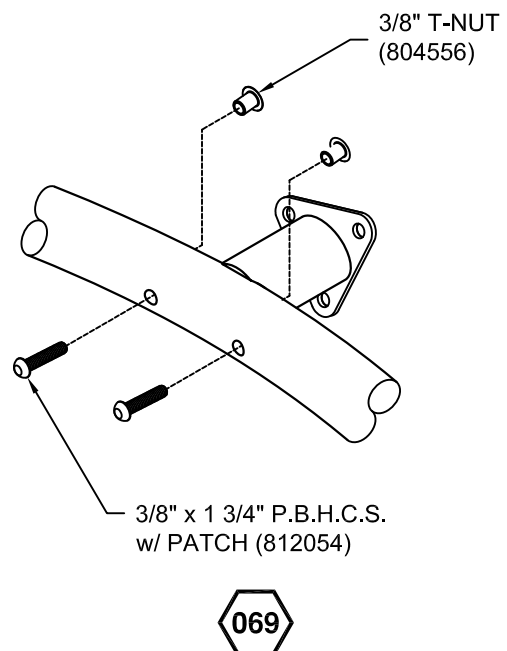

DETAILS -for- 26061 & 26062

IMPORTANT

To REDUCE THE RISK OF CLOTHING ENTANGLEMENT IN COMPLIANCE WITH ASTM F1487, ANY BOLT END PROTRUDING MORE THAN TWO FULL THREADS BEYOND THE FACE OF THE NUT SHALL BE CUT-OFF FLUSH, FILED SMOOTH AND TREATED TO PREVENT CORROSION.

NOTE: AFTER ASSEMBLY IS COMPLETE, PEEN TEE-NUTS AND FLATWASHERS TO MATCH RADIUS OF PIPE.

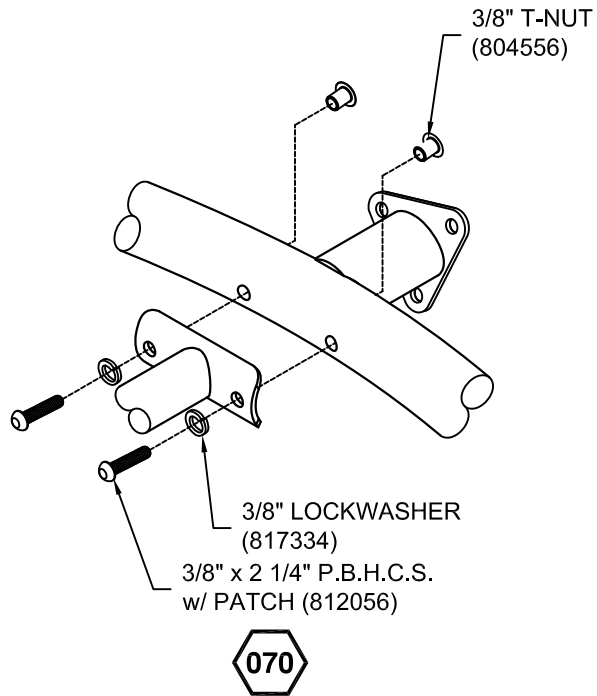
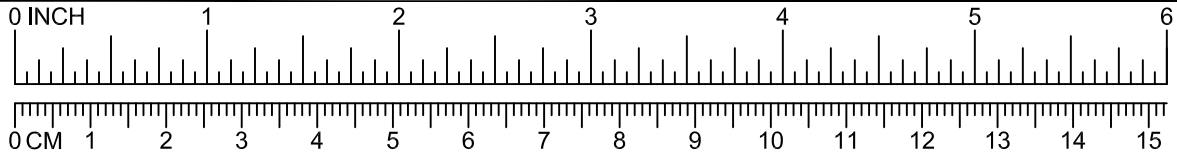

HELIOCENTRIX SUPPORT RUNGS WITH TAB

⬡ = INSTALLATION
DETAIL

○ = PARTS LIST
REFERENCE

INSTRUCTIONS

1. Before assembling this equipment, read the enclosed *INSTALLER INSTRUCTIONS* in the installation booklet; follow all the instructions during installation.
2. Assemble parts as shown in the *ASSEMBLY DRAWING*. Refer to the assembly details for the specific hardware required in each connection.
3. Loctite (supplied by others) should be used on all threaded hardware.

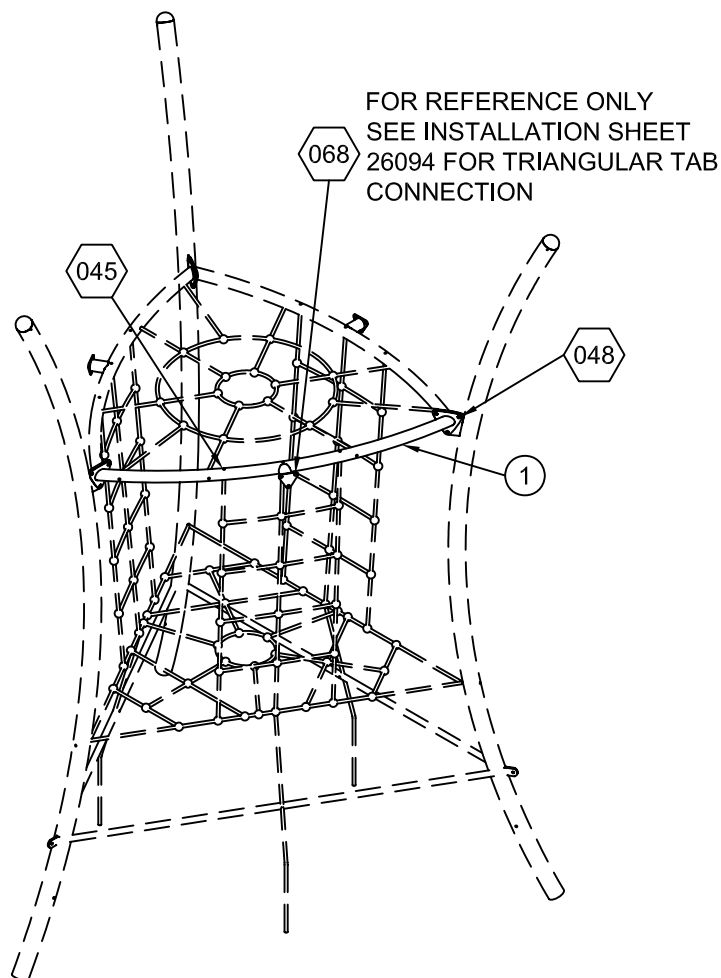

ASSEMBLY DRAWING

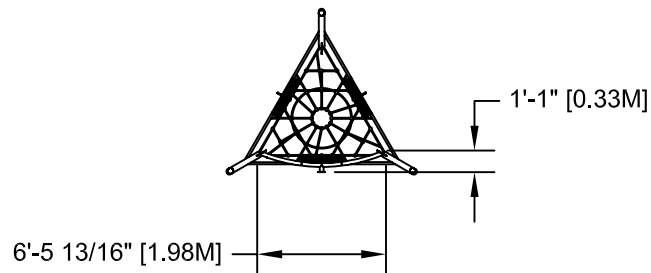

TOP VIEW
26086

PARTS LIST

| <i>REF NO.</i> | <i>DESCRIPTION</i> | <i>26086</i> | <i>PART NUMBER</i> |
|---------------------------|----------------------------------|---------------------|-------------------------------|
| 1 | Heliocentrix Support Rung w/ Tab | 1 | 178709 |
| | <i>Hardware Complete</i> | 1 | 178260 |
| | 3/8" x 3/4" P.B.H.C.S. | 3 | 812052* |
| | 3/8" Lockwasher | 9 | 817334* |
| | 3/8" Flatwasher | 6 | 817410* |
| | 3/8" Barrel Nut | 3 | 804804* |
| | 3/8" x 2 1/2" P.B.H.C.S. | 6 | 812057* |
| | 1/2" Flatwasher | 3 | 817412* |

Unless Otherwise Specified, All Units of Measure are Each

** Included in Hardware*

Warning: During Installation, Hardware And Small Parts Are Choking Hazards For Young Children. Store Unused Parts Appropriately Until Assembly Is Completed. Once Assembly Is Completed, Remove Any Unused Parts From The Play Environment And Dispose/Save Them In A Secure Location.

DETAILS -for- 26086

IMPORTANT

TO REDUCE THE RISK OF CLOTHING ENTANGLEMENT IN COMPLIANCE WITH ASTM F1487, ANY BOLT END PROTRUDING MORE THAN TWO FULL THREADS BEYOND THE FACE OF THE NUT SHALL BE CUT-OFF FLUSH, FILED SMOOTH AND TREATED TO PREVENT CORROSION.

NOTE: AFTER ASSEMBLY IS COMPLETE, PEEN TEE-NUTS AND FLATWASHERS TO MATCH RADIUS OF PIPE.

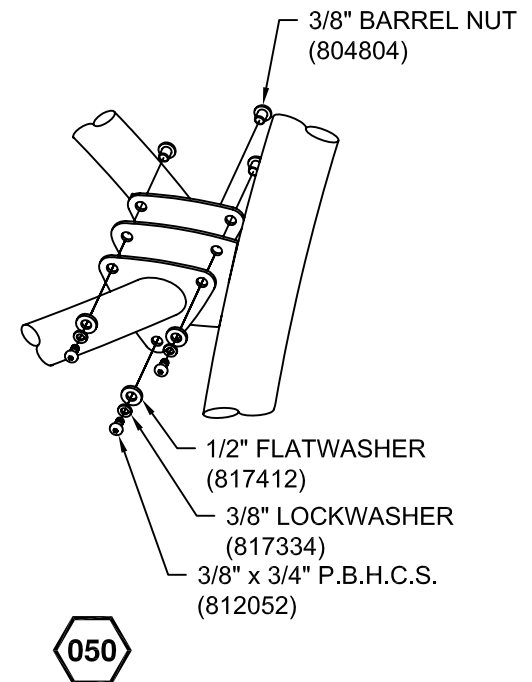
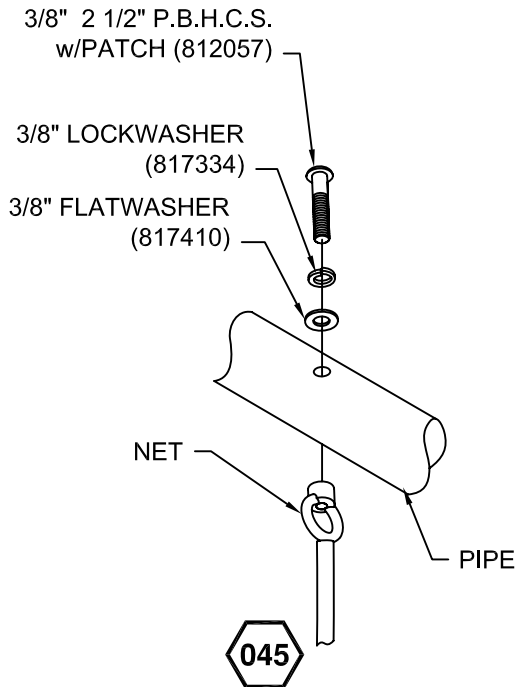
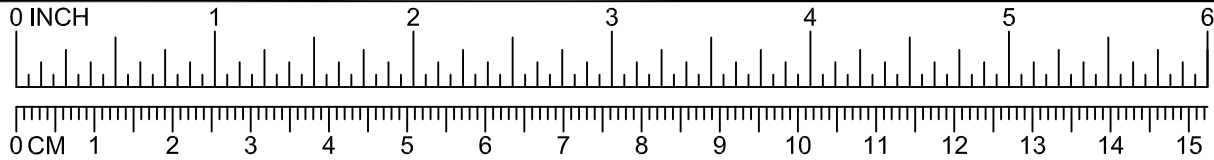

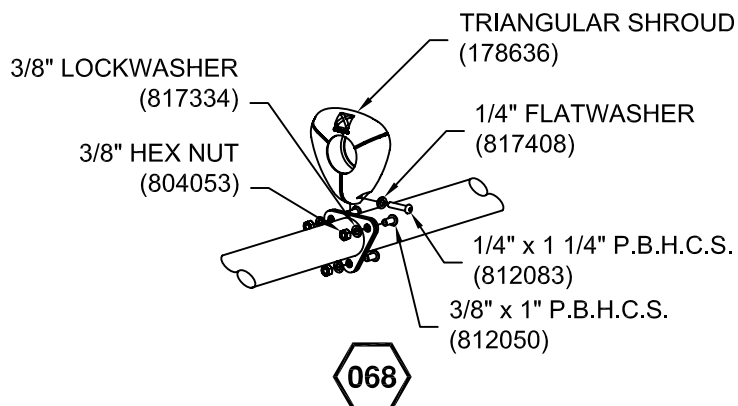

STRETCH TRIANGULAR SHROUD
OVER TRIANGLE TABS BEFORE
INSTALLING 1/4" x 1 1/4" B.H.C.S.

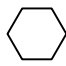

NOTE: SEE INSTALLATION SHEET
26094 FOR RUBBER SHROUD
CONNECTION DETAIL. HARDWARE
FOR THIS CONNECTION IS LOCATED
IN HARDWARE COMPLETE #178755

HELIOCENTRIX

-  = INSTALLATION
 = DETAIL
 = PARTS LIST
 = REFERENCE

INSTRUCTIONS

- Before assembling this equipment, read the enclosed *INSTALLER INSTRUCTIONS* in the installation booklet; follow all the instructions during installation.
- Assemble parts as shown in the *ASSEMBLY DRAWING*. Refer to the assembly details for the specific hardware required in each connection.
- Loctite (supplied by others) should be used on all threaded hardware.

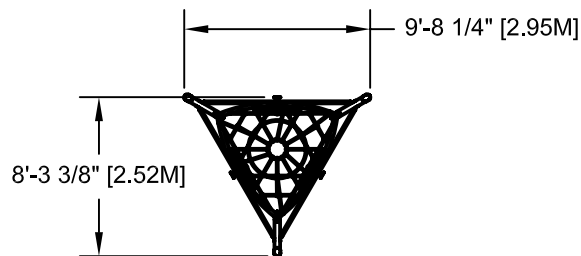

TOP VIEW

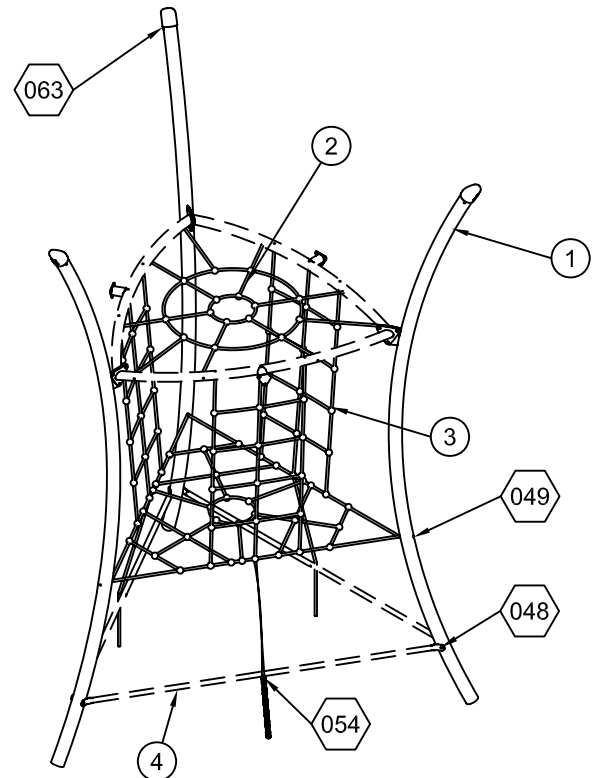

ASSEMBLY DRAWING

PARTS LIST

| REF NO. | DESCRIPTION | No. REQ'D | PART NUMBER |
|---------|-------------------------------------|-----------|-------------|
| 1 | Heliocentrix Upright | 3 | 178720 |
| 2 | Top Net | 1 | 178241 |
| 3 | Bottom Net | 1 | 178242 |
| 4 | Bottom Spacer Bar | 3 | 178221 |
| | Hardware Complete | 1 | 178730 |
| | 3/8" x 4" B.H.S.C.S. | 3 | 811076* |
| | 3/8" Lockwasher | 3 | 817334* |
| | 3/8" Flatwasher | 9 | 817410* |
| | 3/8" x 4 1/2" P.B.H.S.C.S. w/ Patch | 3 | 812077* |
| | 3/8" Hex Nut | 3 | 804200* |
| | 1/4" Hex Nut | 3 | 804351* |
| | 1/4" x 2 1/2" Hex Head Bolt | 3 | 800808* |
| | Post Topper | 3 | 178676* |
| | 3/8" x 1/2" P.B.H.C.S. w/Patch | 6 | 812049* |

Unless Otherwise Specified, All Units of Measure are Each

* Included in Hardware

Warning: During Installation, Hardware And Small Parts Are Choking Hazards For Young Children. Store Unused Parts Appropriately Until Assembly Is Completed. Once Assembly Is Completed, Remove Any Unused Parts From The Play Environment And Dispose/Save Them In A Secure Location.

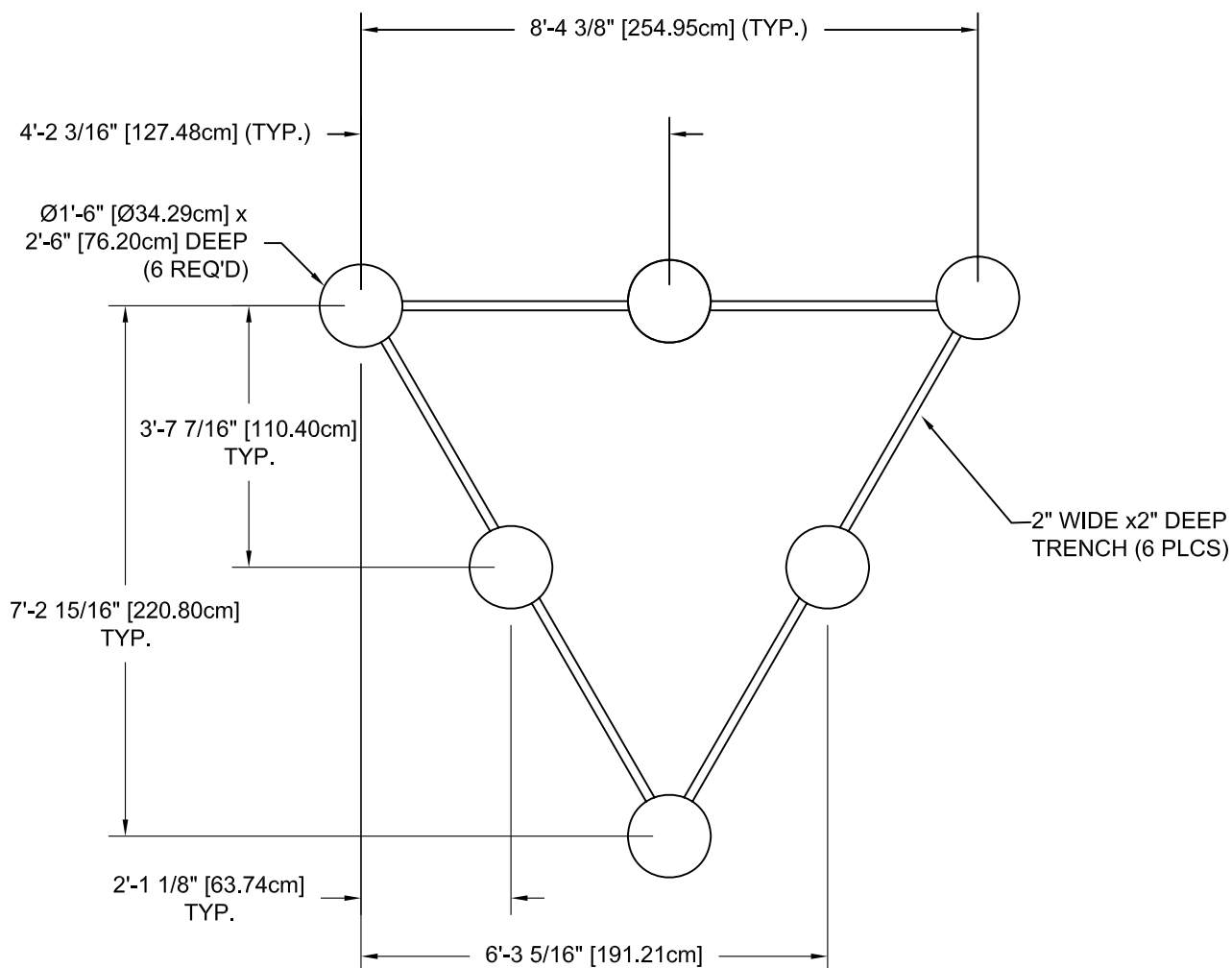

NOTE: HOLE DEPTHS INDICATED ON ALL GROUND PLANS ARE MEASURED FROM THE FINISHED SURFACE. SEE DETAIL 003. ALL FOOTING DIMENSIONS ARE BASED ON LEVEL FINISHED SURFACE.

GROUND PLAN

CONCRETE REQUIRED
.72 CUBIC YARDS
[.54 CUBIC METERS]

DETAILS -for- 26087

IMPORTANT

To REDUCE THE RISK OF CLOTHING ENTANGLEMENT IN COMPLIANCE WITH ASTM F1487, ANY BOLT END PROTRUDING MORE THAN TWO FULL THREADS BEYOND THE FACE OF THE NUT SHALL BE CUT-OFF FLUSH, FILED SMOOTH AND TREATED TO PREVENT CORROSION.

NOTE: AFTER ASSEMBLY IS COMPLETE, PEEN TEE-NUTS AND FLATWASHERS TO MATCH RADIUS OF PIPE.

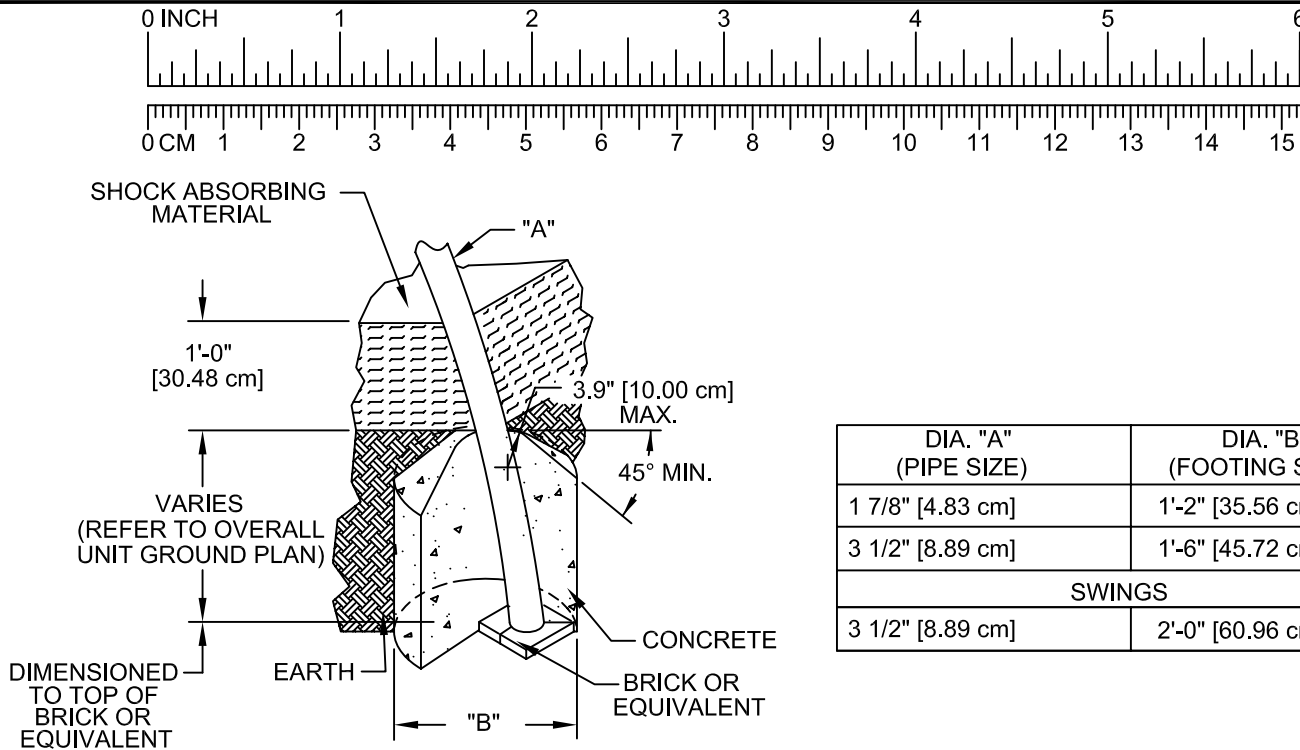

NOTES:

- SLOPED FOOTING IS A REQUIREMENT OF EUROPEAN STANDARD EN1176-1
- SUGGESTED MINIMUM CONCRETE RATING: 3000 PSI

SHOCK ABSORBING PROPERTIES OF SURFACING MATERIALS VARY. IF YOU DETERMINE THAT LESS THAN 1'-0" [30.48cm] OF SURFACING IS REQUIRED, MAKE UP THE DIFFERENCE IN ELEVATION WITH EARTH, BEFORE APPLYING SURFACING.

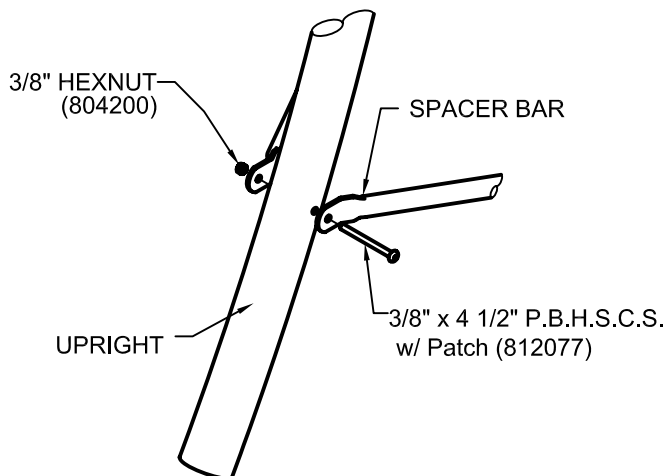

048

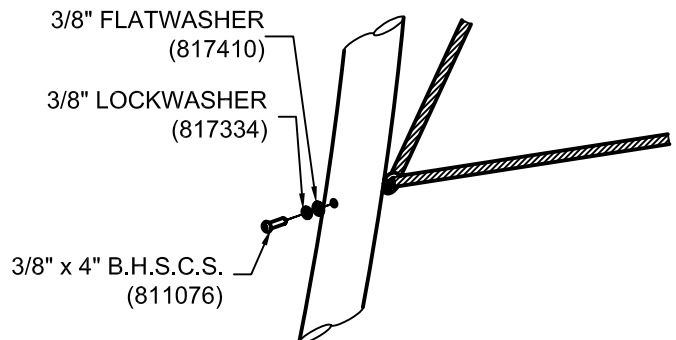

049

DETAILS -for- 26087

IMPORTANT

To Reduce the Risk of Clothing Entanglement in Compliance with ASTM F1487, Any Bolt End Protruding More Than Two Full Threads Beyond the Face of the Nut Shall Be Cut-Off Flush, Filed Smooth and Treated to Prevent Corrosion.

NOTE: AFTER ASSEMBLY IS COMPLETE, PEEN TEE-NUTS AND FLATWASHERS TO MATCH RADIUS OF PIPE.

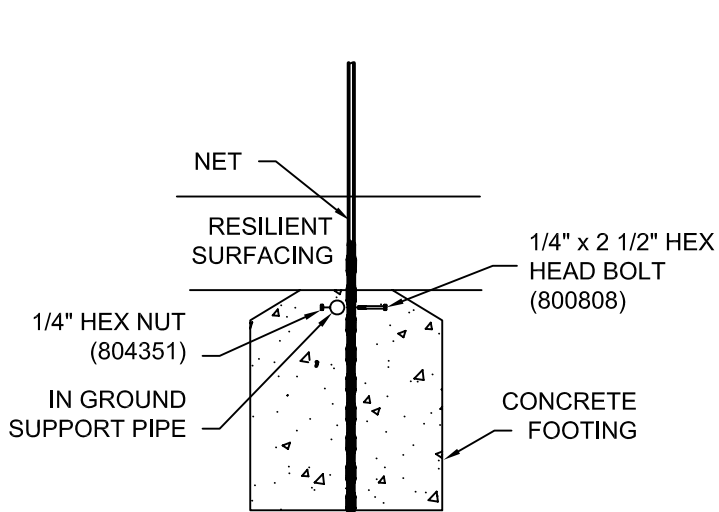
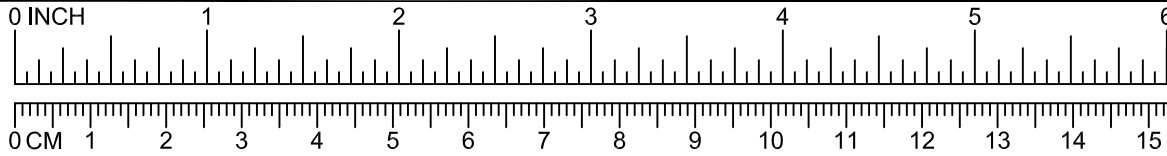

054

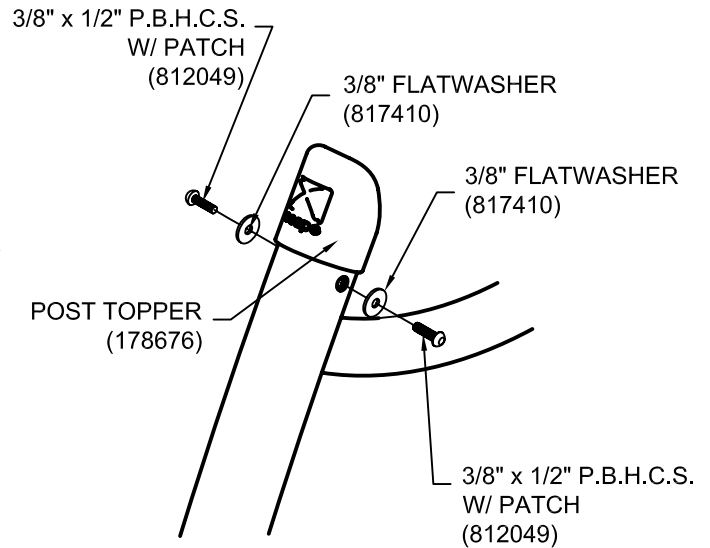

063





Enriching Childhood Through Play™

1-800-235-2440

ISSUED/REVISED: 2/12/09

26091

CROSS BEAM CONNECTOR

-  = INSTALLATION
DETAIL
-  = PARTS LIST
REFERENCE

| | |
|--------------------------------|-------|
| SINGLE LINK CROSS BEAM | 26091 |
| DOUBLE LINK CROSS BEAM | 26090 |
| PS PLUS SINGLE LINK CROSS BEAM | 26092 |
| PT SINGLE LINK CROSS BEAM | 26093 |

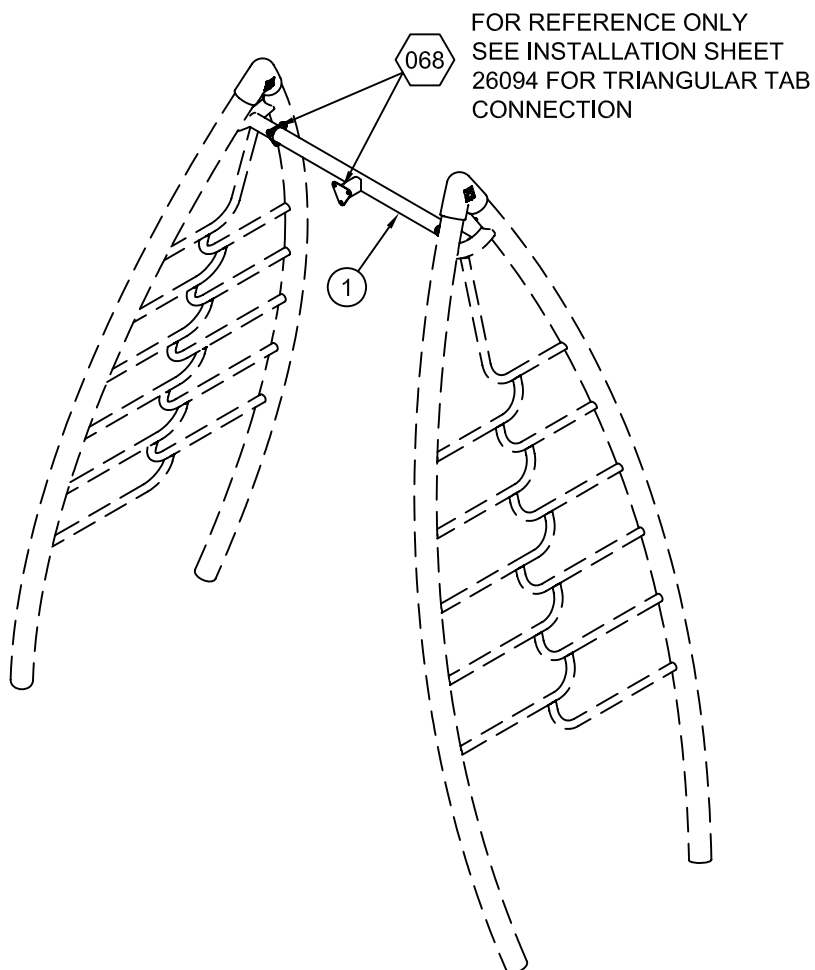

ASSEMBLY DRAWING
26091 SHOWN
26090 SIMILAR

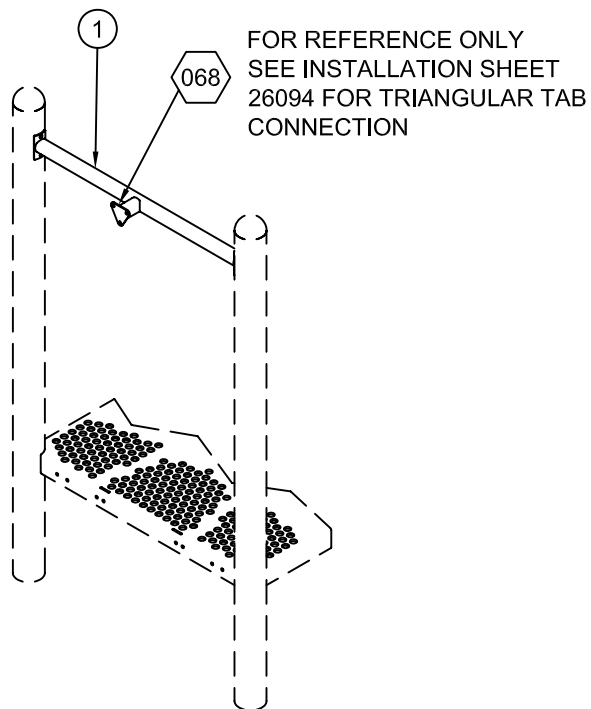

ASSEMBLY DRAWING
26092 SHOWN
26093 SIMILAR

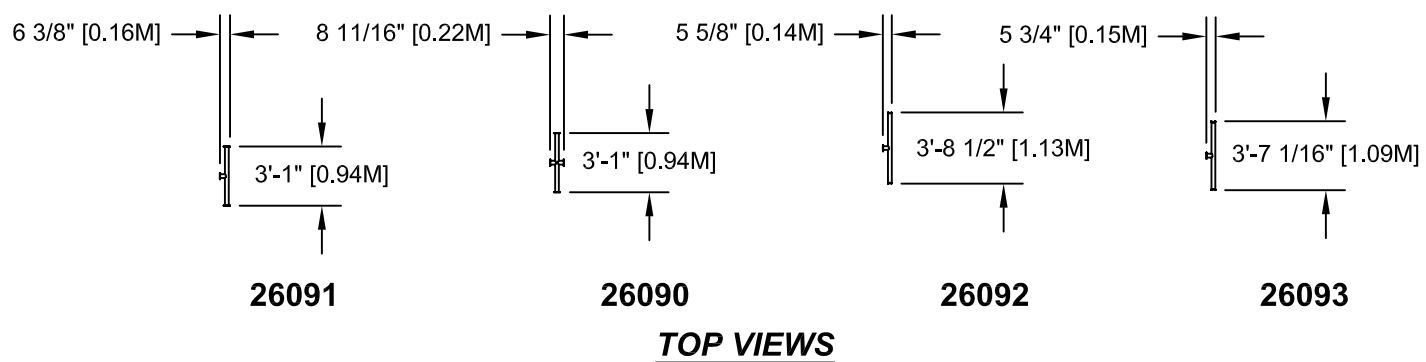

PARTS LIST

| REF NO. | DESCRIPTION | No. REQ'D | | | | PART NUMBER |
|--------------------|----------------------------------|------------------|--------------|--------------|--------------|------------------------|
| | | 26091 | 26090 | 26092 | 26093 | |
| 1 | Single Link Cross Beam | 1 | 0 | 0 | 0 | 178827 |
| 1 | Double Link Cross Beam | 0 | 1 | 0 | 0 | 178569 |
| 1 | PS Plus Single Link Cross Beam | 0 | 0 | 1 | 0 | 178829 |
| 1 | PrimeTime Single Link Cross Beam | 0 | 0 | 0 | 1 | 178831 |
| | Hardware Complete | 0 | 0 | 1 | 1 | 178832 |
| | 3/8" X 1" P.B.H.C.S. w/Patch | 0 | 0 | 4 | 4 | 812050* |
| | 3/8" Lockwasher | 0 | 0 | 4 | 4 | 817334* |

Unless Otherwise Specified, All Units of Measure are Each

** Included in Hardware*

**Warning: During Installation, Hardware And Small Parts Are Choking Hazards
For Young Children. Store Unused Parts Appropriately Until Assembly Is Completed.
Once Assembly Is Completed, Remove Any Unused Parts From The Play Environment
And Dispose/Save Them In A Secure Location.**

DETAILS -for- 26091, 26090, 26092 AND 26093

IMPORTANT

To REDUCE THE RISK OF CLOTHING ENTANGLEMENT IN COMPLIANCE WITH ASTM F1487, ANY BOLT END PROTRUDING MORE THAN TWO FULL THREADS BEYOND THE FACE OF THE NUT SHALL BE CUT-OFF FLUSH, FILED SMOOTH AND TREATED TO PREVENT CORROSION.

NOTE: AFTER ASSEMBLY IS COMPLETE, PEEN TEE-NUTS AND FLATWASHERS TO MATCH RADIUS OF PIPE.

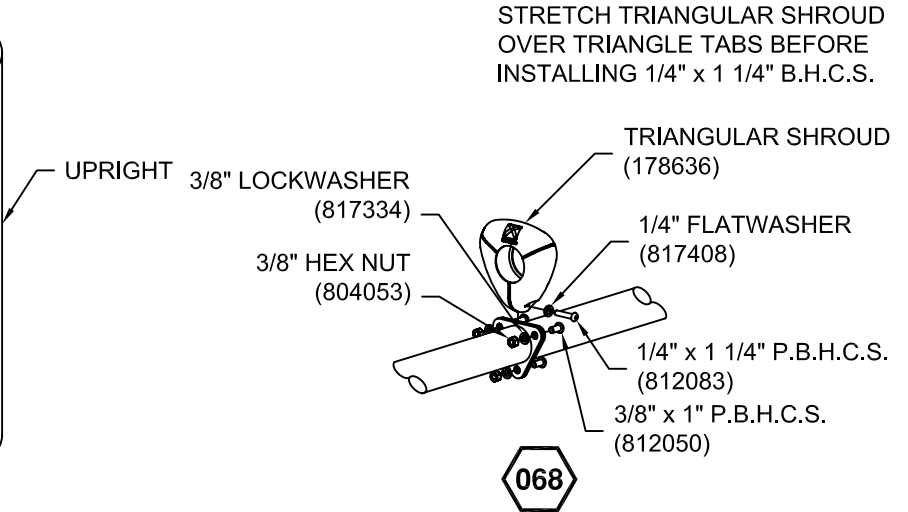
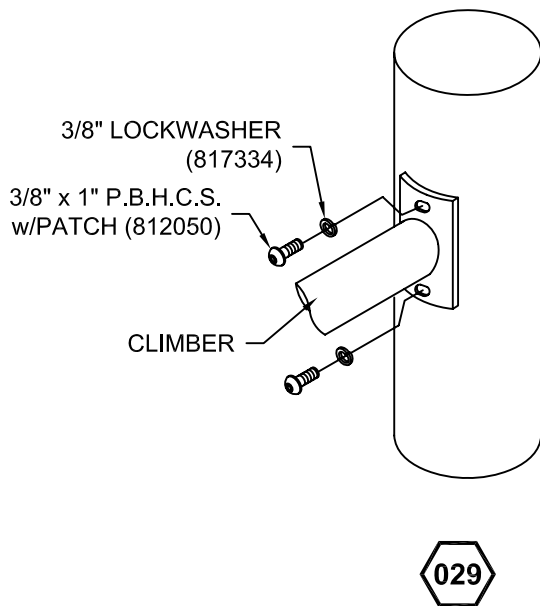
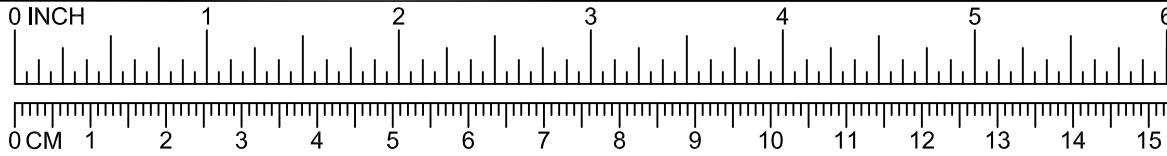

NOTE: SEE INSTALLATION SHEET 26094 FOR RUBBER SHROUD CONNECTION DETAIL. HARDWARE FOR THIS CONNECTION IS LOCATED IN HARDWARE COMPLETE #178755



Enriching Childhood Through Play™

1-800-235-2440

ISSUED/REVISED: 2/4/09

26094

TRIANGULAR SHROUD

- ⬡ = INSTALLATION
DETAIL
- = PARTS LIST
REFERENCE

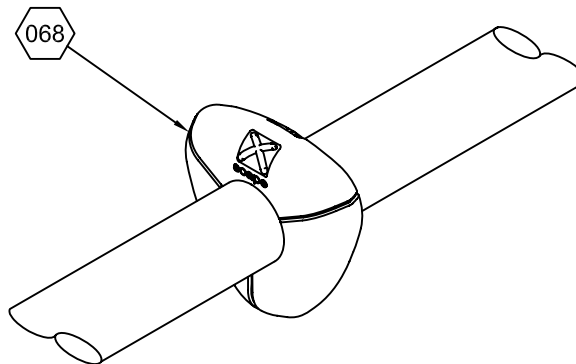

INSTRUCTIONS

1. Before assembling this equipment, read the enclosed *INSTALLER INSTRUCTIONS* in the installation booklet; follow all the instructions during installation.
2. Assemble parts as shown in the *ASSEMBLY DRAWING*. Refer to the assembly details for the specific hardware required in each connection.
3. Loctite (supplied by others) should be used on all threaded hardware.

ASSEMBLY DRAWING

PARTS LIST

| REF NO. | DESCRIPTION | No. REQ'D | PART NUMBER |
|---------|--------------------------|-----------|-------------|
| | Hardware Complete | 1 | 178755 |
| | Triangular Shroud | 1 | 178636* |
| | 3/8" x 1" P.B.H.C.S. | 3 | 812050* |
| | 3/8" Lockwasher | 3 | 817334* |
| | 3/8" Hex Nut | 3 | 804053* |
| | 1/4" x 1 1/4" P.B.H.C.S. | 1 | 812083 |
| | 1/4" Flatwasher | 1 | 817408* |

Unless Otherwise Specified, All Units of Measure are Each

** Included in Hardware*

Warning: During Installation, Hardware And Small Parts Are Choking Hazards For Young Children. Store Unused Parts Appropriately Until Assembly Is Completed. Once Assembly Is Completed, Remove Any Unused Parts From The Play Environment And Dispose/Save Them In A Secure Location.

DETAILS -for- 26094

IMPORTANT

To REDUCE THE RISK OF CLOTHING ENTANGLEMENT IN COMPLIANCE WITH ASTM F1487, ANY BOLT END PROTRUDING MORE THAN TWO FULL THREADS BEYOND THE FACE OF THE NUT SHALL BE CUT-OFF FLUSH, FILED SMOOTH AND TREATED TO PREVENT CORROSION.

NOTE: AFTER ASSEMBLY IS COMPLETE, PEEN TEE-NUTS AND FLATWASHERS TO MATCH RADIUS OF PIPE.

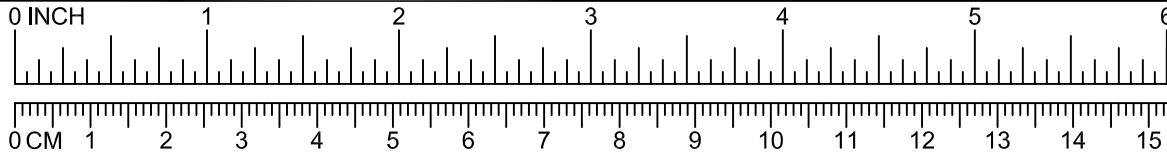

STRETCH TRIANGULAR SHROUD
OVER TRIANGLE TABS BEFORE
INSTALLING 1/4" x 1 1/4" B.H.C.S.

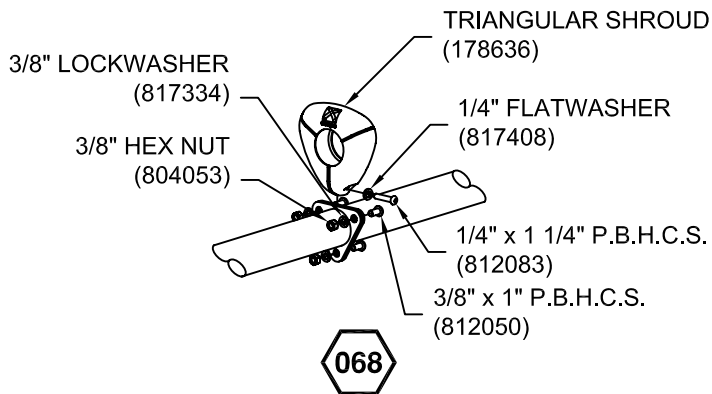

XSCAPE



Enriching Childhood Through Play™

1-800-235-2440

ISSUED/REVISED: 12/07/09

26105

SUPPORT RUNG FOR HELIOCENTRIX

⬡ = INSTALLATION
DETAIL

○ = PARTS LIST
REFERENCE

INSTRUCTIONS

1. Before assembling this equipment, read the enclosed *INSTALLER INSTRUCTIONS* in the installation booklet; follow all the instructions during installation.
2. Assemble parts as shown in the *ASSEMBLY DRAWING*. Refer to the assembly details for the specific hardware required in each connection.
3. Loctite (supplied by others) should be used on all threaded hardware.

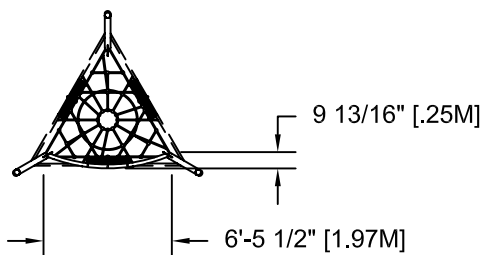

TOP VIEW

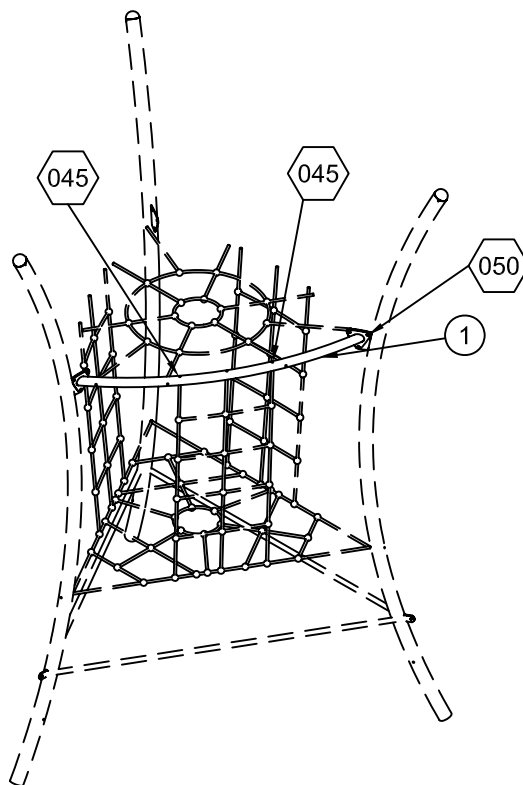

ASSEMBLY VIEW

PARTS LIST

| REF NO. | DESCRIPTION | NO. REQ'D | PART NUMBER |
|---------|--------------------------|-----------|-------------|
| 1 | Heliocentrix Top Bar | 1 | 178257 |
| | Hardware Complete | 1 | 178260 |
| | 3/8" x 3/4" P.B.H.C.S. | 3 | 812052* |
| | 3/8" Lockwasher | 9 | 817334* |
| | 3/8" Flatwasher | 6 | 817410* |
| | 3/8" Barrel Nut | 3 | 804804* |
| | 3/8" x 2 1/2" P.B.H.C.S. | 6 | 812057* |
| | 1/2" Flatwasher | 3 | 817412* |

Unless Otherwise Specified, All Units of Measure are Each

** Included in Hardware*

Warning: During Installation, Hardware And Small Parts Are Choking Hazards For Young Children. Store Unused Parts Appropriately Until Assembly Is Completed. Once Assembly Is Completed, Remove Any Unused Parts From The Play Environment And Dispose/Save Them In A Secure Location.

DETAILS -for- 26105

IMPORTANT

To REDUCE THE RISK OF CLOTHING ENTANGLEMENT IN COMPLIANCE WITH ASTM F1487, ANY BOLT END PROTRUDING MORE THAN TWO FULL THREADS BEYOND THE FACE OF THE NUT SHALL BE CUT-OFF FLUSH, FILED SMOOTH AND TREATED TO PREVENT CORROSION.

NOTE: AFTER ASSEMBLY IS COMPLETE, PEEN TEE-NUTS AND FLATWASHERS TO MATCH RADIUS OF PIPE.

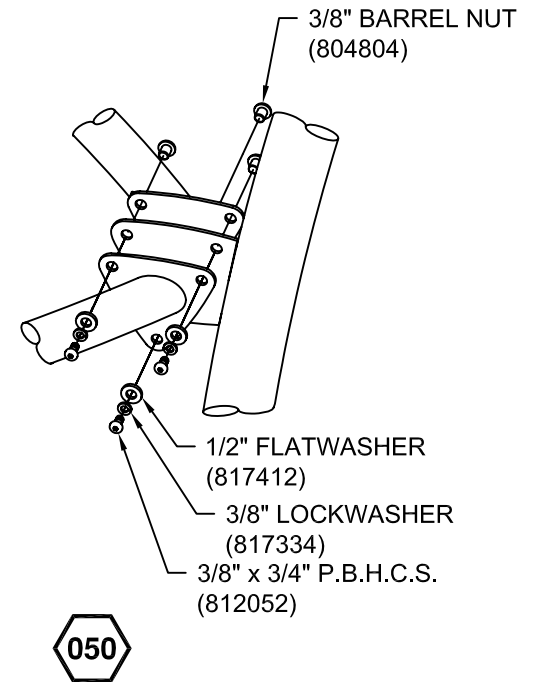
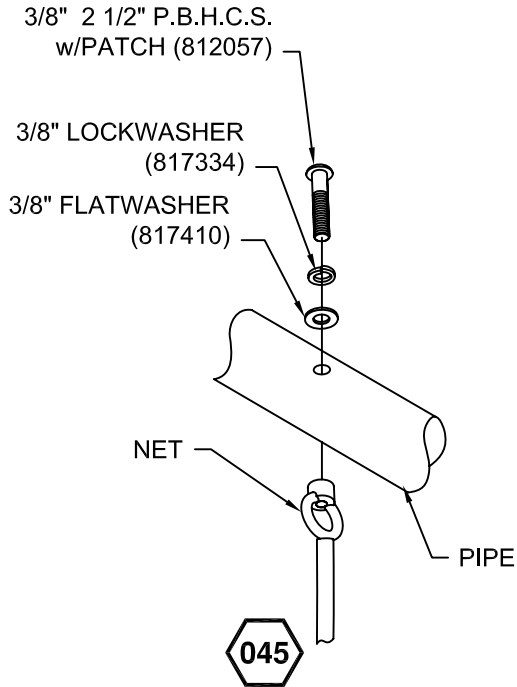
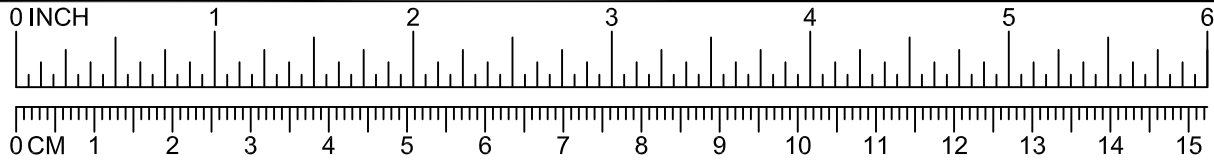

⬡ = INSTALLATION
DETAIL

○ = PARTS LIST
REFERENCE



| | | |
|--|--|--------------|
| | VERT ROCK | 26107 |
| | ARCH ROCK | 26108 |
| | ROCK STEP | 26109 |
| | SINGLE ROCK UPRIGHT | 26111 |
| | DOUBLE ROCK UPRIGHT | 26112 |
| | SINGLE ROCK UPRIGHT ATTACHMENT W/ ROCK STEP | 26113 |
| | DOUBLE ROCK UPRIGHT DUAL ATTACHMENT | 26114 |
| | DOUBLE ROCK UPRIGHT 90° ATTACHMENT | 26115 |
| | SINGLE ROCK UPRIGHT 90° ATTACHMENT | 26116 |
| | SINGLE ROCK UPRIGHT 90° ATTACHMENT (REVERSE) | 26117 |
| | SINGLE ROCK UPRIGHT DUAL ATTACHMENT W/ROCK STEP | 26118 |



26107
VERT ROCK

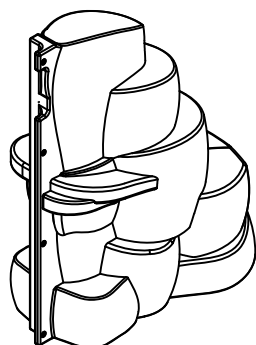

26108
ARCH ROCK



26109
ROCK STEP

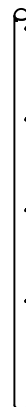

26111
SINGLE ROCK
UPRIGHT



26112
DOUBLE ROCK
UPRIGHT



26113
SINGLE ROCK
UPRIGHT
ATTACHMENT
W/ROCK STEP

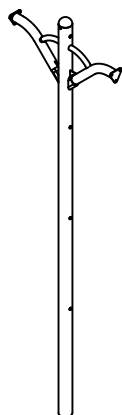

26114
DOUBLE ROCK
UPRIGHT DUAL
ATTACHMENT



26115
DOUBLE ROCK
UPRIGHT 90°
ATTACHMENT



26116
SINGLE ROCK
UPRIGHT 90°
ATTACHMENT



26117
SINGLE ROCK
UPRIGHT 90°
ATTACHMENT
(REVERSE)

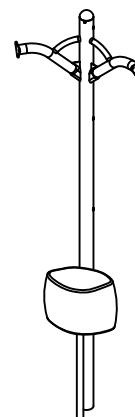

26118
SINGLE ROCK
UPRIGHT DUAL
ATTACHMENT
W/ROCK STEP

INSTALLATION INSTRUCTIONS

1. Before assembling this equipment, read the enclosed INSTALLATION INSTRUCTIONS in the installation booklet; follow all the instructions during installation.
2. Assemble parts as shown in the ASSEMBLY DRAWING. Refer to the assembly details for the specific hardware required in each connection.

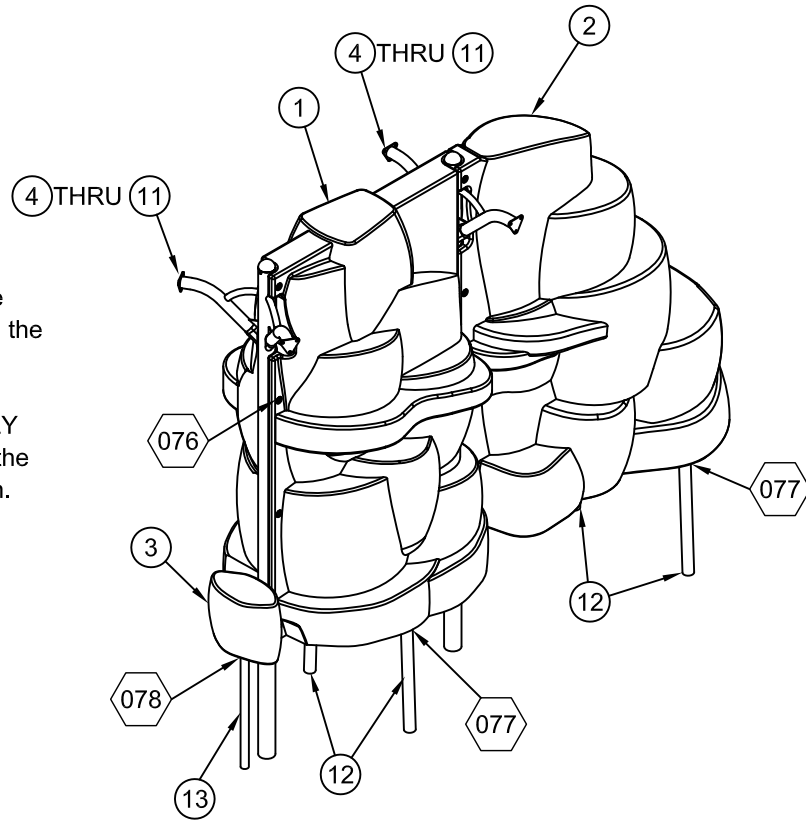

ASSEMBLY VIEW

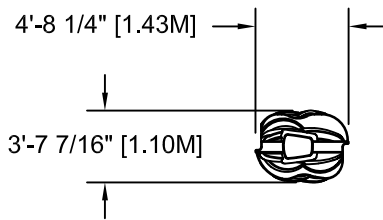

26107

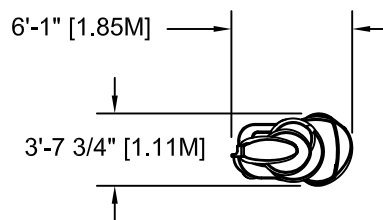

26108

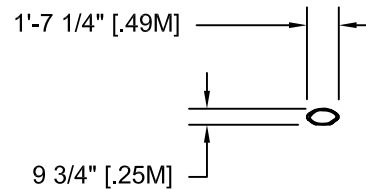

26109

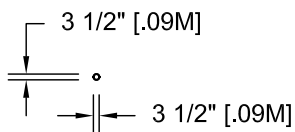

26111

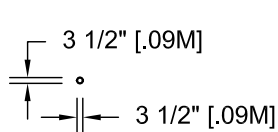

26112

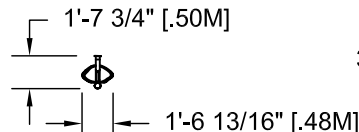

26113

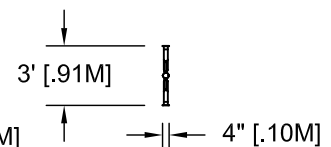

26114

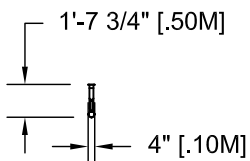

26115

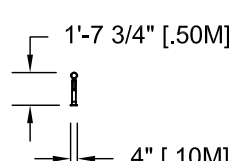

26116

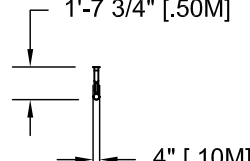

26117

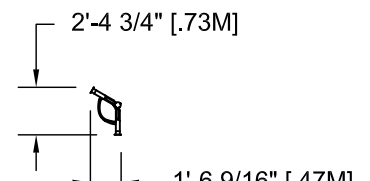

26118

TOP VIEWS

SPECIFICATIONS

ROCKSCAPE ROTOMOLDED PIECES: Shall be manufactured from linear low-density polyethylene material. Polyethylene shall be linear low-density material with UV stabilized color and an anti-static compound additive. Rotationally molded products shall meet or exceed the following specifications: ASTM D-1248, type 2, class A and Federal specification LP-390C, type 1, class M, grade 2, category 3; Density (ASTM D-1505); Brittleness Temperature (ASTM D-746); Tensile Values (ASTM D-638); Flexural Modulus (ASTM-790); Heat Distortion (ASTM-648); Low Temperature Impact (ARM-STD).

METAL COMPONENTS: The Rockstep Footbuck shall be fabricated from 1 5/8" O.D. x .083" (14 Gauge) galvanized steel pipe, 3/16" hot rolled flat steel. The Footbuck shall be fabricated from 2.375" O.D. x .13" Sch. 40 wall galvanized steel pipe and and formed .09" (12 gauge) hot rolled steel plate. The Footbuck Weld Assemblies shall be all welded assemblies and shall be coated with a custom formula of TGIC polyester powder.

STEEL TUBING: All tubing used to manufacture components shall be an electrical resistance welded, cold rolled, high strength steel tubing. The exterior coating will consist of an in line hot-dipped uniform zinc galvanizing, chromate conversion, and acrylic over-coating. The interior coating will consist of a special organic acrylic modified polyester.

POWDER COAT FINISH: Shall be an electrostatically applied custom formula of TGIC polyester powder. All components will be free of sharp edges and excess weld spatter and shall be cleaned in a six stage bath system with an iron phosphate wash, as a rust inhibitor, and a sealer to prevent flash rusting before coating. The coating shall have a super tough finish with maximum exterior durability and will have superior adhesion characteristics. Typical characteristics are: 3.0 - 5.0 mil thickness and oven cured between 375 to 425 degrees Fahrenheit. Pencil Hardness H (ASTM D-3363), Impact (ASTM D-2794-69), Wedge Bend (ASTM D-522-68).

HARDWARE: All nuts, bolts, screws, inserts, and lockwashers used in the assembly of all play equipment, shall be stainless steel, yellow dichromate plated steel, blue-coat plated steel, mechanically galvanized or powder coated/yellow dichromate plated steel. All primary fasteners shall be 300 series stainless steel. Fasteners with yellow dichromate treatment have an electro deposited, 99.9% pure zinc substrate applied from a specially formulated solution sealed with a yellow dichromate top coat designed to work in conjunction with the zinc plating. Yellow dichromate has a 320% longer life to white corrosion and 275% longer to red corrosion than does hot dip galvanizing. NOTE: All weights are based on average comparisons of each part.

SPECIFICATIONS: GAMETIME has a policy of continuous improvement and reserves the right to discontinue or change specifications without notice.



IMPORTANT PRODUCT INFORMATION AND SAFETY WARNINGS



☐ All equipment should be installed on a soft, resilient, energy-absorbing ground surface. NEVER INSTALL PLAY EQUIPMENT ON CONCRETE OR ASPHALT. A fall on a hard surface can result in serious injury to the equipment user.

☐ ALWAYS FOLLOW INSTALLATION INSTRUCTIONS WHEN ERECTING EQUIPMENT.

☐ Worn surfaces around equipment should be restored. Concrete footings should never be exposed. Surface depth should comply with installation instructions.

☐ Equipment should be placed to eliminate conflicting traffic patterns.

☐ All protruding nuts and bolts should be covered; sharp edges on pipes should be capped or removed. Check for bent, broken or severely worn pipe and replace.

☐ Test overall stability and rigidity of all play equipment. Check for proper assembly, installation and ground anchoring.

☐ Check for and repair damage caused by wear or vandalism, a major factor in injury-causing situations.

☐ GAMETIME® PROVIDES ITS CUSTOMERS WITH COMPLETE SPECIFICATION SHEETS AND INSTALLATION INSTRUCTIONS. THE SPECIFICATION SHEET CONTAINS THE LISTING OF EVERY PART USED IN A PIECE OF EQUIPMENT AND SHOULD BE KEPT IN THE CUSTOMER'S FILES FOR ACCURATE REFERENCE WHEN REPLACEMENT PARTS ARE NEEDED.

☐ Never add components not intended for use with this product.

☐ Regular maintenance is necessary on this and all park and recreational equipment to ensure the safety of the user.

☐ Proper maintenance of GAMETIME® equipment requires regular tightening of all bolts, nuts, and set screws.

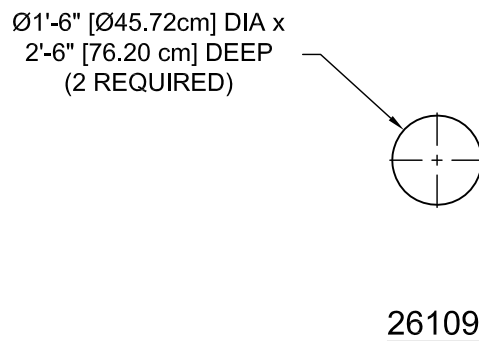
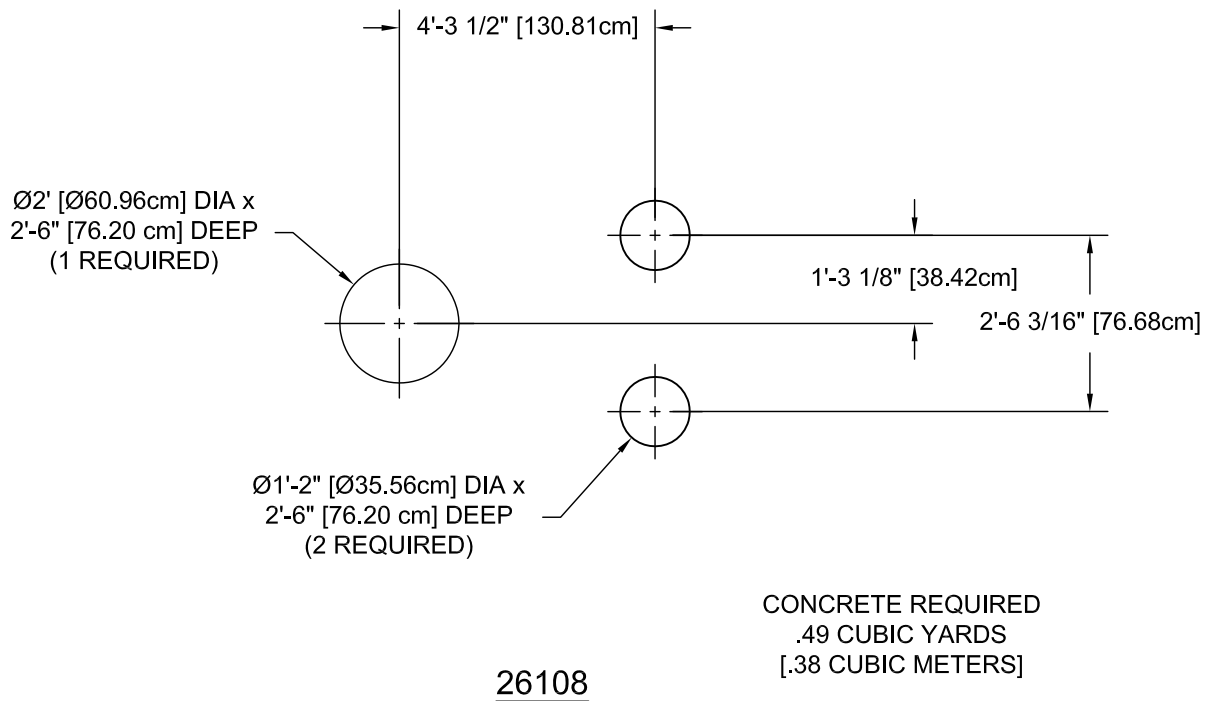
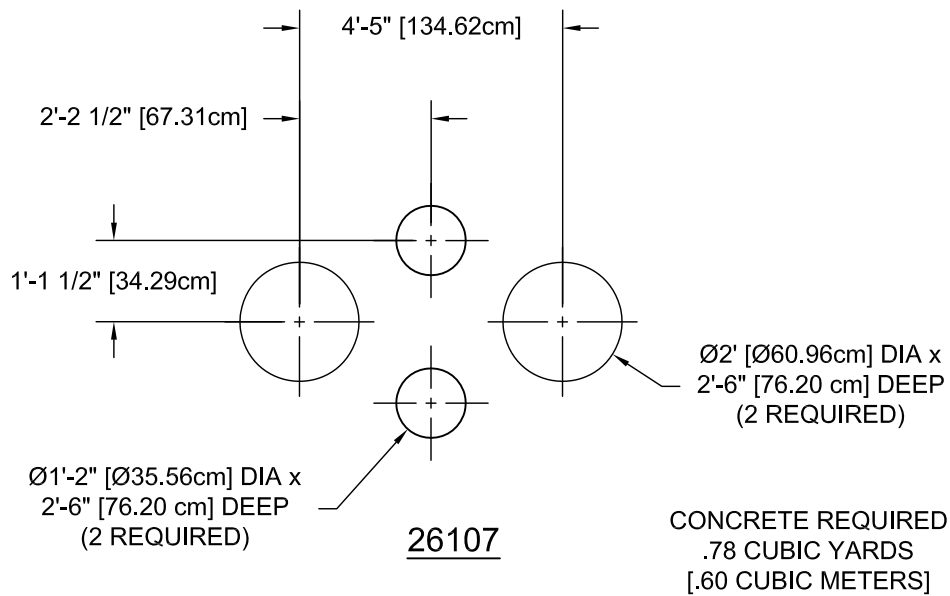

CONCRETE REQUIRED
.10 CUBIC YARDS
[.08 CUBIC METERS]

GROUND PLANS

NOTE:
HOLE DEPTHS INDICATED ON ALL
GROUND PLANS ARE MEASURED FROM
THE FINISHED SURFACE. SEE DETAIL
003. ALL FOOTING DIMENSIONS ARE
BASED ON LEVEL FINISHED SURFACE.