

CBJ- Lemon Creek Reservoir Site-Aerial Photo

Not to Scale

CBJ-Lemon Creek
Reservoir Tank
Diameter: 95'-0"
Height: 32'-6"
Capacity: 1.6 million gallons

Foundation: Concrete ring over sand fill
Year built: 1984 by PDM

Accessories and Access:

One 30" side access manhole, one 24" side access manhole
24" square horizontal access hatch on roof
30" dia. roof vent with cap, 10" dia. tank overflow pipe
Two roof safety tie offs

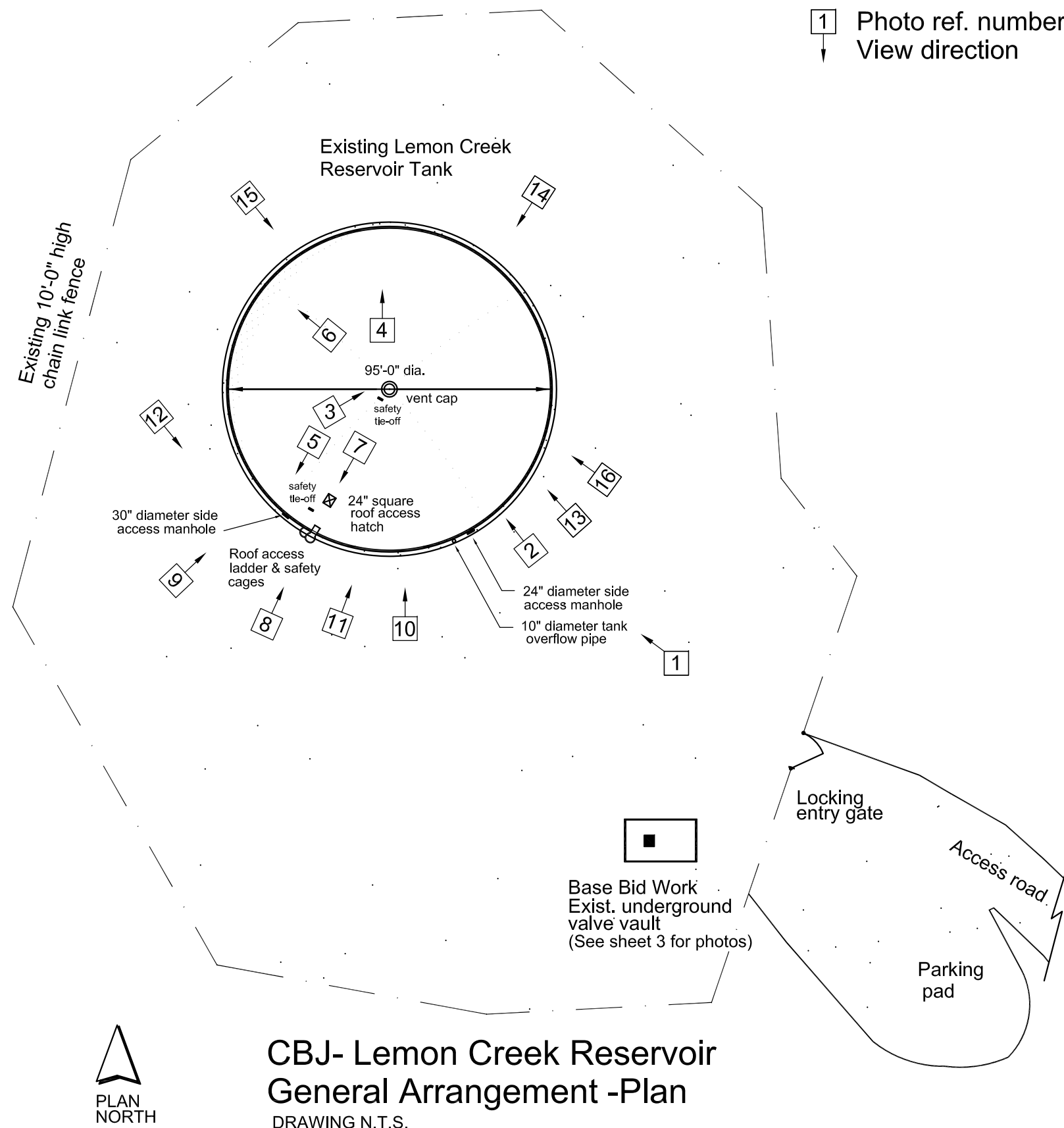

Photo legend:
See sheet 2 of 3

1 Photo ref. number
↓ View direction

CBJ- Lemon Creek Reservoir General Arrangement -Plan

DRAWING N.T.S.

CBJ - WATER RESERVOIR EXTERIOR PAINTING

Project No. E10-217

CITY/BOROUGH OF JUNEAU Alaska's Capital City

Do not scale from this drawing, use dimensions

BASE BID WORK

CBJ-Lemon Creek
Water Reservoir
Site Plan -NTS

Date:
May, 2010

Sheet number:
1 of 3



1 View to Northwest from access rd.



2 Hinge at 24" side access manhole



3 Exist. 30" dia. roof vent



4 Corrosion spots - 6" average diameter



5 View towards access ladder



6 Sample corrosion on top of tank



7 24" square tank access hatch



8 Corrosion at access ladder



9 30" dia. side access manhole



10 Surface corrosion-approx dia. 6"



11 Rust treated by CBJ in 2007



12 View to Northeast



13 View to North

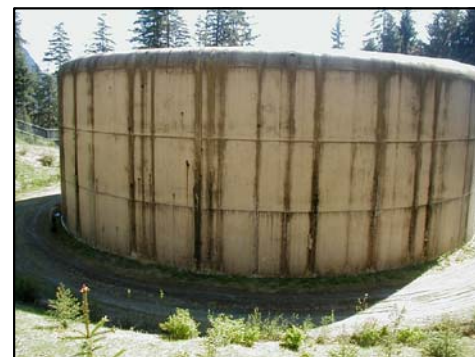

14 View to South



15 View to East



16 CBJ Water dept power washing 2009

CBJ - WATER RESERVOIR EXTERIOR PAINTING

Project No. E10-217

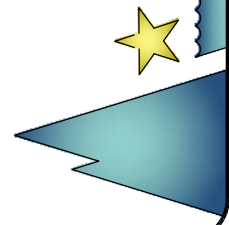

CITY/BOROUGH OF JUNEAU Alaska's Capital City

Do not scale from this drawing, use dimensions

BASE BID WORK
CBJ-Lemon Creek
Reservoir Tank
Reference Photos

Date:
May 2010

Sheet number:
2 of 3



1 36" square access hatch



2 View into valve vault



3 Existing valve piping



4 Valves and controls panelboard



5 General view



6 Existing finish at piping



7 Cathodic protection panel on wall



8 Exist. finish down to black iron



9 Hose bib in vault



10 Note condensation on exist. pipe



11 Inside cathodic rectifier, photo 7, above.



CBJ- Auke Lake Reservoir Site-Aerial Photo

Not to scale

CBJ- Auke Lake
Reservoir Tank
Diameter: 90'-0"
Height: 32'-6"
Capacity: 1.42 million gallons

Foundation: Concrete ring over sand fill
Year built: 1985

Accessories and Access:

One 30" side access manhole, one 24" side access manhole
24" square horizontal access hatch on roof
30" diameter roof vent cap and 4" diameter tank overflow pipe
Two safety line tie-offs on roof

LEGEND

- 1** Photo ref. number
↓ View direction
- Ⓐ Roof vent cap
 - Ⓑ Safety tie off- 2 places
 - Ⓒ 24" square roof access hatch
 - Ⓓ 24" dia.- Side access manhole
 - Ⓔ Roof access ladder and safety cages
 - Ⓕ 4" diameter - tank overflow pipe
 - Ⓖ 36" dia. -Side access manhole

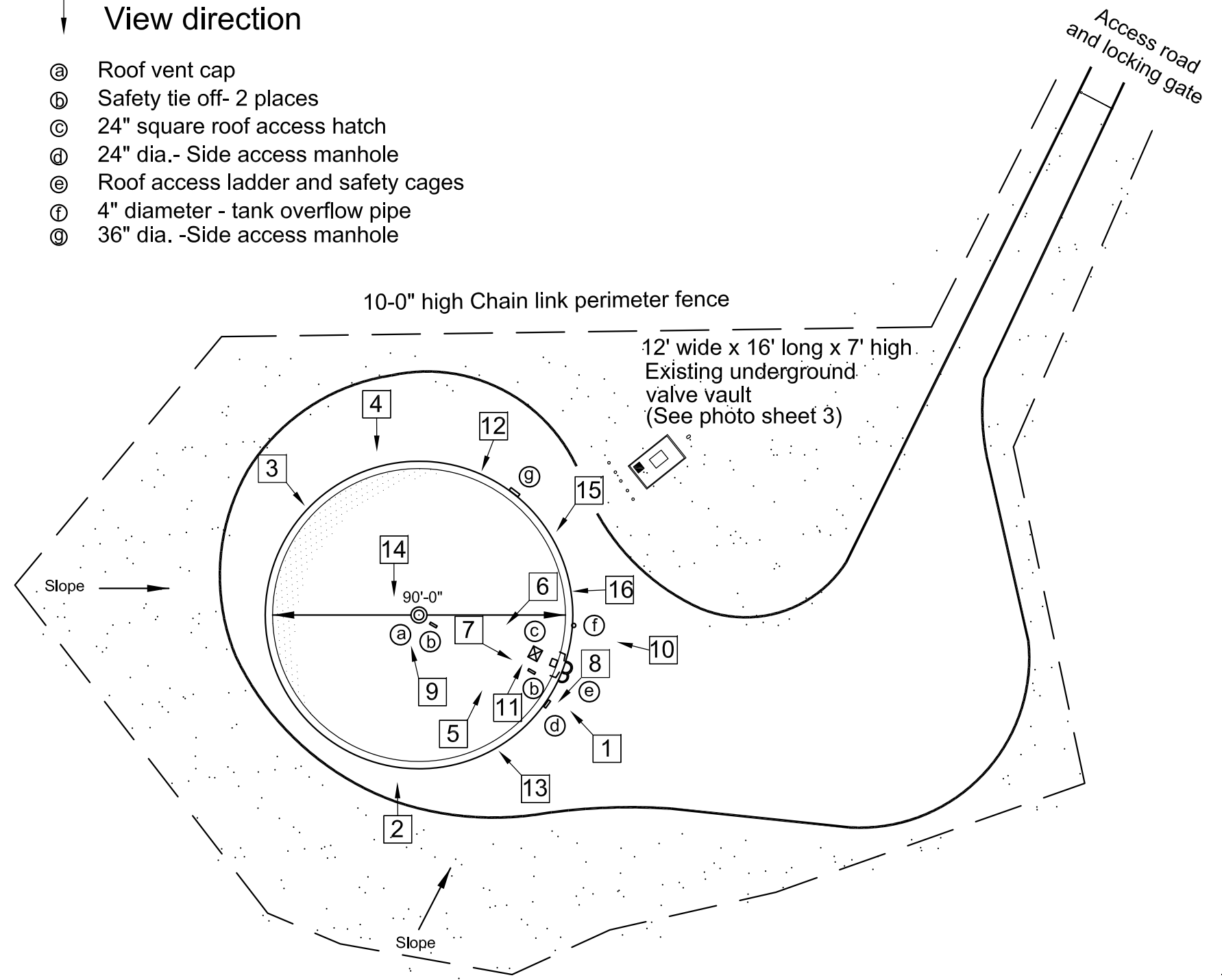

CBJ- Auke Lake Reservoir General Arrangement -Plan

DRAWING N.T.S.



CBJ - WATER RESERVOIR EXTERIOR PAINTING

Project No. EIO-217

CITY/BOROUGH OF JUNEAU Alaska's Capital City

ADDITIVE
ALTERNATE 1

CBJ-Auke Lake
Water Reservoir
Site Plan -NTS

Date:
MAY, 2010

Sheet number:
1 of 3

Do not scale from this drawing, use dimensions



1 Access ladder, overflow pipe & side access manhole



2 View to Northwest



3 View to Southeast



4 View to South



5 Top of tank- view to Northeast



6 Top of tank-exist. conditions



7 Ladder and safety cage



8 Safety railing



9 Top of tank with 30" dia.vent cap



10 Sample rust -approx dia. 6"



11 Access hatch in front of ladder



12 Algae cleaned on side of tank



13 Sample of 6" dia. corrosion spot



14 View of tank top looking South



15 Sample corrosionat grout ring



16 Sample 6" diameter corrosion spot

CBJ - WATER RESERVOIR EXTERIOR PAINTING

Project No. EIO-217

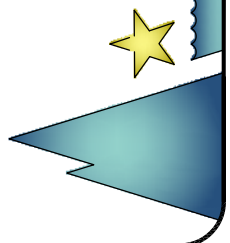

CITY/BOROUGH OF JUNEAU Alaska's Capital City

Do not scale from this drawing, use dimensions

ADDITIVE
ALTERNATE 1

CBJ-Auke Lake
Reservoir Tank
Reference Photos

Date:
May, 2010

Sheet number:
2 of 3



1 Vault access hatch and vent pipe



2 Hatch and vault equip. cover



3 Valve piping-existing paint



4 Vault floor is generally dry



5 Underside of steel equip. cover



6 Pump controls on wall



7 Controls & Cathodic protection



8 Paint on valve box down to blackiron



13 Ladder and cage is in Scope.



14 Existing paint condition



11 Overall view of vault interior



12 Pipe with grounding strap



15 Vent and five pipe bollards



16 Location of valve vault on site