

ATTACHMENT #2



MEMORANDUM

TO: Patty Wahto,
JNU Airport Manager

DATE: May 3, 2016

FROM: Catherine Fritz, AIA
JNU Airport Architect

RE: Architect's Report of April 2016 Activity

A productive meeting was held with Alaskan Region Federal Aviation Administration (FAA) staff on April 7, 2016 to review scope, schedule, and funding plans of several projects. JNU is scheduled to receive important FFY16 Airport Improvements Program (AIP) grants this summer, so I am working with JNU Airport Engineer Ken Nichols, consultant design teams, and City and Borough of Juneau (CBJ) staff to accelerate the completion of bid documents and coordinate schedules to ensure that funding deadlines can be met. Coordination with CBJ Engineering Contracts office has resulted in the development of updated "front end" documents and general conditions to meet FAA requirements and industry standards. FAA grant applications are being prepared, but will not be able to be finalized until actual construction bid amounts are received.

The Snow Removal Equipment Facility (SREF) design team contract for design and construction documents has been finalized, and work has begun in earnest. The construction documents are scheduled to be complete in mid-June. Many of the design assumptions and construction details from the previous building design are being re-used, but significant changes were needed to respond to the new site. The attached drawing illustrates all of the planned components of SREF on the site. The colored areas are eligible for FAA funding through AIP grants.

The focus of current design work is the initial Phase 1-a Equipment Garage. Future components such as the maintenance and operational support spaces have been considered in the site concept, and will be developed to a higher design level in the Fall, once Phase 1-a construction contract is underway.

Phase 1-a, the SREF equipment garage will be approximately 42,000 s.f. in size and will house the equipment and functions noted in the adjacent table. It will be heated and ventilated through the use of a ground source (geothermal) heat pump system. The geothermal loop field is also illustrated in the attached site concept drawing. It will be constructed as part of the RSA II-B (NW Quad Development) project, also scheduled for AIP grant this summer.

Program Name	Programmed Area (sf)
HEATED EQUIPMENT CIRCULATION	20,200
PLOW	1,400
PLOW	1,400
PLOW	1,400
PLOW / BROOM	2,000
BROOM	1,250
BROOM	1,250
BROOM	1,250
DEICING*	600
DEICING*	600
SAND	600
BLOWER	580
BLOWER	580
BLOWER	580
BLOWER	580
FORKLIFT	200
SAND	600
FRICTION TESTER	360
LOADER	500
LOADER	500
LOADER	500
GRADER	625
GRADER	625
UTILITY VEHICLE	360
MAINTENANCE BAY*	2,100
UNISEX TOILET / SHOWER	70
GENERATOR	600
GEOTHERMAL PUMP ROOM	210
MECH/ELECT: FANS, PANELS, FIRE, COMM	2,078
Total (does not include de-icing equipment)	42,398
Non-eligible portion of Maintenance Bay	600
TOTAL AIP ELIGIBLE	41,798
* In future Phase 2 Sand/Chem bldg	
** FAA portion of Maint Bay = 1500sf; JNU = 600sf	

ATTACHMENT #2

The design team submitted 95% complete construction bid documents for the Aircraft Rescue and Fire Fighting (ARFF) Building Modifications project on May 3, 2106. The documents have been sent to the cost estimator and are being reviewed by owner, design team, and the FAA Alaskan Region office. The schedule calls for beginning the bid period in May. Detailed bid and award schedules for all of Junea International Airport's (JNU) construction projects are currently being developed to communicate and coordinate critical deadlines over the next four months.

Renovation of the first floor Women's toilet room is complete, and many positive comments have been received. The Men's toilet room will be renovated later this summer. Other maintenance projects in the terminal that are currently in progress include replacement of stair coverings at the main stairway and Gate 2, and completion of the overhead door replacement in the Baggage Handling Area. New lighting for the main stairway has been designed and will be constructed through an electrical term contract in September.

Silverbow Construction began the roof replacement on April 22, 2016. Most of the work is being accomplished under a tent, which is usually safer and more productive, but was challenging at the project start due to poor weather. The tear-off and hazardous materials abatement are expected to be complete by May 7th, then construction of new components will proceed. Substantial completion is scheduled for June 10, 2016.

CBJ Purchasing Department continues to prepare the Request for Proposals (RFP) for a new contract for the advertising concession. We are hopeful that the solicitation will be advertised soon. The current contract expires at the end of September, and negotiation and execution of a new contract and transition from existing aging equipment will take many weeks to complete. We are anxious to have the RFP process completed as soon as possible to minimize disruption in advertising services and JNU advertising revenue.



First Floor Women's Restroom complete.



Gate 2 Flooring Replacement in progress.



Sections of old roof are cut out and removed.



Active work area is enclosed under tent.

ATTACHMENT #2

- ADMIN
- BUILDING SUPPORT
- Circulation
- COVERED UNHEATED STORAGE
- ENCLOSED HEATED STORAGE
- EQUIPMENT STORAGE
- EXTERIOR STORAGE
- FUEL
- FUTURE HANGER
- MAINTENANCE
- SITE
- YARD STORAGE

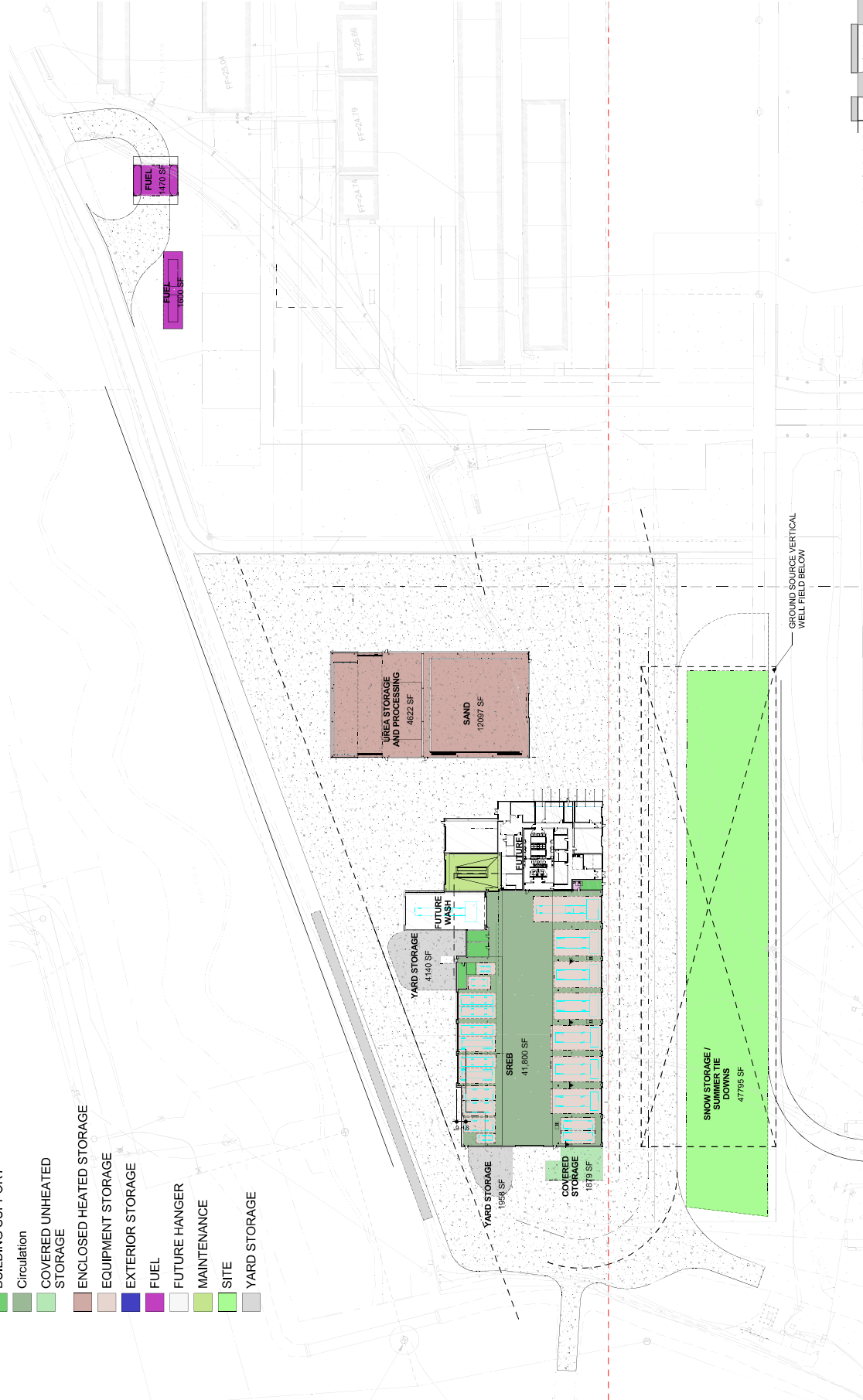

JUNEAU INTERNATIONAL AIRPORT
 SNOW REMOVAL EQUIPMENT FACILITY
 DESIGN DEVELOPMENT
 ISSUE DATE: 04/20/2016
 ©2016 ECI/Hyer, Inc.

SREF SITE PLAN

ECI
 3909 ARCTIC BOULEVARD, SUITE 103
 ANCHORAGE, ALASKA 99503 907.561.5543
 PROJECTNO. 16-0002