

TO: Jeannie Johnson,
JNU Airport Manager

DATE: December 6, 2011

FROM: Catherine Fritz, AIA
JNU Airport Architect

FILE: 1382.16

RE: Terminal Renovation Project Update
Snow Removal Equipment Facility Project Update

Terminal Renovation.

The Main Entry Renovation project is gearing up for construction: submittal reviews, scheduling, and ordering of long lead items is underway. The contractor has confirmed that work on-site will begin in early February. It will begin with demolition of the existing entry wall and exterior deck. A new concrete grade beam and footings will be poured to support the new structural steel. This wall will cant outward and will include a glass curtain wall, similar to the new entry vestibule at Bag Claim. Insulated temporary walls will be constructed to isolate construction work from restaurant and check-in lobby activities.

The RFP for Gift Shop concession was developed during November and will be issued soon. The RFP includes concepts for renovating the existing Gift Shop space. The basic renovation work will be paid from airport project funds; specialty casework and furnishings will be provided by the successful Gift Shop Proposer. A portion of the existing Gift Shop will be closed due to the Main Entry Renovation, so it is timely to update the lighting and interior finishes of the Gift Shop.

Project staff has also been working closely with ESS Glacier Restaurant staff to configure a temporary coffee stand during the Main Entry Renovation work. It will be located in the lobby area on the first floor, between the Check-in and Bag Claim areas. Cup of Joe's will return to its current location once the Main Entry construction is complete.

I presented our geothermal heat pump system at the AAAE Going Green Airports conference in Chicago. The conference had many excellent speakers and ideas for reducing energy consumption and saving operating dollars. We are also gathering energy information for the Alaska Energy Authority, the granting agency that provided funds for our geothermal project. They will be reporting data and information about our project to the Alaska Legislature.

Other projects around the terminal that occurred in November included completion of the new TSA bag screening equipment, tile trim in the Departure Lounge alcove, and installation of blinds in the Alaska Room.



Design concept for renovated Gift Shop

Snow Removal Equipment Facility.

The Site Infrastructure construction documents will begin advertisement in January 2012. This was delayed from the original November bid to allow coordination of work between two other projects on the site, and solidify construction start dates that will work for each contract. The on-site start date for the Site Infrastructure construction will be March 12, 2012. The funding for this work is in place and will be fully spent by the end of summer 2012.

Construction documents for the SREF main building are underway. I will be attending a design meeting on December 7, 2011 to review project components and building systems.

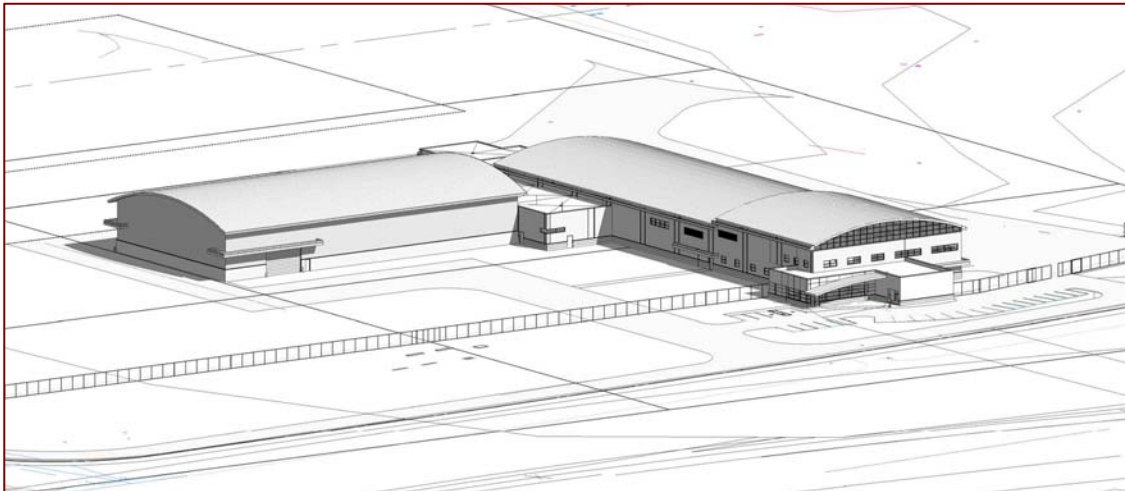

Design concept for SREF including future Sand & Chemical building.