

ATTACHMENT #4

Juneau International Airport Snow Removal Equipment Facilities Project Summary

August 31, 2011

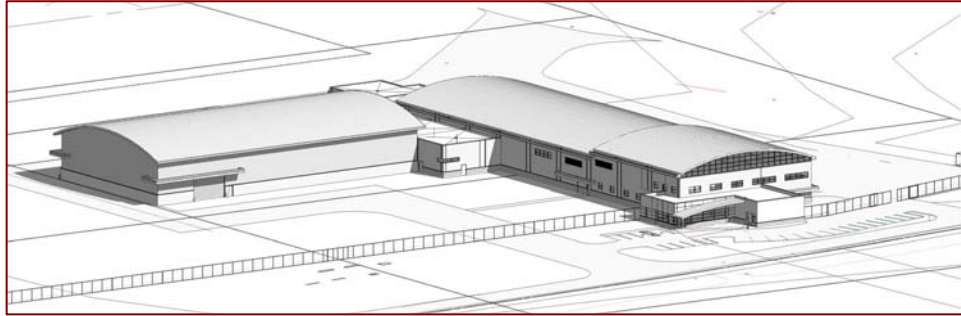

- **Project has 2 major components:**
 - > Equipment Storage & Maintenance Building
 - > Sand & Chemical Building, and associated Support Facilities including Fueling Station & Covered Outdoor Storage
- **Part I: Equipment Storage & Maintenance Building**
 - > Design is fully funded and will be complete in Spring, 2012.
 - > Cost = \$23.7 million. FAA will provide \$19.2 million, required State of Alaska match equals \$.48 million, and required Local match equals \$.48 million. The airport continues to seek funding for \$3.54 million unmet need.
 - > Facility will serve 30 pieces of critical airfield equipment used for snow removal operations, and will increase airfield safety and operational efficiencies.
 - > Design includes energy saving features and utilizes Ground Source Heat Pumps.
 - > Design includes Airfield Lighting Controls & Emergency Generator.
 - > Geothermal Loop Field construction is complete.
 - > Construction of Site Infrastructure components (utilities, access, etc) will be complete in Spring, 2012.
- **Part II: Sand & Chemical Storage Building**
 - > Located adjacent to Equipment Maintenance & Storage Facility
 - > Replaces existing dilapidated structure
 - > Design and construction are not yet scheduled or funded
 - > Fueling Station and support facilities are included in this phase
 - > Cost is estimated at approximately \$10-12 million
- **For additional information, contact Airport Manager, Jeannie Johnson at (907) 789-7821**