

PND 14414

65% REVIEW SUBMITTAL

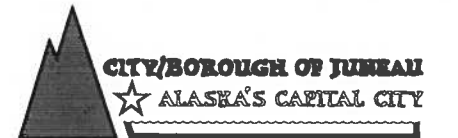

DOCKS & HARBORS DEPARTMENT

REVISIONS

REV.	DATE	DESCRIPTION	DWN.	CKD.	APP.

Peratrovich, Nottingham & Drage, Inc.
Engineering Consultants
 3220 Hospital Drive, Suite 200
 Juneau, Alaska 99801
 TEL: (907) 586-2093 FAX: (907) 586-2099

DESIGN: CRS CHECKED: _____
 DRAWN: TMS APPROVED: _____

SCALE: SCALE IN FEET
 0 60 120

DATE: SEPT., 2000

CITY & BOROUGH OF JUNEAU, ALASKA
DOUGLAS HARBOR UPLANDS
AND MOORAGE EXPANSION

SHEET TITLE:
GENERAL PROJECT LAYOUT

PNAD PROJECT NO. 99220.11 DWG. FILE 1-07.DWG

1.07
 SHEET
 7 OF XX



PND 14419

65% REVIEW SUBMITTAL



REVISIONS					
REV.	DATE	DESCRIPTION	DWN.	CKD.	APP.

Peratrovich, Nottingham & Drage, Inc.
 Engineering Consultants
 3220 Hospital Drive, Suite 200
 Juneau, Alaska 99801
 TEL: (907) 586-2093 FAX: (907) 586-2099

DESIGN: CRS CHECKED: _____
 DRAWN: TMS APPROVED: _____
 SCALE: SCALE IN FEET
 0 30 60

DATE: SEPT., 2000

CITY & BOROUGH OF JUNEAU, ALASKA
DOUGLAS HARBOR UPLANDS
AND MOORAGE EXPANSION

SHEET TITLE:
DREDGING & CONFINED DISPOSAL
GRADING & DRAINAGE PLAN

PND PROJECT NO. 99220.11 DWG. FILE. 2-05.DWG

2.05
 SHEET 7 OF XX

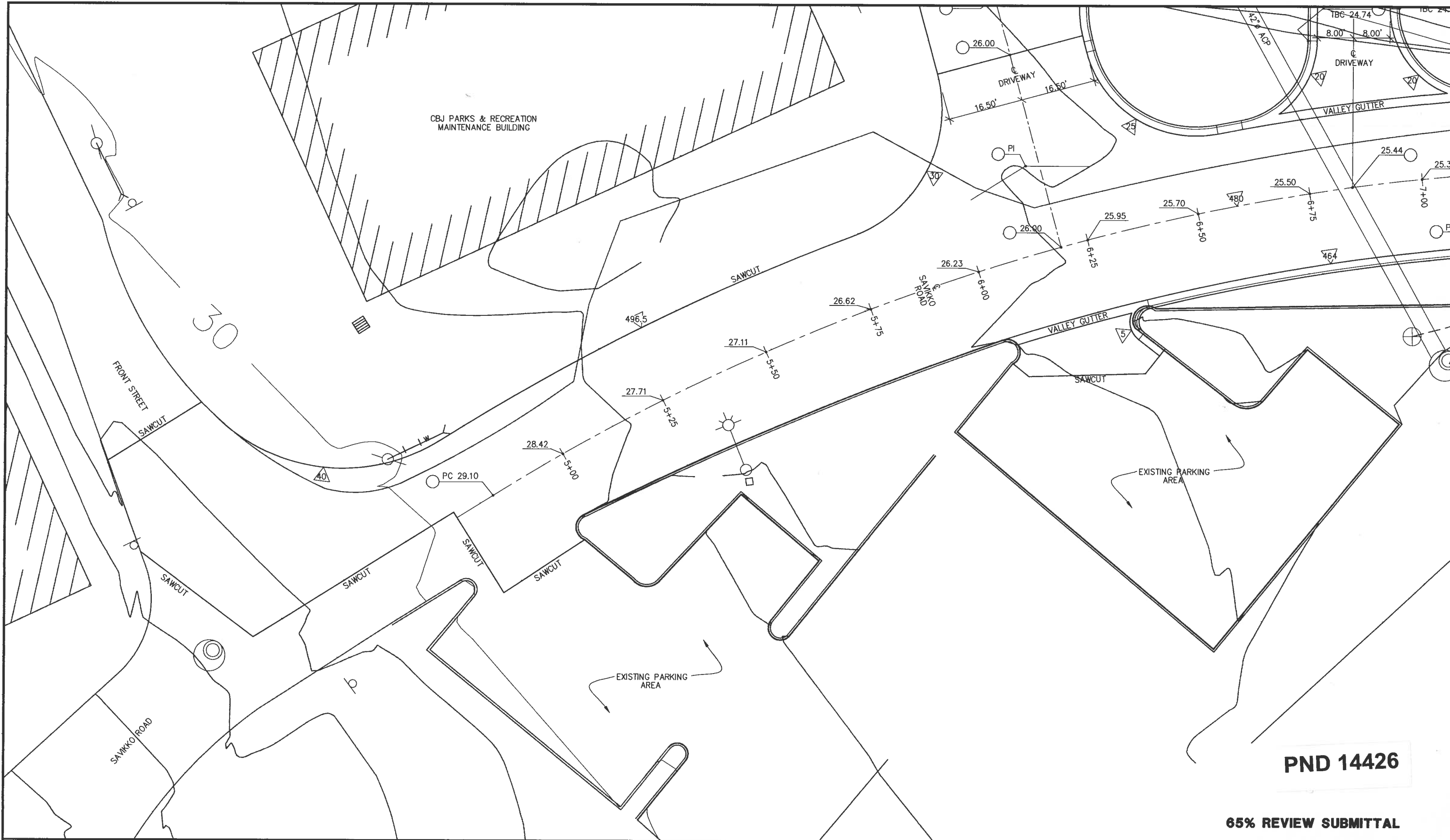

PND 14426

65% REVIEW SUBMITTAL



REVISIONS					
REV.	DATE	DESCRIPTION	DWN.	CKD.	APP.

Peratrovich, Nottingham & Drage, Inc.
Engineering Consultants
3220 Hospital Drive, Suite 200
Juneau, Alaska 99801
TEL: (907) 586-2093 FAX: (907) 586-2099

DESIGN: JWG CHECKED: _____
DRAWN: JWG APPROVED: _____

SCALE: SCALE IN FEET
0 10 20

DATE: SEPT., 2000

CITY & BOROUGH OF JUNEAU, ALASKA
DOUGLAS HARBOR UPLANDS
AND MOORAGE EXPANSION

SHEET TITLE:
SAVIKKO ROAD AND PARKING AREA
SITE GRADING AND DRAINAGE
STA. 4+00 TO STA. 7+00

3.01
SHEET 7 OF XX

PNAD PROJECT NO. 99220.11 DWG. FILE 3-01.DWG

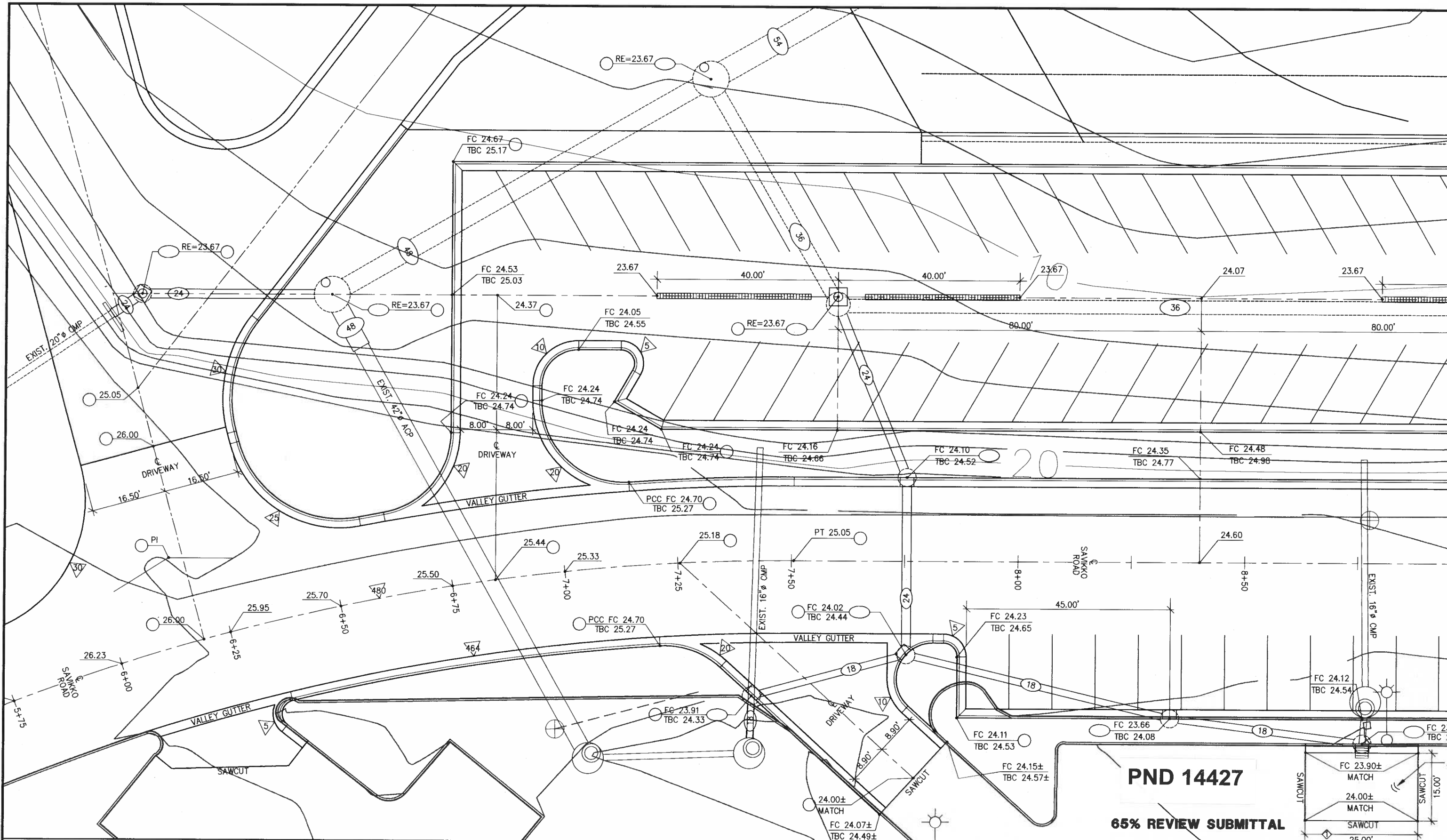

PND 14427

65% REVIEW SUBMITTAL

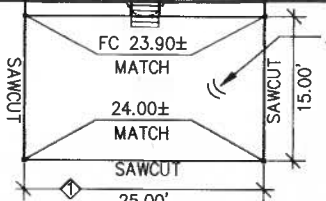

REV.	DATE	DESCRIPTION	DWN.	CKD.	APP.

Peratrovich, Nottingham & Drage, Inc.
 Engineering Consultants
 3220 Hospital Drive, Suite 200
 Juneau, Alaska 99801
 TEL: (907) 586-2093 FAX: (907) 586-2099

DESIGN: JWG CHECKED: _____
 DRAWN: JWG APPROVED: _____

SCALE: SCALE IN FEET
 0 10 20

DATE: SEPT., 2000

**CITY & BOROUGH OF JUNEAU, ALASKA
 DOUGLAS HARBOR UPLANDS
 AND MOORAGE EXPANSION**

SHEET TITLE:
**SAVIKKO ROAD AND PARKING AREA
 SITE GRADING AND DRAINAGE PLAN
 STA. 5 +75 TO STA. 8+75**

3.02
 SHEET
 7 OF XX

PND PROJECT NO. 99220.11 DWG. FILE 3-02.DWG

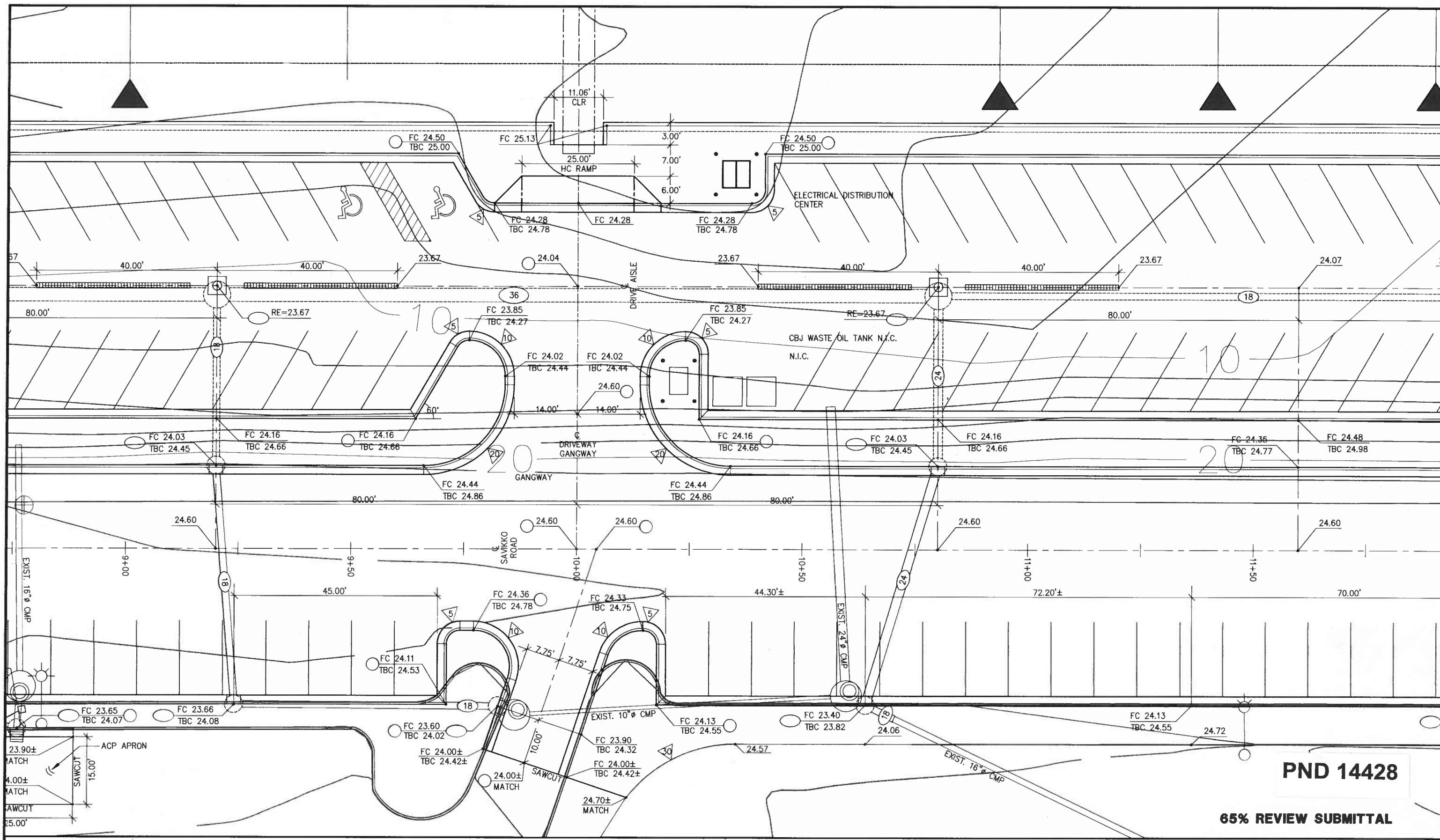

PND14428

65% REVIEW SUBMITTAL



REVISIONS					
REV.	DATE	DESCRIPTION	DWN.	CKD.	APP.

Peratovich, Nottingham & Drage, Inc.
 Engineering Consultants
 3220 Hospital Drive, Suite 200
 Juneau, Alaska 99801
 TEL: (907) 586-2093 FAX: (907) 586-2099

DESIGN: JWG CHECKED: _____
 DRAWN: JWG APPROVED: _____
 SCALE: SCALE IN FEET
 0 10 20

DATE: SEPT., 2000

CITY & BOROUGH OF JUNEAU, ALASKA
DOUGLAS HARBOR UPLANDS
AND MOORAGE EXPANSION

SHEET TITLE:
SAVIKKO ROAD AND PARKING AREA
SITE GRADING AND DRAINAGE PLAN
STA. 8+75 TO STA. 11+75

PND PROJECT NO. 99220.11 DWG. FILE: 3-03.DWG

3.03
 SHEET 7 OF XX

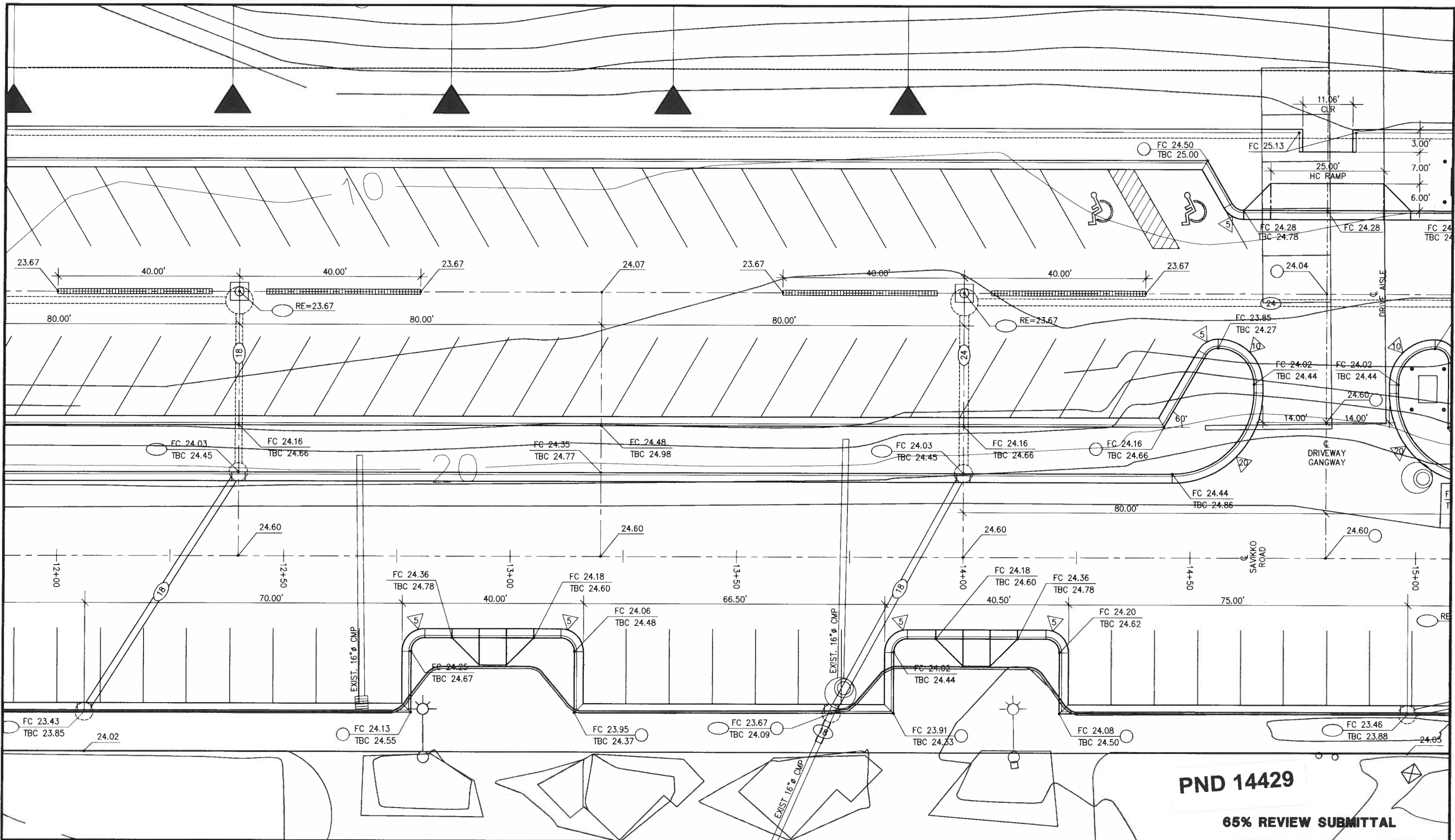

PND 14429
65% REVIEW SUBMITTAL

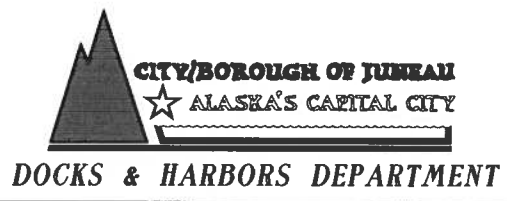

REVISIONS					
REV.	DATE	DESCRIPTION	DWN.	CKD.	APP.

Peratrovich, Nottingham & Drage, Inc.
Engineering Consultants
 3220 Hospital Drive, Suite 200
 Juneau, Alaska 99801
 TEL: (907) 586-2093 FAX: (907) 586-2099

DESIGN: JWG CHECKED: _____
 DRAWN: JWG APPROVED: _____
 SCALE: SCALE IN FEET
 0 10 20

DATE: SEPT., 2000

CITY & BOROUGH OF JUNEAU, ALASKA
DOUGLAS HARBOR UPLANDS
AND MOORAGE EXPANSION

SHEET TITLE:
SAVIKKO ROAD AND PARKING AREA
SITE GRADING AND DRAINAGE PLAN
STA. 11+75 TO 15+00
 PND PROJECT NO. 99220.11 DWG. FILE. 3-04.DWG

3.04
 SHEET
 7 OF XX

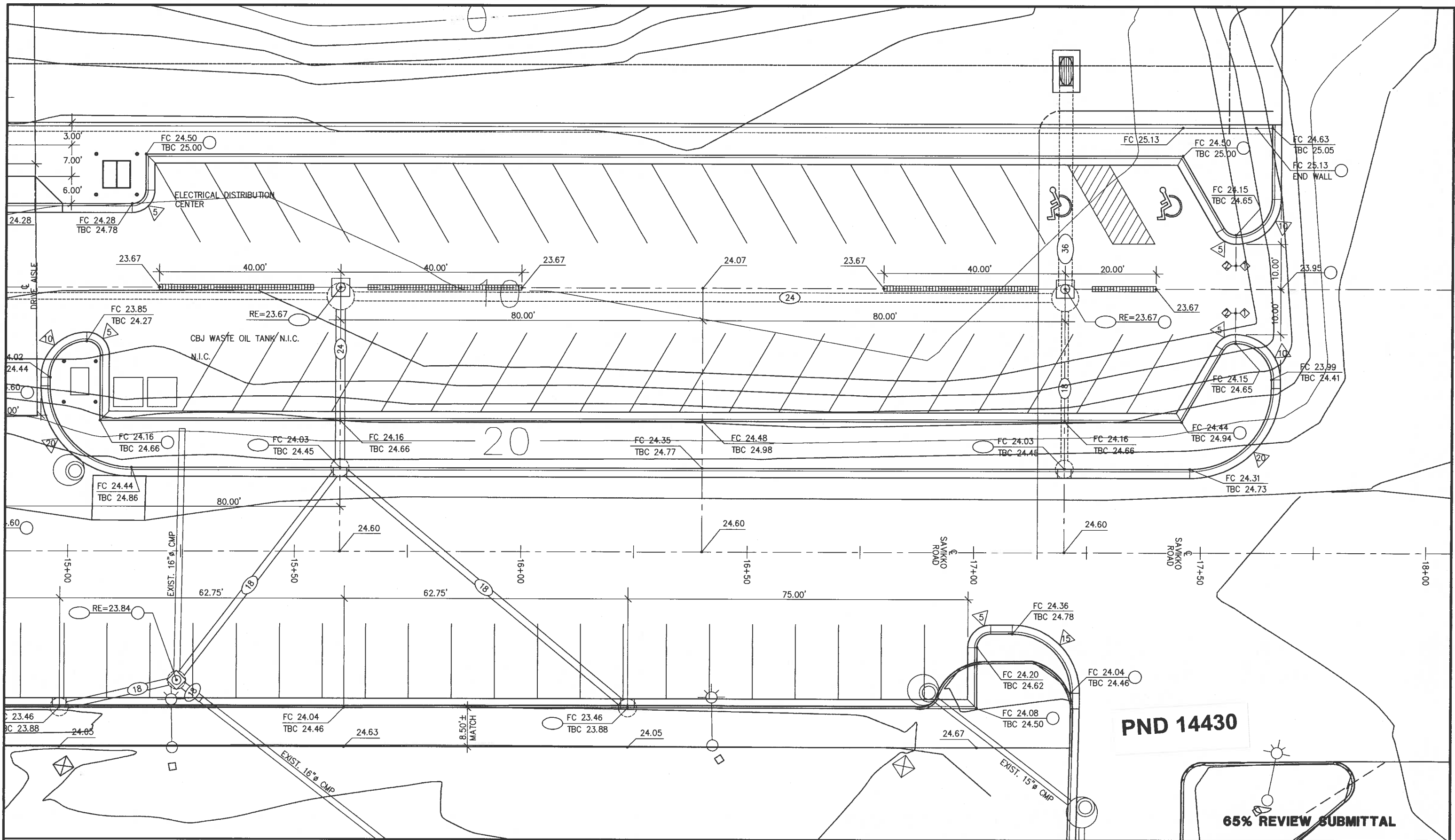

PND 14430

65% REVIEW SUBMITTAL

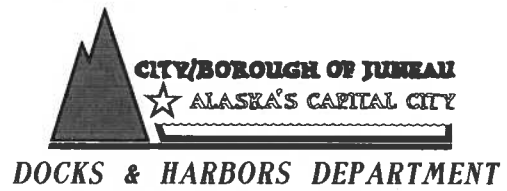

REVISIONS					
REV.	DATE	DESCRIPTION	DWN.	CKD.	APP.

Peratrovich, Nottingham & Drage, Inc.
 Engineering Consultants
 3220 Hospital Drive, Suite 200
 Juneau, Alaska 99801
 TEL: (907) 586-2093 FAX: (907) 586-2099

DESIGN: JWG CHECKED: _____
 DRAWN: JWG APPROVED: _____
 SCALE: SCALE IN FEET
 0 10 20

DATE: SEPT., 2000

CITY & BOROUGH OF JUNEAU, ALASKA
DOUGLAS HARBOR UPLANDS
AND MOORAGE EXPANSION

SHEET TITLE:
SAVIKKO ROAD AND PARKING AREA
SITE GRADING AND DRAINAGE PLAN
STA. 15+00 TO 18+00

3.05
 SHEET 7 OF XX

PND PROJECT NO. 99220.11 DWG. FILE. 3-05.DWG

20

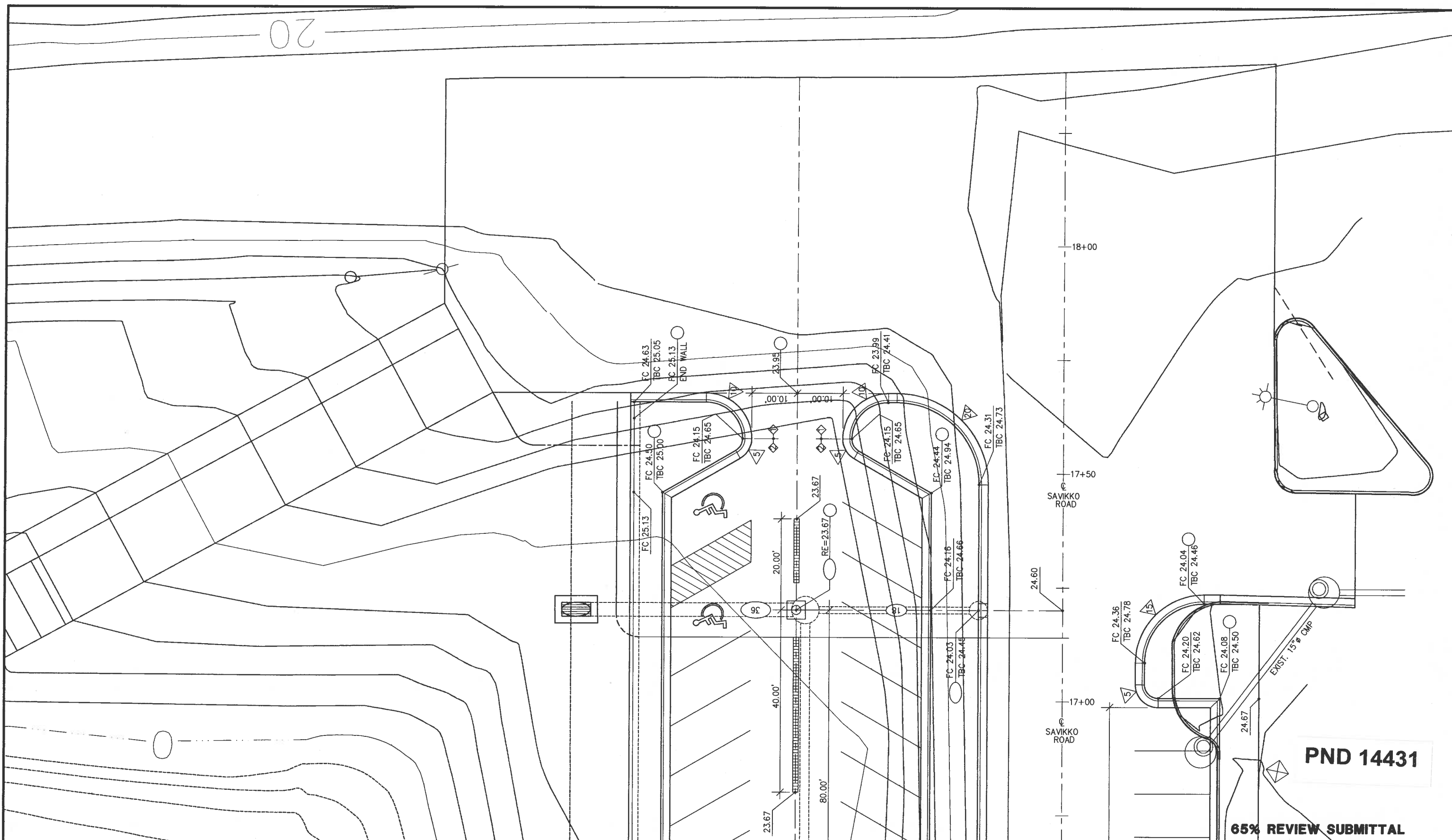

PND 14431

65% REVIEW SUBMITTAL



DOCKS & HARBORS DEPARTMENT

REVISIONS					
REV.	DATE	DESCRIPTION	DWN.	CKD.	APP.

Peratrovich, Nottingham & Drage, Inc.
Engineering Consultants
 3220 Hospital Drive, Suite 200
 Juneau, Alaska 99801
 TEL: (907) 586-2093 FAX: (907) 586-2099

DESIGN: JWG CHECKED: _____
 DRAWN: JWG APPROVED: _____
 SCALE: SCALE IN FEET
 0 10 20

DATE: SEPT., 2000

CITY & BOROUGH OF JUNEAU, ALASKA
DOUGLAS HARBOR UPLANDS
AND MOORAGE EXPANSION

SHEET TITLE:
SAVIKKO ROAD AND PARKING AREA
SITE GRADING AND DRAINAGE PLAN
STA. 16+75 TO 19+00

3.06
 SHEET
 7 OF XX

PND PROJECT NO. 99220.11 DWG. FILE: 3-05.DWG