

CITY & BOROUGH OF JUNEAU, ALASKA

TAKU SEAWALK RELEVELING PROJECT

CBJ CONTRACT NO. DH22-007

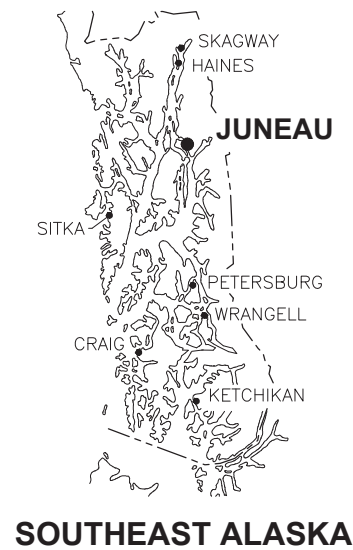
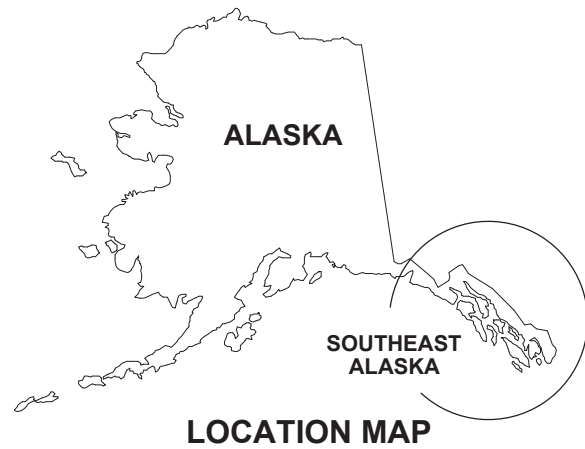

THIS PROJECT

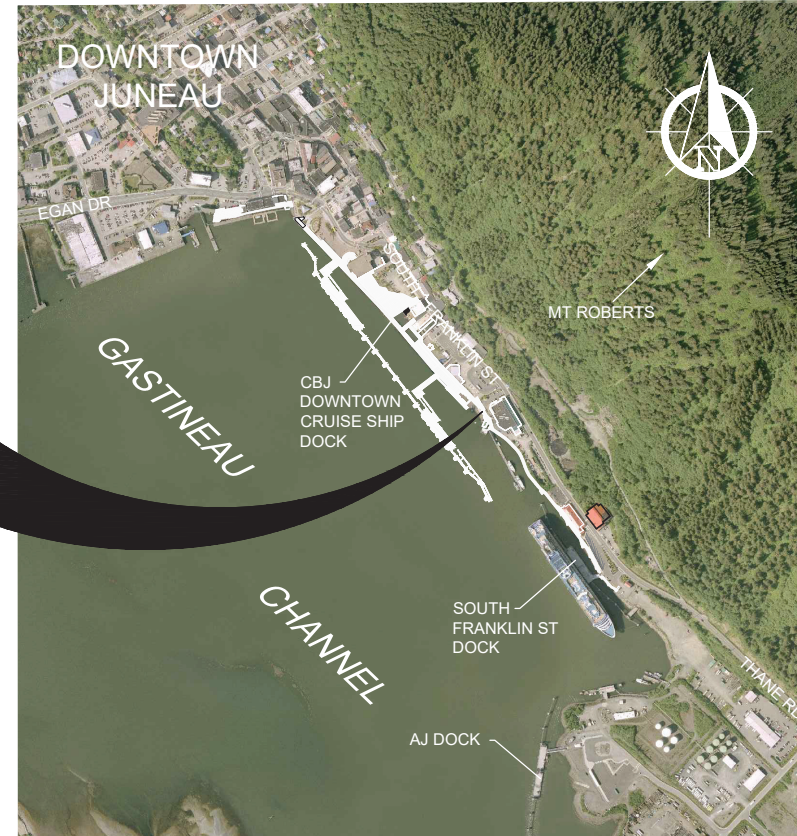

VICINITY MAP

AERIAL PHOTO FROM AEROMAP

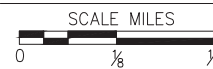

DRAWING INDEX	
DWG. NO.	TITLE
GENERAL	
G101	TITLE SHEET, VICINITY MAP AND DRAWING INDEX
G102	LEGEND, ABBREVIATIONS AND GENERAL NOTES
G103	EXISTING OVERALL SITE PLAN
STRUCTURAL	
S101	EXISTING CONDITIONS AND DEMOLITION PLAN
S102	EXISTING CONDITIONS DETAILS
S103	EXISTING CONDITIONS DETAILS
S201	SEAWALK RELEVELING PLAN
S202	SEAWALK RELEVELING ENLARGEMENT PLANS
S203	SEAWALK RELEVELING DETAILS
S204	SEAWALK RELEVELING DETAILS

TIDAL DATA	ELEV. (FT)
HIGHEST OBSERVED WATER LEVEL	+24.58
MEAN HIGHER HIGH WATER (MHHW)	+16.30
MEAN HIGH WATER (MHW)	+15.34
MEAN SEA LEVEL (MSL)	+8.56
MEAN TIDE LEVEL (MTL)	+8.47
MEAN LOWER WATER (MLW)	+1.60
MEAN LOWER LOW WATER (MLLW)	0.0
LOWEST OBSERVED WATER LEVEL	-6.12

FROM:
NOAA NOS/CO-OPS STATION ID: 9452210 JUNEAU, ALASKA

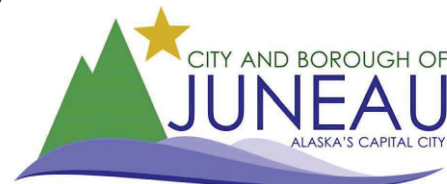

REVISIONS					
REV.	DATE	DESCRIPTION	DWN.	CKD.	APP.



9360 Glacier Highway Ste 100
Juneau, Alaska 99801
Phone: 907-586-2093
Fax: 907-586-2099
www.pndengineers.com

DESIGN: — CHECKED: JLD
DRAWN: WRB APPROVED: JLD

SCALE: AS SHOWN

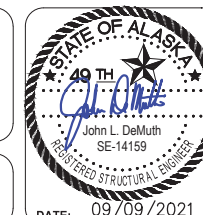

CITY & BOROUGH OF JUNEAU, ALASKA
TAKU SEAWALK RELEVELING PROJECT
CBJ CONTRACT NO. DH22-007

SHEET TITLE:
TITLE SHEET, VICINITY MAP AND DRAWING INDEX

G101

PND PROJECT NO.: 202096 C.A.N.: AECC250

ABBREVIATIONS

A		H		R	
@	AT	H&T	HUB & TACK	RAD	RADIUS
AC	ASBESTOS CEMENT PIPE	HD	HEAVY DUTY	RE	RIM ELEVATION
ACP	ASPHALT CONCRETE PAVEMENT	HDG	HOT-DIPPED GALVANIZED	REF	REFERENCE
ADD	ADDITIVE	HDPE	HIGH DENSITY POLYETHYLENE	REINF	REINFORCEMENT
ADJ	ADJUSTABLE	HORIZ	HORIZONTAL	REQD	REQUIRED
	ALASKA DEPARTMENT OF TRANSPORTATION AND PUBLIC FACILITIES	HSE	HOUSE	RET	RETAINING
AKDOT&PF		HT	HEIGHT	RO	ROUGH OPENING
		HWY.	HIGHWAY	ROW	RIGHT OF WAY
		I		S	
ALT	ALTERNATE	IAW	IN ACCORDANCE WITH	S	SOUTH
APPROX.	APPROXIMATE	ID	INSIDE DIAMETER	SCHED	SCHEDULE
ATS	ALASKA TIDELANDS SURVEY	IE	INVERT ELEVATION	SD	STORM DRAIN
AWS	AMERICAN WELDING SOCIETY	IN	INCH	SDI	STORM DRAIN INLET STRUCTURE
B		IP	IRON PIPE	SDO	STORM DRAIN OUTLET STRUCTURE
BLDG	BUILDING	INV	INVERT	SDR	STANDARD DIMENSION RATIO
BTM, BOT	BOTTOM	J		SF	SQUARE FOOT
C		JB	JUNCTION BOX	SHLDR	SHOULDER
C&G	CURB & GUTTER	L		SI	STREET INTERSECTION
CB	CATCH BASIN	LBS	POUNDS	SPEC	SPECIFICATION (S)
CBJ	CITY AND BOROUGH OF JUNEAU	LF	LINEAR FEET	SQ	SQUARE
CIP	CAST-IN-PLACE	LL	LIVE LOAD	SRB	SHOT ROCK BORROW
CJ	CONTROL JOINT	LOC	LOCATION	SSC	SANITARY SEWER CONNECTION
CL	CENTER LINE	LS	LUMP SUM	SS	STAINLESS STEEL, SANITARY SEWER
CLR	CLEAR	M		SDMH	STORM DRAIN MANHOLE
CLR	CLEAR	MAX	MAXIMUM	SSMH	SANITARY SEWER MANHOLE
CMP	CORRUGATED METAL PIPE	ME	MATCH EXISTING	STA	STATION
CONC.	CONCRETE	MFR	MECHANICAL MANUFACTURE (R)	STD	STANDARD
CP	COMPLETE PENETRATION	MH	MANHOLE	STL	STEEL
CPP	CORRUGATED POLYETHYLENE PIPE	MJ	MECHANICAL JOINT	STRG	STRONG
COR	CORNER	MIN	MINIMUM	SW	SIDEWALK
CSC	COUNTERSINK	MLLW	MEAN LOWER LOW WATER	SWR	SEWER
CY	CUBIC YARD	MSE	MECHANICALLY STABILIZED EARTH	SY	SQUARE YARD
D		MTL	MATERIAL (S)	SYM	SYMMETRICAL
D/DIA	DIAMETER	N		t.	THICK
DBL	DOUBLE	N	NORTH	T&B	TOP AND BOTTOM
DIP	DUCTILE IRON PIPE	NFS	NON FROST SUSCEPTIBLE	T&G	TONGUE AND GROOVE
DIM	DIMENSION	NO	NUMBER	TBC	TOP BACK OF CURB
DN	DOWN	NTS	NOT TO SCALE	TBD	TO BE DETERMINED
DTL	DETAIL	O		TD	TRENCH DRAIN
E		OC	ON CENTER	TEL	TELEPHONE
E	EAST	OD	OUTSIDE DIAMETER	TEMP	TEMPERATURE, TEMPORARY
E.A.	EACH	OHE	OVERHEAD ELECTRICAL	TYP	TYPICAL
EG	EXISTING GROUND	OWS	OIL-WATER SEPARATOR	U	
EJ	EXPANSION JOINT	P		UON	UNLESS OTHERWISE NOTED
EL/ELEV	ELEVATION	P	PIPE	UPC	UNIFORM PLUMBING CODE
EQ	EQUAL	PC	POINT OF CURVATURE, PIECE	USCG	UNITED STATES COAST GUARD
EQUIP	EQUIPMENT	PCC	PRECAST CONCRETE	V	
EXIST	EXISTING	PED	PEDESTAL	VB	VALVE BOX
F		PI	POINT OF INTERSECTION	VERT	VERTICAL
FC	FACE OF CURB	PL	PROPERTY LINE, PLATE	W	
FD	FLOOR DRAIN	PRV	PRESSURE REDUCING VALVE	W	WEST
FG	FINISH GRADE	PSI	POUND PER SQUARE INCH	w/	WITH
FH	FIRE HYDRANT, FLAT HEAD	PT	POINT, PRESSURE TREATED,	WD	WOOD
FIN	FINISH (ED)		POINT OF TANGENCY	WL	WATERLINE
FM	FORCE MAIN SEWER	PVC	POINT OF VERTICAL CURVATURE,	WV	WATER VALVE
FT	FOOT		POLY VINYL CHLORIDE	W/O	WITHOUT
FTG	FOOTING	Q		<PT	ANGLE POINT
FL	FLOWLINE	QTY	QUANTITY		
G					
GAL	GALLON				
GALV	GALVANIZED				
GB	GRADE BREAK				
GV	GATE VALVE				

LEGEND

EXISTING	THIS PROJECT	
		TELEPHONE PEDESTAL
		TELEVISION PEDESTAL
		ELECTRICAL PEDESTAL
		FENCE
		FUEL LINE (ABANDONED)
		FUEL LINE
		ELECTRICAL (ABANDONED)
		ELECTRICAL (UNDERGROUND)
		ELECTRICAL (OVERHEAD)
		WATER
		SANITARY SEWER
		RIGHT-OF-WAY
		COMMUNICATION (CABLE/TEL)
		STORM DRAIN
		FORCE MAIN
		FOUNDATION DRAIN PIPE
		PROPERTY LINE
		GUY WIRE ANCHOR
		GUARDRAIL
		BOLLARD
		CURB & GUTTER
		ELECTRICAL TRANSFORMER
		ELECTRICAL VAULT
		ELECTRICAL HANDHOLE
		FIRE HYDRANT
		LAYOUT POINT
		LIGHT POLE
		SANITARY SEWER MANHOLE
		STORM DRAIN MANHOLE
		STORM DRAIN INLET
		SIGN
		WATER VALVE
		UTILITY POLE
		SECTION OR DETAIL CALLOUT
		LOCATION OF DETAIL OR REFERENCE DRAWING

GENERAL NOTES

- PROPERTY DISTURBED DURING CONSTRUCTION SHALL BE RESTORED TO ITS PRE-CONSTRUCTION CONDITION OR BETTER AT NO ADDITIONAL COST.
- CBJ ENGINEERING STANDARD DETAILS BOOK DATED AUGUST, 2011 IS MADE A PART OF THIS CONTRACT, WITH CURRENT REVISIONS AS APPLICABLE. STANDARD DETAILS SHALL ONLY BE UTILIZED AS SPECIFICALLY REFERENCED IN THE DRAWINGS WITH MODIFICATIONS SPECIFIED.
- THE CONTRACTOR SHALL BE RESPONSIBLE FOR ADHERING TO ALL APPLICABLE, LOCAL, STATE AND FEDERAL CODES, PERMITS AND SAFETY REQUIREMENTS.
- THE LOCATIONS OF EXISTING FEATURES AND UTILITIES SHOWN ON THE DRAWINGS ARE APPROXIMATE. ADDITIONAL UTILITIES NOT SHOWN IN THESE DRAWINGS MAY BE PRESENT. THE CONTRACTOR SHALL VERIFY ALL UTILITY LOCATIONS IN THE FIELD AS NECESSARY, PRIOR TO BEGINNING WORK. THE HORIZONTAL AND VERTICAL LOCATIONS OF ALL UTILITIES ENCOUNTERED IN THE FIELD SHALL BE RECORDED ON THE CONTRACTOR'S RECORD DRAWINGS. CONTACT LOCAL UTILITY COMPANIES PRIOR TO ANY/ ALL EXCAVATIONS AT THE FOLLOWING TELEPHONE NUMBERS:

DIAL BEFORE YOU DIG!
586-1333
 UNDERGROUND POWER, TELEPHONE, T.V.,
 COMMUNICATIONS, WATER AND WASTEWATER LINES
 ARE IN THE AREA. UTILITIES SHOWN HERE DO NOT
 SUBSTITUTE FOR FIELD LOCATES.

- GRADING IS SUBJECT TO MINOR REVISIONS BY THE ENGINEER TO FIT SITE CONDITIONS, AT NO ADDITIONAL COST.
- CONTRACTOR SHALL COORDINATE WITH ALL AFFECTED BOROUGH DEPARTMENTS AND LOCAL UTILITY COMPANIES DURING CONSTRUCTION.
- THE CONTRACTOR SHALL NOT DISRUPT UTILITY SERVICES EXCEPT AS REQUIRED TO COMPLETE THE RECONFIGURATION OF THOSE SERVICES AS SHOWN IN THE PLANS. COORDINATE ANY DISRUPTIONS WITH OWNER A MINIMUM OF 48 HOURS IN ADVANCE.

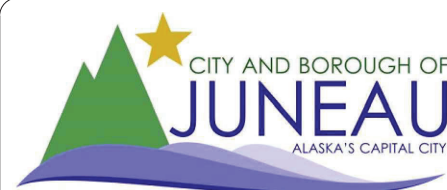

REVISIONS					
REV.	DATE	DESCRIPTION	DWN.	CKD.	APP.

P | N | D
 ENGINEERS, INC.

9360 Glacier Highway Ste 100
 Juneau, Alaska 99801
 Phone: 907-586-2093
 Fax: 907-586-2099
 www.pndengineers.com

DESIGN: — CHECKED: JLD
 DRAWN: WRB APPROVED: JLD

SCALE: AS SHOWN

DATE: 09/09/2021

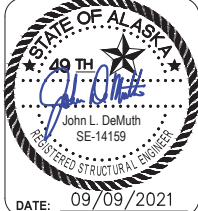

CITY & BOROUGH OF JUNEAU, ALASKA
TAKU SEAWALK RELEVELING PROJECT
 CBJ CONTRACT NO. DH22-007

SHEET TITLE:
LEGEND, ABBREVIATIONS AND GENERAL NOTES

PND PROJECT NO.: 202096 C.A.N.: AECC250

G102

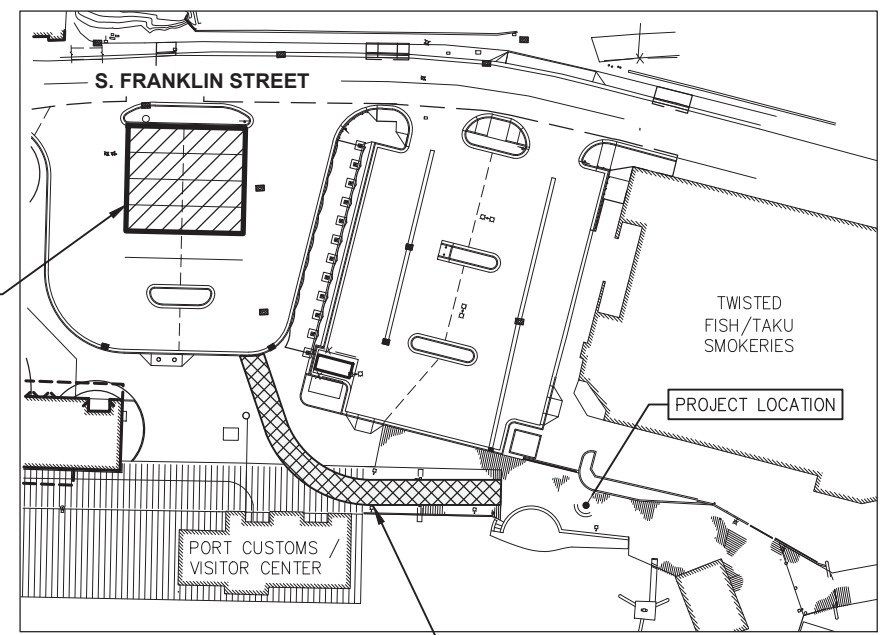
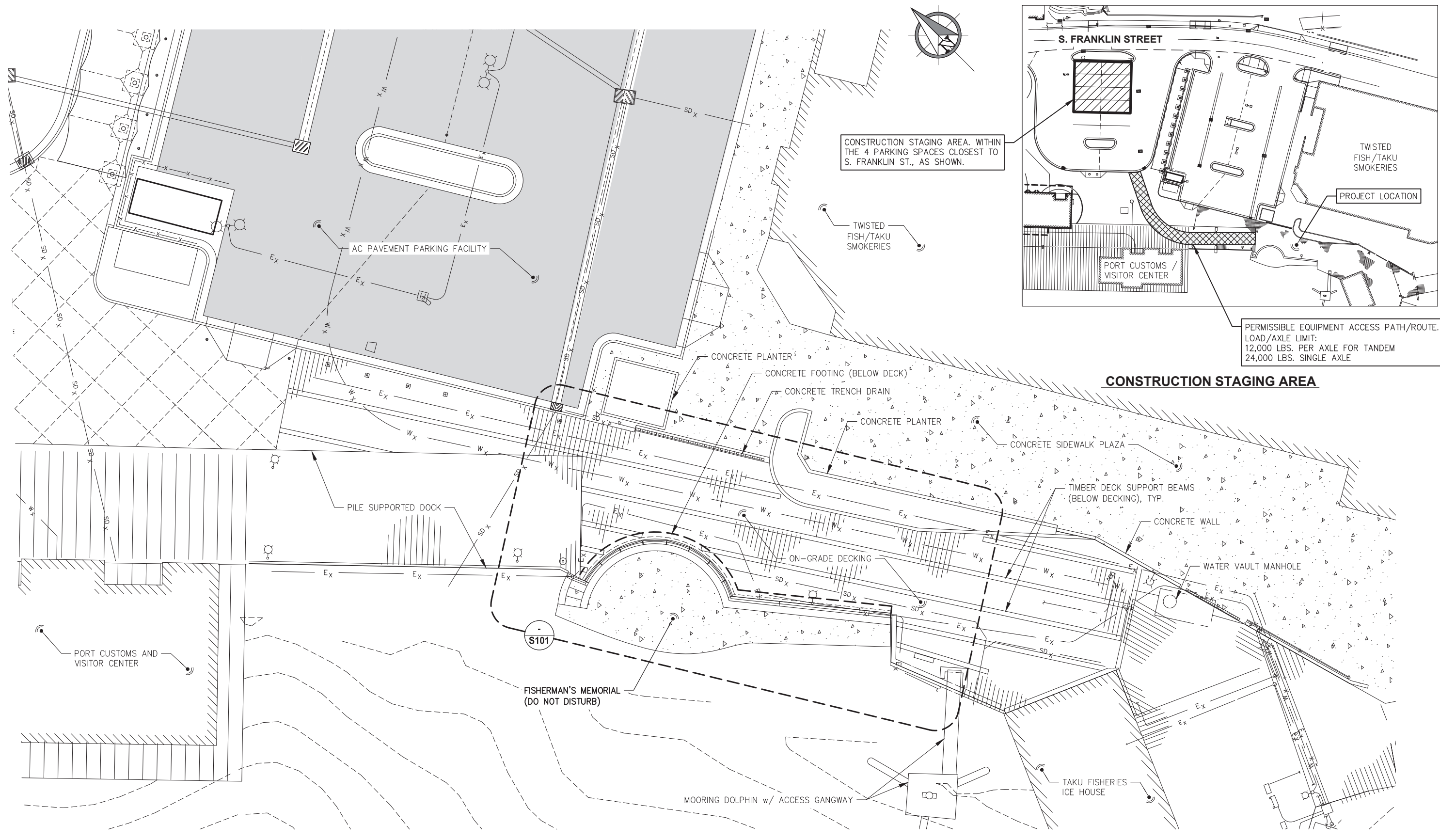

PERMISSIBLE EQUIPMENT ACCESS PATH/ROUTE.
LOAD/AXLE LIMIT:
12,000 LBS. PER AXLE FOR TANDEM
24,000 LBS. SINGLE AXLE

CONSTRUCTION STAGING AREA

REVISIONS					
REV.	DATE	DESCRIPTION	DWN.	CKD.	APP.

PND
ENGINEERS, INC.

9360 Glacier Highway Ste 100
Juneau, Alaska 99801
Phone: 907-586-2093
Fax: 907-586-2099
www.pndengineers.com

DESIGN: JLD CHECKED: JLD
DRAWN: WRB APPROVED: JLD

SCALE: SCALE IN FEET
0 10 20 FT.



CITY & BOROUGH OF JUNEAU, ALASKA
TAKU SEAWALK RELEVELING PROJECT
CBJ CONTRACT NO. DH22-007

SHEET TITLE:
EXISTING OVERALL SITE PLAN

PND PROJECT NO.: 202096 C.A.N.: AECC250

G103



DEMOLITION NOTES	
DESIGNATION	DESCRIPTION
①	REMOVE AND SALVAGE TIMBER DECKING. (NOT SHOWN FOR CLARITY)
②	REMOVE AND SALVAGE TIMBER DECK SUPPORT BEAMS. (HATCHED)
③	DEMOLISH AND DISPOSE TIMBER EDGING PLANKS, TYP.
④	DEMOLISH AND DISPOSE CONCRETE DECK SUPPORT FOOTING.
⑤	REMOVE AND SALVAGE DECK MOUNTED LIGHT POLE.
⑥	DEMOLISH AND DISPOSE TIMBER LEDGER, TYP.

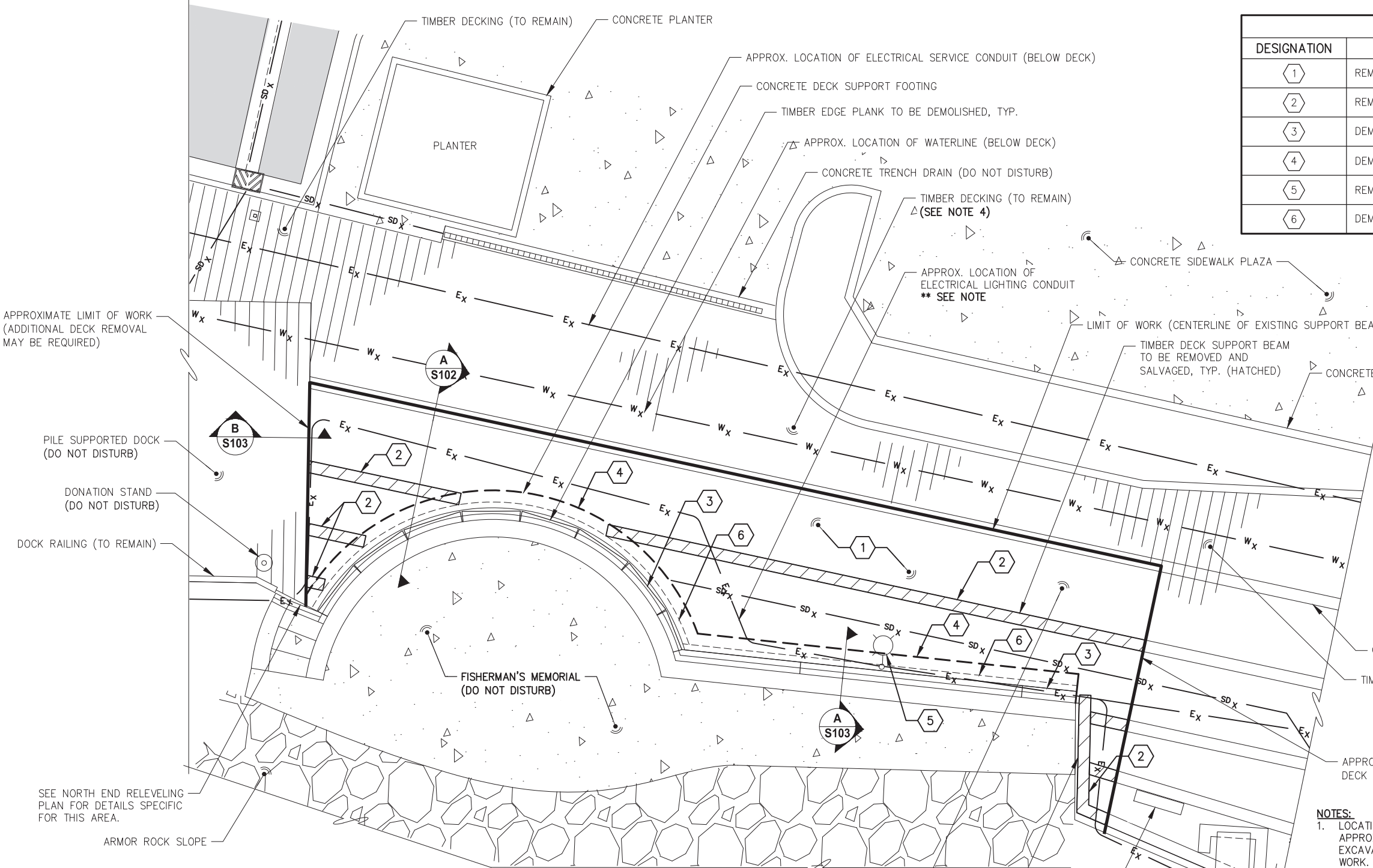

DEMOLITION SUMMARY:

- WITHIN THE APPROXIMATE WORK LIMITS THE CONTRACTOR SHALL:
- REMOVE AND SALVAGE TIMBER DECKING AS REQUIRED
 - REMOVE AND SALVAGE TIMBER DECK SUPPORT BEAMS PER DECK SUPPORT BEAM SPLICE DETAIL AND RELEVELING PLANS
 - REMOVE AND DEMOLISH TIMBER EDGE PLANKS IN THEIR ENTIRETY
 - REMOVE AND DEMOLISH CONCRETE FOOTING ADJACENT TO MEMORIAL IN ITS ENTIRETY
 - REMOVE AND SALVAGE LIGHT POLE

NOTES:

1. LOCATION SHOWN OF EXISTING BURIED UTILITIES BELOW EXISTING DECKING IS APPROXIMATE. CONTRACTOR SHALL USE CAUTION DURING DEMOLITION AND EXCAVATION. FIELD VERIFY LOCATIONS OF ALL UTILITIES PRIOR TO COMMENCING WORK. ANY UTILITIES DAMAGED DURING WORK SHALL BE REPAIRED TO CBJ STANDARDS.
2. DECKING SHOWN REMOVED WITHIN APPROXIMATE WORK LIMITS.
3. CONTRACTOR SHALL USE EXTRA CARE WHEN REMOVING EXISTING TIMBER DECKING AND GRADE BEAMS WITH THE EXPRESS INTENT BEING TO SALVAGE AND REUSE AS MUCH EXISTING MATERIAL AS POSSIBLE. IT IS ASSUMED THAT A SMALL PERCENTAGE OF EXISTING TIMBER DECKING AND GRADE BEAMS MAY NEED TO BE REPLACED WITH NEW DUE TO EXISTING DAMAGE OR UNAVOIDABLE DAMAGE THAT OCCURS DURING REMOVAL. THIS MATERIAL WILL BE ACCOUNTED FOR IN A SEPARATE BID ITEM.
4. CONTRACTOR SHALL ENSURE PORTION OF EXISTING DECK THAT IS TO REMAIN WILL PROVIDE PUBLIC ACCESS DURING CONSTRUCTION. PROVIDE TEMPORARY SAFETY BARRIER AS REQUIRED.

THE LOCATIONS OF EXISTING FEATURES AND UTILITIES SHOWN ON THE DRAWINGS ARE APPROXIMATE. ADDITIONAL UTILITIES NOT SHOWN IN THESE DRAWINGS MAY BE PRESENT. THE CONTRACTOR SHALL VERIFY ALL UTILITY LOCATIONS IN THE FIELD AS NECESSARY, PRIOR TO BEGINNING WORK. SEE GENERAL NOTES, SHEET G102.

REVISIONS					
REV.	DATE	DESCRIPTION	DWN.	CKD.	APP.

PND ENGINEERS, INC.

9360 Glacier Highway Ste 100
Juneau, Alaska 99801
Phone: 907-586-2093
Fax: 907-586-2099
www.pndengineers.com

DESIGN: JLD CHECKED: JLD
DRAWN: WRB APPROVED: JLD

SCALE: SCALE IN FEET
0 5 10 FT.



CITY & BOROUGH OF JUNEAU, ALASKA
TAKU SEAWALK RELEVELING PROJECT
CBJ CONTRACT NO. DH22-007

SHEET TITLE:
EXISTING CONDITIONS AND DEMOLITION PLAN

PND PROJECT NO.: 202096 C.A.N.: AECC250



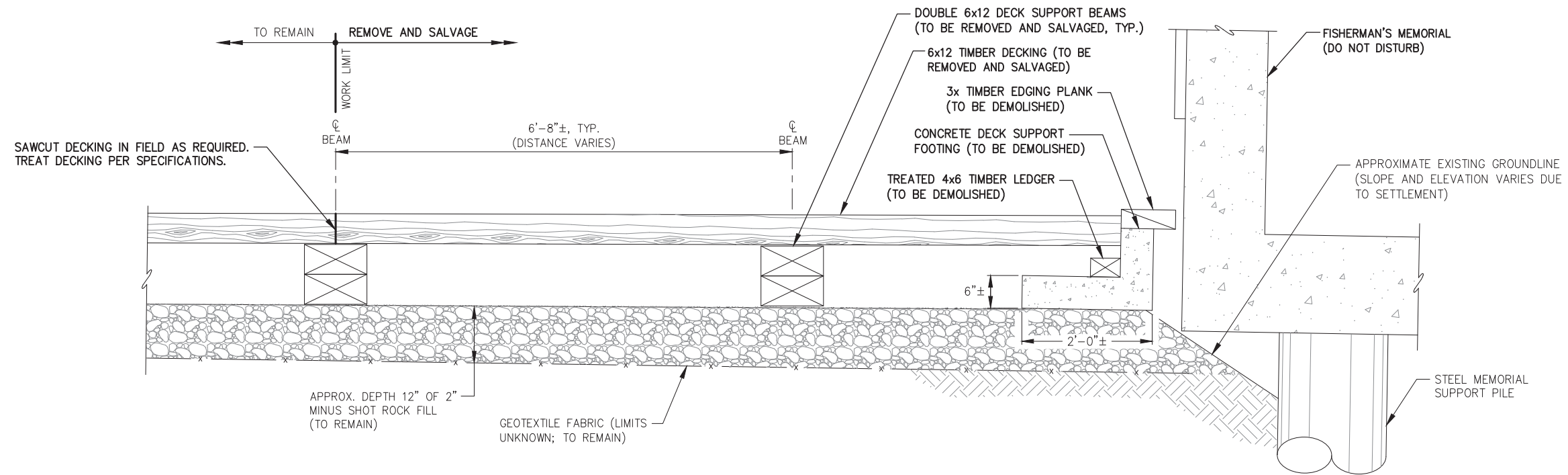

A EXISTING SECTION
S101

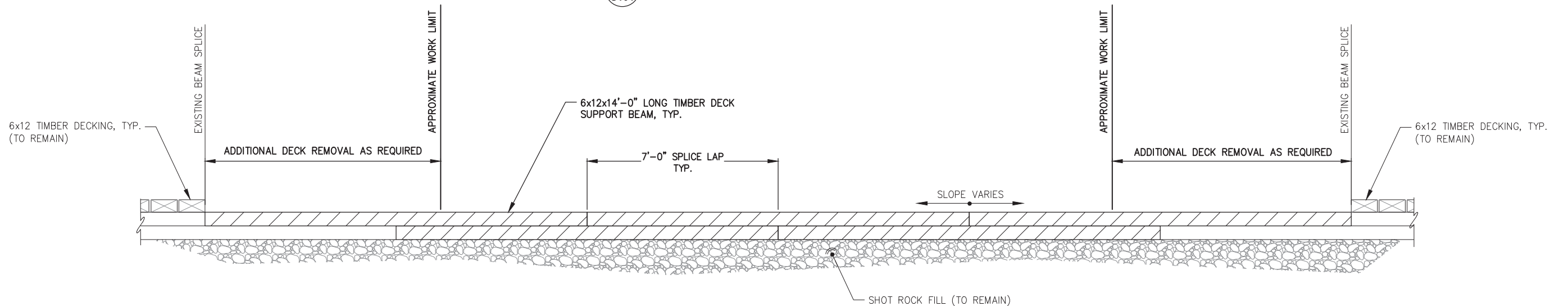

TYPICAL DECK SUPPORT BEAM SPLICES - ELEVATION

- NOTE:**
1. DETAIL REPRESENTS GENERAL, TYPICAL LAYOUT OF EXISTING SUPPORT BEAMS. LENGTH AND SPLICE LOCATION MAY VARY DEPENDING ON LOCATION OF SUPPORT BEAM. SEE OVERALL DEMOLITION PLAN.
 2. HATCHED GRADE BEAMS TO BE REMOVED AND SALVAGED. BEAMS NOT HATCHED TO REMAIN.
 3. BEAMS JOINED w/ SPIKES @ 3'-6" O.C., TYP. REMOVE AND DISPOSE OF SPIKES. REPLACE w/ NEW UPON REPLACEMENT.

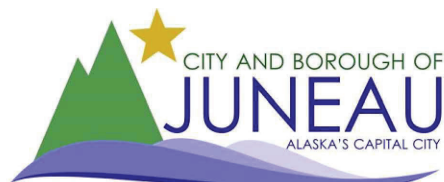

REVISIONS					
REV.	DATE	DESCRIPTION	DWN.	CKD.	APP.



9360 Glacier Highway Ste 100
Juneau, Alaska 99801
Phone: 907-586-2093
Fax: 907-586-2099
www.pndengineers.com

DESIGN: JLD CHECKED: JLD
DRAWN: WRB APPROVED: JLD

SCALE: NTS

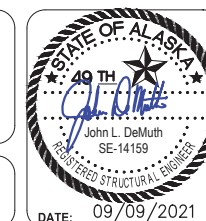

CITY & BOROUGH OF JUNEAU, ALASKA
TAKU SEAWALK RELEVELING PROJECT
CBJ CONTRACT NO. DH22-007

SHEET TITLE:
EXISTING CONDITIONS DETAILS

S102

PND PROJECT NO.: 202096 C.A.N.: AECC250

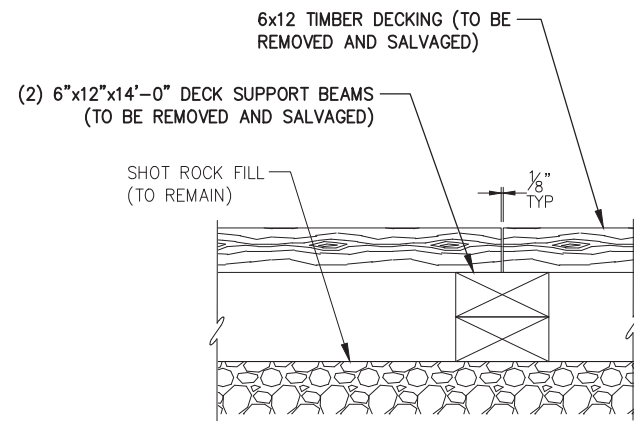

TYPICAL TIMBER DECK JOINT

NOTE:
6x DECK IS ATTACHED TO SUPPORT BEAMS AND LEDGERS w/ GALVANIZED SPIKES AS FOLLOWS: (2) - SPIKES, EACH DECK PLANK, AT EACH SUPPORT BEAM/LEDGER.

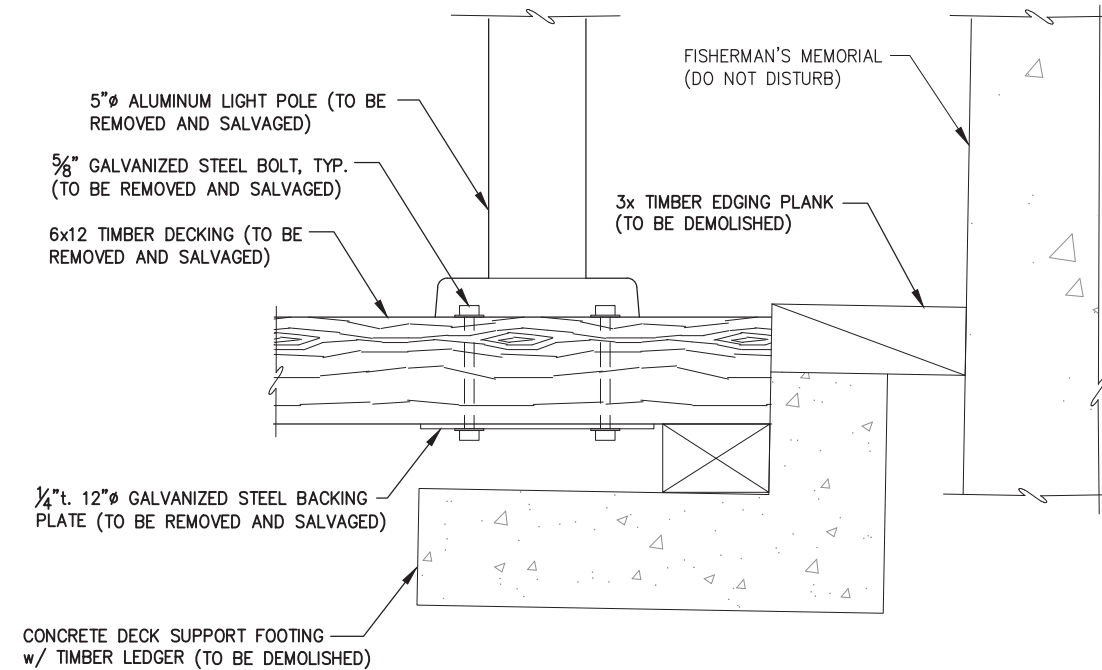

A LIGHT POLE BASE DETAIL

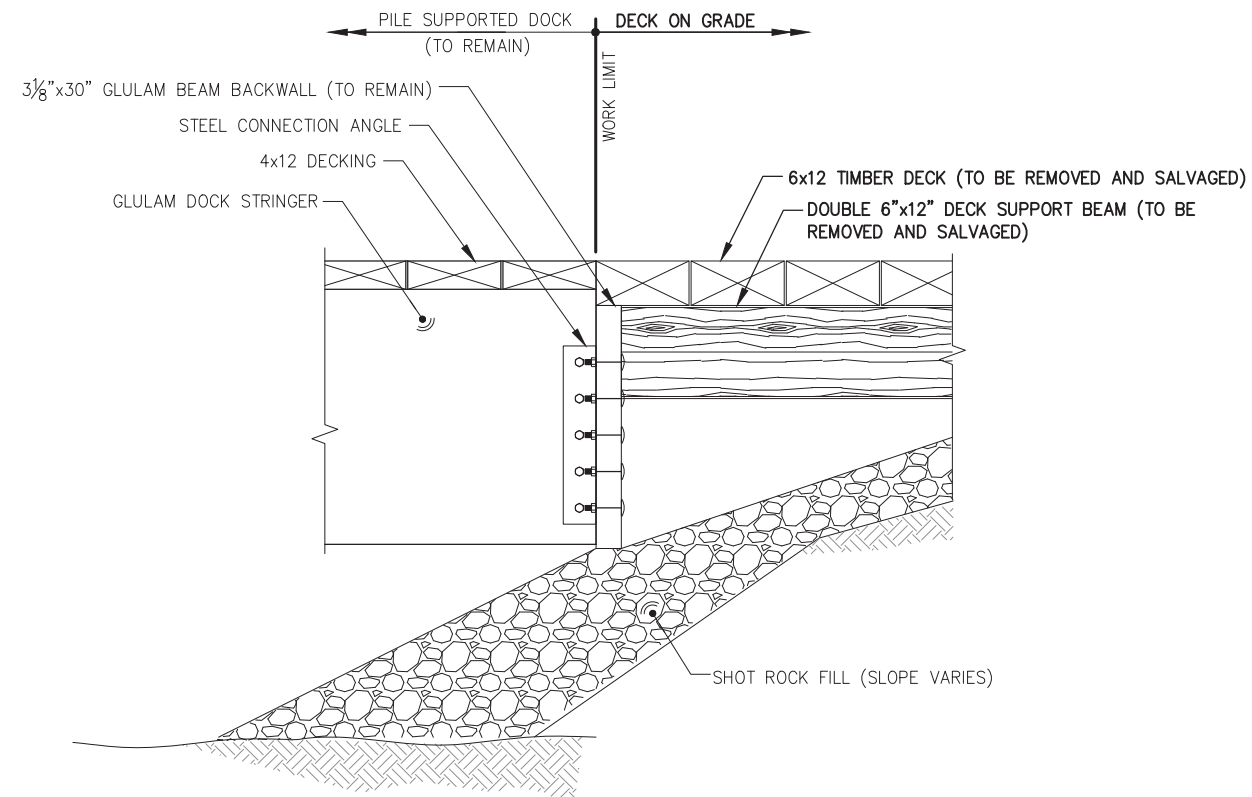

B SECTION AT PILE SUPPORTED DOCK

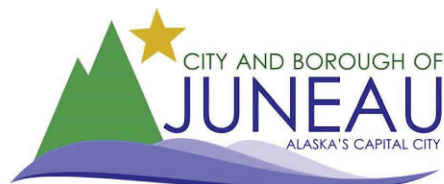

REVISIONS					
REV.	DATE	DESCRIPTION	DWN.	CKD.	APP.



9360 Glacier Highway Ste 100
Juneau, Alaska 99801
Phone: 907-586-2093
Fax: 907-586-2099
www.pndengineers.com

DESIGN: JLD CHECKED: JLD
DRAWN: WRB APPROVED: JLD

SCALE: NTS

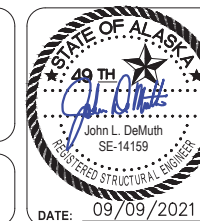

CITY & BOROUGH OF JUNEAU, ALASKA
TAKU SEAWALK RELEVELING PROJECT
CBJ CONTRACT NO. DH22-007

SHEET TITLE:
EXISTING CONDITIONS DETAILS

S103

PND PROJECT NO.: 202096 C.A.N.: AECC250

POINT #	ELEVATION	DESCRIPTION
100	MATCH EXISTING	TOP OF WOOD DECK, EDGE OF PILE SUPPORTED DOCK, CENTERLINE OF BEAM
101	MATCH EXISTING	TOP OF WOOD DECK, CENTERLINE OF BEAM
102	MATCH EXISTING	TOP OF WOOD DECK, CENTERLINE OF BEAM
103	MATCH EXISTING	TOP OF WOOD DECK, CENTERLINE OF BEAM
104	MATCH EXISTING	TOP OF WOOD DECK, CENTERLINE OF BEAM
105	MATCH EXISTING	TOP OF WOOD DECK, CENTERLINE OF BEAM
106 - 112	SEE PLAN AND TABLE SHEET B/S202	
113	MATCH POINT #103	TOP OF WOOD DECK, FACE OF WALL
114	MATCH POINT #102	TOP OF WOOD DECK, FACE OF WALL
115	MATCH POINT #101	TOP OF WOOD DECK, FACE OF WALL
116	MATCH POINT #117	TOP OF WOOD DECK, FACE OF WALL
117	MATCH EXISTING	TOP OF WOOD DECK, EDGE OF PILE SUPPORTED DOCK

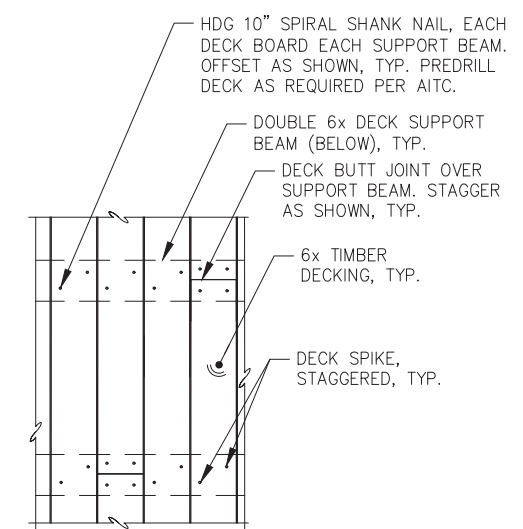
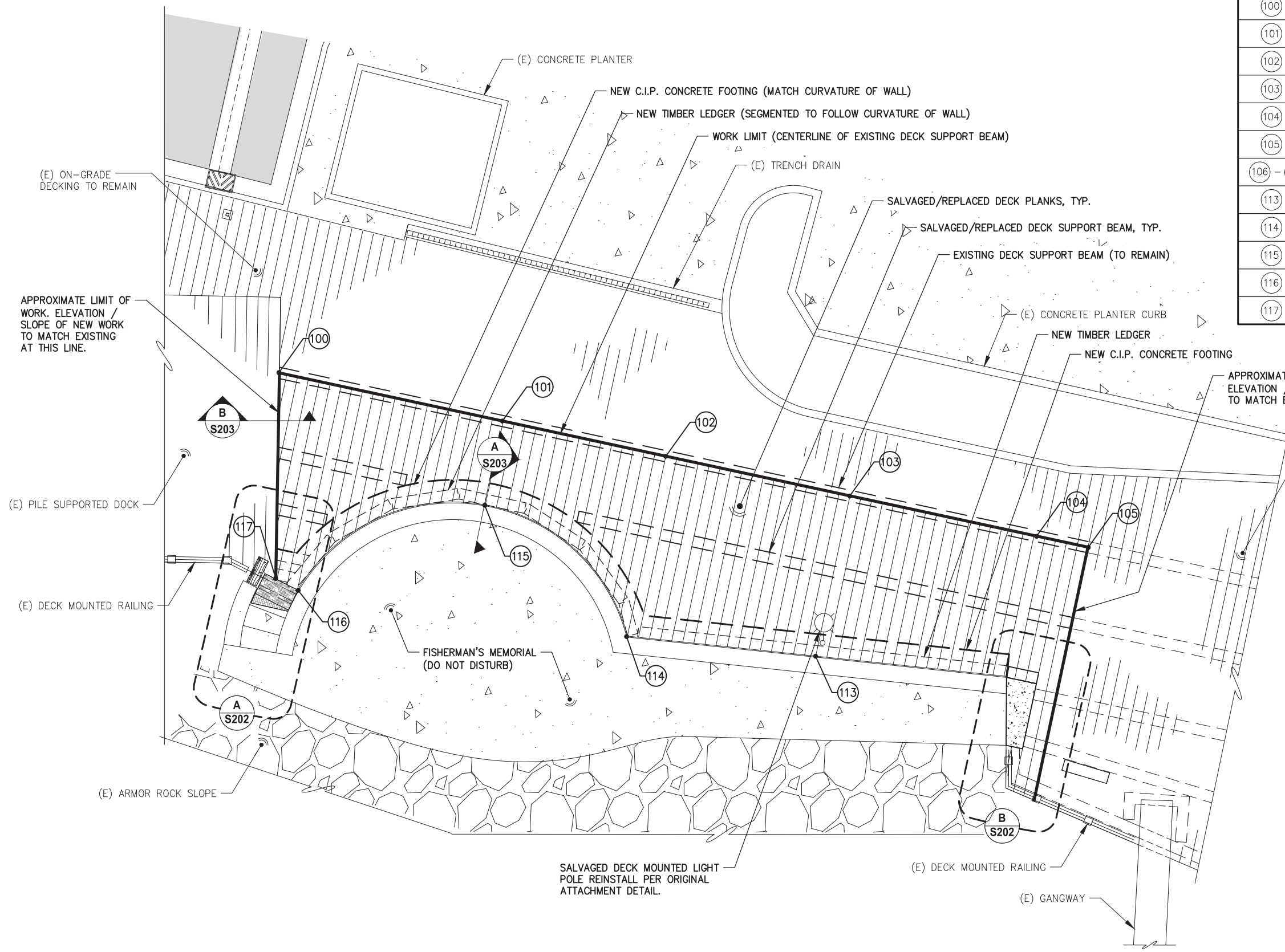

TYPICAL DECK STAGGER / NAILING



REVISIONS					
REV.	DATE	DESCRIPTION	DWN.	CKD.	APP.

PND ENGINEERS, INC.

9360 Glacier Highway Ste 100
Juneau, Alaska 99801
Phone: 907-586-2093
Fax: 907-586-2099
www.pndengineers.com

DESIGN: JLD CHECKED: JLD
DRAWN: WRB APPROVED: JLD

SCALE: SCALE IN FEET
0 10 20 FT.



CITY & BOROUGH OF JUNEAU, ALASKA
TAKU SEAWALK RELEVELING PROJECT
CBJ CONTRACT NO. DH22-007

SHEET TITLE:
SEAWALK RELEVELING PLAN

PND PROJECT NO.: 202096 C.A.N.: AECC250

S201

EDGE OF EXISTING PILE SUPPORTED DOCK, ELEVATION / SLOPE OF SALVAGED REPLACEMENT DECKING TO MATCH.

SALVAGED/REPLACED 6x12 DECKING, TYP.
 NEW C.I.P. CONCRETE FOOTING EXTENSION w/ TIMBER LEDGER(S)
 SALVAGED/REPLACED DOUBLE 6x12 DECK SUPPORT BEAM
 NEW C.I.P. CONCRETE FOOTER
 NEW 6x TIMBER LEDGER SEGMENT, TYP.

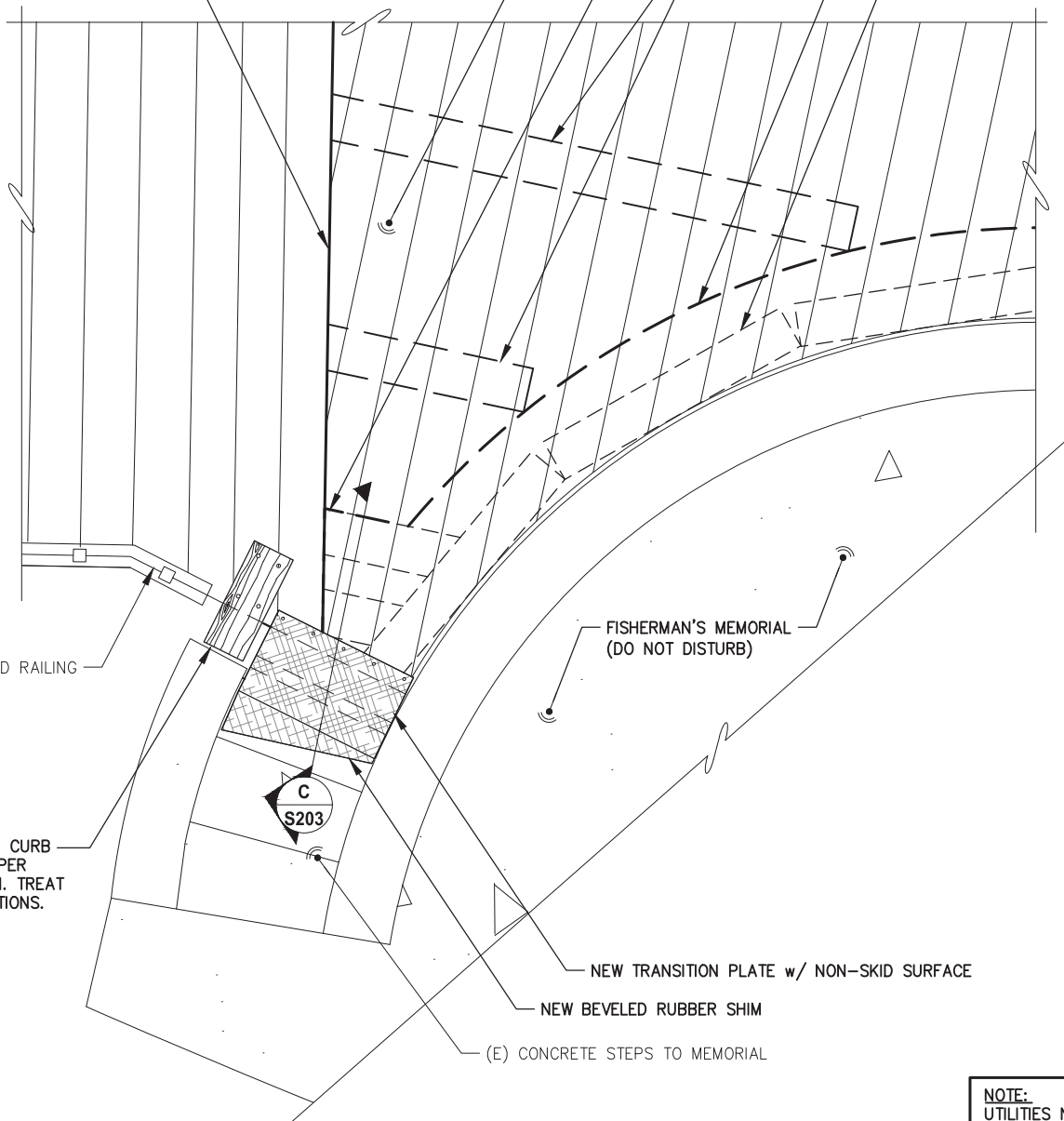

(E) DECK MOUNTED RAILING (TO REMAIN)

NEW DOUBLE 6x12 TIMBER CURB PIECE. FIELD CUT TO FIT PER FIELD ENGINEER DIRECTION. TREAT CUT ENDS PER SPECIFICATIONS. (LENGTH 3 FT.±)

FISHERMAN'S MEMORIAL (DO NOT DISTURB)

C
S203

NEW TRANSITION PLATE w/ NON-SKID SURFACE

NEW BEVELED RUBBER SHIM

(E) CONCRETE STEPS TO MEMORIAL

A NORTH END RELEVELING - PLAN
S201

NOTE:
UTILITIES NOT SHOWN FOR CLARITY, TYP.

NEW 6x TIMBER LEDGER
 NEW C.I.P. CONCRETE FOOTER

SALVAGED/REPLACED 6x12 DECKING, TYP.

SALVAGED DOUBLE 6x12 DECK SUPPORT PIECE TO SUPPORT DECKING THIS AREA/END

(E) DECKING, REMOVE, SALVAGE AND REINSTALL AS REQUIRED TO COMPLETE WORK.

APPROXIMATE LIMIT OF WORK, ELEVATION/SLOPE OF SALVAGED REPLACEMENT DECKING TO MATCH.

(E) DECK SUPPORT BEAM, MODIFY/TRIM AS REQUIRED TO COMPLETE NEW CONCRETE WORK, TYP.

NOTE:
HATCHED EXISTING 6x12 DECK SUPPORT BEAMS SHALL REMAIN IN CURRENT LOCATION AND ELEVATION.

FISHERMAN'S MEMORIAL CONCRETE WALKWAY (DO NOT DISTURB)

NEW C.I.P. CONCRETE TRANSITION, SLOPE/TAPER AS REQUIRED.

(E) DECK EDGE SUPPORT BEAM, MODIFY/TRIM AS REQUIRED TO COMPLETE CONCRETE WORK, TYP.

(E) DECK MOUNTED RAILING (TO REMAIN)

(E) PLACARD (DO NOT DISTURB)

B SOUTH END RELEVELING - PLAN
S201

POINT #	ELEVATION	DESCRIPTION
106	MATCH TOP OF WOOD DECK	TOP OF NEW CONCRETE
107	MATCH TOP OF WOOD DECK	TOP OF NEW CONCRETE
108	MATCH EXISTING	TOP OF WOOD DECK
109	MATCH EXISTING	TOP OF WOOD DECK
110	MATCH EXISTING	TOP OF EXISTING CONCRETE, TOP OF NEW CONCRETE
111	MATCH EXISTING	TOP OF EXISTING CONCRETE, TOP OF NEW CONCRETE
112	MATCH EXISTING	TOP OF EXISTING CONCRETE, TOP OF NEW CONCRETE

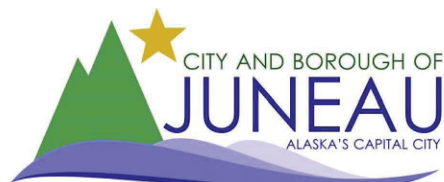

REVISIONS					
REV.	DATE	DESCRIPTION	DWN.	CKD.	APP.



9360 Glacier Highway Ste 100
 Juneau, Alaska 99801
 Phone: 907-586-2093
 Fax: 907-586-2099
 www.pndengineers.com

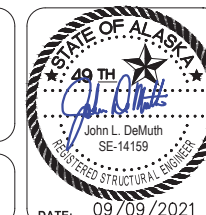

CITY & BOROUGH OF JUNEAU, ALASKA
TAKU SEAWALK RELEVELING PROJECT
 CBJ CONTRACT NO. DH22-007

SHEET TITLE:
SEAWALK RELEVELING ENLARGEMENT PLANS

S202

PND PROJECT NO.: 202096 C.A.N.: AECC250

DESIGN: JLD CHECKED: JLD
 DRAWN: WRB APPROVED: JLD

SCALE:
 NTS

DATE: 09/09/2021

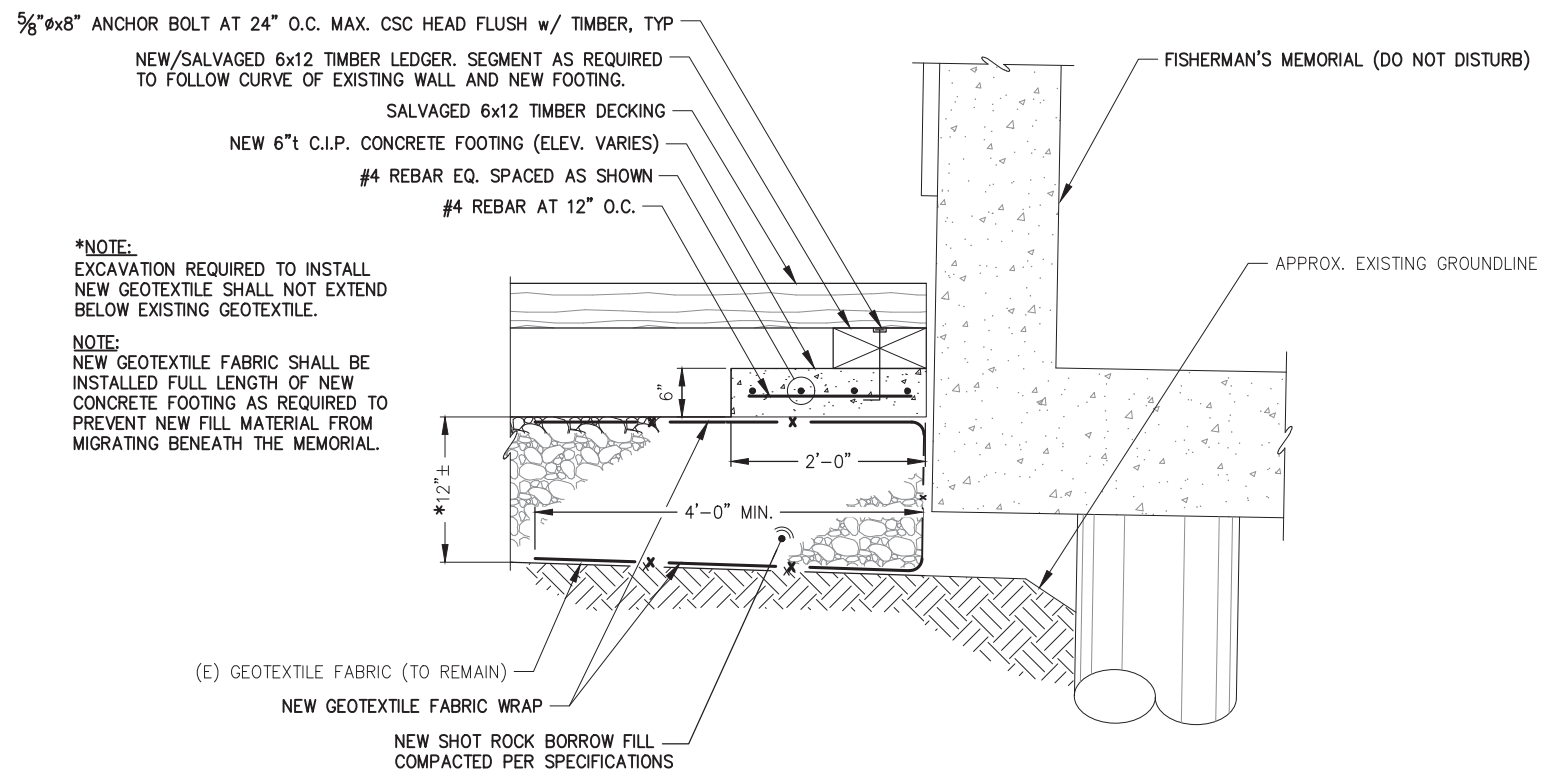

A SECTION AT DECK SUPPORT FOOTING
S201

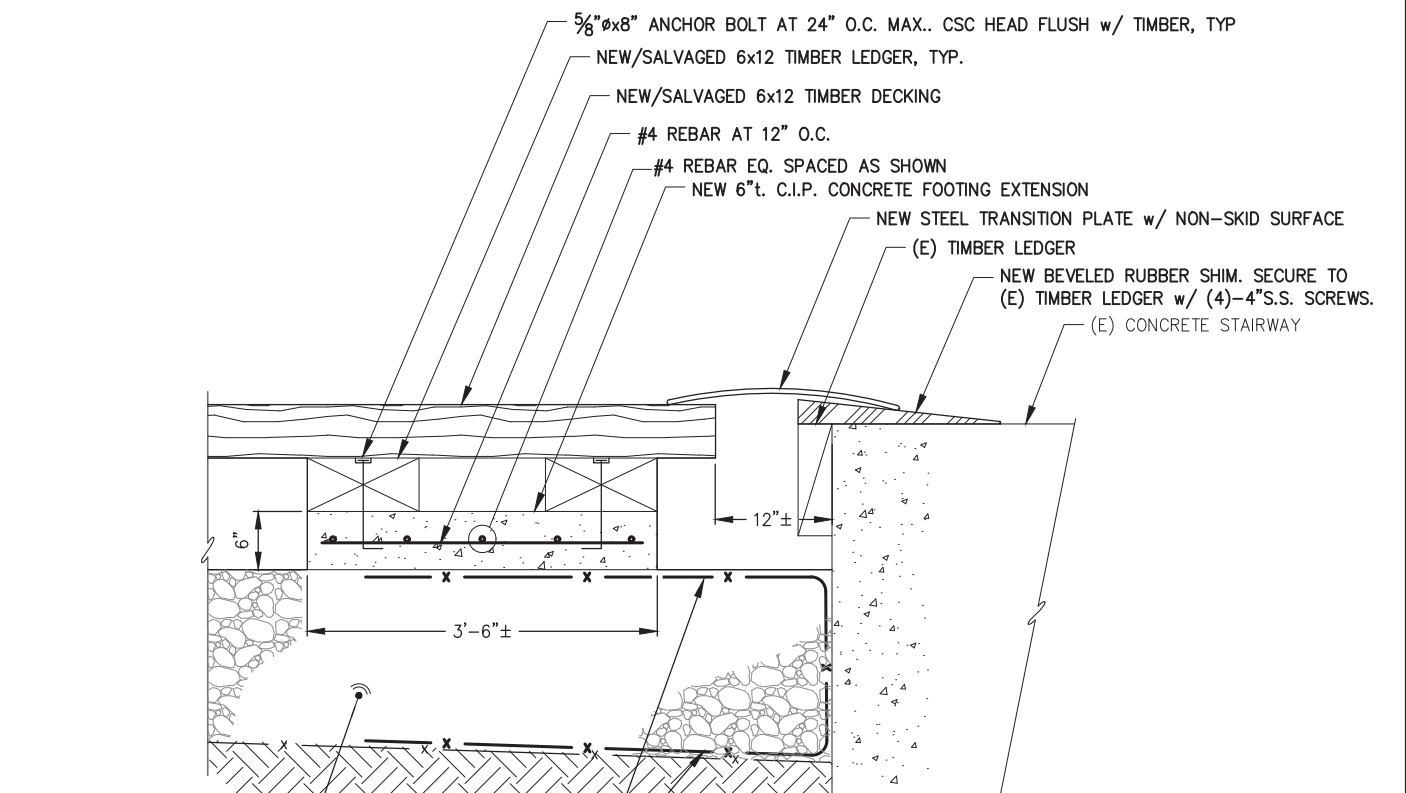

C SECTION AT CONCRETE FOOTING EXTENSION
S202

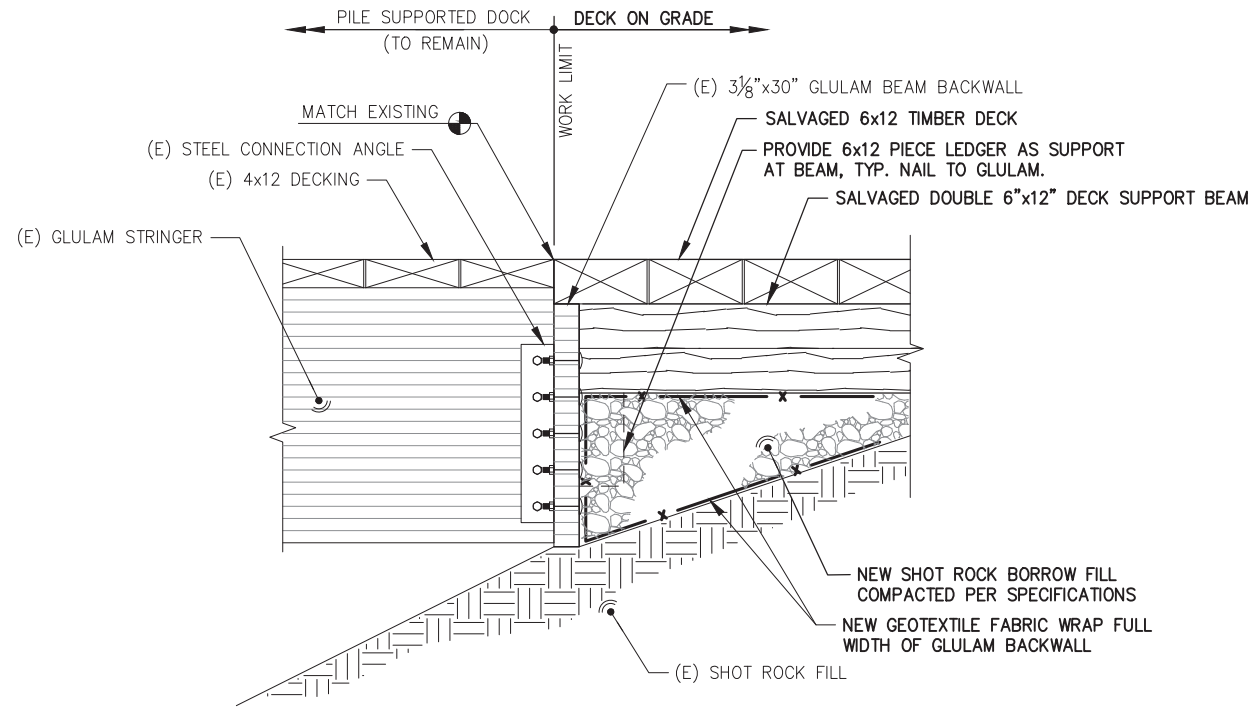

B SECTION AT PILE SUPPORTED DOCK
S201

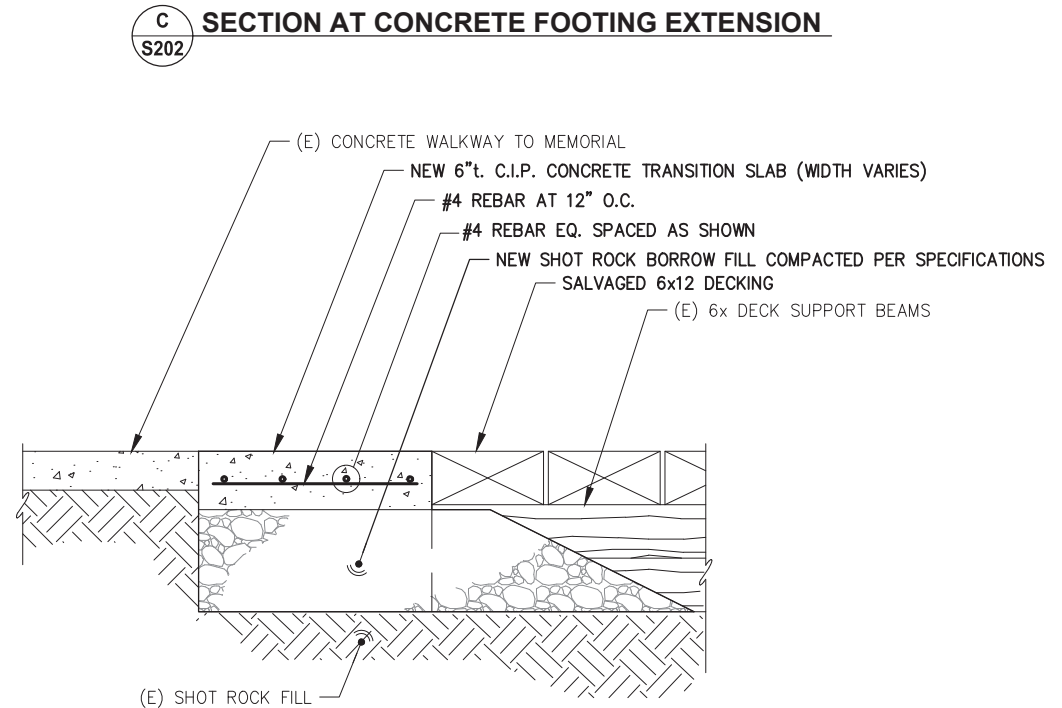

D SECTION AT CONCRETE TRANSITION
S202

NOTE:
THICKNESS OF TRANSITION SLAB MAY VARY SLIGHTLY
DUE TO TAPERING TO MATCH ADJACENT ELEVATIONS.



REVISIONS					
REV.	DATE	DESCRIPTION	DWN.	CKD.	APP.



9360 Glacier Highway Ste 100
Juneau, Alaska 99801
Phone: 907-586-2093
Fax: 907-586-2099
www.pndengineers.com

DESIGN: JLD CHECKED: JLD
DRAWN: WRB APPROVED: JLD

SCALE:
NTS



CITY & BOROUGH OF JUNEAU, ALASKA
TAKU SEAWALK RELEVELING PROJECT
CBJ CONTRACT NO. DH22-007

SHEET TITLE:
SEAWALK RELEVELING DETAILS

S203

PND PROJECT NO.: 202096 C.A.N.: AECC250

DATE: 09/09/2021

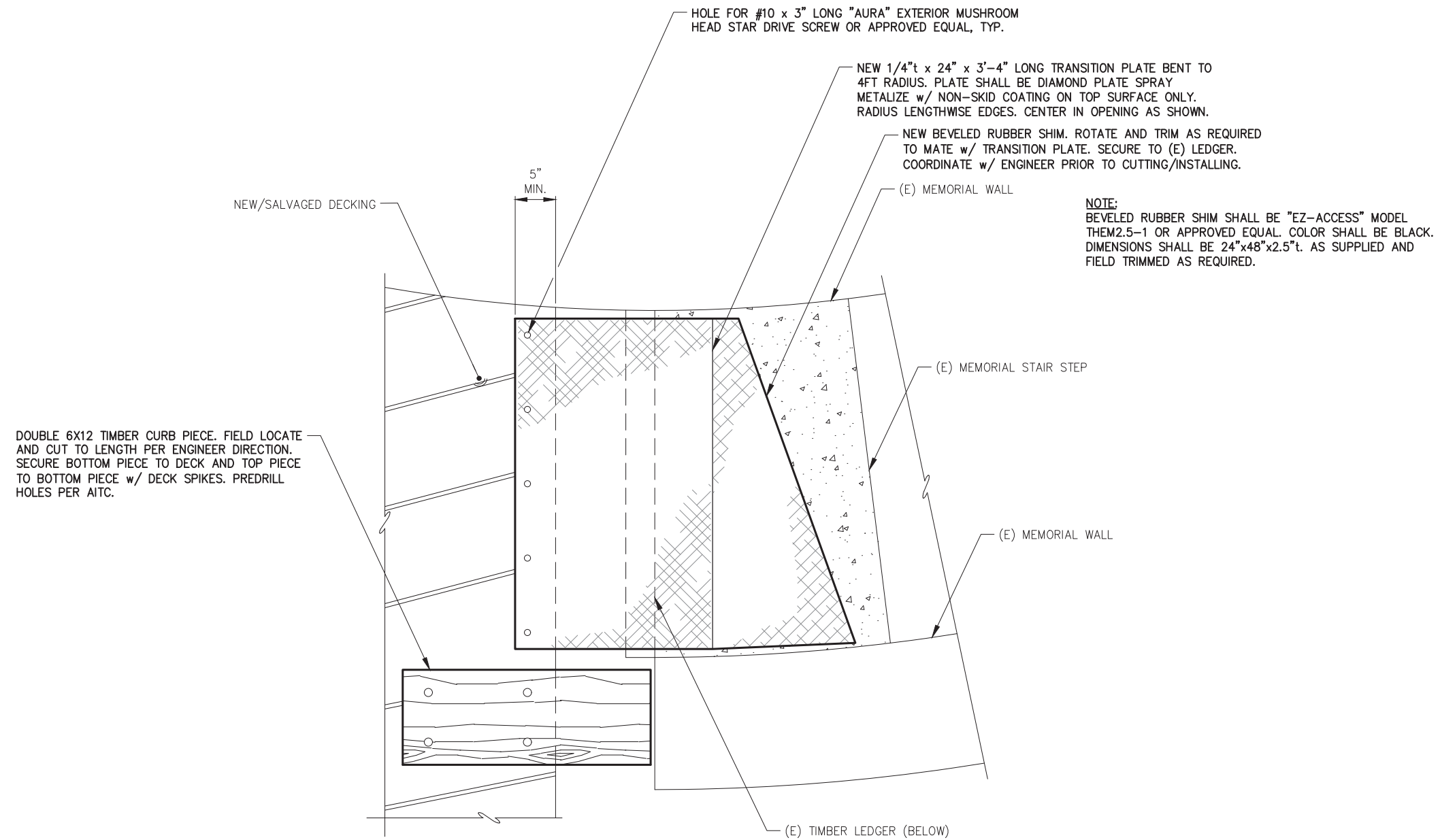

NORTH END TRANSITION - PLAN

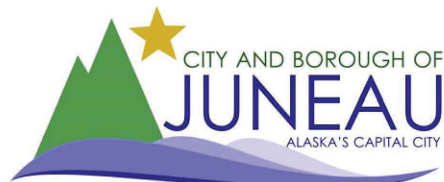

REVISIONS					
REV.	DATE	DESCRIPTION	DWN.	CKD.	APP.

P | N | D
ENGINEERS, INC.

9360 Glacier Highway Ste 100
Juneau, Alaska 99801
Phone: 907-586-2093
Fax: 907-586-2099
www.pndengineers.com

DESIGN: JLD CHECKED: JLD
DRAWN: WRB APPROVED: JLD

SCALE: NTS

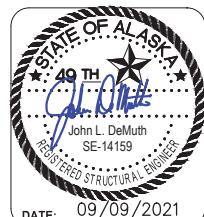

CITY & BOROUGH OF JUNEAU, ALASKA
TAKU SEAWALK RELEVELING PROJECT
CBJ CONTRACT NO. DH22-007

SHEET TITLE:
SEAWALK RELEVELING DETAILS

PND PROJECT NO.: 202096 C.A.N.: AECC250

S204