



**ADDENDUM TO THE CONTRACT**

for the

**STABLER POINT QUARRY OVERBURDEN REMOVAL  
Contract No. BE21-263**

**ADDENDUM NO.: ONE**

**CURRENT DEADLINE FOR BIDS:**

June 3, 2021

**PREVIOUS ADDENDA: NONE**

**ISSUED BY:**

City and Borough of Juneau  
ENGINEERING DEPARTMENT  
155 South Seward Street  
Juneau, Alaska 99801

**DATE ADDENDUM ISSUED:**

**May 19, 2021**

The following items of the contract are modified as herein indicated. All other items remain the same. This addendum has been issued and is posted online. Please refer to the CBJ Engineering Contracts Division webpage at: [http://www.juneau.org/engineering\\_ftp/contracts/Contracts.php](http://www.juneau.org/engineering_ftp/contracts/Contracts.php)

**DRAWINGS:**

- Item No. 1 ***Insert*** attached ***Drawing*** 1 of 3, titled "LOCATION AND DRAWING INDEX" labeled ADDENDUM 1.
- Item No. 3 ***Insert*** attached ***Drawing*** 2 of 3, titled "SITE PLAN" labeled ADDENDUM 1.
- Item No. 3 ***Insert*** attached ***Drawing*** 3 of 3, titled "OVERBURDEN REMOVAL AREA DETAIL" labeled ADDENDUM 1.







By:   
Greg Smith,  
Contract Administrator

Total number of pages contained within this Addendum: 4

# DRAWING INDEX

- SHEET 1 - LOCATION AND DRAWING INDEX
- SHEET 2 - SITE PLAN
- SHEET 3 - OVERBURDEN REMOVAL AREA DETAIL

# LEGEND

-  PRIMARY CONTROL MONUMENT
-  CONTROL POINT
-  G.L.O. BLM PRIMARY MONUMENT BRASS CAP
-  TREELINE
-  CULVERT
-  EXISTING DRAINAGE PATH
-  PROPOSED DRAINAGE PATH

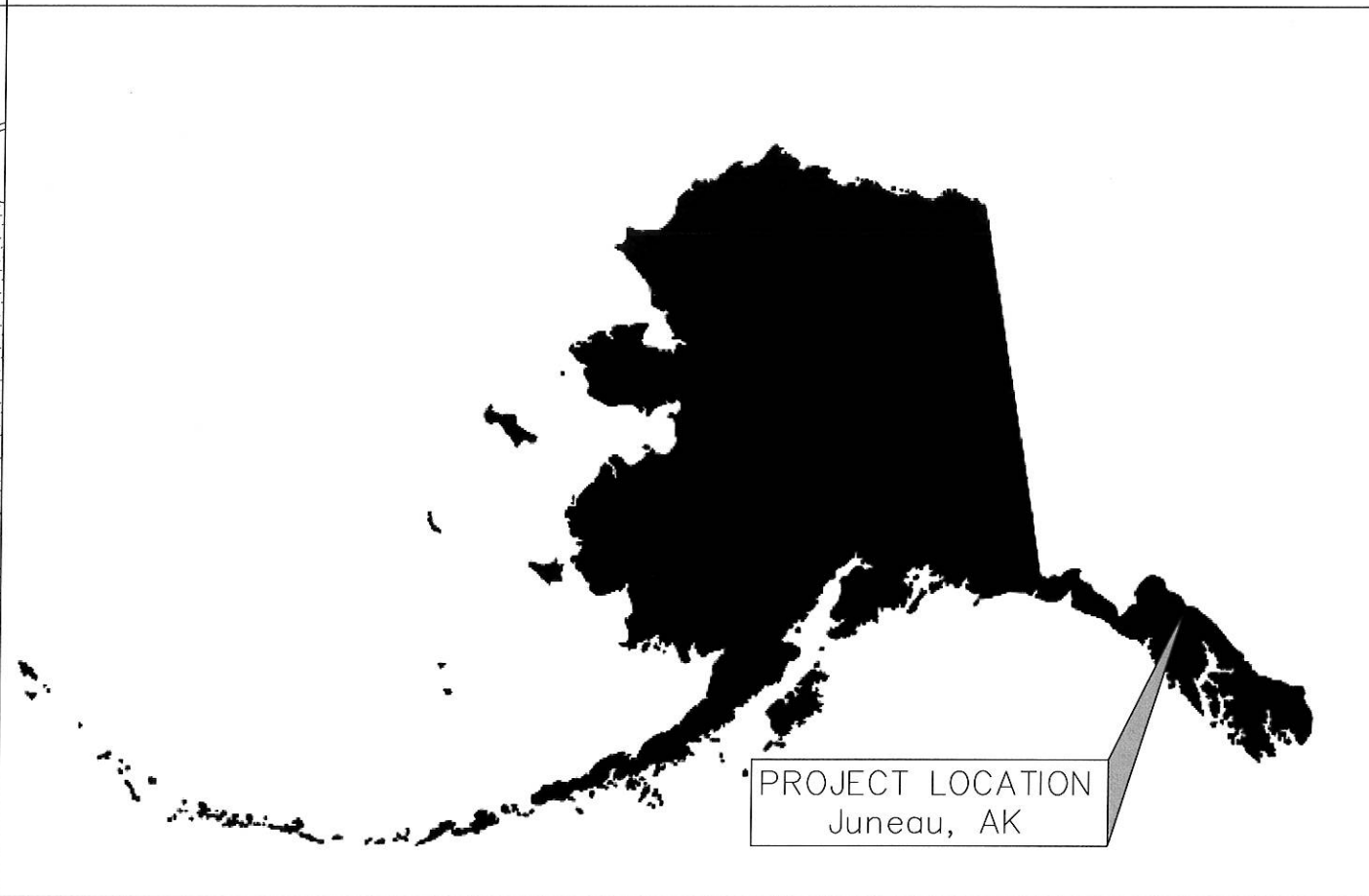
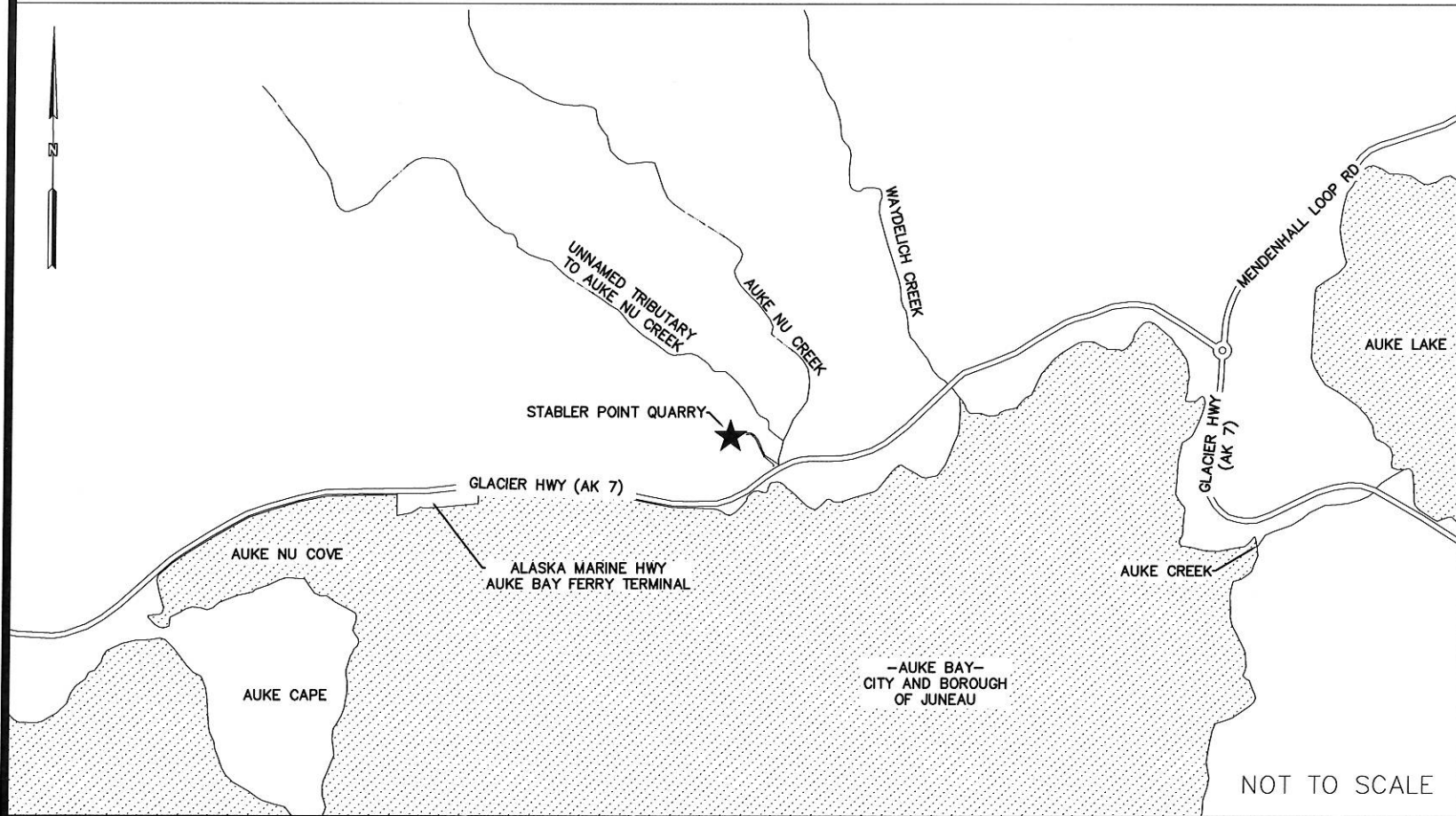

NOT TO SCALE

Revisions		
Date	Description	Intls.
-	-	-

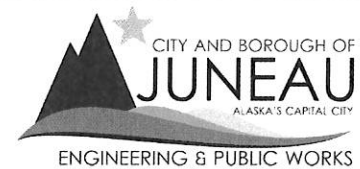

**2021 STABLER POINT QUARRY  
OVERBURDEN DISPOSAL  
CONTRACT NO. BE21-263**

**LOCATION AND DRAWING INDEX**

DATE: 04/07/2021    DRAWN BY: STAFF    SCALE: As Shown

SHEET:  
1 of 3



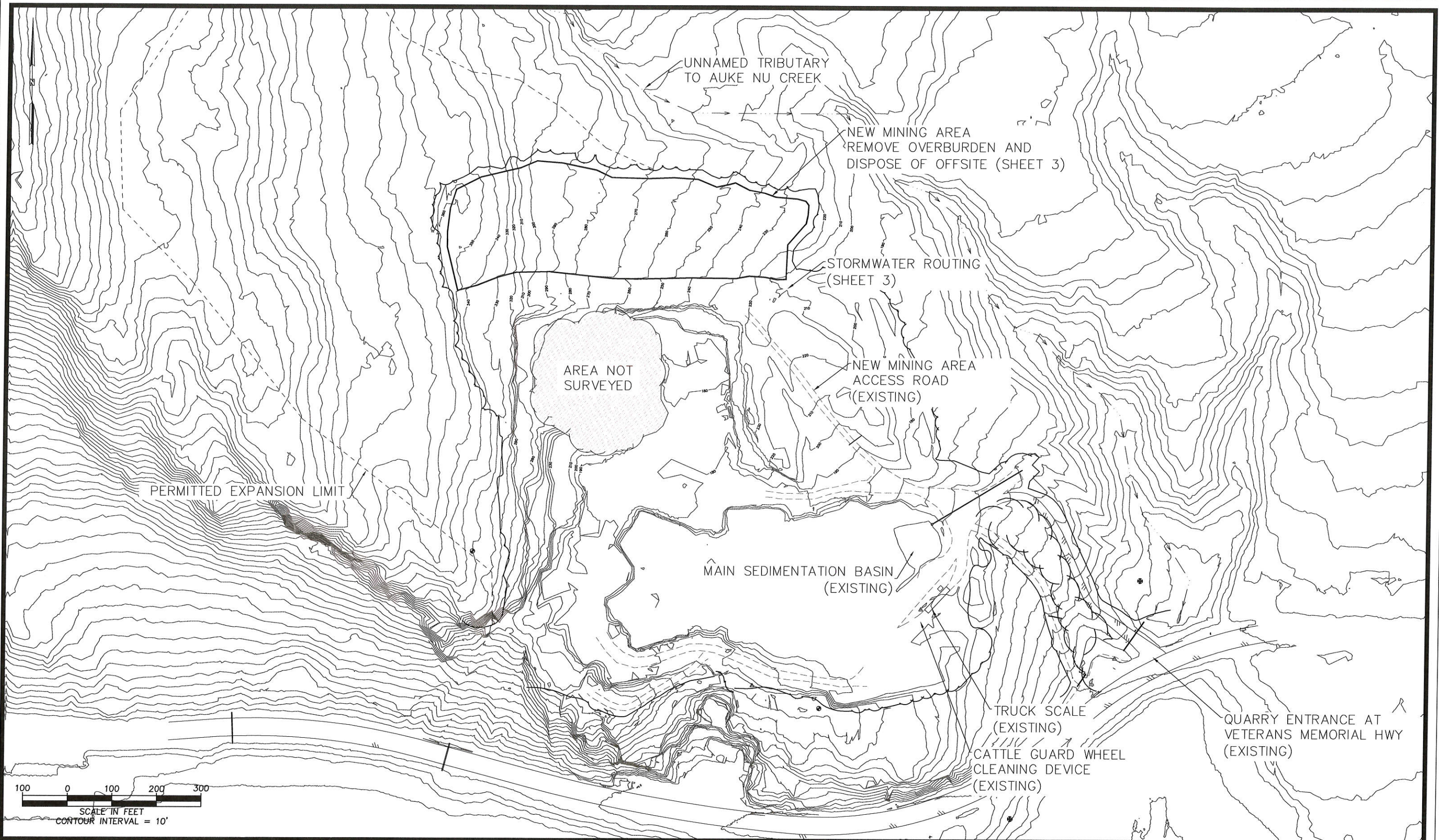

Revisions		
Date	Description	Intls.
-	-	-
-	-	-
-	-	-

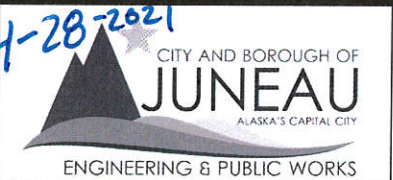
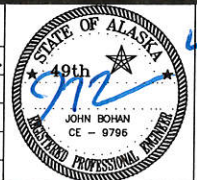

**2021 STABLER POINT QUARRY  
OVERBURDEN DISPOSAL  
CONTRACT NO. BE21-263**

**SITE PLAN**

DATE: 04/07/2021    DRAWN BY: STAFF    SCALE: As Shown

SHEET:  
**2** of **3**



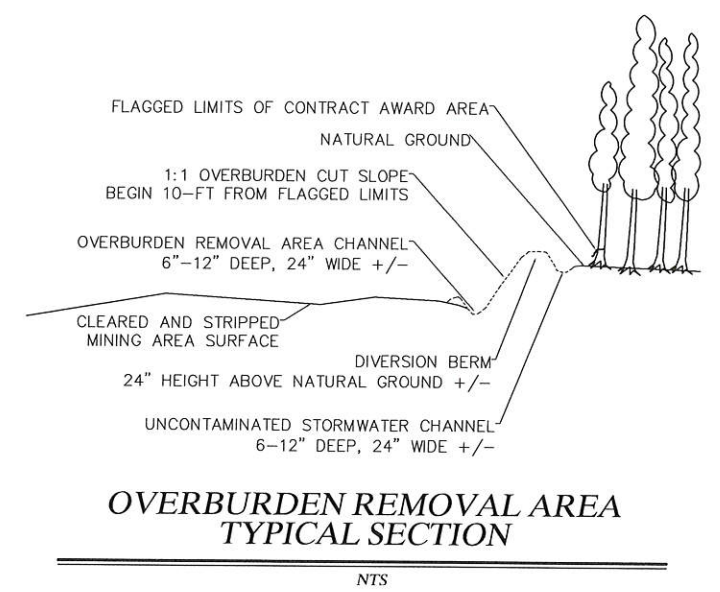
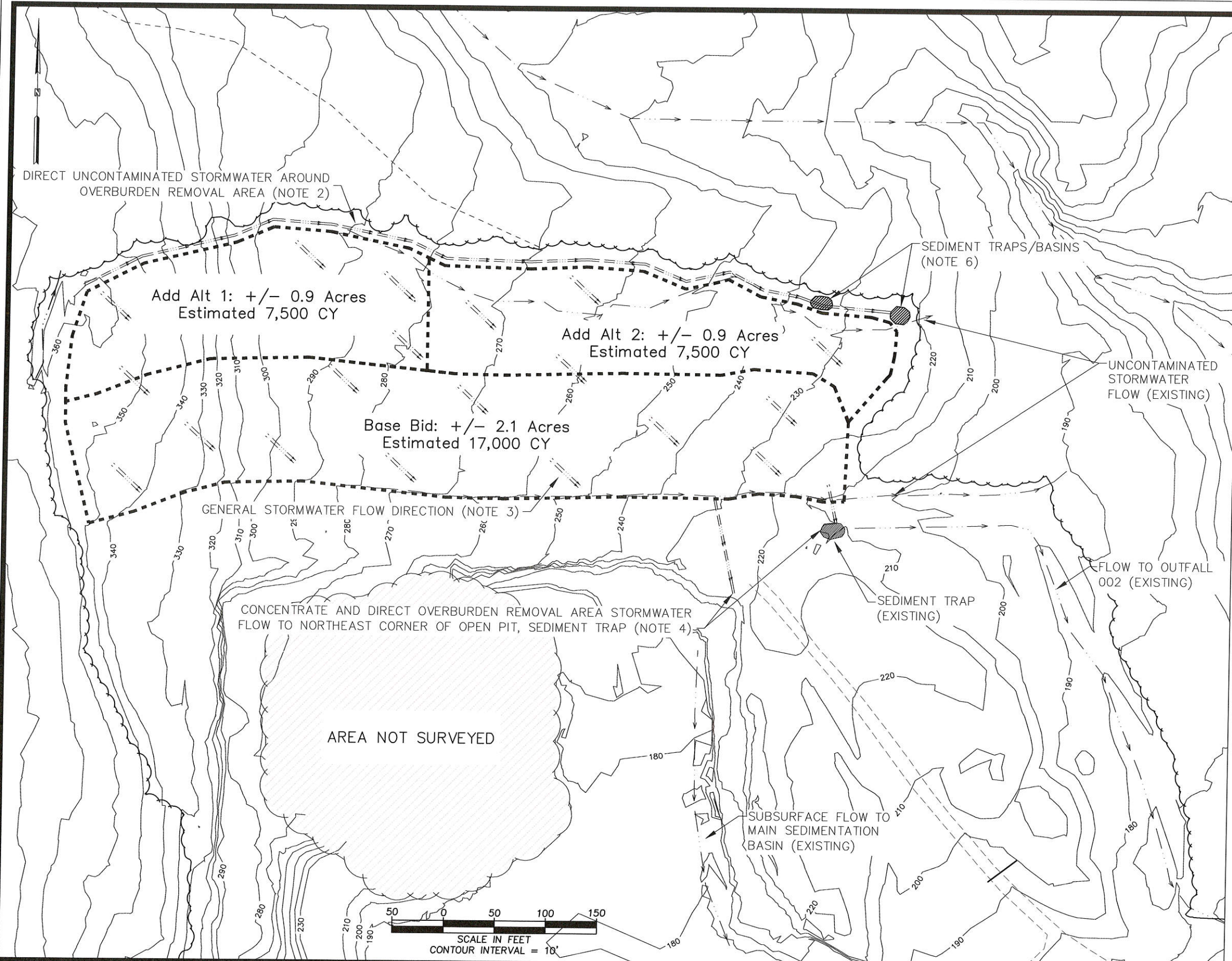

**NOTES**

1. THE LIMITS OF OVERBURDEN REMOVAL AREAS ARE CURRENTLY CLEARED AND GRUBBED WITH MINOR EXCEPTIONS. PERIMETER AREAS MAY REQUIRE INCIDENTAL REMOVAL OF TREE FALL AND GRUBBING TO FACILITATE DRAINAGE ROUTING.
2. THE CONTRACTOR SHALL ESTABLISH UNCONTAMINATED STORMWATER CHANNELS AND DIVERSION BERMS WHERE NECESSARY ALONG THE PERIMETER OF THE AWARDED OVERBURDEN REMOVAL AREA PRIOR TO BEGINNING OVERBURDEN REMOVAL OPERATIONS. THESE CHANNELS AND BERMS SHALL PREVENT UNCONTAMINATED STORMWATER FROM ENTERING THE OVERBURDEN REMOVAL AREA. UNCONTAMINATED STORMWATER CHANNELS SHALL DAYLIGHT ONTO NATURAL GROUND OR AS DIRECTED BY THE ENGINEER.
3. OVERBURDEN AREA STORMWATER CHANNELS SHALL BE EXCAVATED INTO THE CLEARED AND STRIPPED MINING SURFACE WHERE PRACTICABLE AND AS NECESSARY ALONG THE PERIMETER OF AND ACROSS THE FINISHED AREAS TO DIRECT RUNOFF TOWARD THE OPEN PIT AND EXISTING SEDIMENT TRAP. LOCATIONS OF DRAINAGE PATHS WILL VARY AND MAY REQUIRE CONSTRUCTION OF DIVERSION BERMS NEAR THE EASTERN EXTENTS AND WITHIN THE OVERBURDEN AREA TO DIRECT FLOW.
4. OVERBURDEN AREA STORMWATER CHANNELS SHALL BE DIRECTED INTO THE NORTHEAST CORNER OF THE OPEN PIT, EXCEPTING AREAS AT ELEVATIONS WHERE GRADE PREVENTS. RUNOFF FROM AREAS WITHIN THE EASTERN EDGE OF THE OVERBURDEN REMOVAL AREA THAT CANNOT BE DIRECTED INTO THE OPEN PIT SHALL BE DIRECTED INTO THE EXISTING SEDIMENT TRAP NEAR THE SOUTHEAST EXTENT OF THE OVERBURDEN REMOVAL AREA OR AS DIRECTED BY THE ENGINEER.
5. CONTRACTOR SHALL INSTALL CHECK DAMS IN UNCONTAMINATED STORMWATER CHANNELS AND OVERBURDEN REMOVAL AREA STORMWATER CHANNELS AT NO MORE THAN 75-FOOT INTERVALS, AND MORE FREQUENTLY AS NECESSARY TO REDUCE CHANNELIZED WATER VELOCITY AND PREVENT EROSION. CHECK DAM LOCATIONS SHALL BE FIELD VERIFIED BY ENGINEER.
6. CONTRACTOR SHALL CONSTRUCT A MINIMUM OF (2) ROCK-LINED SEDIMENT TRAPS NEAR THE DAYLIGHT END OF THE CLEAN STORMWATER DIVERSION CHANNEL.
7. AT THE COMPLETION OF OVERBURDEN REMOVAL, THE CONTRACTOR SHALL REMOVE ALL SEDIMENT FROM THE EXISTING SEDIMENT TRAP, THE MAIN SEDIMENTATION BASIN, AND THE WHEEL CLEANING DEVICE.
8. NEWLY CONSTRUCTED STORMWATER CONTROLS, INCLUDING BUT NOT LIMITED TO CHANNELS, CHECK DAMS, AND SEDIMENT TRAPS SHALL BE FREE OF SEDIMENT AT THE CONCLUSION OF THE PROJECT.

Revisions		
Date	Description	Intls.
-	-	-
-	-	-
-	-	-

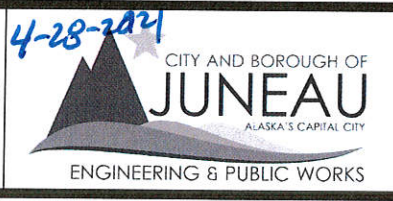

**2021 STABLER POINT QUARRY  
OVERBURDEN DISPOSAL  
CONTRACT NO. BE21-263**

**OVERBURDEN REMOVAL AREA  
DETAIL**

DATE: 04/07/2021    DRAWN BY: STAFF    SCALE: As Shown

SHEET:  
**3** of **3**