



ADDENDUM TO THE CONTRACT

for the

**CHICKEN YARD PARK & AUKE LAKE WAYSIDE IMPROVEMENTS
Contract No. BE20-191**

ADDENDUM NO.: TWO

CURRENT DEADLINE FOR BIDS:

August 4, 2020

PREVIOUS ADDENDA: ONE

ISSUED BY:

City and Borough of Juneau
ENGINEERING DEPARTMENT
155 South Seward Street
Juneau, Alaska 99801

DATE ADDENDUM ISSUED:

July 28, 2020

The following items of the contract are modified as herein indicated. All other items remain the same. This addendum has been issued and is posted online. Please refer to the CBJ Engineering Contracts Division webpage at: <http://www.juneau.org/engineering ftp/contracts/Contracts.php>

DRAWINGS:

Delete Drawing Sheet L100 and **replace with** the attached Drawing Sheet L100, labeled ADDENDUM 2.

By: _____

Greg Smith,
Contract Administrator

Total number of pages contained within this Addendum: 2

Drawing J:\PDC-19-01 Juneau Park Improvements2 - CAD\Corvus-Sheets - Auke Lake Rec.dwg last saved on 6/12/2020 1:49 PM was plotted by Linda Pringle on 6/12/2020 3:25 PM

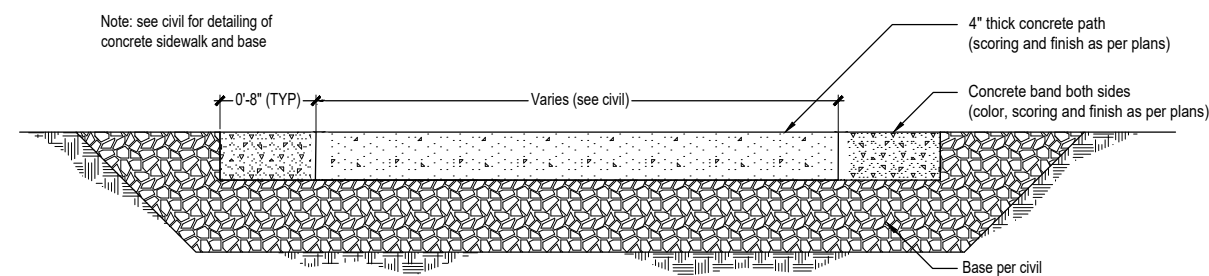
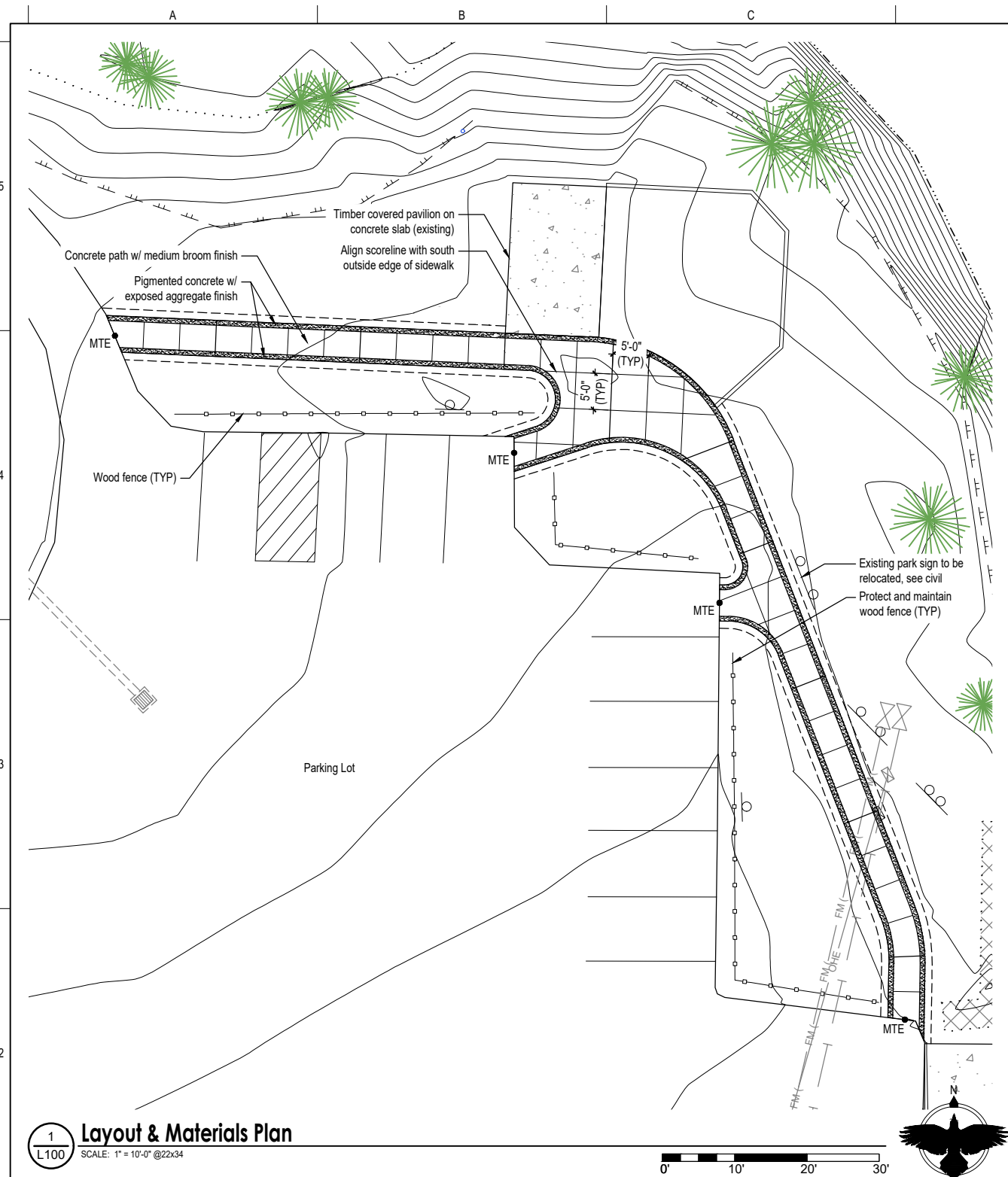

1
L100
SCALE: 1" = 10'-0" @22x34

2
L100
SCALE: NTS @22x34

ADDENDUM 2

Corvus Design
Landscape Architecture
www.corvus-design.com
Anchorage - 907.222.2859
2506-B Fairbanks St. 99503
Juneau - 907.988.9000
119 Seward St. 99801
AECC #1195



City and Borough of Juneau
Auke Lake Wayside
100% Construction Drawings
Juneau, AK

If the above dimension does not measure exactly 1", this drawing has been enlarged or reduced, affecting all scales.

DATE: June 12, 2020
JOB NUMBER: PDC-19-01
DRAWN BY: LP
CHECKED BY: CM

Paving Plan
SHEET #:
L100