

Presented by: The Manager
Introduced: 03/04/82
Drafted by: G.L.S.

RESOLUTION OF THE CITY AND BOROUGH OF JUNEAU, ALASKA

Serial No. 836

A RESOLUTION NAMING THE NEW AIRPORT ACCESS STREET
AND A PORTION OF THE OLD DAIRY ROAD YANDUKIN DRIVE.

WHEREAS, the city and borough has constructed a new street to provide access to the Juneau International Airport, and

WHEREAS, such street should be given a name which is related to airport functions, and

WHEREAS, the word "airport" has already been used in the name of a street, and

WHEREAS, the Tlingit word "Yandukin" means "to fly," and

WHEREAS, the Planning Commission recommends the subject street be named Yandukin Drive;

NOW, THEREFORE, BE IT RESOLVED BY THE ASSEMBLY OF THE CITY AND BOROUGH OF JUNEAU, ALASKA:

That part of the Old Dairy Road and the newly constructed airport access road more particularly shown on Exhibit 1 is named Yandukin Drive.

ADOPTED this 4th day of March, 1982.



Mayor

Attest:



Clerk

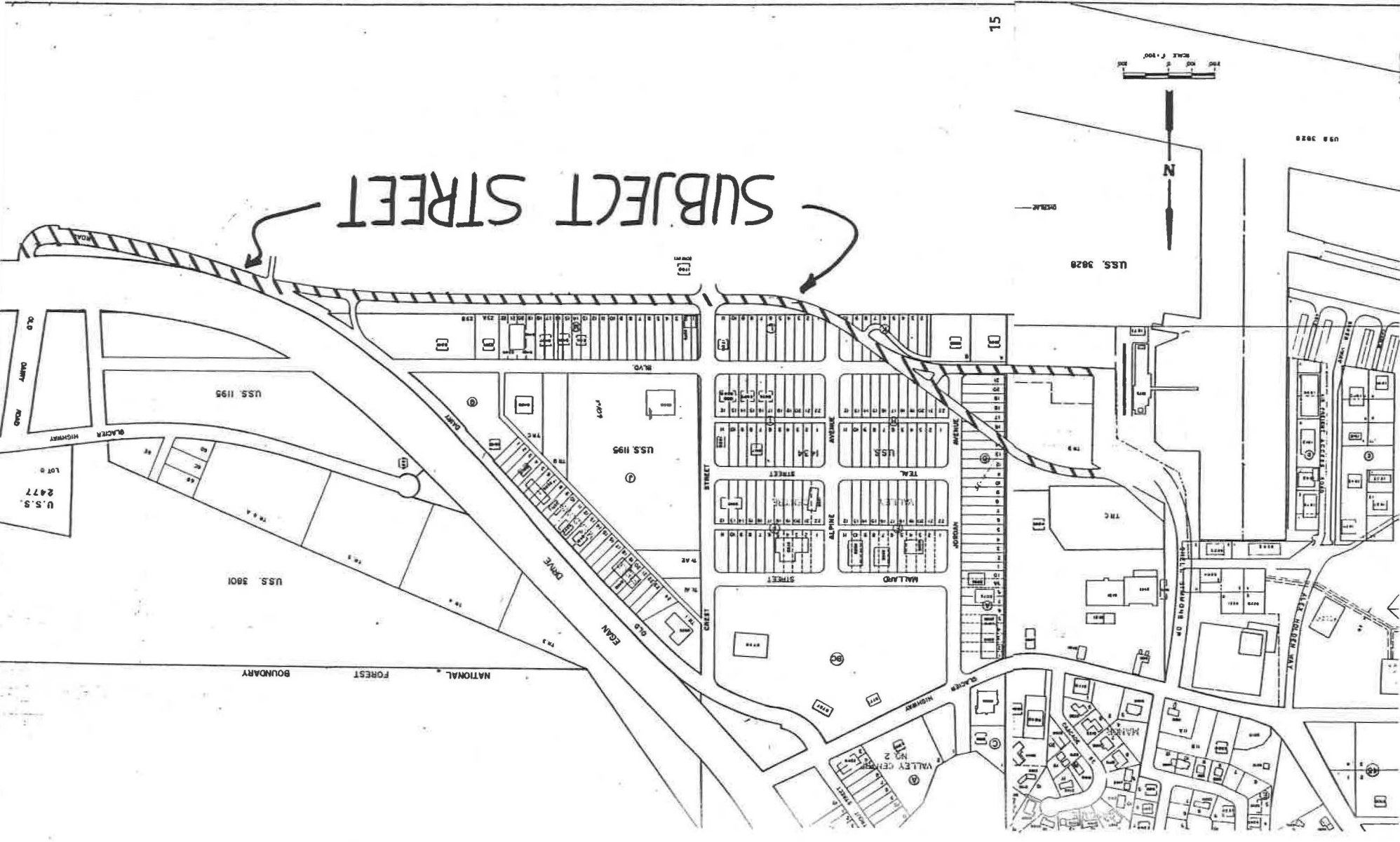

SUBJECT STREET

15



U.S.S. 2477
LOT B
OLD QUARRY ROAD

U.S.S. 1195

U.S.S. 3901

U.S.S. 1195

U.S.S. 3928

U.S.S. 3928

VALLEY CENTER
NO. 2

THE FAIRVIEW APARTMENTS

THE FAIRVIEW APARTMENTS

NATIONAL FOREST BOUNDARY