

DRILL & TAP: 5/8" - 11 N.C. ON 23" B.C. (TYP. 3 PL.)

FRAME  
PLAN VIEW

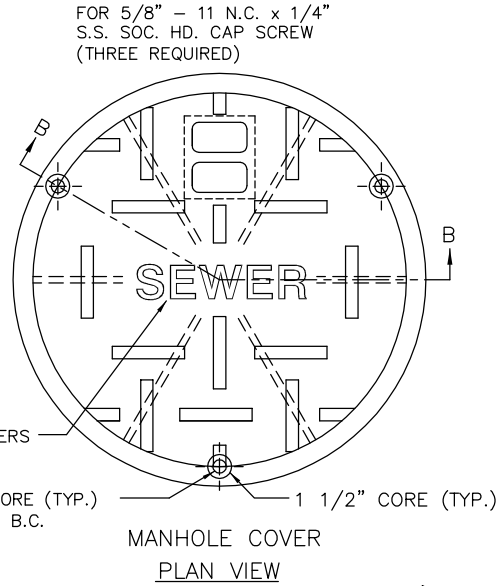

FOR 5/8" - 11 N.C. x 1/4" S.S. SOC. HD. CAP SCREW (THREE REQUIRED)

2" CAST LETTERS (SEE NOTE 2)

3/4" CORE (TYP.) ON 23" B.C.

MANHOLE COVER  
PLAN VIEW

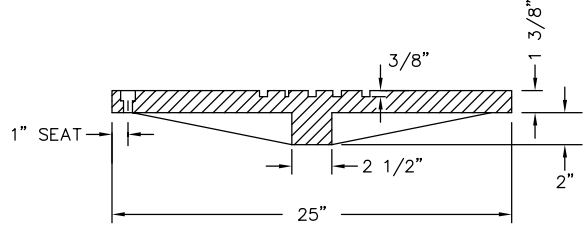

SECTION B-B

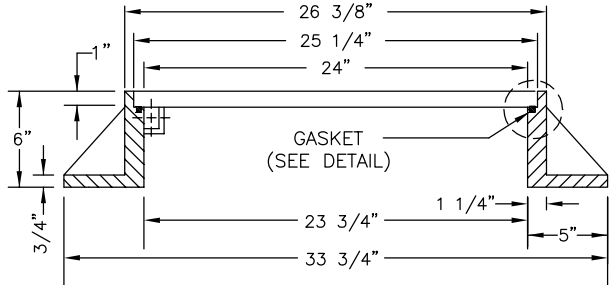

SECTION A-A

ALL MANHOLE COVERS SHALL BE MACHINED BELOW FRAME

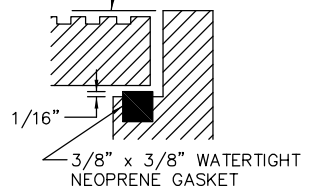

GASKET DETAIL

**NOTES**

1. FRAME MUST BE MACHINED TO FIT WATERTIGHT NEOPRENE GASKET.
2. MANHOLE COVER SHALL BE WATER TIGHT WITH NO HOLES, SHALL HAVE THE WORD(S) "SEWER", "WATER", OR "STORM SEWER" CAST IN COVER AND SHALL BE PROVIDED WITH AN INTEGRAL POCKET LIFT HANDLE.
3. FRAME AND MANHOLE COVER DIMENSIONS SHALL BE IN ACCORDANCE WITH OLYMPIC CONSTRUCTION CASTINGS NO. MH30A , OR AN APPROVED EQUAL. IF MAINLINE IS 20" OR GREATER, PROVIDE A MANHOLE WITH 30" MANHOLE COVER & FRAME.
4. FRAME AND MANHOLE COVER SHALL BE DUCTILE OR CAST IRON AND A TYPE THAT WILL NOT CREATE A HAZARD FOR BICYCLE TRAFFIC.
5. ALL CASTINGS SHALL BE MACHINED BELOW FRAME.
6. MANHOLE COVER AND FRAME SHALL MEET THE MINIMUM REQUIREMENTS OF STANDARD 206A.

SCALE: NTS	DATE: 12/2/96	CITY AND BOROUGH OF JUNEAU, ALASKA <b>LOCKING MANHOLE COVER &amp; FRAME</b>
DRAWN BY: DRW	CHECKED BY: STAFF	
APPROVED BY: <i>DRW</i>	REVISED: 8/14/2011	STANDARD 206B