

GASTINEAU CHANNEL

JUNEAU ISLAND

PND 14414

65% REVIEW SUBMITTAL

CITY & BOROUGH OF JUNEAU, ALASKA  
DOUGLAS HARBOR UPLANDS  
AND MOORAGE EXPANSION

GENERAL PROJECT LAYOUT

1.07

7 OF XX

REVISIONS

REV.	DATE	DESCRIPTION	DWN.	CKD.	APP.

**P** Paretrovich, Nottingham & Drage, Inc.

Engineering Consultants  
3220 Hospital Drive, Suite 200  
Juneau, Alaska 99801  
TEL: (907) 586-2093 FAX: (907) 586-2099

DESIGN: CRS  
CHECKED: TMS  
APPROVED: \_\_\_\_\_  
SCALE: SCALE IN FEET  
0 50 120

DATE: SEPT. 1, 2000

PND PROJECT NO. 99220.11 DWG. FILE: 1-07.DWG



DOCKS & HARBORS DEPARTMENT









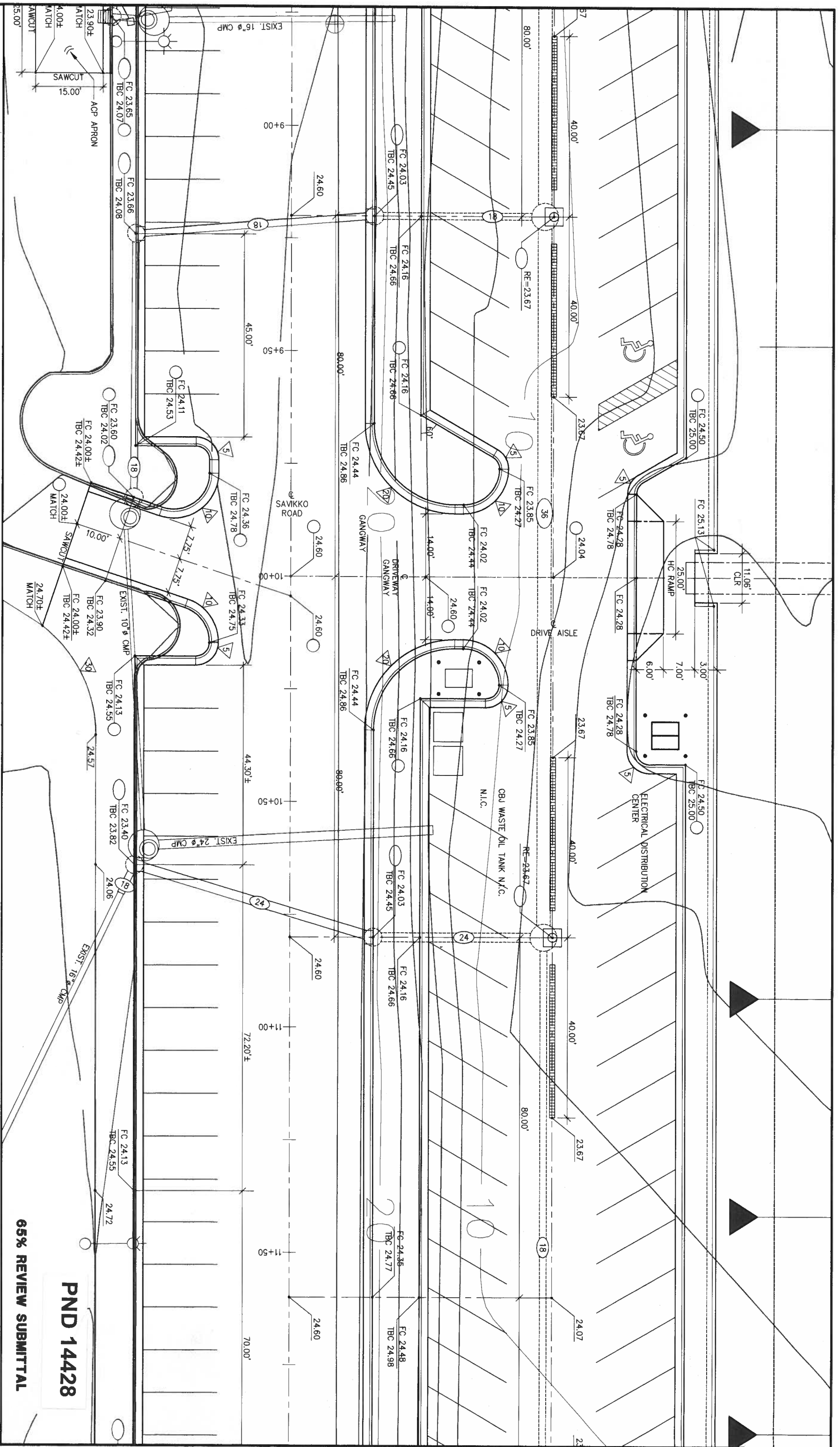

**65% REVIEW SUBMITTAL**

**PND 14428**



**REVISIONS**

REV.	DATE	DESCRIPTION	DWN.	CKD.	APP.

**P** **Peratrovich, Nottingham & Drage, Inc.**  
**Engineering Consultants**  
 3220 Hospital Drive, Suite 200  
 Juneau, Alaska 99801  
 TEL: (907) 586-2093 FAX: (907) 586-2099

DESIGN: JWG CHECKED: \_\_\_\_\_  
 DRAWN: JWG APPROVED: \_\_\_\_\_

SCALE: 0 10 20  
 SCALE IN FEET

DATE: SEPT., 2000

**CITY & BOROUGH OF JUNEAU, ALASKA**  
**DOUGLAS HARBOR UPLANDS**  
**AND MOORAGE EXPANSION**

**SHEET TITLE**  
**SAVIKKO ROAD AND PARKING AREA**  
**SITE GRADING AND DRAINAGE PLAN**  
 STA. 8+76 TO STA. 11+76

**PND PROJECT NO.** 99220.11 **DWG. FILE** 3-03JWG

**3.03**  
 SHEET 7 OF XX

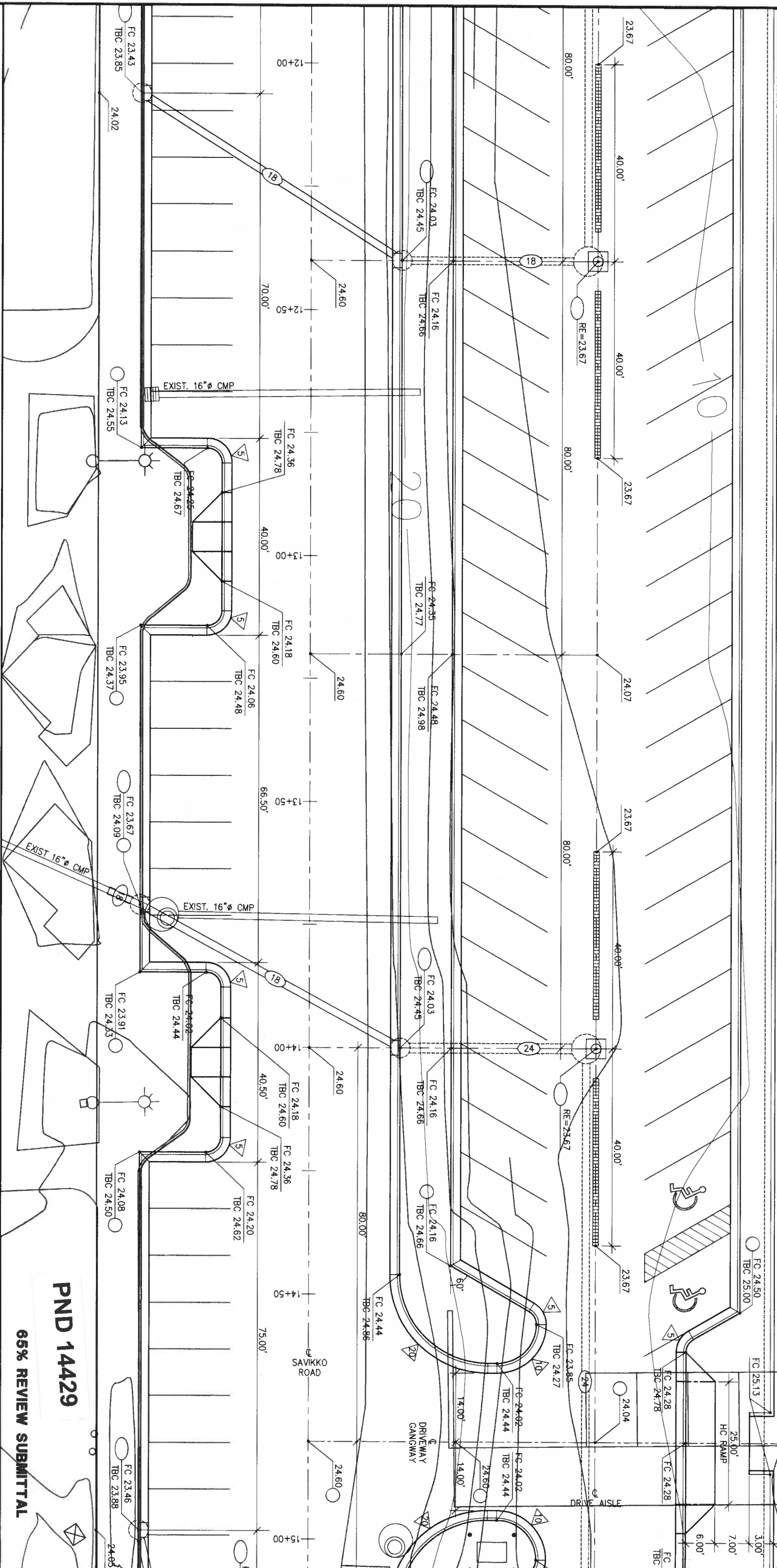
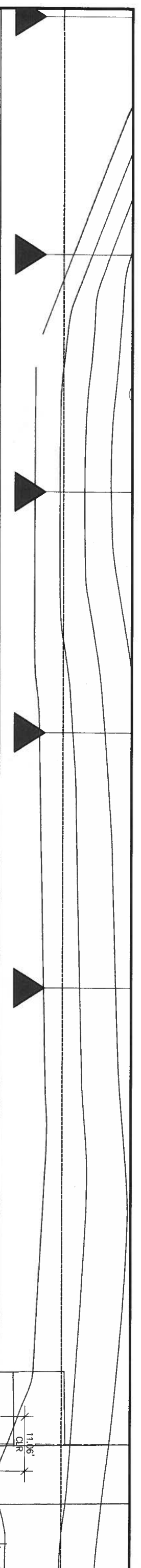

**PND 14429**  
**65% REVIEW SUBMITTAL**

**CITY/BOROUGH OF JUNEAU**  
**ALASKA'S CAPITAL CITY**  
**DOCKS & HARBORS DEPARTMENT**

**REVISIONS**

REV.	DATE	DESCRIPTION	DWN.	CKD.	APP.

**Peratrovich, Nottingham & Drage, Inc.**  
**Engineering Consultants**  
 3220 Hospital Drive, Suite 200  
 Juneau, Alaska 99801  
 TEL: (907) 586-2093 FAX: (907) 586-2099

DESIGN: JWG  
 DRAWN: JWG  
 CHECKED: \_\_\_\_\_  
 APPROVED: \_\_\_\_\_

SCALE: \_\_\_\_\_  
 SCALE IN FEET  
 0 10 20

DATE, SEPT., 2000

**CITY & BOROUGH OF JUNEAU, ALASKA**  
**DOUGLAS HARBOR UPLANDS**  
**AND MOORAGE EXPANSION**

**SHEET TITLE:**  
**SAVIKKO ROAD AND PARKING AREA**  
**SITE GRADING AND DRAINAGE PLAN**  
**STA. 11+75 TO 15+00**

**3.04**  
 SHEET  
 7 OF XX

PMU PROJECT NO. 99220.11 DWG. FILE: 3-04.DWG

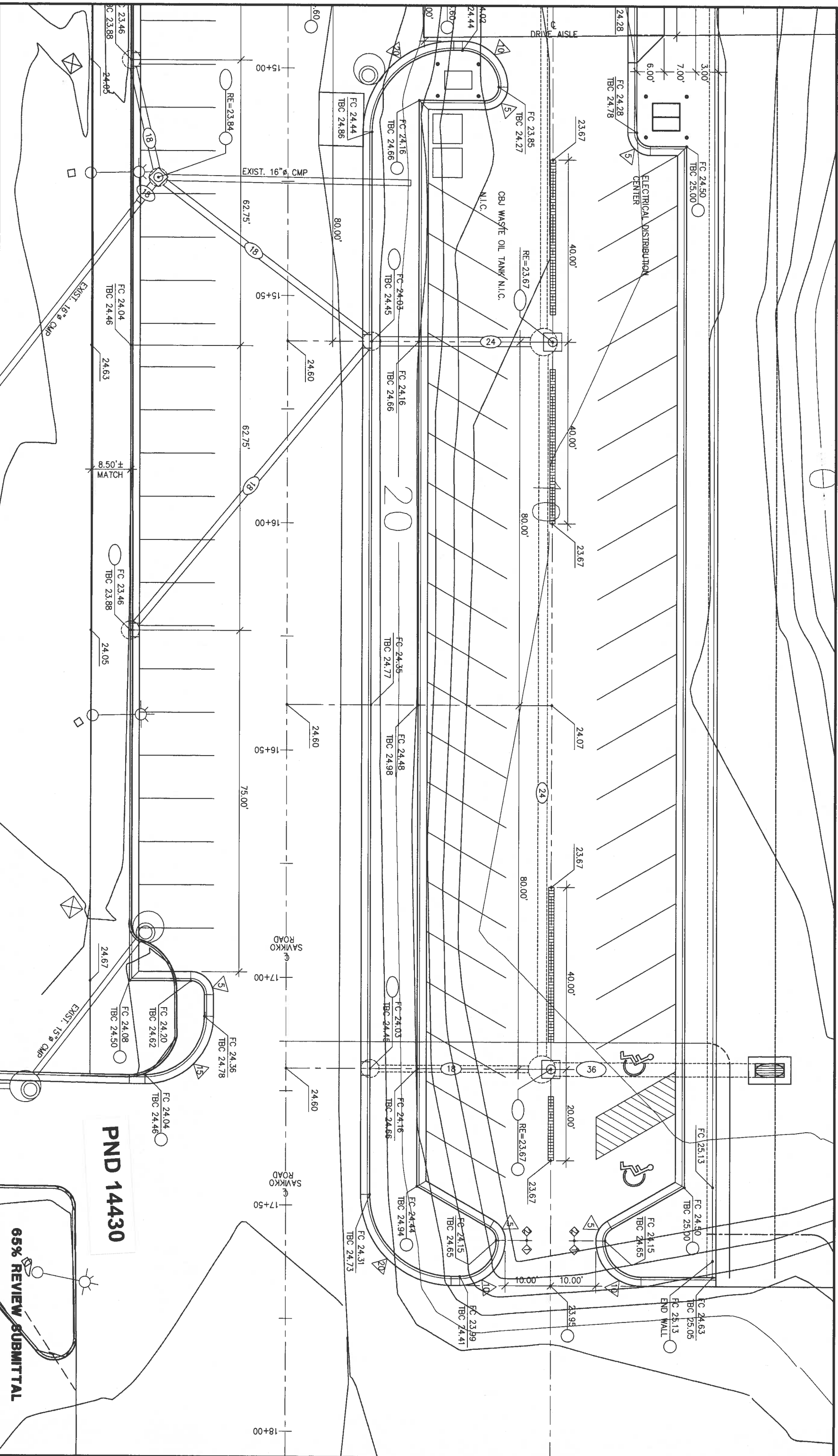

**CITY/BOROUGH OF JUNEAU**  
**ALASKA'S CAPITAL CITY**  
**DOCKS & HARBORS DEPARTMENT**

**REVISIONS**

REV.	DATE	DESCRIPTION	DWN.	CKD.	APP.

**Paratrovich, Nottingham & Drage, Inc.**  
**Engineering Consultants**  
 3220 Hospital Drive, Suite 200  
 Juneau, Alaska 99803  
 TEL: (907) 586-2093 FAX: (907) 586-2099

DESIGN: JWG  
 DRAWN: JWG  
 CHECKED: \_\_\_\_\_  
 APPROVED: \_\_\_\_\_

SCALE: \_\_\_\_\_  
 SCALE IN FEET  
 0 10 20

DATE, SEPT., 2000

**CITY & BOROUGH OF JUNEAU, ALASKA**  
**DOUGLAS HARBOR UPLANDS**  
**AND MOORAGE EXPANSION**

**65% REVIEW SUBMITTAL**

**PND 14430**

**SAVIKCO ROAD AND PARKING AREA**  
**SITE GRADING AND DRAINAGE PLAN**  
**STA. 16+00 TO 18+00**

**3.05**  
 SHEET 7 OF XX

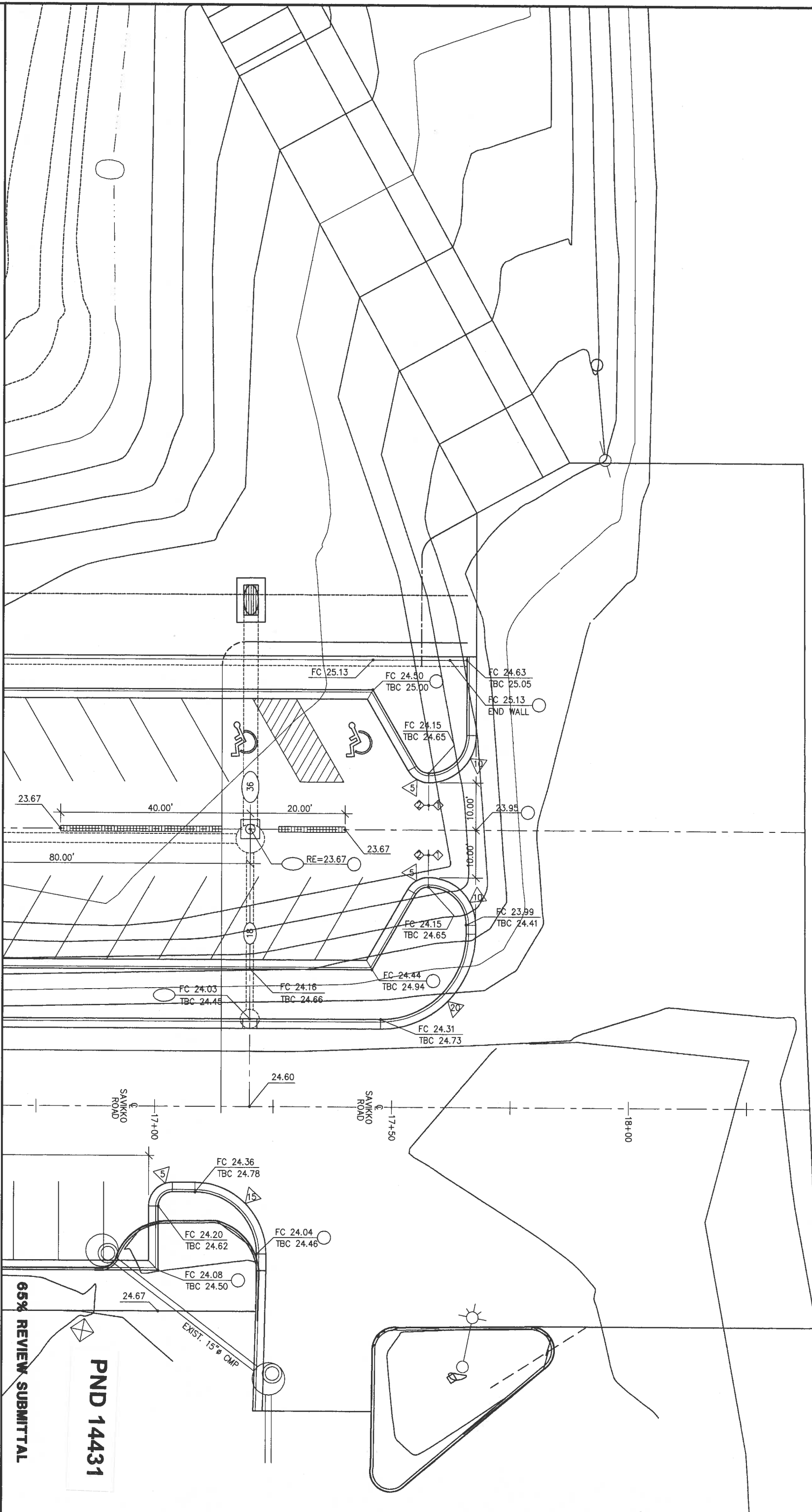

REVISIONS

REV.	DATE	DESCRIPTION	DWN.	CKD.	APP.

**P** Paratovich, Nottingham & Drage, Inc.  
 Engineering Consultants  
 3220 Hospital Drive, Suite 200  
 Juneau, Alaska 99801  
 TEL: (907) 586-2093 FAX: (907) 586-2099

DESIGN: JWG  
 DRAWN: JWG  
 CHECKED: \_\_\_\_\_  
 APPROVED: \_\_\_\_\_

SCALE: \_\_\_\_\_  
 SCALE IN FEET: \_\_\_\_\_  
 0 10 20

DATE: SEPT., 2000

CITY & BOROUGH OF JUNEAU, ALASKA  
 DOUGLAS HARBOR UPLANDS  
 AND MOORAGE EXPANSION

SHEET TITLE:  
 SAVIKKO ROAD AND PARKING AREA  
 SITE GRADING AND DRAINAGE PLAN  
 STA. 16+75 TO 19+00

PND PROJECT NO. 99220.11 DWG. FILE: 3-05.DWG

**3.06**  
 SHEET 7 OF XX

65% REVIEW SUBMITTAL  
**PND 14431**