

# Taku Dock to Marine Park Urban Design Plan



# Docks and Harbors Board Consensus on Four Options

- Hybrid of option 3 and 4
- Inviting and open public space
- Centralized pavilion/shelter
- 150' floating dock
- USS Juneau memorial plaza
- Playground
- B permit in parking garage or access through garage using round-about
- B permit near Pier 49: second choice
- New visitor center and restrooms on north side of parking garage
- Improve stairs and ramp access by library
- Deck over open areas
- Create year-round waterfront destination facility
- Provide service access to facilities and Seawalk
- Provide food cart/truck areas

# Option Three

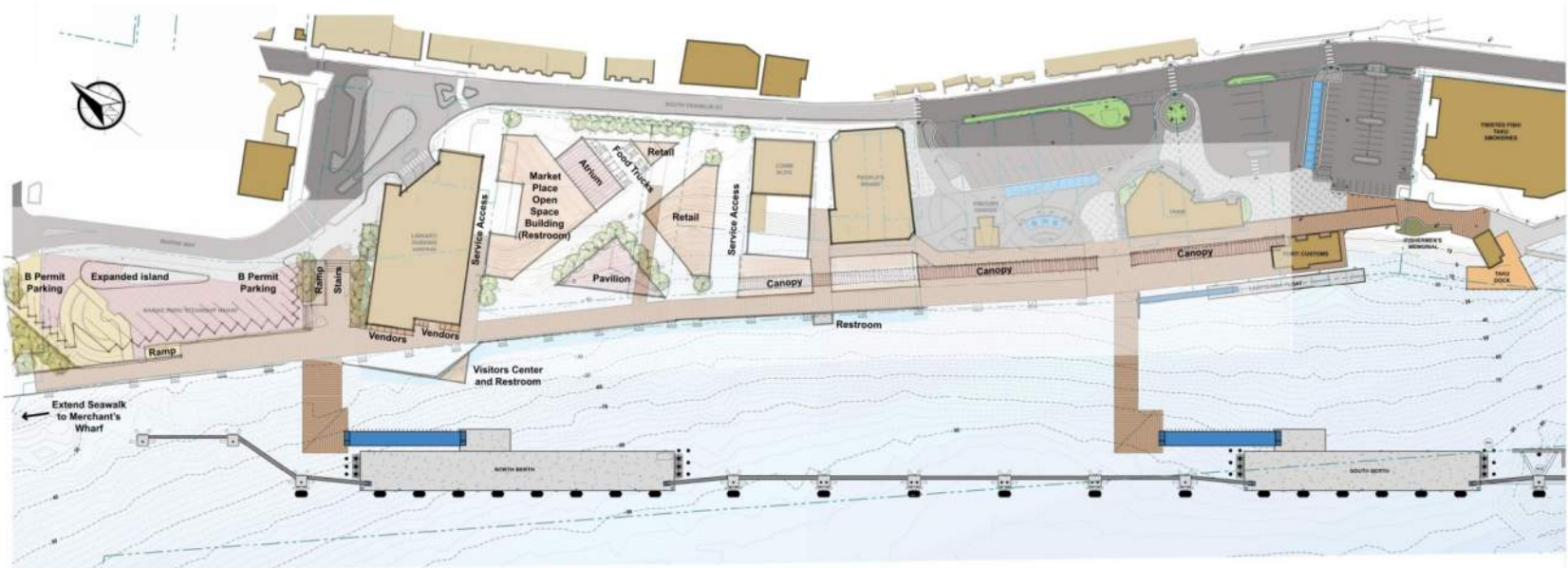

Taku Dock to Marine Park Urban Design Plan  
Option 3



# Option Three

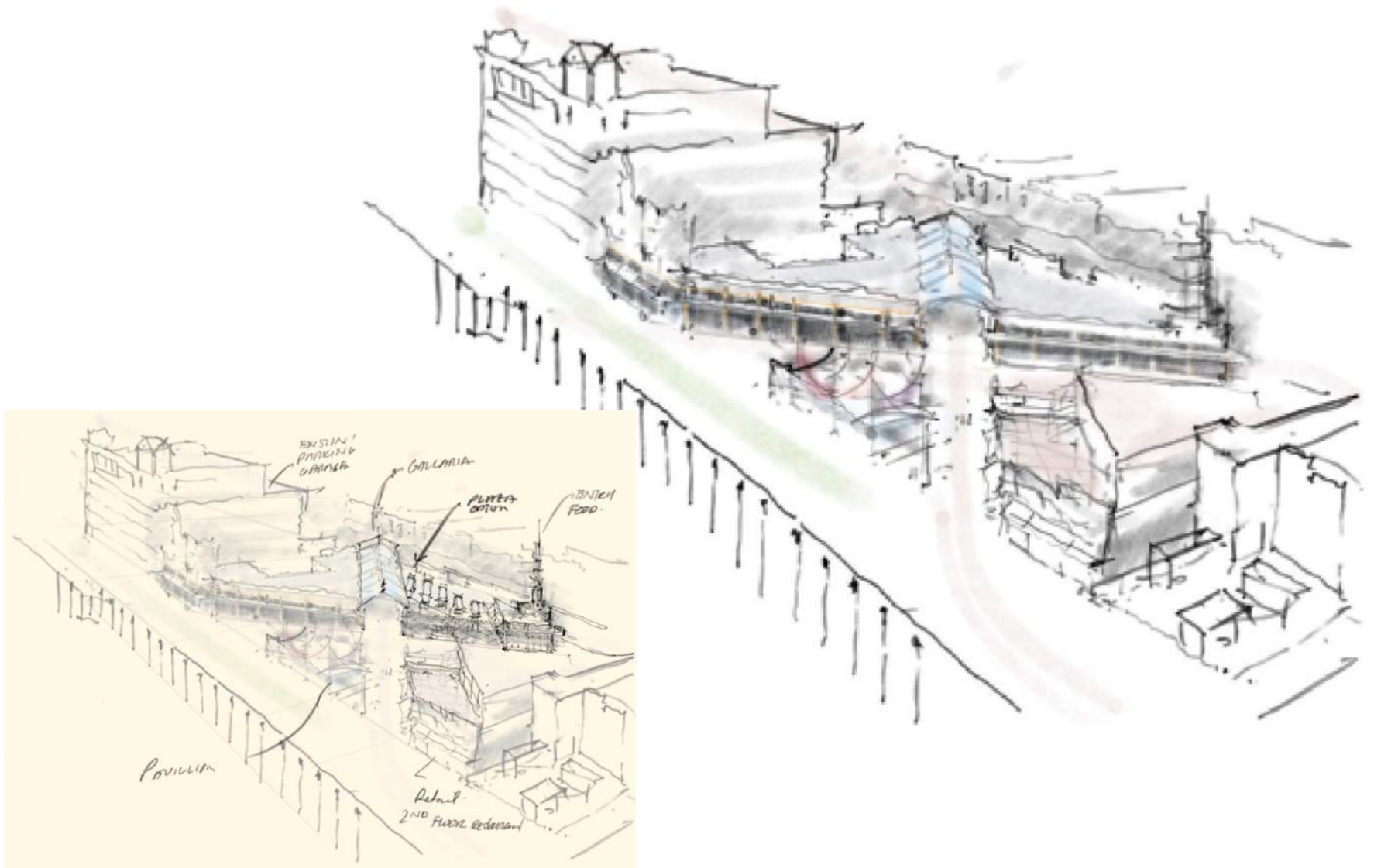

# Option Four

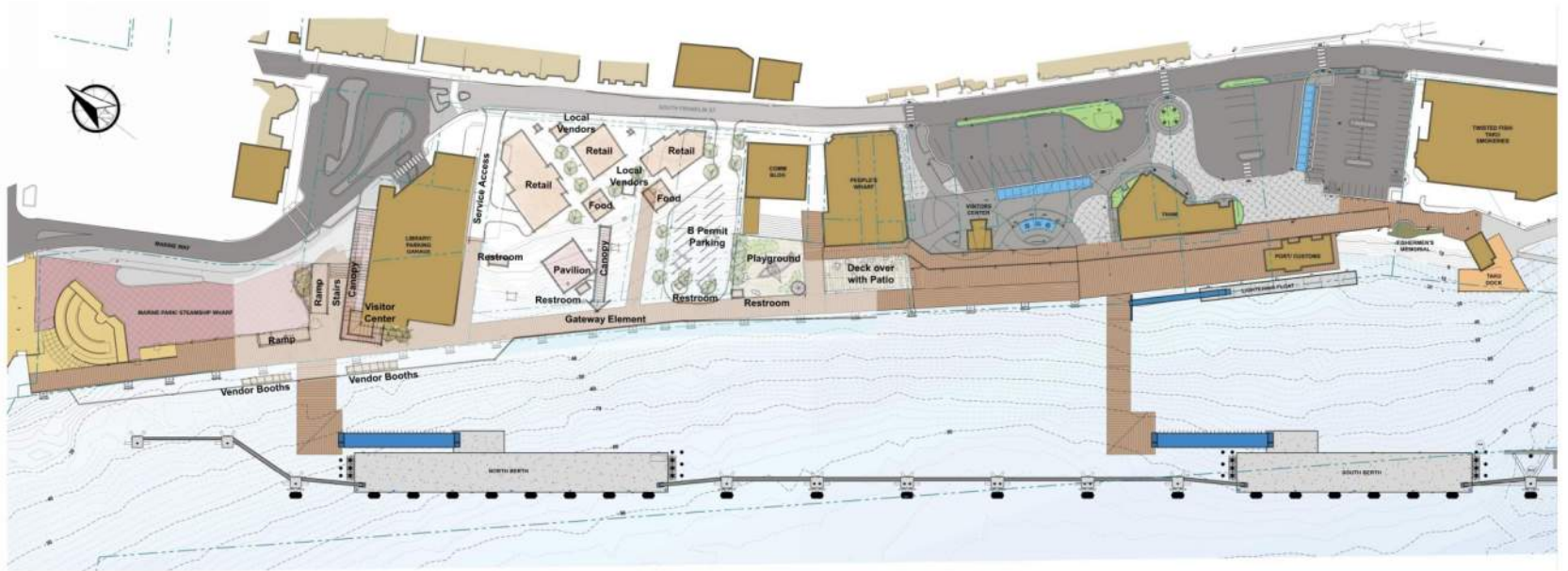

Taku Dock to Marine Park Urban Design Plan  
Option 4



# Option Four



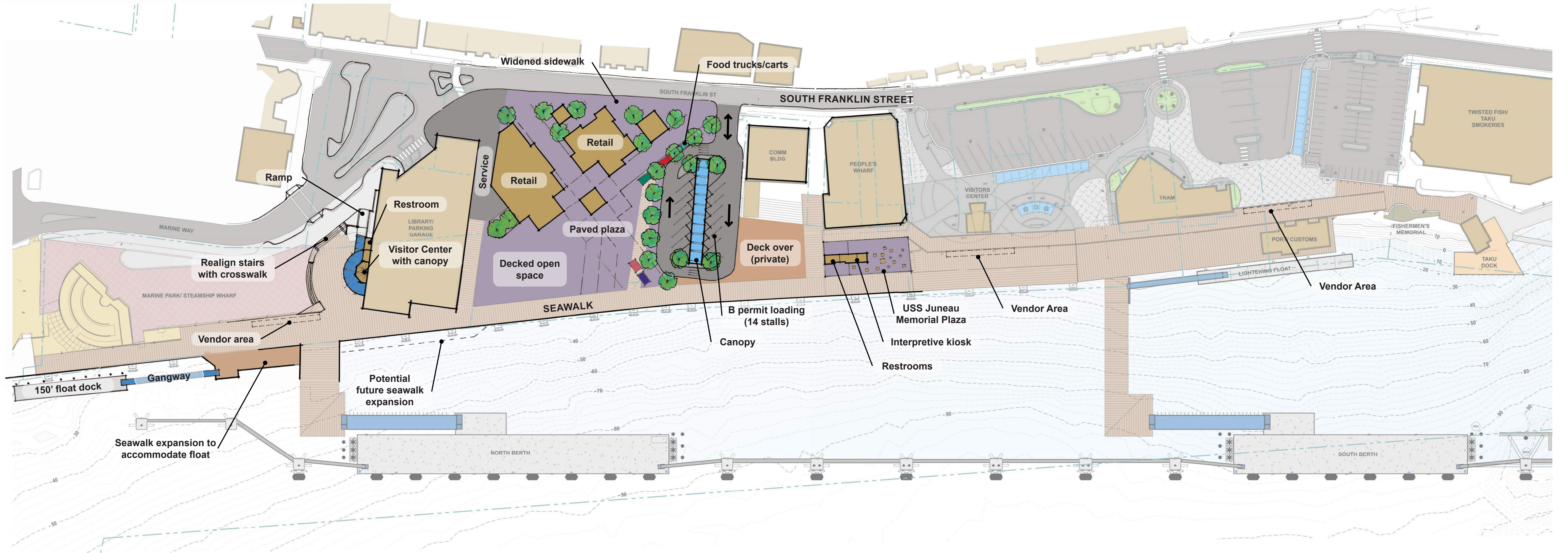

# Taku Dock to Marine Park Urban Design Plan

Preferred Master Plan - Phase I

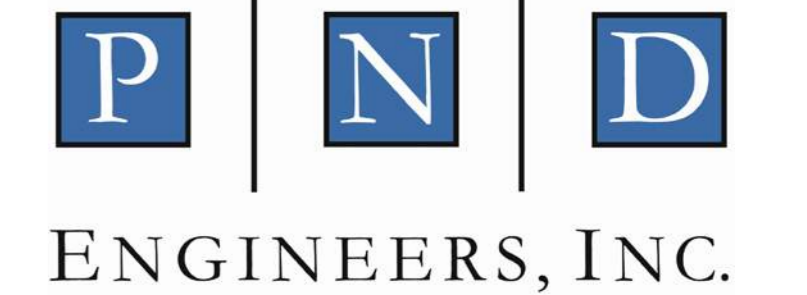

0 50 100 FT



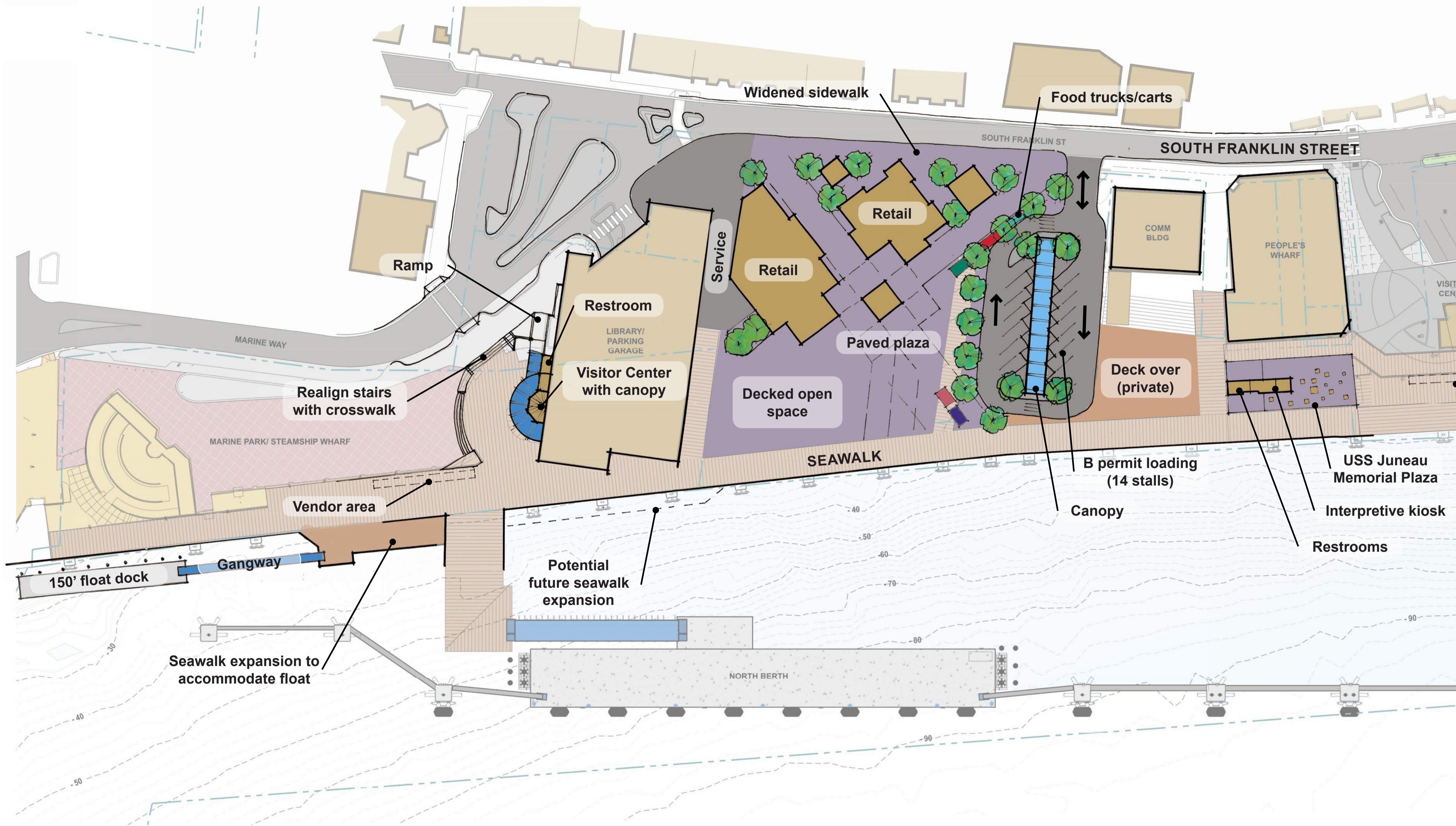

# Taku Dock to Marine Park Urban Design Plan

Preferred Master Plan - Phase I



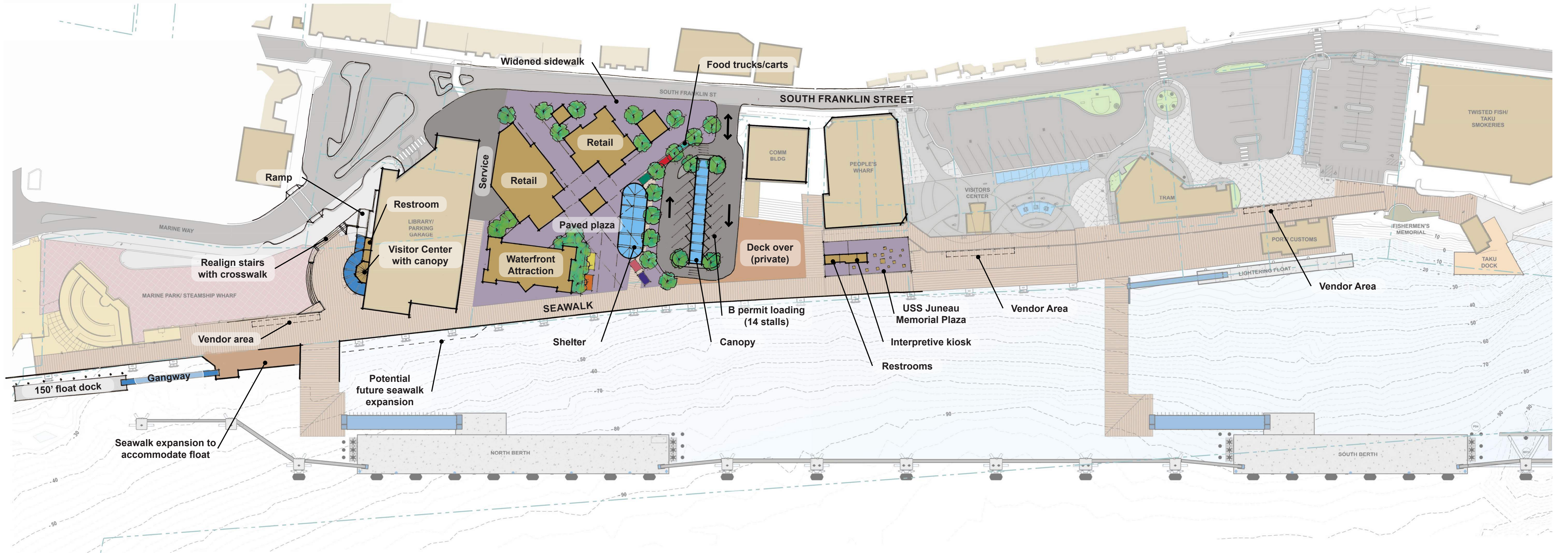

# Taku Dock to Marine Park Urban Design Plan

Preferred Master Plan - Phase II

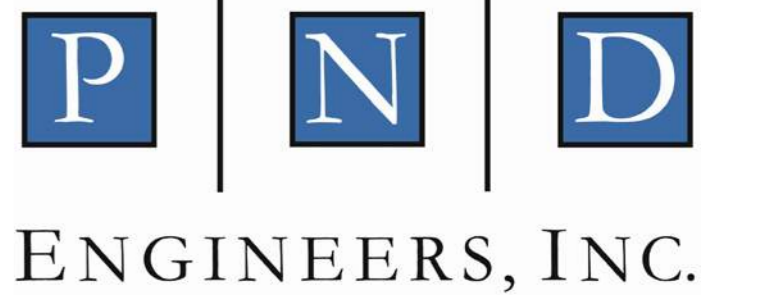

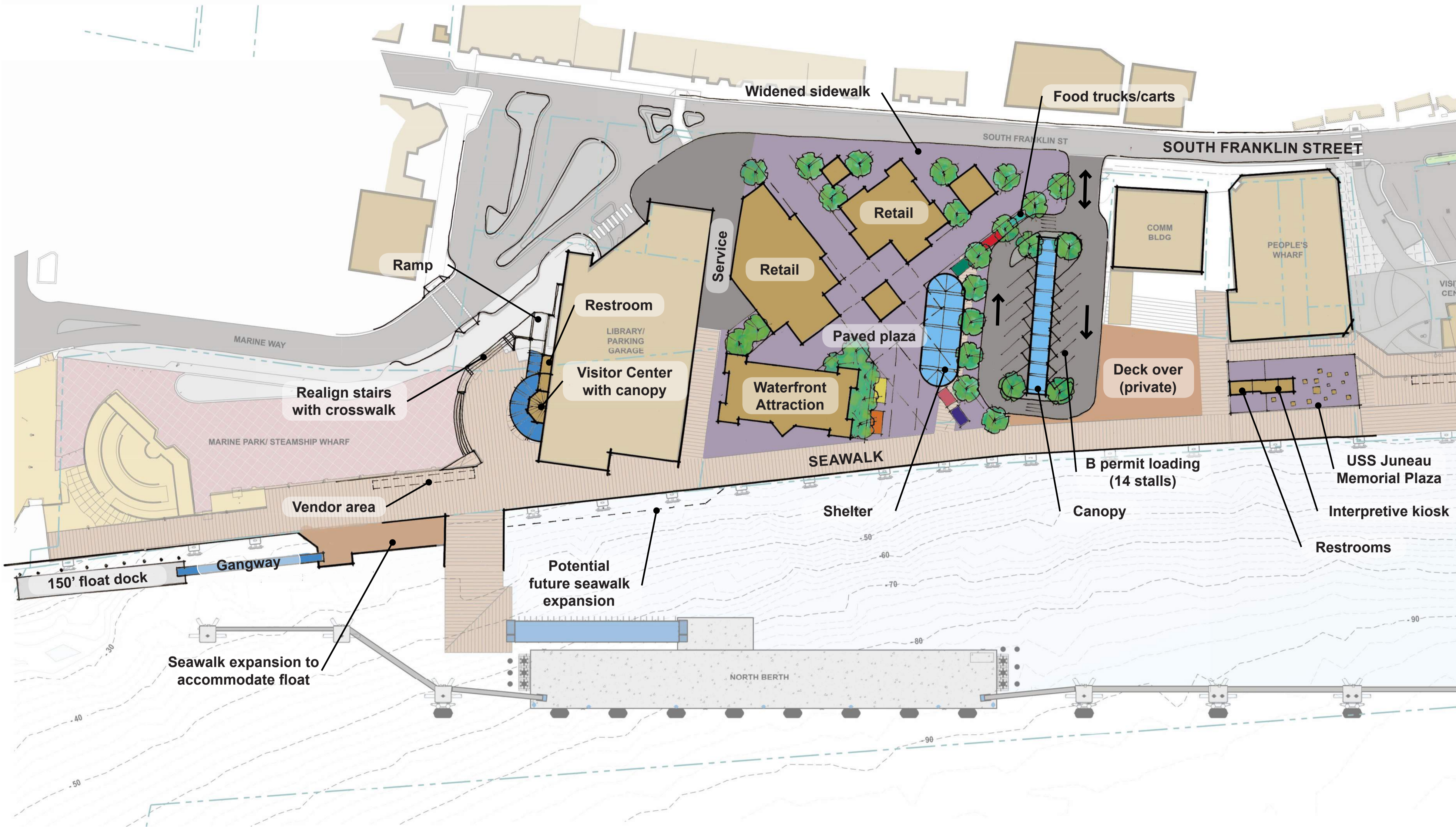

# Taku Dock to Marine Park Urban Design Plan

Preferred Master Plan - Phase II

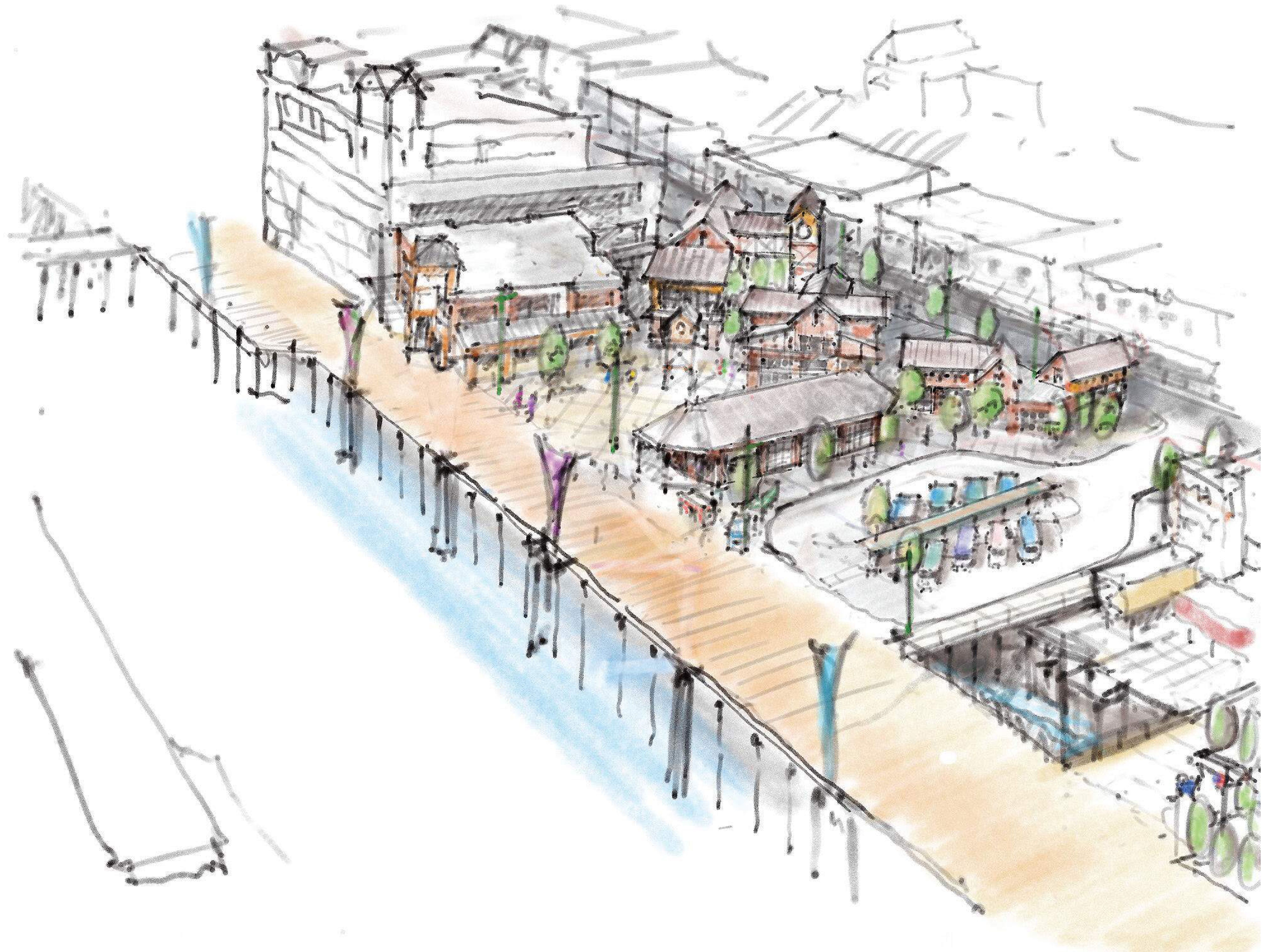

# Taku Dock to Marine Park Urban Design Plan

Preferred Master Plan - Sketch

