

ATTACHMENT #2



MEMORANDUM

TO: Patty Wahto
Airport Manager

FROM: Mike Greene
JNU Airport Project Manager

RE: Engineering Projects Monthly Report

DATE: April 4, 2019

Project specific summaries of project status and activity are presented below.

Runway Safety Area (RSA) Expansion Phase IIC: The project Contractor (SECON) has remobilized and has resumed work operations in the Northeast Development Area (NEDA). Crews have completed work on the installation of the pre-cast bases for the 36 new aircraft tie-downs, and continue to place, compact and final grade the D-1 base course in the new aircraft tie-down area. Crews are also working to complete the installation of the structural section between the new tie-down area and Taxiway E1 and to remove the obsolete edge lighting on the east side of Taxiway E1. This will allow aircraft to taxi directly off of Taxiway E1 into the new tie-down area. A NOTAM (Notice to Airmen) is currently in place for this work, and an updated NOTAM will be put in place to address temporary edge lighting outages as the old light cans are being isolated and removed.

SECON has re-started their temporary asphalt batch plant and plan to start work on the installation of the 10-inches of asphalt paving within the large NEDA tie-down area on Thursday, May 2. SECON has also returned to the Northwest Development Area (NWDA) to resume work operations. Work to replace Gate E has begun, and JNU will position a gate guard at the temporary gate and detour on a 24/7 basis until the new gate is installed, tested and accepted. The new Gate is scheduled to be complete on Friday, April 26.

SECON will also be resuming work on the removal of the last of the asphalt paving within the work limits and on the removal of the aircraft tie-downs located on the south side of the Block I hangars. This work will begin this week, with work scheduled through to completion on the third week of June.

SECON will also be starting work on the installation of the trench drain and on the replacement asphalt paving along the south side of the Block M hangars during the first week of June. JNU has issued a notification to hangar tenants and to aircraft owners advising them of this upcoming work.

The project remains on track for all work to be Substantially Complete on or before July 30, 2019.

ATTACHMENT #2

Recent modifications to the Runway Safety Area “RSA” Phase 2C scope of work include the following:

A. **RFP No. 008 – Drainage Improvements in Work Area 4B:** The work associated with this RFP will extend the trench drain that is to be installed per the contract so that it extends along the entire south side of the Block M hangars. This drainage improvement work was deemed Airport Improvement Program (AIP) eligible by the Federal Aviation Administration (FAA). Work will also include the replacement of all of the asphalt paving located between the hangar and the trench drain.

B. **RFP No. 009 –NWDA Electrical Revisions:** The work associated with this RFP will revise the electrical feed for the new sump pump at the NWDA aircraft wash-down, and introduce a series of two-inch direct bury conduit runs below the new Northwest (NW) Taxilanes 1, 2 and 3 to facilitate future site lighting development within the NWDA.

C. JNU has also contracted with AEL&P to install a series of four-inch direct bury conduit runs below NW Taxilanes 1, 2 and 3 to facilitate future power and telecommunication development within the NWDA.

D. **RFP No. 011 – NEDA Work Reduction:** The work associated with this RFP eliminates the removal of the existing temporary access road that runs along the south side of the NEDA from the current contract with SECON. This road will be needed to facilitate the completion of the upcoming Taxiway A-D1-E project. This work reduction will eliminate the installation of nearly 15,000 cubic yards of topsoil.

As the engineers of record, DOWL continues to provide construction administration and inspection services for this work.

Float Pond Improvements: The water level within the float plane pond reached the 15.5-foot mark in mid-March, and the pond was re-opened to float plane operations on the afternoon of Friday, March 29. The construction and backfilling around the new cast-in-place concrete valve vault has been completed, and the Contractor, Southeast Earthmovers, has completed work on rehabilitating the flapper gate assembly, on the restoration of the east bank of the Emergency Vehicle Access Road (EVAR) and on the re-installation of the permanent security fencing. Work which remains includes the placement and final grading of the D-1 base course, asphalt paving, installation of the 36-inch valve and actuator, and electrical start-up and testing.

The Substantial Completion inspection occurred on March 29, 2019 and a project punch list has been issued to Southeast Earthmovers.

As the engineers of record, PND Engineers continues to provide construction administration and inspection services for this work.

ATTACHMENT #2

Taxiway A Rehabilitation, Taxiway D-1 Relocation and Taxiway E Realignment:

PDC Engineers has released the 95% set of design documents for internal review by the design team and for peer review. JNU is conducting a simultaneous over-the-shoulder review of these documents in an attempt to speed up the overall review process. PDC's current document delivery schedule has the design documents reaching the 100% complete stage at the end of June with delivery to JNU on July 1.

The 95% Construction Safety and Phasing Plan (CSPP) has been reviewed and approved by the FAA.

PDC Engineers continues to coordinate directly with JNU and with the FAA on the development of the technical specifications. JNU is currently working on the development of the Division 0 and Division 1 front end specifications.

JNU is currently working with City & Borough of Juneau (CBJ) Engineering on the development of the Request for Proposals (RFP) language that will be used to obtain proposals from qualified consultants to provide limited Contract Administration and Inspection (CA&I) services during the construction phase of the project.

The goal now is to release this project for competitive bid in July 2019.

Ward Air Hangar Expansion: JNU has had no recent involvement in the development/review of the conceptual design for the new hangar that will be located on Lots 15, 16, 17 and 18 of Block K.

Fed-Ex Expansion: JNU has submitted an environmental Categorical Exclusion request to the FAA for this project. The FAA has not yet responded to this request. R&L Leasing, Inc. has submitted a tenant improvement request, which remains under review.

Lavatory Waste Dump Site: There has been no advancement on the development of a schematic design of the upgraded lavatory waste dump site.

Parking Lot Repairs: This last winter was hard on the asphalt paving in the various public parking lots, as well as on the paving within the rental car parking lot. Existing pot-holes have gotten bigger and new pot-holes have appeared. Many areas within these asphalt paving installations are exhibiting "alligating" which is indicative of subbase settlement and a precursor to the failure of the asphalt paving. In addition to asphalt paving repairs, the short-term, long-term and staff areas of the large parking lot are in need of general repairs. These repairs include the removal and replacement of large portions of the concrete curbs and gutters, upgrades to the storm water collection and drainage system, upgrades to the exterior lighting and the installation of new signage and striping. JNU has general parking lot repairs on its Capital Improvement Plan but does not currently have any money to address any of these repairs.

ATTACHMENT #2

APRIL 1, 2019 - NOTICE OF ON-GOING CONSTRUCTION OPERATIONS:

The following represents the most current schedule for the construction work that is to be completed this spring by SECON-Arete Construction-Ever Electric within the NWDA as part of the continuation of the RSA Phase2C Re-Bid project.

WORK AREA 1 – Development of NW Taxilanes 1, 2 and 3 and Small Aircraft Washdown:

Week of April 8 to April 13:

Wednesday April 10: Set up temporary barricades, put SWPP measures in place, resume asphalt removal operations.

Friday April 13: Start electrical demolition associated with the development of the new taxilanes.

Tuesday April 30: Start work on the placement of sub-base material.

Wednesday May 1: Start work on the placement of D-1 base course.

Wednesday May 22: Start work on asphalt paving.

Thursday May 23: Complete work on asphalt paving.

NOTE: SEE ATTACHED NWDA DEMOLITION PLAN. The asphalt removal and replacement work will impact some of the Block G, Block H and Block I hangar tenants. Access into and out of hangars will be limited or not possible until the work has been completed. The direct taxilane (NW Taxilane 1) to Taxiway B1 will remain closed. Aircraft must continue to use the taxilane by Aero Services to access Taxiway B2.

WORK AREA 2 – Removal of Recycled Asphalt Product (RAP) and Installation of Aircraft Tie-Downs and Asphalt Paving:

Wednesday April 10: Set up temporary barricades, put SWPP measures in place, resume asphalt removal operations.

Monday April 22: Start work on the removal of the existing aircraft tie-downs within the apron on the south side of the Block I hangars.

Monday April 22: Start work on the installation of drainage culvert at the west end of the Block I hangars.

Monday June 10: Start work on the installation of the trench drain on the south side of the Block I hangars.

Saturday June 29: Start work on the placement of sub-base material.

Monday July 1: Start work on the placement of D-1 base course.

Tuesday July 2: Start work on asphalt paving.

Wednesday July 3: Complete work on asphalt paving.

Saturday July 6: Start work on installation of concrete collars on new tie-downs.

Friday July 12: Paint all new markings.

NOTE: SEE ATTACHED NWDA DEMOLITION PLAN. The asphalt removal and replacement work, as well as the drainage improvement work will impact the south facing Block I hangar tenants. Access into and out of hangars will be limited or not possible until the work has been completed. The direct taxilane (NW Taxilane 1) to Taxiway B1 will remain closed. Aircraft must continue to use the taxilane by Aero Services to access Taxiway B2. The use of the apron and aircraft tie-downs on the south side of the Block I hangars will also be affected by the tie-down replacement work and by the asphalt paving work.

ATTACHMENT #2

WORK AREA 3 – Replacement of Gate E:

Work has begun on the construction of a temporary detour that will be used while Gate E is being removed and replaced.

Monday April 15: Start of gate replacement work.

Monday April 22: Gate E work completed.

NOTE: GATE E access and egress will be affected by this work. All traffic will be routed through the detour and temporary gate. The temporary gate will be open and manned with a gate guard between the hours of 7:00 am and 10:00 pm until the end of the day on Sunday April 21. The temporary gate will be closed and locked between the hours of 10:00 pm and 7:00 am during these 7 days. Emergency access or egress may be obtained by coordinating with CBJ Police at 586-0899.

In all work areas, SECON will attempt to maintain the schedules as outlined above and will attempt to work with tenants to maintain access into their hangars. It must be understood that SECON has a job to complete and that they may not be able to comply with every request by tenants to facilitate access into or out of hangars. Tenants are urged to work out alternative aircraft storage and/or tie-down locations as may be needed.

For questions or concerns on the overall RSA Phase 2C project, please contact;

Mike Greene – JNU Airport Project Manager

Ph: 907-586-0453

Cell: 907-321-3804

Mike.Greene@jnuairport.com

For questions or concerns on day-to-day construction operations, hangar access or work scheduling, please contact;

Maureen Hansen – Project Superintendent – SECON

Ph: 907-780-5154

Cell: 907-723-8312

mhansen@colaska.com

ATTACHMENT #2

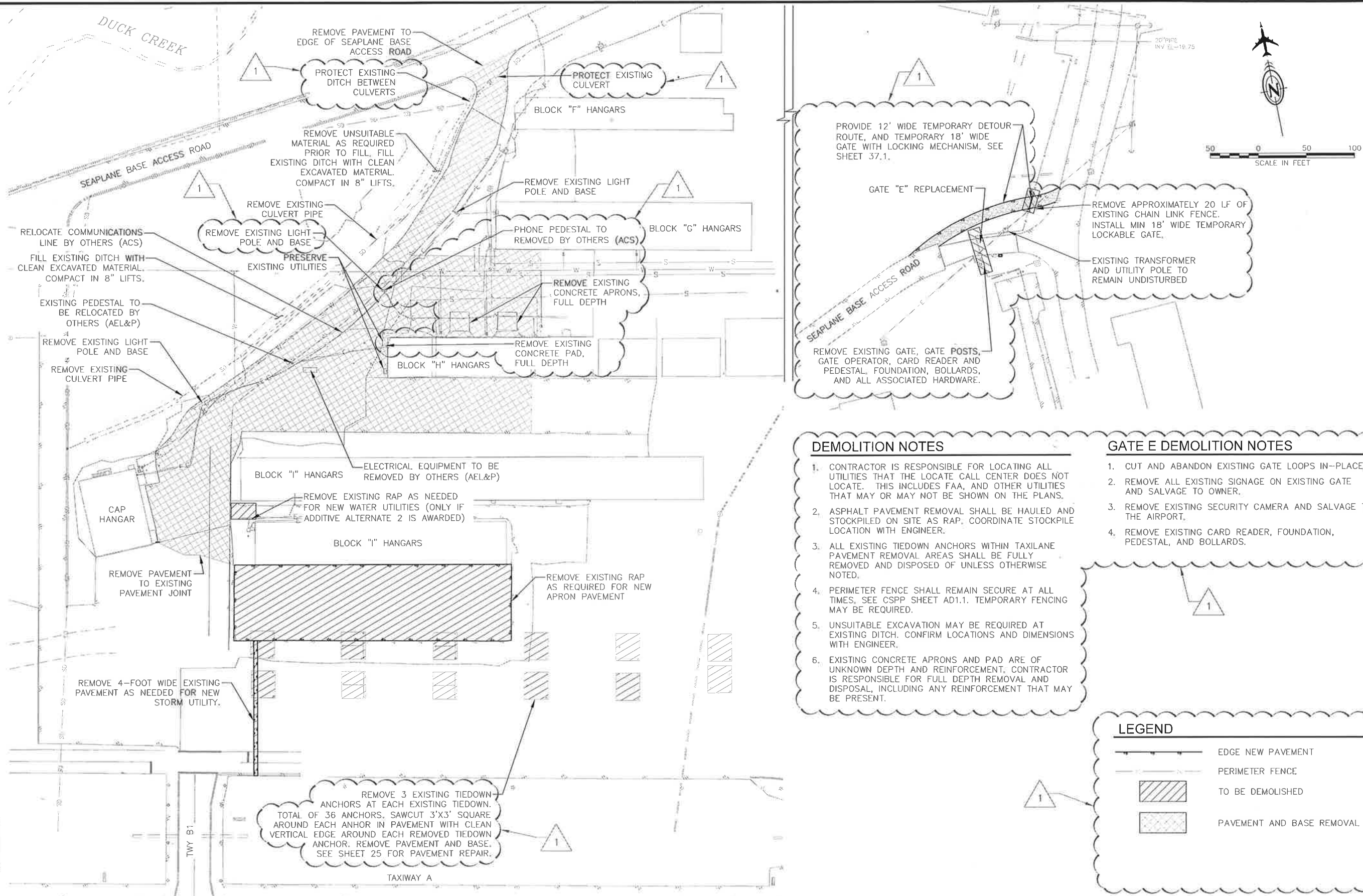

DEMOLITION NOTES

1. CONTRACTOR IS RESPONSIBLE FOR LOCATING ALL UTILITIES THAT THE LOCATE CALL CENTER DOES NOT LOCATE. THIS INCLUDES FAA, AND OTHER UTILITIES THAT MAY OR MAY NOT BE SHOWN ON THE PLANS.
2. ASPHALT PAVEMENT REMOVAL SHALL BE HAULED AND STOCKPILED ON SITE AS RAP. COORDINATE STOCKPILE LOCATION WITH ENGINEER.
3. ALL EXISTING TIEDOWN ANCHORS WITHIN TAXILANE PAVEMENT REMOVAL AREAS SHALL BE FULLY REMOVED AND DISPOSED OF UNLESS OTHERWISE NOTED.
4. PERIMETER FENCE SHALL REMAIN SECURE AT ALL TIMES. SEE CSPP SHEET AD1.1. TEMPORARY FENCING MAY BE REQUIRED.
5. UNSUITABLE EXCAVATION MAY BE REQUIRED AT EXISTING DITCH. CONFIRM LOCATIONS AND DIMENSIONS WITH ENGINEER.
6. EXISTING CONCRETE APRONS AND PAD ARE OF UNKNOWN DEPTH AND REINFORCEMENT. CONTRACTOR IS RESPONSIBLE FOR FULL DEPTH REMOVAL AND DISPOSAL, INCLUDING ANY REINFORCEMENT THAT MAY BE PRESENT.

GATE E DEMOLITION NOTES

1. CUT AND ABANDON EXISTING GATE LOOPS IN-PLACE.
2. REMOVE ALL EXISTING SIGNAGE ON EXISTING GATE AND SALVAGE TO OWNER.
3. REMOVE EXISTING SECURITY CAMERA AND SALVAGE TO THE AIRPORT.
4. REMOVE EXISTING CARD READER, FOUNDATION, PEDESTAL, AND BOLLARDS.

LEGEND

- EDGE NEW PAVEMENT
- PERIMETER FENCE
- TO BE DEMOLISHED
- PAVEMENT AND BASE REMOVAL

**BEFORE YOU DIG
CALL FOR FREE
UNDERGROUND
LOCATION**

Locate Call Center of Alaska
Anchorage Area 278-3121
Statewide 800-478-3121
who will notify subscribed utilities only.
Other utilities need to be contacted individually.

WH	7/23/18	ADDENDUM NO. 3	SCALE		PLAN PREPARED BY: DOWL #AECL848 5368 Commercial Boulevard Juneau, Alaska 99801 907-780-3533		JUNEAU INTERNATIONAL AIRPORT JUNEAU, ALASKA RSA IMPROVEMENTS - PHASE 2C CONTRACT NO. BE18-213 / AIP NO. 3-02-0103-073-2017 NWDA DEMOLITION PLAN	SHEET
			HORZ. SCALE					8.1
			VERT. SEE GRAPHIC					
BY	DATE	REVISIONS	W.O. NO. 1123.62033.02	FILE NO.	DATE 9/6/18			46

ATTACHMENT #2

WORK AREA 1 NOTES

1. THIS WORK AREA IS WITHIN THE AIRCRAFT OPERATIONS AREA, AND INSIDE EXISTING OPERATIONAL AREAS. THE FOLLOWING WORK IS INCLUDED IN WORK AREA 4:
 - A. REMOVE PAVEMENT AND PERFORM DEMOLITION WORK.
 - B. INSTALL NEW STORM DRAIN UTILITIES.
 - C. INSTALL NEW WATER AND SEWER UTILITIES (ADD ALT 1).
 - D. CONSTRUCT AND PAVE NWDA TAXILANES.
 - E. INSTALL RAP.
2. BEFORE BEGINNING WORK IN THIS AREA, THE CONTRACTOR SHALL COMMUNICATE ALL CONSTRUCTION WORK NEEDED WITH THE PROJECT ENGINEER AND ASCO A MINIMUM OF 48 HOURS IN ADVANCE.
3. DURING CONSTRUCTION, THE CONTRACTOR SHALL NOTIFY THE PROJECT ENGINEER AND ASCO OF CHANGED CONDITIONS THAT MIGHT CHANGE A NOTAM. ALL CHANGES TO THE WORK SCHEDULE SHALL BE COMMUNICATED WITH THE PROJECT ENGINEER AND ASCO.
4. THE CONTRACTOR SHALL GIVE THE PROJECT ENGINEER AND ASCO A MINIMUM 5 DAY NOTICE PRIOR TO BEGINNING WORK IN FRONT OF EXISTING HANGAR DOORS.
5. ONCE THE CONTRACTOR HAS COMPLETED ALL TASKS WITHIN THIS WORK AREA, ALL TEMPORARY BARRIERS AND OTHER EQUIPMENT SHALL BE REMOVED FROM THE AREA. ONCE COMPLETED, THE CONTRACTOR SHALL NOTIFY THE PROJECT ENGINEER AND ASCO.

WORK AREA 2 NOTES

1. THIS WORK AREA IS WITHIN THE AIRCRAFT OPERATIONS AREA, AND INSIDE EXISTING OPERATIONAL AREAS. THE FOLLOWING WORK IS INCLUDED IN WORK AREA 2:
 - A. REMOVE PAVEMENT AND PERFORM DEMOLITION WORK.
 - B. CONSTRUCT APRON PAVEMENT.
 - C. APPLY PAVEMENT MARKINGS.
2. BEFORE BEGINNING WORK IN THIS AREA, THE CONTRACTOR SHALL COMMUNICATE ALL CONSTRUCTION WORK NEEDED WITH THE PROJECT ENGINEER AND ASCO A MINIMUM OF 48 HOURS IN ADVANCE.
3. DURING CONSTRUCTION, THE CONTRACTOR SHALL NOTIFY THE PROJECT ENGINEER AND ASCO OF CHANGED CONDITIONS THAT MIGHT CHANGE A NOTAM. ALL CHANGES TO THE WORK SCHEDULE SHALL BE COMMUNICATED WITH THE PROJECT ENGINEER AND ASCO.
4. THE CONTRACTOR SHALL GIVE THE PROJECT ENGINEER AND ASCO A MINIMUM 5 DAY NOTICE PRIOR TO BEGINNING WORK IN FRONT OF EXISTING HANGAR DOORS.
5. ONCE THE CONTRACTOR HAS COMPLETED ALL TASKS WITHIN THIS WORK AREA, ALL TEMPORARY BARRIERS AND OTHER EQUIPMENT SHALL BE REMOVED FROM THE AREA. ONCE COMPLETED, THE CONTRACTOR SHALL NOTIFY THE PROJECT ENGINEER AND ASCO.

LEGEND

- x—x—x— TEMPORARY FENCING
- HAZARD MARKING BARRIER
- SD— PROPOSED STORM DRAIN UTILITY
- TSA— TAXIWAY SAFETY AREA
- TOFA— TAXIWAY OBJECT FREE AREA
- HAUL ROUTE
- AIRCRAFT OPERATIONS AREA BOUNDARY
- WORK AREA 1 BOUNDARY
- WORK AREA 2 BOUNDARY
- WORK AREA 3 BOUNDARY
- TEMPORARY RAP ROAD
- TEMPORARY STOCKPILE BOUNDARY

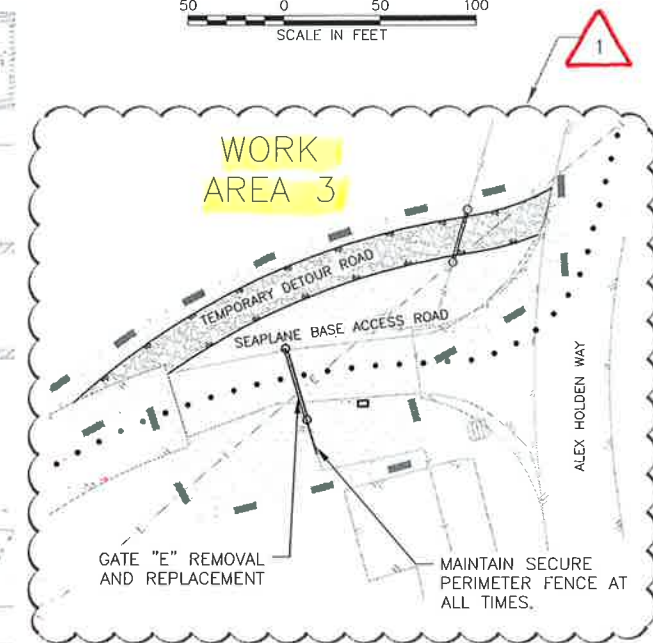
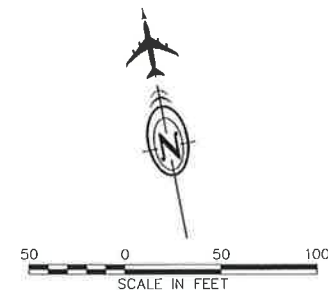
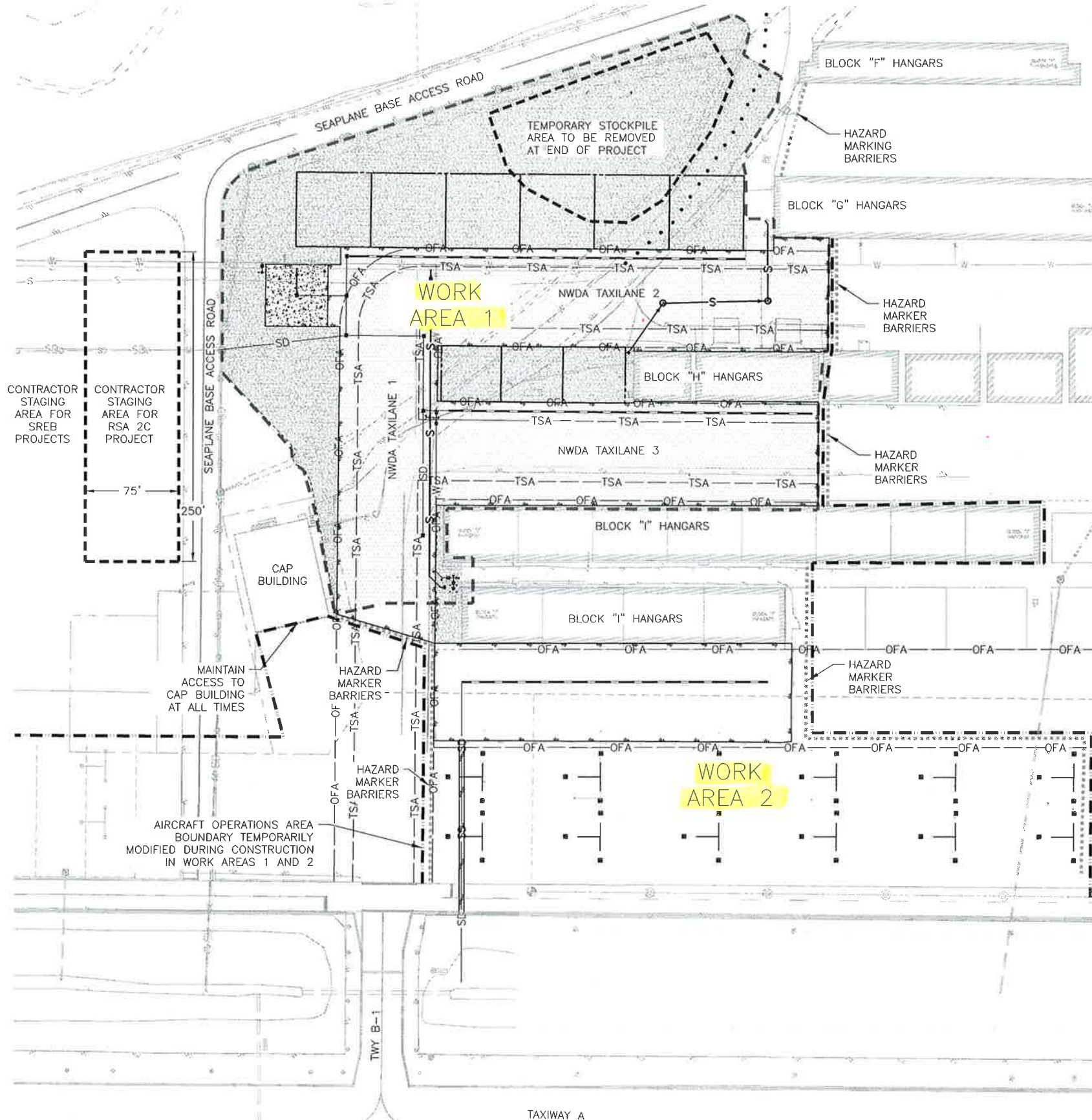

WORK AREA 3 NOTES

1. THIS WORK AREA IS OUTSIDE THE AIRCRAFT OPERATIONS AREA. THE FOLLOWING WORK IS INCLUDED IN WORK AREA 3:
 - A. REMOVE EXISTING GATE AND ASSOCIATED EQUIPMENT.
 - B. INSTALL NEW GATE AND ASSOCIATED EQUIPMENT.
2. BEFORE BEGINNING WORK IN THIS AREA, COMMUNICATE ALL CONSTRUCTION WORK NEEDED WITH THE ENGINEER AND ASCO A MINIMUM OF 48 HOURS IN ADVANCE.
3. DURING CONSTRUCTION, NOTIFY THE ENGINEER AND ASCO OF CHANGED CONDITIONS THAT MIGHT CHANGE A NOTAM. ALL CHANGES TO THE WORK SCHEDULE SHALL BE COMMUNICATED WITH THE ENGINEER AND ASCO.
4. MAINTAIN A SECURE PERIMETER FENCE AT ALL TIMES. TEMPORARY FENCING SHALL BE PROVIDED AS NEEDED DURING CONSTRUCTION TO ENSURE A CONTINUOUS BARRIER EXISTS IN THE AIRPORT PERIMETER FENCE.
5. ONCE THE CONTRACTOR HAS COMPLETED ALL TASKS WITHIN THIS WORK AREA, ALL TEMPORARY BARRIERS AND OTHER EQUIPMENT SHALL BE REMOVED FROM THE AREA. ONCE COMPLETED, NOTIFY THE PROJECT ENGINEER AND ASCO.

WH 7/23/18		ADDENDUM NO. 3		SCALE		PLAN PREPARED BY:		JUNEAU INTERNATIONAL AIRPORT		SHEET	
				HORZ. SCALE		DOWL		JUNEAU, ALASKA		AD1.1	
				VERT. SEE GRAPHIC		#AECL848		CONTRACT NO. BE18-213 / AIP NO. 3-02-0103-073-2017			
				W.O. NO. 1123-62033.02		5368 Commercial Boulevard		CSPP		AD3	
				FILE NO.		Juneau, Alaska 99801		CONSTRUCTION SAFETY PHASING PLAN			
						907-780-3533		NWDA CONSTRUCTION PHASING			
BY		DATE		REVISIONS							