

JUNEAU WETLANDS MANAGEMENT PLAN ATLAS

WETLAND CATEGORIES



A

Maintain all individual functional values in the wetland unit.
One environmental function cannot be substituted for another.



B

Maintain all aggregate functional values in the wetland unit.
One environmental function can be substituted for another.



C

Maintain overall functional value on roaded system.
No net loss of aggregate value to region.



D

Minimize adverse impacts to functional values.



EP

Enhancement Potential



R

Wetlands generally restricted due to land ownership
or management status.

(s)

Indicates that a more restrictive, category A, stream corridor
designation applies to a portion of the wetland unit.

(r)

Indicates that a less restrictive, category C, residential road
corridor designation applies to a portion of the wetland unit.

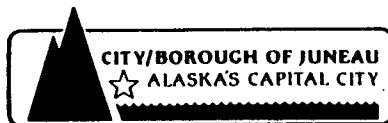

City & Borough of Juneau

May 1994

NOTE: The CBJ Wetlands Management Plan Atlas includes most wetlands identified by the COE within the Adamus Study Area. The boundaries are approximations based on COE aerial photography. The CBJ does not guarantee the accuracy of alignment or scale.

The preparation of these maps was financed in part by funds from the Alaska Coastal Management Program which is funded by the State of Alaska and the Office of Ocean and Coastal Resource Management, National Oceanic and Atmospheric Administration, U.S. Department of Commerce, and administered by the Department of Community and Regional Affairs, Municipal and Regional Assistance Division.

JUNEAU WETLANDS MANAGEMENT PLAN ATLAS

TABLE OF CONTENTS

1

Area	Wetland Unit	Classification	Page(s)	Street Atlas Map
Auke Bay	A1	C	14	B22
	A2	Lake	14,15,19,20	B22,B23,B27
	A5	A(r)	19,20	B27
	A5A	C	20	-
	A5B	C	18,19,20	B26,B27
	A6	B(r)	19,20	B27
	A7	B(s)	19,20,21	B27,B28
	A8	C	19,20	B27
	A9	C	21	B28
	A10	B	21	B28
	A11	B(s)	21	B28
	A12	C	21	B28
	A13	B	21	B28
	A14	C	21	B28
	A15	C	24	B30
	A17	C	21	B28
	A19	D	21	B28
Duck Creek	D2	EP	13	B21
	D3	EP	13	B21

JUNEAU WETLANDS MANAGEMENT PLAN ATLAS

TABLE OF CONTENTS

2

Area	Wetland Unit	Classification	Page(s)	Street Atlas Map
	D4	EP	13	B21
	D5	EP	13	B21
	D6	EP	6,7,13	B15,B16,B21
	D7	B(s)	7	B16
	D8	B(s)	7	B16
	D11	Pond	13	B21
Douglas	DE1	B(r)	29,30,32	D10,D11
	DE2	B(r)	27,28,29	D09,D10
	DE3	A(r)	27,28	D09
	DE4	A(r)	27,28,29,30,32	D09,D10,D11
	DE5	C	28	-
	DE7	B(r)(s)	27,28	D09
	DE8	Federal	26,27,28	D08,D09
	DE9	B(r)	29	D10
	DE10	B(r)	29	D10
	DW2	B(r)	29,30,32	D10,D11
	DW3	C	32	-
	DW4	C	32	-
	DW5	C	32	-
	DW6	C	32	-

JUNEAU WETLANDS MANAGEMENT PLAN ATLAS

TABLE OF CONTENTS

3

Area	Wetland Unit	Classification	Page(s)	Street Atlas Map
	DW7	B(r)	30,32	D11
	DW8	B	30,31,32	D11,D12
	DW9	CBJ Open Space	31,32	D12
	DW11	C	32	-
	DW12	C	31,32	D12
	DW13	C	31,32	D12
	DW15	B	31,32	D12
	DW16	Refuge	31,32	D12
	DW17	Refuge	31,32	D12
	DW18	Refuge	32	-
Jordan Creek	J1	B(s)	16	B24
	J2	A	16	B24
	J3	A	16	B24
	J4	A	13,16	B21,B24
	J5	A(r)	13	B21
	J6	B(s)	6,13	B15,B21
	J7	B(r)/C	6,7	B15,B16
Lemon Creek	L1	B	4,5	B13,B14
	L4	B	4	B13

JUNEAU WETLANDS MANAGEMENT PLAN ATLAS

TABLE OF CONTENTS

4

Area	Wetland Unit	Classification	Page(s)	Street Atlas Map
	L5	B	4	B13
	L6	A/B(s)	3,4	B12,B13
	L7	C	4	B13
	L7A	C	4	B13
	L8	A	2	B10
	L12	B(s)	2,3	B10,B12
	L13	C	3	B12
	L14	B(s)	3	B12
	L15	B(s)	3	B12
	L17	C	3,4	B12,B13
	L18	C	2,4	B10,B13
	L20	C	2,4	B10,B13
	L21	C	4	B13
	L22	C	4	B13
	L23	C	4	B13
	L90	D	5	B14
	L91	D	5	B14
East Mendenhall Valley	M1	B	7,8	B16
	M1A	B	8	-

JUNEAU WETLANDS MANAGEMENT PLAN ATLAS

TABLE OF CONTENTS

5

Area	Wetland Unit	Classification	Page(s)	Street Atlas Map
	M1B	B	8	-
	M1C	B	8	-
	M2	EP	5,6	B14,B15
	M3	B	5	B14
	M4	C	6,8	B15
	M5	A	6,8	B15
	M6	C	6,8	B15
	M7	B(s)/C(s)	6,7,8	B15
	M8	C	6,7,8	B15,B16
	M9	C	6,8	B15,B16
	M10	C	6,8	B15
	M13	C	6,8	B15
	M14	B	6	B15
	M15	C	7	B16
	M17	C	7	B16
	M18	C	7	B16
	M19	Greenbelt	7	B16
	M20	Greenbelt	7	B16
	M21	Greenbelt	7	B16

JUNEAU WETLANDS MANAGEMENT PLAN ATLAS

TABLE OF CONTENTS

6

Area	Wetland Unit	Classification	Page(s)	Street Atlas Map
	M26	B	5	B14
	M27	B	5	B14
	M49	C(s)	7	B16
	M50	C	7	B16
	M51	C(s)	7,8	B16
	M52	C	7,8	B16
	M53	C(s)	7,8	B16
West Mendenhall Valley	MW1	A/B	9	B17
	MW2	B(s)	9,10	B17,B18
	MW3	B(s)/C	9	B17
	MW3A	B	9	B17
	MW4	B	9	B17
	MW5	B/C	9	B17
	MW6	B	7,9,14	B16,B17,B22
	MW9	C	14	B22
	MW11	B(r)(s)	9,10,14	B17,B18,B22
	MW12	C	10,12	B18,B20
	MW13	C	11,12	B19,B20
	MW14	C	11	B19

JUNEAU WETLANDS MANAGEMENT PLAN ATLAS

TABLE OF CONTENTS

7

Area	Wetland Unit	Classification	Page(s)	Street Atlas Map
	MW15	C	12	B20
	MW16	C	11	B19
	MW17	C	13	B21
	MW18	C	14	B22
	MW19	D	14	B22
	MW20	B(s)	9	B17
	MW21	B(s)	9,14	B17,B22
	MW22	C(s)	9	B17
	MW23	C	7	B16
	MW25	B	10	B18
	MW30	B(s)	9	B17
	MW60	C	9	B17
Lower Montana Creek	ML1	A	17,18	B25,B26
	ML2	C	18	B26
	ML15	Greenbelt	17	B25
	ML16	B(r)	22	B29
	ML17	C	14	B22
	ML19	B	17,18,22	B25,B26,B29

JUNEAU WETLANDS MANAGEMENT PLAN ATLAS

TABLE OF CONTENTS

8

Area	Wetland Unit	Classification	Page(s)	Street Atlas Map
Upper Montana Creek	UM1	A/C	18,22,23	B26,B29
	UM6	B	23	-
	UM7	B	23	-
	UM8	C	23	-
	UM9	B	23	-
	UM10	B	23	-
	UM11	B	23	-

Click in specific area to be
taken to that page

Lemon Creek
Mendenhall Valley
Auke Bay

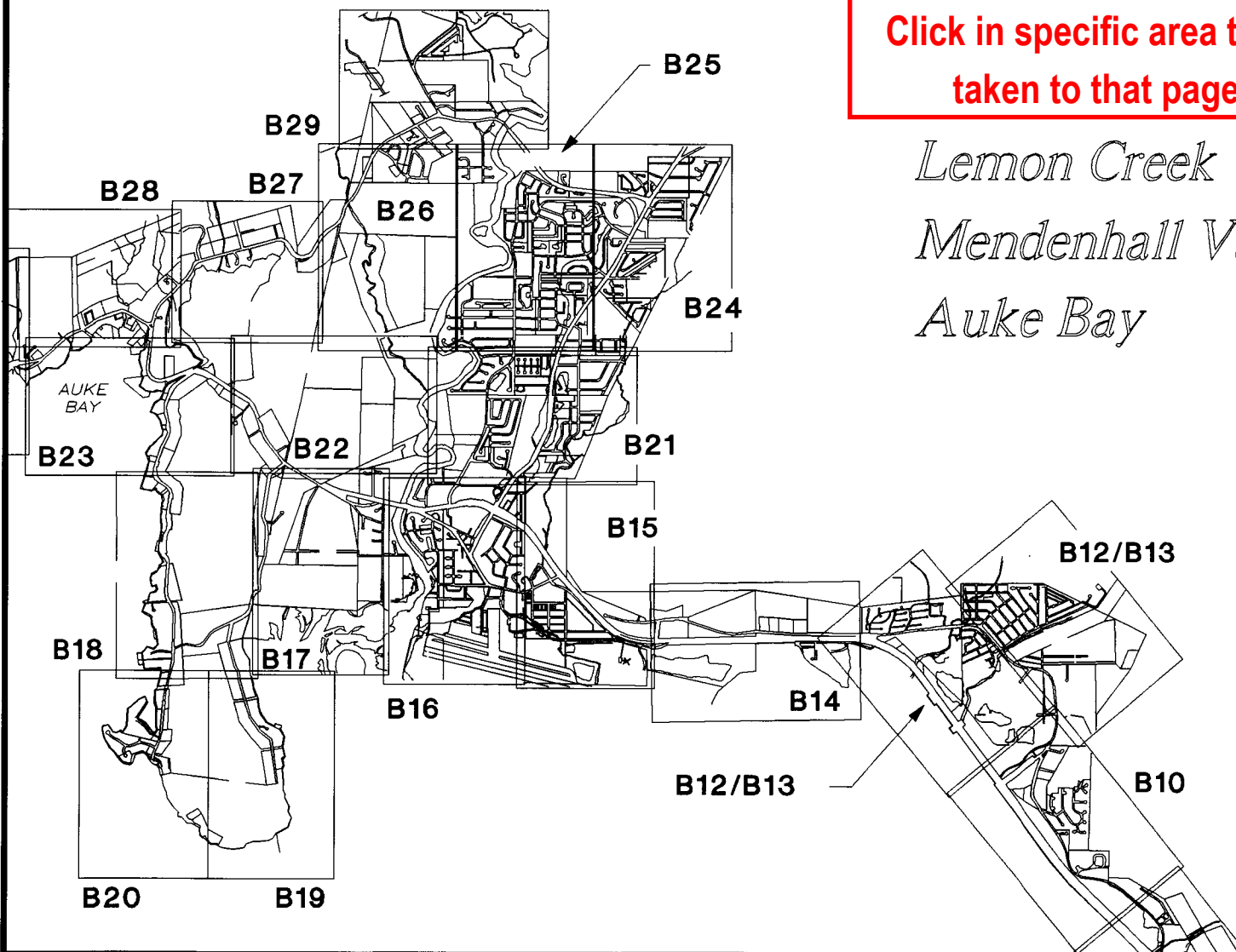

INDEX

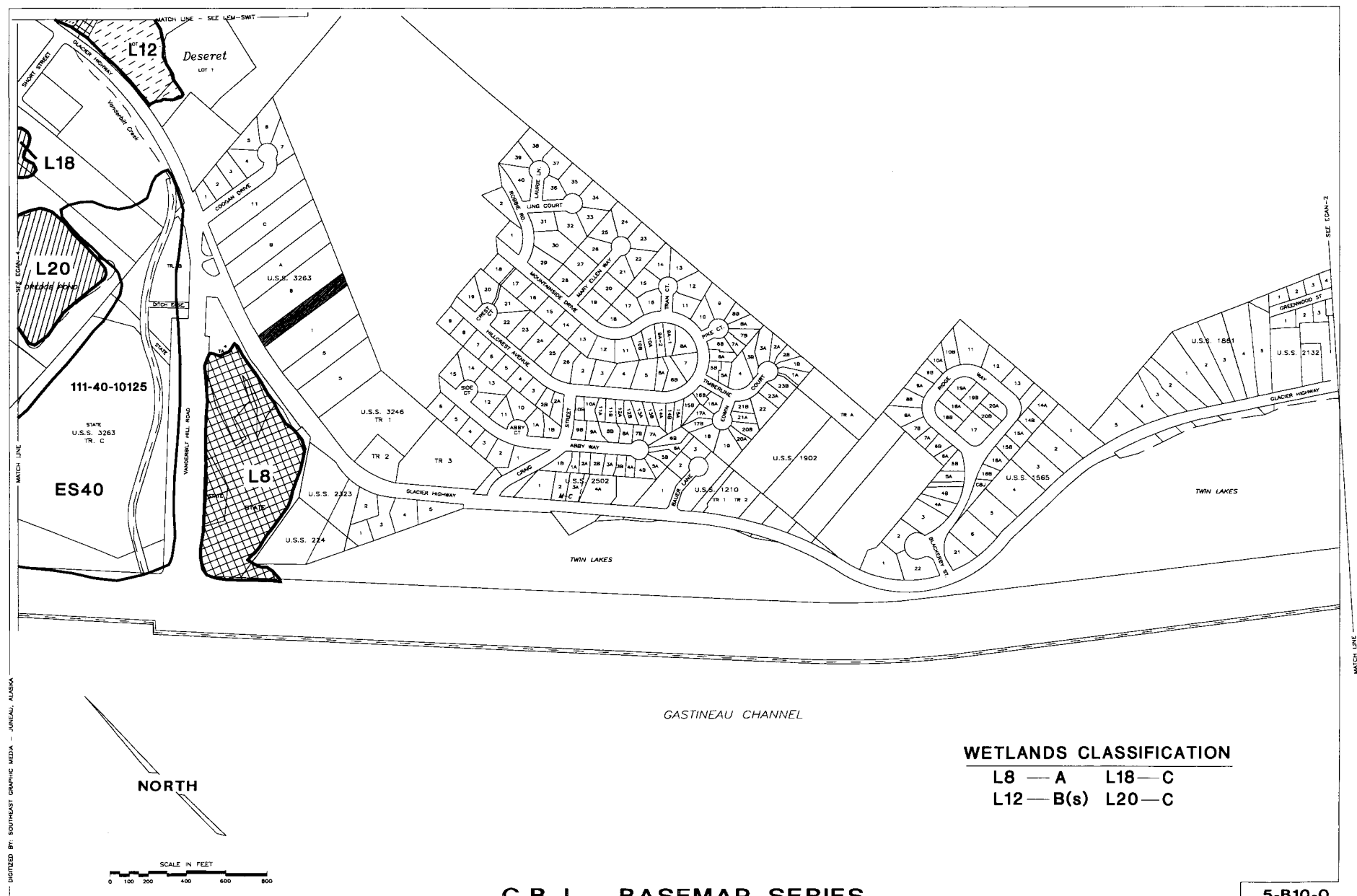

WETLANDS CLASSIFICATION

L6 — A/B(s) L14 — B(s)
 L12 — B(s) L15 — B(s)
 L13 — C L17 — C

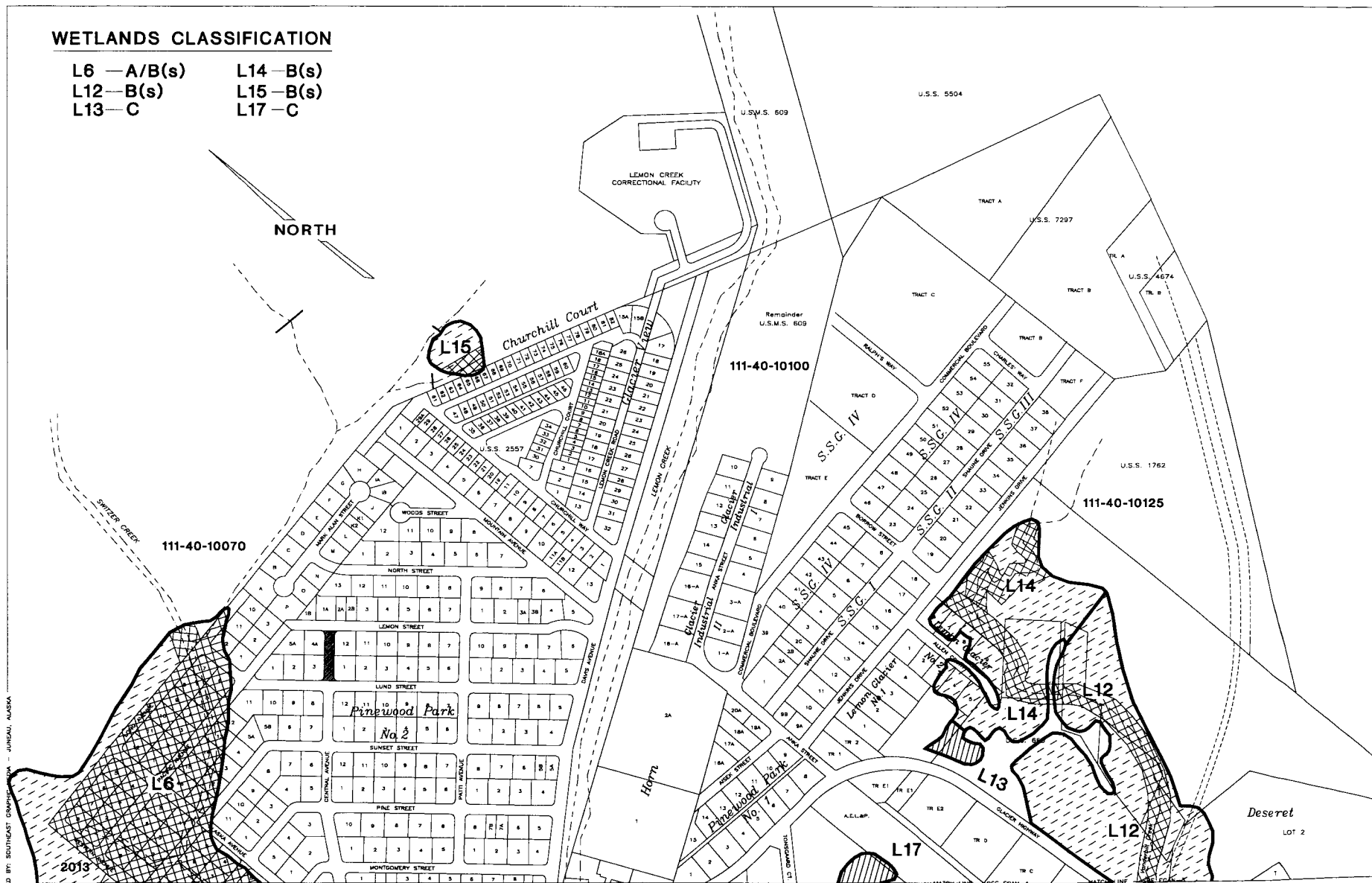

C.B.J. - BASEMAP SERIES

B12-0/B13-0

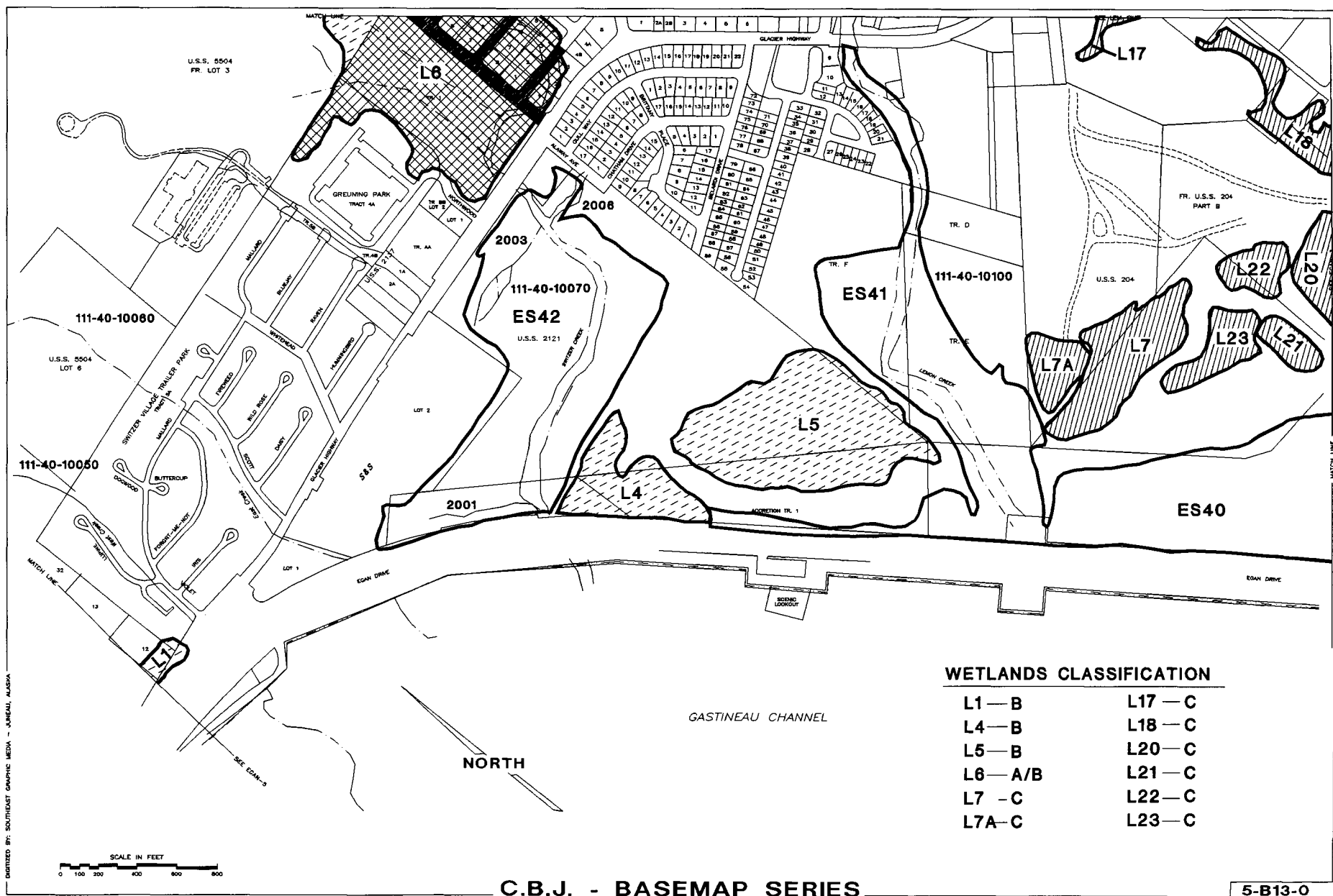

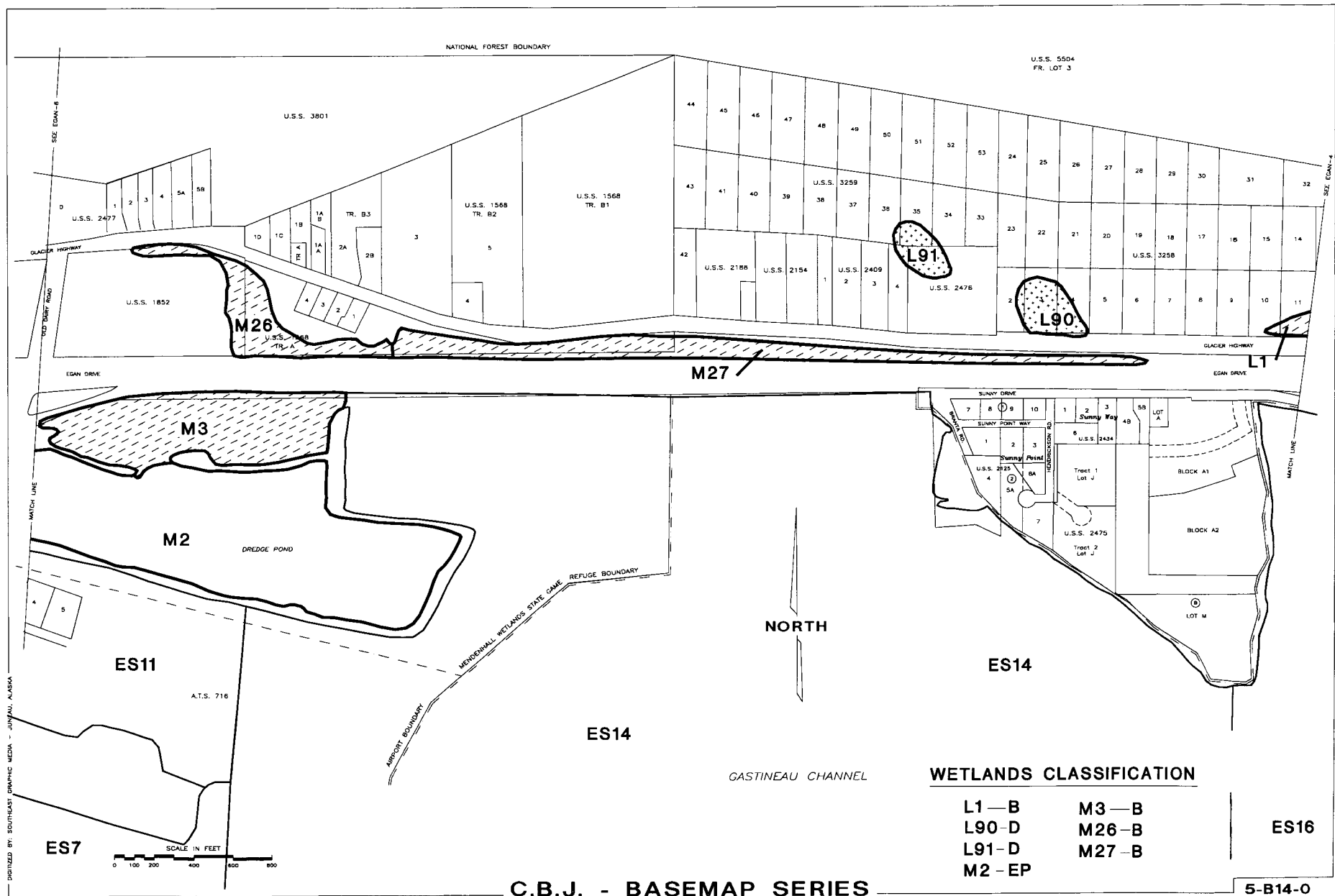

WETLANDS CLASSIFICATION

D6-EP	M7-B(s)/C(s)
J6-B(s)	M8-C
J7-B(r)/C	M9-C
M2-EP	M10-C
M4-C	M13-C
M5-A	M14-B
M6-C	

NORTH

C.B.J. - BASEMAP SERIES

3-B15-0
5-B15-0

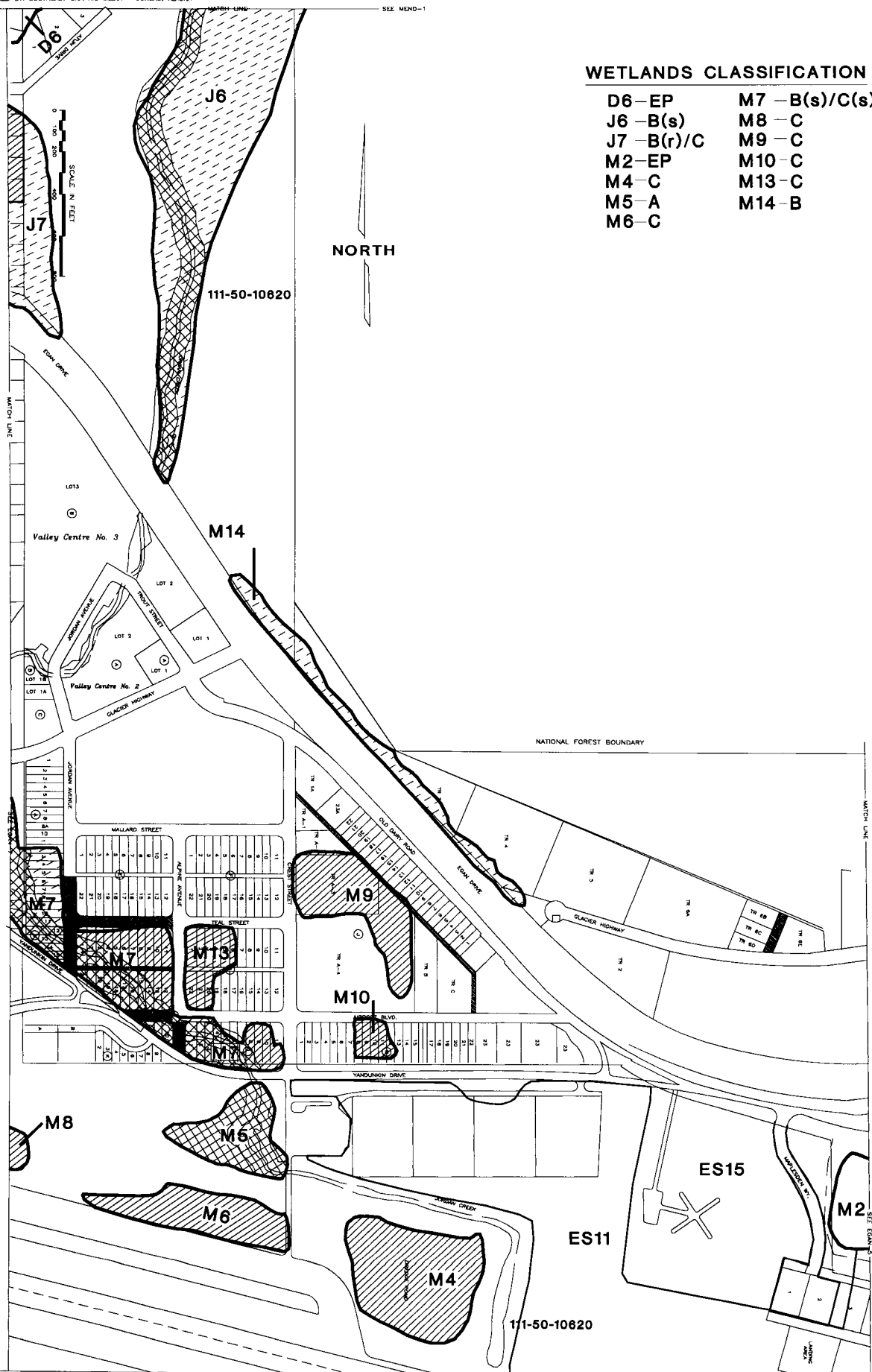

WETLANDS CLASSIFICATION

D6 - EP	M20 - GREENBELT
D7 - B(s)	M21 - GREENBELT
D8 - B(s)	M49 - C(s)
J7 - B(r)/C	M50 - C
M1 - B	M51 - C(s)
M7 - B(s)/C(s)	M52 - C
M8 - C	M53 - C(s)
M15 - C	MW6 - B
M17 - C	MW23 - C
M18 - C	
M19 - GREENBELT	

111-50-10500-2002-3014

C.B.J. - BASEMAP SERIES

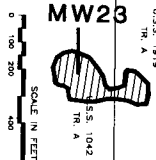

111-50-10500

U.S. 4973
LOT 4

111-50-10500-2002

3-B16-0 4-B16-0
5-B16-0

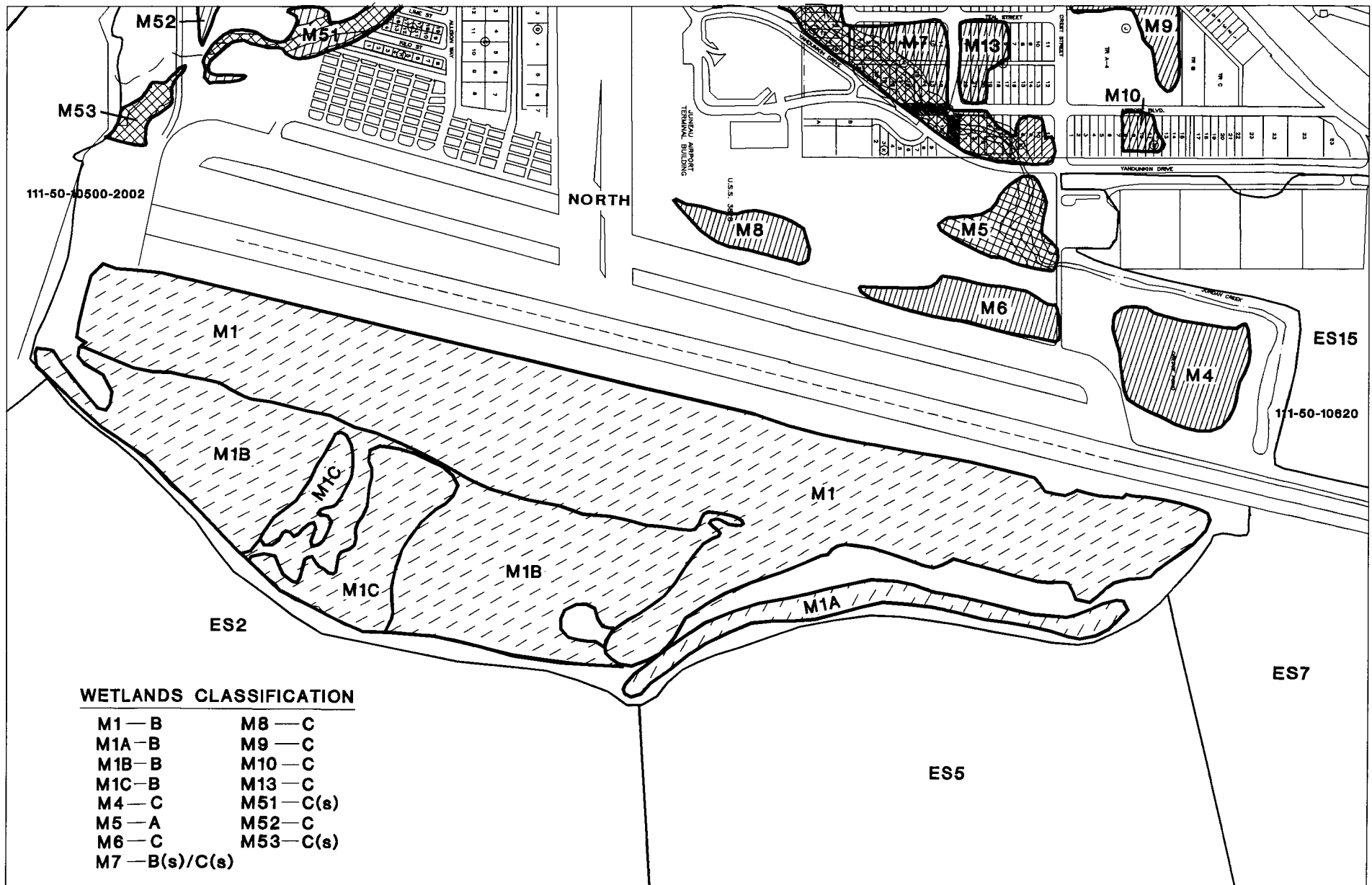



4-B17-0

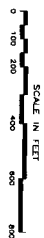

NORTH

4-B18-0

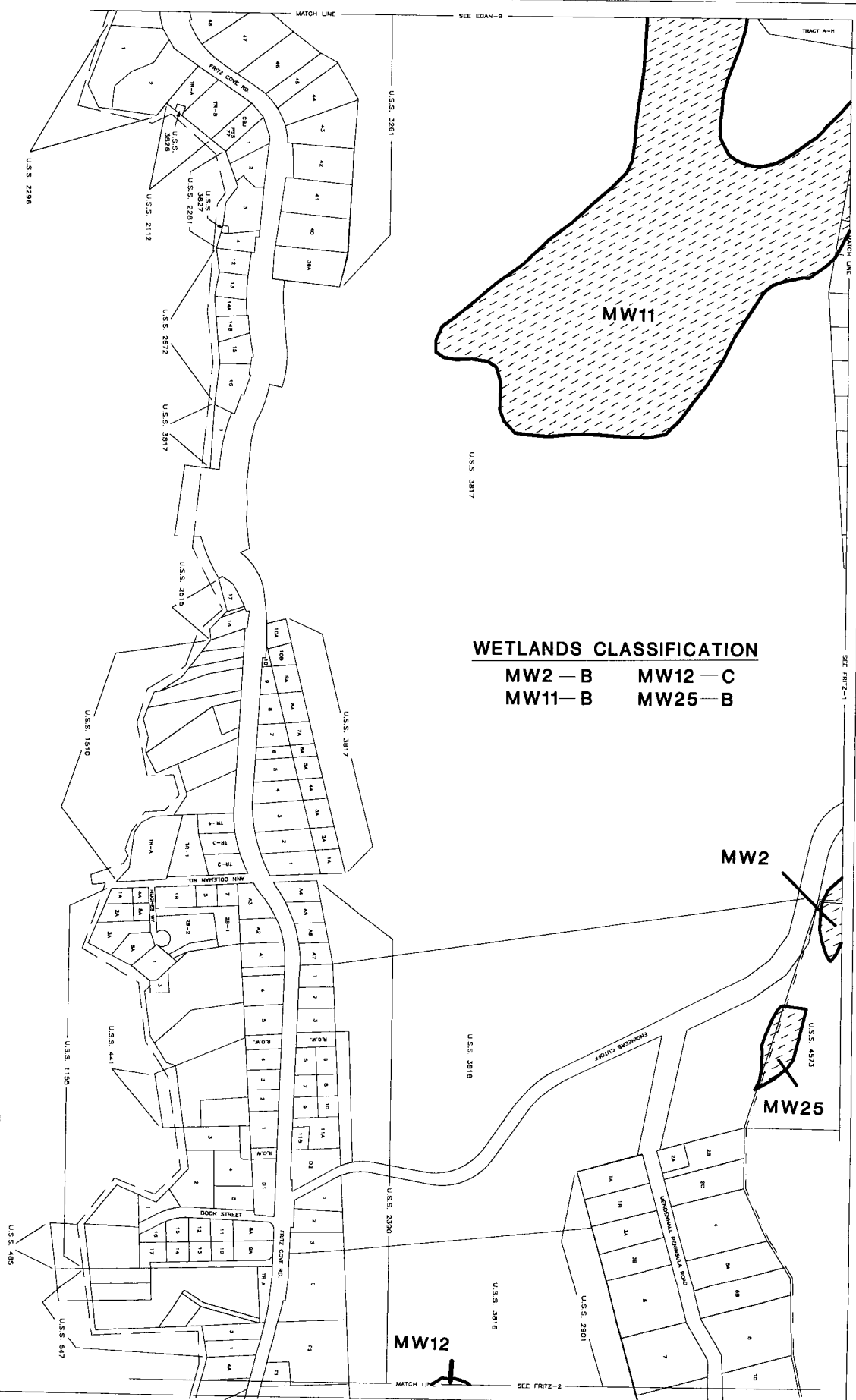

WETLANDS CLASSIFICATION

MW13 — C MW16 — C
MW14 — C

SCALE IN FEET
0 100 200 300 400 500

C.B.J. - BASEMAP SERIES

4-B19-0

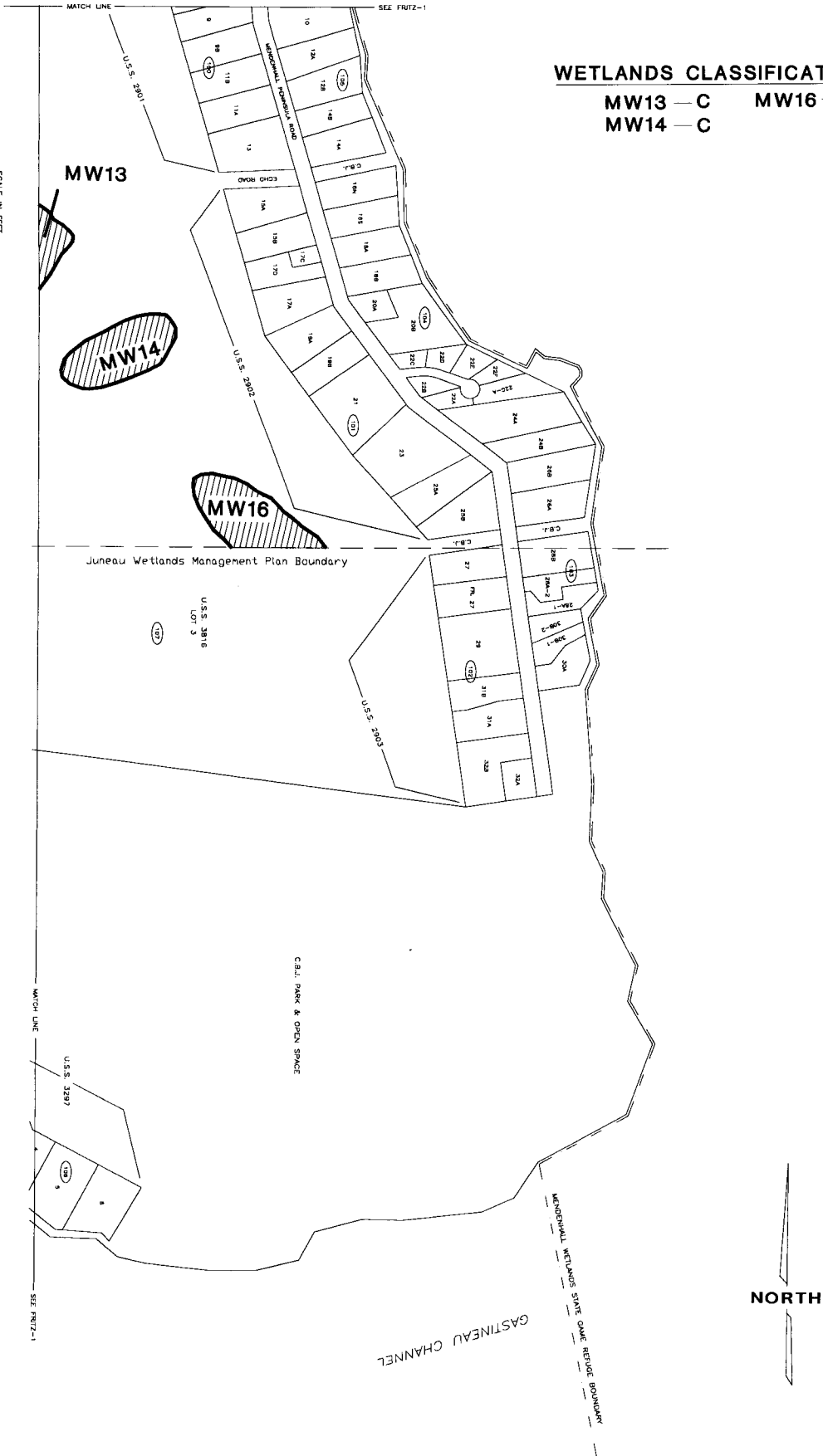

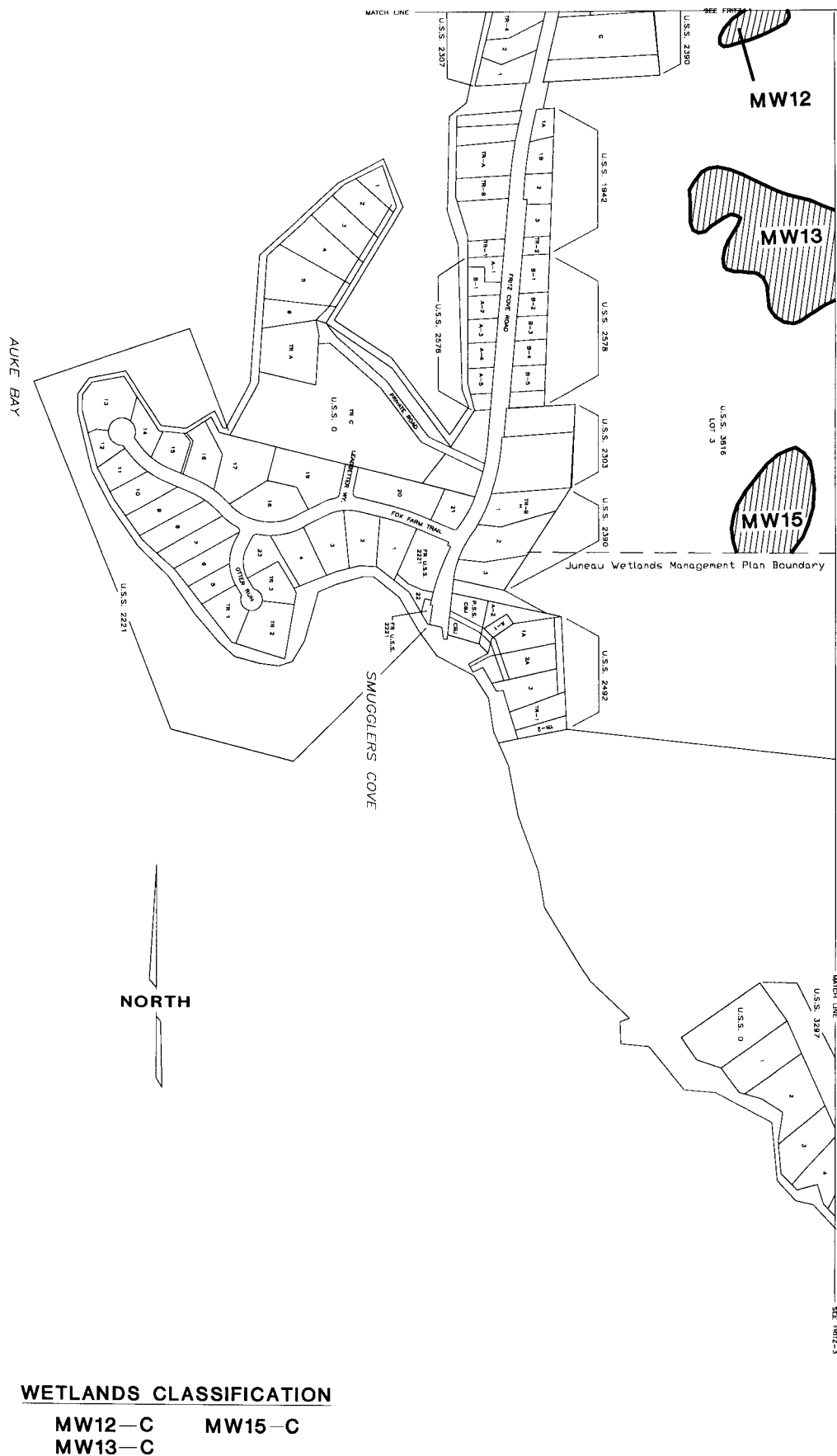
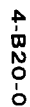

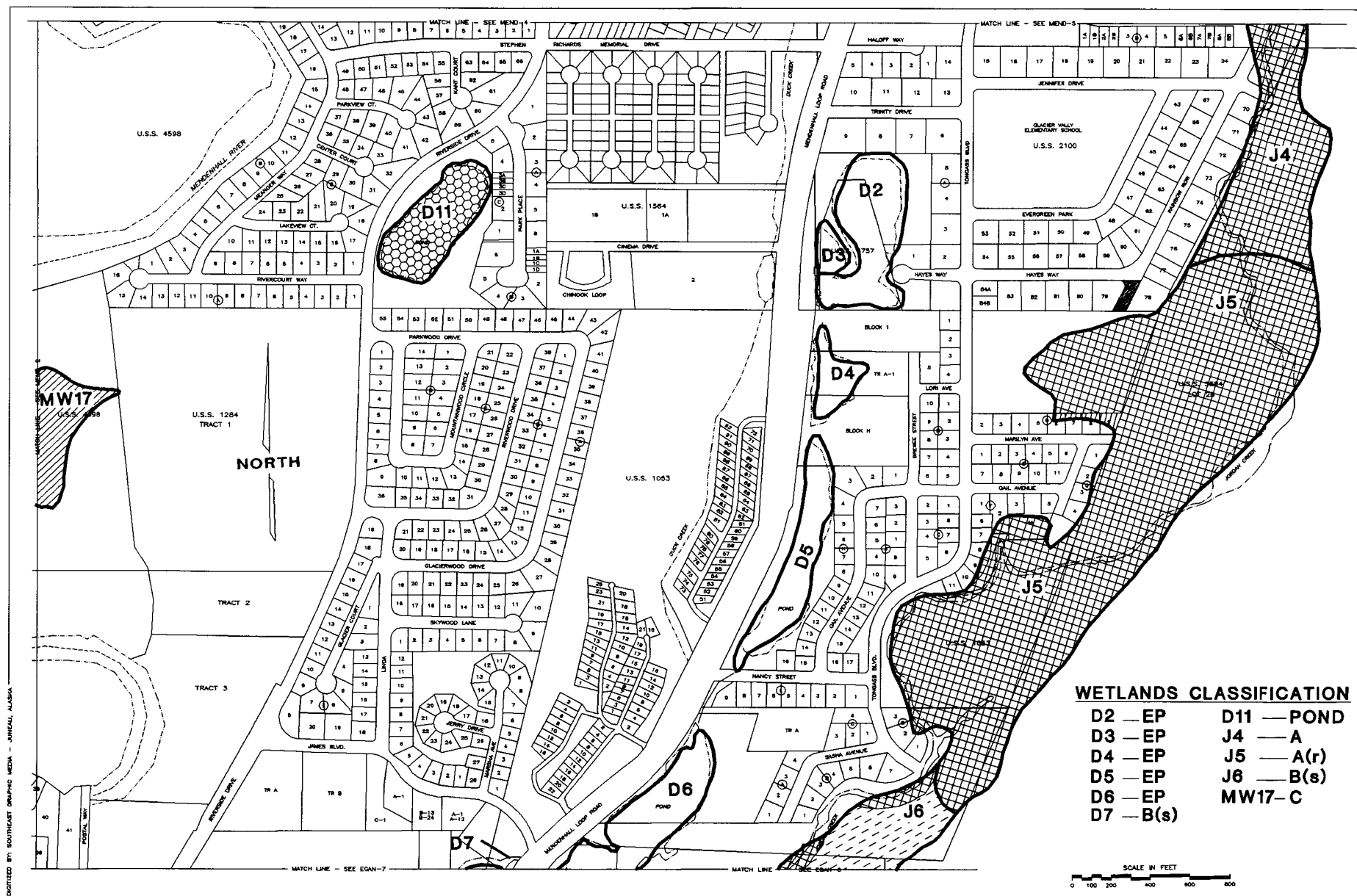

C.B.J. BASEMAP SERIES

4-B21-O
5-B21-O

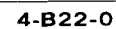

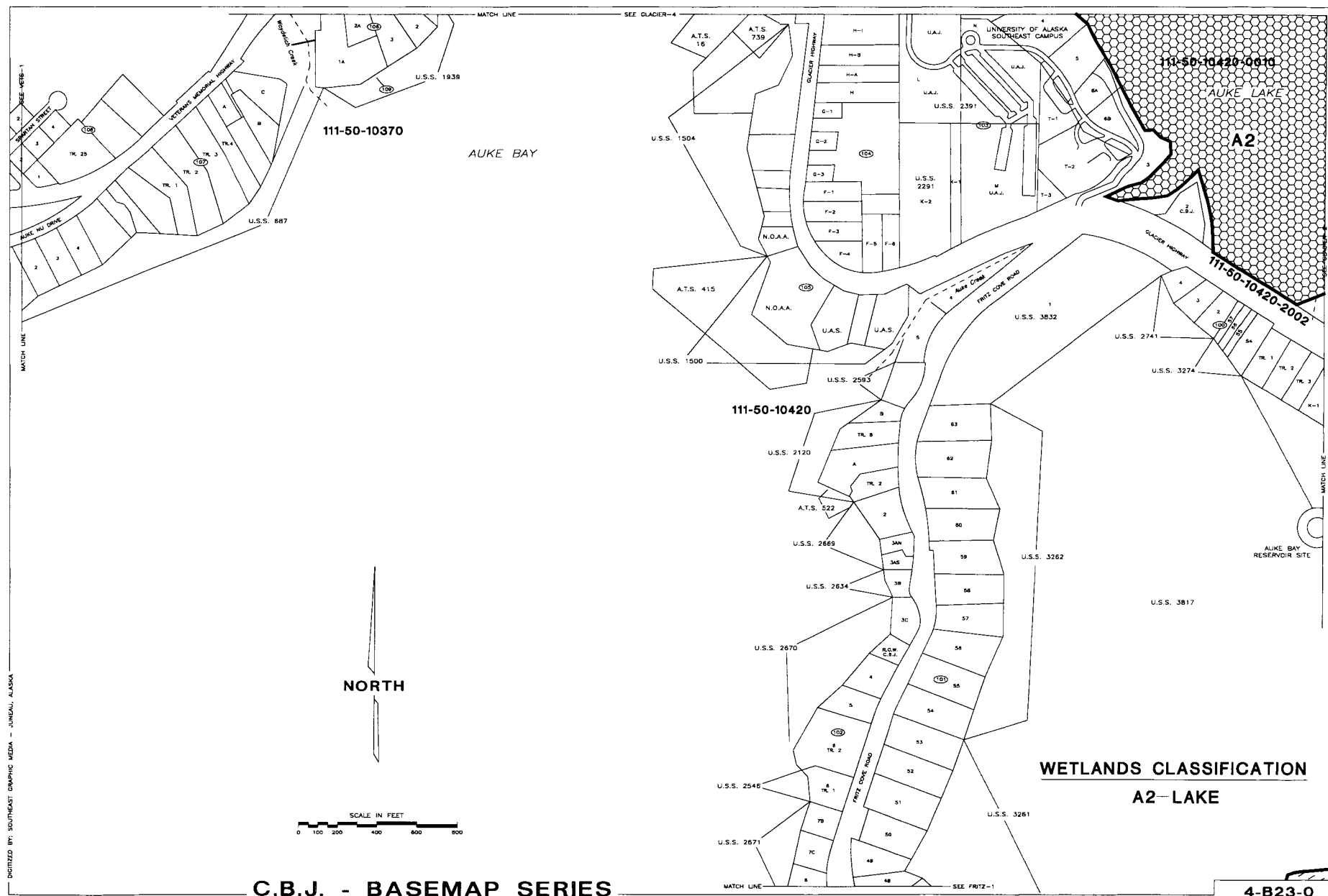

111-50-10500-2004

C.B.J. - BASEMAP SERIES

5-B24-0

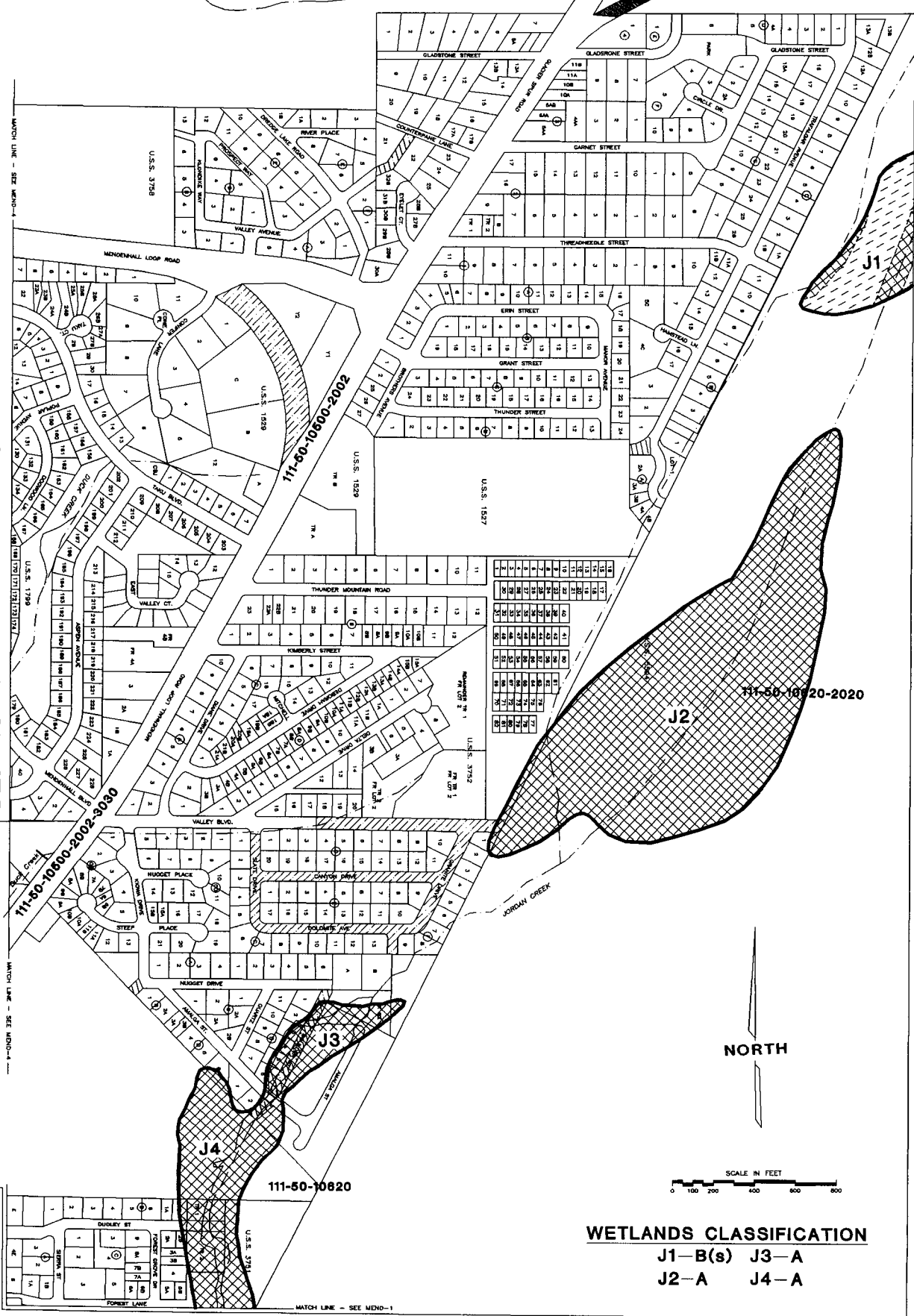

WETLANDS CLASSIFICATION
 J1-B(s) J3-A
 J2-A J4-A

C.B.J. - BASEMAP SERIES

5-B25-0
4-B25-0

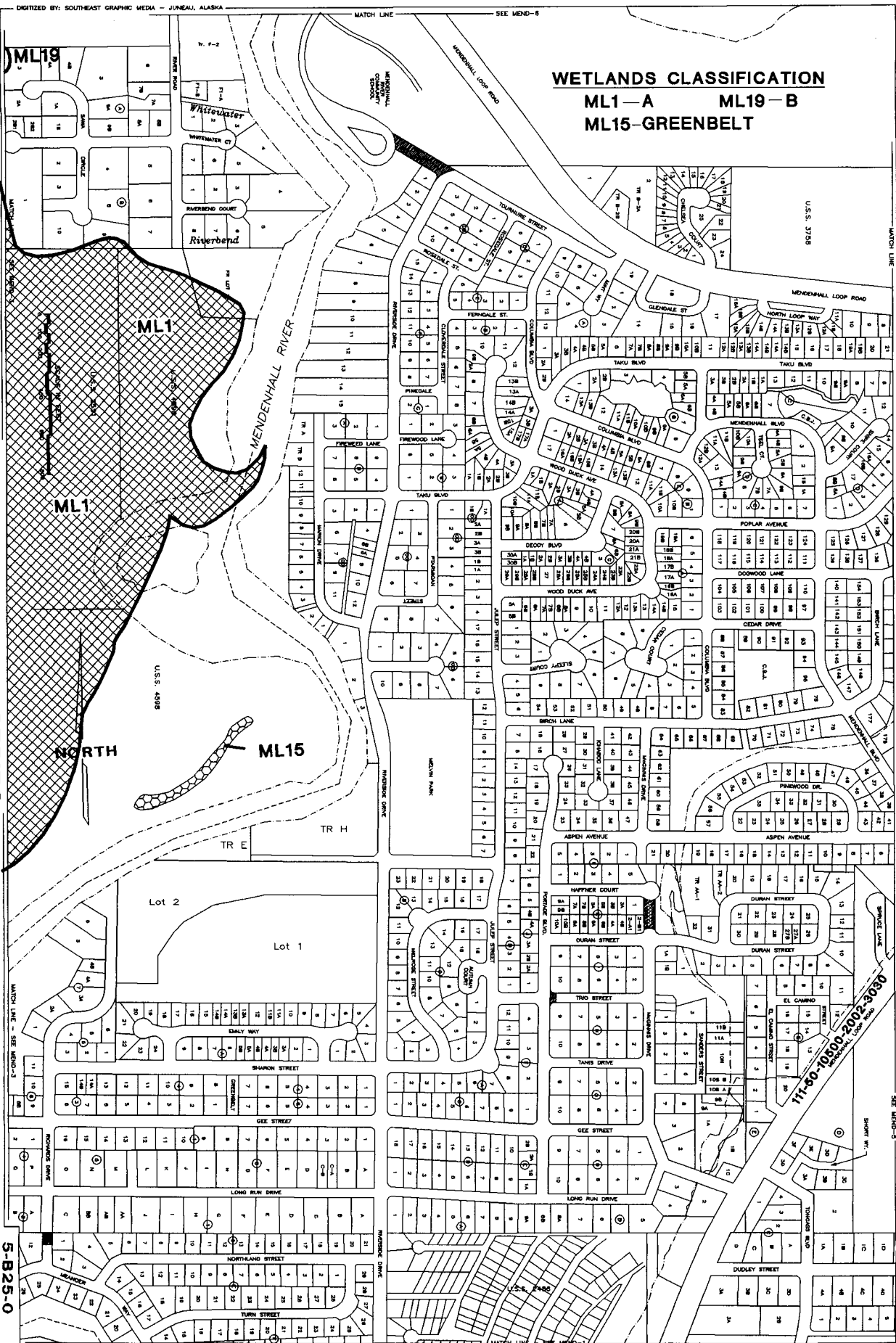

C.B.J. - BASEMAP SERIES

4-B26-0
5-B26-0

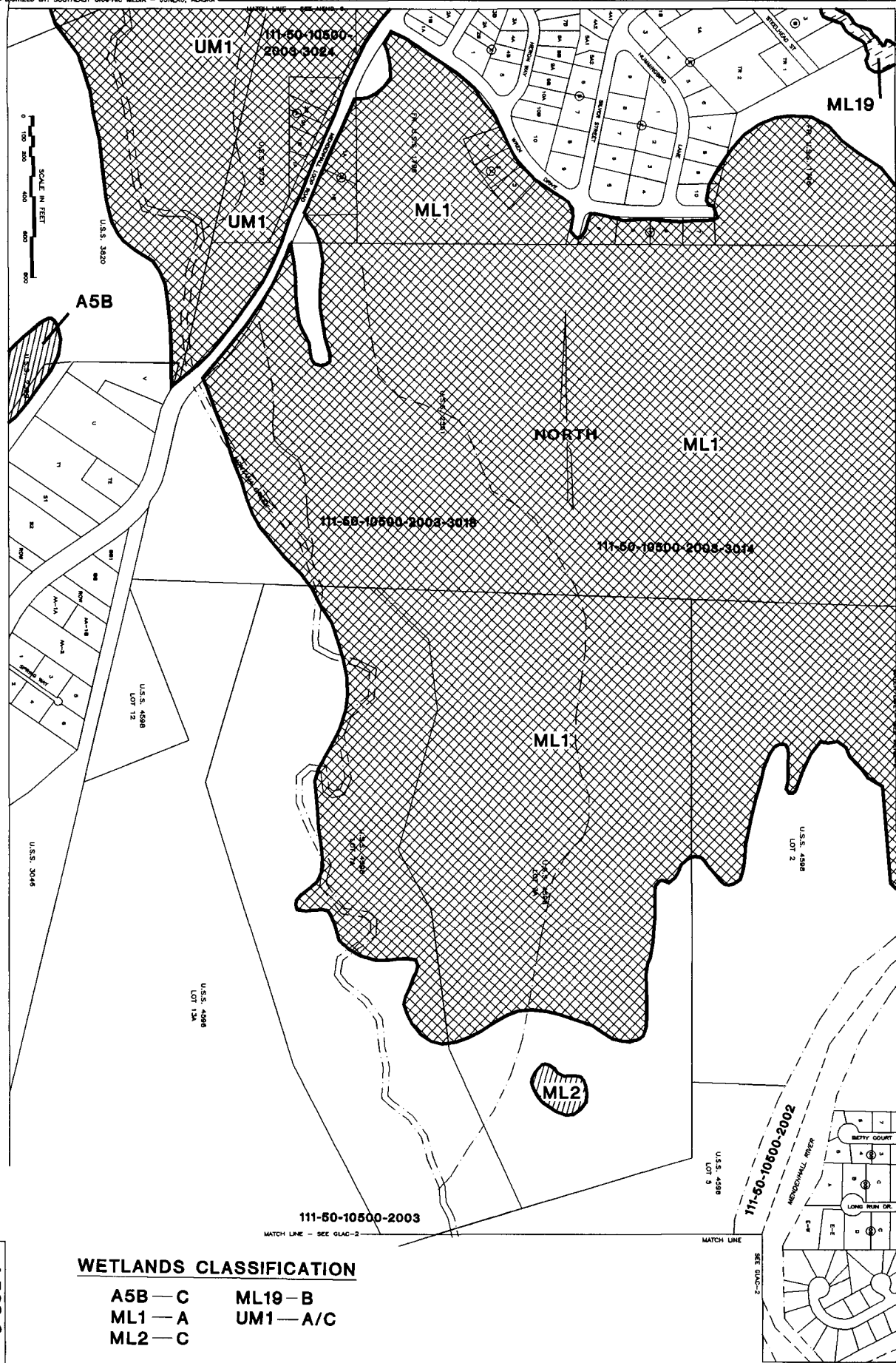

WETLANDS CLASSIFICATION

A5B — C	ML19 — B
ML1 — A	UM1 — A/C
ML2 — C	



NORTH

WETLANDS CLASSIFICATION

A2 - LAKE	A6 - B(r)
A5 - A(r)	A7 - B(s)
A5A - C	A8 - C
A5B - C	

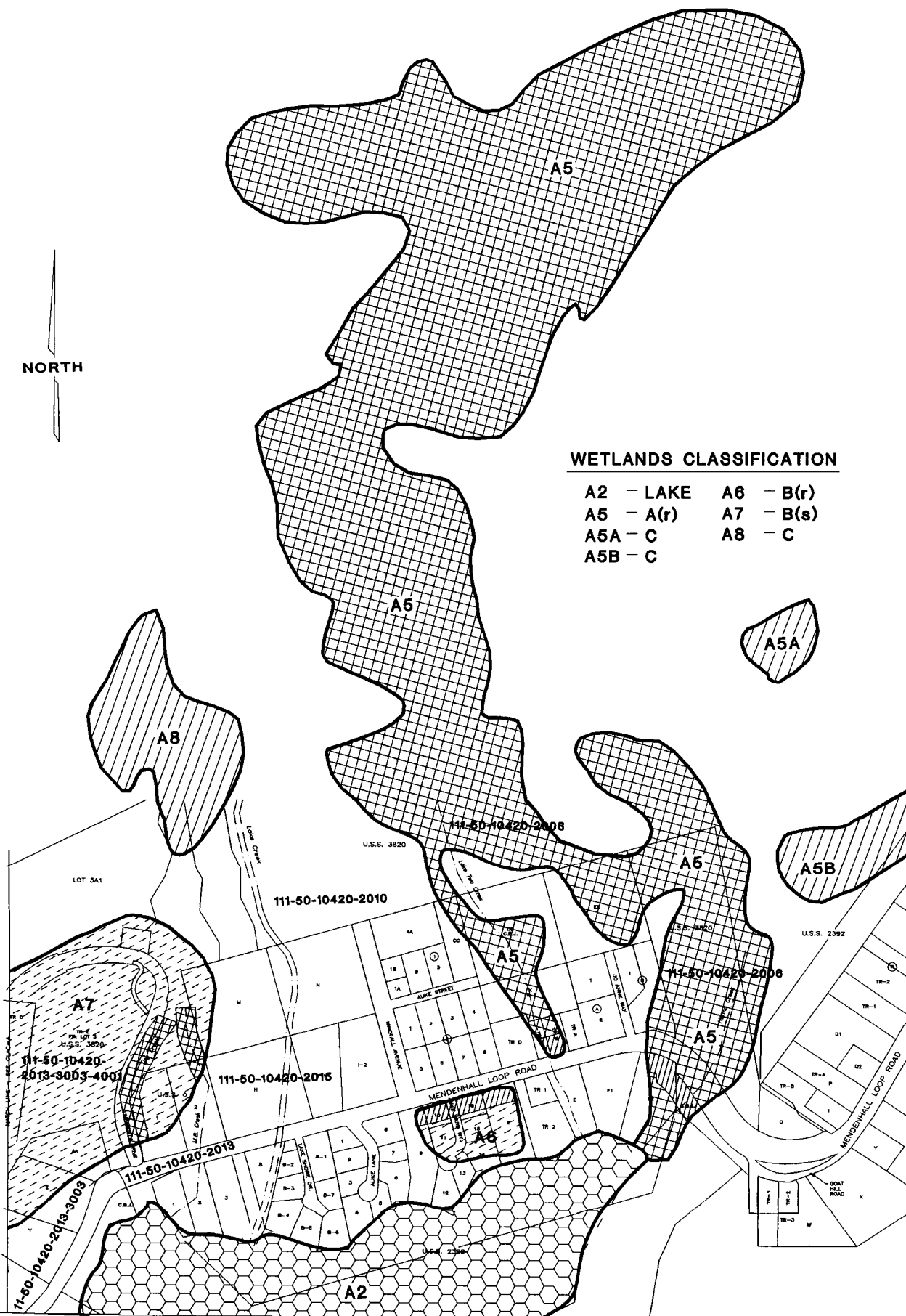

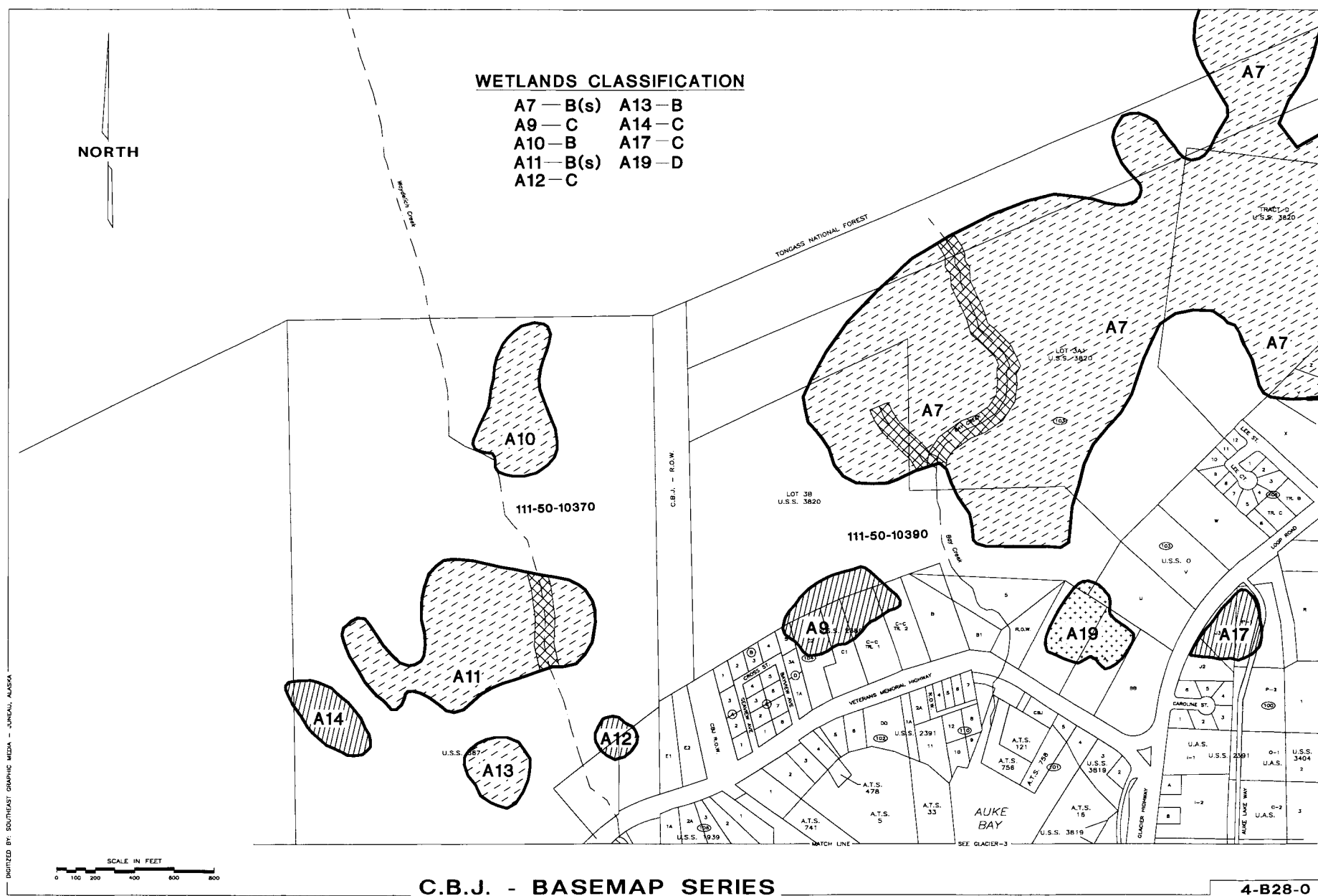

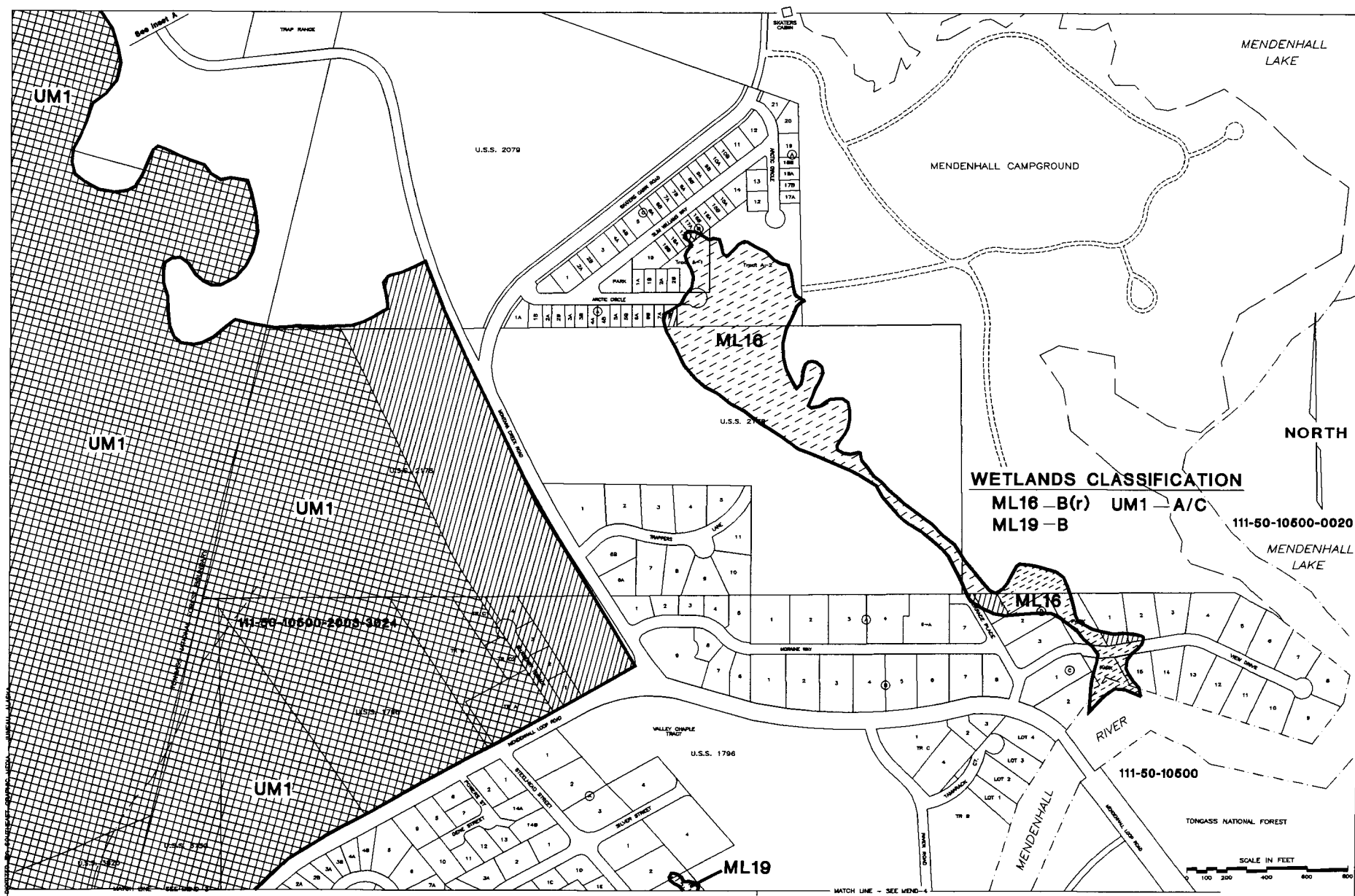

4-B29-0

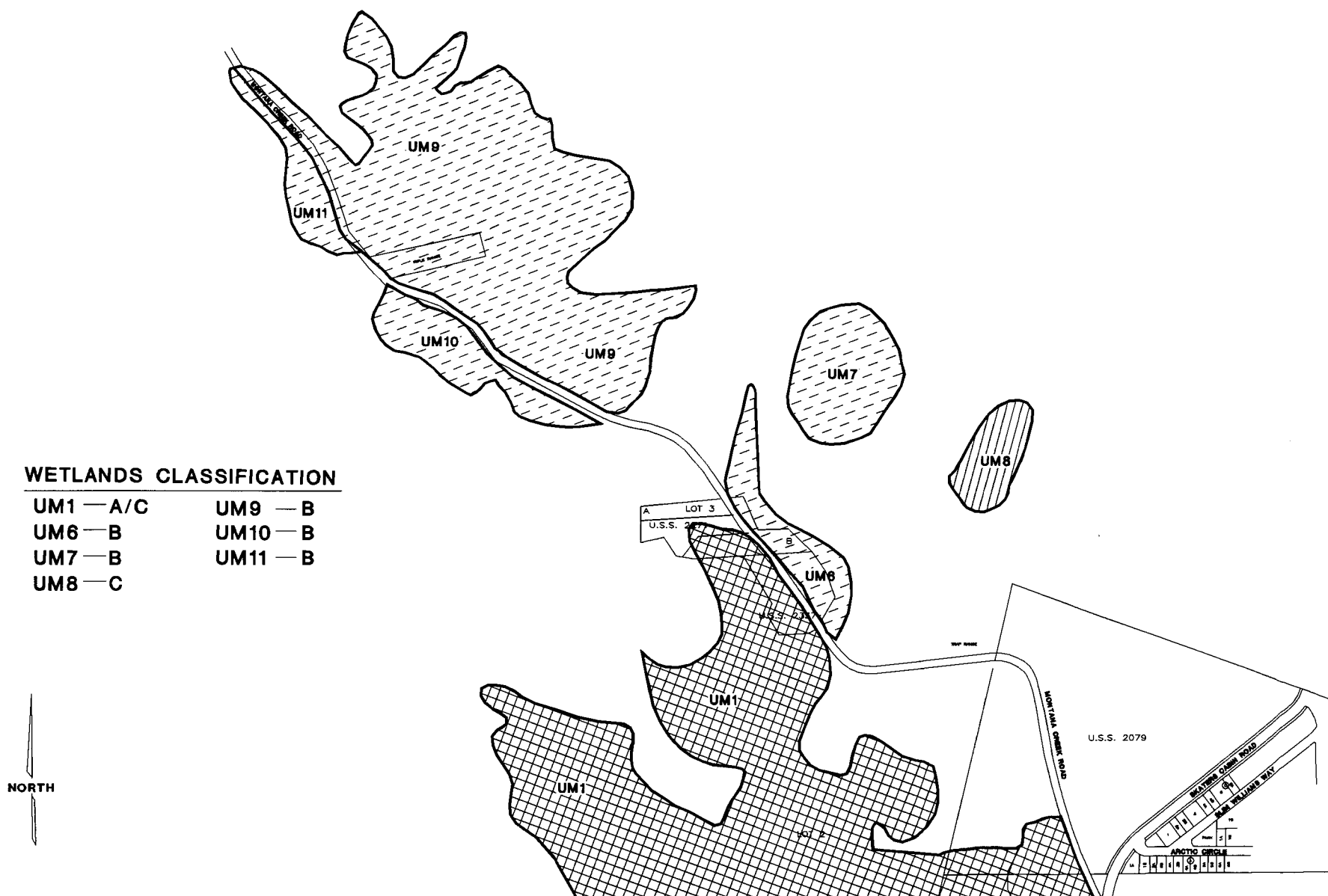

C.B.J. - BASEMAP SERIES

4-B30-0

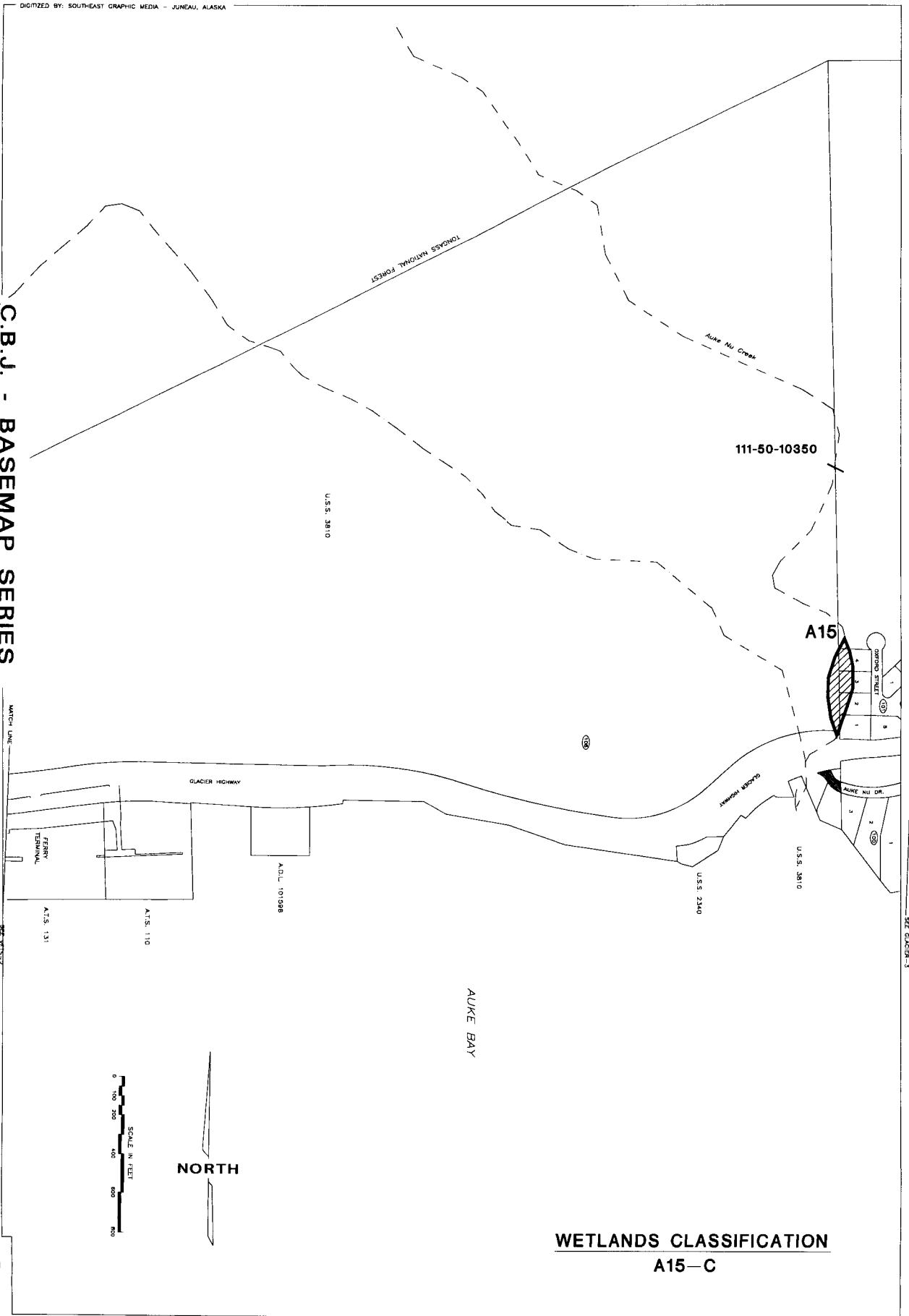

WETLANDS CLASSIFICATION
A15-C

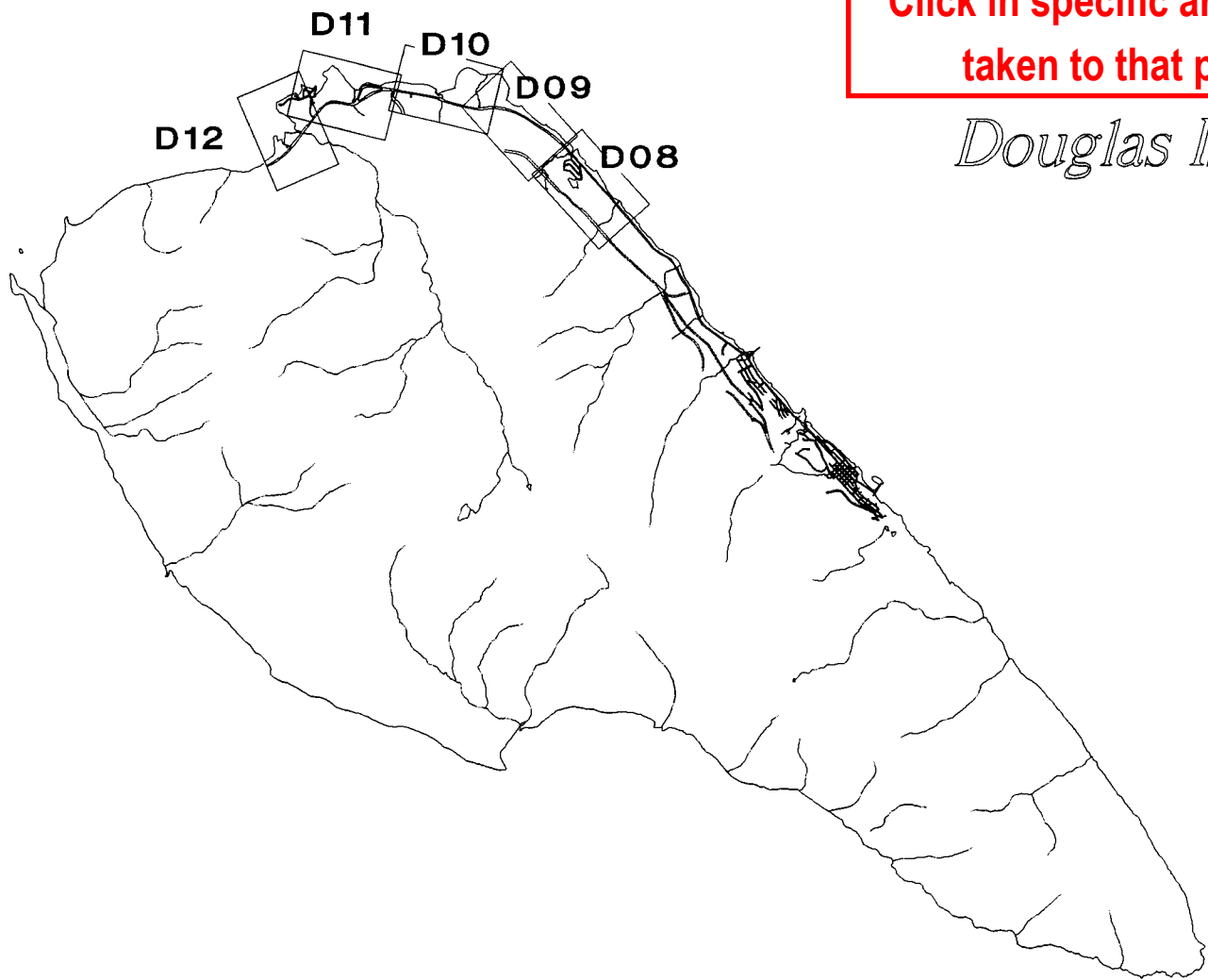

Click in specific area to be
taken to that page

Douglas Island

INDEX

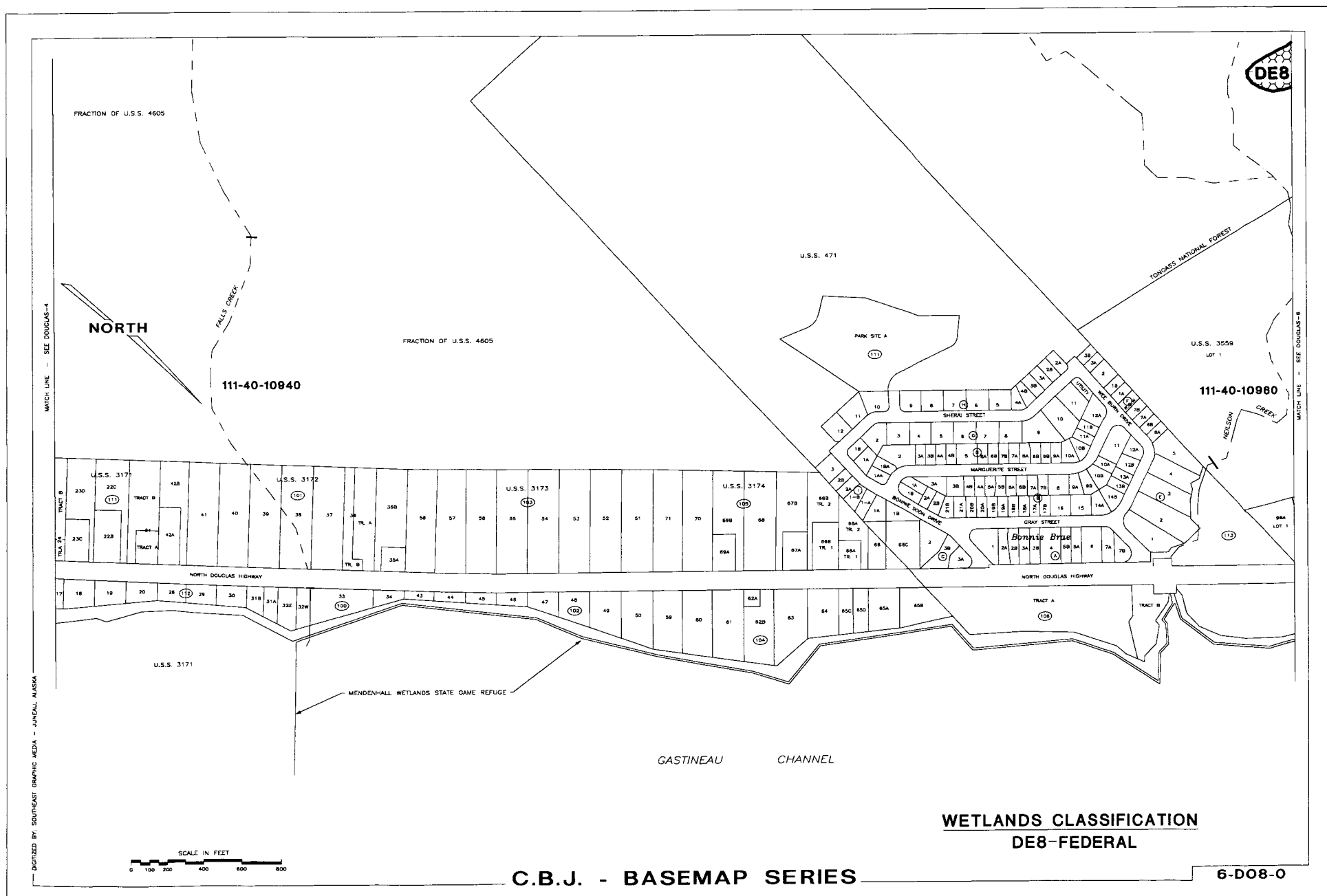



C.B.J. - BASEMAP SERIES

6-D09-0

