



ADDENDUM TO THE CONTRACT

for the

**CHICKEN YARD PARK & AUKE LAKE WAYSIDE IMPROVEMENTS
Contract No. BE-20-191**

ADDENDUM NO.: ONE

**CURRENT DEADLINE FOR BIDS:
August 4, 2020**

PREVIOUS ADDENDA: NONE

ISSUED BY: City and Borough of Juneau
ENGINEERING DEPARTMENT
155 South Seward Street
Juneau, Alaska 99801

DATE ADDENDUM ISSUED: July 22, 2020

The following items of the contract are modified as herein indicated. All other items remain the same. This addendum has been issued and is posted online. Please refer to the CBJ Engineering Contracts Division webpage at: <http://www.juneau.org/engineering ftp/contracts/Contracts.php>

DRAWINGS:

Insert attached Drawing L100, titled "Paving Plan" labeled ADDENDUM 1.

By: 
Greg Smith,
Contract Administrator

Total number of pages contained within this Addendum: 2

Drawing J:\PDC-19-01 Juneau Park Improvements2 - CAD\Corvus-Sheets - Auke Lake Rec.dwg last saved on 6/12/2020 1:49 PM was plotted by Linda Pringle on 6/12/2020 3:25 PM

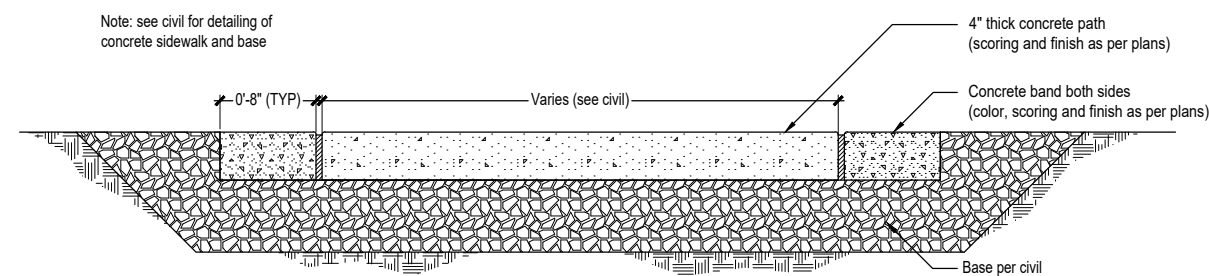
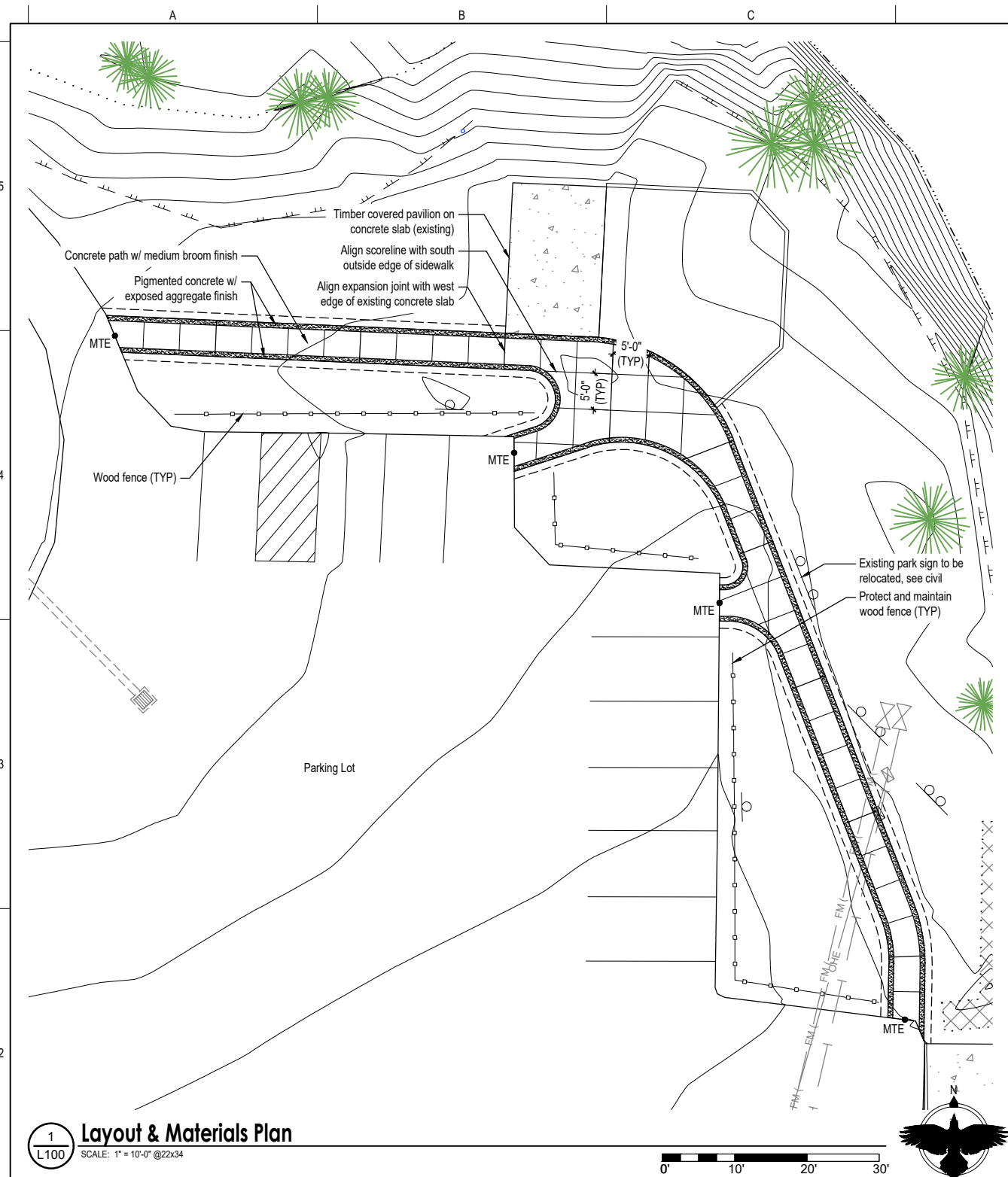

1
L100
Layout & Materials Plan
 SCALE: 1" = 10'-0" @22x34

2
L100
Paving Section - Typical
 SCALE: NTS @22x34

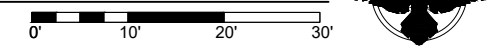

Corvus Design
 Landscape Architecture
 www.corvus-design.com
 Anchorage - 907.222.2859
 2506-B Fairbanks St. 99503
 Juneau - 907.988.9000
 119 Seward St. 99801
 AECC #1195



City and Borough of Juneau
Auke Lake Wayside
 100% Construction Drawings
 Juneau, AK

If the above dimension does not measure exactly 1", this drawing has been enlarged or reduced, affecting all scales.

DATE: June 12, 2020
 JOB NUMBER: PDC-19-01
 DRAWN BY: LP
 CHECKED BY: CM

Paving Plan
 SHEET #:
L100

ADDENDUM 1