

Presented by: The Manager
Introduced: 12/17/2018
Drafted by: R. Palmer III

RESOLUTION OF THE CITY AND BOROUGH OF JUNEAU, ALASKA

Serial No. 2842

A Resolution Confirming the Assessment Roll for LID No. 97, That Installed a Municipal Water System within the Public Roads of the Eagles Edge Subdivision in the Lemon Creek area, Fixing the Time and Method of Payment Assessments, Setting the Date of Levy, and Fixing the Time of Delinquency and Penalties and Interest.

WHEREAS, the Assembly of the City and Borough of Juneau, by Ordinance Serial No. 2013-07 adopted April 1, 2013, created LID No. 97 for the purpose of installing a municipal water system within the public roads of the Eagles Edge Subdivision, benefitting the property described in Exhibit A, attached; and

WHEREAS, the special assessment roll for LID No. 97 has been prepared and notice of the hearing on the special assessment roll given in accordance with CBJ 15.10.130; and

WHEREAS, a hearing on the special assessment roll for LID No. 97 was held on December 17, 2018, and all interested persons were given an opportunity at the hearing to present their objections to the Assembly sitting as the Board of Equalization; and

WHEREAS, the Assembly sitting as a Board of Equalization at said hearing approved the special assessment roll with such corrections as it found necessary.

NOW, THEREFORE, BE IT RESOLVED BY THE ASSEMBLY OF THE CITY AND BOROUGH OF JUNEAU, ALASKA:

Section. 1 That the special assessment roll for LID No. 97, as filed with the City and Borough Treasurer and to the extent corrected by the Assembly sitting as a Board of Equalization, is hereby confirmed.

Section 2. The assessments set forth in said confirmed assessment roll are hereby declared to be due and payable and are a lien upon the property assessed paramount and superior to all liens except for a prior LID assessment or property taxes and subject to the following terms:

(a) Notice of Assessment. The City and Borough Clerk shall cause notice of assessment and time for payment to be published and mailed in accordance with CBJ 15.10.190.

(b) Time for Payment. All or any portion of any assessment appearing thereon may be paid within 45 days from the date of the first publication of the notice without penalty or interest. Any amount remaining unpaid after the 45-day period allowed for payment of assessment without penalty or interest shall be paid in ten equal annual principal installments. The initial installment shall be billed as a separately stated charge on the next property tax bill. Subsequent installments shall be billed as a separately stated charge on the annual property tax bill. Payments shall be made in the same manner and at the same time as property taxes.

(c) Interest on Assessment. All installments shall include interest on the unpaid balance at the rate of 2.0 percent per annum.

(d) Prepayment of Installments. An installment may be prepaid in accordance with CBJ 15.10.230.

(e) Delinquent Assessment. Installments shall become delinquent the day after they are due. The penalty and interest that apply for delinquent payment of property taxes shall apply to delinquent payment of an annual assessment installment and interest as they appear on the tax bill.

Section 3. Effective Date. This resolution shall be effective immediately upon adoption.

Adopted this 17th day of December, 2018.

Beth A. Weldon, Mayor

Attest:

Elizabeth J. McEwen, Municipal Clerk

**LID 97
BOUNDARY**

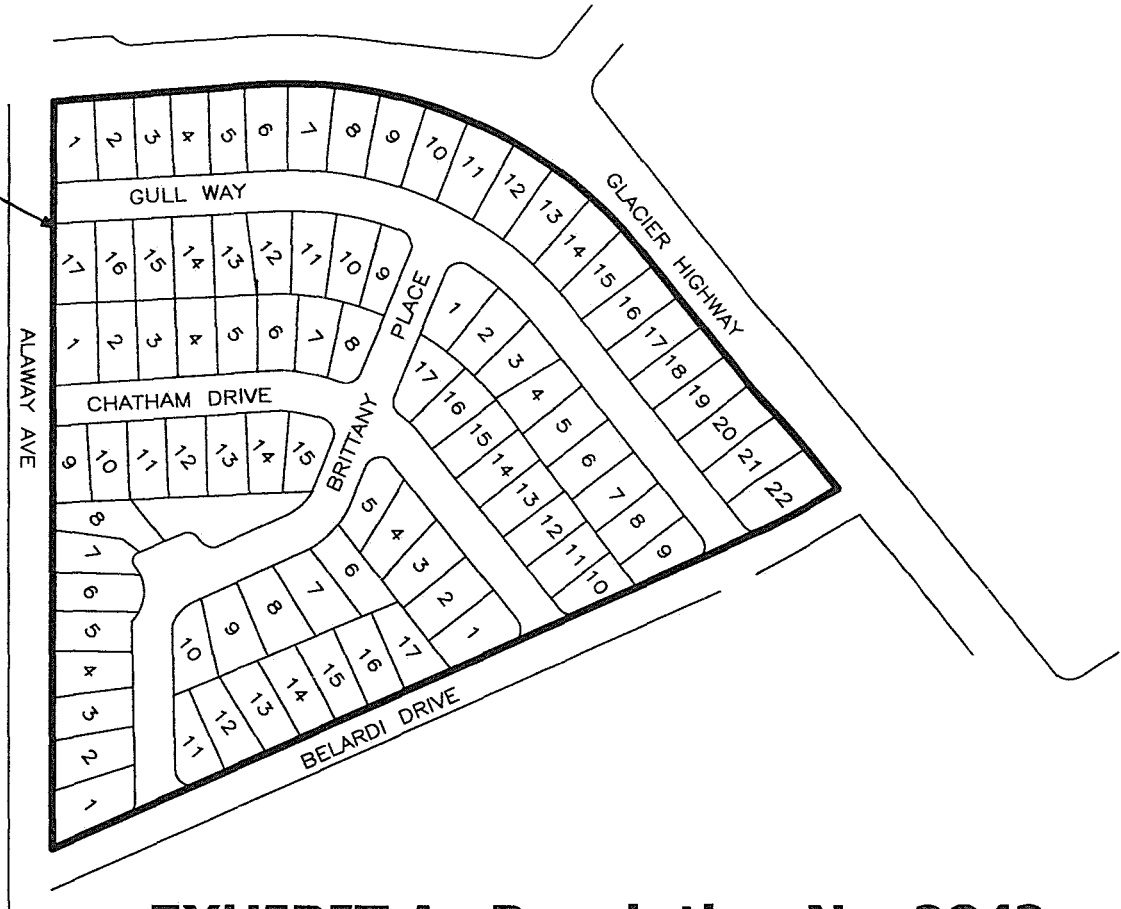
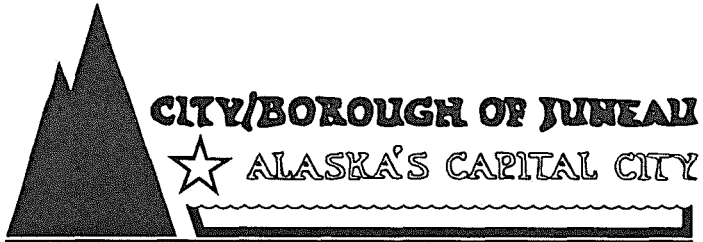

EXHIBIT A - Resolution No. 2842



DEPARTMENT OF ENGINEERING

**EAGLES EDGE SUBDIVISION WATER
SYSTEM REPLACEMENT
LID 97**

BOUNDARY MAP - DECEMBER, 2018

**Local Improvement District 97 Roll as Approved by the Assembly
December 17, 2018 per Resolution 2842**

ASSESSMENT ROLL - EAGLES EDGE WATER SYSTEM REPLACEMENT - LID 97

PARCEL	OWNER	Assmnt	HOUSE #	STREET	ADDRESS	LEGAL DESCRIPTION	CITY STATE	ZIP
5B1301140010	WACKER JOHN & SARA JANE	\$ 3,300.00	6042	GULL WAY	6042 GULL WAY	EAGLES EDGE BL A L 1	JUNEAU AK	99801
5B1301140020	SORIANO RAUL Q & IMELDA G	\$ 3,300.00	6040	GULL WAY	6040 GULL WAY	EAGLES EDGE BL A L 2	JUNEAU AK	99801
5B1301140030	MOISES ORPIANO & ETHEL L	\$ 3,300.00	6038	GULL WAY	6038 GULL WAY	EAGLES EDGE BL A L 3	JUNEAU AK	99801
5B1301140040	M SUE ALEXANDER	\$ 3,300.00	6036	GULL WAY	PO BOX 210796	EAGLES EDGE BL A L 4	AUKE BAY AK	99821
5B1301140050	ELLISON ROSEMARY J	\$ 3,300.00	6034	GULL WAY	6034 GULL WAY	EAGLES EDGE BL A L 5	JUNEAU AK	99801
5B1301140060	ELIZARDE AGNES L & LOPE R	\$ 3,300.00	6032	GULL WAY	6032 GULL WAY	EAGLES EDGE BL A L 6	JUNEAU AK	99801
5B1301140070	LEWIN LUTHER L	\$ 3,300.00	6030	GULL WAY	6030 GULL WAY	EAGLES EDGE BL A L 7	JUNEAU AK	99801
5B1301140080	DARRILLO DIMAS P	\$ 3,300.00	6028	GULL WAY	6028 GULL WAY	EAGLES EDGE BL A L 8	JUNEAU AK	99801
5B1301140090	NIEHAUS HENRY S & WRIGHT COLETTE M	\$ 3,300.00	6026	GULL WAY	6026 GULL WAY	EAGLES EDGE BL A L 9	JUNEAU AK	99801
5B1301140100	ZANORIA JOSEPHINE & PAMPIO	\$ 3,300.00	6024	GULL WAY	6024 GULL WAY	EAGLES EDGE BL A L 10	JUNEAU AK	99801
5B1301140110	DAU MARIAN B	\$ 3,300.00	6022	GULL WAY	PO BOX 020995	EAGLES EDGE BL A L 11	JUNEAU AK	99802
5B1301140120	DJG Development	\$ 3,300.00	6020	GULL WAY	5165 Glacier Hwy	EAGLES EDGE BL A L 12	JUNEAU AK	99803
5B1301140130	GACETA ASELA C & DANILO SR & GACETA	\$ 3,300.00	6018	GULL WAY	6018 GULL WAY	EAGLES EDGE BL A L 13	JUNEAU AK	99801
5B1301140140	HIGBEE RANDY N & SARAH J	\$ 3,300.00	6016	GULL WAY	6016 GULL WAY	EAGLES EDGE BL A L 14	JUNEAU AK	99801
5B1301140150	GARRISON JEFFREY A	\$ 3,300.00	6014	GULL WAY	6014 GULL WAY	EAGLES EDGE BL A L 15	JUNEAU AK	99801
5B1301140160	RODRIGUEZ ESTER G	\$ 3,300.00	6012	GULL WAY	6012 GULL WAY	EAGLES EDGE BL A L 16	JUNEAU AK	99801
5B1301140170	FELICIANO JAY Z & FELICIANO MARIA T	\$ 3,300.00	6010	GULL WAY	6010 GULL WAY	EAGLES EDGE BL A L 17	JUNEAU AK	99801
5B1301140180	PHILLIPS NANCY D	\$ 3,300.00	6008	GULL WAY	PO BOX 022241	EAGLES EDGE BL A L 18	JUNEAU AK	99802
5B1301140190	MAZON SONNY & HEIDI R	\$ 3,300.00	6006	GULL WAY	6006 GULL WAY	EAGLES EDGE BL A L 19	JUNEAU AK	99801
5B1301140200	LUMBAB REUBEN & RACHELL	\$ 3,300.00	6004	GULL WAY	6004 GULL WAY	EAGLES EDGE BL A L 20	JUNEAU AK	99801
5B1301140210	LAFFERTY ANITA E	\$ 3,300.00	6002	GULL WAY	6002 GULL WAY	EAGLES EDGE BL A L 21	JUNEAU AK	99801
5B1301140220	FLAKE MARY ANN	\$ 3,300.00	6000	GULL WAY	6000 GULL WAY	EAGLES EDGE BL A L 22	JUNEAU AK	99801
5B1301150010	SLADKY JERRY R	\$ 3,300.00	1200	BRITTANY PL	1200 BRITTANY PL	EAGLES EDGE BL B L 1PMB 301	JUNEAU AK	99801
5B1301150020	CANON MANUEL M & MARYGEN R	\$ 3,300.00	6015	GULL WAY	6015 GULL WAY	EAGLES EDGE BL B L 2	JUNEAU AK	99801
5B1301150030	TUDTUD MILA & PANTALEON	\$ 3,300.00	6013	GULL WAY	6013 GULL WAY	EAGLES EDGE BL B L 3	JUNEAU AK	99801
5B1301150040	TOLERO FLORENDO R & ROWEMARIE J	\$ 3,300.00	6011	GULL WAY	6011 GULL WAY	EAGLES EDGE BL B L 4	JUNEAU AK	99801
5B1301150050	STARR DELORES D	\$ 3,300.00	6009	GULL WAY	6009 GULL WAY	EAGLES EDGE BL B L 5	JUNEAU AK	99801
5B1301150060	ESCALONA RELYN G & GECEL C	\$ 3,300.00	6007	GULL WAY	1800 NORTHWOOD DR UNIT D28	EAGLES EDGE BL B L 6	JUNEAU AK	99801
5B1301150070	GONZALES GINA D	\$ 3,300.00	6005	GULL WAY	6005 GULL WAY	EAGLES EDGE BL B L 7	JUNEAU AK	99801
5B1301150080	REYNOLDS NELDA	\$ 3,300.00	6003	GULL WAY	PO BOX 020402	EAGLES EDGE BL B L 8	JUNEAU AK	99802
5B1301150090	WHITE LARRY E	\$ 3,300.00	6001	GULL WAY	6001 GULL WAY	EAGLES EDGE BL B L 9	JUNEAU AK	99801
5B1301150100	WILLIAMS NORMAN & LEONA	\$ 3,300.00	6000	CHATHAM DR	PO BOX 020633	EAGLES EDGE BL B L 10	JUNEAU AK	99802
5B1301150110	MEYERS MELINDA L	\$ 3,300.00	6002	CHATHAM DR	6002 CHATHAM DR	EAGLES EDGE BL B L 11	JUNEAU AK	99801
5B1301150120	WILSON JOHNNY S III	\$ 3,300.00	6004	CHATHAM DR	6004 CHATHAM DR	EAGLES EDGE BL B L 12	JUNEAU AK	99801

**Local Improvement District 97 Roll as Approved by the Assembly
December 17, 2018 per Resolution 2842**

5B1301150130	LOSSELYONG MELISSA A	\$	3,300.00	6006	CHATHAM DR	PO BOX 32738	EAGLES EDGE BL B L 13	JUNEAU AK	99803
5B1301150140	WERTHEIMER KEITH	\$	3,300.00	6008	CHATHAM DR	PO BOX 033121	EAGLES EDGE BL B L 14	JUNEAU AK	99803
5B1301150150	BARTOLABA JESS B	\$	3,300.00	6010	CHATHAM DR	6010 CHATHAM DR	EAGLES EDGE BL B L 15	JUNEAU AK	99801
5B1301150160	MARVIN PETER S	\$	3,300.00	6012	CHATHAM DR	6012 CHATHAM DR	EAGLES EDGE BL B L 16	JUNEAU AK	99801
5B1301150170	MALLINGER LORA J TRUST	\$	3,300.00	6014	CHATHAM DR	2000 RAMAR RD LOT 270	EAGLES EDGE BL B L 17	BULLHEAD CITY A	86442
5B1301160010	YADAO BERNARD T & RHODALIE	\$	3,300.00	6001	CHATHAM DR	9182 RIVERWOOD DR	EAGLES EDGE BL C L 1	JUNEAU AK	99801
5B1301160020	JEREZA HILLY V	\$	3,300.00	6003	CHATHAM DR	6003 CHATHAM DR	EAGLES EDGE BL C L 2	JUNEAU AK	99801
5B1301160030	OYLOE STEVE & FRANCES	\$	3,300.00	6005	CHATHAM DR	6005 CHATHAM DR	EAGLES EDGE BL C L 3	JUNEAU AK	99801
5B1301160040	NGUYEN PHAO	\$	3,300.00	6007	CHATHAM DR	8513 RAINBOW ROW	EAGLES EDGE BL C L 4	JUNEAU AK	99801
5B1301160050	MOLES LORI	\$	3,300.00	6009	CHATHAM DR	6009 CHATHAM DR	EAGLES EDGE BL C L 5	JUNEAU AK	99801
5B1301160060	LOTT TIMOTHY & YAVONNE	\$	3,300.00	1302	BRITTANY PL	1302 BRITTANY PL	EAGLES EDGE BL C L 6	JUNEAU AK	99801
5B1301160070	REMBULAT MARNELLIE	\$	3,300.00	1304	BRITTANY PL	1304 BRITTANY PL	EAGLES EDGE BL C L 7	JUNEAU AK	99801
5B1301160080	WELDON-WEETHEE TRUST	\$	3,300.00	1306	BRITTANY PL	649 TUMBLEWEED CR	EAGLES EDGE BL C L 8	INCLINE VILLAGE	89451
5B1301160090	JAMES MICHAEL K & PRECIOSA S	\$	3,300.00	1308	BRITTANY PL	1308 BRITTANY PL	EAGLES EDGE BL C L 9	JUNEAU AK	99801
5B1301160100	TLINGIT HAIDA REGIONAL HOUSING AUTH	\$	3,300.00	1310	BRITTANY PL	PO BOX 032237	EAGLES EDGE BL C L 10	JUNEAU AK	99803
5B1301160110	LIBRANDO DELILAH M	\$	3,300.00	1312	BRITTANY PL	1312 BRITTANY PL	EAGLES EDGE BL C L 11	JUNEAU AK	99801
5B1301160120	BROWN THEA Z	\$	3,300.00	1313	BELARDI DR	1313 BELARDI DR	EAGLES EDGE BL C L 12	JUNEAU AK	99801
5B1301160130	DELOS SANTOS JACQUELINE	\$	3,300.00	1311	BELARDI DR	1311 BELARDI DR	EAGLES EDGE BL C L 13	JUNEAU AK	99801
5B1301160140	HATCH JARRED	\$	3,300.00	1309	BELARDI DR	1309 BELARDI DR	EAGLES EDGE BL C L 14	JUNEAU AK	99801
5B1301160150	SORIANO KATHERINE&SORIANO MARIANO&M	\$	3,300.00	1307	BELARDI DR	1307 BELARDI DR	EAGLES EDGE BL C L 15	JUNEAU AK	99801
5B1301160160	JERUE RICHARD M & JANET K	\$	3,300.00	1305	BELARDI DR	PO BOX 033814	EAGLES EDGE BL C L 16	JUNEAU AK	99803
5B1301160170	ALGABRE NOEL S & FROLYNE YVONNE M	\$	3,300.00	1303	BELARDI DR	1303 BELARDI DR	EAGLES EDGE BL C L 17	JUNEAU AK	99801
5B1301170010	TLINGIT HAIDA REGIONAL HOUSING AUTH	\$	3,300.00	1321	BRITTANY PL	PO BOX 032237	EAGLES EDGE BL D L 1	JUNEAU AK	99803
5B1301170020	TLINGIT HAIDA REGIONAL HOUSING AUTH	\$	3,300.00	1319	BRITTANY PL	PO BOX 032237	EAGLES EDGE BL D L 2	JUNEAU AK	99803
5B1301170030	BROWN WILBUR G	\$	3,300.00	1317	BRITTANY PL	1317 BRITTANY PL	EAGLES EDGE BL D L 3	JUNEAU AK	99801
5B1301170040	TLINGIT HAIDA REGIONAL HOUSING AUTH	\$	3,300.00	1315	BRITTANY PL	PO BOX 032237	EAGLES EDGE BL D L 4	JUNEAU AK	99803
5B1301170050	CANO ROWENA L & JETER G	\$	3,300.00	1313	BRITTANY PL	1313 BRITTANY PL	EAGLES EDGE BL D L 5	JUNEAU AK	99801
5B1301170060	WILLE SHAWN P	\$	3,300.00	1311	BRITTANY PL	1311 BRITTANY PL	EAGLES EDGE BL D L 6	JUNEAU AK	99801
5B1301170070	YADAO ARIEL & BERNARDITA	\$	3,300.00	1309	BRITTANY PL	1309 BRITTANY PLACE	EAGLES EDGE BL D L 7	JUNEAU AK	99801
5B1301170080	BARAJAS DEANA	\$	3,300.00	1307	BRITTANY PL	PO BOX 035293	EAGLES EDGE BL D L 8	JUNEAU AK	99803
5B1301170090	BURFORD ROBERT A	\$	3,300.00	6029	CHATHAM DR	6029 CHATHAM DR	EAGLES EDGE BL D L 9	JUNEAU AK	99801
5B1301170100	DAVIS GEORGE L & AGNES R	\$	3,300.00	6027	CHATHAM DR	PO BOX 34324	EAGLES EDGE BL D L 10	JUNEAU AK	99803
5B1301170110	DEVENNY RICHARD L & PATSY K	\$	3,300.00	6025	CHATHAM DR	6025 CHATHAM DR	EAGLES EDGE BL D L 11	JUNEAU AK	99801
5B1301170120	OLANGCO R U & A R	\$	3,300.00	6023	CHATHAM DR	6023 CHATHAM DR	EAGLES EDGE BL D L 12	JUNEAU AK	99801
5B1301170130	PUNONGBAYAN ERNESTO M & EMMA T	\$	3,300.00	6021	CHATHAM DR	6021 CHATHAM DR	EAGLES EDGE BL D L 13	JUNEAU AK	99801
5B1301170140	KEOPPLE THOMAS L & SAMANTHA J	\$	3,300.00	6019	CHATHAM DR	6019 CHATHAM DR	EAGLES EDGE BL D L 14	JUNEAU AK	99801

**Local Improvement District 97 Roll as Approved by the Assembly
December 17, 2018 per Resolution 2842**

5B1301170150	PENALOSA NENELYN M & ROBERTO Y	\$	3,300.00	6017	CHATHAM DR	6017 CHATHAM DR	EAGLES EDGE BL D L 15	JUNEAU AK	99801
5B1301180010	KWANG K OH & JONG H KIM	\$	3,300.00	6030	CHATHAM DR	6030 CHATHAM DR	EAGLES EDGE BL E L 1	JUNEAU AK	99801
5B1301180020	SCHROEDER ELEANOR M	\$	3,300.00	6028	CHATHAM DR	6028 CHATHAM DR	EAGLES EDGE BL E L 2	JUNEAU AK	99801
5B1301180030	LUMBA DEMETRIO	\$	3,300.00	6026	CHATHAM DR	PO BOX 020883	EAGLES EDGE BL E L 3	JUNEAU AK	99802
5B1301180040	BOHULANO ULYSSES T & SABINA N	\$	3,300.00	6024	CHATHAM DR	6024 CHATHAM DR	EAGLES EDGE BL E L 4	JUNEAU AK	99801
5B1301180050	MENDOZA ELMER L & MARILOU	\$	3,300.00	6022	CHATHAM DR	PO BOX 033054	EAGLES EDGE BL E L 5	JUNEAU AK	99803
5B1301180060	CROPLEY FLORENCE MAY	\$	3,300.00	6020	CHATHAM DR	6020 CHATHAM DR	EAGLES EDGE BL E L 6	JUNEAU AK	99801
5B1301180070	GALLANT J GREG & TERRI S	\$	3,300.00	6018	CHATHAM DR	6018 CHATHAM DR	EAGLES EDGE BL E L 7	JUNEAU AK	99801
5B1301180080	OLANGCO ROLLY R & BEATRIZ Y	\$	3,300.00	6016	CHATHAM DR	6016 CHATHAM DR	EAGLES EDGE BL E L 8	JUNEAU AK	99801
5B1301180090	CARRILLO SUMMIT P	\$	3,300.00	1201	BRITTANY PL	1201 BRITTANY PL	EAGLES EDGE BL E L 9	JUNEAU AK	99801
5B1301180100	ELIZARDE NORMY	\$	3,300.00	6027	GULL WAY	6027 GULL WAY	EAGLES EDGE BL E L 10	JUNEAU AK	99801
5B1301180110	METCALFE JOHN & GEMMA	\$	3,300.00	6029	GULL WAY	6029 GULL WAY	EAGLES EDGE BL E L 11	JUNEAU AK	99801
5B1301180120	HOLLIDAY KIERNAN K & KATHLEEN A	\$	3,300.00	6031	GULL WAY	2227 N JORDAN AVE	EAGLES EDGE BL E L 12	JUNEAU AK	99801
5B1301180130	MOSKITO ROMULO & SALLY	\$	3,300.00	6033	GULL WAY	6033 GULL WAY	EAGLES EDGE BL E L 13	JUNEAU AK	99801
5B1301180140	SORIANO NUMERIANO QUINZON	\$	3,300.00	6035	GULL WAY	6035 GULL WAY	EAGLES EDGE BL E L 14	JUNEAU AK	99801
5B1301180150	HUGHES WENDY I	\$	3,300.00	6037	GULL WAY	PO BOX 021814	EAGLES EDGE BL E L 15	JUNEAU AK	99802
5B1301180160	GACETA GRANCIS S & JEMMALYN A	\$	3,300.00	6039	GULL WAY	6039 GULL WAY	EAGLES EDGE BL E L 16	JUNEAU AK	99801
5B1301180170	NEASE JOHN M & ROSEMARY	\$	3,300.00	6041	GULL WAY	PO BOX 034924	EAGLES EDGE BL E L 17	JUNEAU AK	99803

TOTAL \$ 290,400.00